

STATE OF NEW MEXICO
ENERGY AND MINERALS DEPARTMENT

OIL CONSERVATION DIVISION

P. O. BOX 2088

SANTA FE, NEW MEXICO 87501

Form C-101
Revised 10-1-78

NO. OF COPIES RECEIVED	
DISTRIBUTION	
SANTA FE	
FILL	<input checked="" type="checkbox"/>
U.S.G.S.	
LAND OFFICE	
OPERATOR	

30-059-2016

5A. Indicate Type of Lease
STATE ☐ REC ☐

5. State Oil & Gas Lease No.

APPLICATION FOR PERMIT TO DRILL, DEEPEN, OR PLUG BACK

1b. Type of Work a. Type of Well OIL WELL <input type="checkbox"/> GAS WELL <input checked="" type="checkbox"/> CO2 OTHER <input type="checkbox"/>		DEEPEN <input type="checkbox"/> PLUG BACK <input type="checkbox"/>		7. Unit Agreement Name BDCDGU	
2. Name of Operator Amoco Production Company		3. Address of Operator P. O. Box 68, Hobbs, New Mexico 88240		8. Farm or Lease Name BDCDGU 2034	
4. Location of Well UNIV LETTER G LOCATED 1650 FEET FROM THE East LINE OF SEC. 29 TWP. 20-N RGE. 34-E		10. Field and Pool, or Wildcat Und. Tubb		9. Well No. 291	
11. Elevations (Show whether DT, RT, etc.) 4840' GL		21A. Kind & Status Plug. Bond Blanket on file		22. Approx. Date Work will start 9-7-82	
12. County Union		19. Proposed Depth 2510'		19A. Formation Tubb	
20. Rotary or C.T. Rotary		21B. Drilling Contractor NA		20. Rotary or C.T. Rotary	

23.

PROPOSED CASING AND CEMENT PROGRAM

SIZE OF HOLE	SIZE OF CASING	WEIGHT PER FOOT	SETTING DEPTH	SACKS OF CEMENT	EST. TOP
12-1/4"	9-5/8"	32.30#	700'	Circ.	Surface
8-3/4"	7"	20#	2216'	Circ.	Surface
6-1/4"	5"	13#	2510'	Tie back to 7"	1916'

Propose to drill and equip well in the Tubb formation. After reaching TD logs will be run and evaluated. Perforate and stimulate as necessary in attempting commercial production.

MUD PROGRAM: 0'-700' Native mud and fresh water
700'-TD Commercial mud and brine with minimum properties for safe hole conditions.

BOP PROGRAM Attached
Gas is not dedicated.

APPROVAL VALID FOR 90 DAYS
PERMIT EXPIRES 11-11-82
UNLESS DRILLING UNDERWAY

0+2-NMOCDSF 1-HOU 1-SUSP 1-CLF 1-Amerada 1-UGI 1-Cities Serv. 1-Conoco
1-CO2 in Action 1-Excelsior 1-Sun. Tex.

COLLECT AND SACK SAMPLES FOR
NEW MEXICO BUREAU OF MINES, SOCORRO
AT AT LEAST TEN FOOT INTERVALS

IN ABOVE SPACE DESCRIBE PROPOSED PROGRAM; IF PROPOSAL IS TO DEEPEN OR PLUG BACK, GIVE DATA ON PRESENT PRODUCTIVE ZONE AND PROPOSED NEW PRODUCTIVE ZONE. GIVE BLOWOUT PREVENTER PROGRAM, IF ANY.

I hereby certify that the information above is true and complete to the best of my knowledge and belief.

Signed Cathy L. German Title Assist. Admin. Analyst Date 8-9-82

(This space for State Use)

APPROVED BY Carl Ulvog TITLE DISTRICT SUPERVISOR DATE 8-9-82

CONDITIONS OF APPROVAL, IF ANY:

OIL CONSERVATION COMMISSION TO BE NOTIFIED
WITHIN 24 HOURS OF BEGINNING OPERATIONS

NEW MEXICO OIL CONSERVATION COMMISSION
WELL LOCATION AND ACREAGE DEDICATION PLAT

Form C-102
Supersedes C-128
Effective 1-1-65

All distances must be from the outer boundaries of the Section

Operator AMOCO PRODUCTION COMPANY			Lease Bravo Dome CO2 Gas Unit		Well No. 2034 291G
Unit Letter G	Section 29	Township T20N	Range R34E	County UNION	
Actual Footage Location of Well: 1650 feet from the NORTH line and 1650 feet from the EAST line					
Ground Level Elev. 4844	Producing Formation Tubb		Pool Und. Tubb	Dedicated Acreage: 160 Acres	

- Outline the acreage dedicated to the subject well by colored pencil or hachure marks on the plat below.
- If more than one lease is dedicated to the well, outline each and identify the ownership thereof (both as to working interest and royalty).
- If more than one lease of different ownership is dedicated to the well, have the interests of all owners been consolidated by communitization, unitization, force-pooling, etc?

☐ Yes ☐ No If answer is "yes," type of consolidation _____

If answer is "no," list the owners and tract descriptions which have actually been consolidated. (Use reverse side of this form if necessary.) _____

No allowable will be assigned to the well until all interests have been consolidated (by communitization, unitization, forced-pooling, or otherwise) or until a non-standard unit, eliminating such interests, has been approved by the Commission.

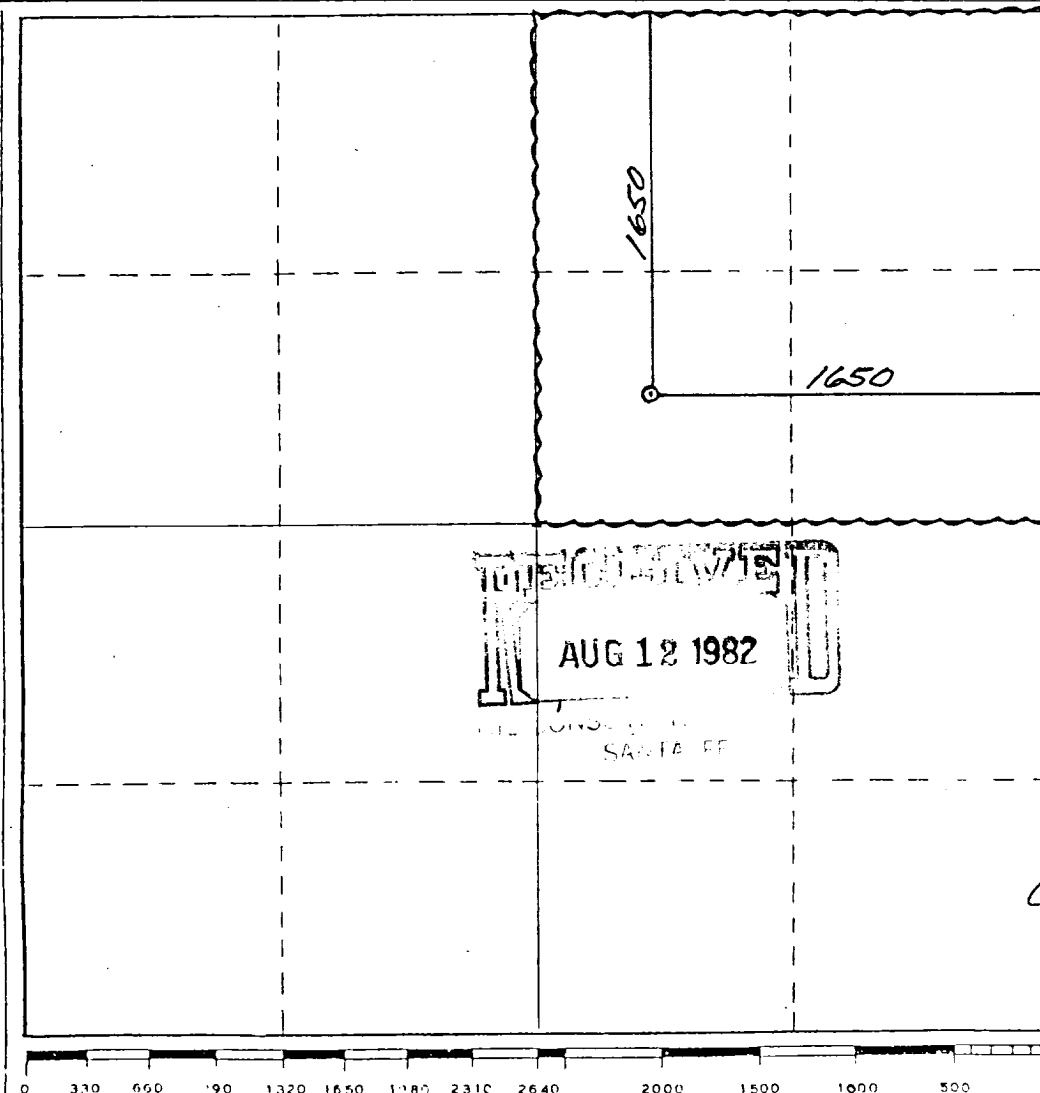

CERTIFICATION

I hereby certify that the information contained herein is true and complete to the best of my knowledge and belief.

Cathy L. Forman
Name

Position
Assist. Admin. Analyst

Company
Amoco Production Company

Date
8-9-82

I hereby certify that the well location shown on this plat was plotted from field notes of actual surveys made by me or under my supervision, and that the same is true and correct to the best of my knowledge and belief.

REGISTERED LAND SURVEYOR
AUG 12 1982

Date Surveyed
[Signature]
Registered Professional Engineer
and/or Land Surveyor
MEXICO

E. SHIELDS
N.M.L.S. NO. 5103
Certificate No.

NOTES

1. Blow-out preventers and master valve to be fluid operated and oil fittings must be in good condition, 3,000# W.P. (6,000 p.s.i. test), minimum.
2. Equipment through which bit must pass shall be as large as the inside diameter of the casing that is being drilled through.
3. Nipple above blow-out preventer shall be same size as casing being drilled through.
4. Kelly cock required, 3,000# W.P. (6,000 p.s.i. test) minimum.
5. OHSCO or comparable safety valve must be available on rig floor at all times with proper connection or sub, 3,000# W.P. (6,000 p.s.i. test), minimum.
6. Blow-out preventers and master valve while drilling intermediate hole to 6000' may be 2,000# W.P. (4,000 p.s.i. test), minimum.
7. Choke assembly, beyond second valve from cross, may be positioned (Optional) outside of derrick foundation.
8. Spool or cross may be eliminated if connections are available in the lower part of the blow-out preventer body.
9. Plug valves - gate valves are optional. Valves shown as 2" are minimum size.
10. Casing head and casing head spool, including attached valves, to be furnished by Amoco.
11. Rams in preventers will be installed as follows:

When drilling, use:	When running casing, use:
Top Preventer - Drill pipe rams	Top Preventer - Casing rams
Bottom Preventer - Blind rams or master valve	Bottom Preventer - Blind rams or master valve

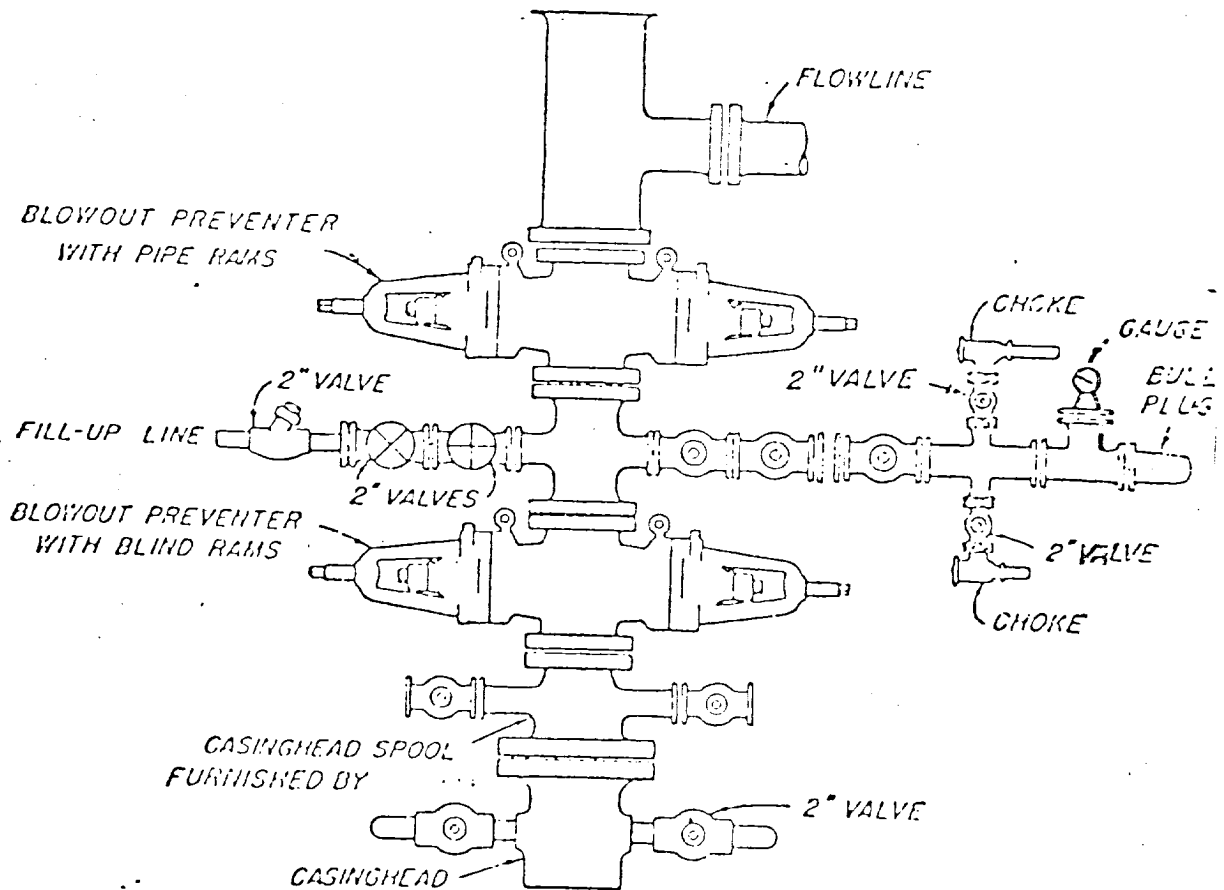

BLOWOUT PREVENTER HOOK-UP

AMOCO FIELD SERVICE COMPANY

EXHIBIT D-1 MODIFIED

JUNE 1, 1962