

## OIL CONSERVATION DIVISION

P. O. BOX 2088

SANTA FE, NEW MEXICO 87501

Form C-101  
Revised 10-1-78

NO. OF COPIES RECEIVED	
DISTRIBUTION	
SANTA FE	<input checked="" type="checkbox"/>
FILE	<input checked="" type="checkbox"/>
U.S.G.S.	<input checked="" type="checkbox"/>
LAND OFFICE	<input checked="" type="checkbox"/>
OPERATOR	<input checked="" type="checkbox"/>

API # 30-059-20266

5A. Indicate Type of Lease
STATE <input checked="" type="checkbox"/> FEE <input type="checkbox"/>
5. State Oil & Gas Lease No.
L-6221

## APPLICATION FOR PERMIT TO DRILL, DEEPEN, OR PLUG BACK

1a. Type of Work		7. Unit Agreement Name	
b. Type of Well DRILL <input checked="" type="checkbox"/> DEEPEN <input type="checkbox"/> PLUG BACK <input type="checkbox"/> OIL WELL <input type="checkbox"/> GAS WELL <input checked="" type="checkbox"/> CO2 OTHER <input type="checkbox"/> SINGLE ZONE <input type="checkbox"/> MULTIPLE ZONE <input type="checkbox"/>		BDCDGU	
2. Name of Operator		8. Farm or Lease Name	
Amoco Production Company		BDCDGU	
3. Address of Operator		9. Well No.	
P. O. Box 606, Clayton, New Mexico 88415		2331-351J	
4. Location of Well		10. Field and Pool, or Wildcat	
UNIT LETTER J LOCATED 1650 FEET FROM THE South LINE		Bravo Dome Carbon Dioxide	
AND 2310 FEET FROM THE East LINE OF SEC. 35 TWP. 23N RCE. 31E NADP		Gas Unit 640 Acre Area	
17. County		18. Rotary or C.T.	
Union		Rotary	
19. Proposed Depth		19A. Formation	
2900'		Tubb	
20. Elevations (Show whether DT, KL, etc.)		21. Kind & Status Plug. Bond	
5320' GL		Blanket-on-file	
21B. Drilling Contractor		22. Approx. Date Work will start	
N/A		March, 1985	

## PROPOSED CASING AND CEMENT PROGRAM

SIZE OF HOLE	SIZE OF CASING	WEIGHT PER FOOT	SETTING DEPTH	SACKS OF CEMENT	EST. TOP
12-1/4"	9-5/8"	32.30#	800'	Circulate	surface
8-3/4"	7"	20#	2900'	Tieback to 9-5/8"	surface

Propose to drill and equip well in the Tubb formation. After reaching TD logs will be run and evaluated. Perforate and stimulate as necessary in attempting commercial production.

Mud Program: 0 - 800' Native Spud Mud  
800 - TD KCL Salt Water Gel-Starch

APPROVAL VALID FOR 180 DAYS  
PERMIT EXPIRES 8-31-85  
UNLESS DRILLING UNDERWAY

BOP Diagram attached.

O+5-NMOCD,SF 1-J. R. Barnettt, HOU Rm. 21.156 1-F. J. Nash, HOU Rm. 4.206 1-WF, C 1-WF, H  
1-Susp, 1-JSM, 1-Amerada 1-Amerigas 1-Cities Service 1-Conoco 1-CO2 in Action 1-Sun  
1-Excelsior 1-Tex 1-Exxon

4 ABOVE SPACE DESCRIBE PROPOSED PROGRAM IF PROPOSAL IS TO DEEPEN OR PLUG BACK, GIVE DATA ON PRESENT PRODUCTIVE ZONE AND PROPOSED NEW PRODUCTIVE ZONE. GIVE BLOWOUT PREVENTER PROGRAM, IF ANY.

hereby certify that the information above is true and complete to the best of my knowledge and belief.

Signed Danny Helton Title Administrative Supervisor Date 2-28-85

(This space for State Use)

APPROVED BY \_\_\_\_\_ TITLE \_\_\_\_\_ DATE 3-4-85

CONDITIONS OF APPROVAL, IF ANY:

NEW MEXICO OIL CONSERVATION COMMISSION  
WELL LOCATION AND ACREAGE DEDICATION PLAT

Form O-111  
Supersedes O-111  
Effective 1-1-61

All distances must be from the outer boundaries of the Section.

Operator <b>AMOCO PRODUCTION CO.</b>			Lease <b>BRAVO DOME CARBON DIOXIDE GAS UNIT</b>		Well No. <b>2331 351J</b>
Unit Letter <b>J</b>	Section <b>35</b>	Township <b>T23N</b>	Range <b>R31E</b>	County <b>UNION</b>	
Actual Portage Location of Well: <b>1650</b> feet from the <b>SOUTH</b> line and <b>2310</b> feet from the <b>EAST</b> line					
Ground Level Elev. <b>5320</b>	Producing Formation <b>TUBB</b>		Pool <b>BRAVO DOME 640 ACRE AREA</b>		Dedicated Acreage: <b>640</b> Acres

1. Outline the acreage dedicated to the subject well by colored pencil or hachure marks on the plat below.
2. If more than one lease is dedicated to the well, outline each and identify the ownership thereof (both as to working interest and royalty).
3. If more than one lease of different ownership is dedicated to the well, have the interests of all owners been consolidated by communitization, unitization, force-pooling, etc?

☐ Yes ☐ No If answer is "yes," type of consolidation \_\_\_\_\_

If answer is "no," list the owners and tract descriptions which have actually been consolidated. (Use reverse side of this form if necessary.) \_\_\_\_\_

No allowable will be assigned to the well until all interests have been consolidated (by communitization, unitization, forced-pooling, or otherwise) or until a non-standard unit, eliminating such interests, has been approved by the Commission.

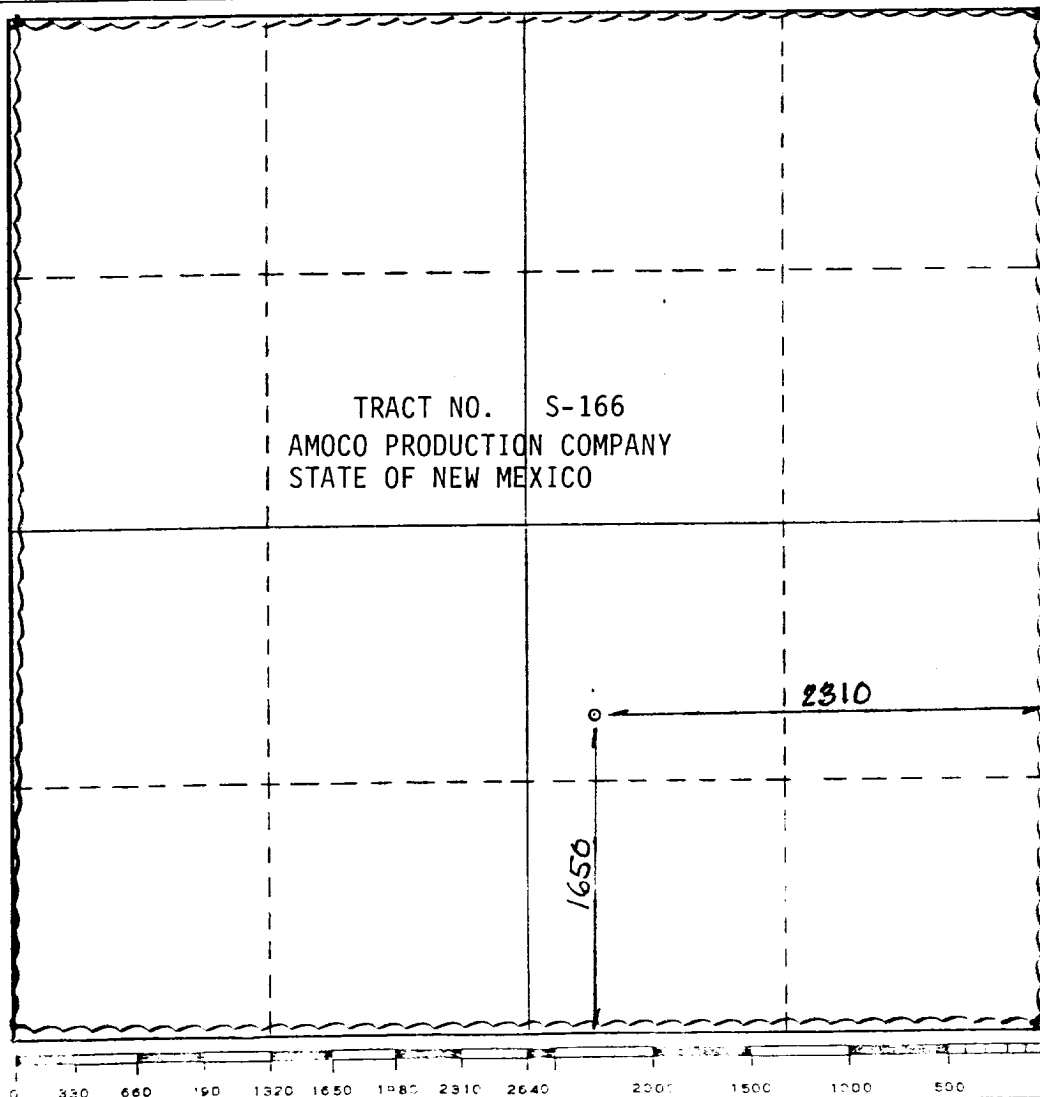

CERTIFICATION

I hereby certify that the information contained herein is true and complete to the best of my knowledge and belief.

Name Danny Holcomb  
Position  
**ADMINISTRATIVE SUPERVISOR**  
Company  
**AMOCO PRODUCTION COMPANY**  
Date  
**2-28-85**

I hereby certify that the well location shown on this plat was plotted from field notes of actual surveys made by me or under my supervision, and that the same is true and correct to the best of my knowledge and belief.

FEB. 28 1985

Date of Survey  
**5103**  
Registered Professional Engineer and/or Land Surveyor

N.M.O.C. NO. 5103

Certificate No. **SH-103**

STANDARD 2000 PSI W.P. BOP STACK

1. Blow-out preventers may be manually operated.
2. All equipment must be in good condition, 2,000 psi W.P. (4,000 psi test) minimum.
3. Bell nipple above blow-out preventer shall be same size as casing being drilled through.
4. Kelly cock to be installed on kelly.
5. Full opening safety valve 2,000 psi w.p. (4,000 psi test) minimum must be available on rig floor at all times with proper connection or subs to fit any tool joint in string.
6. Spool or cross may be eliminated if connections are available in the lower part of the blow-out preventer body.
7. Double or space saver type preventers may be used in lieu of two single preventers.
8. BOP rams to be installed as follows:
  - Top preventer - Drill pipe or casing rams
  - Bottom preventer - Blind rams

\*Anoco District Superintendent may reverse location of rams.
9. Extensions and hand wheels to be installed and braced at all times.
10. Manifold valves may be gate or plug metal to metal seal 2" minimum.

**ILLEGIBLE**

