

OIL CONSERVATION DIVISION

P. O. BOX 2088

SANTA FE, NEW MEXICO 87501

Form C-101
Revised 10-1-78

NO. OF COPIES RECEIVED	
DISTRIBUTION	
SANTA FE	
FILE	<input checked="" type="checkbox"/>
U.S.G.S.	
LAND OFFICE	
OPERATOR	

API # 30-059-20267

5A. Indicate Type of Lease
STATE ☐ FEDERAL ☒

5. State Oil & Gas Lease No.

APPLICATION FOR PERMIT TO DRILL, DEEPEN, OR PLUG BACK

1a. Type of Work b. Type of Well OIL WELL <input type="checkbox"/> GAS WELL <input checked="" type="checkbox"/> CO2 <input type="checkbox"/> OTHER <input type="checkbox"/>		DRILL <input checked="" type="checkbox"/> DEEPEN <input type="checkbox"/> PLUG BACK <input type="checkbox"/>		7. Unit Agreement Name BDCDGU	
2. Name of Operator Amoco Production Company		SINGLE ZONE <input type="checkbox"/> MULTIPLE ZONE <input type="checkbox"/>		8. Farm or Lease Name BDCDGU	
3. Address of Operator P. O. Box 606, Clayton, New Mexico 88415				9. Well No. 2135-291G	
4. Location of Well UNIT LETTER <u>G</u> LOCATED <u>1980</u> FEET FROM THE <u>North</u> LINE AND <u>1980</u> FEET FROM THE <u>East</u> LINE OF SEC. <u>29</u> TWP. <u>21N</u> REC. <u>35E</u> MURPHY				10. Field and Pool, or Wildcat BDCDGU 640 Acre Area	
				12. County Union	
		19. Proposed Depth 3300'		15A. Formation Tubb	
11. Elevations (show whether DT, HL, etc.) 4661' GL		21A. Kind & Status Plug. Bond Blanket-on-file		20. Rotary or C.T. Rotary	
		21B. Drilling Contractor N/A		22. Approx. Date Work will start 2nd Quarter, 1985	

PROPOSED CASING AND CEMENT PROGRAM

SIZE OF HOLE	SIZE OF CASING	WEIGHT PER FOOT	SETTING DEPTH	SACKS OF CEMENT	EST. TOP
12-1/4"	9-5/8"	32.30#	700'	Circulate	surface
8-3/4"	7"	20#	3300'	Tieback to 9-5/8"	surface

Propose to drill and equip well in the Tubb formation. After reaching TD logs will be run and evaluated. Perforate and stimulate as necessary in attempting commercial production.

Mud Program: 0 - 700' Native Spud Mud
700 - TD KCL Salt Water Gel-Starch

APPROVED BY 180 DAYS
11-2-85
UNITED STATES DEPARTMENT OF THE INTERIOR

BOP Diagram attached.

0+5-NMOCD,SF 1-J. R. Barnettt, HOU Rm. 21.156 1-F. J. Nash, HOU Rm. 4.206 1-WF, C 1-WF, 1-Susp, 1-JSM, 1-Amerada 1-Amerigas 1-Cities Service 1-Conoco 1-CO2 in Action 1-Sun 1-Excelsior 1-Tex 1-Exxon

4. ABOVE SPACE DESCRIBE PROPOSED PROGRAM; IF PROPOSAL IS TO DEEPEN OR PLUG BACK, GIVE DATA ON PRESENT PRODUCTIVE ZONE AND PROPOSED NEW PRODU-
IVE ZONE. GIVE BLOWOUT PREVENTER PROGRAM, IF ANY.

hereby certify that the information above is true and complete to the best of my knowledge and belief.

Signed Danny Holcomb Title Admin. Supervisor Date 5-2-85

(Has space for Signer)

DISTRICT SUPERVISOR

APPROVED BY [Signature] TITLE DATE 5-6-85

CONDITIONS OF APPROVAL, IF ANY:

NEW MEXICO OIL CONSERVATION COMMISSION
WELL LOCATION AND ACREAGE DEDICATION PLAT

Form C-102
Supersedes C-128
Effective 1-1-65

All distances must be from the outer boundaries of the Section.

Operator AMOCO PRODUCTION COMPANY			Lease Bravo Dome Carbon Dioxide Gas Unit		Well No. 2135 291G
Unit Letter G	Section 29	Township T21N	Range R35E	County UNION	
Actual Footage Location of Well: 1980 feet from the NORTH line and 1980 feet from the EAST line					
Ground Level Elev. 4661	Producing Formation Tubb	Pool Bravo Dome 640 Acre Area		Dedicated Acreage: 640 Acres	

1. Outline the acreage dedicated to the subject well by colored pencil or hatchure marks on the plat below.
2. If more than one lease is dedicated to the well, outline each and identify the ownership thereof (both as to working interest and royalty).
3. If more than one lease of different ownership is dedicated to the well, have the interests of all owners been consolidated by communitization, unitization, force-pooling, etc?

☐ Yes ☐ No If answer is "yes," type of consolidation _____

If answer is "no," list the owners and tract descriptions which have actually been consolidated. (Use reverse side of this form if necessary.) _____

No allowable will be assigned to the well until all interests have been consolidated (by communitization, unitization, forced-pooling, or otherwise) or until a non-standard unit, eliminating such interests, has been approved by the Commission.

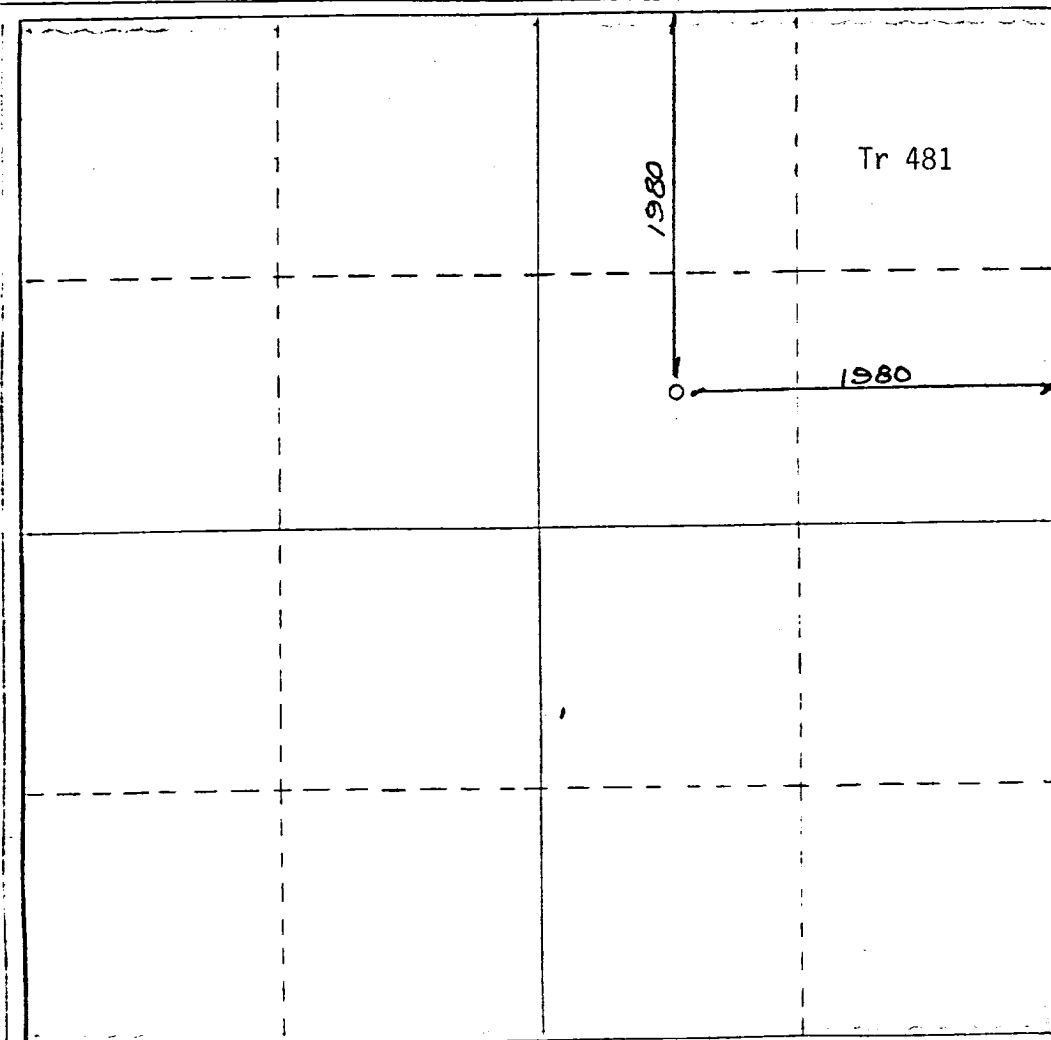

CERTIFICATION

I hereby certify that the information contained herein is true and complete to the best of my knowledge and belief.

Danny Holcomb
Name

Administrative Supervisor

Position

Amoco Production Company

Company

5-1-85

Date

I hereby certify that the well location shown on this plat was plotted from field notes of actual surveys made by me or under my supervision, and that the same is true and correct to the best of my knowledge and belief.

APR 10 1985

Date Surveyed

Registered Professional Engineer
and/or Land Surveyor

NEW MEXICO

N.M.E.S. NO. 5183
Certification No. SHT 18703

STANDARD 2000 PSI W.P. BOP STACK

1. Blow-out preventers may be manually operated.
 2. All equipment must be in good condition, 2,000 psi W.P. (4,000 psi test) minimum.
 3. Bell nipple above blow-out preventer shall be same size as casing being drilled through.
 4. Kelly cock to be installed on kelly.
 5. Full opening safety valve 2,000 psi w.p. (4,000 psi test) minimum must be available on rig floor at all times with proper connection or subs to fit any tool joint in string.
 6. Spool or cross may be eliminated if connections are available in the lower part of the blow-out preventer body.
 7. Double or space saver type preventers may be used in lieu of two single preventers.
 8. BOP rams to be installed as follows:
 - Top preventer - Drill pipe or casing rams
 - Bottom preventer - Blind rams
- *Amoco District Superintendent may reverse location of rams.
9. Extensions and hand wheels to be installed and braced at all times.
 10. Manifold valves may be gate or plug metal to metal seal 2" minimum.

