

NO. OF COPIES RECEIVED	
DISTRIBUTION	
SANTA FE	✓
FILE	✓
U.S.C.S.	✓
LAND OFFICE <i>NMOM</i>	✓
OPERATOR	✓

API# 30-059-20290

SA. Indicate Type of Lease  
STATE ☐ PER ☒  
B. State Oil & Gas Lease No.

APPLICATION FOR PERMIT TO DRILL, DEEPEN, OR PLUG BACK

1a. Type of work DRILL <input checked="" type="checkbox"/> DEEPEN <input type="checkbox"/> PLUG BACK <input type="checkbox"/>				Bravo Dome Carbon Dioxide Gas Unit	
b. Type of Well OIL WELL <input type="checkbox"/> GAS WELL <input checked="" type="checkbox"/> CO2 OTHER <input type="checkbox"/> SINGLE ZONE <input checked="" type="checkbox"/> MULTIPLE ZONE <input type="checkbox"/>				Bravo Dome Carbon Dioxide Gas Unit	
2. Name of Operator Amoco Production Company				9. Well No. 2034-131K	
3. Address of Operator P.O. Box 68 Hobbs, New Mexico 88240				Bravo Dome Carbon Dioxide Gas Unit 640-Acre Area	
4. Location of well UNIT LETTER <u>K</u> LOCATED <u>1650</u> FEET FROM THE <u>South</u> LINE AND <u>1650</u> FEET FROM THE <u>West</u> LINE OF SEC. <u>13</u> TWP. <u>20-N</u> REC. <u>34-E</u> MAPID					
				17. County <u>Union</u>	
18. Elevation (show whether Dr., H., etc.) <u>4690'</u> GL		19. Proposed Depth <u>2900'</u>		20. Rotary or C.T. Tubb Rotary	
21A. Kind & Status Plug. bond Blanket-on-file		21B. Drilling Contractor N/A		22. Approx. Date work will start ASAP	
23.					

### PROPOSED CASING AND CEMENT PROGRAM

SIZE OF HOLE	SIZE OF CASING	WEIGHT PER FOOT	SETTING DEPTH	SACKS OF CEMENT	EST. TOP
12-1/4"	9-5/8"	32.30#	700'	Circulate	surface
8-3/4"	7"	20.0#	2900'	Tieback to 9-5/8"	surface

Propose to drill and equip well in the Tubb formation. After reaching TD logs will be run and evaluated. Perforate and stimulate as necessary in attempting commercial production.

Mud Program:

0 - 700'	Native Spud Mud
700 - TD	KCL Salt Water Gel-Starch

BOP Diagram attached.

APPROVAL VALID FOR 180 DAYS  
PERMIT EXPIRES 4-14-86  
UNLESS DRILLING UNDERWAY

0+5-NMOCDSF 1-J. R. Barnettt, HOU Rm. 21.156 1-F. J. Nash, HOU Rm. 4.206 1-WF, C 1-WF,  
1-Susp, 1-CMH 1-Amerada 1-Amerigas 1-Cities Service 1-Conoco 1-CO2 in Action 1-Sun  
1-Excelsior 1-Tex 1-Exxon

4 ABOVE SPACE DESCRIBE PROPOSED PROGRAM; IF PROPOSAL IS TO DEEPEN OR PLUG BACK, GIVE DATA ON PRESENT PRODUCTIVE ZONE AND PROPOSED NEW PRO-  
 DUCTIVE ZONE. GIVE BLOWOUT PREVENTER PROGRAM, IF ANY.

11 2 11  
hereby certify that the information above is true and complete to the best of my knowledge and belief.

Signed Harry C. Clark Title Administrative Analyst Date 10-10-85

APPROVED BY Roy Johnson TITLE DISTRICT SUPERVISOR DATE 10-15-85

NEW MEXICO OIL CONSERVATION COMMISSION  
WELL LOCATION AND ACREAGE DEDICATION PLAT

Form C-102  
Supersedes C-128  
Effective 1-1-65

All distances must be from the outer boundaries of the Section

Operator AMOCO PRODUCTION COMPANY			Lease B.D.C.D.G.U.		Well No. 2034 131K
Unit Letter K	Section 13	Township T20N	Range R34E	County UNION	
Actual Section Location of Well: 1650 feet from the SOUTH line and 1650 feet from the WEST line					
Ground Level Elev. 4690	Producing Formation Tubb	Pool Bravo Dome 640 Acre Area		Dedicated Acreage: 640 Acres	

1. Outline the acreage dedicated to the subject well by colored pencil or hachure marks on the plat below.
2. If more than one lease is dedicated to the well, outline each and identify the ownership thereof (both as to working interest and royalty).
3. If more than one lease of different ownership is dedicated to the well, have the interests of all owners been consolidated by communitization, unitization, force-pooling, etc?

☒ Yes ☐ No If answer is "yes," type of consolidation Agreement or Forced Pooling

If answer is "no," list the owners and tracts, sections which have actually been consolidated. (Use reverse side of this form if necessary.)

No allowable will be assigned to the well until all interests have been consolidated (by communitization, unitization, forced-pooling, or otherwise) or until a non-standard unit, eliminating such interests, has been approved by the Commission.

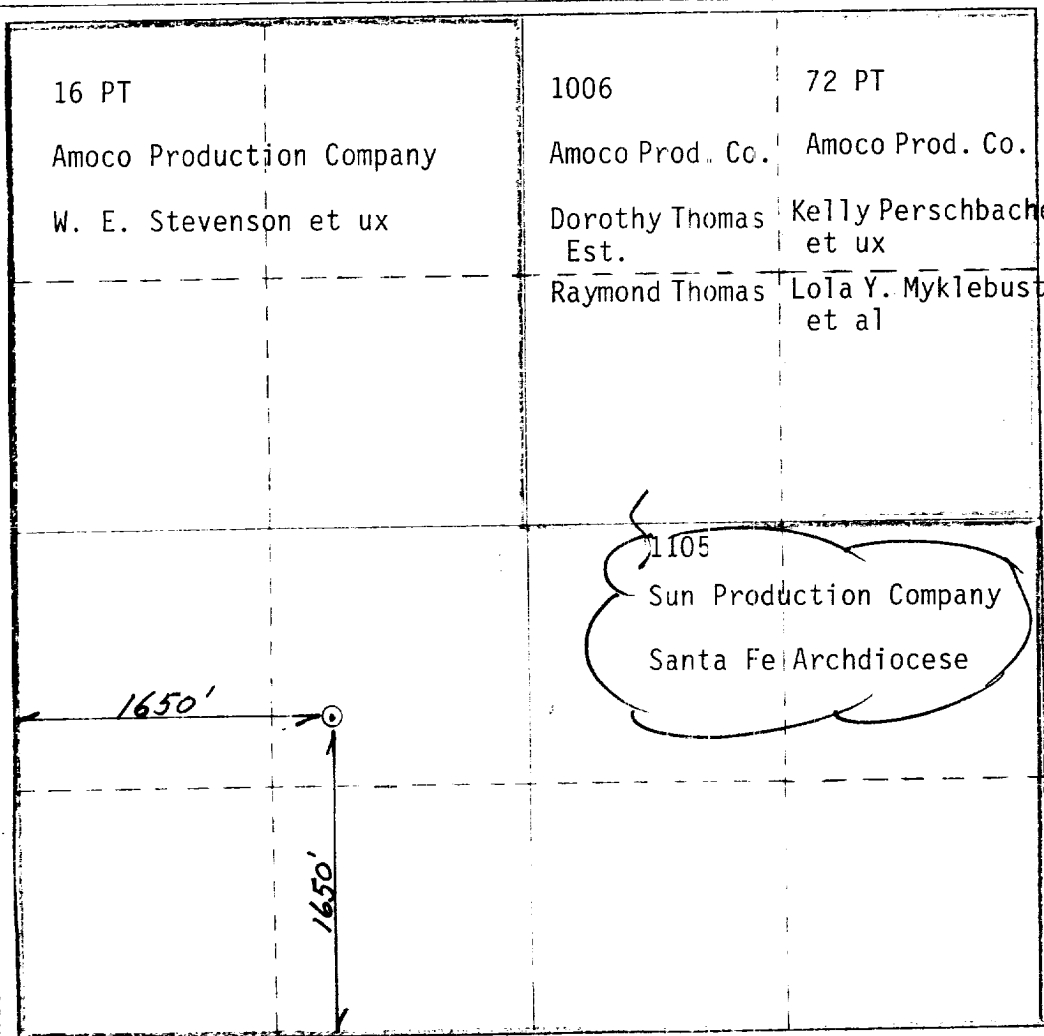

CERTIFICATION

I hereby certify that the information contained herein is true and complete to the best of my knowledge and belief.

Name Harry C. Clark  
Position Admin. Analyst  
Company Amoco Production Co.  
Date 10-10-85

I hereby certify that the well location shown on this plat was plotted from field notes of actual surveys made by me or under my supervision, and that the same is true and correct to the best of my knowledge and belief.

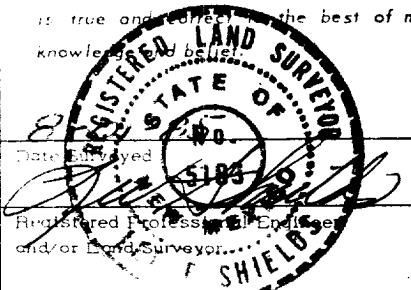

N.M.L.S. NO. 5103  
Certificate No.

STANDARD 2000 PSI W.P. BOP STACK

1. Blow-out preventers may be manually operated.
2. All equipment must be in good condition, 2,000 psi W.P. (4,000 psi test) minimum.
3. Bell nipple above blow-out preventer shall be same size as casing being drilled through.
4. Kelly cock to be installed on kelly.
5. Full opening safety valve 2,000 psi w.p. (4,000 psi test) minimum must be available on rig floor at all times with proper connection or subs to fit any tool joint in string.
6. Spool or cross may be eliminated if connections are available in the lower part of the blow-out preventer body.
7. Double or space saver type preventers may be used in lieu of two single preventers.
8. BOP rams to be installed as follows:
  - Top preventer - Drill pipe or casing rams
  - Bottom preventer - Blind rams

\*Amoco District Superintendent may reverse location of rams.
9. Extensions and hand wheels to be installed and braced at all times.
10. Manifold valves may be gate or plug metal to metal seal 2" minimum.

