

NO. OF COPIES RECEIVED		
DISTRIBUTION		
SANTA FE		
FILE	✓	
U.S.G.S.		
LAND OFFICE		
OPERATOR		

NEW MEXICO OIL CONSERVATION COMMISSION

Form C-101  
Revised 1-1-65

5A. Indicate Type of Lease	
STATE <input type="checkbox"/>	FEE <input checked="" type="checkbox"/>

5. State Oil & Gas Lease No.

APPLICATION FOR PERMIT TO DRILL, DEEPEN, OR PLUG BACK

1a. Type of Work		7. Unit Agreement Name	
b. Type of Well DRILL <input checked="" type="checkbox"/> DEEPEN <input type="checkbox"/> PLUG BACK <input type="checkbox"/> OIL WELL <input checked="" type="checkbox"/> GAS WELL <input type="checkbox"/> OTHER <input type="checkbox"/> SINGLE ZONE <input checked="" type="checkbox"/> MULTIPLE ZONE <input type="checkbox"/>		8. Farm or Lease Name <b>Santa Fe</b>	
2. Name of Operator <b>Shell Oil Company (Rocky Mountain Division)</b>		9. Well No. <b>Two</b>	
3. Address of Operator <b>1700 Broadway, Denver, Colorado 80202</b>		10. Field and Pool, or Wildcat <b>Santa Fe South Block Cactus Area (MC)</b>	
4. Location of Well UNIT LETTER <b>L</b> LOCATED <b>1650</b> FEET FROM THE <b>South</b> LINE AND <b>460</b> FEET FROM THE <b>West</b> LINE OF SEC. <b>29</b> TWP. <b>6N</b> RGE. <b>1W</b> NMPM		12. County <b>Valencia</b>	
19. Proposed Depth <b>14,000'</b>		19A. Formation <b>Entrada</b>	
20. Rotary or C.T. <b>Rotary</b>		21. Elevations (Show whether DF, RT, etc.) <b>5194 Gr.</b>	
21A. Kind & Status Plug. Bond <b>\$10,000 Plugging</b>		21B. Drilling Contractor <b>Noble</b>	
22. Approx. Date Work will start <b>February 15, 1974</b>			

23.

PROPOSED CASING AND CEMENT PROGRAM

SIZE OF HOLE	SIZE OF CASING	WEIGHT PER FOOT	SETTING DEPTH	SACKS OF CEMENT	EST. TOP

See attached drilling prognosis and well location and acreage dedication plat (Form C-102)

IN ABOVE SPACE DESCRIBE PROPOSED PROGRAM: IF PROPOSAL IS TO DEEPEN OR PLUG BACK, GIVE DATA ON PRESENT PRODUCTIVE ZONE AND PROPOSED NEW PRODUCTIVE ZONE. GIVE BLOWOUT PREVENTER PROGRAM, IF ANY.

I hereby certify that the information above is true and complete to the best of my knowledge and belief.

Original Signed By

Signed J. S. Mize Title Division Operations Engineer Date January 18, 1974

(This space for State Use)

APPROVED BY Carl Ulvog TITLE SENIOR PETROLEUM GEOLOGIST DATE 1-23-74  
CONDITIONS OF APPROVAL, IF ANY:

**NEW MEXICO OIL CONSERVATION COMMISSION**  
**WELL LOCATION AND ACREAGE DEDICATION PLAT**

Form C-102  
 Supersedes C-128  
 Effective 1-1-65

All distances must be from the outer boundaries of the Section.

Operator <b>SHELL OIL COMPANY</b>			Lease <b>SHELL-SANTA FE</b>		Well No. <b>2</b>
Unit Letter	Section <b>29</b>	Township <b>6 NORTH</b>	Range <b>1 WEST</b>	County <b>VALENCIA</b>	
Actual Footage Location of Well: <b>1650</b> feet from the <b>south</b> line and <b>660</b> feet from the <b>west</b> line					
Ground Level Elev. <b>5194</b>	Producing Formation <b>ENTRADA EXPLORATORY TEST</b>		Pool <b>WILDCAT</b>	<b>SANTA FE SOUTH BLOCK</b> <b>CACTUS AREA</b>	Dedicated Acreage: <b>40</b> Acres

1. Outline the acreage dedicated to the subject well by colored pencil or hachure marks on the plat below.
2. If more than one lease is dedicated to the well, outline each and identify the ownership thereof (both as to working interest and royalty).
3. If more than one lease of different ownership is dedicated to the well, have the interests of all owners been consolidated by communitization, unitization, force-pooling, etc?

☐ Yes    ☐ No    If answer is "yes," type of consolidation \_\_\_\_\_

If answer is "no," list the owners and tract descriptions which have actually been consolidated. (Use reverse side of this form if necessary.) \_\_\_\_\_

No allowable will be assigned to the well until all interests have been consolidated (by communitization, unitization, forced-pooling, or otherwise) or until a non-standard unit, eliminating such interests, has been approved by the Commission.

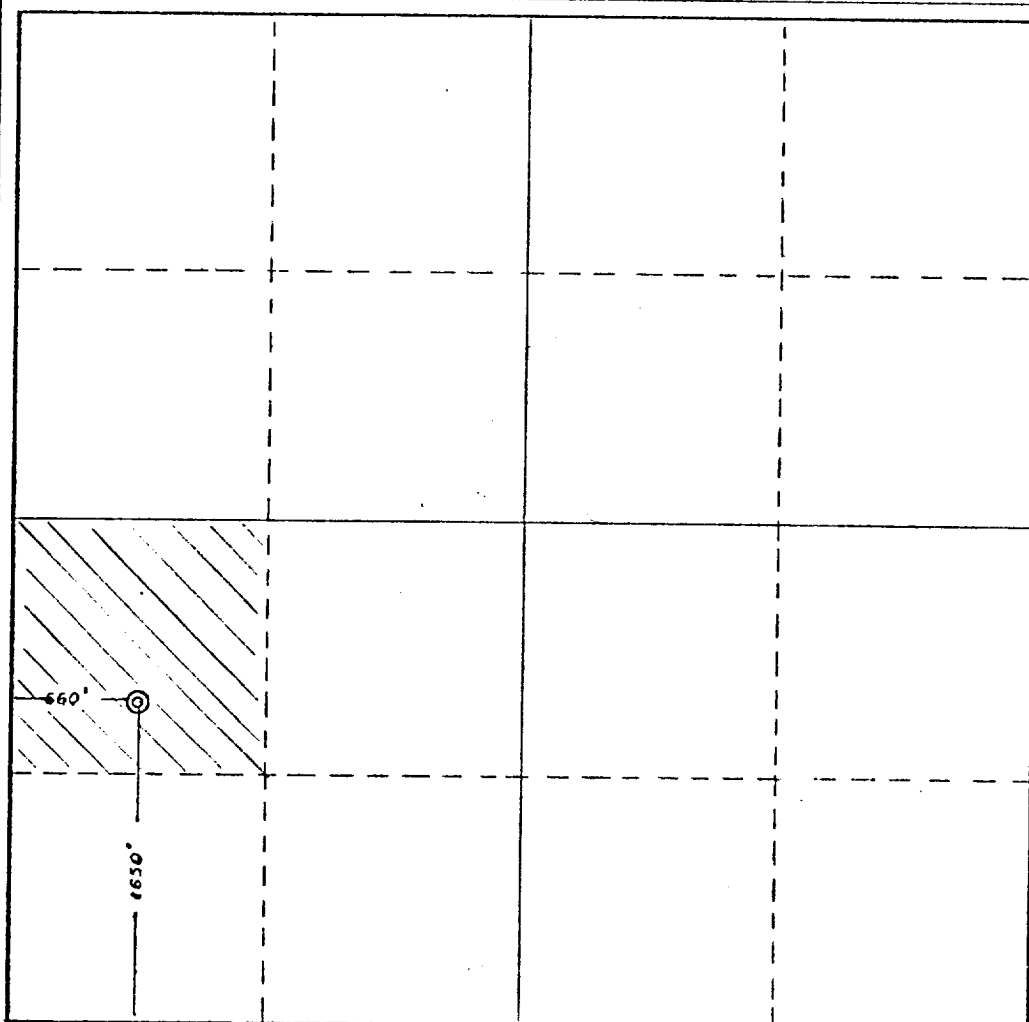

**CERTIFICATION**

*I hereby certify that the information contained herein is true and complete to the best of my knowledge and belief.*

*M. L. Gray*  
 Name

*Drilling Foreman*  
 Position

*Shell Oil Co*  
 Company

Company

Date  
*1-7-74*

*I hereby certify that the well location shown on this plat was plotted from field notes of actual surveys made by me or under my supervision, and that the same is true and correct to the best of my knowledge and belief.*

Date Surveyed  
*Jan. 5<sup>th</sup> 1974*

Registered Professional Engineer and/or Land Surveyor

*Fred D. Harrison*

Certificate No.  
*2031*

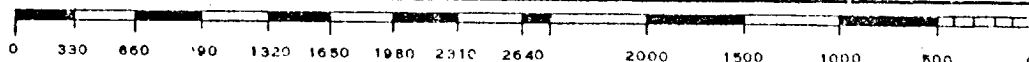

# DRILLING WELL PROGNOSIS

WELL NAME SHELL-SANTA FE NO. 2  
 TYPE WELL EXPLORATION WILDCAT  
 FIELD/AREA SANTA FE - SOUTH BLOCK (CACTUS)

APPROX. LOCATION (SUBJECT TO SURVEY) 1,400' FSL & 900' FWL Sec. 29-T6N-R1W Valencia Co., N. Mex.

EST. G.L. ELEVATION 5,180' PROJECTED TO 14,000' OBJECTIVE Entrada Sandstone  
(15,000') Max

SIZE	CASING PROGRAM	LOGGING PROGRAMS	MAX DEV.	DEPTHS AND FORMATION TOPS	SPECIAL INSTRUCTIONS
17 1/2"	13 3/8"	BHC FDC HDI DIL		300'±	SAMPLES: Surface to 5,000' - 30' 5,000' to TD - 10'
12 1/2"	9 5/8"	BHC FDC HDI DIL	3°	3,000'±	CORES: 10-30' Conventional 200 - Sidewall Shots DST'S: Cretaceous - 7 Conventional Jurassic - 1 Conventional DEVIATION CONTROL Dogleg severity less than 1 1/2° per any 100' interval drop Totco every 500' or on bit change.
8 3/4"	7" If Needed	BHC FDC HDI DIL DIL/SP CNL/GR/CAL PML Seismic Reference Survey Two Man Logging Unit	Angle Buildup Less Than 1° Per 1,000'	Menefee (K) 9,750' Dalton S.S. 11,500' Gallup S.S. 11,850' L. Reg. Gallup S.S. 12,350' Greenhorn LS 12,650' Dakota S.S. 12,700' Morrison (Jr) 13,150' Todilto Anhy 13,500' Entrada S.S. 13,600' TD 14,000'	CEMENT 13 3/8": Cement to Surface 9 5/8": Cement to Surface WOC minimum 18 hrs on any job. MUD Surface to 300' - Spud mud. 300' to 10,000' - Low solids non-dispersed. 10,000' to 14,000' - Dispersed WT: 9.0 VIS: 35-40 WL: 10cc or less

ORIGINATOR: J. N. Carlson DATE 10/1/73

ENGINEERING APPROVAL: [Signature]

PETROLEUM: [Signature]

OPERATIONS: [Signature]

OPERATIONS APPROVAL: [Signature]