

NO. OF COPIES RECEIVED	
DISTRIBUTION	
SANTA FE	
FILE	/
U.S.G.S.	
LAND OFFICE	
OPERATOR	

NEW MEXICO OIL CONSERVATION COMMISSION

API # 30-061-20013

Form C-101
Revised 1-1-65

5A. Indicate Type of Lease	
STATE <input type="checkbox"/>	FEE <input checked="" type="checkbox"/>
5. State Oil & Gas Lease No.	

APPLICATION FOR PERMIT TO DRILL, DEEPEN, OR PLUG BACK

1a. Type of Work	
DRILL <input checked="" type="checkbox"/> DEEPEN <input type="checkbox"/> PLUG BACK <input type="checkbox"/>	
b. Type of Well	
OIL WELL <input checked="" type="checkbox"/> GAS WELL <input type="checkbox"/> OTHER <input type="checkbox"/> SINGLE ZONE <input type="checkbox"/> MULTIPLE ZONE <input type="checkbox"/>	
2. Name of Operator	
REESE AND JONES	
3. Address of Operator	
20 First Plaza, Suite 402, Albuquerque, NM 87102	
4. Location of Well	
UNIT LETTER <u>0</u> LOCATED <u>990</u> FEET FROM THE <u>South</u> LINE AND <u>1980</u> FEET FROM THE <u>East</u> LINE OF SEC. <u>15</u> TWP. <u>6N</u> RGE. <u>3W</u> NMPM	
7. Unit Agreement Name	
8. Farm or Lease Name	
NZ	
9. Well No.	
2	
10. Field and Pool, or Wildcat	
Wildcat	
12. County	
Valencia	
19. Proposed Depth	
3500	
19A. Formation	
Pennsylvanian	
20. Rotary or C.T.	
Rotary	
21. Elevations (Show whether DF, RT, etc.)	
6186 Ungraded ground	
21A. Kind & Status Plug. Bond	
Blanket	
21B. Drilling Contractor	
22. Approx. Date Work will start	
February 1, 1980	

23. PROPOSED CASING AND CEMENT PROGRAM

SIZE OF HOLE	SIZE OF CASING	WEIGHT PER FOOT	SETTING DEPTH	SACKS OF CEMENT	EST. TOP
10 3/4	8 5/8	32	200	100	Cmt. circ.
7 7/8	5 1/2	14	3500 TD	200	2400

Plan to spud 10 3/4" hole and drill to 215 feet and set 200 feet of 8 5/8" casing with sufficient cement to circulate to surface. Drill 7 7/8" hole to 3500 feet or depth sufficient to test the Pennsylvanian formation and run appropriate logs. If production is indicated, will run 5 1/2" casing to total depth, cement with 200 sxs, perforate and stimulate if required. Will run 2 3/8" tubing for production string.

10" Double Gate Hydraulic Schaffer BOP tested to 3000 psi will be on well during all drilling operations.

COLLECT AND SAVE SAMPLES FOR
NEW MEXICO OIL CONSERVATION COMMISSION
AT AT LEAST PER 1000 FEET INTERVALS

APPROVAL VALID FOR 90 DAYS
PER AT LEAST 3-5-80
UNLESS DRILLING UNDERWAY

IN ABOVE SPACE DESCRIBE PROPOSED PROGRAM. IF PROPOSAL IS TO DEEPEN OR PLUG BACK, GIVE DATA ON PRESENT PRODUCTIVE ZONE AND PROPOSED NEW PRODUCTIVE ZONE. GIVE BLOWOUT PREVENTER PROGRAM, IF ANY.

I hereby certify that the information above is true and complete to the best of my knowledge and belief.

Signed Morris B. Jones Title Morris B. Jones, Engineer Date November 26, 1979
(This space for State Use)

APPROVED BY Carl Ulvog TITLE ENGINEER DATE 12-6-79

CONDITIONS OF APPROVAL, IF ANY:

OIL CONSERVATION COMMISSION TO BE NOTIFIED
WITHIN 24 HOURS OF BEGINNING OPERATIONS

WELL LOCATION AND ACREAGE DEDICATION PLAT

Supersedes C-122
Effective 1-1-65

All distances must be from the outer boundaries of the Section.

Operator REESE AND JONES		Lease NZ		Well No. 2
Unit Letter 0	Section 15	Township 6 North	Range 3 West	County Valencia
Actual Footage Location of Well:				
990 feet from the south line and		1980 feet from the east line		
Ground Level Elev. 6186	Producing Formation Pennsylvanian	Pool Wildcat	Dedicated Acreage: 40.00 Acres	

1. Outline the acreage dedicated to the subject well by colored pencil or hachure marks on the plat below.
2. If more than one lease is dedicated to the well, outline each and identify the ownership thereof (both as to working interest and royalty).
3. If more than one lease of different ownership is dedicated to the well, have the interests of all owners been consolidated by communitization, unitization, force-pooling, etc?

☐ Yes ☐ No If answer is "yes," type of consolidation _____

If answer is "no," list the owners and tract descriptions which have actually been consolidated. (Use reverse side of this form if necessary.) _____

No allowable will be assigned to the well until all interests have been consolidated (by communitization, unitization, forced-pooling, or otherwise) or until a non-standard unit, eliminating such interests, has been approved by the Commission.

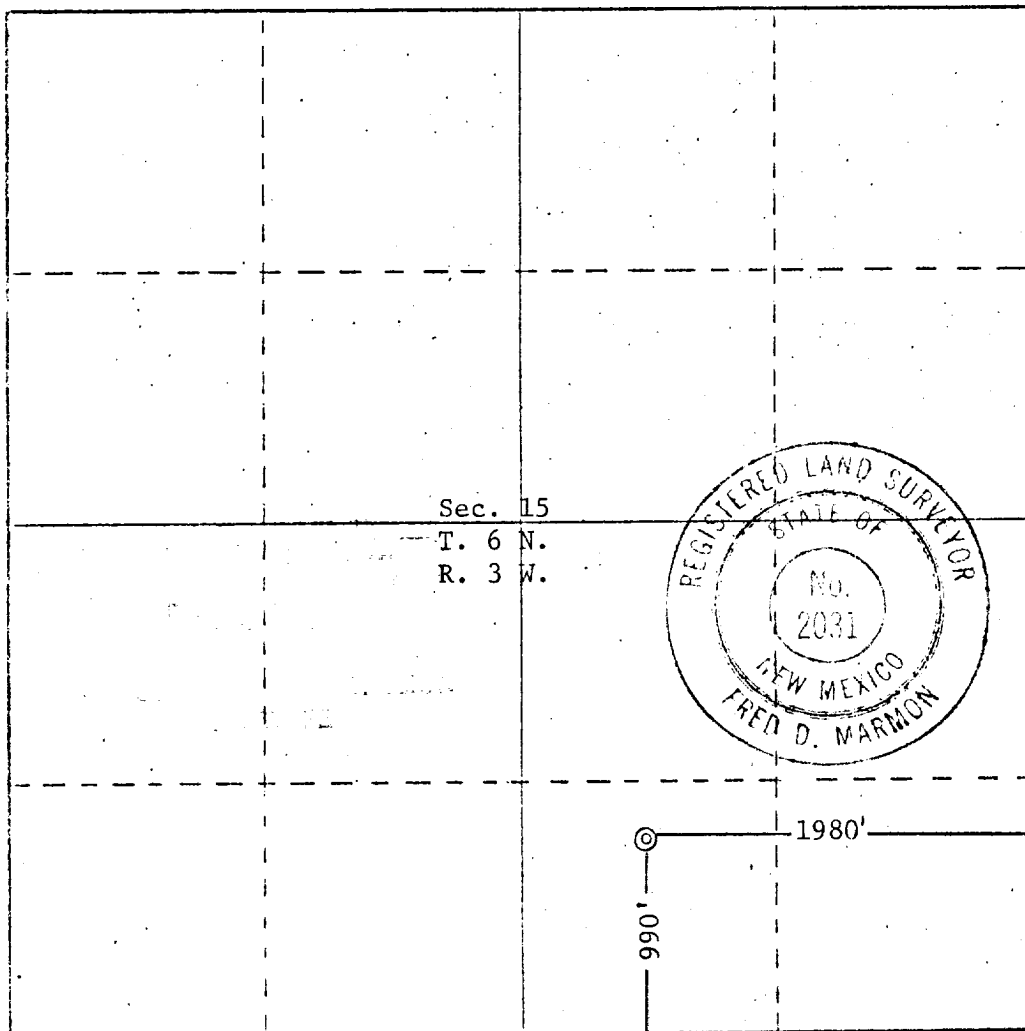

CERTIFICATION

I hereby certify that the information contained herein is true and complete to the best of my knowledge and belief.

Name: *Morris B. Jones*
Morris B. Jones
Position
Engineer

Company
Reese and Jones

Date
November 27, 1979

I hereby certify that the well location shown on this plat was plotted from field notes of actual surveys made by me or under my supervision, and that the same is true and correct to the best of my knowledge and belief.

Date Surveyed
November 24, 1979

Registered Professional Engineer
and/or Land Surveyor

Fred Marmion

Certificate No.
N.M. L.S. # 2031

