

NO. OF COPIES RECEIVED		
DISTRIBUTION		
SANTA FE	1	✓
FILE	1	
U.S.G.S.	1	
LAND OFFICE	1	
OPERATOR	1	

# NEW MEXICO OIL CONSERVATION COMMISSION

Form C-101  
Revised 1-4-65

API # 30-061-20021

APPLICATION FOR PERMIT TO DRILL, DEEPEN, OR PLUG BACK			
1a. Type of Work		7. Unit Agreement Name	
b. Type of Well DRILL <input checked="" type="checkbox"/> DEEPEN <input type="checkbox"/> PLUG BACK <input type="checkbox"/> OIL WELL <input checked="" type="checkbox"/> GAS WELL <input type="checkbox"/> OTHER <input type="checkbox"/> SINGLE ZONE <input type="checkbox"/> MULTIPLE ZONE <input type="checkbox"/>		8. Farm or Lease Name Penteco	
2. Name of Operator BRANA CORPORATION		9. Well No. 4	
3. Address of Operator 1223 First Interstate Bldg, 320 Gold Ave. SW, Albuquerque, NM 87102		10. Field and Pool, or Wildcat Wildcat	
4. Location of Well UNIT LETTER E LOCATED 2600 FEET FROM THE North LINE AND 1230 FEET FROM THE West LINE OF SEC. 19 TWP. 6N RGE. 2W NMPM		12. County Valencia	
19. Proposed Depth 3500		19A. Formation Penn Pictured Cliffs	
20. Rotary or C.T. Rotary		21. Elevations (Show whether DF, RT, etc.) 5986 grnd	
21A. Kind & Status Plug. Bond Blanket		21B. Drilling Contractor Salazar Bros.	
22. Approx. Date Work will start July 5, 1985			

## PROPOSED CASING AND CEMENT PROGRAM

SIZE OF HOLE	SIZE OF CASING	WEIGHT PER FOOT	SETTING DEPTH	SACKS OF CEMENT	EST. TOP
11 1/4"	8 5/8"	32	500	145CF	Circ.
7 7/8"	5 1/2"	14	3500TD	260CF	2000'

Plan to spud 11 1/4" hole and drilled to 500' and set 8 5/8" casing and cement to surface. Drill 7 7/8" hole to 3500' or depth sufficient to test the Pennsylvanian formation and run appropriate logs. If production is indicated, 5 1/2" casing will be run to total depth and cemented with 260 CF of cement, perforated and stimulated if required.

Double Gate Hydraulic BOP tested to 3000 psi will be on well during all drilling operations.

Verbal approval obtained from Mr. Roy Johnson, District Supervisor, Oil Commission, on July 2, 1985.

COLLECT AND SACK SAMPLES FOR  
NEW MEXICO BUREAU OF MINES, SOCORRO  
AT AT LEAST TEN FOOT INTERVALS

APPROVAL VALID FOR 90 DAYS  
PERMIT EXPIRES 10-15-85  
UNLESS DRILLING UNDERWAY

IN ABOVE SPACE DESCRIBE PROPOSED PROGRAM; IF PROPOSAL IS TO DEEPEN OR PLUG BACK, GIVE DATA ON PRESENT PRODUCTIVE ZONE AND PROPOSED NEW PRODUCTIVE ZONE. GIVE BLOWOUT PREVENTER PROGRAM, IF ANY.

I hereby certify that the information above is true and complete to the best of my knowledge and belief.

Signed Morris B. Jones Title Morris B. Jones, Engineer Date 7-2-85

APPROVED BY Roy Johnson TITLE DISTRICT SUPERVISOR DATE 7-15-85

CONDITIONS OF APPROVAL IF ANY: No allowable will be assigned until NON STANDARD LOCATION has been approved.

## OIL CONSERVATION DIVISION

P. O. BOX 2088

SANTA FE, NEW MEXICO 87501

Form C-102  
Revised 10-1-78

All distances must be from the outer boundaries of the Section.

Operator <b>BRANA CORPORATION</b>		Lease <b>Penteco</b>		Well No. <b>1</b>
Unit Letter <b>E</b>	Section <b>19</b>	Township <b>6 North</b>	Range <b>3 West</b>	County <b>Valencia</b>
Actual Footage Location of Well: <b>2600'</b> feet from the <b>North</b> line and <b>1230'</b> feet from the <b>West</b> line				
Ground Level Elev. <b>5986</b>	Producing Formation <b>Pennsylvanian</b>	Pool <b>Wildcat</b>	Dedicated Acreage: <b>40.00</b> Acres	

1. Outline the acreage dedicated to the subject well by colored pencil or hachure marks on the plat below.
2. If more than one lease is dedicated to the well, outline each and identify the ownership thereof (both as to working interest and royalty).
3. If more than one lease of different ownership is dedicated to the well, have the interests of all owners been consolidated by communitization, unitization, force-pooling, etc?

☐ Yes ☐ No If answer is "yes," type of consolidation \_\_\_\_\_

If answer is "no," list the owners and tract descriptions which have actually been consolidated. (Use reverse side of this form if necessary.) \_\_\_\_\_

No allowable will be assigned to the well until all interests have been consolidated (by communitization, unitization, forced-pooling, or otherwise) or until a non-standard unit, eliminating such interests, has been approved by the Commission.

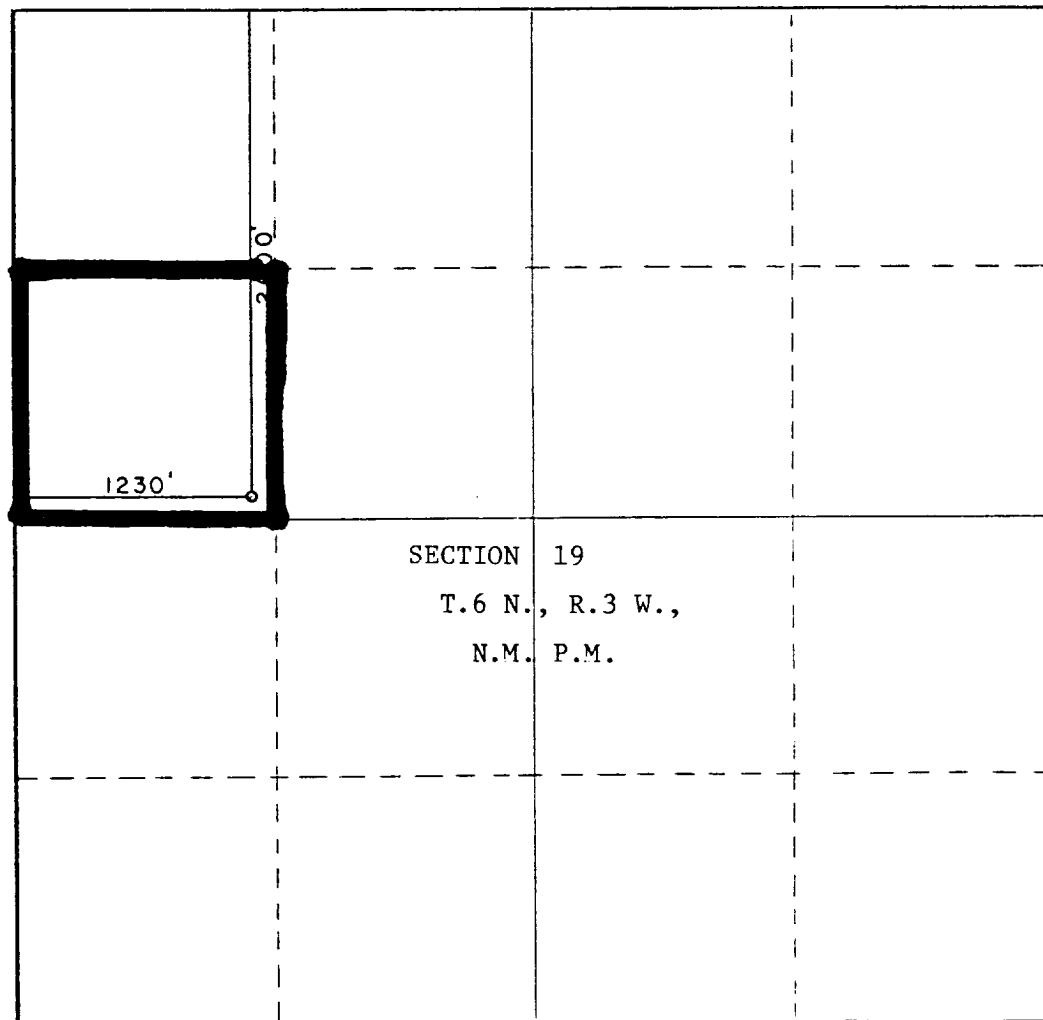

## CERTIFICATION

I hereby certify that the information contained herein is true and complete to the best of my knowledge and belief.

Name

Morris B. Jones

Position

Engineer

Company

Brana Corporation

Date

July 8, 1985

I hereby certify that the well location shown on this plat was plotted from field notes of actual surveys made by me or under my supervision, and that the same is true and correct to the best of my knowledge and belief.

Date Surveyed

July 1, 1985

Registered Professional Engineer  
and/or Land Surveyor Fred Marmon

*Fred J. Marmon*

Certificate No.

2031

0 330 660 990 1320 1650 1980 2310 2640 2000 1500 1000 500 0