

**GW - 163**

**GENERAL  
CORRESPONDENCE**

**YEAR(S):  
1994 - 2007**

**OCD DCP Midstream LP. Sites Discussion Meeting  
(Stephen Weathers, Daniel Dick, et. al) February 1, 2007**

**GPM Artesia GP (GW-23)**

On 5/26/2006, Stephen Weathers PG 303-605-1718 (swweathers@duke-energy.com) submitted a Flare Pit Soil Remediation & Closure Work plan by Conestoga-Rovers & Assoc. to Mike Bratcher. Upon your approval, DEFS will move forward w/ the closure activities. One hard copy of the work plan will also be mailed next week (OCD Santa Fe never received it).

Stephen Weathers, et al. will present the info. during the 1/31/2007 meeting in Santa Fe.

**Lee Compressor Station (GW-227) (Also known as the Gillespie/Feagan)  
A-24-T17 S 35 E**

Closure work plan dated 9/5/2006 mailed to Ben Stone to complete a site closure.

The work plan was develop. Based on DEFS decision to cancel the discharge plan GW-227 and close the site. The closure plan is submitted to the OCD for approval.

Closure Activities: DEFS will remove all remaining equip. from site. The site will be visually inspected to determine if hydrocarb. impacted soil is present at the site. If no HC impacted soils are encountered, the site will be leveled and reseeded with native grass. If HC impacted soils are encountered, the impact soil will be remediated following NMOCD Guidelines for Remed. of Leaks, Spills, & Releases, 8/1993 and using: Benz (10 ppm), BTEX (50 ppm), and TPH (100 ppm). A PID might be used to screen potential HC impacted soil. If headspace is  $\leq 100$  ppm, the PID reading will be used as a substitute to lab analysis for benz./BTEX. If the PID is not used for screening confirm. soil samples will be analyzed for BTEX using EPA 8021B.

HC impact soils that are found to be greater than cleanup criteria will be excavated and properly disposed at an NMOCD approved facility. Confirmation soil samples will then be collected within the base and sidewalls of the excavation to confirm that the HC impacted soils have been removed to below the NMOCD cleanup stds. for this site.

After confirmation soil samples confirm the impacted soils has been removed to below the NMOCD cleanup Stds., the excavation will be backfilled with clean fill mtl. and the area reseeded w/ native grass. A closure report will be completed summarizing all field activities and analytical results. The closure report will also request that no further action will be needed at this site. Upon approval of this work plan, field activities will be scheduled. A 48 hr. notice will be given to the NMOCD Hobbs DO informing them of the start up of the field activities.

## **LEE GP (GW-2)**

Dick Daniel (DIDick@dcpmidstream.com)

Received Q4 2006 GW Monitor Rpt. On 1/30/07 w/ recommendations for certain activities, i.e., free-product recovery in MWs 5 and 15 w/ restart analysis on MW-8 recommended.

Expired DP and OCD msg. to Ruth Lang on 12/21/06: the Lee Compressor Station (GW-227) correspondence dated 12/28/06 indicates that the facility will remain inactive and follow the closure plan to permanently close the facility. Upon receipt of the closure plan info. and verification that contamination exists at the facility with some photos to display what the site currently looks like, the OCD may close the DP?

## **DUKE LINAM RANCH GP (GW-15)**

Third Qtr. 2006 GW Monitoring Report dated January 30, 2007.

GW conditions remain stable. Next monitor event is scheduled for first qtr. 2007. Next annual report for site will be prepared following completion of first qtr. 2007 monitor activities.

On 11/1/2006 Dick Daniel (didick@duke-energy.com) submitted the Annual GW Rpt. 2005-2006. The summary rpt. for Q3 2005 and Q1 2006 GW sampling event. The data indicate that GW conditions remain stable. The next monitor event was performed in 9/2006. The next annual rpt. for the site will be prepared following the completion of the Q1 2007 monitor activities & review & validation of the analytical results. The water tables rose substantially more in MW-1 and 2 than in MW-3, 7 & 9. MW-1 & 2 are located in or adjacent to a natural drainage swale that has been blocked in the S part of site to produce an internally drained condition. The other 3 wells are outside of this area. Unusually high precip in 2004-2005 resulted in more GW mounding beneath the closed drain swale than the rest of the site. The water table in MWs 1 & 2 began to recede after the precip. patterns returned to normal. Water tables in the other 3 wells continue to rise suggesting a more dampened relationship between the precipitation and resulting chgs. in the water table elevations.

MW-7 was not included in the piezometer maps. The level in MW-7 was not included in these maps. Including this well results in a water-table configuration that suggests radial flow from the center of the property. MW-7 has never contained measurable BTEX. This suggests the relatively higher water table in the central part of site is localized so contours should not be carried to the NW. FPH thick measurements for 9/29/2005 (MW-4=0.68 in & MW-6=4.23 in.) and 3/22/2006 (MW-4=0.76 & MW-6=3.69 in.). Only MWs 10 & 10D exceeded BTEX Stds. Any dissolved phase BTEX that emanate from FPH at MW-4 & MW-6 attenuate to below the method reporting limits before migrating to the vicinity of MW-1 (cross gradient) or MW-8 (down gradient). BTEX measured at MW-10 and 10D attenuate to concentrations that are slightly above MW-9 or below the reporting limits (MW-12 & 13) at the interior down gradient wells. The above have remained constant since ~ 6/2001. This indicates that BTEX distribution and attenuating mechanism that controls it are equilibrated.

The affected areas are min. of 1,000 ft. from the nearest down gradient property boundary. Wells containing FPH are in an active gas processing area so the safety risks inherent to restarting FPH collection more than offsets the environmental benefits that would be associated with the activity. The data establishes that dissolved phase releases from the FPH that is present in this area are attenuated approx. 1,000 ft. from the nearest down-gradient property boundary. The next semi-annual GW monitor event is scheduled for the Q3 2006. Contact Michael Stewart PE 303-948-7733 if you have questions.

### **HOBBS BOOSTER CS (GW-44)**

Project Summary: Hobbs Booster Station, (Discharge Plan GW-044)  
(Units C and D, Section 4, Township 19 South, Range 38 East)

Summary date: October 10, 2006

#### **Project history:**

DEFS inherited Hobbs Booster Station (Former Gas Plant) when it acquired the assets of GPM. Site investigation activities began in July 1999. Plume delineation was completed in June 2003.

Two remediation systems are present at the site. An air sparge system was installed in January 2004 to control cross-gradient off site migration of dissolved phase hydrocarbons. It has operated on a near continual basis except for a couple of periods when it was under repair, and the groundwater data verifies that it is controlling off-site migration.

A free phase hydrocarbon (FPH) collection system became operational in January 2005 in the center of the site. It has operated on a regular schedule except for a couple of brief periods when it was down for repairs. The system has effectively remove FPH since it was started. The system is inspected and maintained on a regular basis DEFS is currently evaluating the potential of adding vacuum to the system to increase the production rate and capture zone of each well.

#### **Current Project Status:**

The hydrocarbon plume has been delineated to below the method detection limits. There is no evidence of plume expansion. Operation of the air sparge system is necessary to control dissolved-phase hydrocarbon releases to the south. FPH collection will continue indefinitely.

Detection level Groundwater monitoring continues at the site on a quarterly basis. Operation of the air sparge and the FPH collection system will continue indefinitely.

On 12/17/06 Michael Stewart & Steve Weathers notified OCD that Trident Environmental will conduct quarterly monitor well gauging & GW sampling and the following: SWLs in MW, RW and temp. wells using an oil/water interface problem; Collect GW samples for BTEX w/ QA/QC; Purge water disposed at NMOCD approved facility. Project site location: 1625 W. Marland, Hobbs (C&D 4-19S-36E). Sampling will begin on 12/20/06.

On 10/30/06, Stephen Weathers 303-605-1718 (swweathers@duke-energy.com) submitted additional vacuum enhancement testing for the free phase hydrocarbon extraction system located at C&D 4-19S-38E. DEFS would like to complete this test early next week. Upon completion of the field activities DEFS will complete an assessment report summarizing the results of the test.

The AEC 10/30/06 summary of initial assessment activities & recom. for further evaluation of adding vacuum enhancement to the free phase hydrocarbon extraction system. Depth (BTOC) is about 50 feet. The above SWL indicate that recent heavy rains have not affected the water table in a fashion similar to 2004 precip. This fact is important because the WT historically declined at a rate of about 1 ft/yr. this trend should continue to expose more of the screened interval in these wells to make them available to vacuum effects.

FPH thickness ranges from about 0.43 in. to 10.63 in. in TW-C, OW-25W & 50W, OW-100W, OW-25S, OW-50S, OW-25 E & OW-25 N. There is a gravel interval at about 34 to 64 feet BGL.

On 10/23/2006, Stephen Weathers 4-303-605-1718 (swweathers@duke-energy.com) submitted an electronic copy of the 2005-2006 Annual GW Monitor Rpt. along w/ a cover letter.

The report is missing & OCD should request another copy.

#### **DUKE APEX CS (GW-163)**

old conoco

Trisha Elizondo (ARCADIS) (Trisha.elizondo@arcadis-us.com)

On 1/17/07, notification that ARCADIS will be conducting mo. Product recovery and PCA Junction on 1/22-23/07. Routine product recovery is on-going at site through hand-bailing. MWs at 2 locations will be surveyed to help w/ GW flow & potentiometric surface.

#### **DUKE HOBBS GP (GW-175)**

old conoco

Stephen Weathers (SWWeathers@dcpmidstream.com)

Project Summary: Hobbs Gas Plant  
Unit G, Section 36 Township 18 South, Range 36 East

Summary date: October 10, 2006

Project history:

DEFS acquired the Hobbs Gas Plant in March of 2004. Ground water monitoring wells (6 wells) were installed at the site during the due diligence phase of the acquisition. Benzene was identified above the WQCC standards in one of the groundwater monitoring wells.

**Current Project Status:**

Groundwater monitoring continues at the site on a quarterly basis.

On 1/29/07, 4Q 2006 GW monitor rpt. submitted. Two MWs exhibit elevated benzene levels. SE and E-central portions of site adjacent to process equip. Qtly sampling continues. Results of Q1 2007 sampling will be reported in A1 2007 GW monitor report. Potentiometric surface maps for site in future reports can be expected.

**Remediation Sites**

**C-line Release Site (1RP-401-0)**

Project Summary: C-line Release site (1RP-401-0)  
(Unit O, Section 31, Township 19 South, Range 37 East)

Summary date: October 10, 2006

Project history: Pipeline Release

Duke Energy Field Services C-Line Pipeline Release occurred in May of 2002. The release occurred on New Mexico State Land. Environmental Plus, Inc. was contracted to complete the soil remediation. Approximately 3,868 cubic yards of impacted soil was excavated. 2,707 cubic yards of impacted soils was properly disposed and the remaining impacted soil was blended/shredded until below cleanup standards and placed back into the excavation. During the soil remediation, groundwater was determined to be impacted with hydrocarbons. The groundwater characterization activities began in fourth quarter 2002. A total of 9 groundwater monitor wells were installed. Active free phase hydrocarbon (FPH) removal initiated in November 2003. A soil vapor extraction system was installed in October 2004. The system was expanded to include a second well in June 2005. No FPH has been measured since March 2006 even after the SVE system was turned off (but remains at the site) in June 2006.

**Current Project Status:**

All FPH has been removed as discussed above. The hydrocarbon plume has been delineated. There is no evidence of plume expansion, and, in fact, the plume may actually be contracting.

Groundwater monitoring continues at the site on a quarterly basis. Site monitoring could be decreased to semi-annual.

Received Q3 2006 GW monitor rpt. from Stephen Weathers on 12/18/06.

## **Eldridge Ranch (AP-33)**

Stephen Weathers (SWWeathers@dcpmidstream.com)

Project Summary: Eldridge Ranch, (Abatement Plan AP-33)  
(Unit P, Section 21, Township 19 South, Range 37 East)

Summary date: October 10, 2006

Project history: Pipeline Release

DEFS initiated investigative activities in June 2002 following notification by NMOCD. Site characterization activities were largely completed by the fourth quarter of 2003. The boundaries of detectable hydrocarbons have been delineated.

DEFS submitted the Stage 1 Abatement Site Investigation Report (ASIR) on February 11, 2004 to the New Mexico Oil Conservation Division (OCD). In the ASIR, DEFS committed to continuing two activities (groundwater monitoring and free phase hydrocarbon (FPH) removal) independent of the ASIR review timeframe. The OCD has not commented on the ASIR. Groundwater monitoring and FPH removal activities continue on a regular basis.

### **Current Project Status:**

FPH recovery has been attempted at the site with limited results. The FPH at the site is generally limited in thickness to less than one foot. In addition, the FPH appears to be relatively immobile based upon the inability of the automatic collection systems to collect the liquids.

The hydrocarbon plume has been delineated to below the method detection limits. There is no evidence of plume expansion; however, concentrations the interior of the plume appears to exhibit nominal increases and decrease in response to seasonal precipitation.

Groundwater monitoring continues at the site on a quarterly basis. Site monitoring could be decreased to semi-annual without jeopardizing environmental impacts. FPH removal continues as site conditions warrant.

On 1/26/07, received Q4 2006 GW monitor rpt. for AP-33 near Monument NM. Some conclusions: FPH mobility appears to be limited based on historic bail down/recovery tests and failure to reappear; FPH thick is less than 0.8 ft. in six wells and less than 0.1 ft in 2 of 6 wells. FPH is relatively immobile at thick less than 1 ft. FH continues to decline in MW-EE from max. thick. of 0.83 ft. in 9/2005. FPH thick in other wells (excepting MW-CC) also exhibit decreasing trends. Benzene horiz. distrib. remain unchanged over duration of project. The benz level in the former house well continues to remain below NM WQCC GW std. Summer 2006 rains did not create a spike in levels at MWs like the heavy 2004-2005 rains. No evidence of plume expansion exists ; thus, natural attenuation stabilizes and removes hydrocarbs as they migrate away from area.

AEC recommends that Q1 2007 monitoring be completed and data reviewed to evaluate changes in GW flow patterns in S-central part of study area.

On 12/22/06, received Q3 2006 GW monitor report conclusions: FPH remains in 4 wells in W-central part of study area. FPH thick decrease in 3 of 4 wells. FPH present to N in MW-EE at 0.35 ft. FPH continues to decline from max thick of 0.83 ft. in 9/2005. FPH was not measured anywhere else within study area. FPH mobility appears to be limited based on historic bail down/recovery tests and its failure to reappear in previously affected wells to S. Benz distrib. unchg. over duration of project. Temporal benz distrib. - see charts.

On 10/24/06, Stephen Weathers 303-605-1718 (swweathers@duke-energy.com) submitted GW monitor rpt. for Q2 2006. The former NMG-148C Study Area was combined with the Eldridge Ranch Study Area beginning w/ the Q1 2006. The areas were combined after estab. that hydrocarb plume orig. from NMG-148C had migrated into the Eldridge Ranch Study Area before it attenuated. The combined sites will be treated as a single entity in all subsequent sample events. Activities are governed under AP-33. DEFS submitted the Stage 1 Abatement Site Investigation Rpt. (ASIR) on 2/11/2004 to the OCD. In that rpt., DEFS is committed to continuing 2 activities independ. of the ASIR review timeframe. The activities include GW monitor. & free phase hydrocarb. (FPH) removal when practicable.

GW Monitor activities were completed on 6/19 and 20, 2006 abiding by the OCD approved SAP. SWLs, FPH tick measurements, and GW sampling were completed (see report). The conclusions were: The interpretations are grouped accord. to GW flow, product thick and GW chemistry. 6/2006: data from newly installed MW-28-31 continues to indicate that GW flow beneath the northern part of the Huston property is southward rather than toward the SE.

The WT continues to decline at a uniform rate across the site from a high in 12/2004. The vertical gradient measured between MWs 1s & 1d has not varied substantially over the duration of the project.

Conclusions are: FPH is present in 5 MWs in the w-central part of the study area. The FPH mobility appears to be limited based upon historic bail down/recovery tests & its failure to reappear in previously affected wells to the S. FPH was also present to the N in MW-EE at 0.35 ft. FPH has now declined from a max. thick of 0.83 ft. in 9/2005. FPH was not measured anywhere else within the study area. The Benz distribution has remained essentially unchg. over the duration of the project. MWs 28, 30 & 31 installed in 3/2006 did not contain detectable concentrations of BTEX constituents when they were sampled a second time. MW-29 has detected BTEX. The northernmost NMG-148C plume and moves south. The pattern indicates that the areal extent of the dissolved phase plume assoc. w/ NMG release is not expanding.

The concern. in MW-e & MW-1 located in the S part of this area continue to decline. Samples from the other 4 wells (MW-M, O, Q & M) produced concentrations that were at or slightly higher than the 3/2006 values. This indicates that the S part of the dissolved phase plume in this area appears to be contracting to the N while the remainder of the plume in this area remains constant. None of the data indicates that the plume is expanding.



Benz time concent. for the wells located immed. adjacent to MW-1 or on the Eldridge property (irrigation wells, house well) are shown in Fig. 9. The concentrations in MW-1 and the irrig. well leveled out after an apprec. 1-yr decline. The concent. in the house well has remained consistent over the past 3 sample events. The pattern does not indicate that the dissolved phase plume is expanding in this area. Wells MW-A, 4 & 5 located N of the Huston-Eldridge boundary, remained relatively consistent.

All of the above relationships indicate that natural attenuation is stabilizing & removing hydrocarbs as they migrate away from the src. areas. There is no evidence of plume expansion.

#### Recommendations:

AEC recommends that a Q3 monitoring be completed and evaluated. The monitor freq. should then be decreased from qtrly. to semi-annual if the data results do not vary appreciably. The potential for FPH removal will be evaluated based upon info. gathered during the Q3 monitor event. Recommendations on FPH will be provided as necessary separate from the monitor report. Michael Stewart PE (303-948-7733).

#### **J-4-2 Release Site**

Project Summary: J-4-2 Release Site  
Unit C, Section 27 Township 19 South, Range 35 East

Summary date: October 10, 2006

Project history: Pipeline Leak

The release at this site was discovered in August 2005. EPI completed a limited soil cleanup and preliminary groundwater investigations between August 2005 and the first quarter of 2006.

A work plan proposing additional site characterization activities was submitted to the NMOCD. The site activities were completed in September 2006 and a report is currently being generated.

#### Current Project Status:

Preliminary evaluation of the data indicates that the groundwater plume has been defined beyond the limit of detectable concentrations. Additional activities will be proposed as necessary in the pending investigative report.

On 12/28/06, Stephen Weathers e-mailed a AEC Consultants site investigation rpt. (12/26/07). Water table elevations rose by 0.45 to 1 ft. FPH thickness in MW-2 declined from 0.57 to 0.15 between 2/06 and 9/06. Probably due to high precip. summer 2006. I~ 0.006 toward SE. Head at MW-2 slightly higher than at other wells. K~ 90 ft/day based on pump test. n! 0.15. Estimated GW velocity !3.6 ft/day or 1,310 ft/yr. All develop. and purge water was disposed of at the Linam Ranch facility by EPI. All cuttings generated during the drilling process will be stockpiled

and sampled and then disposed of in an appropriate fashion. Unaffected cuttings will be spread thin.

Final field activity completed was to measure physical properties of saturated mtl. Slug tests were completed on all wells that don't contain FPH to estim. saturated K.

Following recommendations from AEC (Michael Stewart 303-948-7733):

A passive bailer should be installed in MW-2 to attempt to remove mobile FPH. GW monitoring should be completed 3 more times on a qtly. basis to compile a data base based upon 4 seasons of measurements; Qtly repts should be generated based upon the results of the 4th qtr. 2006 and Q1 2007 monitor events; A comprehensive report will be compiled follow. completion of Q2 2007 monitor episode. This report. include recom. of both long-term monitor and , if necessary, implementation of active remediation; Additional charact. activities & active remediation activities will not be completed during this time interval unless data indicates hydrocarb. plume is expanding; the next GW monitor event is scheduled fro the Q4 2006.

On 12/20/06, John Furgerson (jmfergerson@grandecom.net) sent msg. that Trident Environ. a subcontractor of Duke's will be conducting monitor well gauging & GW sampling at 1300 MST Thursday, Dec. 21, 2006. They will measure SWLs in all MWs using an oil/water interface probe; purge non-product MW/RWs. Collect GW samples for BTEX; ship samples using COC protocol; and purge water will be disposed at a NMOCD approved facility.

### **X-line Site (1RP-400)**

Project Summary: X line Release Site (1RP-400)  
Unit B, Section 7 Township 15 South, Range 34 East

Summary date: October 10, 2006

Project history: Pipeline Release

The release at this site was discovered in January 2002. EPI completed soil cleanup and preliminary groundwater investigations the first quarter of 2002. A preliminary groundwater investigation was completed in May 2002.

The following remediation components were installed at the site:

- A free phase hydrocarbon (FPH) removal system was installed in MW-8 in July 2003. The system continued to function until the mobile FPH was removed.
- An air sparge (AS) system became operational in June 2003. The system was operated until hydrocarbon concentrations in the wells (except for the FPH collection well) were all measured below the method detection limits.

· A soil vapor extraction (SVE) system was also installed in June 2003. The SVE system operated regularly until August 2006. No FPH was present in the extraction well in September 2006.

Quarterly monitoring is completed at the site. The last monitoring episode was conducted in September 2006.

**Current Project Status:**

A report detailing the September 2006 activities at this site will be prepared when the analytical data is received and verified.

DEFS will evaluate the feasibility of initiating air sparge in the FPH recovery well to complete source recovery provided no additional FPH is measured in the well.

Received 4th qtr 2006 GW monitor report for pipeline release on January 30, 2007.

Received Q3 2006 GW monitor report from Stephen Weathers 303-605-1718)) for pipeline release on 12/18/06. X-Line pipeline release on the Etcheverry Ranch at 33 deg 02 min 11 sec, 103 deg 32 min 48 sec. MWs 1 through 8 sampled. SWLs reassured. Unfiltered samples were collected for BTEX. MW-8 is not included in hydrograph because casing elev. has not been established (see report for conclusions, etc.).

On 9/8/2006, Stephen Weathers (swweathers@duke-energy.com) sent Ben Stone the Q2 2006 GW monitor report located on the Etcheverry Ranch near Lovington, NM.

The report is missing and OCD needs another copy.

**RR Ext, (AP-55)**

Project Summary: RR Ext, (Abatement Plan AP-55)  
Unit C, Section 19 Township 20 South, Range 37 East

Summary date: October 10, 2006

**Project history:**

DEFS initiated cleanup activities after a December 13, 2005 release. The spill was remediated, and a temporary well was drilled to groundwater during the first quarter of 2006. A sample from the well contained dissolved-phase hydrocarbons.

The NMOCD assigned the site an abatement plan number based upon the groundwater sample. A Stage 1 Abatement Plan Proposal was submitted to the NMOCD on or about May 26, 2006.

**Current Project Status:**

DEFS is waiting for approval for the Stage 1 Abatement Plan Proposal. DEFS will initiate the required activities following receipt of that approval

### **PCA Junction**

Trisha Elizondo (ARCADIS) (Trisha.elizondo@arcadis-us.com)

On 1/17/07, notification that ARCADIS will be conducting mo. Product recovery and PCA Junction on 1/22-23/07. Routine product recovery is on going at site through hand bailing. MWs at 2 locations will be surveyed to help w/ GW flow & potentiometric surface.

### **Monument Booster Station (Gas Compression Facility)**

Q3 2006 GW Monitor activities completed on 9/20/06 & submitted 1/30/07. Next monitor event Q1 2007. Next annual rpt. Prepared following completion of Q1 2007.

No measurable free-product was detected in any MWs. However, in the submittal is shows MWs 1 and 5 have free product at 1.6 and 0.55 inches? No BTEX detected in down-gradient boundary wells MW-3 and 4. No BTEX in up gradient MWs 1D and 2. MW-6 showed anomalously high levels of BEX. Will keep in mind next sample event for continuing trend.

On 11/1/2006, Daniel Dick 303-605-1893 (didick@duke-energy.com) submitted Annual GW Monitor Rpt. 2005-2006. A copy of the summary report for Q3 2005 and Q1 2006 GW sampling effort. Data indicates that the GW conditions remain stable. The next monitor episode was performed 9/2006. The next annual report for the site will be prepared following the completion of the Q1 2007 monitor activities & review & validation of the analytical results. FPH thick measurements on 3/16/06 for period since passive FPH collectors were removed at MW-1 (0.37 in.) and MW-5 (0.39). FPH thick may be declining in MW-1 and is stable at MW-5. None of the BTEX constituents were detected in downgrade boundary wells MW-3 and MW-4. BTEX was also not detected in upgrade wells MW-1D & 2. Hydrocarbs were detected in MW-7, but benz was only constituent above WQCC Stds. No sample has exceeded the WQCC Stds for TEX. Only MW-7 samples have exceeded for benz. Since 2/2000. Benz detection sporadic in all wells except MW-7 since 2/2000. BTX concentrations in MW-7 continue to fluctuate.

Further src. control activities should be postponed given the decreasing product thick in MW-1. The Next semi-annual gw monitor event is scheduled for Q3 2006. Reporting will continue on an annual basis unless unusual conditions warrant notification after the Q3 sampling event.

Attachment: DCP Midstream LP Related Facilities

Application No.	Application Type	Order No. (ex. GW-#)	Applicant	Facility	Environmental Permit Status	Rcvd	Order	Exp	Legal	County	Reviewer	District	Issuing Off	Notes	Cleanup Status
pENV000GW0154	Discharge Plan Permit	143	DCP MIDSTREAM L.P.	DUKE CAL-MON CS	A	03/29/1993	05/14/1993	05/14/2006	J-35-23 S-31 E	Eddy	Chavez	Artesia	Santa Fe		
pENV000GW0242	Discharge Plan Permit	227	DCP MIDSTREAM L.P.	LG&E HADSON GILLESPIE/EAGAN CS	I		12/28/1995	12/28/2005	A-24-17 S-35 E	Lea	Chavez	Hobbs	Santa Fe		
pENV000GW0331	Discharge Plan Permit	316	DCP MIDSTREAM L.P.	DUKE PAIGE CS	A	08/17/1999	01/06/2000	01/06/2005	O-4-21 S-32 E	Lea	Chavez	Hobbs	Santa Fe		
pENV000GW0326	Discharge Plan Permit	311	DCP MIDSTREAM L.P.	RAPTOR COTTON DRAW	A	01/15/1999	01/06/2000	01/06/2005	C-18-25 S-32 E	Lea	Chavez	Hobbs	Santa Fe		
pENV000GW0187	Discharge Plan Permit	176	DCP MIDSTREAM L.P.	DUKE BOOTLEG CS	A	10/27/1994	01/20/1995	01/20/2005	J-18-22 S-33 E	Lea	Chavez	Hobbs	Santa Fe		
pENV000GW0163	Discharge Plan Permit	152	DCP MIDSTREAM L.P.	DUKE WHITE CITY C.S.	C		12/13/1993		-10-24 S-26 E	Eddy	Chavez	Artesia	Santa Fe	Site is shut down-Llano to submit closure	
pENV000GW0228	Discharge Plan Permit	213	DCP MIDSTREAM L.P.	DUKE STRATA CS	A	07/18/1995	08/30/1995	08/30/2000	A-22-23 S-34 E	Lea	Chavez	Hobbs	Santa Fe	closure requested need picture and TPH analysis	
pENV000GW0156	Discharge Plan Permit	145	DCP MIDSTREAM L.P.	DUKE ZIA GAS PLANT & ZIA BOOSTER STATION	A		07/06/1993	07/06/2008	A-19-19 S-32 E	Lea	Chavez	Hobbs	Santa Fe	3 below grade tanks registered	
pENV000GW0303	Discharge Plan Permit	288	DCP MIDSTREAM L.P.	DUKE PARDUE CS	A	10/06/1997	11/24/1997	11/24/2007	J-10-23 S-28 E	Eddy	Chavez	Artesia	Santa Fe	need \$400 fee + sign-off	
pENV000GW0178	Discharge Plan Permit	167	DCP MIDSTREAM L.P.	DUKE P & P Malaga CS	A	05/19/1994	07/25/1994	07/25/2004	G-3-24 S-28 E	Eddy	Chavez	Artesia	Santa Fe	need sign-offs	
pENV000GW0173	Discharge Plan Permit	162	DCP MIDSTREAM L.P.	DUKE ANTELOPE RIDGE GP	A	01/21/1994	04/04/1994	03/23/2004	O-15-23 S-34 E	Lea	Chavez	Hobbs	Santa Fe	rec DP App + \$100 issued PN and Draft DP 1/23/04	
pENV000GW0171	Discharge Plan Permit	160	DCP MIDSTREAM L.P.	DUKE BRIGHTM FED CS	C	11/29/1993	01/14/1994		C-21-19 S-33 E	Lea	Chavez	Hobbs	Santa Fe	DP terminated 1/22/04	
pENV000GW0161	Discharge Plan Permit	150	DCP MIDSTREAM L.P.	DUKE PURE GOLD "28" CS	A		11/22/1993	11/22/2003	D-28-23 S-31 E	Lea	Chavez	Hobbs	Santa Fe	Rec DP application + \$100 issued PN 1/23/04 & Draft DP	
pENV000GW0311	Discharge Plan Permit	296	DCP MIDSTREAM L.P.	DUKE CEDAR CANYON CS	A	03/23/1998	07/15/1998	07/15/2008	P-9-24 S-29 E	Eddy	Chavez	Artesia	Santa Fe		
pENV000GW0252	Discharge Plan Permit	237	DCP MIDSTREAM L.P.	DUKE PECOS DIAMOND GP	A	02/05/1996	03/29/1996	03/29/2011	G-3-18 S-27 E	Eddy	Chavez	Artesia	Santa Fe		1 below grade tank registered

pENV000GW00254	Discharge Plan Permit	239	DCP MIDSTREAM L.P.	Duke QUINN CS	A	03/08/1996	08/09/1996	08/09/2011	L-16-31 N-8 W	San Juan	Chavez	Aztec	Santa Fe	DP w/ filling fee process, renewed, issued with letter mailed out 10/23/2006. Received \$1700 fee 10/26/06. Signed DP received 1-11-07 Ok.	
pENV000GW00088	Discharge Plan Permit	77	DCP MIDSTREAM L.P.	Duke MIDDLE MESA CS	A	04/10/1991	11/14/1991	11/14/2006	M-10-31 N-7 W	San Juan	Chavez	Aztec	Santa Fe		
pENV000GW00002	Discharge Plan Permit	2	DCP MIDSTREAM L.P.	LEE GP	A	11/13/1995	03/16/1981	03/16/2011	N-30-17 S-35 E	Lea	Chavez	Hobbs	Santa Fe		
pENV000GW00009	Discharge Plan Permit	9	DCP MIDSTREAM L.P.	EUNICE CS	C	10/06/1988	10/11/1983		-5-21 S-36 E	Lea	Chavez	Hobbs	Santa Fe	GW-009 vacated and merged into GW-16 OCT 8, 1993	
pENV000GW00016	Discharge Plan Permit	15	DCP MIDSTREAM L.P.	DUKE LINAM RANCH GP	A	05/17/1989	04/25/1984	04/25/2009	-6-19 S-37 E	Lea	Chavez	Hobbs	Santa Fe	1 below grade concrete tank registered	
pENV000GW00017	Discharge Plan Permit	16	DCP MIDSTREAM L.P.	DUKE EUNICE GP	A	04/13/1989	04/25/1984	04/25/2009	H-5-21 S-36 E	Lea	Chavez	Hobbs	Santa Fe	10 below grade tanks + 1 sulphur pit registered	
pENV000GW00024	Discharge Plan Permit	23	DCP MIDSTREAM L.P.	GPM ARTESIA GP	A	01/17/1995	07/01/1985	07/01/2010	-7-18 S-28 E	Eddy	Chavez	Artesia	Santa Fe	call&e-mail 1/07/2000 120 day notice. Late flat fee notice sent 1/11/02. Flat fee received 1/29/02.	1 classifier, 5 sumps, 1 sulphur pit, 2 below grade tanks registered (Flare Pit Soil Remediation & Closure Workplan)
pENV000GW00025	Discharge Plan Permit	24	DCP MIDSTREAM L.P.	DUKE AVALON GP	I	06/15/1990	09/18/1985	09/18/2005	J-9-21 S-27 E	Eddy	Chavez	Artesia	Santa Fe	Notice of late flat fee sent 1/11/2002.	
pENV000GW00044	Discharge Plan Permit	42	DCP MIDSTREAM L.P.	GPM INDIAN HILLS GP	I		07/20/1987		L-13-21 S-25 E	Eddy	Chavez	Artesia	Santa Fe	Letter from Duke, dated 12/10/01, notifying site is inactive.	
pENV000GW00149	Discharge Plan Permit	138	DCP MIDSTREAM L.P.	DUKE TRACHTA CS	C		04/30/1993		-14-23 S-28 E	Eddy	Chavez	Artesia	Santa Fe	Facility is inactive	

pENV000GW00079	Discharge Plan Permit	69	DCP MIDSTREAM L.P.	DUKE CARLSBAD GP	A	12/28/2006	04/29/1992	04/29/2012	G-10-23 S-28 E	Eddy	Chavez	Artesia	Santa Fe	Public Notice prepared 1/15/02. Request for additional information sent 1/2/02. Received \$100 filing fee & renewal on 12/28/06.	4 sumps registered
pENV000GW00189	Discharge Plan Permit	178	DCP MIDSTREAM L.P.	DUKE WON TON CS	C		03/21/1995	03/21/2005	I-10-17 S-37 E	Lea	Chavez	Hobbs	Santa Fe	1 below grade tank registered	
pENV000GW00138	Discharge Plan Permit	127	DCP MIDSTREAM L.P.	DUKE MAGNUM C.S.(BURTON FLATS GP)	A	08/10/1992	02/03/1993	02/03/2008	G-9-20 S-29 E	Eddy	Chavez	Artesia	Santa Fe	1 below grade tank registered as sump	
pENV000GW00139	Discharge Plan Permit	128	DCP MIDSTREAM L.P.	DUKE PAIGE CS	A	08/11/1992	11/19/1992	11/20/2007	O-4-21 S-32 E	Lea	Chavez	Hobbs	Santa Fe	6 mo. Renewal notice sent 7/10/02; renewal application received	
pENV000GW00148	Discharge Plan Permit	137	DCP MIDSTREAM L.P.	DUKE CARRASCO CS	A		04/28/1993	04/28/2008	F-14-23 S-28 E	Eddy	Chavez	Artesia	Santa Fe	1 skid sump registered	
pENV000GW00150	Discharge Plan Permit	139	DCP MIDSTREAM L.P.	DUKE CP-1 CS	C		04/28/1993		I-15-23 S-28 E	Eddy	Chavez	Artesia	Santa Fe	Site inactive, requested closure workplan 1/10/03, WP approved, Closure Approved 10/15/2003	
pENV000GW00153	Discharge Plan Permit	142	DCP MIDSTREAM L.P.	DUKE SAND DUNES CS	A	03/26/1993	05/17/1993	05/17/2008	P-23-23 S-31 E	Eddy	Chavez	Artesia	Santa Fe	1 below grade tank registered	
pENV000GW00155	Discharge Plan Permit	144	DCP MIDSTREAM L.P.	DUKE NORTH (WESTALL) CS	A	05/05/1993	08/19/1993	08/19/2008	E-35-22 S-28 E	Eddy	Chavez	Artesia	Santa Fe	Renewal application dated 4/3/03 - renewal on hold pending legal determination	1 below grade tank registered
pENV000GW00179	Discharge Plan Permit	168	DCP MIDSTREAM L.P.	DUKE SOUTH FEAGAN CS	C	07/06/1994	12/28/1994	12/27/2004	N-31-19 S-25 E	Eddy	Chavez	Artesia	Santa Fe	Late filing fee and flat fee notice sent 1/11/02. Flat fee received 1/29/02.	
pENV000GW00188	Discharge Plan Permit	177	DCP MIDSTREAM L.P.	DUKE MALJAMAR CS	C		03/21/1995	03/21/2005	I-20-17 S-33 E	Lea	Chavez	Hobbs	Santa Fe		
pENV000GW00046	Discharge Plan Permit	44	DCP MIDSTREAM L.P.	HOBBS BOOSTER CS	A		12/23/1987	12/23/2007	-4-19 S-38 E	Lea	Chavez	Hobbs	Santa Fe	renewal notice sent 7/10/02	

pENV000GW0 0270	Discharge Plan Permit	255	DCP MIDSTREAM L.P.	Duke BUENA VISTA CS	A	07/15/1996	09/05/1996	09/05/2011	B-13-30 N-9 W	San Juan	Chavez	Aztec	Santa Fe	DP renewed, issued with letter mailed out 10/23/2006. Received \$1700 on 10/25/2006. Signed DP received on 1/11/2007. Ok.	
pENV000GW0 0273	Discharge Plan Permit	258	DCP MIDSTREAM L.P.	Duke CEDAR HILL CS	A	07/30/1996	09/30/1996	09/30/2011	-29-32 N-10 W	San Juan	Chavez	Aztec	Santa Fe	DP renewed, issued with letter mailed out 10/23/2006. Permit fee of \$1700 received on 10/26/2006. Signed DP received on 1/11/07. Ok.	
pENV000GW0 0292	Discharge Plan Permit	277	DCP MIDSTREAM L.P.	CSI - BIG EDDY LATERAL#1 CS	A		02/17/1997	02/17/2007	A-19-21 S-28 E	Eddy	Chavez	Artesia	Santa Fe	Taken over by Duke Energy. Received DP renewal letter dated 10/19/2006 w/ \$100 filing fee. Mailed out final permit 9/16/06. Awaiting \$1700 Compressor Station fee.	1 below grade tank registered
pENV000GW0 0174	Discharge Plan Permit	163	DCP MIDSTREAM L.P.	DUKE APEX CS	A		04/29/1999	04/29/2004	C-36-18 S-36 E	Lea	Chavez	Hobbs	Santa Fe	request GW info and DP renewal by 12/01/04	
pENV000GW0 0186	Discharge Plan Permit	175	DCP MIDSTREAM L.P.	DUKE HOBBS GP	A		01/09/1995	01/09/2005	G-36-18 S-36 E	Lea	Chavez	Hobbs	Santa Fe	Request DP renewal and GW info BY 12/01/04	
	1RP-401-0		DCP MIDSTREAM L.P.	C-line Release Site (1RP-401-0)					O-31-19 S-37 E	Lea	?	Hobbs	Santa Fe	Meeting w/ company 2/1/07	
	AP-33		DCP MIDSTREAM L.P.	Eldridge Ranch					P-21-19 S-37 E	Lea	?	Hobbs	Santa Fe	Meeting w/ company 2/1/07	
			DCP MIDSTREAM L.P.	J-4-2 Pipeline Release Site					C-27-19 S-35 E		?	Hobbs	Santa Fe	Meeting w/ company 2/1/07	
	1RP-400		DCP MIDSTREAM L.P.	X-line Pipeline Site (1RP-400)					B-7-15 S-34 E		?	Hobbs	Santa Fe	Meeting w/ company 2/1/07	



	AP-55		DCP MIDSTREAM L.P.	RR Ext. (AP- 55)					C-19-20 S-37 E		?	Hobbs	Santa Fe	Meeting w/ company 2/1/07	
	2R-043		DCP MIDSTREAM L.P.	PCA Junction					11-20 S-30 E		?	Hobbs	Santa Fe	Meeting w/ company 2/1/07	
	1R-156		DCP MIDSTREAM L.P.	Monument Booster Station					B-33-19 S-37 E (32.6238 -103.2550)		?	Hobbs	Santa Fe	Meeting w/ company 2/1/07	

**Chavez, Carl J, EMNRD**

---

**From:** Stone, Ben, EMNRD  
**Sent:** Thursday, January 18, 2007 7:43 AM  
**To:** Chavez, Carl J, EMNRD  
**Subject:** FW: Product Recovery and Surveying

CARL, I THINK THESE (Duke) ARE YOURS??.....  
Thanks, Ben

---

**From:** Elizondo, Trisha [mailto:Trisha.Elizondo@arcadis-us.com]  
**Sent:** Wednesday, January 17, 2007 8:13 PM  
**To:** Johnson, Larry, EMNRD; Stone, Ben, EMNRD  
**Cc:** didick@dcpmidstream.com  
**Subject:** Product Recovery and Surveying

Mr. Johnson and Mr. Stone-

This email is to serve as notification that ARCADIS will be conducting monthly product recovery at DCP Midstream's (formerly known as Duke Energy Field Services) Apex Compressor Station and PCA Junction on January 22 and 23, 2007. Routine product recovery is on-going at the site through hand-bailing. Jerry Longwell and Ryan Nanny will be the representatives onsite. While onsite, monitoring wells at the two locations will be also be surveyed to assist in the development of clearer depiction of groundwater flow and the potentiometric surface. Please find below location information for the two sites and topographic maps depicting their locations. If you have any questions please feel free to contact myself (303.434.2686) or Daniel Dick (303.605.1893) of DCP Midstream.

**Apex Compressor Station:** Center E/2, NE/4, NW/4, Section 36, T18S, R36E. Driving directions: Traveling from Hobbs, take 180 W until you come to Maddox Road (approximately 4 miles past the gas plant). Take Maddox Road north for approximately 2500 feet until you come to a rough paved road with a cattle guard and gate at the entrance. Cross the cattle guard and drive 2000 feet until you come to the front gate of the Hobbs Gas Plant. Travel around the perimeter of the gas plant to Apex Compressor Station, located adjacent northwest.

**PCA Junction:** Center W/2, W/2, Section 11, T20S, R30E. Driving directions: Traveling from Hobbs, take 180 W until you come to 360 N. Turn right onto the paved road and travel approximately 2.7 miles until you come to Crazy Horse Road. Turn right. At this point-you will need to be escorted to the site because of the many splits and turns on unlabeled roads. If you would like to witness product recovery events at PCA, please call Jerry Longwell at (432) 425-3763 and he will escort you to the site from Crazy Horse Road.

Thank you,

<<Fig01 Apex Site Location Map.pdf>> <<Fig01 PCA Junction Site Location Map.pdf>>

Trisha Elizondo  
Environmental Scientist  
ARCADIS  
630 Plaza Drive, Suite 200  
Highlands Ranch, Colorado 80129  
Office: (720) 344-3719  
Mobile: (303) 434-2686  
Trisha.Elizondo@arcadis-us.com

DRAFTER: PMW

APPROVED: GN

CHECKED: TE

DRAWING: COSLM-0049

HARD FILE:

PRJCT NO.: CO000889.2801

DWG DATE: 11/17/04

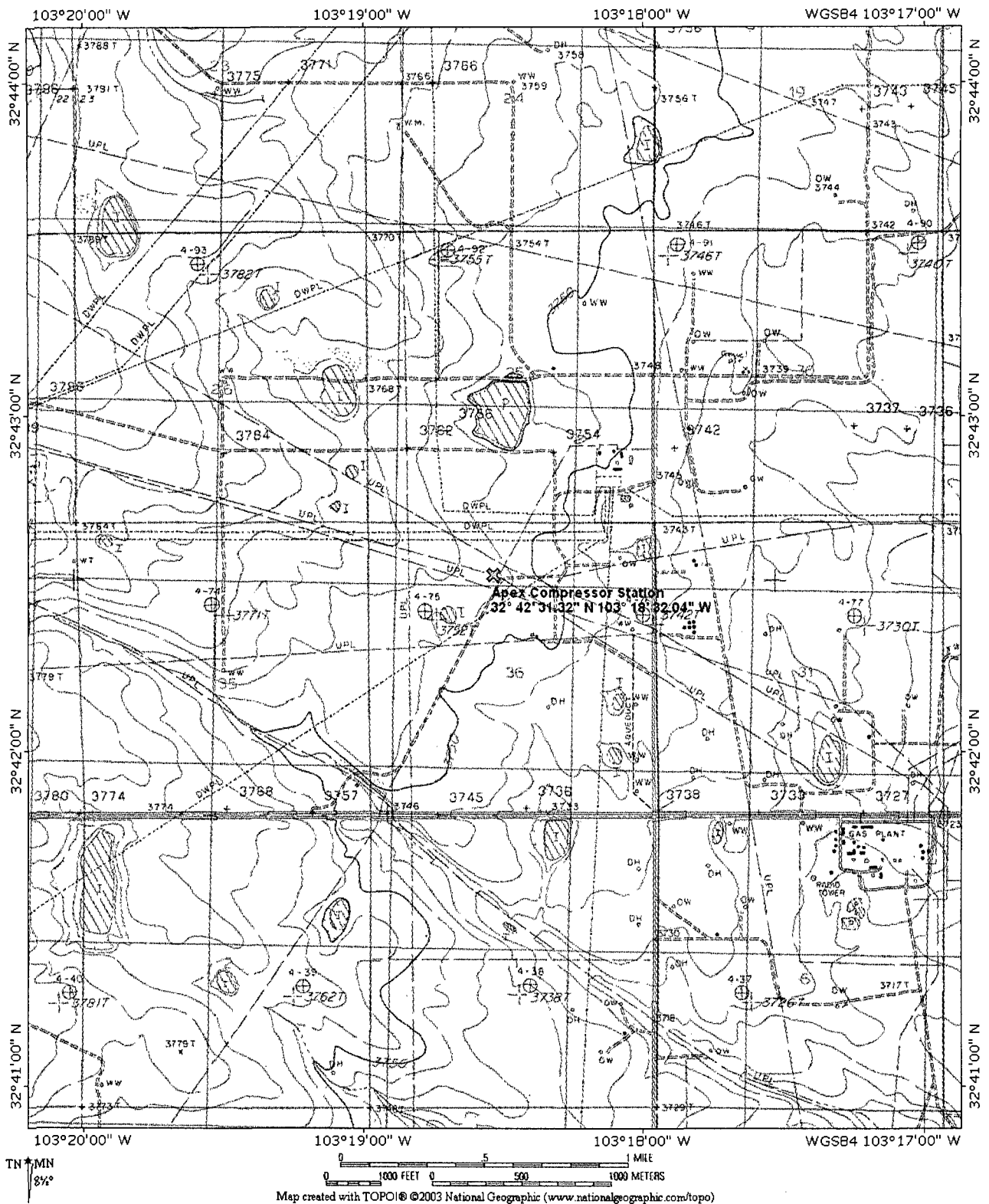

## Site Location Map

APEX COMPRESSOR STATION  
Lea County, New Mexico

FIGURE

1

Chavez, Carl J, EMNRD

To: Chavez, Carl J, EMNRD  
Cc: Rice, Wayne, EMNRD  
Subject: Duke Energy Field Services- Note to File

On January 1, 2007, Wayne Price and Carl Chavez of the Oil Conservation Division (OCD) contacted Ruth Lang of Duke Energy Field Services at (303) 605-1713 and left a phone message regarding the large number of expired facilities (see attachment) where the discharge plan was not renewed within 120 or in advance of their expiration. Wayne Price referred to Ms. Lang's December 2, 2006 e-mail message regarding "Duke Energy Field Services Expired Discharge Plan Facilities."

Mr. Price informed Ms. Lang that all discharge plan renewal applications need to be submitted to the OCD for review by March 1, 2007. In addition, she was informed that the OCD will be issuing an Notice of Violation for neglecting to renew its discharge plan permits with the OCD.

Carl J. Chavez, CHMM  
New Mexico Energy, Minerals & Natural Resources Dept.  
Oil Conservation Division, Environmental Bureau  
1220 South St. Francis Dr., Santa Fe, New Mexico 87505  
Office: (505) 476-3491  
Fax: (505) 476-3462  
E-mail: [CarlJChavez@state.nm.us](mailto:CarlJChavez@state.nm.us)  
Website: <http://www.emnrd.state.nm.us/oed/>  
(Pollution Prevention Guidance is under "Publications")

1/5/2007

Permit ID	Facility	Company	Status	Expired	Contact	phone	e-mail	Comments
150	Pure Gold "28" CS	Duke	A	11/22/03	Lisabeth Klein	303-605-1778	<a href="mailto:eaklein@duke-energy.com">eaklein@duke-energy.com</a>	Request 120 day extension to 4/1/07
162	Antelope Ridge Gas Plant	Duke	A	3/23/04	Lisabeth Klein	303-605-1778	<a href="mailto:eaklein@duke-energy.com">eaklein@duke-energy.com</a>	Request 120 day extension to 4/1/07
167	Malaga CS	Duke	A	7/25/04	Lisabeth Klein	303-605-1778	<a href="mailto:eaklein@duke-energy.com">eaklein@duke-energy.com</a>	Request 120 day extension to 4/1/07
311	Cotton Draw CS	Duke	A	1/6/05	Lisabeth Klein	303-605-1778	<a href="mailto:eaklein@duke-energy.com">eaklein@duke-energy.com</a>	Request 120 day extension to 4/1/07
316	Hat Mesa CS	Duke	A	1/6/05	Lisabeth Klein	303-605-1778	<a href="mailto:eaklein@duke-energy.com">eaklein@duke-energy.com</a>	Request 120 day extension to 4/1/07
176	Boot Leg CS	Duke	A	1/20/05	Lisabeth Klein	303-605-1778	<a href="mailto:eaklein@duke-energy.com">eaklein@duke-energy.com</a>	Request 120 day extension to 4/1/07
227	Lee CS	Duke	I	12/28/05	Lisabeth Klein	303-605-1778	<a href="mailto:eaklein@duke-energy.com">eaklein@duke-energy.com</a>	Submitted correspondence to Ben Stone during meeting in Sept. 2006
168	Feagen Booster Station	Duke	I	12/27/04	Lisabeth Klein	303-605-1778	<a href="mailto:eaklein@duke-energy.com">eaklein@duke-energy.com</a>	Closed 2/1/05
177	Maljamar CS	Duke	A	3/21/05	Lisabeth Klein	303-605-1778	<a href="mailto:eaklein@duke-energy.com">eaklein@duke-energy.com</a>	Request 120 day extension to 4/1/07
178	Wonton CS	Duke	A	3/21/05	Lisabeth Klein	303-605-1778	<a href="mailto:eaklein@duke-energy.com">eaklein@duke-energy.com</a>	Request 120 day extension to 4/1/07
24	Avalon Gas Plant	Duke	A	9/18/05	Lisabeth Klein	303-605-1778	<a href="mailto:eaklein@duke-energy.com">eaklein@duke-energy.com</a>	Request 120 day extension to 4/1/07
163	Apex CS	Duke	A	4/29/04	Lisabeth Klein	303-605-1778	<a href="mailto:eaklein@duke-energy.com">eaklein@duke-energy.com</a>	Request 120 day extension to 4/1/07
175	Hobbs Gas Process Plant	Duke	A	1/9/05	Lisabeth Klein	303-605-1778	<a href="mailto:eaklein@duke-energy.com">eaklein@duke-energy.com</a>	Request 120 day extension to 4/1/07
16	Eunice Gas Plant	Duke	A	4/25/09	Lisabeth Klein	303-605-1778	<a href="mailto:eaklein@duke-energy.com">eaklein@duke-energy.com</a>	Request 120 day extension to 4/1/07
139	CP-1 CS	Duke	A	3/23/04	Lisabeth Klein	303-605-1778	<a href="mailto:eaklein@duke-energy.com">eaklein@duke-energy.com</a>	Closed 10/15/03
42	Indian Hills Gas Plant	Duke	I	4/6/2002	Lisabeth Klein	303-605-1778	<a href="mailto:eaklein@duke-energy.com">eaklein@duke-energy.com</a>	Dismantled

## Chavez, Carl J, EMNRD

---

**From:** Chavez, Carl J, EMNRD  
**Sent:** Wednesday, November 29, 2006 10:31 AM  
**To:** Stone, Ben, EMNRD  
**Subject:** RE: Product Recovery and Groundwater Sampling

Ben:

I see that Duke APEX (GW-163) is mine, but couldn't find PCA Junction. Thnx.

-----Original Message-----

**From:** Stone, Ben, EMNRD  
**Sent:** Wednesday, November 29, 2006 8:24 AM  
**To:** Chavez, Carl J, EMNRD  
**Subject:** FW: Product Recovery and Groundwater Sampling

I think this one is yours Carl.

Thanks,

Ben

-----Original Message-----

**From:** Nanny, Joel [mailto:JNanny@arcadis-us.com]  
**Sent:** Wednesday, November 29, 2006 8:23 AM  
**To:** Stone, Ben, EMNRD  
**Cc:** Tischer, Steve; Longwell, Jerry  
**Subject:** Product Recovery and Groundwater Sampling

This e-mail is to inform you that Jerry Longwell or I will be performing product recovery at APEX and PCA Junction. One of us will travel to Ramsey to gauge and take water samples.

We appreciate your business and please feel free to call Steve Tischer (432-687-5400), Jerry Longwell (432-425-3763), or myself (432-556-7795) if you have any questions about the upcoming event. The event is scheduled to begin Monday, December 11th.

Ryan Nanny  
Geologist/Scientist



# NEW MEXICO ENERGY, MINERALS and NATURAL RESOURCES DEPARTMENT

**BILL RICHARDSON**

Governor

**Joanna Prukop**

Cabinet Secretary

**Mark E. Fesmire, P.E.**

Director

**Oil Conservation Division**

September 30, 2005

**CERTIFIED MAIL**

**RETURN RECEIPT NO. 7001 1940 0004 7923 4788**

Karin Kimura  
Duke Energy Field Service  
370 17<sup>th</sup> Street  
Denver, Colorado 80202

Subject Matter: Compliance Orders

Dear Ms. Kimura:

Please find enclosed Compliance Orders for the following facilities:

NM-OCD 2006-002	Val Verde Plant	GW-051
NM-OCD 2006-003	Arch Rock Compressor St.	GW-183
NM-OCD 2006-004	Sandstone Compressor St.	GW-193
NM-OCD 2006-005	Hobbs Gas Processing Plant	GW-175
NM-OCD 2006-006	Apex Compressor St.	GW-163

Sincerely,

Mark E. Fesmire, P.E.

Director-Oil Conservation Division



# NEW MEXICO ENERGY, MINERALS and NATURAL RESOURCES DEPARTMENT

**BILL RICHARDSON**

Governor

**Joanna Prukop**

Cabinet Secretary

**Mark E. Fesmire, P.E.**

Director

**Oil Conservation Division**

September 16, 2005

**CERTIFIED MAIL**

**RETURN RECEIPT NO. 7001 1940 0004 7923 4764**

Karin Kimura  
Duke Energy Field Service  
P.O. Box 5493  
Denver, Colorado 80202

Subject Matter: Compliance Orders

Dear Ms. Kimura:

Please find enclosed Compliance Orders for the following facilities:

NM-OCD 2006-002	Val Verde Plant	GW-051
NM-OCD 2006-003	Arch Rock Compressor St.	GW-183
NM-OCD 2006-004	Sandstone Compressor St.	GW-193
NM-OCD 2006-005	Hobbs Gas Processing Plant	GW-175
NM-OCD 2006-006	Apex Compressor St.	GW-163

Sincerely,

J. Daniel Sanchez  
Enforcement and Compliance Manager  
Oil Conservation Division





# NEW MEXICO ENERGY, MINERALS and NATURAL RESOURCES DEPARTMENT

**BILL RICHARDSON**

Governor

**Joanna Prukop**

Cabinet Secretary

**Mark E. Fesmire, P.E.**

Director

**Oil Conservation Division**

September 15, 2005

This is a directive to notify that I, Mark Fesmire, will be out of the office from September 16 through 23, 2005.

During my absence, Daniel Sanchez is hereby given authority to sign all OCD documents requiring my signature.

A handwritten signature in black ink, appearing to read "Mark E. Fesmire", followed by a long horizontal flourish.

Mark E. Fesmire, PE  
Director

*changed RBDPS  
11-9-04*

October 20, 2004

UPS Next Day Air (Tracking No. 1Z F46 915 22 1003 178 4)

Mr. Roger Anderson, Chief, Environmental Bureau  
New Mexico Energy, Minerals  
& Natural Resources Department  
Oil Conservation Division  
1220 South St. Francis Drive  
Santa Fe, NM 87505

SUBJECT: Notification of Change of Ownership

Dear Mr. Anderson:

Duke Energy Field Services, LP (DEFS) is submitting notification of a change of ownership for facilities in Eddy and Lea Counties, New Mexico. Effective April 30, 2004, DEFS is the new owner of the facilities identified in the attached list. The attachment lists the facility name, county, legal location, operating status, and, if applicable, discharge permit number.

DEFS will comply with the terms and conditions of the previously approved discharge permits issued to ConocoPhillips or its predecessors. However, by agreeing to comply with those permits, DEFS does not waive its objection to the applicability of the Water Quality Control Commission regulations for facilities that do not have and do not intend to have any discharges that may move directly or indirectly into groundwater, nor does it waive its position that the Oil and Gas Act regulations, not the WQCC regulations, apply to gathering system facilities.

If you have any questions regarding this transfer of ownership and/or the discharge permits, please call me at (303) 605-1717.

Sincerely,  
Duke Energy Field Services, LP

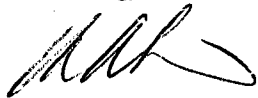

Karin Kimura  
Senior Environmental Specialist

Attachment

Duke Energy Field Services, LP  
Notification of Change in Ownership  
Southeast New Mexico  
Effective April 30, 2004

OPERATING STATUS	FACILITY NAME	COUNTY	LEGAL DESCRIPTION	DISCHARGE PERMIT NO.
✓ Active	Antelope Ridge Gas Plant	Lea	SE 15, T23S, R34E	GW-162 (expired)
✓ Active	Apex CS	Lea	NENW 36, T18S, R36E	GW-163 (expired)
✓ Active	Bootleg CS	Lea	SWSE 18, T22S, R33E	GW-176
✓ Active	Cabin Lake CS	Eddy	SESE 34, T21S, R30E	None
✓ Active	Cal-Mon CS (aka Llano-Cal-Mon CS)	Eddy	SENE 35, T23S, R31E	GW-143
✓ Active	Cal-Mon VRU (aka CVRU)	Lea	NESE 16, T24S, R32E	None
✓ Active	Carlsbad (aka CB, South CB) Master	Eddy	SWSE 31, T22S, R27E	None
✓ Active	Catchlaw Pig	Lea	Center NW 30, T18S, R36E	None
✓ Active	Cedar Canyon CS (aka Buckstate CS)	Eddy	SESE 9, T24S, R29E	GW-296
✓ Active	Cotton Draw CS	Lea	NENW & NWE 18, T25S, R32E	GW-311
✓ Active	Cotton Draw Drip (dismantled)	Lea	NWNW25, T23S, R32E	None
✓ Active	Craft Drip (former Dehy)	Eddy	NWNW 19, T24S, R29E	None
✓ Active	Cunningham First Cut	Lea	NWSW 27, T18S, R36E	None
✓ Active	Exxon DA CS (AKA - "DA CS")	Lea	SESW 31, T21S, R35E	None
✓ Active	Gas Co. North Meter	Lea	S 27, T18S, R36E	None
✓ Active	Grama Ridge #1	Lea	SWNW3, T22S, R34E	None
✓ Active	Grama Ridge Launcher	Lea	NESE 29, T21S, R34E	None
✓ Will be reactivated as Paige CS	Hat Mesa (aka #2) CS	Lea	SWNE 11, T21S, R32E	GW-316
✓ Active	Hobbs Gas Plant	Lea	SWNE 36, T18S, R36E	GW-175

OPERATING STATUS	FACILITY NAME	COUNTY	LEGAL DESCRIPTION	DISCHARGE PERMIT NO.
✓ Active	IMC Pig Receiver (former drip)	Eddy	SWSW 1, T22S, R29E	None
✓ Inactive	Lee CS (inactive) (aka Gillespie/Feagan CS)	Lea	NENE 24, T17S, R35E	GW-227
✓ Active	Livingston Ridge CS	Eddy	SWNE 24, T22S, R31E	None
✓ Active	Maddox First Cut (aka CS or Scrubber)	Lea	SWSE 25, T18S, R36E	None
✓ Active	NEC (aka Northeast Carlsbad) CS	Eddy	Lot 9, Sec 6, T21S, R28E	GW-280
✓ Active	P&P Malaga (aka Titan/Malaga, Low Pressure Gathering Compressor Station) CS	Eddy	SWNE 3, T24S, R28E	GW-167 (expired)
✓ Active	Pardue CS (aka Oxy/Oryx Pardue CS)	Eddy	SENE 10, T23S, R28E	GW-288
✓ Active	PCA Dehy	Eddy	NWSE 27, T25S, R29E	None
✓ Active	PCA Junction (former Drip, pigs active)	Eddy	NWSE 11, T20S, R30E	None
✓ Active	Pure Gold 28 CS	Eddy	NWNW 28, T23S, R31E	GW-150
✓ Active	Turkey Track CS	Eddy	NWSW 27, T18S, R31E	None
✓ Active	West Turkey Track CS	Eddy	SW 6, T19S, R30E	None
✓ Active	Zia Booster (aka CS)	Lea	SESE 18, T19S, R32E	GW-145
✓ Active	Zia Gas Plant	Lea	NENE 19, T19S, R32E	GW-145
✓ Dismantled	Navaho Dehy (dismantled)	Eddy	NWSE 20, T17S, R27E	None
✓ Inactive	Barnaval Draw CS	Eddy	SWNW3, T17S, R29E	None
✓ Inactive	Concarb East Dehy (dismantled)	Lea	SWNE 4, T21S, R36E	None

OPERATING STATUS	FACILITY NAME	COUNTY	LEGAL DESCRIPTION	DISCHARGE PERMIT NO.
✓ Inactive	Concarb West Drip	Lea	SENW 13, T21S, R34E	None
✓ Inactive	Delhi Connect (aka Delhi Drip, dismantled)	Lea	NESW 28, T19S, R36E	None
✓ Inactive	Fasken Dehy	Lea	NWSE 25, T19S, R33E	None
✓ Inactive	Gas Co. South Meter	Lea	SW 34, T18S, R36E	None
✓ Inactive	Hobbs Office	Lea	NENE 33, T18S, R38E	None
✓ Inactive	Kerr Mac Station (former JT Plant)	Eddy	NWSW 4, T21S, R31E	None
✓ Inactive	Rattlesnake CS	Lea	SE 33, T26S, R33E	None
✓ Inactive	Rattlesnake Flats Delivery (inactive)	Lea	NENE 8, T26S, R34E	None
✓ Inactive	Read & Stevens (aka R&S/Norlea) CS	Lea	SWSW 10, T20S, R34E	None
✓ Inactive	Red Lake CS (dismantled)	Eddy	NESW 10, T17S, R28E	None
✓ Inactive	White City (former Dehy)	Eddy	NESE 10, T24S, R26E	None
✓ Closed	Yates Bright (aka Bright/Federal) CS	Lea	NENW 21, T19S, R33E	None
✓ Inactive	Bass Turkey Track (Dehy)	Eddy	SENE 2, T19S, R28E	None
✓ Inactive	Enron 6 " (aka HNG 6", one idle AST)	Eddy	NESE 22, T24S, R27E	None
✓ Inactive	FNM (aka P&M) Delivery	Lea	SESE 10, T19S, R36E	None
✓ Inactive	Getty (aka Texaco) 2 State Dehy	Lea	SWNW 3, T22S, R34E	None
✓ Inactive	Getty 36 (aka 36) Dehy	Lea	SENW 36, T21S, R34E	None

OPERATING STATUS	FACILITY NAME	COUNTY	LEGAL DESCRIPTION	DISCHARGE PERMIT NO.
✓ Inactive	Inexco Nauman (aka Nauman) Dehy	Eddy	NESE 12, T21S, R26E	None
✓ Inactive	Lovelace Dehy	Eddy	SWSW 27, T22S, R27E	None
✓ Inactive	Neeley (aka Sante Fe Neely) Dehy	Eddy	NENE28, T22S, R27E	None
✓ Inactive	NEL (Northeast Loving)	Eddy	NESE9, T23S, R28E	None
✓ Inactive	NGPL Dehy	Eddy	SESW31, T22S, R27E	None
✓ Inactive	North Maduro Dehy	Lea	SENE 20, T19S, R33E	None
✓ Inactive	Queen Lake (aka QL 36) Dehy	Eddy	NESE 36, T24S, R28E	None
✓ Inactive	Read & Stevens TT	Eddy	NESE 25, T18S, R28E	None
✓ Closed	Strata CS (1 idle separator)	Lea	NA	None
✓ Inactive	Swearingen	Eddy	NWSE4, T23S, R28E	None
✓ Inactive	Topaz Dehy	Lea	SWNW 30, T20S, R34E	None
✓ Inactive	TW Atoka Scrubber (one idle scrubber)	Eddy	SESE 3, T18S, R27E	None
✓ Inactive	TWS Carlsbad Dehy (dismantled)	Eddy	SWNE18, T23S, R27E	None
✓ Inactive	Weems (aka Sante Fe Weems) Dehy	Eddy	NWNW 27, T22S, R27E	None

## Price, Wayne

---

**From:** Price, Wayne  
**Sent:** Wednesday, October 20, 2004 11:35 AM  
**To:** Sharon Hall (E-mail)  
**Cc:** Williams, Chris  
**Subject:** Duke conference call Oct 20, 2004

Thank you for the up-date please CC other parties.

Hobbs Gas Plant is currently permitted GW-175 and will expire Jan 09, 2005. You have missed the 120 day pre-submittal. Therefore permit will expire on that date.

Apex Compressor St is currently permitted GW-163, permit expired 4/29/2004.

CPA Junction permit # 2R0043. active remediation.

Pursuant to our telephone conference Duke shall submit the following information by December 01, 2004.

1. Transfer of Discharge Plan: The OCD will be notified prior to any transfer of ownership, control, or possession of a facility with an approved discharge plan. A written commitment to comply with the terms and conditions of the previously approved discharge plan must be submitted by the purchaser and approved by the OCD prior to transfer. (for GW-163 and GW-175)
2. All up-dated information pertaining to groundwater contamination with conclusions and recommendations for the three sites.
3. Submit a discharge plan renewal application with a \$100 filing fee for each site, GW-163 and GW-175. Guidelines and Application attached. Please include the GW number on the application. I also included our new public notice regs with flowchart.



ofsguid.doc



dp\_apps.rtf



Public Notice  
Reg's..doc



PN Flow Chart.doc

Good luck and look forward to working with everybody.

Sincerely:

Wayne Price  
New Mexico Oil Conservation Division  
1220 S. Saint Francis Drive  
Santa Fe, NM 87505  
505-476-3487  
fax: 505-476-3462  
E-mail: WPRICE@state.nm.us

**AFFIDAVIT OF PUBLICATION**

State of New Mexico,  
County of Lea.

I, KATHI BEARDEN

Publisher

of the Hobbs News-Sun, a  
newspaper published at  
Hobbs, New Mexico, do solemnly  
swear that the clipping attached  
hereto was published once a  
week in the regular and entire  
issue of said paper, and not a  
supplement thereof for a period.

of 1  
\_\_\_\_\_ weeks.

Beginning with the issue dated

August 18 2002

and ending with the issue dated

August 18 2002

Kathi Bearden  
Publisher

Sworn and subscribed to before

me this 19th day of

August 2002

Godi Benson  
Notary Public.

My Commission expires  
October 18, 2004  
(Seal)

This newspaper is duly qualified  
to publish legal notices or adver-  
tisements within the meaning of  
Section 3, Chapter 167, Laws of  
1937, and payment of fees for  
said publication has been made.

**LEGAL NOTICE  
August 18, 2002  
NOTICE OF PUBLICATION**

**STATE OF NEW MEXICO  
ENERGY, MINERALS AND NATURAL RESOURCES  
DEPARTMENT  
OIL CONSERVATION DIVISION**

Notice is hereby given that pursuant to New Mexico Water  
Quality Control Commission Regulations, the following dis-  
charge plan applications has been submitted to the Direc-  
tor of the Oil Conservation Division, 1220 S. Saint Francis  
Drive, Santa Fe, New Mexico 87505, Telephone (505)  
476-3440:

(GW-163) - Conoco Inc., Neal Goates (281-293-3822)  
Project Manager, 600 N. Dairy Ashford P.O. Box  
3030 Houston, Texas 77079-6651, has submitted a  
discharge plan modification application for their  
Apex Compressor Station located in the SE/4 NE/4  
Section 36, Township 18 South, Range 36 East,  
NMPM, Lea County, New Mexico. The modification  
would allow the use of calcium nitrate amendment  
technology to remediate hydrocarbon contaminated  
groundwater and for the installation of groundwater  
injection and monitoring wells. Groundwater is at a  
depth of approximately 40 feet with a total dissolved  
solids concentration of approximately 300 mg/l.

Any interested person may obtain further information from  
the Oil Conservation Division and may submit written com-  
ments to the Director of the Oil Conservation Division at  
the address given above. The discharge plan application  
may be viewed at the above address between 8:00 a.m.  
and 4:00 p.m., Monday through Friday. Prior to ruling on  
any proposed discharge plan or its modification, the Direc-  
tor of the Oil Conservation Division shall allow at least thir-  
ty (30) days after the date of publication of this notice dur-  
ing which comments may be submitted to him and a public  
hearing may be requested by any interested person. Re-  
quests for a public hearing shall set forth the reasons why  
a hearing should be held. A hearing will be held if the Di-  
rector determines there is significant public interest.

If no public hearing is held, the Director will approve or dis-  
approve the proposed plan based on information available.  
If a public hearing is held, the director will approve or dis-  
approve the proposed plan based on information in the  
plan and information submitted at the hearing.

GIVEN under the Seal of New Mexico Oil Conservation  
Commission at Santa Fe, New Mexico, on this 14th day of  
August 2002.

STATE OF NEW MEXICO  
OIL CONSERVATION DIVISION

(seal)  
LORI WROTENBERY, Director  
#19170

01100060000      02558254  
State of New Mexico Oil &  
1220 S. St. Francis  
Santa Fe, NM 87505



# Advertising Receipt

**Hobbs Daily News-Sun**

201 N Thorp  
P O Box 850  
Hobbs, NM 88241-0850  
Phone: (505) 393-2123  
Fax: (505) 397-0610

Ed Martin  
State of New Mexico Oil &  
Conservation Division \*  
1220 S. St. Francis  
Santa Fe, NM 87505

**Cust#:** 01100060-000  
**Ad#:** 02558254  
**Phone:** (505)476-3440  
**Date:** 08/15/02

**Ad taker:** Meg      **Salesperson:** 08      **Classification:** 672

Description	Start	Stop	Ins.	Cost/Day	Surcharges	Total
07 07 Daily News-Sun	08/18/02	08/18/02	1	53.68		53.68
Affidavit for legals						2.00

**Payment Reference:**

LEGAL NOTICE  
August 18, 2002  
NOTICE OF PUBLICATION

STATE OF NEW MEXICO  
ENERGY, MINERALS AND NATURAL RESOURCES DEPARTMENT  
OIL CONSERVATION DIVISION

**Total:** 55.68  
**Tax:** 0.00  
**Net:** 55.68  
**Prepaid:** 0.00

**Total Due** 55.68

Notice is hereby given that pursuant to New Mexico Water Quality Control Commission Regulations, the following discharge plan applications has been submitted to the Director of the Oil Conservation Division, 1220 S. Saint Francis Drive, Santa Fe, New Mexico 87505, Telephone (505) 476-3440:

(GW-163) - Conoco Inc., Neal Goates (281-293-3822) Project Manager, 600 N. Dairy Ashford P.O. Box 3030 Houston, Texas 77079-6651, has submitted a discharge plan modification application for their Apex Compressor Station located in the SE/4

*ok Waint*

THE SANTA FE  
**NEW MEXICAN**  
Founded 1849

NM OIL CONSERVATION DIVISION

1220 S. ST. FRANCIS

SANTA FE, NM 87505

ATTN WAYNE PRICE

AD NUMBER: 276464

ACCOUNT: 56689

LEGAL NO: 72006

P.O.#: 02199000249

179 LINES 1 time(s) at \$ 78.91

AFFIDAVITS: 5.25

TAX: 5.26

TOTAL: 89.42

**NOTICE OF  
PUBLICATION**

**STATE OF NEW MEXICO  
ENERGY, MINERALS  
AND NATURAL  
RESOURCES  
DEPARTMENT OIL  
CONSERVATION  
DIVISION**

Notice is hereby given that pursuant to New Mexico Water Quality Control Commission Regulations, the following discharge plan applications has been submitted to the Director of the Oil Conservation Division, 1220 S. Saint Francis Drive, Santa Fe, New Mexico 87505, Telephone (505) 476-3440:

(GW-163) - Conoco Inc., Neal Goates (281-293-3822) Project Manager, 600 N. Dairy Ashford P.O. Box 3030 Houston, Texas 77079-6651, has submitted a discharge plan modification application for their Apex Compressor Station located in the SE/4 NE/4 Section 36, Township 18 South, Range 36 East, NMPM, Lea County, New Mexico. The modification would allow the use of calcium nitrate amendment technology to remediate hydrocarbon contaminated groundwater and for the installation of groundwater injection and monitoring wells. Groundwater is at a depth of approximately 40 feet with a total dissolved solids concentration of approximately 300 mg/l.

Any interested person may obtain further information from the Oil Conservation Division and may submit written com-

ments to the Director of the Oil Conservation Division at the address given above. The discharge plan application may be viewed at the above address between 8:00 a.m. and 4:00 p.m., Monday through Friday. Prior to ruling on any proposed discharge plan or its modification, the Director of the Oil Conservation Division shall allow at least thirty (30) days after the date of publication of this notice during which comments may be submitted to him and a public hearing may be requested by any interested person. Requests for a public hearing shall set forth

the reasons why a hearing should be held. A hearing will be held if the Director determines there is significant public interest.

If no public hearing is held, the Director will approve or disapprove the proposed plan based on information available. If a public hearing is held, the director will approve or disapprove the proposed plan based on information in the plan and information submitted at the hearing.

GIVEN under the Seal of New Mexico Oil Conservation Commission at Santa Fe, New Mexico, on this 14th day of August 2002.

STATE OF NEW MEXICO  
OIL CONSERVATION DIVISION

SEAL  
LORI WROTENBERY, Director  
Legal #72006  
Pub. Aug. 19, 2002

**AFFIDAVIT OF PUBLICATION**

STATE OF NEW MEXICO

COUNTY OF SANTA FE

I, K. Voorhees being first duly sworn declare and say that I am Legal Advertising Representative of THE SANTA FE NEW MEXICAN, a daily newspaper published in the English language, and having a general circulation in the Counties of Santa Fe and Los Alamos, State of New Mexico and being a Newspaper duly qualified to publish legal notices and advertisements under the provisions of Chapter 167 on Session Laws of 1937; that the publication #72006 a copy of which is hereto attached was published in said newspaper 1 day(s) between 08/19/2002 and 08/19/2002 and that the notice was published in the newspaper proper and not in any supplement; the first publication being on the 19 day of August, 2002 and that the undersigned has personal knowledge of the matter and things set forth in this affidavit.

/s/ K. Voorhees

LEGAL ADVERTISEMENT REPRESENTATIVE

Subscribed and sworn to before me on this 19 day of August A.D., 2002

Notary

Laura E. Harding

Commission Expires

11/23/03

*Approved*  
*WP*  
*8/13/02*

## NOTICE OF PUBLICATION

### STATE OF NEW MEXICO ENERGY, MINERALS AND NATURAL RESOURCES DEPARTMENT OIL CONSERVATION DIVISION

Notice is hereby given that pursuant to New Mexico Water Quality Control Commission Regulations, the following discharge plan applications has been submitted to the Director of the Oil Conservation Division, 1220 S. Saint Francis Drive, Santa Fe, New Mexico 87505, Telephone (505) 476-3440:

**(GW-163) – Conoco Inc., Neal Goates (281-293-3822) Project Manager, 600 N. Dairy Ashford P.O. Box 3030 Houston, Texas 77079-6651, has submitted a discharge plan modification application for their Apex Compressor Station located in the SE/4 NE/4 Section 36, Township 18 South, Range 36 East, NMPM, Lea County, New Mexico. The modification would allow the use of calcium nitrate amendment technology to remediate hydrocarbon contaminated groundwater and for the installation of groundwater injection and monitoring wells. Groundwater is at a depth of approximately 40 feet with a total dissolved solids concentration of approximately 300 mg/l.**

Any interested person may obtain further information from the Oil Conservation Division and may submit written comments to the Director of the Oil Conservation Division at the address given above. The discharge plan application may be viewed at the above address between 8:00 a.m. and 4:00 p.m., Monday through Friday. Prior to ruling on any proposed discharge plan or its modification, the Director of the Oil Conservation Division shall allow at least thirty (30) days after the date of publication of this notice during which comments may be submitted to him and a public hearing may be requested by any interested person. Requests for a public hearing shall set forth the reasons why a hearing should be held. A hearing will be held if the Director determines there is significant public interest.

If no public hearing is held, the Director will approve or disapprove the proposed plan based on information available. If a public hearing is held, the director will approve or disapprove the proposed plan based on information in the plan and information submitted at the hearing.

GIVEN under the Seal of New Mexico Oil Conservation Commission at Santa Fe, New Mexico, on this 14<sup>th</sup> day of August 2002.

STATE OF NEW MEXICO  
OIL CONSERVATION DIVISION

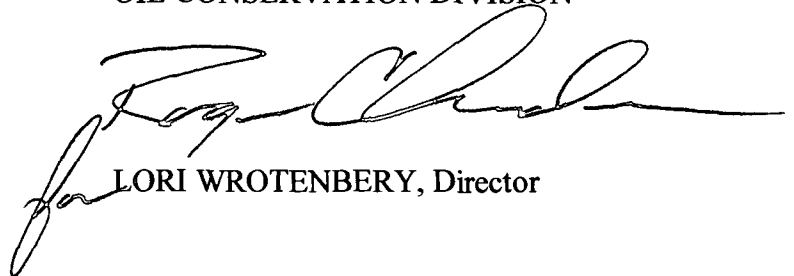

LORI WROTENBERY, Director

SEAL

ACKNOWLEDGEMENT OF RECEIPT  
OF CHECK/CASH

I hereby acknowledge receipt of check No.                      dated 7-24-02,  
or cash received on 8-13-02 in the amount of \$ 950.00  
from Conoco Inc.

for GW-163 Apex Compressor Station

Submitted by: Martyn Kicling Date: 8-13-02

Submitted to ASD by: Marty Kicling Date: 8-13-02

Received in ASD by:                      Date:                     

Filing Fee            New Facility            Renewal           

Modification ✓ Other                     

Organization Code 521.07 Applicable FY 2002

To be deposited in the Water Quality Management Fund.

Full Payment ✓ or Annual Increment           



Conoco Inc  
Ponca City, OK 74602

No.                      02-20/311

07/24/2002

\*\*\* VOIDED AFTER 90 DAYS \*\*\*

TO: CITIBANK DELAWARE  
New Castle DE

Pay exactly: \*\*\*\*\* \$950.00 \*\*\*\*\*

Pay Vendor No. 10030420  
To the NW WATER QUALITY MANAGEMENT FUND  
Order 1220 SO ST FRANCIS DR  
Of SANTA FE NM 87505

A. L. Conlin

Authorized Signature



July 22, 2002

Mr. Wayne Price  
NM Oil Conservation Division  
1220 South St. Francis Dr.  
Santa Fe, NM 87505

RECEIVED  
JUL 26 2002  
Environmental Bureau  
Oil Conservation Division

RE: DISCHARGE PLAN GW-163  
APEX COMPRESSOR STATION  
LEA COUNTY, NEW MEXICO

Dear Mr. Price:

The purpose of this letter is to request a modification to the groundwater discharge plan GW-163 for the Apex Compressor Station located in the SE/4 NE/4 Section 36, Township 18 South, Range 36 East, NMPM, Lea County, New Mexico. The modification would allow the use of calcium nitrate amendment technology to remediate existing concentrations of BTEX in groundwater at the site. Nitrate reacts with the BTEX resulting in the destruction of both reactants and the production of non toxic byproducts (Carbon Dioxide, Water, and Nitrogen Gas)

We plan to install eight two-inch injection wells in the highest concentrations of the plume (see Figure 1). Injection of 4 to 10 gallons of calcium nitrate solution in each well, depending on location within the plume, should attain the goal of bringing groundwater concentrations of BTEX below regulatory limits. Existing monitor wells will be used to monitor progress of the remediation and target areas of the plume for repeat applications if necessary.

In order to address concerns that excess nitrate (nitrate that is not consumed in reactions with organic constituents) may pose a hazard to future groundwater users, we propose to install four two-inch wells at the downgradient edge of the plume (see Figure 1) and inject them with Regenix Hydrogen Release Compound® (HRC). HRC is a sticky gel that will bleed off lactic acid (food-grade carbon source) over time, forming a reactive barrier to excess nitrate, effectively isolating the treatment area from other groundwater and limiting further downgradient migration of nitrate.

Enclosed please find a check for \$950.00 to cover the \$100.00 filing fee and the \$850.00 modification fee. We appreciate your time and effort in addressing this matter. If you

have additional questions or concerns please contact me at (281) 293-3822 or Dan Erskine at (505) 237-8440.

Sincerely,

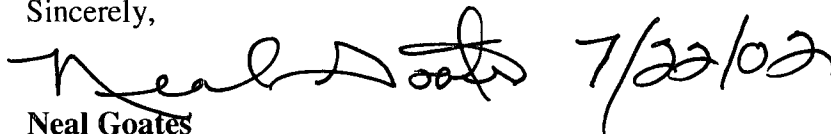
Handwritten signature of Neal Goates and the date 7/22/02.

**Neal Goates**  
Remediation Project Manager  
Mid-Continent BU, EP Americas, NG&GP

CC: Mark Bishop, Conoco CG&P, Hobbs, NM  
OCD/Hobbs, NM

ATTACHMENT



Figure1. Proposed Treatment Wells

**MAXIM**  
TECHNOLOGIES INC®

CONOCO Apex Compressor Station,  
West of Hobbs, New Mexico

Project No. 2007219

Drawing By: DWE Date: 03/02/01

File Name: Proposed Wells.dsf

Checked By: DWE Date: 03/02/01





SPECIAL HANDLING

Check No. 5306542

Control Number

391288

The enclosed check is in settlement of invoices detailed below:

Vendor Name: NW WATER QUALITY MANAGEMENT FUND

Vendor Number: 10030420

RECEIVED  
JUL 26 2002  
Environmental Bureau  
Oil Conservation Division

Your Invoice No.	Our Document No.	Date	Gross Amt.	Discount Amt.	Net Amt.
RQC156484	1900328495	07/22/2002	950.00	0.00	950.00
ADJ Text: KATHRYN HARAHA - PO 3029 - HOUSTON, TX					
Total All Invoices:					950.00

IN CASE OF QUESTIONS ABOUT THIS CHECK, PLEASE CALL: 281-293-3388

**ADJ Codes:** Q=Wrong Quantity P=Wrong Price C=Wrong Calculation M=Multiple Errors F=Corrected Freight Charges  
D=Corrected Discount T=Tax Removal B=Backup Withholding of 31% Per IRS regulations \*=Tax in Net



P.O. Box 2197  
Houston, TX 77252-2197  
(281) 293-3822  
Fax (281) 293-3305  
Cell Phone: 832-465-4123

-----Original Message-----

From: Price, Wayne [mailto:WPrice@state.nm.us]  
Sent: Thursday, June 27, 2002 12:02 PM  
To: Goates, R. Neal  
Cc: 'cyancey@maximusa.com'  
Subject: Conoco Apex Compressor St. GW-163

OCD is in receipt of the proposed Phase II Groundwater Investigation Dated May 1, 2002 for the above subject facility. In order for OCD to process this request Conoco shall submit a request to modify the current discharge plan. OCD has determined this will be a major modification since it involves injection into the groundwater. Please send a \$100.00 filing fee upon submittal.

Sincerely:

<<...OLE\_Obj...>>

Wayne Price  
New Mexico Oil Conservation Division  
1220 S. Saint Francis Drive  
Santa Fe, NM 87505  
505-476-3487  
fax: 505-476-3462  
E-mail: WPRICE@state.nm.us

## Price, Wayne

---

**From:** Goates, R. Neal [R-Neal.Goates@conoco.com]  
**Sent:** Thursday, June 27, 2002 2:05 PM  
**To:** Price, Wayne  
**Cc:** Daniel W. Erskine, Ph.D.; Clyde L. Yancey  
**Subject:** RE: Conoco Apex Compressor St. GW-163

Wayne that sounds good. We will try to get you something soon.

Neal Goates  
Remediation Project Manager  
Mid-Continent BU, EP Americas, NG&GP

Conoco Inc.  
600 N. Dairy Ashford  
P.O. Box 2197  
Houston, TX 77252-2197  
(281) 293-3822  
Fax (281)293-3305  
Cell Phone: 832-465-4123

-----Original Message-----

**From:** Price, Wayne [mailto:WPrice@state.nm.us]  
**Sent:** Thursday, June 27, 2002 2:22 PM  
**To:** Goates, R. Neal  
**Subject:** RE: Conoco Apex Compressor St. GW-163

Yes, a statement will be OK along with the \$100 filing fee. There will be a modification fee of 1/2 of the discharge plan fee of \$1700 which would be \$850. Your total fee cost will be \$100 filing fee + the medication fee of \$850 = \$950.00. See WQCC 20.6.2.3113 (Fees). Once we receive your notice then OCD will issue public notice, wait 30 days for comments, and then approve plan, unless their is request for a hearing.

-----Original Message-----

**From:** Goates, R. Neal [mailto:R-Neal.Goates@conoco.com]  
**Sent:** Thursday, June 27, 2002 12:03 PM  
**To:** Price, Wayne  
**Cc:** Clyde L. Yancey; Daniel W. Erskine, Ph.D.; Goates, R. Neal  
**Subject:** RE: Conoco Apex Compressor St. GW-163  
**Importance:** High

Thanks Wayne,  
Will there be other fees for the project outside the annual monitor well fees as discussed last week? Just for clarity will a statement as an addendum to the existing discharge plan explaining the process be adequate for the modification? I apologize for the questions I've done so much since our discussion. Dan if the answer is no to other fees and yes to the addendum please complete the meet the intent of the program. If additional fees etc apply I'm still waiting on personnel to return to work in order to consider the project still a go.

Neal Goates  
Remediation Project Manager  
Mid-Continent BU, EP Americas, NG&GP

Conoco Inc.  
600 N. Dairy Ashford

**Price, Wayne**

**From:** Price, Wayne  
**Sent:** Tuesday, February 05, 2002 12:08 PM  
**To:** 'Bishop, Mark A.'  
**Subject:** RE: Non-exempt waste disposal for Conoco CG&P

OCD hereby approves of your request and will place a copy of this approval in each Discharge Plan.

-----Original Message-----

**From:** Bishop, Mark A. [mailto:Mark.A.Bishop@conoco.com]  
**Sent:** Tuesday, February 05, 2002 11:24 AM  
**To:** WPrice@state.nm.us  
**Subject:** Non-exempt waste disposal for Conoco CG&P facilities

Mr. Price,

A reevaluation of preferred non-exempt waste handling facilities has been completed for southeast New Mexico and a team of Conoco personnel has chosen Sundance waste handling facility at Eunice, NM to be our primary non-exempt waste handling facility. Controlled recovery Inc. will be the secondary facility. We would like to amend the following OCD Groundwater discharge permits to include the Sundance facility for disposal of non-exempt fluids. Thank you for your consideration of our request

Maljamar Gas Plant	GW-020
Maljamar Area Blanket OCD permit	
Antelope Ridge Gas Plant	GW-162
Hobbs Gas Plant	GW-175
Apex compressor Station	GW-163
Bootleg Compressor Station	GW-176
Bright /Yates Compressor Station	GW-160
Cedar Canyon Compressor Station	GW-296
Cal-Mon Compressor Station	GW-143
NE Carlsbad Compressor Station	GW-280
Cotton Draw Compressor Station	GW-311
Hat Mesa Compressor Station	GW-316
Lee Compressor Station	GW-227
Pardue Compressor Station	GW-288
Pure Gold Compressor Station	GW-150
Malaga Compressor Station	GW-167

Mark Bishop  
 Environmental Specialist  
 Conoco Inc. CG&P  
 SE New Mexico Operating Unit  
 505-391-1956

2/6/2002

## Price, Wayne

---

**From:** Price, Wayne  
**Sent:** Thursday, August 30, 2001 4:18 PM  
**To:** 'mark.a.bishop@usa.conoco.com'  
**Cc:** Williams, Chris  
**Subject:** Conoco inspection frequency for GW-143,150,162,163,167,175,227, and 316

Dear Mr. Bishop:

The OCD is in receipt of Conoco's letters dated 04/06/2001 requesting a change in inspection frequency for the above captioned facilities.  
Your request is hereby approved.

Please be advised that NMOCD approval of this request does not relieve Conoco Inc. of responsibility should their closure activities pose a threat to ground water, surface water, human health or the environment. In addition, NMOCD approval does not relieve Conoco Inc. of responsibility for compliance with any other federal, state, or local laws and/or regulations.

**Tracking:**

**Recipient**  
'mark.a.bishop@usa.conoco.com'  
Williams, Chris

**Delivery**

Delivered: 8/30/01 4:18 PM



# NEW MEXICO ENERGY, MINERALS and NATURAL RESOURCES DEPARTMENT

GARY E. JOHNSON

Governor

Jennifer A. Salisbury  
Cabinet Secretary

May 22, 2001

Lori Wrotenbery

Director

Oil Conservation Division

**CERTIFIED MAIL**

**RETURN RECEIPT NO. 5357 8246**

Mr. John E. Skopak  
Conoco Inc.  
P.O. Box 2197  
Houston, Texas 77252-2197

Re: APEX Compressor Station  
Discharge Plan GW-163  
Groundwater Investigation

Dear Mr. Skopak:

The New Mexico Oil Conservation Division (OCD) is in receipt of Conoco Inc.'s Groundwater Investigation Plan dated March 06, 2001 for the APEX Compressor Station. **The plan is hereby approved with the results of the investigation to be submitted to the OCD Santa Fe office and a copy provided to the District office by July 31, 2001.**

Please be advised that NMOCD approval of this plan does not relieve Conoco Inc. of liability should their operations fail to adequately investigate and remediate contamination that pose a threat to ground water, surface water, human health or the environment. In addition, NMOCD approval does not relieve Conoco Inc. of responsibility for compliance with any other federal, state, or local laws and/or regulations.

Sincerely Yours;

Wayne Price-Pet. Engr. Spec.

cc: OCD Hobbs Office

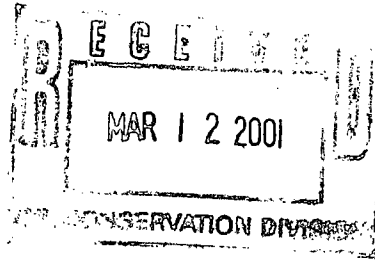

March 6, 2001

Mr. Wayne Price  
NM Oil Conservation Division  
2040 S. Pacheco  
Santa Fe, NM 87505

RE: APEX COMPRESSOR STATION  
GROUNDWATER INVESTIGATION  
HOBBS, LEA COUNTY, NEW MEXICO

Dear Mr. Price:

Accompanying this letter is a copy of a report detailing the subsurface investigation performed during January 23, 2001 at the Apex Compressor Station, west of Hobbs, New Mexico.

In the report we provide details of additional actions that we propose to implement at the facility. We are prepared to initiate these actions as soon as we receive your approval to proceed. If you have any questions or comments regarding this report, please do not hesitate to contact Clyde Yancey or Dan Erskine at 505-237-8440.

Sincerely,  
MAXIM TECHNOLOGIES, INC.

Clyde L. Yancey, P.G.

CC: Mark Bishop, Conoco NG&GP, Maljamar, NM  
OCD/Hobbs, NM

ATTACHMENT

Price, Wayne

**From:** Price, Wayne  
**Sent:** Thursday, January 11, 2001 11:46 AM  
**To:** 'Clyde L. Yancey'  
**Subject:** RE: Work Plans for Apex Compressor Station and PCA Junction

GW-163

NO ~~GW~~?  
GW??

CASE # ASSIGNED 2R0043

The groundwater investigation work plan is hereby approved with the following additional conditions as listed in the attachment Gwapp.doc:

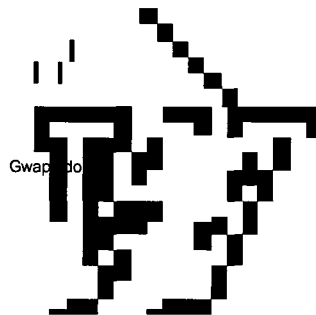

-----  
**From:** Clyde L. Yancey[SMTP:cyancey@swcp.com]  
**Sent:** Wednesday, January 10, 2001 3:40 PM  
**To:** WPrice@state.nm.us  
**Cc:** Skopak, John E.; Bishop, Mark A.  
**Subject:** Work Plans for Apex Compressor Station and PCA Junction

<<File: OCD Cover Letter.doc>><<File: WORKPLAN 1.DOC>><<File: WORKPLAN 1 PCA.DOC>>

Dear Wayne,

Attached is a cover letter to you and two work plans for the above referenced sites. We would appreciate your review and comments as soon as possible. We would like to get out and install/sample the monitor w during the week of 1/22/01.

Thanks,

1. A minimum of three soil samples shall be submitted for laboratory confirmation from each bore hole and shall be analyzed for Benzene, Toluene, Ethylbenzene, and total Xylene (BTEX method 8021), Total Petroleum Hydrocarbons (TPH method 418.1 or 8015) and chlorides.
2. New monitor well(s) shall be completed as follows:
  - a. At least 15 feet of well screen shall be placed across the water table interface with 5 feet of the well screen above the water table and 10 feet of the well screen below the water table.
  - b. An appropriately sized gravel pack shall be set in the annulus around the well screen from the bottom of the hole to 2-3 feet above the top of the well screen.
  - c. A 2-3 foot bentonite plug shall be placed above the gravel pack.
  - d. The remainder of the hole shall be grouted to the surface with cement containing 3-5% bentonite.
  - e. A concrete pad shall be placed at the surface around the well. The well shall be installed with a suitable protective locking device.
  - f. The well(s) shall be developed after construction using EPA approved procedures.
3. No less than 48 hours after the well(s) are developed, ground water from all monitor well(s) shall be purged, sampled and analyzed for Volatile Organics (EPA method 8260), General chemistry, total dissolved solids, pH (EPA method CFR 40 136.3) and New Mexico Water Quality Control Commission (WQCC) metals, all using EPA approved methods and quality assurance/quality control (QA/QC) procedures.
4. All wastes generated during the investigation shall be disposed of at an OCD approved facility.
5. Conoco Inc. shall submit the results of the investigation to the OCD Santa Fe Office by **April 15, 2001** with a copy provided to the appropriate OCD District Office and shall include the following investigative information:
  - a. A description of all investigation, remediation and monitoring activities which have occurred including conclusions and recommendations.
  - b. A geologic/lithologic log and well completion diagram for each bore hole or monitor well.
  - c. A water table potentiometric map showing the location of the leaks and spills, excavated areas, monitor wells, and any other pertinent site features as well as the



~~Mr. Ralph Corry~~

~~01/27/01~~

~~Page 2~~

direction and magnitude of the hydraulic gradient.

- d. Isopleth maps for contaminants of concern which were observed during the investigations.
  - e. Summary tables of all soil and ground water quality sampling results and copies of all laboratory analytical data sheets and associated QA/QC data taken within the past year.
  - f. The quantity and disposition of all recovered product and/or wastes generated.
6. Conoco Inc. will notify the OCD Santa Fe office and the appropriate OCD District office at least 48 hours in advance of all scheduled activities such that the OCD has the opportunity to witness the events and/or split samples during OCD's normal business hours.

Please be advised that NMOCD approval of this groundwater investigation plan does not relieve Conoco Inc. of responsibility should their activities have failed to adequately investigate and remediate contamination that pose a threat to ground water, surface water, human health or the environment. In addition, NMOCD approval does not relieve Conoco Inc. of responsibility for compliance with any other federal, state, or local laws and/or regulations.

**MAXIM** Technologies Inc®

505-237-8440

Mr. Wayne Price  
NM Oil Conservation Division  
2040 S. Pacheco  
Santa Fe, NM 87505

**RE: Work Plans – Apex Compressor Station & PCA Junction**

Dear Wayne:

Please find attached work plans for the above referenced sites. These work plans address the installation and sampling of monitor wells to assess hydrocarbon impacts addressed in the December 6, 2000 letter from Maxim (on behalf of Conoco Inc.) to your attention. We would appreciate your review and comments on the plans. It is our intention to initiate the work during the week of January 22, 2001. Therefore, we would appreciate your review as soon as possible.

If you have any questions, please do not hesitate to call.

Sincerely,  
**MAXIM TECHNOLOGIES, INC.**

Clyde

Copy:  
John E. Skopak, Conoco RT, Houston, TX  
Mark A. Bishop, Conoco NG&GP, Maljamar, NM



Joyce M. Miley  
Environmental Consultant  
Engineering and Compliance  
Natural Gas & Gas Products Department

Conoco Inc.  
600 N. Dairy Ashford Rd.  
P.O. Box 2197, HU3036  
Houston, TX 77252  
Telephone: (281) 293-4498  
Facsimile: (281) 293-1214

DEC 18 2000

November 30, 2000

**Certified Mail No. 7099 3220 0003 1150 1803**  
**Return Receipt Requested**

Mr. Roger Anderson  
Environmental Bureau Chief  
New Mexico Energy, Minerals & Natural Resources Department  
Oil Conservation Division  
2040 South Pacheco Street  
Santa Fe, New Mexico 87505

Re: Change of Ownership  
Conoco Inc., Natural Gas & Gas Products Department

Dear Mr. Anderson:

Effective December 1, 2000, Conoco Inc., Natural Gas & Gas Products Department (NG&GP) assumed ownership of LG&E Natural Gathering & Processing LLC, and LG&E Natural Pipeline LLC (LG&E). These LG&E entities, in turn, own certain natural gas facilities in SE New Mexico. These facilities and their OCD Groundwater Discharge numbers are listed in the table below.

Facility Name	OCD Groundwater Discharge Permit
Antelope Ridge Gas Plant	GW-162
Hobbs Gas Plant	GW-175
Apex Compressor Station	GW-163
Bootleg (aka. NBR) Compressor Station	GW-176
Bright/Yates Compressor Station	GW-160
Cedar Canyon Compressor Station	GW-296
Cal-Mon Compressor Station	GW-143
NE Carlsbad Compressor Station	GW-280
Cotton Draw Compressor Station	GW-311
Hat Mesa Compressor Station	GW-316
Lee (aka. Lea and/or Fagan/Gillespie) Compressor Station	GW-227
Pardue Farms Compressor Station	GW-288
Pure Gold 28 Compressor Station	GW-150
Parker & Parsley (aka. Malaga) Compressor Station	GW-167

Several of these locations have conditions in their permits that require the new owner to supply a written commitment to comply with the terms and conditions of the previously approved discharge plans. LG&E has informed Conoco that all above locations are in compliance with the discharge plans. Conoco has copies of all of the approval letters and LG&E signed conditions of approval for these locations. We agree to continue to operate the locations in conformance with the groundwater permits, the approval conditions and the OCD regulations.

In addition, pursuant to certain requirements of the transaction in which Conoco acquired the entities, the names of certain entities have been changed to the following: Raptor Natural Gathering & Processing LLC and Raptor Natural Pipeline LLC (in each case replacing LG&E with Raptor).

Conoco Inc. requests that all future correspondence concerning these facilities be forwarded to me at the address above. If you have any questions or require additional information, please do not hesitate to contact Mr. Mark Bishop at (505) 623-5659 or myself at (281) 293-4498.

Sincerely,

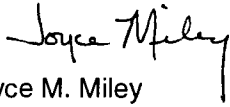

Joyce M. Miley

cc.:

Ms. Patricia Merrill  
LG&E Energy Corp.  
220 West Main Street  
PO Box 32030  
Louisville, KY 40232-2030

**Certified Mail No. 7099 3220 0003 1150 1797**  
**Return Receipt Requested**

April 5, 2000

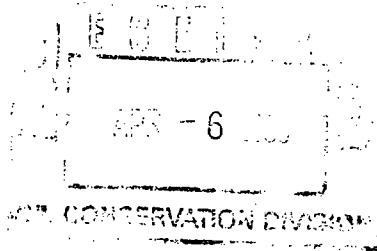

**LG&E ENERGY**  
**MARKETING**

**LG&E Natural Gathering & Processing Co.**  
921 West Sanger  
Hobbs, New Mexico 88240  
505-393-2153  
505-393-0381 FAX

Mr. Wayne Price  
State of New Mexico  
Energy, Minerals and Natural Resources Department  
Oil Conservation Division  
2040 S. Pacheco Street  
Santa Fe, New Mexico 87505

Dear Mr. Price,

Please find enclosed the necessary checks for the Discharge Fees for Antelope Ridge Gas Plant, and Apex Compressor Station.

Antelope Ridge Gas Plant; GW-162 in the amount of	\$1,667.50
Apex Compressor Station; GW-163 in the amount of	\$ 690.00

If you have any questions concerning this payment please give me a call. As always, thank you for all of your help.

Sincerely

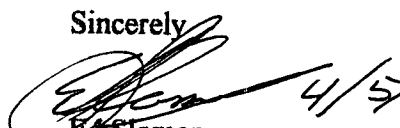
 4/5/00  
Ed Sloman  
Supervisor  
Operations Support

A SUBSIDIARY OF  
**LG&E ENERGY**

ACKNOWLEDGEMENT OF RECEIPT  
OF CHECK/CASH

I hereby acknowledge receipt of check No.                      dated 4/4/00  
or cash received on                      in the amount of \$ 690<sup>00</sup>  
from LG&E NATURAL GATHERING + PROCESSING  
for APEX COMPRESSOR ST GW-163  
Submitted by: WAYNE PRICE Date: 4/7/00  
Submitted to ASD by: Wayne Price Date: "  
Received in ASD by:                      Date:                     

Filing Fee        New Facility        Renewal ✓  
Modification        Other                       
(specify)

Organization Code 521.07 Applicable FY 2000

To be deposited in the Water Quality Management Fund.

Full Payment ✓ or Annual Increment       

THIS CHECK IS VOID WITHOUT A COLORED BACKGROUND AND AN ARTIFICIAL WATERMARK CERTIFICATION SEAL ON THE BACK-- HOLD AT ANGLE TO VIEW-SEAL.

**LG&E Natural Gathering & Processing**

2777 Stemmons Frwy, Suite 1700  
Dallas TX 75207

PNC Bank, National Association  
Jeannette PA

60-162  
433

Pay

Date	Amount
04/04/00	\$*****690.00

SIX HUNDRED NINETY AND 00/100 \*\*\*\*\*

Dollars

TO  
THE  
ORDER  
OF

**WATER QUALITY MANAGEMENT FUND**

STATE OF NEW MEXICO  
PO BOX 2088  
SANTA FE NM 87504-2088

*Patricia A. Lockwood*

SIGNATURE HAS A COLORED BACKGROUND • BORDER CONTAINS MICROPRINTING

LG&E Natural Gathering & Processing

PNC Bank, National Association

STUB CHECK NO. [REDACTED]

1 OF 1 DATE: 04/04/00

INVOICE NUMBER	DATE	PAYMENT ADVICE	GROSS	DISCOUNT	NET
REQ033000A  for GW-163	03/30/00		690.00		690.00
67184	WATER QUALITY MANAGEMENT FUND		TOTALS	690.00	690.00

# The Santa Fe New Mexican

Since 1849 We Read You.

NM OIL CONSERVATION DIVISION  
ATTN: DONNA DOMINGUEZ  
2040 S. PACHECO ST.  
SANTA FE, NM 87505

AD NUMBER: 139961      ACCOUNT: 56689  
LEGAL NO: 67124      P.O.#: 00199000278  
289 LINES      1 time(s) at \$ 127.39  
AFFIDAVITS:      5.25  
TAX:      8.29  
TOTAL:      140.93

## AFFIDAVIT OF PUBLICATION

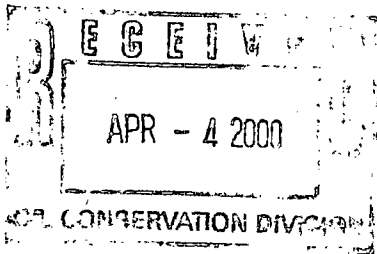

STATE OF NEW MEXICO  
COUNTY OF SANTA FE

I, B. Perner being first duly sworn declare and say that I am Legal Advertising Representative of THE SANTA FE NEW MEXICAN, a daily newspaper published in the English language, and having a general circulation in the Counties of Santa Fe and Los Alamos, State of New Mexico and being a Newspaper duly qualified to publish legal notices and advertisements under the provisions of Chapter 167 on Session Laws of 1937; that the publication #67124 a copy of which is hereto attached was published in said newspaper 1 day(s) between 03/30/2000 and 03/30/2000 and that the notice was published in the newspaper proper and not in any supplement; the first publication being on the 30 day of March, 2000 and that the undersigned has personal knowledge of the matter and things set forth in this affidavit.

/s/

Betty Perner  
LEGAL ADVERTISEMENT REPRESENTATIVE

Subscribed and sworn to before me on this  
29 day of March A.D., 2000

Notary

Candace R. Duntson

Commission Expires

11/16/2003

APPROVED  
W. Perner



**NOTICE OF PUBLICATION**

**STATE OF NEW MEXICO  
ENERGY, MINERALS AND  
NATURAL RESOURCES  
DEPARTMENT  
OIL CONSERVATION  
DIVISION**

Notice is hereby given that pursuant to New Mexico Water Quality Control Commission Regulations, the following discharge plan applications has been submitted to the Director of the Oil Conservation Division, 2040 South Pacheco, Santa Fe, New Mexico 87505, Telephone (505) 827-7131:

(GW-151) - El Paso Natural Gas Company, Tom Martinez, Senior Environmental Engineer, One Petroleum Center, Bldg. 2, 3300 North "A" Street, Midland, Texas, 79705, has submitted a renewal application for the previously approved discharge plan for their Eunice "B" Compressor Station located in the NW/4 NW/4 Quarter of Section 5, Township 21 South, Range 36 East, NMPM, Lea County, New Mexico. Approximately 50 gallons per day of waste water will be stored in above ground steel tanks prior to disposal at an OCD approved off-site disposal facility. Groundwater most likely to be affected in the event of an accidental discharge is at a depth of approximately 160 feet with a total dissolved solids concentration of 1000 mg/L. The discharge plan addresses how spills, leaks, and other accidental discharges to the surface will be managed.

(GW-162) - LG&E Natural Gathering and Processing Co., J.R. Delaney, Operations Manager, 921 W. Sanger, Hobbs, New Mexico, 88240, has submitted a renewal application for the previously approved discharge plan for their Antelope Ridge Gas Processing Plant located in the SW/4, SE/4 Quarter of Section 15, Township 23 South, Range 34 East, NMPM, Lea County, New Mexico. Approximately 2100 gallons per day of waste water will be stored in above ground steel tanks prior to disposal at an OCD approved off-site disposal facility. Groundwater most likely to be affected in the event of an accidental discharge is at a depth of approximately 400 feet with a total dissolved solids concentration of 55 mg/L. The discharge plan addresses how spills, leaks, and other accidental discharges to the surface will be managed.

(GW-163) - LG&E Natural Gathering and Processing

Co., J.R. Delaney, Operations Manager, 921 W. Sanger, Hobbs, New Mexico, 88240, has submitted a renewal application for the previously approved discharge plan for their Apex Compressor Station located in the SE/4, NE/4 Quarter of Section 36, Township 18 South, Range 36 East, NMPM, Lea County, New Mexico. Approximately 42 gallons per day of waste water will be stored in above ground steel tanks prior to disposal at an OCD approved off-site disposal facility. Groundwater most likely to be affected in the event of an accidental discharge is at a depth of approximately 40 feet with a total dissolved solids concentration of 300 mg/L. The discharge plan addresses how spills, leaks and other accidental discharges to the surface will be managed.

Any interested person may obtain further information from the Oil Conservation Division and may submit written comments to the

Director of the Oil Conservation Division at the address given above. The discharge plan application may be viewed at the above address between 8:00 a.m. and 4:00 p.m., Monday through Friday. Prior to ruling on any proposed discharge plan or its modification, the Director of the Oil Conservation Division shall allow at least thirty (30) days after the date of publication of his notice during which comments may be submitted to him and a public hearing may be requested by any interested person. Requests for a public hearing shall set forth the reasons why a hearing should be held. A hearing will be held if the Director determines there is significant public interest.

If no public hearing is held, the Director will approve or disapprove the proposed plan based on information available. If a public hearing is held, the director will approve or disapprove the proposed plan based on information in the plan and information submitted at the hearing.

GIVEN under the Seal of New Mexico Oil Conservation Commission at Santa Fe, New Mexico, on this 24th day of March, 2000.

STATE OF NEW MEXICO  
OIL CONSERVATION  
DIVISION  
LORI WROTENBERY,  
Director

Legal #67124  
Pub. March 30, 2000

NOTICE OF PUBLICATION

STATE OF NEW MEXICO  
ENERGY, MINERALS AND NATURAL RESOURCES DEPARTMENT  
OIL CONSERVATION DIVISION

Notice is hereby given that pursuant to New Mexico Water Quality Control Commission Regulations, the following discharge plan applications has been submitted to the Director of the Oil Conservation Division, 2040 South Pacheco, Santa Fe, New Mexico 87505, Telephone (505) 827-7131:

(GW-151) - El Paso Natural Gas Company, Tom Martinez, Senior Environmental Engineer, One Petroleum Center, Bldg. 2, 3300 North "A" Street, Midland, Texas, 79705, has submitted a renewal application for the previously approved discharge plan for their Eunice "B" Compressor Station located in the NW/4 NW/4 Quarter of Section 5, Township 21 South, Range 36 East, NMPM, Lea County, New Mexico. Approximately 50 gallons per day of waste water will be stored in above ground steel tanks prior to disposal at an OCD approved off-site disposal facility. Groundwater most likely to be affected in the event of an accidental discharge is at a depth of approximately 160 feet with a total dissolved solids concentration of 1000 mg/L. The discharge plan addresses how spills, leaks, and other accidental discharges to the surface will be managed.

(GW-162) - LG&E Natural Gathering and Processing Co., J.R. Delaney, Operations Manager, 921 W. Sanger, Hobbs, New Mexico, 88240, has submitted a renewal application for the previously approved discharge plan for their Antelope Ridge Gas Processing Plant located in the SW/4, SE/4 Quarter of Section 15, Township 23 South, Range 34 East, NMPM, Lea County, New Mexico. Approximately 2100 gallons per day of waste water will be stored in above ground steel tanks prior to disposal at an OCD approved off-site disposal facility. Groundwater most likely to be affected in the event of an accidental discharge is at a depth of approximately 400 feet with a total dissolved solids concentration of 55 mg/L. The discharge plan addresses how spills, leaks, and other accidental discharges to the surface will be managed.

(GW-163) - LG&E Natural Gathering and Processing Co., J.R. Delaney, Operations Manager, 921 W. Sanger, Hobbs, New Mexico, 88240, has submitted a renewal application for the previously approved discharge plan for their Apex Compressor Station located in the SE/4, NE/4 Quarter of Section 36, Township 18 South, Range 36 East, NMPM, Lea County, New Mexico. Approximately 42 gallons per day of waste water will be stored in above ground steel tanks prior to disposal at an OCD approved off-site disposal facility. Groundwater most likely to be affected in the event of an accidental discharge is at a depth of approximately 40 feet with a total dissolved solids concentration of 300 mg/L. The discharge plan addresses how spills, leaks, and other accidental discharges to the surface will be managed.

Any interested person may obtain further information from the Oil Conservation Division and may submit written comments to the Director of the Oil Conservation Division at the address given above. The discharge plan application may be viewed at the above address between 8:00 a.m. and 4:00 p.m., Monday through Friday. Prior to ruling on any proposed discharge plan or its modification, the Director of the Oil Conservation Division shall allow at least thirty (30) days after the date of publication of this notice during which comments may be submitted to him and a public hearing may be requested by any interested person. Requests for a public hearing shall set forth the reasons why a hearing should be held. A hearing will be held if the Director determines there is significant public interest.

If no public hearing is held, the Director will approve or disapprove the proposed plan based on information available. If a public hearing is held, the director will approve or disapprove the proposed plan based on information in the plan and information submitted at the hearing.

GIVEN under the Seal of New Mexico Oil Conservation Commission at Santa Fe, New Mexico, on this 24th day of March, 2000.

STATE OF NEW MEXICO  
OIL CONSERVATION DIVISION

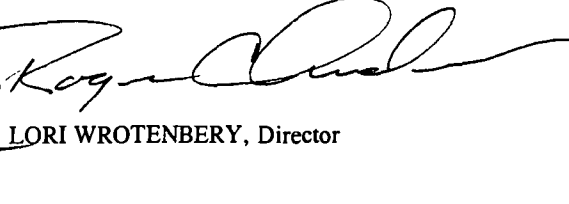

LORI WROTENBERY, Director

S E A L



March 10, 2000

**LG&E Natural Gathering & Processing Co.**  
921 West Sanger  
Hobbs, New Mexico 88240  
505-393-2153  
505-393-0381 FAX

Mr. Roger C. Anderson  
Environmental Bureau Chief  
New Mexico Energy, Minerals & Natural Resources Department  
Oil Conservation Division  
2040 South Pacheco Street  
Santa Fe, New Mexico 87505

Dear Mr. Anderson,

Please find attached to this cover letter our Discharge Plan renewal application for our Apex Compressor Station. Discharge Plan number GW-163. Additionally attached is a check for fifty dollars (\$50.00) for application fee. A check for the additional \$690.00 will follow at your direction.

There have been no changes in this station since the original Discharge Plan, GW-163, was submitted. The station still has the same four compressors operating in the same manner as the original plan indicates.

If you have any questions concerning this Discharge Plan renewal please feel free to call me at your convenience.

Sincerely

A handwritten signature in black ink, appearing to read "Ed Sloman", with a long, sweeping horizontal line extending to the right.

Ed Sloman  
Supervisor  
Operations Support

## **Price, Wayne**

---

**From:** System Administrator[SMTP:postmaster@lgeenergy.com]  
**Sent:** Friday, February 25, 2000 3:11 PM  
**To:** Price, Wayne  
**Subject:** Delivered: Discharge Plans



Discharge Plans

<<Discharge Plans>> Your message

**To:** 'ed.sloman@lgeenergy.com'  
**Subject:** Discharge Plans  
**Sent:** Fri, 25 Feb 2000 17:06:18 -0500

was delivered to the following recipient(s):

Sloman, Ed on Fri, 25 Feb 2000 17:10:58 -0500  
MSEXCH:MSEExchangeMTA:HOBBS:HONMMONTFS1

## **Price, Wayne**

---

**From:** Price, Wayne  
**Sent:** Friday, February 25, 2000 3:06 PM  
**To:** 'ed.sloman@lgeenergy.com'  
**Subject:** Discharge Plans

Dear Ed:

We received the fees& Info for GW-150,175 & 176 Thanks!

After reviewing the files our records reflect that the following Discharge Plan sites have expired!

Antelope Ridge Gas Plant	GW-162	filing fee \$50 + Renewal fee \$1667.50
Apex Compressor St.	GW-163	filing fee \$50 + Renewal fee \$ 690.00
Low Press Gathering	GW-167	filing fee \$50 + Renewal fee \$ 0.00

Please submit the discharge plan application plus fees by March 10, 2000.



**NEW MEXICO ENERGY, MINERALS  
& NATURAL RESOURCES DEPARTMENT**

OIL CONSERVATION DIVISION  
2040 South Pacheco Street  
Santa Fe, New Mexico 87505  
(505) 827-7131

November 18, 1998

**CERTIFIED MAIL**

**RETURN RECEIPT NO. Z-357-870-035**

Mr. Ed Sloman  
LG&E Natural Gathering and Processing Co.  
921 West Sanger  
Hobbs, New Mexico 88240

**RE: Discharge Plan GW-163 Renewal  
Apex Compressor Station  
Lea County, New Mexico**

Dear Mr. Sloman:

On April 29, 1994, the groundwater discharge plan, GW-163, for the **Apex Compressor Station** located in the SE/4 NE/4 of Section 36, Township 18 South, Range 36 East, NMPM, Lea County, New Mexico, was approved by the Director of the New Mexico Oil Conservation Division (OCD). This discharge plan was required and submitted pursuant to Water Quality Control Commission (WQCC) regulations and was approved for a period of five years. **The approval will expire on April 29, 1999.**

If your facility continues to have potential or actual effluent or leachate discharges and you wish to continue operation, you must renew your discharge plan. **If LG&E Natural Gathering and Processing Co. submits an application for renewal at least 120 days before the discharge plan expires, then the existing approved discharge plan for the same activity shall not expire until the application for renewal has been approved or disapproved.** The OCD is reviewing discharge plan submittals and renewals carefully and the review time can extend for several weeks to months. Please indicate whether you have made, or intend to make, any changes in your system, and if so, please include these modifications in your application for renewal.

Please submit the original and one copy to the OCD Santa Fe Office and one copy to the OCD Hobbs District Office. Note that the completed and signed application form must be submitted with your discharge plan renewal request. (Copies of the WQCC regulations and discharge plan application form and guidelines have been provided to LG&E Natural Gathering and Processing Co. in the past. A complete copy of the regulations is also available on OCD's website at [www.emnrd.state.nm.us/oed.htm](http://www.emnrd.state.nm.us/oed.htm).)

Mr. Ed Sloman  
LG&E Natural Gathering and Processing, GW-163  
November 18, 1998  
Page 2

---

The discharge plan renewal application for the Apex Compressor Station is subject to the WQCC Regulations 3114 discharge plan fee. Every billable facility submitting a discharge plan renewal will be assessed a fee equal to the filing fee of fifty (\$50) dollars. There is a renewal flat fee required of \$690.00 for compressor stations with greater than 3000 horsepower rating which is equal to one-half of the original flat fee. The fifty (\$50) dollar filing fee is to be submitted with discharge plan renewal application and is nonrefundable.

Please make all checks payable to **NMED-Water Quality Management** and addressed to the OCD Santa Fe Office.

If you no longer have any actual or potential discharges a discharge plan is not needed, please notify this office. If you have any questions regarding this matter, please do not hesitate to contact W. Jack Ford at (505) 827-7156.

Sincerely,



Roger C. Anderson  
Environmental Bureau Chief

RCA/wjf

cc: OCD Hobbs District Officer

HADSON

OIL CONSERVATION DIVISION  
RECEIVED

'94 MAR 5 AM 8 50

May 3, 1994

Mr. William J. LeMay  
Director  
Oil Conservation Division  
Post Office Box 2088  
Santa Fe, New Mexico 87504

Re: Discharge Plan GW-163  
Apex Compressor Station  
Lea County, New Mexico

Dear Mr. LeMay:

Enclosed please find our check in the amount of \$1,380.00 for the referenced location.

If you have questions or comments, do not hesitate to call.

Very truly yours,

LLANO, INC.



Ed Sloman

Enclosures

Llano File No. P.04.21.94.

LLANO, INC.

A SUBSIDIARY OF HADSON ENERGY PRODUCTS & SERVICES, INC.

921 W. Senger / Hobbs, New Mexico 88240  
Telephone (505) 383-2152 / FAX (505) 383-0361



LLANO, Inc. OPERATING ACCOUNT

L1930		03/23/94			
INVOICE NO.	DATE	REFERENCE	GROSS AMOUNT	DEDUCTIONS	NET AMOUNT
CKRQ940308	03/18/94				1,380.00*
		CHECK TOTAL			\$1,380.00

OPERATING ACCOUNT  
BOX 26770  
OKLAHOMA CITY, OKLAHOMA 73126-6770

LLANO, Inc.

DATE	CHECK NUMBER
03/23/94	

ONE-THOUSAND-THREE-HUNDRED-EIGHTY-DOLLARS-ZERO-CENTS\*\*\*\*\*  
\*\*\*\*\*  
PAY TO THE ORDER OF

CHECK AMOUNT
****\$1,380.00*

OIL CONSERVATION DIVISION  
P.O. BOX 2088  
SANTA FE, NM

LLANO, INC.  
OPERATING ACCOUNT

Payable through  
Mellon Bank (DE) N.A., Wilmington, DE 19899  
Mellon Bank (East) N.A., Philadelphia, PA 19102

87501

*[Signature]*





STATE OF NEW MEXICO

ENERGY, MINERALS AND NATURAL RESOURCES DEPARTMENT

OIL CONSERVATION DIVISION



BRUCE KING  
GOVERNOR

ANITA LOCKWOOD  
CABINET SECRETARY

POST OFFICE BOX 2088  
STATE LAND OFFICE BUILDING  
SANTA FE, NEW MEXICO 87504  
(505) 827-5800

April 29, 1994

**CERTIFIED MAIL**

**RETURN RECEIPT NO. P-176-012-207**

Mr. J.R. Delaney  
Llano Inc.  
921 W. Sanger  
Hobbs, New Mexico 88240

**Re: Discharge Plan (GW-163)  
Apex Compressor Station  
Lea County, New Mexico**

Dear Mr. Delaney:

The groundwater discharge plan GW-163 for the Llano Inc. Apex Compressor Station located in the SE/4 NE/4 Section 36, Township 18 South, Range 36 East, NMPM, Lea County, New Mexico is **hereby approved** under the conditions contained in the enclosed attachment. The discharge plan consists of the application dated March 10, 1994.

The discharge plan was submitted pursuant to section 3-106 of the Water Quality Control Commission Regulations. It is approved pursuant to section 3-109.A.. Please note Section 3-109.F., which provides for possible future amendment of the plan. Please be advised that approval of this plan does not relieve you of liability should your operation result in actual pollution of surface or ground waters or the environment which may be actionable under other laws and/or regulations.

Please be advised that all exposed pits, including lined pits and open top tanks (exceeding 16 feet in diameter) shall be screened, netted, or otherwise rendered nonhazardous to wildlife including migratory birds.

Please note that section 3-104 of the regulations requires that "when a plan has been approved, discharges must be consistent with the terms and conditions of the plan". Pursuant to Section 3-107.C. you are required to notify the Director of any facility expansion, production increase, or process modification that would result in any change in the discharge of water quality or volume.

Mr. J.R. Delaney  
April 29, 1994  
Page 2

Pursuant to Section 3-109.G.4., this approval is for a period of five years. This approval will expire April 29, 1999 and you should submit an application for renewal in ample time before that date.

The discharge plan application for the Llano Inc. Apex Compressor Station is subject to the WQCC Regulation 3-114 discharge plan fee. Every billable facility submitting a discharge plan will be assessed a fee equal to the filing fee of fifty (50) dollars plus a flat rate of thirteen-hundred eighty (1380) dollars for compressor stations with more than 3000 horsepower.

The OCD has received your \$50 filing fee. The flat fee for an approved discharge plan may be in a single payment due at the time of approval, or in equal annual installments over the duration of the plan, with the first payment due upon receipt of this approval.

On behalf of the staff of the Oil Conservation Division, I wish to thank you and your staff for your cooperation during this discharge plan review.

Sincerely,

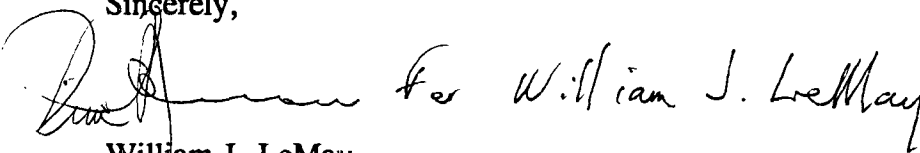
A handwritten signature in cursive script, appearing to read "William J. LeMay", followed by the text "for William J. LeMay".

William J. LeMay  
Director

WJL/cee  
Attachment

xc: Wayne Price

ATTACHMENT TO THE DISCHARGE PLAN GW-163 APPROVAL  
LLANO INC.  
APEX COMPRESSOR STATION  
DISCHARGE PLAN REQUIREMENTS  
(April 29, 1994)

1. Drum Storage: All drums will be stored on pad and curb type containment.
2. Sump Inspection: Any new sumps or below-grade tanks will incorporate leak detection in their designs.
3. Berms: All tanks that contain materials other than freshwater will be bermed to contain one and one-third (1-1/3) the capacity of the largest tank within the berm or one and one-third (1-1/3) the total capacity of all interconnected tanks.
4. Pressure testing: All discharge plan facilities are required to pressure test all underground piping at the time of discharge plan renewal. All new underground piping shall be designed and installed to allow for isolation and pressure testing at 3 psi above normal operating pressure.
5. Spills: All spills and/or leaks will be reported to the OCD district office pursuant to WQCC Rule 1-203 and OCD Rule 116.
6. OCD Inspection: Additional requirements may be placed on the facility based upon results from OCD inspections.

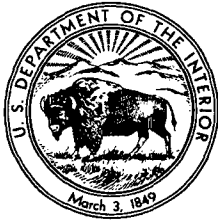

**UNITED STATES  
DEPARTMENT OF THE INTERIOR  
FISH AND WILDLIFE SERVICE  
Ecological Services**  
Suite D, 3530 Pan American Highway, NE  
Albuquerque, New Mexico 87107

April 8, 1994

OIL CONSERVATION DIVISION  
RECEIVED  
'94 APR 13 AM 8 50

William J. Lemay, Director  
Director, State of New Mexico  
Oil Conservation Division  
P.O. Box 2088  
Santa Fe, New Mexico 87504-2088

Dear Mr. Lemay:

This responds to the notice of publication received by the U.S. Fish and Wildlife Service (Service) on March 23, 1994, regarding the Oil Conservation Division (OCD) discharge permit GW-160 effects on fish, shellfish, and wildlife resources in New Mexico.

The Service has determined there are no wetlands or other environmentally sensitive habitats, plants, or animals that will be adversely affected by the following discharge.

GW-160 Llano Inc., Hobbs, New Mexico, Apex Compressor Station located in the SE/4 NE/4 section 36, T. 18 S., R. 36 E. Lea County, New Mexico. Approximately 42 gallons per day of wastewater will be collected and stored in an above ground closed top steel tank prior to transport to an OCD approved offsite disposal facility.

However, the above ground steel tank capacity should be able to contain all the water produced during periods of inclement weather when it is not possible to drain the tank on a regular schedule. The tank should also exhibit strong corrosion resistance to those fluids the tank will store. The tanks should be exposed entirely to visually detect leaks. If leaks are detected surface soil monitoring and runoff prevention measures should be implemented.

If you have any questions concerning our comments, please contact Mary Orms at (505) 883-7877.

Sincerely,

Jennifer Fowler-Propst  
State Supervisor

cc:

Director, New Mexico Department of Game and Fish, Santa Fe, New Mexico  
Regional Administrator, U.S. Environmental Protection Agency, Dallas, Texas

**NOTICE OF PUBLICATION**  
**STATE OF NEW MEXICO ENERGY,**  
**MINERALS AND NATURAL**  
**RESOURCES DEPARTMENT**  
**OIL CONSERVATION DIVISION**

Notice is hereby given that pursuant to New Mexico Water Quality Control Commission Regulations, the following discharge plan applications have been submitted to the Director of the Oil Conservation Division, State Land Office Building, P.O. Box 2088, Santa Fe, New Mexico 87504-2088. Telephone (505) 827-5800.

(GW-180) Llanos Inc., J.R. Delaney, Operations Manager, 821 W. Sanger, Hobbs, New Mexico, 88240, has submitted a discharge plan application for their Apex Compressor Station located in the SE/4 NE/4 Section 38, Township 18 South, Range 36 East, NM/PM, Lea County, New Mexico. Approximately 42 gallons per day of waste water with a total dissolved solids concentration of 2400 mg/l will be collected and stored in an above ground closed top steel tank prior to transport to an OCD approved offsite disposal facility. Groundwater most likely to be affected in the event of an accidental discharge is at a depth approximately 40 feet with a total dissolved solids concentration of approximately 300 mg/l. The discharge plan addresses how spills, leaks, and other accidental discharges to the surface will be managed.

Any interested person may obtain further information from the Oil Conservation Division and may submit written comments to the Director of the Oil Conservation Division at the address given above. The discharge plan application may be viewed at the above address between 8:00 a.m. and 4:00 p.m., Monday through Friday. Prior to ruling on any proposed discharge plan or its modification, the Director of the Oil Conservation Division shall allow at least thirty (30) days after the date of publication of this notice during which comments may be submitted to him and public hearing may be requested by any interested person. Requests for public hearing shall set forth the reasons why a hearing should be held. A hearing will be held if the director determines there is a significant public interest.

If no hearing is held, the Director will approve or disapprove the proposed plan based on information available. If a public hearing is held, the director will approve or disapprove the proposed plan based on information in the plan and information submitted at the

STATE OF NEW MEXICO

County of Bernalillo

ss

Bill Tafoya being duly sworn declares and says that he is Classified Advertising Manager of The Albuquerque Journal, and that this newspaper is duly qualified to publish legal notices or advertisements within the meaning of Section 3, Chapter 167, Session Laws of 1937, and that payment therefore has been made or assessed as court costs; that the notice, copy of which is hereto attached, was published in said paper in the regular daily edition,

for 1 times, the first publication being on the 28 day of Mar, 1994 and the subsequent consecutive publications on \_\_\_\_\_, 1994

Bill Tafoya  
Sworn and subscribed to before me, a notary Public in and for the County of Bernalillo and State of New Mexico, this 28 day of Mar 1994.

PRICE \$ 29.71

Statement to come at end of month.

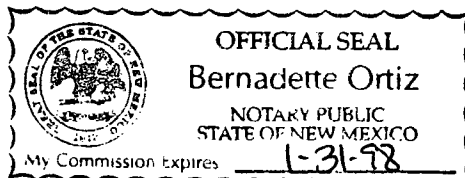

CLA-22-A (R-1/93) ACCOUNT NUMBER C81184

ACKNOWLEDGEMENT OF RECEIPT  
OF CHECK/CASH

I hereby acknowledge receipt of check No. [REDACTED] dated 3/23/94,  
or cash received on May 13, 1994 in the amount of \$ 1380<sup>00</sup>  
from Llano Inc

for Apex Compressor Station GW-163

Submitted by: \_\_\_\_\_ Date: \_\_\_\_\_  
(Facility Name) (DP No.)

Submitted to ASD by: Robert Myers Date: 5-13-94

Received in ASD by: AL. Monby Date: 5/13/94

Filing Fee \_\_\_\_\_ New Facility X Renewal \_\_\_\_\_

Modification \_\_\_\_\_ Other \_\_\_\_\_  
(specify)

Organization Code 521.07 Applicable FY 94

To be deposited in the Water Quality Management Fund.

Full Payment X or Annual Increment \_\_\_\_\_

## NOTICE OF PUBLICATION

### STATE OF NEW MEXICO ENERGY, MINERALS AND NATURAL RESOURCES DEPARTMENT OIL CONSERVATION DIVISION

Notice is hereby given that pursuant to the New Mexico Water Quality Control Commission Regulations, the following discharge plan application has been submitted to the Director of the Oil Conservation Division, State Land Office Building, P.O. Box 2088, Santa Fe, New Mexico 87504-2088, Telephone (505) 827-5800:

(GW-160) - Llano Inc., J.R. Delaney, Operations Manager, 921 W. Sanger, Hobbs, New Mexico, 88240, has submitted a discharge plan application for their Apex Compressor Station located in the SE/4 NE/4 Section 36, Township 18 South, Range 36 East, NM/PM, Lea County, New Mexico. Approximately 42 gallons per day of waste water with a total dissolved solids concentration of 2400 mg/l will be collected and stored in an above ground closed top steel tank prior to transport to an OCD approved offsite disposal facility. Groundwater most likely to be affected in the event of an accidental discharge is at a depth approximately 40 feet with a total dissolved solids concentration of approximately 300 mg/l. The discharge plan addresses how spills, leaks, and other accidental discharges to the surface will be managed.

Any interested person may obtain further information from the Oil Conservation Division and may submit written comments to the Director of the Oil Conservation Division at the address given above. The discharge plan application may be viewed at the above address between 8:00 a.m. and 4:00 p.m., Monday thru Friday. Prior to ruling on any proposed discharge plan or its modification, the Director of the Oil Conservation Division shall allow at least thirty (30) days after the date of publication of this notice during which comments may be submitted to him and public hearing may be requested by any interested person. Request for public hearing shall set forth the reasons why a hearing shall be held. A hearing will be held if the director determines that there is significant public interest.

If no hearing is held, the Director will approve or disapprove the plan based on the information available. If a public hearing is held, the Director will approve the plan based on the information in the plan and information presented at the hearing.

GIVEN under the Seal of New Mexico Oil Conservation Commission at Santa Fe, New Mexico, on this 22nd day of March, 1994.

STATE OF NEW MEXICO  
OIL CONSERVATION DIVISION

*William J. Lemay*  
WILLIAM J. LEMAY, Director *by MES*

SEAL



State of New Mexico  
Energy, Minerals and Natural Resources Department  
OIL CONSERVATION DIVISION  
P.O. Box 2088  
Santa Fe, NM 87501

RECEIVED

MAR 21 1994

OIL CONSERVATION DIV.  
SANTA FE

**DISCHARGE PLAN APPLICATION FOR NATURAL GAS PROCESSING PLANTS,  
OIL REFINERIES AND GAS COMPRESSOR STATIONS**

(Refer to OCD Guidelines for assistance in completing the application.)

- I. TYPE: Compressor Station
- II. OPERATOR: Llano, Inc.
- ADDRESS: 921 West Sanger Hobbs, New Mexico 88240
- CONTACT PERSON: John R. Delaney PHONE: (505) 393-2153
- III. LOCATION: SE /4 NE /4 Section 36 Township 18S Range 36E  
Submit large scale topographic map showing exact location.
- IV. Attach the name and address of the landowner(s) of the disposal facility site.
- V. Attach description of the facility with a diagram indicating location of fences, pits, dikes, and tanks on the facility.
- VI. Attach a description of sources, quantities and quality of effluent and waste solids.
- VII. Attach a description of current liquid and solid waste transfer and storage procedures.
- VIII. Attach a description of current liquid and solid waste disposal procedures.
- IX. Attach a routine inspection and maintenance plan to ensure permit compliance.
- X. Attach a contingency plan for reporting and clean-up of spills or releases.
- XI. Attach geological/hydrological evidence demonstrating that disposal of oil field wastes will not adversely impact fresh water. Depth to and quality of ground water must be included.
- XII. Attach such other information as is necessary to demonstrate compliance with any other OCD rules, regulations and/or orders.
- XIII. CERTIFICATION

I hereby certify that the information submitted with this application is true and correct to the best of my knowledge and belief.

Name: JOHN R DELANEY Title: General Manager

Signature: [Signature] Date: 3/10/94

DISTRIBUTION: Original and one copy to Santa Fe with one copy to appropriate Division District Office.

I.

The major purpose of this facility, The Apex Compressor Station, is to compress natural gas.

This compressor station will be a "Booster" station. We will take gas from one section of our natural gas system, boost the pressure, and move the gas to another part of our system. To accomplish this goal we will be using four gas compressors, totaling approximately 3,850 H.P.

At this facility we will have a scrubber, skid mounted, on each compressor. This will remove the free liquids from the stream of natural gas before it is compressed. All liquids which are recovered from this facility will be contained by a 210 Bbl. tank which will be emptied into trucks as often as necessary, and transported to either market, or to a licensed disposal, which ever is applicable.

This is an existing compressor station. Three of the units have been in place prior to the requirement of a Discharge Plan. We are currently adding a fourth unit, and this discharge plan will reflect all units at this station.

II.

The Owner/Operator of the facility will be:  
LLano Inc. (505) 393-2153  
921 W. Sanger  
Hobbs, New Mexico 88240

Mr. J. R. Delaney (505) 393-2153  
Manager; Operations  
921 W. Sanger  
Hobbs, New Mexico 88240

III.

Location: SE/4, of NE/4, Section 36, Township 18 S,  
Range 36 E, NMPM, LEA County,  
New Mexico:

Attached please find a copy of the topographic map  
showing the location of the compressor station.

IV.

According to original Rights - of - Way  
documents the land owner for this property is:

ElPaso Natural Gas  
C/O Mr. Hubert Eldridge.  
P. O. Box 1492  
ElPaso, Texas 79978

(915) 541-2134  
ElPaso, Texas

## V. Facility Description

This compressor station, The Apex Compressor Station, consist of four, gas engine driven, natural gas compressors. Each of the compressors have an inlet scrubber attached to each skid. There is a filter the gas goes through after compression. The scrubbers, and filter have automatic dump valves on them, and transfer the liquid they catch to a 210 Barrel Steel tank, closed top, which exist in the area. There is an existing sump system which collects and contains the used compressor oils, and any waste water from the compressor skids. The water in this sump will be gravity separated from the used oil, and disposed of properly. The used engine oil is reclaimed by our oil vendor.

Natural gas enters this station through any single, or combination of three different lines. The gas is compressed and discharged from the station to any of four different lines. This station is designed for optimum versatility in the operations of our pipeline system.

VI. Sources, Quantities, & Quality of Effluent & Waste Solids

- 1) ENGINE COOLING WATER - Each engine driving a compressor contains approximately 340 gallons of a 50% antifreeze, 50% water mixture for cooling purposes. These are closed loop systems and normally requires no make-up.
- 2) SEPARATORS - Each scrubber (located on the compressor skid) remove an estimated 0 to 1 BBL/day of water and an estimated 0 to 1 BBL/day of hydrocarbon liquids depending upon ambient conditions, and other factors involved.
- 3) WASTE LUBRICATION OILS - The compressors contain approximately 60 gallons of lubricating oil and the engines contain approximately 100 gallons of lubrication oil each. The lubrication oil is a standard 30 or 40 weight oil and replaced approximately every 2500 hours of run time, or as required by oil analysis.

The produced water and hydrocarbon liquids will be commingled within the facility. Individual rates, volumes and concentrations should not vary beyond the ranges identified above. All process units will be self-contained to prevent intentional or inadvertent discharges and spills.

## VII. TRANSFER & STORAGE OF PROCESS FLUIDS & EFFLUENTS

Produced water and hydrocarbon liquids are collected in the compressor scrubber, and the filter. The produced water and hydrocarbon liquids are commingled and piped to a closed storage tank. ( See attached facility schematic).

The compressor scrubbers are each pressurized. The closed storage tank will be maintained at atmospheric pressure.

The closed storage tank is a standard API 210 Barrel tank. The tank is constructed above ground level with an earthen dike enclosure to provide secondary containment equal to one-third greater than the tank capacity.

Waste lubrication oil and foundation drains are piped to above ground pipe blowcases, on the fourth unit, the other three existing units have a sump system in place. On this system gravity feeds the spent oil and skid drains to the sump.



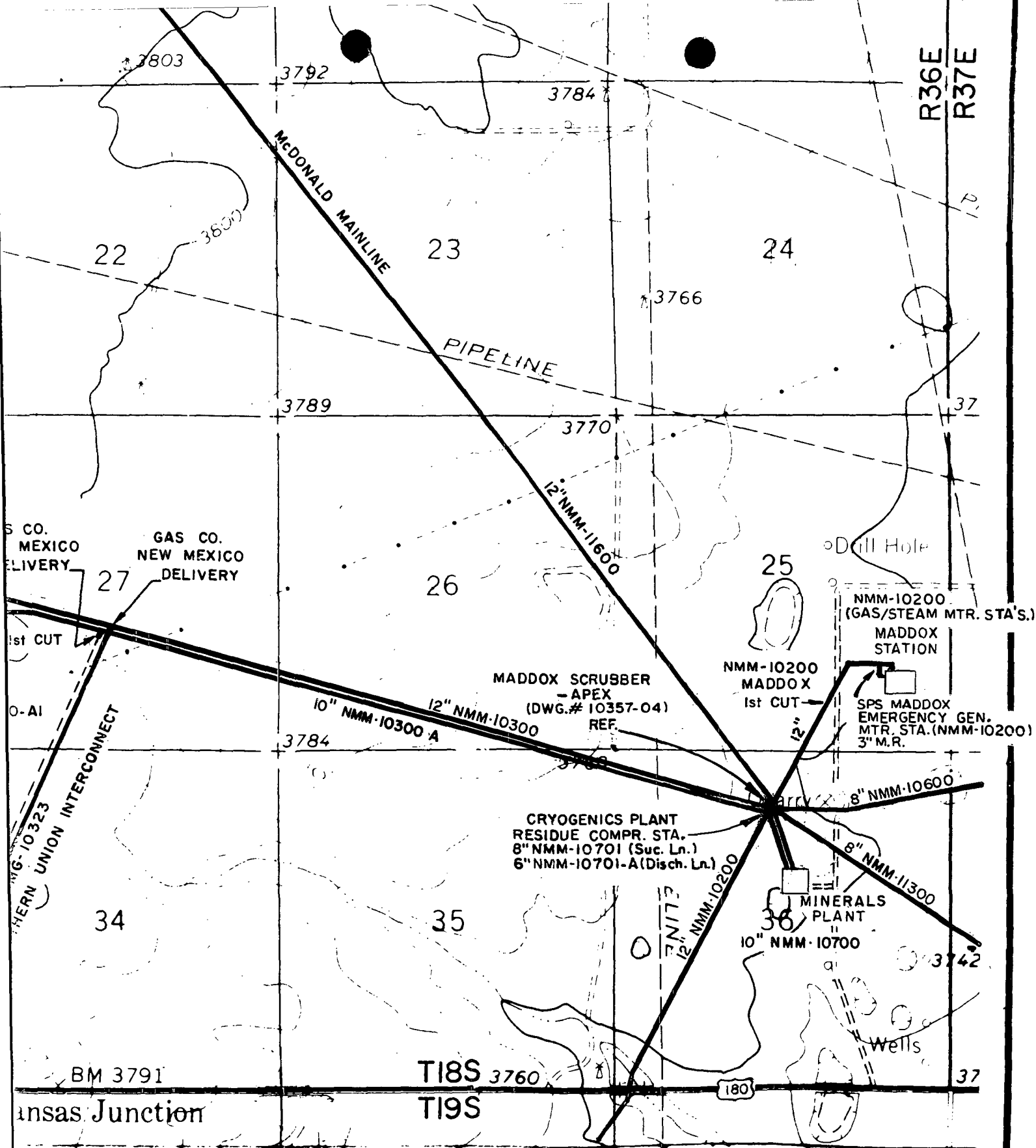

**INC.  
MAP**

**SCALE**



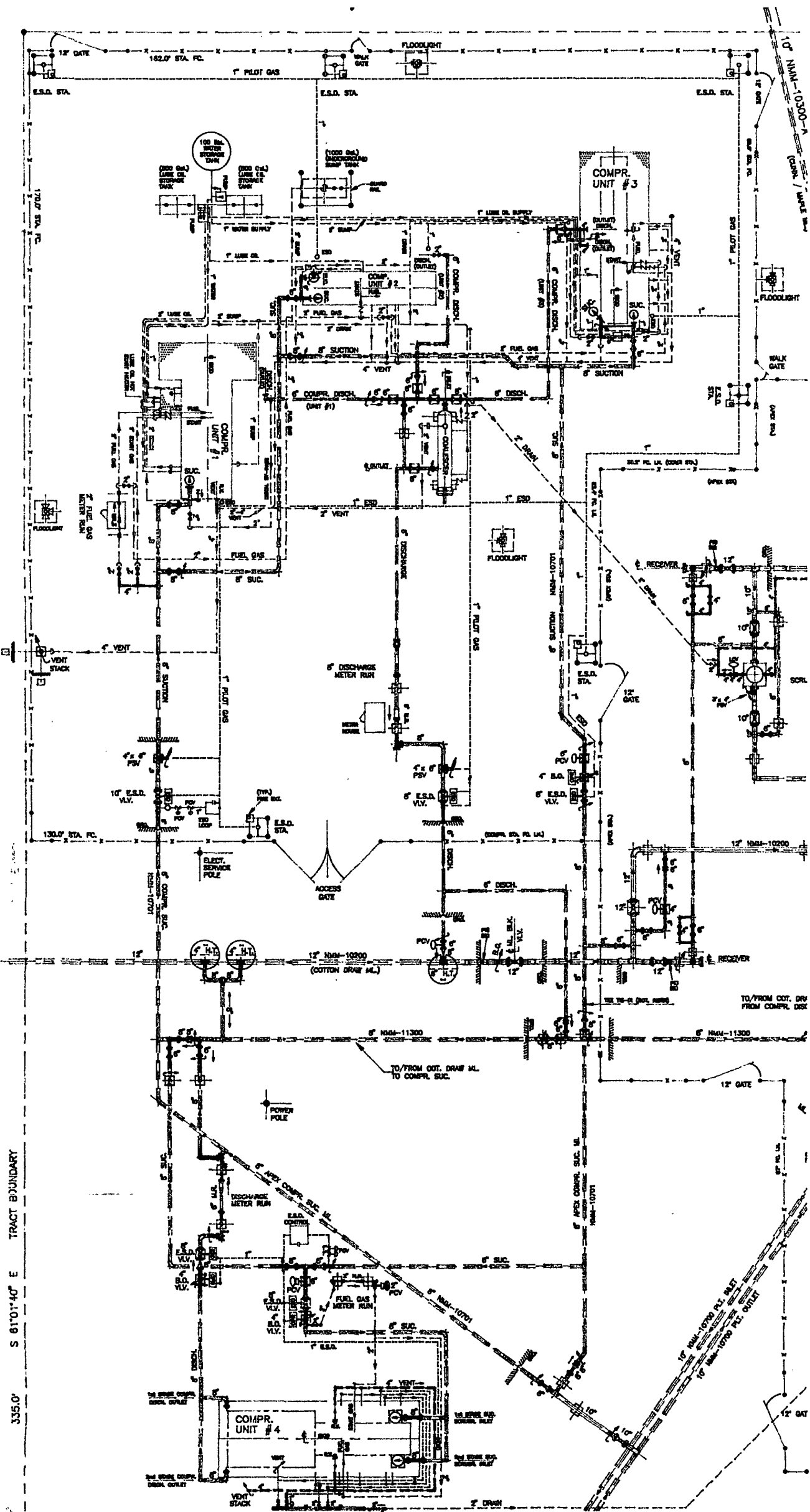

335.0' S 61°01'40" E TRACT BOUNDARY

VIII.

This is not a disposal site for EFFLUENT Liquid.

As previously stated, the purpose of this site is to compress natural gas. There will be some produced water, and condensate which will be recovered from the natural gas. These liquids will be stored in a 210 Bbl. tank, and will be hauled from location. The produced water will be disposed of by a trucking company, either Rowland Trucking, or AA Oilfield Service. Both of these companies have approved disposal wells which they use, and charge us for the disposal of the produced water.

The condensate will be sold to a refinery. The refinery of choice will be elected by price, and they will pick up the condensate from the storage tank and transport it to their facility.

The used engine lubricants, and filters will be handled by our oil vendor. The Compressors are a rental unit, and three owned units, LLano Inc. will preform all maintenance required on this unit.

The storage tank will be monitored by our operators on a daily bases. Our operators will be reporting to their supervisor by mobile communications if this tank should need any further attention. Our supervisors have the means to order a truck to haul liquid at the time our operator's report to him. With this type of check, and safety check, there should be no ground water contamination to contend with.

Simply stated, if the liquid is contained in the tank, then it cannot contaminate the ground, or ground water.

IX.

This facility will have an operator which will check the operations of the facility on a daily bases. The operator will report the functioning of the compressors, and a log will be kept of the units. If the operator should locate any problem in any of the equipment, what-so-ever, he will report the problem to his supervisor. Each operator is equipped with mobile communications, which is monitored 24 hours a day.

In the event of a "reportable spill", the operator would notify his supervisor immediately of the occurrence. The supervisor would in turn notify his immediate supervisor, and our emergency report and operating plan would be implemented.

Fluids will be collected inside pressure vessels. These vessels will be ASME stamped, approved, pressure vessels. Therefore, no precipitation can be collected in them, or commingled with produced fluids.

The compressor units have an "environmental" skid, which will not allow precipitation which has contacted this unit to runoff onto the ground. The new unit skid will be piped into a "blow casing" which will transfer all fluids to an above ground storage tank. The original three units are piped into a gravity feed sump system. As previously stated the contents of these tank will be hauled by truck as often as necessary to assure proper levels are maintained.

The sump system is a 1000 gal. tank which has been installed since the origin of this station. The existing sump will be tested by placing a "stand pipe" in the top of the tank, six feet tall. The tank, and pipe will be filled with water, and the level of the "stand pipe," will be monitored for at least 30 min. This will be done at least once a year, to assure there are no leaks in the sump tank. The drain lines will be tested at least once every five years in the same manner to assure OCD compliance.

X.

Our contingency plan for cleaning up spills, and reporting same is not complicated. We have a supervisor on call who is available on 24 hours a day. There are administrative support supervisors available when ever needed.

If a spill should occur, the supervisor on duty would start the field operations of the clean-up, by first stopping the source of the spill, and containing all fluids that he possibly can. The on duty supervisor would notify the support people of the situation. The OCD would be notified pursuant to rule 116, and a contractor would be dispatched at that time to start clean up. The land owner would be notified, and all measures would be taken to protect his live-stock, as well as any wild animals.

All clean up would be carried out in an approved manner, and all necessary waste would be dealt with accordingly.

## XI. SITE CHARACTERISTICS

A. There have been water wells located within one mile of the location of this compressor station. Therefore laboratory analysis of water from the closest well has been submitted, and is attached to this application.

This is not a disposal site. So we would not adversely effect any water, ground, or other environmental state with the disposal of waste.

(ALSO SEE SECTION 5)

Assaigai Analytical Labs  
7300 Jefferson NE  
Albuquerque, NM 87109

Attn: MARLEAH M. MARTIN  
Phone: (505) 345-8964

LLANO, INC.  
921 W. SANGER  
HOBBS, NM 88240

Attn: ED SLOMAN

Purchase Order: 12980  
Invoice Number:

Order #: 93-11-141  
Date: 12/02/93 14:33  
Work ID: MINERALS INC.  
Date Received: 11/19/93  
Date Completed: 12/02/93

Client Code: LLA01

## SAMPLE IDENTIFICATION

<u>Sample</u> <u>Number</u>	<u>Sample</u> <u>Description</u>
01	MINERAL INC.

<u>Sample</u> <u>Number</u>	<u>Sample</u> <u>Description</u>
--------------------------------	-------------------------------------

ND = None Detected D\_F = Dilution Factor NT = Not Tested  
B = Analyte was present in the blank J = Estimated value  
E = Estimated Value, Concentration exceeds calibration range  
MULTIPLY THE LIMIT BY THE DILUTION FACTOR.

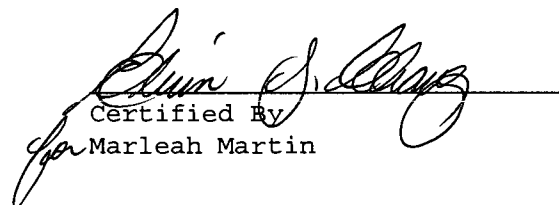
  
Certified By  
for Marleah Martin

Page 1

REPORT

Work Order # 93-11-141

Received: 11/19/93

Results By Test

TEST CODE	Sample <u>01</u>
default units	(entered units)
WFAAX	N/A
N/A	





Page 2

REPORT

Work Order # 93-11-141

Received: 11/19/93

Results by Sample

SAMPLE ID MINERAL INC. FRACTION 01A TEST CODE TDS NAME TDS/EPA 160.1  
Date & Time Collected 11/18/93 14:40:00 Category WATER

PARAMETER	RESULT	LIMIT	D_F	DATE_ANAL
Total Dissolved Solids	<u>344</u>	<u>1.0</u>	<u>1.0</u>	<u>11/23/93</u>

Notes and Definitions for this Report:

EXTRACTED \_\_\_\_\_  
ANALYST JCB  
UNITS mg/L  
BATCH\_ID WTDS-090  
COMMENTS \_\_\_\_\_ N/A



Page 3

REPORT

Work Order # 93-11-141

Received: 11/19/93

Results by Sample

SAMPLE ID MINERAL INC. FRACTION 01A TEST CODE WALK NAME ALKALINITY/EPA 310.1  
Date & Time Collected 11/18/93 14:40:00 Category WATER

PARAMETER	RESULT	LIMIT	D_F	DATE_ANAL
Alkalinity	<u>7.6</u>	<u>2.0</u>	<u>1.0</u>	<u>12/01/93</u>

Notes and Definitions for this Report:

EXTRACTED \_\_\_\_\_  
ANALYST DS  
UNITS mg/L  
BATCH\_ID WALK-47  
COMMENTS \_\_\_\_\_ N/A



Page 4

REPORT

Work Order # 93-11-141

Received: 11/19/93

Results by Sample

SAMPLE ID MINERAL INC. FRACTION 01E TEST CODE WBTEX NAME BTEX/EPA 602  
Date & Time Collected 11/18/93 14:40:00 Category WATER

PARAMETER	RESULT	LIMIT	D_F	DATE_ANAL
Benzene	<u>ND</u>	<u>1.0</u>	<u>1.0</u>	<u>11/23/93</u>
Toluene	<u>ND</u>	<u>1.0</u>	<u>1.0</u>	<u>11/23/93</u>
Ethylbenzene	<u>ND</u>	<u>1.0</u>	<u>1.0</u>	<u>11/23/93</u>
P-&m-xylene	<u>ND</u>	<u>1.0</u>	<u>1.0</u>	<u>11/23/93</u>
O-xylene	<u>ND</u>	<u>1.0</u>	<u>1.0</u>	<u>11/23/93</u>

Notes and Definitions for this Report:

EXTRACTED \_\_\_\_\_

ANALYST NOFILE ID 015UNITS ug/LBATCH\_ID WGCVOA-110

COMMENTS \_\_\_\_\_ N/A



Page 5

REPORT

Work Order # 93-11-141

Received: 11/19/93

Results by Sample

SAMPLE ID MINERAL INC. FRACTION 01B TEST CODE WCL NAME CHLORIDE/EPA 325.3  
 Date & Time Collected 11/18/93 14:40:00 Category WATER

PARAMETER	RESULT	LIMIT	D_F	DATE_ANAL
Chloride	<u>25.0</u>	<u>1.0</u>	<u>1.0</u>	<u>11/29/93</u>

Notes and Definitions for this Report:

EXTRACTED \_\_\_\_\_  
 ANALYST TSH  
 UNITS mg/L  
 BATCH\_ID WCL-54  
 COMMENTS N/A



Page 6

REPORT

Work Order # 93-11-141

Received: 11/19/93

Results by Sample

SAMPLE ID MINERAL INC. FRACTION 01D TEST CODE WFAACA NAME CALCIUM (FAA)/EPA 215.1  
Date & Time Collected 11/18/93 14:40:00 Category WATER

PARAMETER	RESULT	LIMIT	D_F	DATE_EXT	DATE_ANAL
Calcium, Ca	<u>74.8</u>	<u>0.10</u>	<u>10</u>	<u>11/22/93</u>	<u>12/01/93</u>

Notes and Definitions for this Report:

ANALYST KHUNITS mg/LBATCH\_ID WFAA-004COMMENTS N/A

Page 7

REPORT

Work Order # 93-11-141

Received: 11/19/93

Results by Sample

SAMPLE ID MINERAL INC. FRACTION 01D TEST CODE WFAACU NAME COPPER (FAA)/EPA 220.1  
Date & Time Collected 11/18/93 14:40:00 Category WATER

PARAMETER	RESULT	LIMIT	D_F	DATE_EXT	DATE_ANAL
Copper, Cu	<u>0.06</u>	<u>0.020</u>	<u>1.0</u>	<u>11/22/93</u>	<u>11/24/93</u>

Notes and Definitions for this Report:

ANALYST DH

UNITS mg/L

BATCH\_ID WFAA-004

COMMENTS N/A



Page 8

REPORT

Work Order # 93-11-141

Received: 11/19/93

Results by Sample

SAMPLE ID MINERAL INC. FRACTION 01D TEST CODE WFAAFE NAME IRON (FAA)/EPA 236.1  
Date & Time Collected 11/18/93 14:40:00 Category WATER

PARAMETER	RESULT	LIMIT	D_F	DATE_EXT	DATE_ANAL
Iron, Fe	<u>0.06</u>	<u>0.050</u>	<u>1.0</u>	<u>11/22/93</u>	<u>11/24/93</u>

Notes and Definitions for this Report:

ANALYST DHUNITS mg/LBATCH\_ID WFAA-004COMMENTS N/A

Page 9

REPORT

Work Order # 93-11-141

Received: 11/19/93

Results by Sample

SAMPLE ID MINERAL INC. FRACTION 01D TEST CODE WFAAK NAME POTASSIUM (FAA)/EPA 258.1  
Date & Time Collected 11/18/93 14:40:00 Category WATER

PARAMETER	RESULT	LIMIT	D_F	DATE_EXT	DATE_ANAL
Potassium, K	<u>1.86</u>	<u>0.050</u>	<u>1.0</u>	<u>11/22/93</u>	<u>12/01/93</u>

Notes and Definitions for this Report:

ANALYST KH

UNITS mg/L

BATCH\_ID WFAA-004

COMMENTS N/A





Page 10

REPORT

Work Order # 93-11-141

Received: 11/19/93

Results by Sample

SAMPLE ID MINERAL INC. FRACTION 01D TEST CODE WPAAMG NAME MAGNESIUM (FAA)/EPA 242.1  
Date & Time Collected 11/18/93 14:40:00 Category WATER

PARAMETER	RESULT	LIMIT	D_F	DATE_EXT	DATE_ANAL
Magnesium, Mg	<u>8.29</u>	<u>0.0050</u>	<u>3.0</u>	<u>11/22/93</u>	<u>12/01/93</u>

Notes and Definitions for this Report:

ANALYST KH

UNITS mg/L

BATCH\_ID WFAA-004

COMMENTS N/A



Page 11

REPORT

Work Order # 93-11-141

Received: 11/19/93

Results by Sample

SAMPLE ID MINERAL INC. FRACTION 01D TEST CODE WFAAMN NAME MANGANESE (FAA)/EPA 243.1  
Date & Time Collected 11/18/93 14:40:00 Category WATER

PARAMETER	RESULT	LIMIT	D_F	DATE_EXT	DATE_ANAL
Manganese, Mn	<u>ND</u>	<u>0.020</u>	<u>1.0</u>	<u>11/22/93</u>	<u>12/01/93</u>

Notes and Definitions for this Report:

ANALYST KH

UNITS mg/L

BATCH\_ID WFAA-004

COMMENTS N/A



Page 12

REPORT

Work Order # 93-11-141

Received: 11/19/93

Results by Sample

SAMPLE ID MINERAL INC. FRACTION 01D TEST CODE WFAANA NAME SODIUM (FAA)/EPA 273.1  
 Date & Time Collected 11/18/93 14:40:00 Category WATER

PARAMETER	RESULT	LIMIT	D_F	DATE_EXT	DATE_ANAL
Sodium, Na	<u>28.1</u>	<u>0.020</u>	<u>5.0</u>	<u>11/22/93</u>	<u>12/01/93</u>

Notes and Definitions for this Report:

ANALYST KH

UNITS mg/L

BATCH\_ID WFAA-004

COMMENTS N/A



Page 13

REPORT

Work Order # 93-11-141

Received: 11/19/93

Results by Sample

SAMPLE ID MINERAL INC.

FRACTION 01D

TEST CODE WFAAZN

NAME ZINC (FAA)/EPA 289.1

Date & Time Collected 11/18/93 14:40:00

Category WATER

PARAMETER	RESULT	LIMIT	D_F	DATE_EXT	DATE_ANAL
Zinc, Zn	<u>1.63</u>	<u>0.010</u>	<u>2.0</u>	<u>11/22/93</u>	<u>11/30/93</u>

Notes and Definitions for this Report:

ANALYST DH

UNITS mg/L

BATCH\_ID WFAA-004

COMMENTS N/A



Page 14

REPORT

Work Order # 93-11-141

Received: 11/19/93

Results by Sample

SAMPLE ID MINERAL INC. FRACTION 01B TEST CODE WFL NAME FLUORIDE/EPA 340.2  
Date & Time Collected 11/18/93 14:40:00 Category WATER

PARAMETER	RESULT	LIMIT	D_F	DATE_ANAL
Fluoride	<u>0.822</u>	<u>0.025</u>	<u>1.0</u>	<u>11/30/93</u>

Notes and Definitions for this Report:

EXTRACTED \_\_\_\_\_

ANALYST TSH

UNITS \_\_\_\_\_ mg/L

BATCH\_ID WFL-035

COMMENTS \_\_\_\_\_ N/A



Page 15

REPORT

Work Order # 93-11-141

Received: 11/19/93

Results by Sample

SAMPLE ID MINERAL INC. FRACTION 01C TEST CODE WNO3 NAME NITRATE as (N)/SM 4500D  
Date & Time Collected 11/18/93 14:40:00 Category WATER

PARAMETER	RESULT	LIMIT	D_F	DATE_ANAL
Nitrate	<u>2.1</u>	<u>0.30</u>	<u>1.0</u>	<u>11/22/93</u>

Notes and Definitions for this Report:

EXTRACTED \_\_\_\_\_

ANALYST SKD

UNITS \_\_\_\_\_ mg/L

BATCH\_ID WNO3-097

COMMENTS \_\_\_\_\_ N/A



Page 16

REPORT

Work Order # 93-11-141

Received: 11/19/93

Results by Sample

SAMPLE ID MINERAL INC. FRACTION 01A TEST CODE WPH NAME pH/EPA 150.1  
Date & Time Collected 11/18/93 14:40:00 Category WATER

PARAMETER	RESULT	LIMIT	D_F	DATE_ANAL
pH	<u>7.2</u>	<u>0.10</u>	<u>1.0</u>	<u>11/19/93</u>

Notes and Definitions for this Report:

EXTRACTED \_\_\_\_\_  
ANALYST JCB  
UNITS pH Units  
BATCH\_ID WPH-152  
COMMENTS \_\_\_\_\_ N/A



Page 17

REPORT

Work Order # 93-11-141

Received: 11/19/93

Results by Sample

SAMPLE ID MINERAL INC. FRACTION 01B TEST CODE WSO4 NAME SULFATE/EPA 375.4  
Date & Time Collected 11/18/93 14:40:00 Category WATER

PARAMETER	RESULT	LIMIT	D_F	DATE_ANAL
Sulfate	<u>151</u>	<u>5.0</u>	<u>10</u>	<u>11/22/93</u>

Notes and Definitions for this Report:

EXTRACTED \_\_\_\_\_

ANALYST TSH

UNITS mg/L

BATCH\_ID WSO4-047

COMMENTS \_\_\_\_\_ N/A







Lab job no.: 70141 Date           

Page 1 of 1

3711 ADMIRAL, SUITE C  
EL PASO, TEXAS 79925  
(915) 593-6000

MELQUIADES ALANIS  
6411 LOCAL UNO  
CIUDAD JUAREZ, CHIHUAHUA MEXICO 32320

Project Manager/Contact \_\_\_\_\_

Telephone No. 665 6393-200-9159

Fax. No. 501 (393) 6381

**Samplers: (Signature)** Eric M. Caldwell

100

[illegible]

Relinquished by: _____		Received by: _____		Relinquished by: _____		Received by: _____	
Signature: _____		Signature: _____		Signature: _____		Signature: _____	
Printed: _____		Printed: _____		Printed: _____		Printed: _____	
Company: _____		Company: _____		Company: _____		Company: _____	
Reason: _____		Reason: _____		Reason: _____		Reason: _____	
Date: _____		Date: _____		Date: _____		Date: _____	
Time: _____		Time: _____		Time: _____		Time: _____	
Method of Shipment: _____		Comments: _____		After analysis, samples are to be:  <input type="checkbox"/> Disposed of (additional fee) <input type="checkbox"/> Stored (30 days max) <input type="checkbox"/> Stored over 30 days (additional fee) <input type="checkbox"/> Returned to customer			
Shipment No. _____		_____					
Special Instructions: _____		_____					

ACKNOWLEDGEMENT OF RECEIPT  
OF CHECK/CASH

I hereby acknowledge receipt of check No. [REDACTED] dated 3/2/94,  
or cash received on 3/21/94 in the amount of \$ 50<sup>00</sup>

from Llano, Inc  
for Apex Compressor Station 641-163  
(Facility Name) (DP No.)

Submitted by: \_\_\_\_\_ Date: \_\_\_\_\_

Submitted to ASD by: W. H. M. Brown Date: 3/21/94

Received in ASD by: Angie Oliver Date: 3/21/94

Filing Fee X New Facility \_\_\_\_\_ Renewal \_\_\_\_\_

Modification \_\_\_\_\_ Other \_\_\_\_\_  
(specify)

Organization Code 521.07 Applicable FY 94

To be deposited in the Water Quality Management Fund.

Full Payment \_\_\_\_\_ or Annual Increment \_\_\_\_\_

LLANO, INC.

OX 1320  
HOBBS, NEW MEXICO 88240

SUNWEST BANK OF HOBBS, N.A.  
HOBBS, NEW MEXICO 88240

95-321  
1122

TO THE ORDER OF

THE SUNWEST BANK OF HOBBS, N.A.  
OIL CONSERVATION DIVISION  
P O BOX 2088  
SANTA FE, NEW MEXICO 87501

CHECK DATE: 3/2/94 CHECK NO: [REDACTED]

CHECK AMOUNT: \$50.00

LLANO, INC. - GENERAL ACCOUNT

VOID AFTER 90 DAYS

002787