

**GW - 344**

**REPORTS**

**YEAR(S):**

**2006**



# TARGA

Targa Midstream Services Limited Partnership  
6 Desta Drive, Suite 3300  
Midland, TX 79705  
432.688.0555  
[www.targaresources.com](http://www.targaresources.com)

March 21, 2006

2006 MAR 24 PM 12 04

Mr. Wayne Price  
Environmental Bureau Chief  
Oil Conservation Division  
1220 S. St. Francis Dr.  
Santa Fe, New Mexico 87505

RE: Targa Midstream Services L P  
South Eunice Compressor Station Brine Storage Pond Closure  
Discharge Plan GW-344

Dear Mr. Price:

As per Targa Midstream Services L P initial notification (Feb 28, 2006 memo, attached for your convenience) Targa proposes to close the brine storage pond at the South Eunice Compressor Station.

Find drawings attached for additional information: Figure 1 Site Location, Figure 2 Site Drawing, and Figure 3 Proposed Sample Locations.

The sediment and liner removal will begin upon your approval of the plan.

[cwrangham@targaresources.com](mailto:cwrangham@targaresources.com) or 432.688.0542

Sincerely,

Cal Wrangham  
Environmental, Safety, and Health  
Targa Midstream services L P

Cc: File Eunice Plant (GW-344)

SITE LOCATION

R-37-E

N

GRAPHIC SCALE IN FEET

Scale: 1" = 2000'

FIGURE #1

LEA COUNTY, NEW MEXICO



TARGA

EUNICE SOUTH COMPRESSOR STATION  
SE4, NW4, SECTION 27, T-22-S, R-37-E

SITE LOCATION

DATE  
03-15-06

NAME: SJA

FILE: 6-0111

Larson &  
Associates, Inc.  
Environmental Consultants

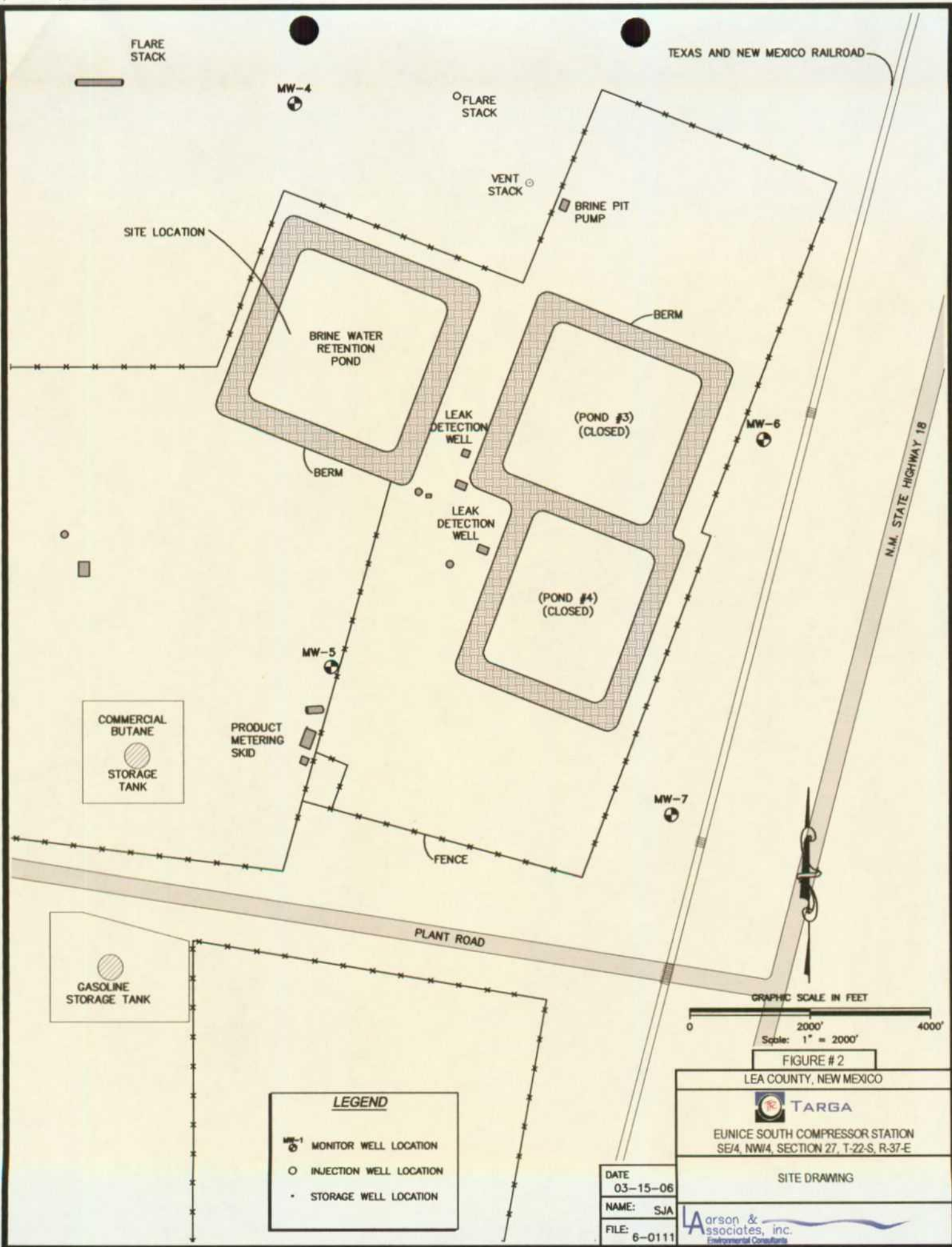



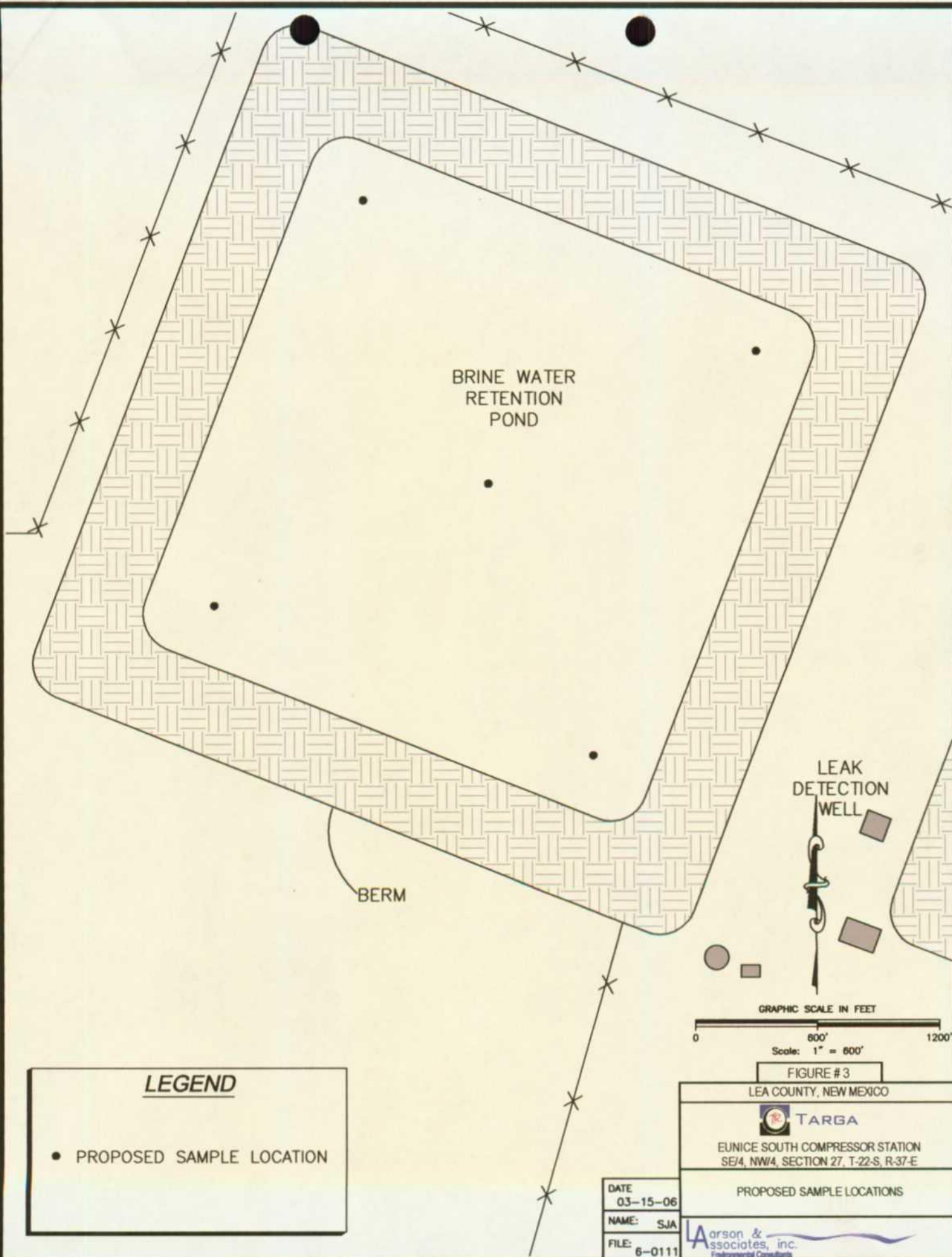



# TARGA

Targa Midstream Services Limited Partnership  
6 Desta Drive, Suite 3300  
Midland, TX 79705  
432.688.0555  
[www.targaresources.com](http://www.targaresources.com)

February 28, 2006

Mr. Wayne Price  
Environmental Bureau Chief  
Oil Conservation Division  
1220 S. St. Francis Dr.  
Santa Fe, New Mexico 87505

RE: Targa Midstream Services L P  
South Eunice Compressor Station Brine Storage Pond Closure  
Discharge Plan GW-344

Dear Mr. Price:

Targa Midstream Services L P proposes to close the brine storage pond at the South Eunice Compressor Station. The pond will be closed by removing sediment and the liner from the pond. The sediment and liner will be disposed of at a NMOCD approved facility. Soil samples will be collected beneath the pond after removing the liner in at least (3) three locations. Soil samples will be collected at depths of approximately fifteen (15) feet BGS using a stainless steel hand auger, or drilling rig. The samples will be placed in laboratory prepared containers, labeled, chilled in an ice chest, and delivered under chain of custody control to an environmental laboratory for chloride analysis. Targa will submit a summary report to the NMOCD upon completion of the project including laboratory analysis, and quality assurance and quality control (QA/QC) data.

Sincerely,

Cal Wrangham  
Environmental, Safety, and Health  
Targa Midstream services L P

Cc: File Eunice Plant (GW-344)