

**2RP-3873**  
**REMEDIATION REPORT**  
**Nash Draw Tank Battery #10**  
**Eddy County, New Mexico**

LAI Project No. 16-0108-02

March 21, 2017

Prepared for:

XTO Energy, Inc.  
500 W. Illinois Ave., Suite 100  
Midland, Texas 79707

Prepared by:

Larson & Associates, Inc.  
507 North Marienfeld Street, Suite 205  
Midland, Texas 79701

  
\_\_\_\_\_  
Mark J. Larson, P.G.

Certified Professional Geologist #10490

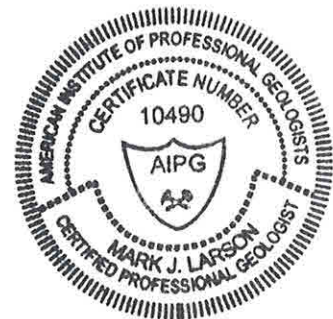

**This Page Intentionally Left Blank**

## Table of Contents

1.0	INTRODUCTION .....	1
1.1	Background.....	1
1.2	Physical Setting.....	1
1.3	Recommended Remediation Action Levels.....	2
2.0	REMEDICATION .....	2
3.0	CONCLUSIONS .....	2

## Tables

Table 1	Assessment Soil Sample Analytical Data Summary
Table 2	Confirmation Soil Sample Analytical Data Summary

## Figures

Figure 1	Topographic Map
Figure 2	Aerial Map
Figure 3	Site Map Showing Excavations and Depths

## Appendices

Appendix A	OCD Approval
Appendix B	Laboratory Reports
Appendix C	Photographs
Appendix D	Waste Manifests
Appendix E	Initial and Final C-141

## **1.0 INTRODUCTION**

Larson & Associates, Inc. (LAI) has prepared this report on behalf of XTO Energy, Inc. (XTO) for submittal to the New Mexico Oil Conservation Division (OCD) District 2, in Artesia, New Mexico and U.S. Bureau of Land Management (BLM) in Carlsbad, New Mexico, to document soil remediation at the Nash Draw #10 tank battery (Site). The Site is located in Unit G (SW/4, NE/4), Section 13, Township 23 South, Range 29 East in Eddy County, New Mexico. The geodetic position is North 32° 18' 25.95861" and West 103° 56' 7.98566". Figure 1 presents a topographic map. Figure 2 presents an aerial map.

### **1.1 Background**

On June 20, 2016, LAI personnel used a Terraprobe® direct-push rig to collect soil samples at four (4) locations (DP-02-01 through DP-02-04). Soil samples were collected between ground surface and approximately four (4) feet below ground surface (bgs). A background sample (DP-02-BG) was collected about 80 feet southwest of the Site at approximately 1 foot bgs. The laboratory analysis and initial C-141 were submitted to OCD which assigned remediation permit number 2RP-3873, on September 8, 2016.

On September 28, 2016, LAI personnel supervised a backhoe operated by SDR Enterprises, LLC (SDR), Hobbs, New Mexico, to collect soil samples to delineate impacts observed in samples from DP-02-01 and DP-02-02. On October 19, 2016, LAI personnel supervised Scarborough Drilling, Inc. (SDI), Lamesa, Texas, to collect soil samples with an air rotary rig and jam tube sampler to delineate total petroleum hydrocarbons (TPH) observed in samples from DP-02-02. Table 1 presents the analytical data summary for the assessment soil samples

On November 7, 2016, LAI, on behalf of XTO, submitted a plan OCD District 2 and BLM for approval to remediate impacts to soil based on laboratory analysis of soil samples collected on June 20, 2016, September 28, 2016 and October 19, 2016. On November 10, 2016, OCD District 2 approved the remediation plan. Appendix A presents the OCD approval.

### **1.2 Physical Setting**

The physical setting is as follows:

- Elevation is approximately 2,998 feet above mean sea level (AMSL);
- Topography slopes toward the south-southeast;
- The nearest surface water feature is a playa lake (Salt Lake) located about ½ mile west of the Site;
- Surface geology is comprised of unconsolidated Holocene to mid- Pleistocene-age eolian and piedmont-slope deposits that are approximately 80 feet thick according to a log from a nearby well;
- The Triassic-age Chinle formation of the Dockum group underlies the unconsolidated deposits and is comprised of interbedded sand, clay, and mudstone;



- According to State of New Mexico Office of the State Engineer (NMOSE) records a fresh water well is located about 1.25 miles south in Unit J (NW/4, SE/4), Section 24, Township 23 South, Range 29 East with groundwater reported at about 54 feet bgs.

### 1.3 Recommended Remediation Action Levels

Recommended remediation action levels (RRAL) were calculated for benzene, BTEX and TPH based on the following criteria established by the OCD in "Guidelines for Remediation of Leaks, Spills and Releases, August 13, 1993":

Criteria	Result	Score
Depth-to-Groundwater	50 - 99 feet	10
Wellhead Protection Area	No	0
Distance to Surface Water Body	>1,000 Horizontal Feet	0

The following RRAL apply to the release for ranking score: 10

- Benzene 10 mg/Kg
- BTEX 50 mg/Kg
- TPH 1,000 mg/Kg

## 2.0 REMEDIATION

Soil remediation was performed between November 11 and 29, 2016, according to the plan approved by OCD District 2 on November 10, 2016. SDR, under supervision from LAI, excavated soil from the area of DP-02-01 measuring about 10 x 20 feet to about 1 foot bgs. SDR excavated soil from the area of DP-02-02 measuring about 25 x 35 feet to about 16 feet bgs. Soil samples collected from the excavation sidewalls and bottom were analyzed by Permian Basin Environmental Lab (PBEL) for benzene, toluene, ethylbenzene and xylenes (BTEX) by EPA SW-846 Method 8020B and TPH by EPA SW-846 Method 8015 including GRO (C6 – C12), DRO (>C12 – C28) and ORO (>C28 – C35). PBEL reported benzene below the Method 8020B reporting limit (RL) and BTEX below the RRAL (50 mg/Kg). TPH was reported above the RRAL (1,000 mg/Kg) in soil samples from the east sidewall at 4 feet (4,150 mg/Kg) that required additional excavation to the east approximately ten (10) horizontal feet. A sample collected from east sidewall of the extended excavation on November 21, 2016, confirmed TPH was below the RRAL (<28.7 mg/Kg). TPH was below the RRAL in the remaining sidewall and bottom confirmation samples from the excavation. The excavation was filled with caliche to about 4 feet bgs where a 20 mil thickness polyethylene liner was installed. The remainder of the excavation from 4 feet to ground surface was filled caliche.

Approximately 777 cubic yards of contaminated soil was disposed at Lea Land Landfill, LLC. Table 2 presents the confirmation soil sample analytical data summary. Figure 3 presents the remediation areas. Appendix B presents the confirmation sample laboratory reports. Appendix C presents photographs. Appendix D presents the waste manifests. Appendix E presents the initial and final C-141.

### **3.0 CONCLUSIONS**

Soil was remediated according to the remediation plans approved by OCD District 2. XTO requests no further action for 2RP-3873.

## Tables

Table 1

2RP-3873

## Assessment Soil Sample Analytical Data Summary

XTO Energy, Inc., Nash Draw Tank Battery 10

Unit G (SW/4, NE/4), Section 13, Township 23 South, Range 29 East  
Eddy County, New Mexico

Location	Depth (Feet)	Collection Date	Status	C6 - C12 (mg/Kg)	>C12 - C28 (mg/Kg)	>C28 - C35 (mg/Kg)	TPH (mg/Kg)	Chloride (mg/Kg)
OCD RRAL: 1,000								
DP-02-BG	0 - 1	6/20/2016	In-Situ	<26.3	<26.3	<26.3	<26.3	37.6
DP-02-01	0 - 1	6/20/2016	Excavated	434	4,780	793	6,007	19.4
	4	9/28/2016	In-Situ	<28.7	62.9	<28.7	62.9	--
	8	9/28/2016	In-Situ	<30.1	43.3	<30.1	43.3	--
	10	9/28/2016	In-Situ	<26.9	34.6	<26.9	34.6	--
DP-02-02	0 - 1	6/20/2016	Excavated	825	6,430	1,201	8,456	457
	1 - 2	6/20/2016	Excavated	570	2,450	327	3,350	2,220
	4	9/28/2016	Excavated	1,080	2,890	556	4,520	13,600
	8	9/28/2016	Excavated	964	1,970	372	3,310	6,150
	10.5	9/28/2016	Excavated	838	1,070	179	2,090	119
	15	10/19/2016	Excavated	308	739	74.9	1,121.9	--
	20	10/19/2016	In-Situ	39.2	210	36.6	285.8	--
	25	10/19/2016	In-Situ	--	--	--	--	--
DP-02-03	0 - 1	6/20/2016	In-Situ	<26.6	53	<26.6	53	36.5
	1 - 2	6/20/2016	In-Situ	--	--	--	--	--
	2 - 3	6/20/2016	In-Situ	--	--	--	--	--
	3 - 4	6/20/2016	In-Situ	--	--	--	--	--

**Table 1**  
**2RP-3874**  
**Investigation Soil Sample Analytical Data Summary**  
**XTO Energy, Inc., Nash Draw Tank Battery 19 and 34**  
**Unit J (NE/4, SW/4), Section 12, Township 23 South, Range 29 East**  
**Eddy County, New Mexico**  
**N32.316944° W-103.936667°**

Location	Depth (Feet)	Collection Date	Status	C6 - C12 (mg/Kg)	>C12 - C28 (mg/Kg)	>C28 - C35 (mg/Kg)	TPH (mg/Kg)
<b>OCD RRAL:</b>							
<b>DP-07-01</b>	0 - 1	6/22/2016	In-Situ	31	547	115	<b>683</b>
	1 - 2	6/22/2016	In-Situ	1,970	21,400	3,060	<b>26,500</b>
	2 - 3	6/22/2016	In-Situ	<27.2	<27.2	<27.2	<27.2
<b>DP-07-02</b>	0 - 1	6/22/2016	In-Situ	<139	20,300	5,330	<b>25,630</b>
	1 - 2	6/22/2016	In-Situ	39.2	286	71.2	<b>396.4</b>
	2 - 3	6/22/2016	In-Situ	72.5	31.7	<28.7	104.2
	3 - 4	6/22/2016	In-Situ	<29.8	<29.8	<29.8	<29.8
<b>DP-07-03</b>	0 - 1	6/22/2016	In-Situ	<28.4	750	244	<b>994</b>
	1 - 2	6/22/2016	In-Situ	<28.7	<28.7	<28.7	<28.7
	2 - 3	6/22/2016	In-Situ	<29.8	<29.8	<29.8	<29.8
	3 - 4	6/22/2016	In-Situ	--	--	--	--
<b>DP-07-04</b>	0 - 1	6/22/2016	In-Situ	<27.5	359	97.4	<b>456.4</b>
<b>DP-07-05</b>	0 - 1	6/22/2016	In-Situ	216	5,530	1,560	<b>7,306</b>
	1 - 2	6/22/2016	In-Situ	33.0	1,400	254	<b>1,680</b>
	2 - 3	6/22/2016	In-Situ	37.5	87.2	<28.1	<b>124.7</b>
<b>DP-07-06</b>	0 - 1	6/22/2016	In-Situ	<27.8	102	98.7	<b>200.7</b>



**Table 1**  
**2RP-3873**  
**Assessment Soil Sample Analytical Data Summary**  
**XTO Energy, Inc., Nash Draw Tank Battery 10**  
**Unit G (SW/4, NE/4), Section 13, Township 23 South, Range 29 East**  
**Eddy County, New Mexico**

Location	Depth (Feet)	Collection Date	Status	C6 - C12 (mg/Kg)	>C12 - C28 (mg/Kg)	>C28 - C35 (mg/Kg)	TPH (mg/Kg)	Chloride (mg/Kg)
OCD RRAL: 1,000								
DP-02-04	0 - 1	6/20/2016	In-Situ	<26.6	<26.6	<26.6	<26.6	68.9
	1 - 2	6/20/2016	In-Situ	--	--	--	--	--
	2 - 3	6/20/2016	In-Situ	--	--	--	--	--
	3 - 4	6/20/2016	In-Situ	--	--	--	--	--

Notes: laboratory analysis performed by Permian Basin Environmental Lab, Midland, Texas, by EPA SW-846 method 8015M (TPH) and 300.0 (chloride)  
 Depth in feet below ground surface (bgs)  
 mg/Kg: milligrams per kilogram equivalent to parts per million (ppm)  
 RRAL: Remediation action level calculated from OCD guidance document (August 13, 1993)  
 P: analysis pending

Table 2  
2RP-3873  
Confirmation Soil Sample Analytical Data Summary  
XTO Energy, Inc., Nash Draw Tank Battery 10  
Unit G (SW/4, NE/4), Section 13, Township 23 South, Range 29 East  
Eddy County, New Mexico

Location	Sidewall	Depth (Feet)	Collection Date	Status	Benzene (mg/Kg)	BTEX (mg/Kg)	C6 - C12 (mg/Kg)	>C12 - C28 (mg/Kg)	>C28 - C35 (mg/Kg)	TPH (mg/Kg)
OCD RRAL:										
DP-02-02	North	4	11/11/2016	In-Situ	<0.00118	<0.01	<29.4	<29.4	<29.4	<29.4
		12	11/11/2016	In-Situ	<0.00106	<0.01	53.3	338	34.4	425.70
		16	11/11/2016	In-Situ	<0.00108	0.04	201	647	92.5	940.50
	East (Sidewall) (Bottom)	4	11/11/2016	Excavated	<0.00111	0.03	382	3,330	439	4,150
		4	11/21/2016	In-Situ	--	--	<28.7	<28.7	<28.7	<28.7
		8	11/16/2016	In-Situ	<0.00111	<0.00777	<27.8	<27.8	<27.8	<27.8
		12	11/11/2016	In-Situ	<0.00111	<0.00777	<27.8	<27.8	<27.8	<27.8
		16	11/11/2016	In-Situ	<0.00109	<0.00761	<27.2	<27.2	<27.2	<27.2
	South	4	11/11/2016	In-Situ	<0.00112	<0.00786	<28.1	<28.1	<28.1	<28.1
		12	11/11/2016	In-Situ	<0.00110	<0.0077	<27.5	<27.5	<27.5	<27.5
		16	11/11/2016	In-Situ	<0.00109	<0.00761	<27.2	<27.2	<27.2	<27.2
	West	4	11/11/2016	In-Situ	<0.00119	<0.00833	<29.8	<29.8	<29.8	<29.8
		12	11/11/2016	In-Situ	<0.00119	<0.00833	<27.2	<27.2	<27.2	<27.2
		16	11/11/2016	In-Situ	<0.00108	<0.00754	<26.9	<26.9	<26.9	<26.9

Notes: laboratory analysis performed by Permian Basin Environmental Lab, Midland, Texas, by EPA SW-846 Methods 8021B (BTEX) and 8015M (TPH)  
Depth in feet below ground surface (bgs)  
mg/kg: milligrams per kilogram equivalent to parts per million (ppm)  
RRAL: Remediation action level calculated from OCD guidance document (August 13, 1993)  
P: Denotes laboratory results pending

## Figures



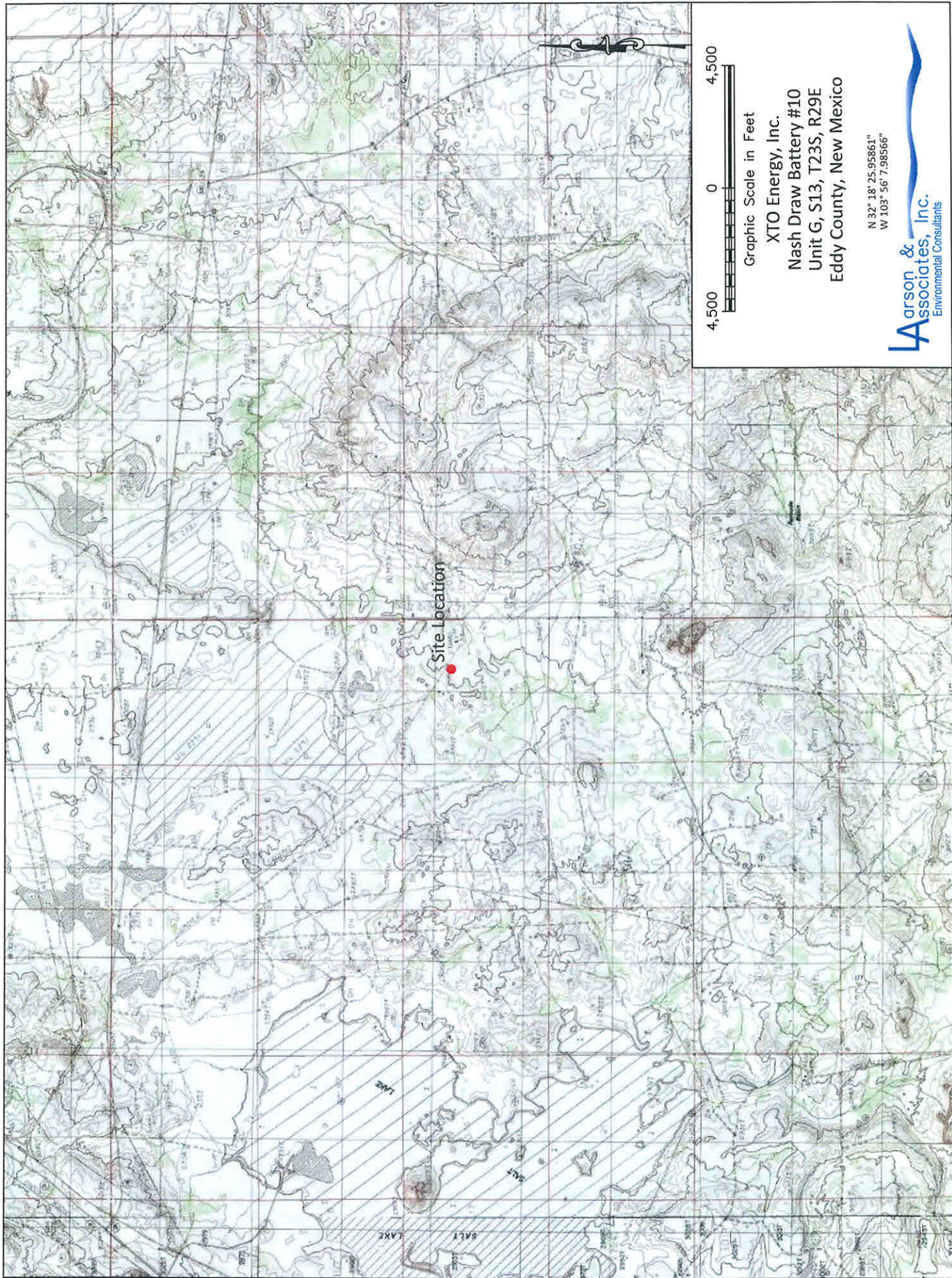

Figure 1 - Topographic Map





Graphic Scale in Feet

XTO Energy, Inc.  
Nash Draw Battery #10  
Unit G, S13, T23S, R29E  
Eddy County, New Mexico

N 32° 18' 25.95861"  
W 103° 56' 7.98566"



Figure 2 - Aerial Map

11" x 8.5"

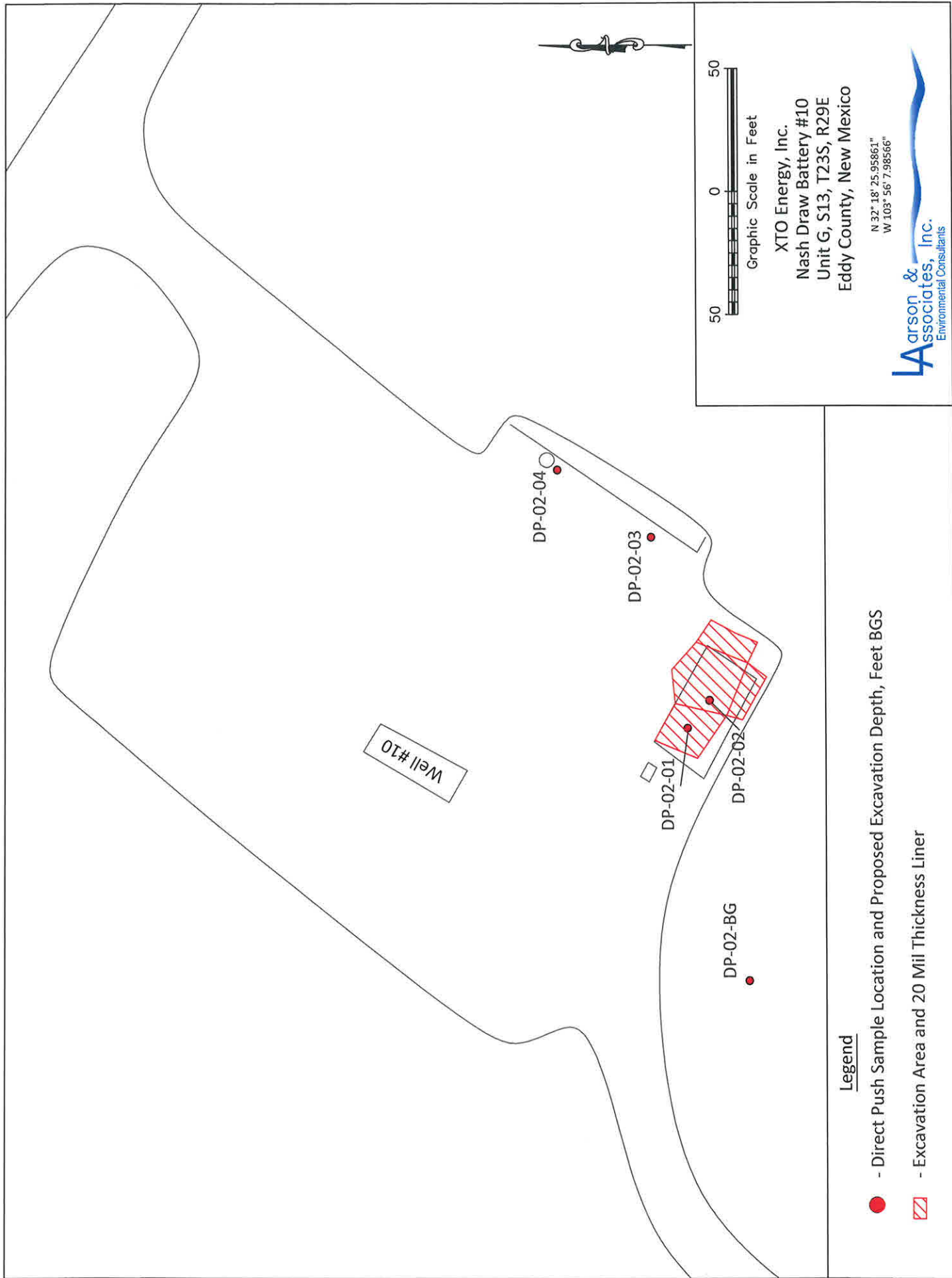

Figure 3 - Site Map Showing Excavation and Sample Locations

## **Appendix A**

### **Remediation Plan Approval**



**From:** Patterson, Heather, EMNRD [Heather.Patterson@state.nm.us]  
**Sent:** Thursday, November 10, 2016 1:33 PM  
**To:** Mark Larson; Bratcher, Mike, EMNRD; Weaver, Crystal, EMNRD; hprice@blm.gov  
**Cc:** McMinn, Dudley; Williams, Luke  
**Subject:** RE: 2RP-3873, Remediation Plan, Nash Draw Tank Battery #10, November 2, 2016

RE: XTO \* Nash Draw Unit Battery #10 \* 30-015-26992 \* 2RP-3873

Mark,

Your remediation proposal for the above referenced release is approved.

OCD approval does not relieve the operator of liability should their operations fail to adequately investigate and remediate contamination that may pose a threat to ground water, surface water, human health or the environment. In addition, OCD approval does not relieve the operator of responsibility for compliance with any other federal, state, local laws and/or regulations.

If you have any questions or concerns, and for notification, please contact me.

Heather Patterson  
Environmental Specialist  
NMOCD District II  
Office (575)748-1283 ext.101  
Cell (575)703-0228

**From:** Mark Larson [<mailto:Mark@laenvironmental.com>]  
**Sent:** Monday, November 07, 2016 6:36 PM  
**To:** Patterson, Heather, EMNRD; Bratcher, Mike, EMNRD; Weaver, Crystal, EMNRD; [hprice@blm.gov](mailto:hprice@blm.gov)  
**Cc:** McMinn, Dudley; Williams, Luke  
**Subject:** Re: 2RP-3873, Remediation Plan, Nash Draw Tank Battery #10, November 2, 2016

All,

Please find attached remediation plan for the Nash Draw Tank Battery #10. The plan was revised to include BTEX in excavation samples, where applicable, and the laboratory report for soil samples collected on September 28, 2016. Remediation will commence on Tuesday, November 8, 2016, per our verbal discussion and approval yesterday. Please contact Dudley McMinn with XTO at (432) 682-8873 or me if you have questions.

Respectfully,

Mark J. Larson, P.G.  
President/Sr. Project Manager  
507 N. Marienfeld St., Suite 205  
Midland, Texas 79701  
Office – 432-687-0901  
Cell – 432- 556-8656  
Fax – 432-687-0456  
[mark@laenvironmental.com](mailto:mark@laenvironmental.com)

## **Appendix B**

### **Laboratory Reports**

**PERMIAN BASIN  
ENVIRONMENTAL LAB, LP  
1400 Rankin Hwy  
Midland, TX 79701**



## Analytical Report

**Prepared for:**

Mark Larson  
Larson & Associates, Inc.  
P.O. Box 50685  
Midland, TX 79710

Project: Nash Draw Battery #10  
Project Number: 16-0108-02  
Location: Eddy Co, NM  
Lab Order Number: 6K14001



NELAP/TCEQ # T104704156-13-3

Report Date: 11/15/16

Larson & Associates, Inc.  
P.O. Box 50685  
Midland TX, 79710

Project: Nash Draw Battery #10  
Project Number: 16-0108-02  
Project Manager: Mark Larson

Fax: (432) 687-0456

#### ANALYTICAL REPORT FOR SAMPLES

Sample ID	Laboratory ID	Matrix	Date Sampled	Date Received
DP-02-02, N4	6K14001-01	Soil	11/11/16 10:45	11-11-2016 16:00
DP-02-02, N12	6K14001-02	Soil	11/11/16 10:55	11-11-2016 16:00
DP-02-02, N16	6K14001-03	Soil	11/11/16 11:00	11-11-2016 16:00
DP-02-02, E4	6K14001-04	Soil	11/11/16 10:29	11-11-2016 16:00
DP-02-02, E12	6K14001-05	Soil	11/11/16 10:30	11-11-2016 16:00
DP-02-02, E16	6K14001-06	Soil	11/11/16 10:35	11-11-2016 16:00
DP-02-02, S4	6K14001-07	Soil	11/11/16 10:10	11-11-2016 16:00
DP-02-02, S12	6K14001-08	Soil	11/11/16 10:14	11-11-2016 16:00
DP-02-02, S16	6K14001-09	Soil	11/11/16 10:25	11-11-2016 16:00
DP-02-02, W4	6K14001-10	Soil	11/11/16 09:35	11-11-2016 16:00
DP-02-02, W12	6K14001-11	Soil	11/11/16 09:46	11-11-2016 16:00
DP-02-02, W16	6K14001-12	Soil	11/11/16 10:00	11-11-2016 16:00



Larson & Associates, Inc.  
P.O. Box 50685  
Midland TX, 79710

Project: Nash Draw Battery #10  
Project Number: 16-0108-02  
Project Manager: Mark Larson

Fax: (432) 687-0456

**DP-02-02, N4**  
**6K14001-01 (Soil)**

Analyte	Result	Reporting Limit	Units	Dilution	Batch	Prepared	Analyzed	Method	Notes
---------	--------	--------------------	-------	----------	-------	----------	----------	--------	-------

**Permian Basin Environmental Lab, L.P.**

**Organics by GC**

Benzene	ND	0.00118	mg/kg dry	1	P6K1401	11/14/16	11/14/16	EPA 8021B	
Toluene	ND	0.00235	mg/kg dry	1	P6K1401	11/14/16	11/14/16	EPA 8021B	
Ethylbenzene	ND	0.00118	mg/kg dry	1	P6K1401	11/14/16	11/14/16	EPA 8021B	
Xylene (p/m)	ND	0.00235	mg/kg dry	1	P6K1401	11/14/16	11/14/16	EPA 8021B	
Xylene (o)	ND	0.00118	mg/kg dry	1	P6K1401	11/14/16	11/14/16	EPA 8021B	
Surrogate: 4-Bromofluorobenzene		76.0 %	75-125		P6K1401	11/14/16	11/14/16	EPA 8021B	
Surrogate: 1,4-Difluorobenzene		78.5 %	75-125		P6K1401	11/14/16	11/14/16	EPA 8021B	

**General Chemistry Parameters by EPA / Standard Methods**

% Moisture	15.0	0.1	%	1	P6K1505	11/15/16	11/15/16	% calculation	
------------	------	-----	---	---	---------	----------	----------	---------------	--

**Total Petroleum Hydrocarbons C6-C35 by EPA Method 8015M**

C6-C12	ND	29.4	mg/kg dry	1	P6K1503	11/14/16	11/14/16	TPH 8015M	
>C12-C28	ND	29.4	mg/kg dry	1	P6K1503	11/14/16	11/14/16	TPH 8015M	
>C28-C35	ND	29.4	mg/kg dry	1	P6K1503	11/14/16	11/14/16	TPH 8015M	
Surrogate: 1-Chlorooctane		79.7 %	70-130		P6K1503	11/14/16	11/14/16	TPH 8015M	
Surrogate: o-Terphenyl		92.0 %	70-130		P6K1503	11/14/16	11/14/16	TPH 8015M	
Total Petroleum Hydrocarbon C6-C35	ND	29.4	mg/kg dry	1	[CALC]	11/14/16	11/14/16	calc	

Larson & Associates, Inc.  
P.O. Box 50685  
Midland TX, 79710

Project: Nash Draw Battery #10  
Project Number: 16-0108-02  
Project Manager: Mark Larson

Fax: (432) 687-0456

**DP-02-02, N12**  
**6K14001-02 (Soil)**

Analyte	Result	Reporting Limit	Units	Dilution	Batch	Prepared	Analyzed	Method	Notes
---------	--------	--------------------	-------	----------	-------	----------	----------	--------	-------

**Permian Basin Environmental Lab, L.P.**

**Organics by GC**

Benzene	ND	0.00106	mg/kg dry	1	P6K1401	11/14/16	11/14/16	EPA 8021B	
Toluene	ND	0.00213	mg/kg dry	1	P6K1401	11/14/16	11/14/16	EPA 8021B	
Ethylbenzene	ND	0.00106	mg/kg dry	1	P6K1401	11/14/16	11/14/16	EPA 8021B	
Xylene (p/m)	ND	0.00213	mg/kg dry	1	P6K1401	11/14/16	11/14/16	EPA 8021B	
Xylene (o)	ND	0.00106	mg/kg dry	1	P6K1401	11/14/16	11/14/16	EPA 8021B	
Surrogate: 1,4-Difluorobenzene		76.2 %	75-125		P6K1401	11/14/16	11/14/16	EPA 8021B	
Surrogate: 4-Bromofluorobenzene		83.1 %	75-125		P6K1401	11/14/16	11/14/16	EPA 8021B	

**General Chemistry Parameters by EPA / Standard Methods**

% Moisture	6.0	0.1	%	1	P6K1505	11/15/16	11/15/16	% calculation	
------------	-----	-----	---	---	---------	----------	----------	---------------	--

**Total Petroleum Hydrocarbons C6-C35 by EPA Method 8015M**

C6-C12	53.3	26.6	mg/kg dry	1	P6K1503	11/14/16	11/14/16	TPH 8015M	
>C12-C28	338	26.6	mg/kg dry	1	P6K1503	11/14/16	11/14/16	TPH 8015M	
>C28-C35	34.4	26.6	mg/kg dry	1	P6K1503	11/14/16	11/14/16	TPH 8015M	
Surrogate: 1-Chlorooctane		76.0 %	70-130		P6K1503	11/14/16	11/14/16	TPH 8015M	
Surrogate: o-Terphenyl		89.8 %	70-130		P6K1503	11/14/16	11/14/16	TPH 8015M	
Total Petroleum Hydrocarbon C6-C35	425	26.6	mg/kg dry	1	[CALC]	11/14/16	11/14/16	calc	

Larson & Associates, Inc.  
P.O. Box 50685  
Midland TX, 79710

Project: Nash Draw Battery #10  
Project Number: 16-0108-02  
Project Manager: Mark Larson

Fax: (432) 687-0456

**DP-02-02, N16**  
**6K14001-03 (Soil)**

Analyte	Result	Reporting Limit	Units	Dilution	Batch	Prepared	Analyzed	Method	Notes
---------	--------	--------------------	-------	----------	-------	----------	----------	--------	-------

**Permian Basin Environmental Lab, L.P.**

**Organics by GC**

Benzene	ND	0.00108	mg/kg dry	1	P6K1401	11/14/16	11/14/16	EPA 8021B	
Toluene	ND	0.00215	mg/kg dry	1	P6K1401	11/14/16	11/14/16	EPA 8021B	
Ethylbenzene	0.0141	0.00108	mg/kg dry	1	P6K1401	11/14/16	11/14/16	EPA 8021B	
Xylene (p/m)	0.0175	0.00215	mg/kg dry	1	P6K1401	11/14/16	11/14/16	EPA 8021B	
Xylene (o)	0.00377	0.00108	mg/kg dry	1	P6K1401	11/14/16	11/14/16	EPA 8021B	
Surrogate: 4-Bromofluorobenzene		96.7 %	75-125		P6K1401	11/14/16	11/14/16	EPA 8021B	
Surrogate: 1,4-Difluorobenzene		75.5 %	75-125		P6K1401	11/14/16	11/14/16	EPA 8021B	

**General Chemistry Parameters by EPA / Standard Methods**

% Moisture	7.0	0.1	%	1	P6K1505	11/15/16	11/15/16	% calculation	
------------	-----	-----	---	---	---------	----------	----------	---------------	--

**Total Petroleum Hydrocarbons C6-C35 by EPA Method 8015M**

C6-C12	201	26.9	mg/kg dry	1	P6K1503	11/14/16	11/15/16	TPH 8015M	
>C12-C28	647	26.9	mg/kg dry	1	P6K1503	11/14/16	11/15/16	TPH 8015M	
>C28-C35	92.5	26.9	mg/kg dry	1	P6K1503	11/14/16	11/15/16	TPH 8015M	
Surrogate: 1-Chlorooctane		86.5 %	70-130		P6K1503	11/14/16	11/15/16	TPH 8015M	
Surrogate: o-Terphenyl		99.2 %	70-130		P6K1503	11/14/16	11/15/16	TPH 8015M	
Total Petroleum Hydrocarbon C6-C35	940	26.9	mg/kg dry	1	[CALC]	11/14/16	11/15/16	calc	

Larson & Associates, Inc.  
P.O. Box 50685  
Midland TX, 79710

Project: Nash Draw Battery #10  
Project Number: 16-0108-02  
Project Manager: Mark Larson

Fax: (432) 687-0456

**DP-02-02, E4**  
**6K14001-04 (Soil)**

Analyte	Result	Reporting Limit	Units	Dilution	Batch	Prepared	Analyzed	Method	Notes
Permian Basin Environmental Lab, L.P.									
<b>Organics by GC</b>									
Benzene	ND	0.00111	mg/kg dry	1	P6K1401	11/14/16	11/14/16	EPA 8021B	
Toluene	ND	0.00222	mg/kg dry	1	P6K1401	11/14/16	11/14/16	EPA 8021B	
Ethylbenzene	0.0130	0.00111	mg/kg dry	1	P6K1401	11/14/16	11/14/16	EPA 8021B	
Xylene (p/m)	0.0164	0.00222	mg/kg dry	1	P6K1401	11/14/16	11/14/16	EPA 8021B	
Xylene (o)	0.00304	0.00111	mg/kg dry	1	P6K1401	11/14/16	11/14/16	EPA 8021B	
Surrogate: 1,4-Difluorobenzene		70.6 %	75-125		P6K1401	11/14/16	11/14/16	EPA 8021B	S-GC
Surrogate: 4-Bromofluorobenzene		90.7 %	75-125		P6K1401	11/14/16	11/14/16	EPA 8021B	
<b>General Chemistry Parameters by EPA / Standard Methods</b>									
% Moisture	10.0	0.1	%	1	P6K1505	11/15/16	11/15/16	% calculation	
<b>Total Petroleum Hydrocarbons C6-C35 by EPA Method 8015M</b>									
C6-C12	382	27.8	mg/kg dry	1	P6K1503	11/14/16	11/14/16	TPH 8015M	
>C12-C28	3330	27.8	mg/kg dry	1	P6K1503	11/14/16	11/14/16	TPH 8015M	
>C28-C35	439	27.8	mg/kg dry	1	P6K1503	11/14/16	11/14/16	TPH 8015M	
Surrogate: 1-Chlorooctane		68.3 %	70-130		P6K1503	11/14/16	11/14/16	TPH 8015M	S-GC
Surrogate: o-Terphenyl		72.6 %	70-130		P6K1503	11/14/16	11/14/16	TPH 8015M	
Total Petroleum Hydrocarbon C6-C35	4150	27.8	mg/kg dry	1	[CALC]	11/14/16	11/14/16	calc	

Larson & Associates, Inc.  
P.O. Box 50685  
Midland TX, 79710

Project: Nash Draw Battery #10  
Project Number: 16-0108-02  
Project Manager: Mark Larson

Fax: (432) 687-0456

**DP-02-02, E12**  
**6K14001-05 (Soil)**

Analyte	Result	Reporting Limit	Units	Dilution	Batch	Prepared	Analyzed	Method	Notes
---------	--------	--------------------	-------	----------	-------	----------	----------	--------	-------

**Permian Basin Environmental Lab, L.P.**

**Organics by GC**

Benzene	ND	0.00111	mg/kg dry	1	P6K1401	11/14/16	11/14/16	EPA 8021B	
Toluene	ND	0.00222	mg/kg dry	1	P6K1401	11/14/16	11/14/16	EPA 8021B	
Ethylbenzene	ND	0.00111	mg/kg dry	1	P6K1401	11/14/16	11/14/16	EPA 8021B	
Xylene (p/m)	ND	0.00222	mg/kg dry	1	P6K1401	11/14/16	11/14/16	EPA 8021B	
Xylene (o)	ND	0.00111	mg/kg dry	1	P6K1401	11/14/16	11/14/16	EPA 8021B	
Surrogate: 4-Bromofluorobenzene		79.7 %	75-125		P6K1401	11/14/16	11/14/16	EPA 8021B	
Surrogate: 1,4-Difluorobenzene		70.6 %	75-125		P6K1401	11/14/16	11/14/16	EPA 8021B	S-GC

**General Chemistry Parameters by EPA / Standard Methods**

% Moisture	10.0	0.1	%	1	P6K1505	11/15/16	11/15/16	% calculation	
<b>Total Petroleum Hydrocarbons C6-C35 by EPA Method 8015M</b>									
C6-C12	ND	27.8	mg/kg dry	1	P6K1504	11/14/16	11/15/16	TPH 8015M	
>C12-C28	ND	27.8	mg/kg dry	1	P6K1504	11/14/16	11/15/16	TPH 8015M	
>C28-C35	ND	27.8	mg/kg dry	1	P6K1504	11/14/16	11/15/16	TPH 8015M	
Surrogate: 1-Chlorooctane		67.1 %	70-130		P6K1504	11/14/16	11/15/16	TPH 8015M	S-GC
Surrogate: o-Terphenyl		78.6 %	70-130		P6K1504	11/14/16	11/15/16	TPH 8015M	
Total Petroleum Hydrocarbon C6-C35	ND	27.8	mg/kg dry	1	[CALC]	11/14/16	11/15/16	calc	

Larson & Associates, Inc.  
P.O. Box 50685  
Midland TX, 79710

Project: Nash Draw Battery #10  
Project Number: 16-0108-02  
Project Manager: Mark Larson

Fax: (432) 687-0456

**DP-02-02, E16**  
**6K14001-06 (Soil)**

Analyte	Result	Reporting Limit	Units	Dilution	Batch	Prepared	Analyzed	Method	Notes
---------	--------	--------------------	-------	----------	-------	----------	----------	--------	-------

**Permian Basin Environmental Lab, L.P.**

**Organics by GC**

Benzene	ND	0.00109	mg/kg dry	1	P6K1401	11/14/16	11/14/16	EPA 8021B	
Toluene	ND	0.00217	mg/kg dry	1	P6K1401	11/14/16	11/14/16	EPA 8021B	
Ethylbenzene	ND	0.00109	mg/kg dry	1	P6K1401	11/14/16	11/14/16	EPA 8021B	
Xylene (p/m)	ND	0.00217	mg/kg dry	1	P6K1401	11/14/16	11/14/16	EPA 8021B	
Xylene (o)	ND	0.00109	mg/kg dry	1	P6K1401	11/14/16	11/14/16	EPA 8021B	
Surrogate: 4-Bromofluorobenzene		77.8 %	75-125		P6K1401	11/14/16	11/14/16	EPA 8021B	
Surrogate: 1,4-Difluorobenzene		72.0 %	75-125		P6K1401	11/14/16	11/14/16	EPA 8021B	S-GC

**General Chemistry Parameters by EPA / Standard Methods**

% Moisture	8.0	0.1	%	1	P6K1505	11/15/16	11/15/16	% calculation	
<b>Total Petroleum Hydrocarbons C6-C35 by EPA Method 8015M</b>									
C6-C12	ND	27.2	mg/kg dry	1	P6K1504	11/14/16	11/15/16	TPH 8015M	
>C12-C28	ND	27.2	mg/kg dry	1	P6K1504	11/14/16	11/15/16	TPH 8015M	
>C28-C35	ND	27.2	mg/kg dry	1	P6K1504	11/14/16	11/15/16	TPH 8015M	
Surrogate: 1-Chlorooctane		67.0 %	70-130		P6K1504	11/14/16	11/15/16	TPH 8015M	S-GC
Surrogate: o-Terphenyl		80.4 %	70-130		P6K1504	11/14/16	11/15/16	TPH 8015M	
Total Petroleum Hydrocarbon C6-C35	ND	27.2	mg/kg dry	1	[CALC]	11/14/16	11/15/16	calc	

Larson & Associates, Inc.  
P.O. Box 50685  
Midland TX, 79710

Project: Nash Draw Battery #10  
Project Number: 16-0108-02  
Project Manager: Mark Larson

Fax: (432) 687-0456

**DP-02-02, S4**  
**6K14001-07 (Soil)**

Analyte	Result	Reporting Limit	Units	Dilution	Batch	Prepared	Analyzed	Method	Notes
---------	--------	--------------------	-------	----------	-------	----------	----------	--------	-------

**Permian Basin Environmental Lab, L.P.**

**Organics by GC**

Benzene	ND	0.00112	mg/kg dry	1	P6K1401	11/14/16	11/14/16	EPA 8021B	
Toluene	ND	0.00225	mg/kg dry	1	P6K1401	11/14/16	11/14/16	EPA 8021B	
Ethylbenzene	ND	0.00112	mg/kg dry	1	P6K1401	11/14/16	11/14/16	EPA 8021B	
Xylene (p/m)	ND	0.00225	mg/kg dry	1	P6K1401	11/14/16	11/14/16	EPA 8021B	
Xylene (o)	ND	0.00112	mg/kg dry	1	P6K1401	11/14/16	11/14/16	EPA 8021B	
Surrogate: 1,4-Difluorobenzene		70.0 %	75-125		P6K1401	11/14/16	11/14/16	EPA 8021B	S-GC
Surrogate: 4-Bromofluorobenzene		78.8 %	75-125		P6K1401	11/14/16	11/14/16	EPA 8021B	

**General Chemistry Parameters by EPA / Standard Methods**

% Moisture	11.0	0.1	%	1	P6K1505	11/15/16	11/15/16	% calculation	
------------	------	-----	---	---	---------	----------	----------	---------------	--

**Total Petroleum Hydrocarbons C6-C35 by EPA Method 8015M**

C6-C12	ND	28.1	mg/kg dry	1	P6K1504	11/14/16	11/15/16	TPH 8015M	
>C12-C28	ND	28.1	mg/kg dry	1	P6K1504	11/14/16	11/15/16	TPH 8015M	
>C28-C35	ND	28.1	mg/kg dry	1	P6K1504	11/14/16	11/15/16	TPH 8015M	
Surrogate: 1-Chlorooctane		70.8 %	70-130		P6K1504	11/14/16	11/15/16	TPH 8015M	
Surrogate: o-Terphenyl		84.3 %	70-130		P6K1504	11/14/16	11/15/16	TPH 8015M	
Total Petroleum Hydrocarbon C6-C35	ND	28.1	mg/kg dry	1	[CALC]	11/14/16	11/15/16	calc	

Larson & Associates, Inc.  
P.O. Box 50685  
Midland TX, 79710

Project: Nash Draw Battery #10  
Project Number: 16-0108-02  
Project Manager: Mark Larson

Fax: (432) 687-0456

**DP-02-02, S12**  
**6K14001-08 (Soil)**

Analyte	Result	Reporting Limit	Units	Dilution	Batch	Prepared	Analyzed	Method	Notes
---------	--------	--------------------	-------	----------	-------	----------	----------	--------	-------

**Permian Basin Environmental Lab, L.P.**

**Organics by GC**

Benzene	ND	0.00110	mg/kg dry	1	P6K1401	11/14/16	11/14/16	EPA 8021B	
Toluene	ND	0.00220	mg/kg dry	1	P6K1401	11/14/16	11/14/16	EPA 8021B	
Ethylbenzene	ND	0.00110	mg/kg dry	1	P6K1401	11/14/16	11/14/16	EPA 8021B	
Xylene (p/m)	ND	0.00220	mg/kg dry	1	P6K1401	11/14/16	11/14/16	EPA 8021B	
Xylene (o)	ND	0.00110	mg/kg dry	1	P6K1401	11/14/16	11/14/16	EPA 8021B	
Surrogate: 4-Bromofluorobenzene		80.1 %	75-125		P6K1401	11/14/16	11/14/16	EPA 8021B	
Surrogate: 1,4-Difluorobenzene		76.5 %	75-125		P6K1401	11/14/16	11/14/16	EPA 8021B	

**General Chemistry Parameters by EPA / Standard Methods**

% Moisture	9.0	0.1	%	1	P6K1505	11/15/16	11/15/16	% calculation	
<b>Total Petroleum Hydrocarbons C6-C35 by EPA Method 8015M</b>									
C6-C12	ND	27.5	mg/kg dry	1	P6K1504	11/14/16	11/15/16	TPH 8015M	
>C12-C28	ND	27.5	mg/kg dry	1	P6K1504	11/14/16	11/15/16	TPH 8015M	
>C28-C35	ND	27.5	mg/kg dry	1	P6K1504	11/14/16	11/15/16	TPH 8015M	
Surrogate: 1-Chlorooctane		66.5 %	70-130		P6K1504	11/14/16	11/15/16	TPH 8015M	S-GC
Surrogate: o-Terphenyl		79.4 %	70-130		P6K1504	11/14/16	11/15/16	TPH 8015M	
Total Petroleum Hydrocarbon C6-C35	ND	27.5	mg/kg dry	1	[CALC]	11/14/16	11/15/16	calc	



Larson & Associates, Inc.  
P.O. Box 50685  
Midland TX, 79710

Project: Nash Draw Battery #10  
Project Number: 16-0108-02  
Project Manager: Mark Larson

Fax: (432) 687-0456

**DP-02-02, S16**  
**6K14001-09 (Soil)**

Analyte	Result	Reporting Limit	Units	Dilution	Batch	Prepared	Analyzed	Method	Notes
---------	--------	--------------------	-------	----------	-------	----------	----------	--------	-------

**Permian Basin Environmental Lab, L.P.**

**Organics by GC**

Benzene	ND	0.00109	mg/kg dry	1	P6K1401	11/14/16	11/14/16	EPA 8021B	
Toluene	ND	0.00217	mg/kg dry	1	P6K1401	11/14/16	11/14/16	EPA 8021B	
Ethylbenzene	ND	0.00109	mg/kg dry	1	P6K1401	11/14/16	11/14/16	EPA 8021B	
Xylene (p/m)	ND	0.00217	mg/kg dry	1	P6K1401	11/14/16	11/14/16	EPA 8021B	
Xylene (o)	ND	0.00109	mg/kg dry	1	P6K1401	11/14/16	11/14/16	EPA 8021B	
Surrogate: 1,4-Difluorobenzene		75.6 %	75-125		P6K1401	11/14/16	11/14/16	EPA 8021B	
Surrogate: 4-Bromofluorobenzene		80.0 %	75-125		P6K1401	11/14/16	11/14/16	EPA 8021B	

**General Chemistry Parameters by EPA / Standard Methods**

% Moisture	8.0	0.1	%	1	P6K1505	11/15/16	11/15/16	% calculation	
<b>Total Petroleum Hydrocarbons C6-C35 by EPA Method 8015M</b>									
C6-C12	ND	27.2	mg/kg dry	1	P6K1504	11/14/16	11/15/16	TPH 8015M	
>C12-C28	ND	27.2	mg/kg dry	1	P6K1504	11/14/16	11/15/16	TPH 8015M	
>C28-C35	ND	27.2	mg/kg dry	1	P6K1504	11/14/16	11/15/16	TPH 8015M	
Surrogate: 1-Chlorooctane		61.5 %	70-130		P6K1504	11/14/16	11/15/16	TPH 8015M	S-GC
Surrogate: o-Terphenyl		75.9 %	70-130		P6K1504	11/14/16	11/15/16	TPH 8015M	
Total Petroleum Hydrocarbon C6-C35	ND	27.2	mg/kg dry	1	[CALC]	11/14/16	11/15/16	calc	

Larson & Associates, Inc.  
P.O. Box 50685  
Midland TX, 79710

Project: Nash Draw Battery #10  
Project Number: 16-0108-02  
Project Manager: Mark Larson

Fax: (432) 687-0456

**DP-02-02, W4**  
**6K14001-10 (Soil)**

Analyte	Result	Reporting Limit	Units	Dilution	Batch	Prepared	Analyzed	Method	Notes
---------	--------	--------------------	-------	----------	-------	----------	----------	--------	-------

**Permian Basin Environmental Lab, L.P.**

**Organics by GC**

Benzene	ND	0.00119	mg/kg dry	1	P6K1401	11/14/16	11/14/16	EPA 8021B	
Toluene	ND	0.00238	mg/kg dry	1	P6K1401	11/14/16	11/14/16	EPA 8021B	
Ethylbenzene	ND	0.00119	mg/kg dry	1	P6K1401	11/14/16	11/14/16	EPA 8021B	
Xylene (p/m)	ND	0.00238	mg/kg dry	1	P6K1401	11/14/16	11/14/16	EPA 8021B	
Xylene (o)	ND	0.00119	mg/kg dry	1	P6K1401	11/14/16	11/14/16	EPA 8021B	
Surrogate: 1,4-Difluorobenzene		80.9 %	75-125		P6K1401	11/14/16	11/14/16	EPA 8021B	
Surrogate: 4-Bromofluorobenzene		81.4 %	75-125		P6K1401	11/14/16	11/14/16	EPA 8021B	

**General Chemistry Parameters by EPA / Standard Methods**

% Moisture	16.0	0.1	%	1	P6K1505	11/15/16	11/15/16	% calculation	
<b>Total Petroleum Hydrocarbons C6-C35 by EPA Method 8015M</b>									
C6-C12	ND	29.8	mg/kg dry	1	P6K1504	11/14/16	11/15/16	TPH 8015M	
>C12-C28	ND	29.8	mg/kg dry	1	P6K1504	11/14/16	11/15/16	TPH 8015M	
>C28-C35	ND	29.8	mg/kg dry	1	P6K1504	11/14/16	11/15/16	TPH 8015M	
Surrogate: 1-Chlorooctane		64.6 %	70-130		P6K1504	11/14/16	11/15/16	TPH 8015M	S-GC
Surrogate: o-Terphenyl		79.9 %	70-130		P6K1504	11/14/16	11/15/16	TPH 8015M	
Total Petroleum Hydrocarbon C6-C35	ND	29.8	mg/kg dry	1	[CALC]	11/14/16	11/15/16	calc	

Larson & Associates, Inc.  
P.O. Box 50685  
Midland TX, 79710

Project: Nash Draw Battery #10  
Project Number: 16-0108-02  
Project Manager: Mark Larson

Fax: (432) 687-0456

**DP-02-02, W12**  
**6K14001-11 (Soil)**

Analyte	Result	Reporting Limit	Units	Dilution	Batch	Prepared	Analyzed	Method	Notes
---------	--------	--------------------	-------	----------	-------	----------	----------	--------	-------

**Permian Basin Environmental Lab, L.P.**

**Organics by GC**

Benzene	ND	0.00109	mg/kg dry	1	P6K1401	11/14/16	11/14/16	EPA 8021B	
Toluene	ND	0.00217	mg/kg dry	1	P6K1401	11/14/16	11/14/16	EPA 8021B	
Ethylbenzene	ND	0.00109	mg/kg dry	1	P6K1401	11/14/16	11/14/16	EPA 8021B	
Xylene (p/m)	ND	0.00217	mg/kg dry	1	P6K1401	11/14/16	11/14/16	EPA 8021B	
Xylene (o)	ND	0.00109	mg/kg dry	1	P6K1401	11/14/16	11/14/16	EPA 8021B	
Surrogate: 4-Bromofluorobenzene		77.7 %	75-125		P6K1401	11/14/16	11/14/16	EPA 8021B	
Surrogate: 1,4-Difluorobenzene		76.1 %	75-125		P6K1401	11/14/16	11/14/16	EPA 8021B	

**General Chemistry Parameters by EPA / Standard Methods**

% Moisture	8.0	0.1	%	1	P6K1505	11/15/16	11/15/16	% calculation	
------------	-----	-----	---	---	---------	----------	----------	---------------	--

**Total Petroleum Hydrocarbons C6-C35 by EPA Method 8015M**

C6-C12	ND	27.2	mg/kg dry	1	P6K1504	11/14/16	11/15/16	TPH 8015M	
>C12-C28	ND	27.2	mg/kg dry	1	P6K1504	11/14/16	11/15/16	TPH 8015M	
>C28-C35	ND	27.2	mg/kg dry	1	P6K1504	11/14/16	11/15/16	TPH 8015M	
Surrogate: 1-Chlorooctane		58.6 %	70-130		P6K1504	11/14/16	11/15/16	TPH 8015M	S-GC
Surrogate: o-Terphenyl		73.5 %	70-130		P6K1504	11/14/16	11/15/16	TPH 8015M	
Total Petroleum Hydrocarbon C6-C35	ND	27.2	mg/kg dry	1	[CALC]	11/14/16	11/15/16	calc	

Larson & Associates, Inc.  
P.O. Box 50685  
Midland TX, 79710

Project: Nash Draw Battery #10  
Project Number: 16-0108-02  
Project Manager: Mark Larson

Fax: (432) 687-0456

**DP-02-02, W16**  
**6K14001-12 (Soil)**

Analyte	Result	Reporting Limit	Units	Dilution	Batch	Prepared	Analyzed	Method	Notes
---------	--------	--------------------	-------	----------	-------	----------	----------	--------	-------

**Permian Basin Environmental Lab, L.P.**

**Organics by GC**

Benzene	ND	0.00108	mg/kg dry	1	P6K1401	11/14/16	11/14/16	EPA 8021B	
Toluene	ND	0.00215	mg/kg dry	1	P6K1401	11/14/16	11/14/16	EPA 8021B	
Ethylbenzene	ND	0.00108	mg/kg dry	1	P6K1401	11/14/16	11/14/16	EPA 8021B	
Xylene (p/m)	ND	0.00215	mg/kg dry	1	P6K1401	11/14/16	11/14/16	EPA 8021B	
Xylene (o)	ND	0.00108	mg/kg dry	1	P6K1401	11/14/16	11/14/16	EPA 8021B	
Surrogate: 1,4-Difluorobenzene		81.5 %	75-125		P6K1401	11/14/16	11/14/16	EPA 8021B	
Surrogate: 4-Bromofluorobenzene		79.5 %	75-125		P6K1401	11/14/16	11/14/16	EPA 8021B	

**General Chemistry Parameters by EPA / Standard Methods**

% Moisture	7.0	0.1	%	1	P6K1505	11/15/16	11/15/16	% calculation	
------------	-----	-----	---	---	---------	----------	----------	---------------	--

**Total Petroleum Hydrocarbons C6-C35 by EPA Method 8015M**

C6-C12	ND	26.9	mg/kg dry	1	P6K1504	11/14/16	11/15/16	TPH 8015M	
>C12-C28	ND	26.9	mg/kg dry	1	P6K1504	11/14/16	11/15/16	TPH 8015M	
>C28-C35	ND	26.9	mg/kg dry	1	P6K1504	11/14/16	11/15/16	TPH 8015M	
Surrogate: 1-Chlorooctane		61.5 %	70-130		P6K1504	11/14/16	11/15/16	TPH 8015M	S-GC
Surrogate: o-Terphenyl		77.1 %	70-130		P6K1504	11/14/16	11/15/16	TPH 8015M	
Total Petroleum Hydrocarbon C6-C35	ND	26.9	mg/kg dry	1	[CALC]	11/14/16	11/15/16	calc	

Larson & Associates, Inc.  
P.O. Box 50685  
Midland TX, 79710

Project: Nash Draw Battery #10  
Project Number: 16-0108-02  
Project Manager: Mark Larson

Fax: (432) 687-0456

**Organics by GC - Quality Control**  
**Permian Basin Environmental Lab, L.P.**

Analyte	Result	Reporting Limit	Units	Spike Level	Source Result	%REC	%REC Limits	RPD	RPD Limit	Notes
---------	--------	-----------------	-------	-------------	---------------	------	-------------	-----	-----------	-------

**Batch P6K1401 - General Preparation (GC)**

**Blank (P6K1401-BLK1)**

Prepared & Analyzed: 11/14/16

Benzene	ND	0.00100	mg/kg wet							
Toluene	ND	0.00200	"							
Ethylbenzene	ND	0.00100	"							
Xylene (p/m)	ND	0.00200	"							
Xylene (o)	ND	0.00100	"							
Surrogate: 1,4-Difluorobenzene	0.0567		"	0.0800		70.9	75-125			S-GC
Surrogate: 4-Bromofluorobenzene	0.0619		"	0.0800		77.4	75-125			

**LCS (P6K1401-BS1)**

Prepared & Analyzed: 11/14/16

Benzene	0.0868	0.00100	mg/kg wet	0.100		86.8	70-130			
Toluene	0.0915	0.00200	"	0.100		91.5	70-130			
Ethylbenzene	0.104	0.00100	"	0.100		104	70-130			
Xylene (p/m)	0.191	0.00200	"	0.200		95.5	70-130			
Xylene (o)	0.0940	0.00100	"	0.100		94.0	70-130			
Surrogate: 1,4-Difluorobenzene	0.0606		"	0.0800		75.7	75-125			
Surrogate: 4-Bromofluorobenzene	0.0635		"	0.0800		79.4	75-125			

**LCS Dup (P6K1401-BSD1)**

Prepared & Analyzed: 11/14/16

Benzene	0.0861	0.00100	mg/kg wet	0.100		86.1	70-130	0.879	20	
Toluene	0.0927	0.00200	"	0.100		92.7	70-130	1.33	20	
Ethylbenzene	0.109	0.00100	"	0.100		109	70-130	4.75	20	
Xylene (p/m)	0.194	0.00200	"	0.200		96.9	70-130	1.48	20	
Xylene (o)	0.0963	0.00100	"	0.100		96.3	70-130	2.48	20	
Surrogate: 1,4-Difluorobenzene	0.0610		"	0.0800		76.3	75-125			
Surrogate: 4-Bromofluorobenzene	0.0660		"	0.0800		82.5	75-125			

**Matrix Spike (P6K1401-MS1)**

Source: 6K14001-01

Prepared & Analyzed: 11/14/16

Benzene	0.140	0.00118	mg/kg dry	0.235	ND	59.4	80-120			QM-07
Toluene	0.149	0.00235	"	0.235	ND	63.2	80-120			QM-07
Ethylbenzene	0.153	0.00118	"	0.235	ND	64.8	80-120			QM-07
Xylene (p/m)	0.292	0.00235	"	0.471	ND	62.1	80-120			QM-07
Xylene (o)	0.151	0.00118	"	0.235	ND	64.0	80-120			QM-07
Surrogate: 4-Bromofluorobenzene	0.0774		"	0.0941		82.2	75-125			
Surrogate: 1,4-Difluorobenzene	0.0725		"	0.0941		77.0	75-125			

Permian Basin Environmental Lab, L.P.

*The results in this report apply to the samples analyzed in accordance with the samples received in the laboratory. This analytical report must be reproduced in its entirety, with written approval of Permian Basin Environmental Lab.*

1400 Rankin HWY Midland, TX 79701 432-686-7235

Page 15 of 22

Larson & Associates, Inc.  
P.O. Box 50685  
Midland TX, 79710

Project: Nash Draw Battery #10  
Project Number: 16-0108-02  
Project Manager: Mark Larson

Fax: (432) 687-0456

**Organics by GC - Quality Control**  
**Permian Basin Environmental Lab, L.P.**

Analyte	Result	Reporting Limit	Units	Spike Level	Source Result	%REC	%REC Limits	RPD	RPD Limit	Notes
---------	--------	--------------------	-------	----------------	------------------	------	----------------	-----	--------------	-------

**Batch P6K1401 - General Preparation (GC)**

Matrix Spike Dup (P6K1401-MSD1)	Source: 6K14001-01			Prepared & Analyzed: 11/14/16						
Benzene	0.149	0.00118	mg/kg dry	0.235	ND	63.1	80-120	6.16	20	QM-07
Toluene	0.154	0.00235	"	0.235	ND	65.6	80-120	3.76	20	QM-07
Ethylbenzene	0.163	0.00118	"	0.235	ND	69.4	80-120	6.74	20	QM-07
Xylene (p/m)	0.307	0.00235	"	0.471	ND	65.2	80-120	4.94	20	QM-07
Xylene (o)	0.161	0.00118	"	0.235	ND	68.3	80-120	6.50	20	QM-07
Surrogate: 4-Bromofluorobenzene	0.0799		"	0.0941		84.9	75-125			
Surrogate: 1,4-Difluorobenzene	0.0762		"	0.0941		81.0	75-125			

Larson & Associates, Inc.  
P.O. Box 50685  
Midland TX, 79710

Project: Nash Draw Battery #10  
Project Number: 16-0108-02  
Project Manager: Mark Larson

Fax: (432) 687-0456

**General Chemistry Parameters by EPA / Standard Methods - Quality Control**  
**Permian Basin Environmental Lab, L.P.**

Analyte	Result	Reporting Limit	Units	Spike Level	Source Result	%REC	%REC Limits	RPD	RPD Limit	Notes
---------	--------	--------------------	-------	----------------	------------------	------	----------------	-----	--------------	-------

**Batch P6K1505 - \*\*\* DEFAULT PREP \*\*\***

**Blank (P6K1505-BLK1)**

Prepared & Analyzed: 11/15/16

% Moisture ND 0.1 %

**Duplicate (P6K1505-DUP1)**

Source: 6K14002-12

Prepared & Analyzed: 11/15/16

% Moisture 11.0 0.1 % 10.0 9.52 20

Larson & Associates, Inc.  
P.O. Box 50685  
Midland TX, 79710

Project: Nash Draw Battery #10  
Project Number: 16-0108-02  
Project Manager: Mark Larson

Fax: (432) 687-0456

**Total Petroleum Hydrocarbons C6-C35 by EPA Method 8015M - Quality Control**  
**Permian Basin Environmental Lab, L.P.**

Analyte	Result	Reporting Limit	Units	Spike Level	Source Result	%REC	%REC Limits	RPD	RPD Limit	Notes
---------	--------	-----------------	-------	-------------	---------------	------	-------------	-----	-----------	-------

**Batch P6K1503 - TX 1005**

**Blank (P6K1503-BLK1)**

Prepared & Analyzed: 11/14/16

C6-C12	ND	25.0	mg/kg wet							
>C12-C28	ND	25.0	"							
>C28-C35	ND	25.0	"							
Surrogate: 1-Chlorooctane	105		"	100		105	70-130			
Surrogate: o-Terphenyl	62.1		"	50.0		124	70-130			

**LCS (P6K1503-BS1)**

Prepared & Analyzed: 11/14/16

C6-C12	1030	25.0	mg/kg wet	1000		103	75-125			
>C12-C28	975	25.0	"	1000		97.5	75-125			
Surrogate: 1-Chlorooctane	119		"	100		119	70-130			
Surrogate: o-Terphenyl	60.1		"	50.0		120	70-130			

**LCS Dup (P6K1503-BSD1)**

Prepared & Analyzed: 11/14/16

C6-C12	1020	25.0	mg/kg wet	1000		102	75-125	1.51	20	
>C12-C28	971	25.0	"	1000		97.1	75-125	0.429	20	
Surrogate: 1-Chlorooctane	122		"	100		122	70-130			
Surrogate: o-Terphenyl	61.5		"	50.0		123	70-130			

**Matrix Spike (P6K1503-MS1)**

Source: 6K11008-12

Prepared & Analyzed: 11/14/16

C6-C12	820	27.2	mg/kg dry	1090	ND	75.4	75-125			
>C12-C28	885	27.2	"	1090	19.6	79.6	75-125			
Surrogate: 1-Chlorooctane	88.9		"	109		81.8	70-130			
Surrogate: o-Terphenyl	40.5		"	54.3		74.6	70-130			

**Matrix Spike Dup (P6K1503-MSD1)**

Source: 6K11008-12

Prepared: 11/14/16 Analyzed: 11/15/16

C6-C12	1170	27.2	mg/kg dry	1090	ND	107	75-125	34.9	20	R
>C12-C28	1170	27.2	"	1090	19.6	106	75-125	28.2	20	R
Surrogate: 1-Chlorooctane	120		"	109		110	70-130			
Surrogate: o-Terphenyl	56.1		"	54.3		103	70-130			

Permian Basin Environmental Lab, L.P.

The results in this report apply to the samples analyzed in accordance with the samples received in the laboratory. This analytical report must be reproduced in its entirety, with written approval of Permian Basin Environmental Lab.

1400 Rankin HWY Midland, TX 79701 432-686-7235



Larson & Associates, Inc.  
P.O. Box 50685  
Midland TX, 79710

Project: Nash Draw Battery #10  
Project Number: 16-0108-02  
Project Manager: Mark Larson

Fax: (432) 687-0456

## Total Petroleum Hydrocarbons C6-C35 by EPA Method 8015M - Quality Control

### Permian Basin Environmental Lab, L.P.

Analyte	Result	Reporting Limit	Units	Spike Level	Source Result	%REC	%REC Limits	RPD	RPD Limit	Notes
---------	--------	-----------------	-------	-------------	---------------	------	-------------	-----	-----------	-------

#### Batch P6K1504 - TX 1005

##### Blank (P6K1504-BLK1)

Prepared: 11/14/16 Analyzed: 11/15/16

C6-C12	ND	25.0	mg/kg wet							
>C12-C28	ND	25.0	"							
>C28-C35	ND	25.0	"							
Surrogate: 1-Chlorooctane	115		"	100		115	70-130			
Surrogate: o-Terphenyl	70.5		"	50.0		141	70-130			S-GC

##### LCS (P6K1504-BS1)

Prepared: 11/14/16 Analyzed: 11/15/16

C6-C12	1050	25.0	mg/kg wet	1000		105	75-125			
>C12-C28	1050	25.0	"	1000		105	75-125			
Surrogate: 1-Chlorooctane	122		"	100		122	70-130			
Surrogate: o-Terphenyl	64.4		"	50.0		129	70-130			

##### LCS Dup (P6K1504-BSD1)

Prepared: 11/14/16 Analyzed: 11/15/16

C6-C12	1070	25.0	mg/kg wet	1000		107	75-125	1.74	20	
>C12-C28	1040	25.0	"	1000		104	75-125	1.44	20	
Surrogate: 1-Chlorooctane	113		"	100		113	70-130			
Surrogate: o-Terphenyl	64.4		"	50.0		129	70-130			

##### Matrix Spike (P6K1504-MS1)

Source: 6K14002-09

Prepared: 11/14/16 Analyzed: 11/15/16

C6-C12	1030	26.6	mg/kg dry	1060	24.4	94.1	75-125			
>C12-C28	1040	26.6	"	1060	ND	98.0	75-125			
Surrogate: 1-Chlorooctane	111		"	106		104	70-130			
Surrogate: o-Terphenyl	51.8		"	53.2		97.4	70-130			

##### Matrix Spike Dup (P6K1504-MSD1)

Source: 6K14002-09

Prepared: 11/14/16 Analyzed: 11/15/16

C6-C12	1040	26.6	mg/kg dry	1060	24.4	95.5	75-125	1.44	20	
>C12-C28	1070	26.6	"	1060	ND	101	75-125	2.51	20	
Surrogate: 1-Chlorooctane	114		"	106		107	70-130			
Surrogate: o-Terphenyl	48.2		"	53.2		90.7	70-130			

Permian Basin Environmental Lab, L.P.

The results in this report apply to the samples analyzed in accordance with the samples received in the laboratory. This analytical report must be reproduced in its entirety, with written approval of Permian Basin Environmental Lab.

1400 Rankin HWY Midland, TX 79701 432-686-7235

Larson & Associates, Inc.  
P.O. Box 50685  
Midland TX, 79710

Project: Nash Draw Battery #10  
Project Number: 16-0108-02  
Project Manager: Mark Larson

Fax: (432) 687-0456

### Notes and Definitions

S-GC Surrogate recovery outside of control limits. The data was accepted based on valid recovery of the remaining surrogate.

R The RPD exceeded the method control limit. The individual analyte QA/QC recoveries, however, were within acceptance limits.

QM-07 The spike recovery was outside acceptance limits for the MS and/or MSD. The batch was accepted based on acceptable LCS recovery.

BULK Samples received in Bulk soil containers

DET Analyte DETECTED

ND Analyte NOT DETECTED at or above the reporting limit

NR Not Reported

dry Sample results reported on a dry weight basis

RPD Relative Percent Difference

LCS Laboratory Control Spike

MS Matrix Spike

Dup Duplicate

Report Approved By: \_\_\_\_\_

Date: 11/15/2016

Brent Barron, Laboratory Director/Technical Director

This material is intended only for the use of the individual (s) or entity to whom it is addressed, and may contain information that is privileged and confidential.

If you have received this material in error, please notify us immediately at 432-686-7235.

Permian Basin Environmental Lab, L.P.

*The results in this report apply to the samples analyzed in accordance with the samples received in the laboratory. This analytical report must be reproduced in its entirety, with written approval of Permian Basin Environmental Lab.*

1400 Rankin HWY Midland, TX 79701 432-686-7235

Larson & Associates, Inc.  
P.O. Box 50685  
Midland TX, 79710

Project: Nash Draw Battery #10  
Project Number: 16-0108-02  
Project Manager: Mark Larson

Fax: (432) 687-0456

CHAIN-OF-CUSTOMERS

Page 22 of 22

[illegible]

**PERMIAN BASIN  
ENVIRONMENTAL LAB, LP  
1400 Rankin Hwy  
Midland, TX 79701**



## Analytical Report

**Prepared for:**

Mark Larson  
Larson & Associates, Inc.  
P.O. Box 50685  
Midland, TX 79710

Project: Nash Draw Battery #10

Project Number: 16-0108-02

Location: NM

Lab Order Number: 6K22002



NELAP/TCEQ # T104704156-13-3

Report Date: 11/23/16

Larson & Associates, Inc.  
P.O. Box 50685  
Midland TX, 79710

Project: Nash Draw Battery #10  
Project Number: 16-0108-02  
Project Manager: Mark Larson

Fax: (432) 687-0456

### ANALYTICAL REPORT FOR SAMPLES

Sample ID	Laboratory ID	Matrix	Date Sampled	Date Received
DP-02-02-E4	6K22002-01	Soil	11/21/16 11:40	11-22-2016 09:06

Larson & Associates, Inc.  
P.O. Box 50685  
Midland TX, 79710

Project: Nash Draw Battery #10  
Project Number: 16-0108-02  
Project Manager: Mark Larson

Fax: (432) 687-0456

**DP-02-02-E4**  
**6K22002-01 (Soil)**

Analyte	Result	Reporting Limit	Units	Dilution	Batch	Prepared	Analyzed	Method	Notes
---------	--------	--------------------	-------	----------	-------	----------	----------	--------	-------

**Permian Basin Environmental Lab, L.P.**

**General Chemistry Parameters by EPA / Standard Methods**

% Moisture	13.0	0.1	%	1	P6K2301	11/23/16	11/23/16	% calculation
------------	------	-----	---	---	---------	----------	----------	---------------

**Total Petroleum Hydrocarbons C6-C35 by EPA Method 8015M**

C6-C12	ND	28.7	mg/kg dry	1	P6K2305	11/22/16	11/23/16	TPH 8015M
>C12-C28	ND	28.7	mg/kg dry	1	P6K2305	11/22/16	11/23/16	TPH 8015M
>C28-C35	ND	28.7	mg/kg dry	1	P6K2305	11/22/16	11/23/16	TPH 8015M
Surrogate: 1-Chlorooctane		70.6 %	70-130		P6K2305	11/22/16	11/23/16	TPH 8015M
Surrogate: o-Terphenyl		84.9 %	70-130		P6K2305	11/22/16	11/23/16	TPH 8015M
Total Petroleum Hydrocarbon C6-C35	ND	28.7	mg/kg dry	1	[CALC]	11/22/16	11/23/16	calc

Larson & Associates, Inc.  
P.O. Box 50685  
Midland TX, 79710

Project: Nash Draw Battery #10  
Project Number: 16-0108-02  
Project Manager: Mark Larson

Fax: (432) 687-0456

**General Chemistry Parameters by EPA / Standard Methods - Quality Control**  
**Permian Basin Environmental Lab, L.P.**

Analyte	Result	Reporting Limit	Units	Spike Level	Source Result	%REC	%REC Limits	RPD	RPD Limit	Notes
---------	--------	--------------------	-------	----------------	------------------	------	----------------	-----	--------------	-------

**Batch P6K2301 - \*\*\* DEFAULT PREP \*\*\***

**Blank (P6K2301-BLK1)**

Prepared & Analyzed: 11/23/16

% Moisture ND 0.1 %

**Duplicate (P6K2301-DUP1)**

Source: 6K22001-05

Prepared & Analyzed: 11/23/16

% Moisture 11.0 0.1 % 12.0 8.70 20

**Duplicate (P6K2301-DUP2)**

Source: 6K22006-23

Prepared & Analyzed: 11/23/16

% Moisture 9.0 0.1 % 10.0 10.5 20



Larson & Associates, Inc.  
P.O. Box 50685  
Midland TX, 79710

Project: Nash Draw Battery #10  
Project Number: 16-0108-02  
Project Manager: Mark Larson

Fax: (432) 687-0456

**Total Petroleum Hydrocarbons C6-C35 by EPA Method 8015M - Quality Control**  
**Permian Basin Environmental Lab, L.P.**

Analyte	Result	Reporting Limit	Units	Spike Level	Source Result	%REC	%REC Limits	RPD	RPD Limit	Notes
---------	--------	--------------------	-------	----------------	------------------	------	----------------	-----	--------------	-------

**Batch P6K2305 - TX 1005**

**Blank (P6K2305-BLK1)**

Prepared: 11/22/16 Analyzed: 11/23/16

C6-C12	ND	25.0	mg/kg wet							
>C12-C28	ND	25.0	"							
>C28-C35	ND	25.0	"							
Surrogate: 1-Chlorooctane	88.9		"	100		88.9	70-130			
Surrogate: o-Terphenyl	53.9		"	50.0		108	70-130			

**LCS (P6K2305-BS1)**

Prepared: 11/22/16 Analyzed: 11/23/16

C6-C12	928	25.0	mg/kg wet	1000		92.8	75-125			
>C12-C28	1040	25.0	"	1000		104	75-125			
Surrogate: 1-Chlorooctane	116		"	100		116	70-130			
Surrogate: o-Terphenyl	58.4		"	50.0		117	70-130			

Larson & Associates, Inc.  
P.O. Box 50685  
Midland TX, 79710

Project: Nash Draw Battery #10  
Project Number: 16-0108-02  
Project Manager: Mark Larson

Fax: (432) 687-0456

### Notes and Definitions

BULK Samples received in Bulk soil containers  
DET Analyte DETECTED  
ND Analyte NOT DETECTED at or above the reporting limit  
NR Not Reported  
dry Sample results reported on a dry weight basis  
RPD Relative Percent Difference  
LCS Laboratory Control Spike  
MS Matrix Spike  
Dup Duplicate

Report Approved By:



Date:

11/23/2016

Brent Barron, Laboratory Director/Technical Director

This material is intended only for the use of the individual (s) or entity to whom it is addressed, and may contain information that is privileged and confidential.

If you have received this material in error, please notify us immediately at 432-686-7235.

CHAIN-OF-CUSTODY

507 N. Marientfeld, Ste. 200  
Midland, TX 79701  
432-687-0901

DATE: 11-22-16 PAGE 1 OF 1  
PO #: \_\_\_\_\_ LAB WORK ORDER #: \_\_\_\_\_  
PROJECT LOCATION OR NAME: X10 Nash Draw Battery 10  
LAI PROJECT #: 16-0108-02 COLLECTOR: Travis Williams

S=SOIL  
W=WATER  
A=AIR  
P=PAINT  
SL=SLUDGE  
OT=OTHER

[illegible]

Lab #	Date	Time
-------	------	------

11-21-16 11:40

5	1
---	---

[illegible]





--	--

ANALYSES	
BTEX <input type="checkbox"/>	MTBE <input type="checkbox"/>
TRPH 418.1 <input type="checkbox"/>	TPH 1005 <input type="checkbox"/> <input checked="" type="checkbox"/> TPH 1006 <input type="checkbox"/>
GASOLINE MOD 8015 <input type="checkbox"/>	<input checked="" type="checkbox"/>
DIESEL - MOD 8015 <input type="checkbox"/>	<input checked="" type="checkbox"/>
VOC 8260 <input type="checkbox"/>	
SVOC 8270 <input type="checkbox"/>	PAH 8270 <input type="checkbox"/> HOLDPAH <input type="checkbox"/>
8081 PESTICIDES <input type="checkbox"/>	8151 HERBICIDES <input type="checkbox"/>
8082 PCBs <input type="checkbox"/>	
TCLP - METALS (RCRA) <input type="checkbox"/>	TCLP VOC <input type="checkbox"/>
TCLP - PEST <input type="checkbox"/>	HERB <input type="checkbox"/> Semi-VOC <input type="checkbox"/>
TOTAL METALS (RCRA) <input type="checkbox"/>	OTHER LIST <input type="checkbox"/>
LEAD - TOTAL <input type="checkbox"/>	D.W. 200.8 <input type="checkbox"/> TCLP <input type="checkbox"/>
RO <input type="checkbox"/>	TOX <input type="checkbox"/> FLASHPOINT <input type="checkbox"/>
TDS <input type="checkbox"/>	% MOISTURE <input type="checkbox"/> CYANIDE <input type="checkbox"/>
pH <input type="checkbox"/>	HEXAVALENT CHROMIUM <input type="checkbox"/>
EXPLOSIVES <input type="checkbox"/>	PECHLORATE <input type="checkbox"/>
CHLORIDE <input type="checkbox"/>	ANIONS <input type="checkbox"/> ALKALINITY <input type="checkbox"/>
FIELD NOTES	

FIELD NOTES

RELINQUISHED BY:(Signature) DATE/TIME RECEIVED BY: (Signature)

DATE/TIME	DATE/TIME
11-22-16	

RECEIVED BY: (Signature)

DATE TIME 11 25

RECEIVED BY: (Signature)

9

1

---

1000

☒ HAND

DELIVER

D

100

Page 7 of 7

**Appendix C**  
**Photographs**



Location Sign



Location Viewing South Prior to Remediation, February 3, 2016





Location Viewing East Prior to Remediation, February 3, 2016



Initial Excavation at DP-02-02 and DP-02-01 Viewing West, November 11, 2016





Initial Excavation at DP-02-02 and DP-02-01 Viewing East, November 11, 2016



Expanded Excavation at DP-02-02 and DP-02-01 Viewing West, November 16, 2016





Bottom (17 feet) of Expanded Excavation at DP-02-02 Viewing South, November 16, 2016



Expanded Excavation at DP-02-02 and DP-02-01 Viewing East, November 16, 2016





Liner Installed in Excavation DP-02-02 (4 feet) Viewing East, November 28, 2016



Liner Installed in Excavation DP-02-02 (4 feet) Viewing North, November 28, 2016





Completed Remediation Viewing South, November 29, 2016



Completed Remediation Viewing East, November 29, 2016

**Appendix D**  
**Waste Manifests**



# LEA LAND DISPOSAL SITE NEW MEXICO

MILE MARKER #64 US HWY 62/180 • 30 MILES EAST OF CARLSBAD, NM • PHONE (575) 887-4048

## LEA LAND, LLC

1300 WEST MAIN STREET • OKLAHOMA CITY, OK 73106 • PHONE (405) 236-4257

### NON-HAZARDOUS WASTE MANIFEST

NO

116168

1. PAGE \_\_\_ OF \_\_\_

2. TRAILER NO. 122

G

3. COMPANY NAME

4. ADDRESS

5. PICK-UP DATE 1-27

PHONE NO.

CITY

STATE

ZIP

6. TNRCC I.D. NO.

E

7. NAME OR DESCRIPTION OF WASTE SHIPPED:

8. CONTAINERS  
No. Type

9. TOTAL  
QUANTITY

10. UNIT  
Wt/Vol.

11. TEXAS  
WASTE ID #

N

a.

b.

E

c.

R

d.

12. COMMENTS OR SPECIAL INSTRUCTIONS:

13. WASTE PROFILE NO.

A

14.

#### IN CASE OF EMERGENCY OR SPILL, CONTACT

NAME

PHONE NO

24-HOUR EMERGENCY NO.

T

O

15. **GENERATOR'S CERTIFICATION:** I Hereby declare that the contents of this consignment are fully and accurately described above by proper shipping name and are classified, packed, marked, and labeled, and are in all respects in proper condition for transport by highway according to applicable international and national government regulations, including applicable state regulations, and are the same materials previously approved by LEA LAND, LLC

R

PRINTED/TYPED NAME

SIGNATURE

DATE

T

R

16. **TRANSPORTER (1)**

NAME:

TEXAS I.D. NO.

IN CASE OF EMERGENCY CONTACT:

EMERGENCY PHONE:

18. **TRANSPORTER (1):** Acknowledgment of receipt of material

PRINTED/TYPED NAME

SIGNATURE

DATE

17. **TRANSPORTER (2)**

NAME:

TEXAS I.D. NO.

IN CASE OF EMERGENCY CONTACT:

EMERGENCY PHONE:

19. **TRANSPORTER (2):** Acknowledgment of receipt of material

PRINTED/TYPED NAME

SIGNATURE

DATE

D

F

I

S

C

P

I

O

L

S

I

A

T

L

Y

PERMIT NO.

WM-01-035 - New Mexico

ADDRESS:

Mile Marker 64, U.S. Hwy 62/180,  
30 Miles East of Carlsbad, NM

PHONE:

575-887-4048

21. **DISPOSAL FACILITY'S CERTIFICATION:** I Hereby certify that the above described wastes were delivered to this facility, that the facility is authorized and permitted to receive such wastes.

AUTHORIZED SIGNATURE

CELL NO.

DATE

TIME

GENERATOR: COPIES 1 & 6

DISPOSAL SITE: COPIES 2 & 3

TRANSPORTERS: COPIES 4 & 5

COPY 4



# LEA LAND DISPOSAL SITE NEW MEXICO

MILE MARKER #64 US HWY 62/180 • 30 MILES EAST OF CARLSBAD, NM • PHONE (575) 887-4048

## LEA LAND, LLC

1300 WEST MAIN STREET • OKLAHOMA CITY, OK 73106 • PHONE (405) 236-4257

### NON-HAZARDOUS WASTE MANIFEST

NO

116169

1. PAGE \_\_\_ OF \_\_\_

2. TRAILER NO. 12

G

3. COMPANY NAME

4. ADDRESS

5. PICK-UP DATE

PHONE NO.

CITY

STATE

ZIP

6. TNRCC I.D. NO.

E

7. NAME OR DESCRIPTION OF WASTE SHIPPED:

8. CONTAINERS

9. TOTAL

10. UNIT

11. TEXAS

N

a.

No.

Type

QUANTITY

Wt/Vol.

WASTE ID #

E

b.

c.

R

d.

12. COMMENTS OR SPECIAL INSTRUCTIONS:

13. WASTE PROFILE NO.

A

14.

### IN CASE OF EMERGENCY OR SPILL, CONTACT

NAME

PHONE NO

24-HOUR EMERGENCY NO.

T

O

15. **GENERATOR'S CERTIFICATION:** I Hereby declare that the contents of this consignment are fully and accurately described above by proper shipping name and are classified, packed, marked, and labeled, and are in all respects in proper condition for transport by highway according to applicable international and national government regulations, including applicable state regulations, and are the same materials previously approved by LEA LAND, LLC

R

PRINTED/TYPED NAME

SIGNATURE

DATE

T

16.

### TRANSPORTER (1)

NAME:

TEXAS I.D. NO.

IN CASE OF EMERGENCY CONTACT:

EMERGENCY PHONE:

R

18. **TRANSPORTER (1):** Acknowledgment of receipt of material

PRINTED/TYPED NAME

SIGNATURE

DATE

D

F

PERMIT NO.

WM-01-035 - New Mexico

ADDRESS:

Mile Marker 64, U.S. Hwy 62/180,  
30 Miles East of Carlsbad, NM

PHONE:

575-887-4048

I

S

C

P

I

O

L

S

I

T

A

T

21. **DISPOSAL FACILITY'S CERTIFICATION:** I Hereby certify that the above described wastes were delivered to this facility, that the facility is authorized and permitted to receive such wastes.

AUTHORIZED SIGNATURE

CELL NO.

DATE

TIME

GENERATOR: COPIES 1 & 6

DISPOSAL SITE: COPIES 2 & 3

TRANSPORTERS: COPIES 4 & 5

COPY 4



# LEA LAND DISPOSAL SITE NEW MEXICO

MILE MARKER #64 US HWY 62/180 • 30 MILES EAST OF CARLSBAD, NM • PHONE (575) 887-4048

## LEA LAND, LLC

1300 WEST MAIN STREET • OKLAHOMA CITY, OK 73106 • PHONE (405) 236-4257

### NON-HAZARDOUS WASTE MANIFEST

NO

116170

1. PAGE \_\_\_ OF \_\_\_

2. TRAILER NO. 210

G

3. COMPANY NAME

4. ADDRESS

5. PICK-UP DATE

E

PHONE NO.

CITY

STATE

ZIP

6. TNRCC I.D. NO.

N

7. NAME OR DESCRIPTION OF WASTE SHIPPED:

8. CONTAINERS  
No. Type

9. TOTAL  
QUANTITY

10. UNIT  
Wt/Vol.

11. TEXAS  
WASTE ID #

E

a.

b.

c.

R

d.

A

12. COMMENTS OR SPECIAL INSTRUCTIONS:

13. WASTE PROFILE NO.

T

14.

#### IN CASE OF EMERGENCY OR SPILL, CONTACT

NAME

PHONE NO

24-HOUR EMERGENCY NO.

O

15. **GENERATOR'S CERTIFICATION:** I Hereby declare that the contents of this consignment are fully and accurately described above by proper shipping name and are classified, packed, marked, and labeled, and are in all respects in proper condition for transport by highway according to applicable international and national government regulations, including applicable state regulations, and are the same materials previously approved by LEA LAND, LLC

R

PRINTED/TYPED NAME

SIGNATURE

DATE

T

16. **TRANSPORTER (1)**

17. **TRANSPORTER (2)**

NAME:

NAME:

TEXAS I.D. NO.

TEXAS I.D. NO.

IN CASE OF EMERGENCY CONTACT:

IN CASE OF EMERGENCY CONTACT:

EMERGENCY PHONE:

EMERGENCY PHONE:

S

18. **TRANSPORTER (1):** Acknowledgment of receipt of material

19. **TRANSPORTER (2):** Acknowledgment of receipt of material

PRINTED/TYPED NAME

PRINTED/TYPED NAME

SIGNATURE

DATE

SIGNATURE

DATE

D

Lea Land, LLC

ADDRESS:

Mile Marker 64, U.S. Hwy 62/180,  
30 Miles East of Carlsbad, NM

PHONE:

575-887-4048

F

PERMIT NO.

WM-01-035 - New Mexico

20. COMMENTS

I

S

C

P

I

O

L

S

I

T

21. **DISPOSAL FACILITY'S CERTIFICATION:** I Hereby certify that the above described wastes were delivered to this facility, that the facility is authorized and permitted to receive such wastes.

AUTHORIZED SIGNATURE

CELL NO.

DATE

TIME

GENERATOR: COPIES 1 & 6

DISPOSAL SITE: COPIES 2 & 3

TRANSPORTERS: COPIES 4 & 5

COPY 4



# LEA LAND DISPOSAL SITE NEW MEXICO

MILE MARKER #64 US HWY 62/180 • 30 MILES EAST OF CARLSBAD, NM • PHONE (575) 887-4048

## LEA LAND, LLC

1300 WEST MAIN STREET • OKLAHOMA CITY, OK 73106 • PHONE (405) 236-4257

### NON-HAZARDOUS WASTE MANIFEST

NO **116171**

1. PAGE    OF   

2. TRAILER NO.   

G

3. COMPANY NAME

4. ADDRESS

5. PICK-UP DATE

E

PHONE NO.

CITY

STATE

ZIP

6. TNRCC I.D. NO.

N

7. NAME OR DESCRIPTION OF WASTE SHIPPED:

8. CONTAINERS  
No. Type

9. TOTAL  
QUANTITY

10. UNIT  
Wt/Vol.

11. TEXAS  
WASTE ID #

E

a.

b.

c.

R

d.

A

12. COMMENTS OR SPECIAL INSTRUCTIONS:

13. WASTE PROFILE NO.

T

14.

### IN CASE OF EMERGENCY OR SPILL, CONTACT

NAME

PHONE NO.

24-HOUR EMERGENCY NO.

O

15. **GENERATOR'S CERTIFICATION:** I Hereby declare that the contents of this consignment are fully and accurately described above by proper shipping name and are classified, packed, marked, and labeled, and are in all respects in proper condition for transport by highway according to applicable international and national government regulations, including applicable state regulations, and are the same materials previously approved by LEA LAND, LLC

R

PRINTED/TYPED NAME

SIGNATURE

DATE

T

16.

### TRANSPORTER (1)

17.

### TRANSPORTER (2)

NAME:

NAME:

TEXAS I.D. NO.

TEXAS I.D. NO.

IN CASE OF EMERGENCY CONTACT:

IN CASE OF EMERGENCY CONTACT:

EMERGENCY PHONE:

EMERGENCY PHONE:

R

18. **TRANSPORTER (1):** Acknowledgment of receipt of material

19. **TRANSPORTER (2):** Acknowledgment of receipt of material

PRINTED/TYPED NAME

PRINTED/TYPED NAME

SIGNATURE

DATE

SIGNATURE

DATE

D

Lea Land, LLC

ADDRESS:

Mile Marker 64, U.S. Hwy 62/180,  
30 Miles East of Carlsbad, NM

PHONE:

575-887-4048

F

PERMIT NO.

WM-01-035 - New Mexico

20. COMMENTS

I

S

C

P

O

L

S

I

T

L

21. **DISPOSAL FACILITY'S CERTIFICATION:** I Hereby certify that the above described wastes were delivered to this facility, that the facility is authorized and permitted to receive such wastes.

AUTHORIZED SIGNATURE

CELL NO.

DATE

TIME



# LEA LAND DISPOSAL SITE NEW MEXICO

MILE MARKER #64 US HWY 62/180 • 30 MILES EAST OF CARLSBAD, NM • PHONE (575) 887-4048

## LEA LAND, LLC

1300 WEST MAIN STREET • OKLAHOMA CITY, OK 73106 • PHONE (405) 236-4257

### NON-HAZARDOUS WASTE MANIFEST

NO

116172

1. PAGE \_\_\_ OF \_\_\_

2. TRAILER NO.

G

3. COMPANY NAME

4. ADDRESS

5. PICK-UP DATE

PHONE NO.

CITY

STATE

ZIP

6. TNRCC I.D. NO.

E

7. NAME OR DESCRIPTION OF WASTE SHIPPED:

8. CONTAINERS  
No. Type

9. TOTAL  
QUANTITY

10. UNIT  
Wt/Vol.

11. TEXAS  
WASTE ID #

N

a.

b.

E

c.

R

d.

12. COMMENTS OR SPECIAL INSTRUCTIONS:

13. WASTE PROFILE NO.

A

14.

### IN CASE OF EMERGENCY OR SPILL, CONTACT

NAME

PHONE NO

24-HOUR EMERGENCY NO.

T

O

15. **GENERATOR'S CERTIFICATION:** I Hereby declare that the contents of this consignment are fully and accurately described above by proper shipping name and are classified, packed, marked, and labeled, and are in all respects in proper condition for transport by highway according to applicable international and national government regulations, including applicable state regulations, and are the same materials previously approved by LEA LAND, LLC

R

PRINTED/TYPED NAME

SIGNATURE

DATE

T

16.

### TRANSPORTER (1)

NAME:

TEXAS I.D. NO.

IN CASE OF EMERGENCY CONTACT:

EMERGENCY PHONE:

18. **TRANSPORTER (1):** Acknowledgment of receipt of material

PRINTED/TYPED NAME

SIGNATURE

DATE

17.

### TRANSPORTER (2)

NAME:

TEXAS I.D. NO.

IN CASE OF EMERGENCY CONTACT:

EMERGENCY PHONE:

19. **TRANSPORTER (2):** Acknowledgment of receipt of material

PRINTED/TYPED NAME

SIGNATURE

DATE

D

Lea Land, LLC

ADDRESS:

Mile Marker 64, U.S. Hwy 62/180,  
30 Miles East of Carlsbad, NM

PHONE:

575-887-4048

F

PERMIT NO.

WM-01-035 - New Mexico

20. COMMENTS

S

21. **DISPOSAL FACILITY'S CERTIFICATION:** I Hereby certify that the above described wastes were delivered to this facility, that the facility is authorized and permitted to receive such wastes.

A

AUTHORIZED SIGNATURE

CELL NO.

DATE

TIME

L

GENERATOR: COPIES 1 & 6

DISPOSAL SITE: COPIES 2 & 3

TRANSPORTERS: COPIES 4 & 5

COPY 4



# LEA LAND DISPOSAL SITE NEW MEXICO

MILE MARKER #64 US HWY 62/180 • 30 MILES EAST OF CARLSBAD, NM • PHONE (575) 887-4048

## LEA LAND, LLC

1300 WEST MAIN STREET • OKLAHOMA CITY, OK 73106 • PHONE (405) 236-4257

### NON-HAZARDOUS WASTE MANIFEST

NO 116173

1. PAGE OF

2. TRAILER NO.

G

3. COMPANY NAME

4. ADDRESS

5. PICK-UP DATE

PHONE NO.

CITY

STATE

ZIP

6. TNRCC I.D. NO.

E

7. NAME OR DESCRIPTION OF WASTE SHIPPED:

8. CONTAINERS  
No. | Type

9. TOTAL  
QUANTITY

10. UNIT  
Wt/Vol.

11. TEXAS  
WASTE ID #

N

a.

b.

E

c.

R

d.

12. COMMENTS OR SPECIAL INSTRUCTIONS:

13. WASTE PROFILE NO.

A

14.

#### IN CASE OF EMERGENCY OR SPILL, CONTACT

NAME

PHONE NO.

24-HOUR EMERGENCY NO.

T

O

15. **GENERATOR'S CERTIFICATION:** I hereby declare that the contents of this consignment are fully and accurately described above by proper shipping name and are classified, packed, marked, and labeled, and are in all respects in proper condition for transport by highway according to applicable international and national government regulations, including applicable state regulations, and are the same materials previously approved by LEA LAND, LLC

R

PRINTED/TYPED NAME

SIGNATURE

DATE

T

16.

#### TRANSPORTER (1)

NAME:

TEXAS I.D. NO.

IN CASE OF EMERGENCY CONTACT:

EMERGENCY PHONE:

R

17.

#### TRANSPORTER (2)

NAME:

TEXAS I.D. NO.

IN CASE OF EMERGENCY CONTACT:

EMERGENCY PHONE:

T

18. **TRANSPORTER (1):** Acknowledgment of receipt of material

19. **TRANSPORTER (2):** Acknowledgment of receipt of material

PRINTED/TYPED NAME

PRINTED/TYPED NAME

SIGNATURE

DATE

SIGNATURE

DATE

D

Lea Land, LLC

ADDRESS:

Mile Marker 64, U.S. Hwy 62/180,  
30 Miles East of Carlsbad, NM

PHONE:

575-887-4048

F

PERMIT NO.

WM-01-035 - New Mexico

20. COMMENTS

S

21. **DISPOSAL FACILITY'S CERTIFICATION:** I hereby certify that the above described wastes were delivered to this facility, that the facility is authorized and permitted to receive such wastes.

A

AUTHORIZED SIGNATURE

CELL NO.

DATE

TIME

L

GENERATOR: COPIES 1 & 6

DISPOSAL SITE: COPIES 2 & 3

TRANSPORTERS: COPIES 4 & 5

COPY 4



# LEA LAND DISPOSAL SITE NEW MEXICO

MILE MARKER #64 US HWY 62/180 • 30 MILES EAST OF CARLSBAD, NM • PHONE (575) 887-4048

**LEA LAND, LLC**

1300 WEST MAIN STREET • OKLAHOMA CITY, OK 73106 • PHONE (405) 236-4257

## NON-HAZARDOUS WASTE MANIFEST

NO

116174

1. PAGE OF

2. TRAILER NO.

G E N E R A T O R	3. COMPANY NAME		4. ADDRESS		5. PICK-UP DATE	
	PHONE NO.		CITY STATE ZIP		6. TNRCC I.D. NO.	
	7. NAME OR DESCRIPTION OF WASTE SHIPPED:				8. CONTAINERS No. Type	9. TOTAL QUANTITY
	a.					
E N V I R O N M E N T	b.					
	c.					
	d.					
	12. COMMENTS OR SPECIAL INSTRUCTIONS:				13. WASTE PROFILE NO.	
T R A N S P O R T E R	14. <b>IN CASE OF EMERGENCY OR SPILL, CONTACT</b>					
	NAME		PHONE NO.		24-HOUR EMERGENCY NO.	
	15. <b>GENERATOR'S CERTIFICATION:</b> I Hereby declare that the contents of this consignment are fully and accurately described above by proper shipping name and are classified, packed, marked, and labeled, and are in all respects in proper condition for transport by highway according to applicable international and national government regulations, including applicable state regulations, and are the same materials previously approved by LEA LAND, LLC					
	PRINTED/TYPED NAME			SIGNATURE		
T R A N S P O R T E R S	16. <b>TRANSPORTER (1)</b>			17. <b>TRANSPORTER (2)</b>		
	NAME:			NAME:		
	TEXAS I.D. NO.			TEXAS I.D. NO.		
	IN CASE OF EMERGENCY CONTACT:			IN CASE OF EMERGENCY CONTACT:		
D I S P O S I T I O N	EMERGENCY PHONE:			EMERGENCY PHONE:		
	18. <b>TRANSPORTER (1):</b> Acknowledgment of receipt of material			19. <b>TRANSPORTER (2):</b> Acknowledgment of receipt of material		
	PRINTED/TYPED NAME			PRINTED/TYPED NAME		
	SIGNATURE			SIGNATURE		
D I S P O S I T I O N F A C I L I T Y	ADDRESS:		PHONE:			
	Lea Land, LLC		Mile Marker 64, U.S. Hwy 62/180, 30 Miles East of Carlsbad, NM		575-887-4048	
	PERMIT NO.		20. COMMENTS			
	WM-01-035 - New Mexico					
A U T H O R I Z E D	21. <b>DISPOSAL FACILITY'S CERTIFICATION:</b> I Hereby certify that the above described wastes were delivered to this facility, that the facility is authorized and permitted to receive such wastes.					
	AUTHORIZED SIGNATURE		CELL NO.		DATE	TIME



# LEA LAND DISPOSAL SITE NEW MEXICO

MILE MARKER #64 US HWY 62/180 • 30 MILES EAST OF CARLSBAD, NM • PHONE (575) 887-4048

## LEA LAND, LLC

1300 WEST MAIN STREET • OKLAHOMA CITY, OK 73106 • PHONE (405) 236-4257

### NON-HAZARDOUS WASTE MANIFEST

NO

116175

1. PAGE \_\_\_ OF \_\_\_

2. TRAILER NO. 1

G

3. COMPANY NAME

4. ADDRESS

5. PICK-UP DATE

PHONE NO.

CITY

STATE

ZIP

6. TNRCC I.D. NO.

E

7. NAME OR DESCRIPTION OF WASTE SHIPPED:

8. CONTAINERS  
No. Type

9. TOTAL  
QUANTITY

10. UNIT  
Wt/Vol.

11. TEXAS  
WASTE ID #

N

a.

b.

E

c.

R

d.

12. COMMENTS OR SPECIAL INSTRUCTIONS:

13. WASTE PROFILE NO.

A

14.

#### IN CASE OF EMERGENCY OR SPILL, CONTACT

NAME

PHONE NO

24-HOUR EMERGENCY NO.

T

O

15. **GENERATOR'S CERTIFICATION:** I Hereby declare that the contents of this consignment are fully and accurately described above by proper shipping name and are classified, packed, marked, and labeled, and are in all respects in proper condition for transport by highway according to applicable international and national government regulations, including applicable state regulations, and are the same materials previously approved by LEA LAND, LLC

R

PRINTED/TYPED NAME

SIGNATURE

DATE

T

16.

#### TRANSPORTER (1)

NAME:

TEXAS I.D. NO.

IN CASE OF EMERGENCY CONTACT:

EMERGENCY PHONE:

R

18. **TRANSPORTER (1):** Acknowledgment of receipt of material

PRINTED/TYPED NAME

SIGNATURE

DATE

D

Lea Land, LLC

ADDRESS:

Mile Marker 64, U.S. Hwy 62/180,  
30 Miles East of Carlsbad, NM

PHONE:

575-887-4048

F

PERMIT NO.

WM-01-035 - New Mexico

20. COMMENTS

I

S

C

P

I

O

L

S

I

T

A

21. **DISPOSAL FACILITY'S CERTIFICATION:** I Hereby certify that the above described wastes were delivered to this facility, that the facility is authorized and permitted to receive such wastes.

AUTHORIZED SIGNATURE

CELL NO.

DATE

TIME

GENERATOR: COPIES 1 & 6

DISPOSAL SITE: COPIES 2 & 3

TRANSPORTERS: COPIES 4 & 5

COPY 4



# LEA LAND DISPOSAL SITE NEW MEXICO

MILE MARKER #64 US HWY 62/180 • 30 MILES EAST OF CARLSBAD, NM • PHONE (575) 887-4048

## LEA LAND, LLC

1300 WEST MAIN STREET • OKLAHOMA CITY, OK 73106 • PHONE (405) 236-4257

### NON-HAZARDOUS WASTE MANIFEST

NO

116178

1. PAGE \_\_\_ OF \_\_\_

2. TRAILER NO.

G

3. COMPANY NAME

4. ADDRESS

5. PICK-UP DATE

PHONE NO.

CITY

STATE

ZIP

6. TNRCC I.D. NO.

E

7. NAME OR DESCRIPTION OF WASTE SHIPPED:

8. CONTAINERS

9. TOTAL

10. UNIT

11. TEXAS

a.

No.

Type

QUANTITY

Wt/Vol.

WASTE ID #

b.

c.

R

12. COMMENTS OR SPECIAL INSTRUCTIONS:

13. WASTE PROFILE NO.

A

14.

### IN CASE OF EMERGENCY OR SPILL, CONTACT

T

NAME

PHONE NO.

24-HOUR EMERGENCY NO.

O

15. **GENERATOR'S CERTIFICATION:** I hereby declare that the contents of this consignment are fully and accurately described above by proper shipping name and are classified, packed, marked, and labeled, and are in all respects in proper condition for transport by highway, according to applicable international and national government regulations, including applicable state regulations, and are the same materials previously approved by LEA LAND, LLC

R

PRINTED/TYPED NAME

SIGNATURE

DATE

T

16.

### TRANSPORTER (1)

NAME:

TEXAS I.D. NO.

IN CASE OF EMERGENCY CONTACT:

EMERGENCY PHONE:

R

18. **TRANSPORTER (1):** Acknowledgment of receipt of material

PRINTED/TYPED NAME

SIGNATURE

DATE

D

F

PERMIT NO.

WM-01-035 - New Mexico

ADDRESS:

Mile Marker 64, U.S. Hwy 62/180,  
30 Miles East of Carlsbad, NM

PHONE:

575-887-4048

I

S

20. **DISPOSAL FACILITY'S CERTIFICATION:** I hereby certify that the above described wastes were delivered to this facility, that the facility is authorized and permitted to receive such wastes.

A

AUTHORIZED SIGNATURE

CELL NO.

DATE

TIME

GENERATOR: COPIES 1 & 6

DISPOSAL SITE: COPIES 2 & 3

TRANSPORTERS: COPIES 4 & 5

COPY 4



# LEA LAND DISPOSAL SITE NEW MEXICO

MILE MARKER #64 US HWY 62/180 • 30 MILES EAST OF CARLSBAD, NM • PHONE (575) 887-4048

## LEA LAND, LLC

1300 WEST MAIN STREET • OKLAHOMA CITY, OK 73106 • PHONE (405) 236-4257

### NON-HAZARDOUS WASTE MANIFEST

NO **116179**

1. PAGE    OF   

2. TRAILER NO.   

G

3. COMPANY NAME

4. ADDRESS

5. PICK-UP DATE

PHONE NO.

CITY

STATE

ZIP

6. TNRCC I.D. NO.

E

7. NAME OR DESCRIPTION OF WASTE SHIPPED:

8. CONTAINERS  
No. Type

9. TOTAL  
QUANTITY

10. UNIT  
Wt/Vol.

11. TEXAS  
WASTE ID #

N

a.

E

b.

R

c.

d.

A

12. COMMENTS OR SPECIAL INSTRUCTIONS:

13. WASTE PROFILE NO.

T

14.

#### IN CASE OF EMERGENCY OR SPILL, CONTACT

NAME

PHONE NO

24-HOUR EMERGENCY NO.

O

15. **GENERATOR'S CERTIFICATION:** I hereby declare that the contents of this consignment are fully and accurately described above by proper shipping name and are classified, packed, marked, and labeled, and are in all respects in proper condition for transport by highway according to applicable international and national government regulations, including applicable state regulations, and are the same materials previously approved by LEA LAND, LLC

R

PRINTED/TYPED NAME

SIGNATURE

DATE

T

16.

#### TRANSPORTER (1)

17.

#### TRANSPORTER (2)

NAME:

NAME:

TEXAS I.D. NO.

TEXAS I.D. NO.

IN CASE OF EMERGENCY CONTACT:

IN CASE OF EMERGENCY CONTACT:

EMERGENCY PHONE:

EMERGENCY PHONE:

S

18. **TRANSPORTER (1):** Acknowledgment of receipt of material

19. **TRANSPORTER (2):** Acknowledgment of receipt of material

PRINTED/TYPED NAME

PRINTED/TYPED NAME

SIGNATURE

DATE

SIGNATURE

DATE

D

Lea Land, LLC

ADDRESS:

Mile Marker 64, U.S. Hwy 62/180,  
30 Miles East of Carlsbad, NM

PHONE:

575-887-4048

I

PERMIT NO.

WM-01-035 - New Mexico

20. COMMENTS

S

21. **DISPOSAL FACILITY'S CERTIFICATION:** I hereby certify that the above described wastes were delivered to this facility, that the facility is authorized and permitted to receive such wastes.

A

AUTHORIZED SIGNATURE

CELL NO.

DATE

TIME

L



# LEA LAND DISPOSAL SITE NEW MEXICO

MILE MARKER #64 US HWY 62/180 • 30 MILES EAST OF CARLSBAD, NM • PHONE (575) 887-4048

## LEA LAND, LLC

1300 WEST MAIN STREET • OKLAHOMA CITY, OK 73106 • PHONE (405) 236-4257

### NON-HAZARDOUS WASTE MANIFEST

NO

116180

1. PAGE \_\_\_ OF \_\_\_

2. TRAILER NO.

G

3. COMPANY NAME

4. ADDRESS

5. PICK-UP DATE

PHONE NO.

CITY

STATE

ZIP

6. TNRCC I.D. NO.

E

7. NAME OR DESCRIPTION OF WASTE SHIPPED:

8. CONTAINERS

9. TOTAL

10. UNIT

11. TEXAS

N

a.

No.

Type

QUANTITY

Wt/Vol.

WASTE ID #

E

b.

R

c.

A

12. COMMENTS OR SPECIAL INSTRUCTIONS:

13. WASTE PROFILE NO.

T

14.

#### IN CASE OF EMERGENCY OR SPILL, CONTACT

NAME

PHONE NO

24-HOUR EMERGENCY NO.

O

15. **GENERATOR'S CERTIFICATION:** I Hereby declare that the contents of this consignment are fully and accurately described above by proper shipping name and are classified, packed, marked, and labeled, and are in all respects in proper condition for transport by highway according to applicable international and national government regulations, including applicable state regulations, and are the same materials previously approved by LEA LAND, LLC

R

PRINTED/TYPED NAME

SIGNATURE

DATE

T

16.

#### TRANSPORTER (1)

NAME:

TEXAS I.D. NO.

IN CASE OF EMERGENCY CONTACT:

EMERGENCY PHONE:

R

18. **TRANSPORTER (1):** Acknowledgment of receipt of material

PRINTED/TYPED NAME

SIGNATURE

DATE

D

F

PERMIT NO.

WM-01-035 - New Mexico

I

S

C

P

I

O

L

21. **DISPOSAL FACILITY'S CERTIFICATION:** I Hereby certify that the above described wastes were delivered to this facility, that the facility is authorized and permitted to receive such wastes.

AUTHORIZED SIGNATURE

CELL NO.

DATE

TIME

GENERATOR: COPIES 1 & 6

DISPOSAL SITE: COPIES 2 & 3

TRANSPORTERS: COPIES 4 & 5

COPY 4



# LEA LAND DISPOSAL SITE NEW MEXICO

MILE MARKER #64 US HWY 62/180 • 30 MILES EAST OF CARLSBAD, NM • PHONE (575) 887-4048

## LEA LAND, LLC

1300 WEST MAIN STREET • OKLAHOMA CITY, OK 73106 • PHONE (405) 236-4257

### NON-HAZARDOUS WASTE MANIFEST

NO **116181**

1. PAGE    OF   

2. TRAILER NO. **2123**

G

3. COMPANY NAME

4. ADDRESS

5. PICK-UP DATE

PHONE NO.

CITY

STATE

ZIP

6. TNRCC I.D. NO.

E

7. NAME OR DESCRIPTION OF WASTE SHIPPED:

8. CONTAINERS

9. TOTAL

10. UNIT

11. TEXAS

N

a.

No.

Type

QUANTITY

Wt/Vol.

WASTE ID #

E

b.

c.

R

d.

12. COMMENTS OR SPECIAL INSTRUCTIONS:

13. WASTE PROFILE NO.

A

14.

### IN CASE OF EMERGENCY OR SPILL, CONTACT

T

NAME

PHONE NO

24-HOUR EMERGENCY NO.

O

**15. GENERATOR'S CERTIFICATION:** I Hereby declare that the contents of this consignment are fully and accurately described above by proper shipping name and are classified, packed, marked, and labeled, and are in all respects in proper condition for transport by highway according to applicable international and national government regulations, including applicable state regulations, and are the same materials previously approved by LEA LAND, LLC

R

PRINTED/TYPED NAME

SIGNATURE

DATE

T

16.

### TRANSPORTER (1)

17.

### TRANSPORTER (2)

R

NAME:

NAME:

TEXAS I.D. NO.

TEXAS I.D. NO.

IN CASE OF EMERGENCY CONTACT:

IN CASE OF EMERGENCY CONTACT:

EMERGENCY PHONE:

EMERGENCY PHONE:

R

**18. TRANSPORTER (1):** Acknowledgment of receipt of material

**19. TRANSPORTER (2):** Acknowledgment of receipt of material

T

PRINTED/TYPED NAME

PRINTED/TYPED NAME

R

SIGNATURE

DATE

SIGNATURE

DATE

D

Lea Land, LLC

ADDRESS:

Mile Marker 64, U.S. Hwy 62/180,  
30 Miles East of Carlsbad, NM

PHONE:

575-887-4048

F

PERMIT NO.

WM-01-035 - New Mexico

20. COMMENTS

I

S

C

P

I

O

L

**21. DISPOSAL FACILITY'S CERTIFICATION:** I Hereby certify that the above described wastes were delivered to this facility, that the facility is authorized and permitted to receive such wastes.

AUTHORIZED SIGNATURE

CELL NO.

DATE

TIME



# LEA LAND DISPOSAL SITE NEW MEXICO

MILE MARKER #64 US HWY 62/180 • 30 MILES EAST OF CARLSBAD, NM • PHONE (575) 887-4048

## LEA LAND, LLC

1300 WEST MAIN STREET • OKLAHOMA CITY, OK 73106 • PHONE (405) 236-4257

### NON-HAZARDOUS WASTE MANIFEST

NO

116182

1. PAGE \_\_\_ OF \_\_\_

2. TRAILER NO. \_\_\_\_\_

G

3. COMPANY NAME

4. ADDRESS

5. PICK-UP DATE

PHONE NO.

CITY

STATE

ZIP

6. TNRCC I.D. NO.

E

7. NAME OR DESCRIPTION OF WASTE SHIPPED:

8. CONTAINERS

9. TOTAL

10. UNIT

11. TEXAS

N

a.

No.

Type

QUANTITY

Wt/Vol.

WASTE ID #

E

b.

c.

R

d.

12. COMMENTS OR SPECIAL INSTRUCTIONS:

13. WASTE PROFILE NO.

A

14.

#### IN CASE OF EMERGENCY OR SPILL, CONTACT

T

NAME

PHONE NO

24-HOUR EMERGENCY NO.

O

15. **GENERATOR'S CERTIFICATION:** I hereby declare that the contents of this consignment are fully and accurately described above by proper shipping name and are classified, packed, marked, and labeled, and are in all respects in proper condition for transport by highway according to applicable international and national government regulations, including applicable state regulations, and are the same materials previously approved by LEA LAND, LLC

R

PRINTED/TYPED NAME

SIGNATURE

DATE

T

16.

#### TRANSPORTER (1)

17.

#### TRANSPORTER (2)

R

NAME:

NAME:

TEXAS I.D. NO.

TEXAS I.D. NO.

IN CASE OF EMERGENCY CONTACT:

IN CASE OF EMERGENCY CONTACT:

EMERGENCY PHONE:

EMERGENCY PHONE:

T

18. **TRANSPORTER (1):** Acknowledgment of receipt of material

19. **TRANSPORTER (2):** Acknowledgment of receipt of material

R

PRINTED/TYPED NAME

PRINTED/TYPED NAME

SIGNATURE

DATE

SIGNATURE

DATE

D

Lea Land, LLC

ADDRESS:

Mile Marker 64, U.S. Hwy 62/180,  
30 Miles East of Carlsbad, NM

PHONE:

575-887-4048

F

PERMIT NO.

WM-01-035 - New Mexico

20. COMMENTS

I

21. **DISPOSAL FACILITY'S CERTIFICATION:** I hereby certify that the above described wastes were delivered to this facility, that the facility is authorized and permitted to receive such wastes.

S

I

AUTHORIZED SIGNATURE

CELL NO.

DATE

TIME



# LEA LAND DISPOSAL SITE NEW MEXICO

MILE MARKER #64 US HWY 62/180 • 30 MILES EAST OF CARLSBAD, NM • PHONE (575) 887-4048

## LEA LAND, LLC

1300 WEST MAIN STREET • OKLAHOMA CITY, OK 73106 • PHONE (405) 236-4257

### NON-HAZARDOUS WASTE MANIFEST

NO **116183**

1. PAGE     OF    

2. TRAILER NO.    

G

3. COMPANY NAME

4. ADDRESS

5. PICK-UP DATE

PHONE NO.

CITY

STATE

ZIP

6. TNRCC I.D. NO.

E

7. NAME OR DESCRIPTION OF WASTE SHIPPED:

8. CONTAINERS  
No. Type

9. TOTAL  
QUANTITY

10. UNIT  
Wt/Vol.

11. TEXAS  
WASTE ID #

N

a.

b.

E

c.

R

d.

12. COMMENTS OR SPECIAL INSTRUCTIONS:

13. WASTE PROFILE NO.

A

14.

### IN CASE OF EMERGENCY OR SPILL, CONTACT

NAME

PHONE NO

24-HOUR EMERGENCY NO.

T

O

15. **GENERATOR'S CERTIFICATION:** I Hereby declare that the contents of this consignment are fully and accurately described above by proper shipping name and are classified, packed, marked, and labeled, and are in all respects in proper condition for transport by highway according to applicable international and national government regulations, including applicable state regulations, and are the same materials previously approved by LEA LAND, LLC

R

PRINTED/TYPED NAME

SIGNATURE

DATE

T

16.

### TRANSPORTER (1)

NAME:

TEXAS I.D. NO.

IN CASE OF EMERGENCY CONTACT:

EMERGENCY PHONE:

R

18. **TRANSPORTER (1):** Acknowledgment of receipt of material

PRINTED/TYPED NAME

SIGNATURE

DATE

D

F

PERMIT NO.

WM-01-035 - New Mexico

I

A

S

C

P

I

O

L

S

I

A

T

L

Y

ADDRESS:

Mile Marker 64, U.S. Hwy 62/180,  
30 Miles East of Carlsbad, NM

PHONE:

575-887-4048

20. COMMENTS

21. **DISPOSAL FACILITY'S CERTIFICATION:** I Hereby certify that the above described wastes were delivered to this facility, that the facility is authorized and permitted to receive such wastes.

AUTHORIZED SIGNATURE

CELL NO.

DATE

TIME



# LEA LAND DISPOSAL SITE NEW MEXICO

MILE MARKER #64 US HWY 62/180 • 30 MILES EAST OF CARLSBAD, NM • PHONE (575) 887-4048

## LEA LAND, LLC

1300 WEST MAIN STREET • OKLAHOMA CITY, OK 73106 • PHONE (405) 236-4257

### NON-HAZARDOUS WASTE MANIFEST

NO

113267

1. PAGE \_\_\_ OF \_\_\_

2. TRAILER NO. 117

G

3. COMPANY NAME

4. ADDRESS

5. PICK-UP DATE

PHONE NO.

CITY

STATE

ZIP

6. TNRCC I.D. NO.

E

7. NAME OR DESCRIPTION OF WASTE SHIPPED:

8. CONTAINERS  
No. Type

9. TOTAL  
QUANTITY

10. UNIT  
Wt/Vol.

11. TEXAS  
WASTE ID #

N

a.

b.

E

c.

R

d.

12. COMMENTS OR SPECIAL INSTRUCTIONS:

13. WASTE PROFILE NO.

A

14.

#### IN CASE OF EMERGENCY OR SPILL, CONTACT

NAME

PHONE NO.

24-HOUR EMERGENCY NO.

T

O

15. **GENERATOR'S CERTIFICATION:** I Hereby declare that the contents of this consignment are fully and accurately described above by proper shipping name and are classified, packed, marked, and labeled, and are in all respects in proper condition for transport by highway according to applicable international and national government regulations, including applicable state regulations, and are the same materials previously approved by LEA LAND, LLC

R

PRINTED/TYPED NAME

SIGNATURE

DATE

T

16.

#### TRANSPORTER (1)

NAME:

TEXAS I.D. NO.

IN CASE OF EMERGENCY CONTACT:

EMERGENCY PHONE:

R

18. **TRANSPORTER (1):** Acknowledgment of receipt of material

PRINTED/TYPED NAME

SIGNATURE

DATE

D

Lea Land, LLC

ADDRESS:

Mile Marker 64, U.S. Hwy 62/180,  
30 Miles East of Carlsbad, NM

PHONE:

575-887-4048

F

PERMIT NO.

WM-01-035 - New Mexico

20. COMMENTS

S

21. **DISPOSAL FACILITY'S CERTIFICATION:** I Hereby certify that the above described wastes were delivered to this facility, that the facility is authorized and permitted to receive such wastes.

I

AUTHORIZED SIGNATURE

CELL NO.

DATE

TIME

GENERATOR: COPIES 1 & 6

DISPOSAL SITE: COPIES 2 & 3

TRANSPORTERS: COPIES 4 & 5

COPY 4



# LEA LAND DISPOSAL SITE NEW MEXICO

MILE MARKER #64 US HWY 62/180 • 30 MILES EAST OF CARLSBAD, NM • PHONE (575) 887-4048

## LEA LAND, LLC

1300 WEST MAIN STREET • OKLAHOMA CITY, OK 73106 • PHONE (405) 236-4257

### NON-HAZARDOUS WASTE MANIFEST

NO

116271

1. PAGE \_\_\_ OF \_\_\_

2. TRAILER NO. 315

G

3. COMPANY NAME

PHONE NO.

4. ADDRESS

CITY

STATE

ZIP

5. PICK-UP DATE

6. TNRCC I.D. NO.

E

7. NAME OR DESCRIPTION OF WASTE SHIPPED:

8. CONTAINERS  
No. Type

9. TOTAL  
QUANTITY

10. UNIT  
Wt/Vol.

11. TEXAS  
WASTE ID #

N

a.

b.

E

c.

R

d. 41520

12. COMMENTS OR SPECIAL INSTRUCTIONS:

13. WASTE PROFILE NO.

A

14.

### IN CASE OF EMERGENCY OR SPILL, CONTACT

NAME

PHONE NO

24-HOUR EMERGENCY NO.

T

O

15. **GENERATOR'S CERTIFICATION:** I Hereby declare that the contents of this consignment are fully and accurately described above by proper shipping name and are classified, packed, marked, and labeled, and are in all respects in proper condition for transport by highway according to applicable international and national government regulations, including applicable state regulations, and are the same materials previously approved by LEA LAND, LLC

R

PRINTED/TYPED NAME

SIGNATURE

DATE

T

16.

### TRANSPORTER (1)

NAME:

TEXAS I.D. NO.

IN CASE OF EMERGENCY CONTACT:

EMERGENCY PHONE:

R

18. **TRANSPORTER (1):** Acknowledgment of receipt of material

PRINTED/TYPED NAME

SIGNATURE

DATE

D

Lea Land, LLC

ADDRESS:

Mile Marker 64, U.S. Hwy 62/180,  
30 Miles East of Carlsbad, NM

PHONE:

575-887-4048

F

PERMIT NO.

WM-01-035 - New Mexico

20. COMMENTS

I

21. **DISPOSAL FACILITY'S CERTIFICATION:** I Hereby certify that the above described wastes were delivered to this facility, that the facility is authorized and permitted to receive such wastes.

S

AUTHORIZED SIGNATURE

CELL NO.

DATE

TIME

A

T

L

Y

GENERATOR: COPIES 1 & 6

DISPOSAL SITE: COPIES 2 & 3

TRANSPORTERS: COPIES 4 & 5

COPY 4



# LEA LAND DISPOSAL SITE NEW MEXICO

MILE MARKER #64 US HWY 62/180 • 30 MILES EAST OF CARLSBAD, NM • PHONE (575) 887-4048

## LEA LAND, LLC

1300 WEST MAIN STREET • OKLAHOMA CITY, OK 73106 • PHONE (405) 236-4257

### NON-HAZARDOUS WASTE MANIFEST

NO

116273

1. PAGE \_\_\_ OF \_\_\_

2. TRAILER NO. 12

G

3. COMPANY NAME

4. ADDRESS

5. PICK-UP DATE

PHONE NO.

CITY

STATE

ZIP

6. TNRCC I.D. NO.

E

7. NAME OR DESCRIPTION OF WASTE SHIPPED:

8. CONTAINERS

9. TOTAL

10. UNIT

11. TEXAS

a.

No.

Type

QUANTITY

Wt/Vol.

WASTE ID #

b.

c.

d.

12. COMMENTS OR SPECIAL INSTRUCTIONS:

13. WASTE PROFILE NO.

A

14.

### IN CASE OF EMERGENCY OR SPILL, CONTACT

NAME

PHONE NO

24-HOUR EMERGENCY NO.

T

O

15. **GENERATOR'S CERTIFICATION:** I hereby declare that the contents of this consignment are fully and accurately described above by proper shipping name and are classified, packed, marked, and labeled, and are in all respects in proper condition for transport by highway according to applicable international and national government regulations, including applicable state regulations, and are the same materials previously approved by LEA LAND, LLC

R

PRINTED/TYPED NAME

SIGNATURE

DATE

T

16. **TRANSPORTER (1)**

17. **TRANSPORTER (2)**

NAME:

NAME:

TEXAS I.D. NO.

TEXAS I.D. NO.

IN CASE OF EMERGENCY CONTACT:

IN CASE OF EMERGENCY CONTACT:

EMERGENCY PHONE:

EMERGENCY PHONE:

18. **TRANSPORTER (1):** Acknowledgment of receipt of material

19. **TRANSPORTER (2):** Acknowledgment of receipt of material

PRINTED/TYPED NAME

PRINTED/TYPED NAME

SIGNATURE

DATE

SIGNATURE

DATE

D

Lea Land, LLC

ADDRESS:

Mile Marker 64, U.S. Hwy 62/180,  
30 Miles East of Carlsbad, NM

PHONE:

575-887-4048

F

PERMIT NO.

WM-01-035 - New Mexico

20. COMMENTS

I

21. **DISPOSAL FACILITY'S CERTIFICATION:** I hereby certify that the above described wastes were delivered to this facility, that the facility is authorized and permitted to receive such wastes.

S

AUTHORIZED SIGNATURE

CELL NO.

DATE

TIME



# LEA LAND DISPOSAL SITE NEW MEXICO

MILE MARKER #64 US HWY 62/180 • 30 MILES EAST OF CARLSBAD, NM • PHONE (575) 887-4048

## LEA LAND, LLC

1300 WEST MAIN STREET • OKLAHOMA CITY, OK 73106 • PHONE (405) 236-4257

### NON-HAZARDOUS WASTE MANIFEST

NO

116274

1. PAGE \_\_\_ OF \_\_\_

2. TRAILER NO.

G

3. COMPANY NAME

4. ADDRESS

5. PICK-UP DATE

PHONE NO.

CITY

STATE

ZIP

6. TNRCC I.D. NO.

E

7. NAME OR DESCRIPTION OF WASTE SHIPPED:

8. CONTAINERS

9. TOTAL

10. UNIT

11. TEXAS

N

a.

No.

Type

QUANTITY

Wt/Vol.

WASTE ID #

E

b.

R

c.

12. COMMENTS OR SPECIAL INSTRUCTIONS:

13. WASTE PROFILE NO.

A

14.

### IN CASE OF EMERGENCY OR SPILL, CONTACT

NAME

PHONE NO

24-HOUR EMERGENCY NO.

T

15. **GENERATOR'S CERTIFICATION:** I Hereby declare that the contents of this consignment are fully and accurately described above by proper shipping name and are classified, packed, marked, and labeled, and are in all respects in proper condition for transport by highway according to applicable international and national government regulations, including applicable state regulations, and are the same materials previously approved by LEA LAND, LLC

O

PRINTED/TYPED NAME

SIGNATURE

DATE

T

16.

### TRANSPORTER (1)

NAME:

TEXAS I.D. NO.

IN CASE OF EMERGENCY CONTACT:

EMERGENCY PHONE:

17.

### TRANSPORTER (2)

NAME:

TEXAS I.D. NO.

IN CASE OF EMERGENCY CONTACT:

EMERGENCY PHONE:

R

18. **TRANSPORTER (1):** Acknowledgment of receipt of material

PRINTED/TYPED NAME

SIGNATURE

DATE

19. **TRANSPORTER (2):** Acknowledgment of receipt of material

PRINTED/TYPED NAME

SIGNATURE

DATE

D

Lea Land, LLC

ADDRESS:

Mile Marker 64, U.S. Hwy 62/180,  
30 Miles East of Carlsbad, NM

PHONE:

575-887-4048

F

PERMIT NO.

WM-01-035 - New Mexico

20. COMMENTS

I

21. **DISPOSAL FACILITY'S CERTIFICATION:** I Hereby certify that the above described wastes were delivered to this facility, that the facility is authorized and permitted to receive such wastes.

S

AUTHORIZED SIGNATURE

CELL NO.

DATE

TIME

## **Appendix E**

### **Initial and Final C-141**

District I  
1625 N. French Dr., Hobbs, NM 88240  
District II  
811 S. First St., Artesia, NM 88210  
District III  
1000 Rio Brazos Road, Aztec, NM 87410  
District IV  
1220 S. St. Francis Dr., Santa Fe, NM 87505

State of New Mexico  
Energy Minerals and Natural Resources  
Oil Conservation Division  
1220 South St. Francis Dr.  
Santa Fe, NM 87505

# NM OIL CONSERVATION

ARTESIA DISTRICT

SEP 07 2016

Submit 1 Copy to appropriate District Office in accordance with 19.15.29 NMAC.

RECEIVED

Form C-141  
Revised August 8, 2011

## Release Notification and Corrective Action

NAB1625328377		OPERATOR	<input checked="" type="checkbox"/> Initial Report	<input type="checkbox"/> Final Report
Name of Company: XTO Energy, Inc. 5380		Contact: Dudley McMinn		
Address: 500 W. Illinois Ave., Suite 100, Midland, TX 70701		Telephone No.: (432) 682-8873		
Facility Name: Nash Draw Unit Battery #10		Facility Type: Tank Battery (Equipment Removed)		
Surface Owner: Federal		Mineral Owner: Federal		API No. 30-015-26992

## LOCATION OF RELEASE



Unit Letter	Section	Township	Range	Feet from the	North/South Line	Feet from the	East/West Line	County
G	13	23S	29E	1750	North	1850	East	Eddy

Latitude 32.307222 Longitude -103.935556

## NATURE OF RELEASE

Type of Release: Crude Oil	Volume of Release: Unknown	Volume Recovered: None
Source of Release: Spills	Date and Hour of Occurrence Unknown	Date and Hour of Discovery 07-20-2016
Was Immediate Notice Given? <input type="checkbox"/> Yes <input type="checkbox"/> No <input checked="" type="checkbox"/> Not Required	If YES, To Whom?	
By Whom?	Date and Hour	
Was a Watercourse Reached? <input type="checkbox"/> Yes <input checked="" type="checkbox"/> No	If YES, Volume Impacting the Watercourse.	
If a Watercourse was Impacted, Describe Fully.*		
Describe Cause of Problem and Remedial Action Taken.* Hydrocarbons in soil due to historic use of tank battery reported in soil samples by laboratory following removal of tanks and equipment. Will remediate to OCD and BLM requirements.		
Describe Area Affected and Cleanup Action Taken.* Affected soil to be excavated, treated onsite treatment or disposed offsite at OCD approved facility. Refer to attached analytical data summary.		

I hereby certify that the information given above is true and complete to the best of my knowledge and understand that pursuant to NMOC rules and regulations all operators are required to report and/or file certain release notifications and perform corrective actions for releases which may endanger public health or the environment. The acceptance of a C-141 report by the NMOC marked as "Final Report" does not relieve the operator of liability should their operations have failed to adequately investigate and remediate contamination that pose a threat to ground water, surface water, human health or the environment. In addition, NMOC acceptance of a C-141 report does not relieve the operator of responsibility for compliance with any other federal, state, or local laws and/or regulations.

Signature: 		OIL CONSERVATION DIVISION	
Printed Name: Luke Williams		Approved by Environmental Specialist: 	
Title: EH&S Coordinator		Approval Date: 9/8/16	Expiration Date: N/A
E-mail Address: Luke.Williams@xtoenergy.com		Conditions of Approval: Remediation per O.C.D. Rules & Guidelines Attached <input type="checkbox"/>	
Date: 09-07-2016 Phone: (432) 683-8873		SUBMIT REMEDIATION PROPOSAL NO	

\* Attach Additional Sheets If Necessary

LATER THAN: 10/9/16

2RP-3873

## **Patterson, Heather, EMNRD**

---

**From:** Mark Larson <Mark@laenvironmental.com>  
**Sent:** Wednesday, September 07, 2016 4:54 PM  
**To:** Patterson, Heather, EMNRD  
**Cc:** McMinn, Dudley; Williams, Luke  
**Subject:** Re: Initial C-141s for XTO Energy, Inc., Nash Draw Unit Tank Batteries (8), Eddy County, New Mexico  
**Attachments:** Initial C-141, XTO Energy, Inc., Nash Draw unit Battery 1 & 6, September 7, 2016.pdf; Initial C-141, XTO Energy, Inc., Nash Draw Unit Battery 10, September 7, 2016.pdf; Initial C-141, XTO Energy, Inc., Nash Draw Unit Battery 9, September 7, 2016.pdf; Initial C-141, XTO Energy, Inc., Nash Draw Unit Battery 15 & 33, September 7, 2016.pdf; Initial C-141, XTO Energy, Inc., Nash Draw Unit Battery 24, September 7, 2016.pdf; Initial C-141, XTO Energy, Inc., Nash Draw Unit Battery 36, September 7, 2016.pdf; Initial C-141, XTO Energy, Inc., Nash Draw Unit Battery 19 & 34, September 7, 2016.pdf; Initial C-141, XTO Energy, Inc., Nash Draw Unit Battery 38, September 7, 2016.pdf

Dear Heather,

The attached C-141s and supporting documentation are submitted on behalf of XTO Energy, Inc., for eight (8) tank batteries located in the Nash Draw Unit, Eddy County, New Mexico. Please contact Dudley McMinn with XTO Energy, Inc. at (432) 682-8873 or me if you have questions.

Respectfully,

Mark J. Larson

---

**From:** Mark Larson  
**Sent:** Wednesday, September 07, 2016 10:59 AM  
**To:** 'heather.patterson@state.nm.us'  
**Cc:** 'McMinn, Dudley'; 'Luke\_Williams@xtoenergy.com'  
**Subject:** Re: Meeting Confirmation

Dear Heather,

This message is to confirm our meeting at your office on September 15, 2016 at 10:00 AM (Mountain Time). Please contact me if you have questions. See you then!

Respectfully,

Mark J. Larson, P.G.  
President/Sr. Project Manager  
507 N. Marienfeld St., Suite 205  
Midland, Texas 79701  
(432) 687-0901 ( O )  
(432) 556-8656 ( C )



[www.LAEnvironmental.com](http://www.LAEnvironmental.com)

"Serving the Permian Basin Since 2000"



District I  
1625 N. French Dr., Hobbs, NM 88240  
District II  
811 S. First St., Artesia, NM 88210  
District III  
1000 Rio Brazos Road, Aztec, NM 87410  
District IV  
1220 S. St. Francis Dr., Santa Fe, NM 87505

State of New Mexico  
Energy Minerals and Natural Resources

Oil Conservation Division  
1220 South St. Francis Dr.  
Santa Fe, NM 87505

Form C-141  
Revised August 8, 2011

Submit 1 Copy to appropriate District Office in  
accordance with 19.15.29 NMAC.

**Release Notification and Corrective Action**

**OPERATOR**

☐ Initial Report ☒ Final Report

Name of Company: XTO Energy, Inc.	Contact: Dudley McMinn	
Address: 500 W. Illinois Ave., Suite 100, Midland, TX 70701	Telephone No.: (432) 682-8873	
Facility Name: Nash Draw Unit Battery #10	Facility Type: Tank Battery (Equipment Removed)	
Surface Owner: Federal	Mineral Owner: Federal	API No. 30-015-26992

**LOCATION OF RELEASE**

Unit Letter G	Section 13	Township 23S	Range 29E	Feet from the 1750	North/South Line North	Feet from the 1850	East/West Line East	County: Eddy
------------------	---------------	-----------------	--------------	-----------------------	---------------------------	-----------------------	------------------------	--------------

Latitude 32.307222 Longitude -103.935556

**NATURE OF RELEASE**

Type of Release: Crude Oil	Volume of Release: Unknown	Volume Recovered: None
Source of Release: Spills	Date and Hour of Occurrence Unknown	Date and Hour of Discovery 07-20-2016
Was Immediate Notice Given? <input type="checkbox"/> Yes <input type="checkbox"/> No <input checked="" type="checkbox"/> Not Required	If YES, To Whom?	
By Whom?	Date and Hour	
Was a Watercourse Reached? <input type="checkbox"/> Yes <input checked="" type="checkbox"/> No	If YES, Volume Impacting the Watercourse.	
If a Watercourse was Impacted, Describe Fully.*		
Describe Cause of Problem and Remedial Action Taken.* Hydrocarbons in soil due to historic use of tank battery reported in soil samples by laboratory following removal of tanks and equipment. Will remediate to OCD and BLM requirements.		
Describe Area Affected and Cleanup Action Taken.* Soil was excavated to 1 foot bgs at location DP-02-01 over an area measuring approximately 10' x 20' and backfilled with caliche. Soil was excavated to maximum depth of 16 feet at DP-02-02 over an area measuring approximately 25 x 35 feet. Laboratory analysis of soil samples from east sidewall (4 feet) exceeded RRAL therefore excavation extended east approximately 10 feet horizontally and 5 feet vertically. Final confirmation samples from excavation bottom and sidewalls were below the RRAL for BTEX and TPH. Excavation DP-02-02 was filled with caliche to 4 feet where a 20 mil thickness polyethylene liner was installed. The remaining excavation above the liner was filled with caliche. Remediation area was graded for drainage. Approximately 777 cubic yards of contaminated soil was disposed at Lea Land Landfill, LLC.		
I hereby certify that the information given above is true and complete to the best of my knowledge and understand that pursuant to NMOCD rules and regulations all operators are required to report and/or file certain release notifications and perform corrective actions for releases which may endanger public health or the environment. The acceptance of a C-141 report by the NMOCD marked as "Final Report" does not relieve the operator of liability should their operations have failed to adequately investigate and remediate contamination that pose a threat to ground water, surface water, human health or the environment. In addition, NMOCD acceptance of a C-141 report does not relieve the operator of responsibility for compliance with any other federal, state, or local laws and/or regulations.		
<b>OIL CONSERVATION DIVISION</b>		
Signature:	Approved by Environmental Specialist: <i>Bradford Billings</i>	
Printed Name: Luke Williams	Approval Date: 11/19/2019 Expiration Date:	
Title: EH&S Coordinator	Conditions of Approval:	
E-mail Address: Luke_Williams@xtoenergy.com	Attached <input type="checkbox"/>	
Date: 03-21-2016	Phone: (432) 683-8873	