

2RP-3876
REMEDIATION REPORT
Nash Draw Tank Battery #9
Eddy County, New Mexico

LAI Project No. 16-0108-03

March 21, 2017

Prepared for:

XTO Energy, Inc.
500 W. Illinois Ave., Suite 100
Midland, Texas 79707

Prepared by:

Larson & Associates, Inc.
507 North Marienfeld Street, Suite 205
Midland, Texas 79701



Mark J. Larson, P.G.

Certified Professional Geologist #10490

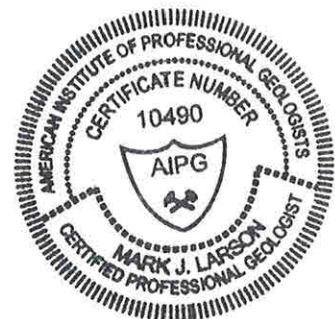

This Page Intentionally Left Blank

Table of Contents

1.0	INTRODUCTION	1
1.1	<i>Background</i>	1
1.2	<i>Physical Setting</i>	1
1.3	<i>Recommended Remediation Action Levels</i>	2
2.0	REMEDICATION	2
3.0	CONCLUSIONS	2

Tables

Table 1	Assessment Soil Sample Analytical Data Summary
Table 2	Confirmation Soil Sample Analytical Data Summary

Figures

Figure 1	Topographic Map
Figure 2a	Aerial Map
Figure 3	Site Map Showing Excavations and Depths

Appendices

Appendix A	OCD Approval
Appendix B	Laboratory Reports
Appendix C	Photographs
Appendix D	Waste Manifests
Appendix E	Initial and Final C-141

1.0 INTRODUCTION

Larson & Associates, Inc. (LAI) has prepared this report on behalf of XTO Energy, Inc. (XTO) for submittal to the New Mexico Oil Conservation Division (OCD) District 2, in Artesia, New Mexico and U.S. Bureau of Land Management (BLM) in Carlsbad, New Mexico, to document soil remediation at the Nash Draw #9 tank battery (Site). The Site is located in Unit B (NW/4, NE/4), Section 13, Township 23 South, Range 29 East in Eddy County, New Mexico. The geodetic position is North 32° 18' 35.21677" and West 103° 56' 13.33217". Figure 1 presents a topographic map. Figure 2 presents an aerial map.

1.1 Background

On June 21, 2016, LAI personnel used a Terraprobe® direct-push rig to collect soil samples at five (5) locations (DP-03-01 through DP-03-05). Soil samples were collected between ground surface and approximately four (4) feet below ground surface (bgs). A background sample (DP-03-BG) was collected about 60 feet west of the Site at approximately 1 foot bgs. The laboratory analysis and initial C-141 were submitted to OCD which assigned remediation permit number 2RP-3876, on September 8, 2016.

On September 29, 2016, LAI personnel supervised a backhoe operated by SDR Enterprises, LLC (SDR), Hobbs, New Mexico, to collect soil samples to delineate impacts observed in samples from DP-03-01, DP-03-02 and DP-03-05. On October 19, 2016, LAI personnel supervised Scarborough Drilling, Inc. (SDI), Lamesa, Texas, to collect soil samples with an air rotary rig and jam tube sampler to delineate total petroleum hydrocarbons (TPH) and chloride observed in samples from location DP-03-02. Table 1 presents the analytical data summary for the assessment soil samples

On November 7, 2016, LAI, on behalf of XTO, submitted a plan OCD District 2 and BLM for approval to remediate impacts to soil based on laboratory analysis of soil samples collected on June 21, 2016, September 28, 2016 and October 19, 2016. On November 10, 2016, OCD District 2 approved the remediation plan. Appendix A presents the OCD approval.

1.2 Physical Setting

The physical setting is as follows:

- Elevation is approximately 3,000 feet above mean sea level (AMSL);
- Topography slopes west towards a playa lake (Salt Lake) located about 700 feet west of the Site;
- Surface geology is comprised of unconsolidated Holocene to mid- Pleistocene-age eolian and piedmont-slope deposits that are approximately 80 feet thick according to a log from a nearby well;
- The Triassic-age Chinle formation of the Dockum group underlies the unconsolidated deposits and is comprised of interbedded sand, clay, and mudstone;
- According to State of New Mexico Office of the State Engineer (NMOSE) records a fresh water well is located about 1.5 miles south in Unit J (NW/4, SE/4), Section 24, Township 23 South, Range 29 East with groundwater reported at about 54 feet bgs.

1.3 Recommended Remediation Action Levels

Recommended remediation action levels (RRAL) were calculated for benzene, BTEX and TPH based on the following criteria established by the OCD in "Guidelines for Remediation of Leaks, Spills and Releases, August 13, 1993":

Criteria	Result	Score
Depth-to-Groundwater	50 - 99 feet	10
Wellhead Protection Area	No	0
Distance to Surface Water Body	200 - 1,000 Horizontal Feet	10

The following RRAL apply to the release for ranking score: 10

- Benzene 10 mg/Kg
- BTEX 50 mg/Kg
- TPH 100 mg/Kg

2.0 REMEDIATION

Soil remediation was performed between November 9, 2016 and December 15, 2016, according to the plan approved by OCD District 2 on November 10, 2016. SDR, under supervision from LAI, excavated soil from the area of DP-03-01 and DP-03-02 measuring about 45 x 50 feet to about 5 feet bgs. SDR excavated soil from the area of DP-03-04 measuring about 15 x 20 feet to about 2 feet bgs. SDR excavated soil from the area of DP-03-05 measuring about 35 x 50 feet to about 4 feet bgs. Soil samples collected from the excavation sidewalls were analyzed by Permian Basin Environmental Lab (PBEL) for benzene, toluene, ethylbenzene and xylenes (BTEX) by EPA SW-846 Method 8020B and TPH by EPA SW-846 Method 8015 including GRO (C6 – C12), DRO (>C12 – C28) and ORO (>C28 – C35). Soil was excavated laterally until concentrations of benzene, BTEX and TPH were below the RRAL of 10 mg/Kg, 50 mg/Kg and 100 mg/Kg, respectively. The excavation was filled with caliche.

Approximately 1,423 cubic yards of contaminated soil was disposed at Lea Land Landfill, LLC. Table 2 presents the confirmation soil sample analytical data summary. Figure 3 presents the remediation areas. Appendix B presents the confirmation sample laboratory reports. Appendix C presents photographs. Appendix D presents the waste manifests. Appendix E presents the initial and final C-141.

3.0 CONCLUSIONS

Soil was remediated according to the remediation plans approved by OCD District 2. XTO requests no further action for 2RP-3876.

Tables

Table 1
2RP-3876
Assessment Soil Sample Analytical Data Summary
XTO Energy, Inc., Nash Draw Tank Battery 9
Unit B (NW/4, NE/4), Section 13, Township 23 South, Range 29 East
Eddy County, New Mexico

Location	Depth (Feet)	Collection Date	Status	C6 - C12 (mg/Kg)	>C12 - C28 (mg/Kg)	>C28 - C35 (mg/Kg)	TPH (mg/Kg)	Chloride (mg/Kg)
OCD RRAL:								
DP-03-BG	0 - 1	6/21/2016	In-Situ	<26.0	<26.0	<26.0	<26.0	59.4
DP-03-01	0 - 1	6/21/2016	Excavated	390	3,670	1,130	5,190	63.9
	1 - 2	6/21/2016	Excavated	--	--	--	--	--
	2 - 3	6/21/2016	Excavated	876	10,200	1,440	12,516	330
	3 - 4	6/21/2016	Excavated	1,080	10,500	1,370	12,950	104
	6	9/29/2016	In-Situ	<29.1	80.0	<29.1	80.0	--
	10	9/29/2016	In-Situ	<27.5	137	41.5	178.5	--
	14	9/29/2016	In-Situ	<27.2	68.8	<27.2	68.8	--
DP-03-02	0 - 1	6/21/2016	Excavated	641	12,800	2,250	15,691	608
	1 - 2	6/21/2016	Excavated	921	17,600	2,250	20,771	1,590
	2 - 3	6/21/2016	Excavated	274	7,390	1,290	8,954	1,690
	3 - 4	6/21/2016	Excavated	403	11,500	1,450	13,300	715
	6	9/29/2016	In-Situ	381	5,620	776	6,770	1,110
	7	9/29/2016	In-Situ	160	1,790	320	2,270	760
	10	10/19/2016	In-Situ	<26.6	<26.6	<26.6	<26.6	60.2
	15	10/19/2016	In-Situ	<26.3	<26.3	<26.3	<26.3	158
	20	10/19/2016	In-Situ	--	--	--	--	--
DP-03-03	0 - 1	6/21/2016	In-Situ	<28.1	379	107	486	53.7

Table 1
2RP-3876
Assessment Soil Sample Analytical Data Summary
XTO Energy, Inc., Nash Draw Tank Battery 9
Unit B (NW/4, NE/4), Section 13, Township 23 South, Range 29 East
Eddy County, New Mexico

Location	Depth (Feet)	Collection Date	Status	C6 - C12 (mg/Kg)	>C12 - C28 (mg/Kg)	>C28 - C35 (mg/Kg)	TPH (mg/Kg)	Chloride (mg/Kg)
OCD RRAL:								
	1 - 2	6/21/2016	In-Situ	--	--	--	--	--
	2 - 3	6/21/2016	In-Situ	--	--	--	--	--
							100	
DP-03-04	0 - 1	6/21/2016	Excavated	<139	3,750	857	4,607	1,680
	1 - 2	6/21/2016	Excavated	<31.6	134	41.9	175.9	275
	2 - 3	6/21/2016	In-Situ	<26.9	27.9	<26.9	27.9	--
DP-03-05	0 - 1	6/21/2016	Excavated	1,430	19,300	3,500	24,230	6,170
	1 - 2	6/21/2016	Excavated	45.3	3,800	583	4,428.30	1,170
	2 - 3	6/21/2016	Excavated	35.0	2,000	280	2,310	574
	4	9/29/2016	Excavated	<28.7	71.7	<28.7	71.7	152
	6	9/29/2016	In-Situ	<29.1	<29.1	<29.1	<29.1	755
	9	9/29/2016	In-Situ	<27.5	66.8	<27.5	66.8	494

Notes: laboratory analysis performed by Permian Basin Environmental Lab, Midland, Texas, by EPA SW-846 method 8015M (TPH) and 300.0 (chloride)
 Depth in feet below ground surface (bgs)
 mg/Kg: milligrams per kilogram equivalent to parts per million (ppm)
 RRAL: Remediation action level calculated from OCD guidance document (August 13, 1993)
 P: analysis pending

Table 2

2RP-3876

Confirmation Soil Sample Analytical Data Summary

XTO Energy, Inc., Nash Draw Tank Battery 9

Unit B (NW/4, NE/4), Section 13, Township 23 South, Range 29 East

Eddy County, New Mexico

Location	Sidewall	Depth (Feet)	Collection Date	Status	Benzene (mg/Kg)	BTEX (mg/Kg)	C6 - C12 (mg/Kg)	>C12 - C28 (mg/Kg)	>C28 - C35 (mg/Kg)	TPH (mg/Kg)
OCD RRAL:					10		50		100	
DP-03-01	South	3	11/9/2016	Excavated	<0.00114	<0.008	59.9	430	72.1	562
		3	11/18/2016	In-Situ	--	--	<28.4	<28.4	<28.4	<28.4
	East	3	11/9/2016	Excavated	<0.00111	<0.0078	52.4	1,650	339	2,041.4
		3	11/18/2016	In-Situ	--	--	<28.1	<28.1	<28.1	<28.1
	West	3	11/9/2016	In-Situ	<0.00111	<0.0078	<27.8	<27.8	<27.8	<27.8
	North	3	11/9/2016	Excavated	0.00324	0.38174	1,410	5,320	862	7,590
		5	11/18/2016	In-Situ	--	--	<27.5	<27.5	<27.5	<27.5
DP-03-02	North	4	11/9/2016	In-Situ	<0.00114	0.00411	<28.4	<28.4	<28.4	<28.4
	East	4	11/9/2016	Excavated	<0.00109	0.03843	<27.2	381	87.0	468
		4	11/18/2016	In-Situ	--	--	<28.4	<28.4	<28.4	<28.4
	South	4	11/9/2016	In-Situ	<0.00114	0.00319	<28.4	<28.4	<28.4	<28.4
	West	3	11/9/2016	In-Situ	<0.00115	0.00271	<28.7	<28.7	<28.7	<28.7
DP-03-05	North	2	11/9/2016	In-Situ	<0.00106	<0.01	<26.6	<26.6	<26.6	<26.6
	East	2	11/9/2016	Excavated	<0.00111	<0.01	<27.8	319	71.3	390.3
		4	11/18/2016	In-Situ	--	--	<27.2	<27.2	<27.2	<27.2
	South	2	11/9/2016	Excavated	<0.00111	<0.01	<27.8	1,400	427	1,830
		4	11/18/2016	In-Situ	--	--	<27.5	<27.5	<27.5	<27.5
	West	2	11/9/2016	Excavated	<0.00111	<0.01	<27.8	267	78.5	345.5
		4	11/18/2016	In-Situ	--	--	<27.2	<27.2	<27.2	<27.2

Table 1
2RP-3876
Assessment Soil Sample Analytical Data Summary
XTO Energy, Inc., Nash Draw Tank Battery 9
Unit B (NW/4, NE/4), Section 13, Township 23 South, Range 29 East
Eddy County, New Mexico

Location	Depth (Feet)	Collection Date	Status	C6 - C12 (mg/Kg)	>C12 - C28 (mg/Kg)	>C28 - C35 (mg/Kg)	TPH (mg/Kg)	Chloride (mg/Kg)
OCD RRAL: 100								
DP-03-BG	0 - 1	6/21/2016	In-Situ	<26.0	<26.0	<26.0	<26.0	59.4
DP-03-01	0 - 1	6/21/2016	In-Situ	390	3,670	1,130	5,190	63.9
	1 - 2	6/21/2016	In-Situ	--	--	--	--	--
	2 - 3	6/21/2016	In-Situ	876	10,200	1,440	12,516	330
	3 - 4	6/21/2016	In-Situ	1,080	10,500	1,370	12,950	104
	6	9/29/2016	In-Situ	<29.1	80.0	<29.1	80.0	--
	10	9/29/2016	In-Situ	<27.5	137	41.5	178.5	--
	14	9/29/2016	In-Situ	<27.2	68.8	<27.2	68.8	--
DP-03-02	0 - 1	6/21/2016	In-Situ	641	12,800	2,250	15,691	608
	1 - 2	6/21/2016	In-Situ	921	17,600	2,250	20,771	1,590
	2 - 3	6/21/2016	In-Situ	274	7,390	1,290	8,954	1,690
	3 - 4	6/21/2016	In-Situ	403	11,500	1,450	13,300	715
	6	9/29/2016	In-Situ	381	5,620	776	6,770	1,110
	7	9/29/2016	In-Situ	160	1,790	320	2,270	760
	10	10/19/2016	In-Situ	<26.6	<26.6	<26.6	<26.6	60.2
	15	10/19/2016	In-Situ	<26.3	<26.3	<26.3	<26.3	158
	20	10/19/2016	In-Situ	--	--	--	--	--
DP-03-03	0 - 1	6/21/2016	In-Situ	<28.1	379	107	486	53.7

Table 1
2RP-3876
Assessment Soil Sample Analytical Data Summary
XTO Energy, Inc., Nash Draw Tank Battery 9
Unit B (NW/4, NE/4), Section 13, Township 23 South, Range 29 East
Eddy County, New Mexico

Location	Depth (Feet)	Collection Date	Status	C6 - C12 (mg/Kg)	>C12 - C28 (mg/Kg)	>C28 - C35 (mg/Kg)	TPH (mg/Kg)	Chloride (mg/Kg)
OCD RRAL: 100								
DP-03-04	1 - 2	6/21/2016	In-Situ	--	--	--	--	--
	2 - 3	6/21/2016	In-Situ	--	--	--	--	--
	0 - 1	6/21/2016	In-Situ	<139	3,750	857	4,607	1,680
	1 - 2	6/21/2016	In-Situ	<31.6	134	41.9	175.9	275
	2 - 3	6/21/2016	In-Situ	<26.9	27.9	<26.9	27.9	--
DP-03-05	0 - 1	6/21/2016	In-Situ	1,430	19,300	3,500	24,230	6,170
	1 - 2	6/21/2016	In-Situ	45.3	3,800	583	4,428.30	1,170
	2 - 3	6/21/2016	In-Situ	35.0	2,000	280	2,310	574
	4	9/29/2016	In-Situ	<28.7	71.7	<28.7	71.7	152
	6	9/29/2016	In-Situ	<29.1	<29.1	<29.1	<29.1	755
	9	9/29/2016	In-Situ	<27.5	66.8	<27.5	66.8	494

Notes: laboratory analysis performed by Permian Basin Environmental Lab, Midland, Texas, by EPA SW-846 method 8015M (TPH) and 300.0 (chloride)
 Depth in feet below ground surface (bgs)
 mg/Kg: milligrams per kilogram equivalent to parts per million (ppm)
 RRAL: Remediation action level calculated from OCD guidance document (August 13, 1993)
 P: analysis pending

Figures

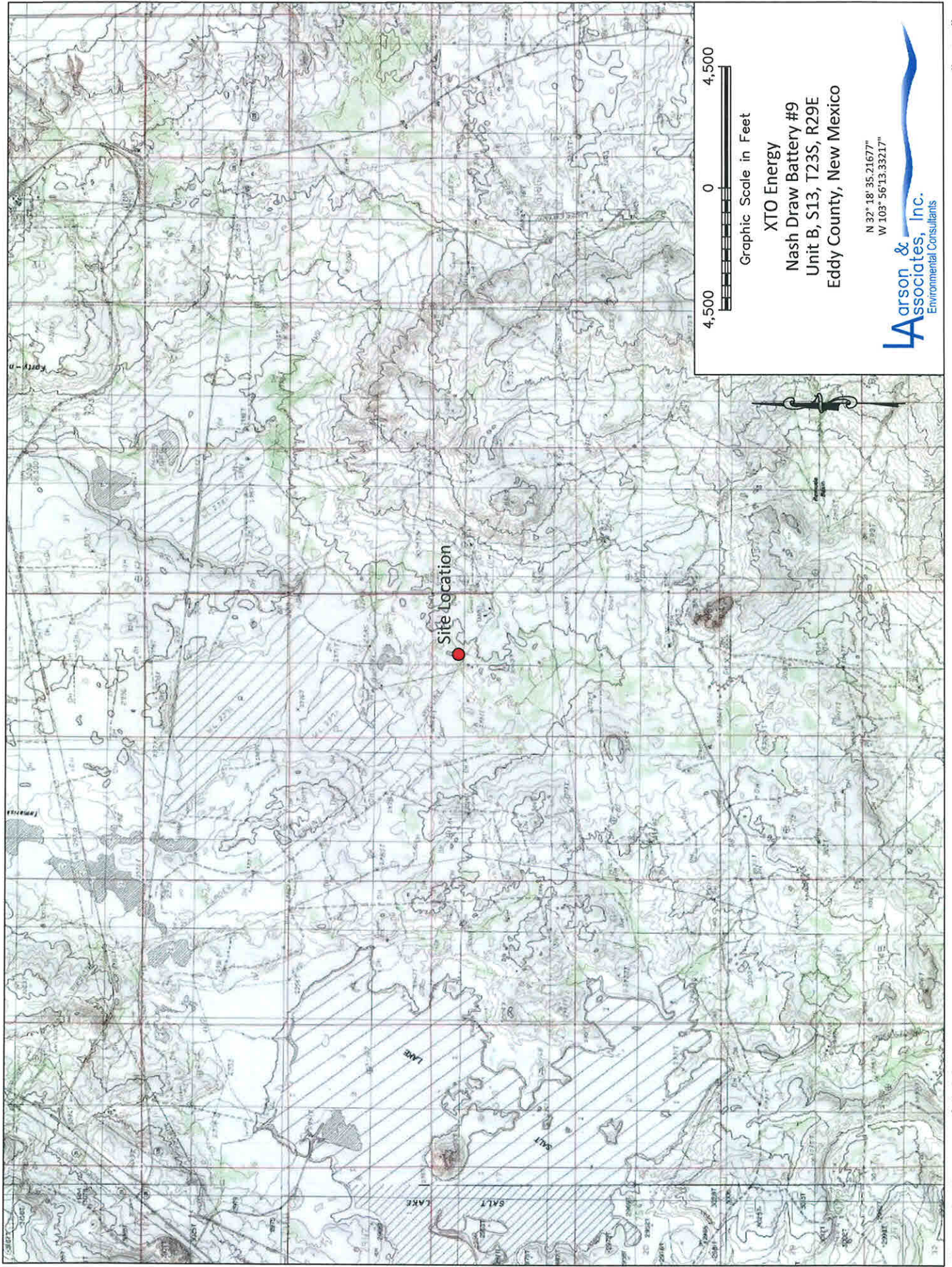

Figure 1 - Topographic Map



3/25/2017

Battery #9

100 0 100
Graphic Scale in Feet

XTO Energy
Nash Draw Battery #9
Unit B, S13, T23S, R29E
Eddy County, New Mexico

N 32° 18' 35.2167"
W 103° 56' 13.33217"

Larson & Associates, Inc.
Environmental Consultants

11" x 8.5"

Figure 2 - Aerial Map

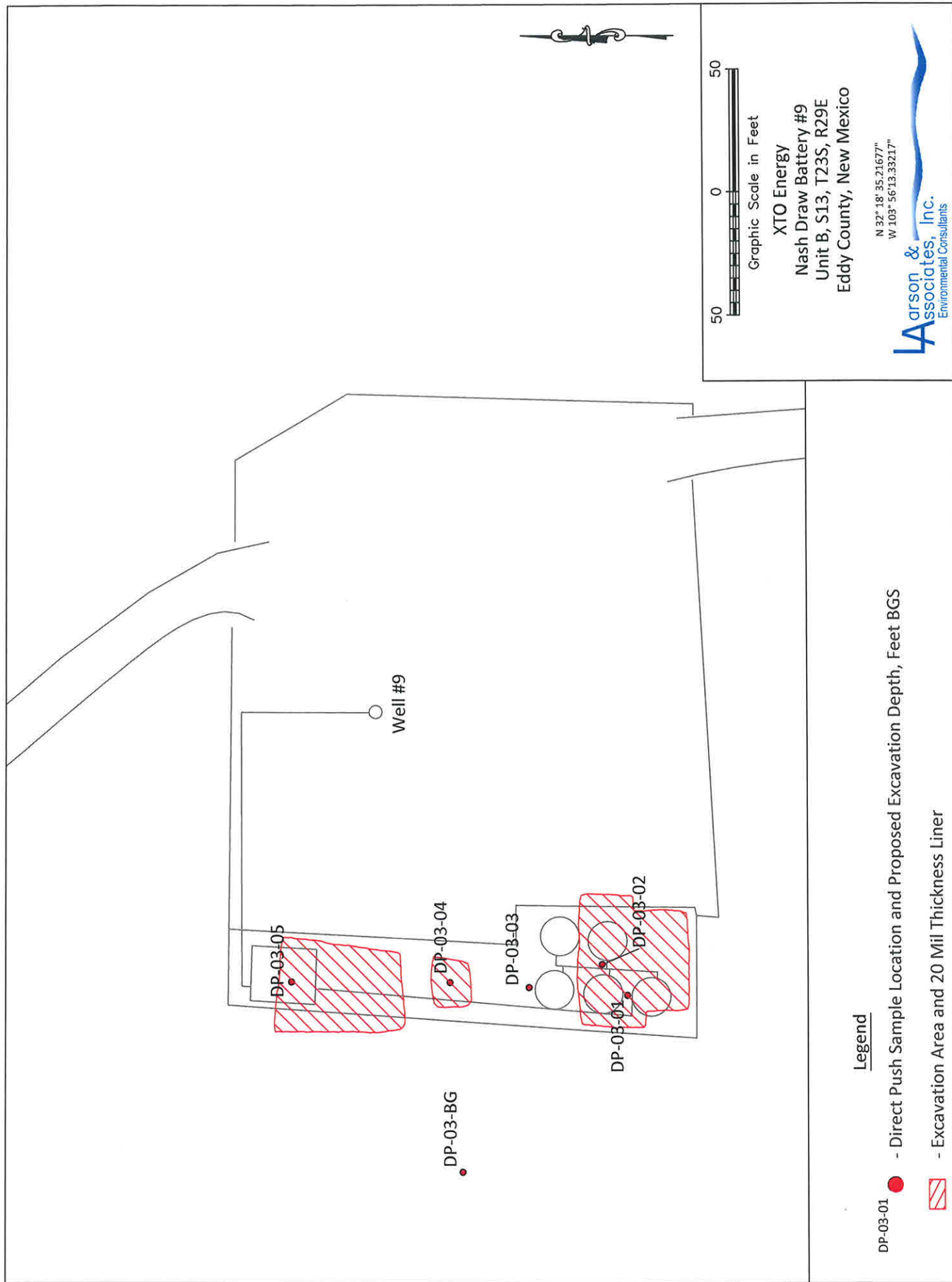

Figure 3 - Site Map Showing Excavation and Sample Locations

Appendix A
Remediation Plan Approval

From: Patterson, Heather, EMNRD [Heather.Patterson@state.nm.us]
Sent: Thursday, November 10, 2016 1:50 PM
To: Mark Larson; Bratcher, Mike, EMNRD; Weaver, Crystal, EMNRD; hprice@blm.gov
Cc: McMinn, Dudley; Williams, Luke
Subject: RE: 2RP-3876, Remediation Plan, Nash Draw Tank Battery #9, November 2, 2016

RE: XTO * Nash Draw Battery #9 * 30-015-26991 * 2RP-3876

Mark,

Your proposed remediation for the above referenced site is approved.

OCD approval does not relieve the operator of liability should their operations fail to adequately investigate and remediate contamination that may pose a threat to ground water, surface water, human health or the environment. In addition, OCD approval does not relieve the operator of responsibility for compliance with any other federal, state, local laws and/or regulations.

If you have any questions or concerns, and for notification, please contact me.

Heather Patterson
Environmental Specialist
NMOCD District II
Office (575)748-1283 ext.101
Cell (575)703-0228

From: Mark Larson [<mailto:Mark@laenvironmental.com>]
Sent: Monday, November 07, 2016 6:41 PM
To: Patterson, Heather, EMNRD; Bratcher, Mike, EMNRD; Weaver, Crystal, EMNRD; hprice@blm.gov
Cc: McMinn, Dudley; Williams, Luke
Subject: Re: 2RP-3876, Remediation Plan, Nash Draw Tank Battery #9, November 2, 2016

All,

Please find attached remediation plan for the Nash Draw Tank Battery #9. The plan was revised to include BTEX in excavation samples, where applicable, and the laboratory report for soil samples collected on September 29, 2016. Remediation will commence on Tuesday, November 8, 2016, per our verbal discussion and approval yesterday. Please contact Dudley McMinn with XTO at (432) 682-8873 or me if you have questions.

Respectfully,

Mark J. Larson, P.G.
President/Sr. Project Manager
507 N. Marienfeld St., Suite 205
Midland, Texas 79701
Office – 432-687-0901
Cell – 432- 556-8656
Fax – 432-687-0456
mark@laenvironmental.com

Appendix B

Laboratory Reports

**PERMIAN BASIN
ENVIRONMENTAL LAB, LP
1400 Rankin Hwy
Midland, TX 79701**



Analytical Report

Prepared for:

Mark Larson
Larson & Associates, Inc.
P.O. Box 50685
Midland, TX 79710

Project: Nash Draw Battery #9

Project Number: 11-0108-03

Location: Eddy Co., NM

Lab Order Number: 6K14002



NELAP/TCEQ # T104704156-13-3

Report Date: 11/15/16

Larson & Associates, Inc.
P.O. Box 50685
Midland TX, 79710

Project: Nash Draw Battery #9
Project Number: 11-0108-03
Project Manager: Mark Larson

Fax: (432) 687-0456

ANALYTICAL REPORT FOR SAMPLES

Sample ID	Laboratory ID	Matrix	Date Sampled	Date Received
DP-03-01,S3	6K14002-01	Soil	11/09/16 09:40	11-11-2016 16:00
DP-03-01,E3	6K14002-02	Soil	11/09/16 09:45	11-11-2016 16:00
DP-03-01,W3	6K14002-03	Soil	11/09/16 09:50	11-11-2016 16:00
DP-03-01,N3	6K14002-04	Soil	11/09/16 09:55	11-11-2016 16:00
DP-03-02, N4	6K14002-05	Soil	11/09/16 13:50	11-11-2016 16:00
DP-03-02, E4	6K14002-06	Soil	11/09/16 13:56	11-11-2016 16:00
DP-03-02, S4	6K14002-07	Soil	11/09/16 14:00	11-11-2016 16:00
DP-03-02, W3	6K14002-08	Soil	11/09/16 14:05	11-11-2016 16:00
DP-03-05, N2	6K14002-09	Soil	11/09/16 15:30	11-11-2016 16:00
DP-03-05, E2	6K14002-10	Soil	11/09/16 15:42	11-11-2016 16:00
DP-03-05, S2	6K14002-11	Soil	11/09/16 15:45	11-11-2016 16:00
DP-03-05, W2	6K14002-12	Soil	11/09/16 15:48	11-11-2016 16:00

Larson & Associates, Inc.
P.O. Box 50685
Midland TX, 79710

Project: Nash Draw Battery #9
Project Number: 11-0108-03
Project Manager: Mark Larson

Fax: (432) 687-0456

DP-03-01,S3
6K14002-01 (Soil)

Analyte	Result	Reporting Limit	Units	Dilution	Batch	Prepared	Analyzed	Method	Notes
---------	--------	--------------------	-------	----------	-------	----------	----------	--------	-------

Permian Basin Environmental Lab, L.P.

Organics by GC

Benzene	ND	0.00114	mg/kg dry	1	P6K1401	11/14/16	11/14/16	EPA 8021B	
Toluene	ND	0.00227	mg/kg dry	1	P6K1401	11/14/16	11/14/16	EPA 8021B	
Ethylbenzene	ND	0.00114	mg/kg dry	1	P6K1401	11/14/16	11/14/16	EPA 8021B	
Xylene (p/m)	ND	0.00227	mg/kg dry	1	P6K1401	11/14/16	11/14/16	EPA 8021B	
Xylene (o)	ND	0.00114	mg/kg dry	1	P6K1401	11/14/16	11/14/16	EPA 8021B	
Surrogate: 4-Bromofluorobenzene		77.0 %	75-125		P6K1401	11/14/16	11/14/16	EPA 8021B	
Surrogate: 1,4-Difluorobenzene		76.6 %	75-125		P6K1401	11/14/16	11/14/16	EPA 8021B	

General Chemistry Parameters by EPA / Standard Methods

% Moisture	12.0	0.1	%	1	P6K1505	11/15/16	11/15/16	% calculation	
------------	------	-----	---	---	---------	----------	----------	---------------	--

Total Petroleum Hydrocarbons C6-C35 by EPA Method 8015M

C6-C12	59.9	28.4	mg/kg dry	1	P6K1504	11/14/16	11/15/16	TPH 8015M	
>C12-C28	430	28.4	mg/kg dry	1	P6K1504	11/14/16	11/15/16	TPH 8015M	
>C28-C35	72.1	28.4	mg/kg dry	1	P6K1504	11/14/16	11/15/16	TPH 8015M	
Surrogate: 1-Chlorooctane		63.4 %	70-130		P6K1504	11/14/16	11/15/16	TPH 8015M	S-GC
Surrogate: o-Terphenyl		79.1 %	70-130		P6K1504	11/14/16	11/15/16	TPH 8015M	
Total Petroleum Hydrocarbon C6-C35	562	28.4	mg/kg dry	1	[CALC]	11/14/16	11/15/16	calc	

Permian Basin Environmental Lab, L.P.

The results in this report apply to the samples analyzed in accordance with the samples received in the laboratory. This analytical report must be reproduced in its entirety, with written approval of Permian Basin Environmental Lab.

1400 Rankin HWY Midland, TX 79701 432-686-7235

Larson & Associates, Inc.
P.O. Box 50685
Midland TX, 79710

Project: Nash Draw Battery #9
Project Number: 11-0108-03
Project Manager: Mark Larson

Fax: (432) 687-0456

DP-03-01,E3
6K14002-02 (Soil)

Analyte	Result	Reporting Limit	Units	Dilution	Batch	Prepared	Analyzed	Method	Notes
Permian Basin Environmental Lab, L.P.									
Organics by GC									
Benzene	ND	0.00111	mg/kg dry	1	P6K1401	11/14/16	11/14/16	EPA 8021B	
Toluene	ND	0.00222	mg/kg dry	1	P6K1401	11/14/16	11/14/16	EPA 8021B	
Ethylbenzene	ND	0.00111	mg/kg dry	1	P6K1401	11/14/16	11/14/16	EPA 8021B	
Xylene (p/m)	ND	0.00222	mg/kg dry	1	P6K1401	11/14/16	11/14/16	EPA 8021B	
Xylene (o)	ND	0.00111	mg/kg dry	1	P6K1401	11/14/16	11/14/16	EPA 8021B	
Surrogate: 1,4-Difluorobenzene		74.1 %	75-125		P6K1401	11/14/16	11/14/16	EPA 8021B	S-GC
Surrogate: 4-Bromofluorobenzene		80.2 %	75-125		P6K1401	11/14/16	11/14/16	EPA 8021B	
General Chemistry Parameters by EPA / Standard Methods									
% Moisture	10.0	0.1	%	1	P6K1505	11/15/16	11/15/16	% calculation	
Total Petroleum Hydrocarbons C6-C35 by EPA Method 8015M									
C6-C12	52.4	27.8	mg/kg dry	1	P6K1504	11/14/16	11/15/16	TPH 8015M	
>C12-C28	1650	27.8	mg/kg dry	1	P6K1504	11/14/16	11/15/16	TPH 8015M	
>C28-C35	339	27.8	mg/kg dry	1	P6K1504	11/14/16	11/15/16	TPH 8015M	
Surrogate: 1-Chlorooctane		68.6 %	70-130		P6K1504	11/14/16	11/15/16	TPH 8015M	S-GC
Surrogate: o-Terphenyl		87.2 %	70-130		P6K1504	11/14/16	11/15/16	TPH 8015M	
Total Petroleum Hydrocarbon C6-C35	2040	27.8	mg/kg dry	1	[CALC]	11/14/16	11/15/16	calc	

Permian Basin Environmental Lab, L.P.

The results in this report apply to the samples analyzed in accordance with the samples received in the laboratory. This analytical report must be reproduced in its entirety, with written approval of Permian Basin Environmental Lab.

1400 Rankin HWY Midland, TX 79701 432-686-7235

Larson & Associates, Inc.
P.O. Box 50685
Midland TX, 79710

Project: Nash Draw Battery #9
Project Number: 11-0108-03
Project Manager: Mark Larson

Fax: (432) 687-0456

DP-03-01,W3
6K14002-03 (Soil)

Analyte	Result	Reporting Limit	Units	Dilution	Batch	Prepared	Analyzed	Method	Notes
---------	--------	--------------------	-------	----------	-------	----------	----------	--------	-------

Permian Basin Environmental Lab, L.P.

Organics by GC

Benzene	ND	0.00111	mg/kg dry	1	P6K1401	11/14/16	11/14/16	EPA 8021B	
Toluene	ND	0.00222	mg/kg dry	1	P6K1401	11/14/16	11/14/16	EPA 8021B	
Ethylbenzene	ND	0.00111	mg/kg dry	1	P6K1401	11/14/16	11/14/16	EPA 8021B	
Xylene (p/m)	ND	0.00222	mg/kg dry	1	P6K1401	11/14/16	11/14/16	EPA 8021B	
Xylene (o)	ND	0.00111	mg/kg dry	1	P6K1401	11/14/16	11/14/16	EPA 8021B	
Surrogate: 4-Bromofluorobenzene		75.6 %	75-125		P6K1401	11/14/16	11/14/16	EPA 8021B	
Surrogate: 1,4-Difluorobenzene		73.8 %	75-125		P6K1401	11/14/16	11/14/16	EPA 8021B	S-GC

General Chemistry Parameters by EPA / Standard Methods

% Moisture	10.0	0.1	%	1	P6K1505	11/15/16	11/15/16	% calculation	
------------	------	-----	---	---	---------	----------	----------	---------------	--

Total Petroleum Hydrocarbons C6-C35 by EPA Method 8015M

C6-C12	ND	27.8	mg/kg dry	1	P6K1504	11/14/16	11/15/16	TPH 8015M	
>C12-C28	ND	27.8	mg/kg dry	1	P6K1504	11/14/16	11/15/16	TPH 8015M	
>C28-C35	ND	27.8	mg/kg dry	1	P6K1504	11/14/16	11/15/16	TPH 8015M	
Surrogate: 1-Chlorooctane		94.0 %	70-130		P6K1504	11/14/16	11/15/16	TPH 8015M	
Surrogate: o-Terphenyl		106 %	70-130		P6K1504	11/14/16	11/15/16	TPH 8015M	
Total Petroleum Hydrocarbon C6-C35	ND	27.8	mg/kg dry	1	[CALC]	11/14/16	11/15/16	calc	

Larson & Associates, Inc.
P.O. Box 50685
Midland TX, 79710

Project: Nash Draw Battery #9
Project Number: 11-0108-03
Project Manager: Mark Larson

Fax: (432) 687-0456

DP-03-01,N3
6K14002-04 (Soil)

Analyte	Result	Reporting Limit	Units	Dilution	Batch	Prepared	Analyzed	Method	Notes
---------	--------	--------------------	-------	----------	-------	----------	----------	--------	-------

Permian Basin Environmental Lab, L.P.

Organics by GC

Benzene	0.00324	0.00112	mg/kg dry	1	P6K1401	11/14/16	11/14/16	EPA 8021B	
Toluene	0.0726	0.00225	mg/kg dry	1	P6K1401	11/14/16	11/14/16	EPA 8021B	
Ethylbenzene	0.0714	0.00112	mg/kg dry	1	P6K1401	11/14/16	11/14/16	EPA 8021B	
Xylene (p/m)	0.155	0.00225	mg/kg dry	1	P6K1401	11/14/16	11/14/16	EPA 8021B	
Xylene (o)	0.0795	0.00112	mg/kg dry	1	P6K1401	11/14/16	11/14/16	EPA 8021B	
Surrogate: 1,4-Difluorobenzene		76.7 %	75-125		P6K1401	11/14/16	11/14/16	EPA 8021B	
Surrogate: 4-Bromofluorobenzene		62.7 %	75-125		P6K1401	11/14/16	11/14/16	EPA 8021B	S-GC

General Chemistry Parameters by EPA / Standard Methods

% Moisture	11.0	0.1	%	1	P6K1505	11/15/16	11/15/16	% calculation	
------------	------	-----	---	---	---------	----------	----------	---------------	--

Total Petroleum Hydrocarbons C6-C35 by EPA Method 8015M

C6-C12	1410	281	mg/kg dry	10	P6K1504	11/14/16	11/15/16	TPH 8015M	
>C12-C28	5320	281	mg/kg dry	10	P6K1504	11/14/16	11/15/16	TPH 8015M	
>C28-C35	862	281	mg/kg dry	10	P6K1504	11/14/16	11/15/16	TPH 8015M	
Surrogate: 1-Chlorooctane		92.7 %	70-130		P6K1504	11/14/16	11/15/16	TPH 8015M	
Surrogate: o-Terphenyl		96.6 %	70-130		P6K1504	11/14/16	11/15/16	TPH 8015M	
Total Petroleum Hydrocarbon C6-C35	7590	281	mg/kg dry	10	[CALC]	11/14/16	11/15/16	calc	

Permian Basin Environmental Lab, L.P.

The results in this report apply to the samples analyzed in accordance with the samples received in the laboratory. This analytical report must be reproduced in its entirety, with written approval of Permian Basin Environmental Lab.

1400 Rankin HWY Midland, TX 79701 432-686-7235

Page 6 of 21

Larson & Associates, Inc.
P.O. Box 50685
Midland TX, 79710

Project: Nash Draw Battery #9
Project Number: 11-0108-03
Project Manager: Mark Larson

Fax: (432) 687-0456

DP-03-02, N4
6K14002-05 (Soil)

Analyte	Result	Reporting Limit	Units	Dilution	Batch	Prepared	Analyzed	Method	Notes
---------	--------	--------------------	-------	----------	-------	----------	----------	--------	-------

Permian Basin Environmental Lab, L.P.

Organics by GC

Benzene	ND	0.00114	mg/kg dry	1	P6K1401	11/14/16	11/14/16	EPA 8021B	
Toluene	0.00411	0.00227	mg/kg dry	1	P6K1401	11/14/16	11/14/16	EPA 8021B	
Ethylbenzene	ND	0.00114	mg/kg dry	1	P6K1401	11/14/16	11/14/16	EPA 8021B	
Xylene (p/m)	ND	0.00227	mg/kg dry	1	P6K1401	11/14/16	11/14/16	EPA 8021B	
Xylene (o)	ND	0.00114	mg/kg dry	1	P6K1401	11/14/16	11/14/16	EPA 8021B	
Surrogate: 4-Bromofluorobenzene		90.1 %	75-125		P6K1401	11/14/16	11/14/16	EPA 8021B	
Surrogate: 1,4-Difluorobenzene		70.4 %	75-125		P6K1401	11/14/16	11/14/16	EPA 8021B	S-GC

General Chemistry Parameters by EPA / Standard Methods

% Moisture	12.0	0.1	%	1	P6K1505	11/15/16	11/15/16	% calculation	
------------	------	-----	---	---	---------	----------	----------	---------------	--

Total Petroleum Hydrocarbons C6-C35 by EPA Method 8015M

C6-C12	ND	28.4	mg/kg dry	1	P6K1504	11/14/16	11/15/16	TPH 8015M	
>C12-C28	ND	28.4	mg/kg dry	1	P6K1504	11/14/16	11/15/16	TPH 8015M	
>C28-C35	ND	28.4	mg/kg dry	1	P6K1504	11/14/16	11/15/16	TPH 8015M	
Surrogate: 1-Chlorooctane		75.8 %	70-130		P6K1504	11/14/16	11/15/16	TPH 8015M	
Surrogate: o-Terphenyl		85.4 %	70-130		P6K1504	11/14/16	11/15/16	TPH 8015M	
Total Petroleum Hydrocarbon C6-C35	ND	28.4	mg/kg dry	1	[CALC]	11/14/16	11/15/16	calc	

Permian Basin Environmental Lab, L.P.

The results in this report apply to the samples analyzed in accordance with the samples received in the laboratory. This analytical report must be reproduced in its entirety, with written approval of Permian Basin Environmental Lab.

1400 Rankin HWY Midland, TX 79701 432-686-7235

Larson & Associates, Inc.
P.O. Box 50685
Midland TX, 79710

Project: Nash Draw Battery #9
Project Number: 11-0108-03
Project Manager: Mark Larson

Fax: (432) 687-0456

DP-03-02, E4
6K14002-06 (Soil)

Analyte	Result	Reporting Limit	Units	Dilution	Batch	Prepared	Analyzed	Method	Notes
Permian Basin Environmental Lab, L.P.									
Organics by GC									
Benzene	ND	0.00109	mg/kg dry	1	P6K1401	11/14/16	11/14/16	EPA 8021B	
Toluene	0.0203	0.00217	mg/kg dry	1	P6K1401	11/14/16	11/14/16	EPA 8021B	
Ethylbenzene	0.00543	0.00109	mg/kg dry	1	P6K1401	11/14/16	11/14/16	EPA 8021B	
Xylene (p/m)	0.00818	0.00217	mg/kg dry	1	P6K1401	11/14/16	11/14/16	EPA 8021B	
Xylene (o)	0.00452	0.00109	mg/kg dry	1	P6K1401	11/14/16	11/14/16	EPA 8021B	
Surrogate: 4-Bromofluorobenzene		83.1 %	75-125		P6K1401	11/14/16	11/14/16	EPA 8021B	
Surrogate: 1,4-Difluorobenzene		75.3 %	75-125		P6K1401	11/14/16	11/14/16	EPA 8021B	
General Chemistry Parameters by EPA / Standard Methods									
% Moisture	8.0	0.1	%	1	P6K1505	11/15/16	11/15/16	% calculation	
Total Petroleum Hydrocarbons C6-C35 by EPA Method 8015M									
C6-C12	ND	27.2	mg/kg dry	1	P6K1504	11/14/16	11/15/16	TPH 8015M	
>C12-C28	381	27.2	mg/kg dry	1	P6K1504	11/14/16	11/15/16	TPH 8015M	
>C28-C35	87.0	27.2	mg/kg dry	1	P6K1504	11/14/16	11/15/16	TPH 8015M	
Surrogate: 1-Chlorooctane		75.8 %	70-130		P6K1504	11/14/16	11/15/16	TPH 8015M	
Surrogate: o-Terphenyl		87.4 %	70-130		P6K1504	11/14/16	11/15/16	TPH 8015M	
Total Petroleum Hydrocarbon C6-C35	468	27.2	mg/kg dry	1	[CALC]	11/14/16	11/15/16	calc	

Larson & Associates, Inc.
P.O. Box 50685
Midland TX, 79710

Project: Nash Draw Battery #9
Project Number: 11-0108-03
Project Manager: Mark Larson

Fax: (432) 687-0456

DP-03-02, S4
6K14002-07 (Soil)

Analyte	Result	Reporting Limit	Units	Dilution	Batch	Prepared	Analyzed	Method	Notes
---------	--------	--------------------	-------	----------	-------	----------	----------	--------	-------

Permian Basin Environmental Lab, L.P.

Organics by GC

Benzene	ND	0.00114	mg/kg dry	1	P6K1401	11/14/16	11/14/16	EPA 8021B	
Toluene	0.00319	0.00227	mg/kg dry	1	P6K1401	11/14/16	11/14/16	EPA 8021B	
Ethylbenzene	ND	0.00114	mg/kg dry	1	P6K1401	11/14/16	11/14/16	EPA 8021B	
Xylene (p/m)	ND	0.00227	mg/kg dry	1	P6K1401	11/14/16	11/14/16	EPA 8021B	
Xylene (o)	ND	0.00114	mg/kg dry	1	P6K1401	11/14/16	11/14/16	EPA 8021B	
Surrogate: 1,4-Difluorobenzene		69.6 %	75-125		P6K1401	11/14/16	11/14/16	EPA 8021B	S-GC
Surrogate: 4-Bromofluorobenzene		75.7 %	75-125		P6K1401	11/14/16	11/14/16	EPA 8021B	

General Chemistry Parameters by EPA / Standard Methods

% Moisture	12.0	0.1	%	1	P6K1505	11/15/16	11/15/16	% calculation	
------------	------	-----	---	---	---------	----------	----------	---------------	--

Total Petroleum Hydrocarbons C6-C35 by EPA Method 8015M

C6-C12	ND	28.4	mg/kg dry	1	P6K1504	11/14/16	11/15/16	TPH 8015M	
>C12-C28	ND	28.4	mg/kg dry	1	P6K1504	11/14/16	11/15/16	TPH 8015M	
>C28-C35	ND	28.4	mg/kg dry	1	P6K1504	11/14/16	11/15/16	TPH 8015M	
Surrogate: 1-Chlorooctane		68.9 %	70-130		P6K1504	11/14/16	11/15/16	TPH 8015M	S-GC
Surrogate: o-Terphenyl		78.5 %	70-130		P6K1504	11/14/16	11/15/16	TPH 8015M	
Total Petroleum Hydrocarbon C6-C35	ND	28.4	mg/kg dry	1	[CALC]	11/14/16	11/15/16	calc	

Larson & Associates, Inc.
P.O. Box 50685
Midland TX, 79710

Project: Nash Draw Battery #9
Project Number: 11-0108-03
Project Manager: Mark Larson

Fax: (432) 687-0456

DP-03-02, W3
6K14002-08 (Soil)

Analyte	Result	Reporting Limit	Units	Dilution	Batch	Prepared	Analyzed	Method	Notes
---------	--------	--------------------	-------	----------	-------	----------	----------	--------	-------

Permian Basin Environmental Lab, L.P.

Organics by GC

Benzene	ND	0.00115	mg/kg dry	1	P6K1401	11/14/16	11/14/16	EPA 8021B	
Toluene	ND	0.00230	mg/kg dry	1	P6K1401	11/14/16	11/14/16	EPA 8021B	
Ethylbenzene	ND	0.00115	mg/kg dry	1	P6K1401	11/14/16	11/14/16	EPA 8021B	
Xylene (p/m)	0.00271	0.00230	mg/kg dry	1	P6K1401	11/14/16	11/14/16	EPA 8021B	
Xylene (o)	0.00144	0.00115	mg/kg dry	1	P6K1401	11/14/16	11/14/16	EPA 8021B	
Surrogate: 4-Bromofluorobenzene		76.5 %	75-125		P6K1401	11/14/16	11/14/16	EPA 8021B	
Surrogate: 1,4-Difluorobenzene		69.5 %	75-125		P6K1401	11/14/16	11/14/16	EPA 8021B	S-GC

General Chemistry Parameters by EPA / Standard Methods

% Moisture	13.0	0.1	%	1	P6K1505	11/15/16	11/15/16	% calculation	
------------	------	-----	---	---	---------	----------	----------	---------------	--

Total Petroleum Hydrocarbons C6-C35 by EPA Method 8015M

C6-C12	ND	28.7	mg/kg dry	1	P6K1504	11/14/16	11/15/16	TPH 8015M	
>C12-C28	ND	28.7	mg/kg dry	1	P6K1504	11/14/16	11/15/16	TPH 8015M	
>C28-C35	ND	28.7	mg/kg dry	1	P6K1504	11/14/16	11/15/16	TPH 8015M	
Surrogate: 1-Chlorooctane		73.4 %	70-130		P6K1504	11/14/16	11/15/16	TPH 8015M	
Surrogate: o-Terphenyl		83.2 %	70-130		P6K1504	11/14/16	11/15/16	TPH 8015M	
Total Petroleum Hydrocarbon C6-C35	ND	28.7	mg/kg dry	1	[CALC]	11/14/16	11/15/16	calc	

Permian Basin Environmental Lab, L.P.

The results in this report apply to the samples analyzed in accordance with the samples received in the laboratory. This analytical report must be reproduced in its entirety, with written approval of Permian Basin Environmental Lab.

1400 Rankin HWY Midland, TX 79701 432-686-7235

Larson & Associates, Inc.
P.O. Box 50685
Midland TX, 79710

Project: Nash Draw Battery #9
Project Number: 11-0108-03
Project Manager: Mark Larson

Fax: (432) 687-0456

DP-03-05, N2
6K14002-09 (Soil)

Analyte	Result	Reporting Limit	Units	Dilution	Batch	Prepared	Analyzed	Method	Notes
---------	--------	--------------------	-------	----------	-------	----------	----------	--------	-------

Permian Basin Environmental Lab, L.P.

Organics by GC

Benzene	ND	0.00106	mg/kg dry	1	P6K1502	11/15/16	11/15/16	EPA 8021B	
Toluene	ND	0.00213	mg/kg dry	1	P6K1502	11/15/16	11/15/16	EPA 8021B	
Ethylbenzene	ND	0.00106	mg/kg dry	1	P6K1502	11/15/16	11/15/16	EPA 8021B	
Xylene (p/m)	ND	0.00213	mg/kg dry	1	P6K1502	11/15/16	11/15/16	EPA 8021B	
Xylene (o)	ND	0.00106	mg/kg dry	1	P6K1502	11/15/16	11/15/16	EPA 8021B	
Surrogate: 1,4-Difluorobenzene		74.4 %	75-125		P6K1502	11/15/16	11/15/16	EPA 8021B	S-GC
Surrogate: 4-Bromofluorobenzene		76.7 %	75-125		P6K1502	11/15/16	11/15/16	EPA 8021B	

General Chemistry Parameters by EPA / Standard Methods

% Moisture	6.0	0.1	%	1	P6K1505	11/15/16	11/15/16	% calculation	
------------	-----	-----	---	---	---------	----------	----------	---------------	--

Total Petroleum Hydrocarbons C6-C35 by EPA Method 8015M

C6-C12	ND	26.6	mg/kg dry	1	P6K1504	11/14/16	11/15/16	TPH 8015M	
>C12-C28	ND	26.6	mg/kg dry	1	P6K1504	11/14/16	11/15/16	TPH 8015M	
>C28-C35	ND	26.6	mg/kg dry	1	P6K1504	11/14/16	11/15/16	TPH 8015M	
Surrogate: 1-Chlorooctane		67.9 %	70-130		P6K1504	11/14/16	11/15/16	TPH 8015M	S-GC
Surrogate: o-Terphenyl		80.2 %	70-130		P6K1504	11/14/16	11/15/16	TPH 8015M	
Total Petroleum Hydrocarbon C6-C35	ND	26.6	mg/kg dry	1	[CALC]	11/14/16	11/15/16	calc	

Larson & Associates, Inc.
P.O. Box 50685
Midland TX, 79710

Project: Nash Draw Battery #9
Project Number: 11-0108-03
Project Manager: Mark Larson

Fax: (432) 687-0456

DP-03-05, E2
6K14002-10 (Soil)

Analyte	Result	Reporting Limit	Units	Dilution	Batch	Prepared	Analyzed	Method	Notes
---------	--------	--------------------	-------	----------	-------	----------	----------	--------	-------

Permian Basin Environmental Lab, L.P.

Organics by GC

Benzene	ND	0.00111	mg/kg dry	1	P6K1502	11/15/16	11/15/16	EPA 8021B	
Toluene	ND	0.00222	mg/kg dry	1	P6K1502	11/15/16	11/15/16	EPA 8021B	
Ethylbenzene	ND	0.00111	mg/kg dry	1	P6K1502	11/15/16	11/15/16	EPA 8021B	
Xylene (p/m)	ND	0.00222	mg/kg dry	1	P6K1502	11/15/16	11/15/16	EPA 8021B	
Xylene (o)	ND	0.00111	mg/kg dry	1	P6K1502	11/15/16	11/15/16	EPA 8021B	
Surrogate: 1,4-Difluorobenzene		97.0 %	75-125		P6K1502	11/15/16	11/15/16	EPA 8021B	
Surrogate: 4-Bromofluorobenzene		99.3 %	75-125		P6K1502	11/15/16	11/15/16	EPA 8021B	

General Chemistry Parameters by EPA / Standard Methods

% Moisture	10.0	0.1	%	1	P6K1505	11/15/16	11/15/16	% calculation	
------------	------	-----	---	---	---------	----------	----------	---------------	--

Total Petroleum Hydrocarbons C6-C35 by EPA Method 8015M

C6-C12	ND	27.8	mg/kg dry	1	P6K1504	11/14/16	11/15/16	TPH 8015M	
>C12-C28	319	27.8	mg/kg dry	1	P6K1504	11/14/16	11/15/16	TPH 8015M	
>C28-C35	71.3	27.8	mg/kg dry	1	P6K1504	11/14/16	11/15/16	TPH 8015M	
Surrogate: 1-Chlorooctane		69.4 %	70-130		P6K1504	11/14/16	11/15/16	TPH 8015M	S-GC
Surrogate: o-Terphenyl		81.5 %	70-130		P6K1504	11/14/16	11/15/16	TPH 8015M	
Total Petroleum Hydrocarbon C6-C35	391	27.8	mg/kg dry	1	[CALC]	11/14/16	11/15/16	calc	

Larson & Associates, Inc.
P.O. Box 50685
Midland TX, 79710

Project: Nash Draw Battery #9
Project Number: 11-0108-03
Project Manager: Mark Larson

Fax: (432) 687-0456

DP-03-05, S2
6K14002-11 (Soil)

Analyte	Result	Reporting Limit	Units	Dilution	Batch	Prepared	Analyzed	Method	Notes
---------	--------	--------------------	-------	----------	-------	----------	----------	--------	-------

Permian Basin Environmental Lab, L.P.

Organics by GC

Benzene	ND	0.00111	mg/kg dry	1	P6K1502	11/15/16	11/15/16	EPA 8021B	
Toluene	ND	0.00222	mg/kg dry	1	P6K1502	11/15/16	11/15/16	EPA 8021B	
Ethylbenzene	ND	0.00111	mg/kg dry	1	P6K1502	11/15/16	11/15/16	EPA 8021B	
Xylene (p/m)	ND	0.00222	mg/kg dry	1	P6K1502	11/15/16	11/15/16	EPA 8021B	
Xylene (o)	ND	0.00111	mg/kg dry	1	P6K1502	11/15/16	11/15/16	EPA 8021B	
Surrogate: 4-Bromofluorobenzene		76.9 %	75-125		P6K1502	11/15/16	11/15/16	EPA 8021B	
Surrogate: 1,4-Difluorobenzene		77.2 %	75-125		P6K1502	11/15/16	11/15/16	EPA 8021B	

General Chemistry Parameters by EPA / Standard Methods

% Moisture	10.0	0.1	%	1	P6K1505	11/15/16	11/15/16	% calculation	
------------	------	-----	---	---	---------	----------	----------	---------------	--

Total Petroleum Hydrocarbons C6-C35 by EPA Method 8015M

C6-C12	ND	27.8	mg/kg dry	1	P6K1504	11/14/16	11/15/16	TPH 8015M	
>C12-C28	1400	27.8	mg/kg dry	1	P6K1504	11/14/16	11/15/16	TPH 8015M	
>C28-C35	427	27.8	mg/kg dry	1	P6K1504	11/14/16	11/15/16	TPH 8015M	
Surrogate: 1-Chlorooctane		72.8 %	70-130		P6K1504	11/14/16	11/15/16	TPH 8015M	
Surrogate: o-Terphenyl		85.5 %	70-130		P6K1504	11/14/16	11/15/16	TPH 8015M	
Total Petroleum Hydrocarbon C6-C35	1830	27.8	mg/kg dry	1	[CALC]	11/14/16	11/15/16	calc	

Larson & Associates, Inc.
P.O. Box 50685
Midland TX, 79710

Project: Nash Draw Battery #9
Project Number: 11-0108-03
Project Manager: Mark Larson

Fax: (432) 687-0456

DP-03-05, W2
6K14002-12 (Soil)

Analyte	Result	Reporting Limit	Units	Dilution	Batch	Prepared	Analyzed	Method	Notes
---------	--------	--------------------	-------	----------	-------	----------	----------	--------	-------

Permian Basin Environmental Lab, L.P.

Organics by GC

Benzene	ND	0.00111	mg/kg dry	1	P6K1502	11/15/16	11/15/16	EPA 8021B	
Toluene	0.00604	0.00222	mg/kg dry	1	P6K1502	11/15/16	11/15/16	EPA 8021B	
Ethylbenzene	0.00254	0.00111	mg/kg dry	1	P6K1502	11/15/16	11/15/16	EPA 8021B	
Xylene (p/m)	0.00656	0.00222	mg/kg dry	1	P6K1502	11/15/16	11/15/16	EPA 8021B	
Xylene (o)	0.00237	0.00111	mg/kg dry	1	P6K1502	11/15/16	11/15/16	EPA 8021B	
Surrogate: 1,4-Difluorobenzene		75.8 %	75-125		P6K1502	11/15/16	11/15/16	EPA 8021B	
Surrogate: 4-Bromofluorobenzene		78.2 %	75-125		P6K1502	11/15/16	11/15/16	EPA 8021B	

General Chemistry Parameters by EPA / Standard Methods

% Moisture	10.0	0.1	%	1	P6K1505	11/15/16	11/15/16	% calculation	
------------	------	-----	---	---	---------	----------	----------	---------------	--

Total Petroleum Hydrocarbons C6-C35 by EPA Method 8015M

C6-C12	ND	27.8	mg/kg dry	1	P6K1504	11/14/16	11/15/16	TPH 8015M	
>C12-C28	267	27.8	mg/kg dry	1	P6K1504	11/14/16	11/15/16	TPH 8015M	
>C28-C35	78.5	27.8	mg/kg dry	1	P6K1504	11/14/16	11/15/16	TPH 8015M	
Surrogate: 1-Chlorooctane		73.9 %	70-130		P6K1504	11/14/16	11/15/16	TPH 8015M	
Surrogate: o-Terphenyl		85.8 %	70-130		P6K1504	11/14/16	11/15/16	TPH 8015M	
Total Petroleum Hydrocarbon C6-C35	346	27.8	mg/kg dry	1	[CALC]	11/14/16	11/15/16	calc	

Permian Basin Environmental Lab, L.P.

The results in this report apply to the samples analyzed in accordance with the samples received in the laboratory. This analytical report must be reproduced in its entirety, with written approval of Permian Basin Environmental Lab.

1400 Rankin HWY Midland, TX 79701 432-686-7235

Larson & Associates, Inc.
P.O. Box 50685
Midland TX, 79710

Project: Nash Draw Battery #9
Project Number: 11-0108-03
Project Manager: Mark Larson

Fax: (432) 687-0456

Organics by GC - Quality Control
Permian Basin Environmental Lab, L.P.

Analyte	Result	Reporting Limit	Units	Spike Level	Source Result	%REC	%REC Limits	RPD	RPD Limit	Notes
---------	--------	--------------------	-------	----------------	------------------	------	----------------	-----	--------------	-------

Batch P6K1401 - General Preparation (GC)

Blank (P6K1401-BLK1)

Prepared & Analyzed: 11/14/16

Benzene	ND	0.00100	mg/kg wet							
Toluene	ND	0.00200	"							
Ethylbenzene	ND	0.00100	"							
Xylene (p/m)	ND	0.00200	"							
Xylene (o)	ND	0.00100	"							
Surrogate: 1,4-Difluorobenzene	0.0567		"	0.0800		70.9	75-125			S-GC
Surrogate: 4-Bromofluorobenzene	0.0619		"	0.0800		77.4	75-125			

LCS (P6K1401-BS1)

Prepared & Analyzed: 11/14/16

Benzene	0.0868	0.00100	mg/kg wet	0.100		86.8	70-130			
Toluene	0.0915	0.00200	"	0.100		91.5	70-130			
Ethylbenzene	0.104	0.00100	"	0.100		104	70-130			
Xylene (p/m)	0.191	0.00200	"	0.200		95.5	70-130			
Xylene (o)	0.0940	0.00100	"	0.100		94.0	70-130			
Surrogate: 1,4-Difluorobenzene	0.0606		"	0.0800		75.7	75-125			
Surrogate: 4-Bromofluorobenzene	0.0635		"	0.0800		79.4	75-125			

LCS Dup (P6K1401-BSD1)

Prepared & Analyzed: 11/14/16

Benzene	0.0861	0.00100	mg/kg wet	0.100		86.1	70-130	0.879	20	
Toluene	0.0927	0.00200	"	0.100		92.7	70-130	1.33	20	
Ethylbenzene	0.109	0.00100	"	0.100		109	70-130	4.75	20	
Xylene (p/m)	0.194	0.00200	"	0.200		96.9	70-130	1.48	20	
Xylene (o)	0.0963	0.00100	"	0.100		96.3	70-130	2.48	20	
Surrogate: 1,4-Difluorobenzene	0.0610		"	0.0800		76.3	75-125			
Surrogate: 4-Bromofluorobenzene	0.0660		"	0.0800		82.5	75-125			

Matrix Spike (P6K1401-MS1)

Source: 6K14001-01

Prepared & Analyzed: 11/14/16

Benzene	0.140	0.00118	mg/kg dry	0.235	ND	59.4	80-120			QM-07
Toluene	0.149	0.00235	"	0.235	ND	63.2	80-120			QM-07
Ethylbenzene	0.153	0.00118	"	0.235	ND	64.8	80-120			QM-07
Xylene (p/m)	0.292	0.00235	"	0.471	ND	62.1	80-120			QM-07
Xylene (o)	0.151	0.00118	"	0.235	ND	64.0	80-120			QM-07
Surrogate: 1,4-Difluorobenzene	0.0725		"	0.0941		77.0	75-125			
Surrogate: 4-Bromofluorobenzene	0.0774		"	0.0941		82.2	75-125			

Permian Basin Environmental Lab, L.P.

The results in this report apply to the samples analyzed in accordance with the samples received in the laboratory. This analytical report must be reproduced in its entirety, with written approval of Permian Basin Environmental Lab.

1400 Rankin HWY Midland, TX 79701 432-686-7235

Page 15 of 21

Larson & Associates, Inc.
P.O. Box 50685
Midland TX, 79710

Project: Nash Draw Battery #9
Project Number: 11-0108-03
Project Manager: Mark Larson

Fax: (432) 687-0456

Organics by GC - Quality Control
Permian Basin Environmental Lab, L.P.

Analyte	Result	Reporting Limit	Units	Spike Level	Source Result	%REC	%REC Limits	RPD	RPD Limit	Notes
---------	--------	--------------------	-------	----------------	------------------	------	----------------	-----	--------------	-------

Batch P6K1401 - General Preparation (GC)

Matrix Spike Dup (P6K1401-MSD1)

Source: 6K14001-01

Prepared & Analyzed: 11/14/16

Benzene	0.149	0.00118	mg/kg dry	0.235	ND	63.1	80-120	6.16	20	QM-07
Toluene	0.154	0.00235	"	0.235	ND	65.6	80-120	3.76	20	QM-07
Ethylbenzene	0.163	0.00118	"	0.235	ND	69.4	80-120	6.74	20	QM-07
Xylene (p/m)	0.307	0.00235	"	0.471	ND	65.2	80-120	4.94	20	QM-07
Xylene (o)	0.161	0.00118	"	0.235	ND	68.3	80-120	6.50	20	QM-07
Surrogate: 4-Bromofluorobenzene	0.0799		"	0.0941		84.9	75-125			
Surrogate: 1,4-Difluorobenzene	0.0762		"	0.0941		81.0	75-125			

Batch P6K1502 - General Preparation (GC)

Blank (P6K1502-BLK1)

Prepared & Analyzed: 11/15/16

Benzene	ND	0.00100	mg/kg wet							
Toluene	ND	0.00200	"							
Ethylbenzene	ND	0.00100	"							
Xylene (p/m)	ND	0.00200	"							
Xylene (o)	ND	0.00100	"							
Surrogate: 1,4-Difluorobenzene	0.0576		"	0.0800		72.0	75-125			S-GC
Surrogate: 4-Bromofluorobenzene	0.0629		"	0.0800		78.6	75-125			

LCS (P6K1502-BS1)

Prepared & Analyzed: 11/15/16

Benzene	0.0890	0.00100	mg/kg wet	0.100		89.0	70-130			
Toluene	0.0932	0.00200	"	0.100		93.2	70-130			
Ethylbenzene	0.106	0.00100	"	0.100		106	70-130			
Xylene (p/m)	0.194	0.00200	"	0.200		96.8	70-130			
Xylene (o)	0.0956	0.00100	"	0.100		95.6	70-130			
Surrogate: 4-Bromofluorobenzene	0.0662		"	0.0800		82.8	75-125			
Surrogate: 1,4-Difluorobenzene	0.0645		"	0.0800		80.6	75-125			

Permian Basin Environmental Lab, L.P.

The results in this report apply to the samples analyzed in accordance with the samples received in the laboratory. This analytical report must be reproduced in its entirety, with written approval of Permian Basin Environmental Lab.

Larson & Associates, Inc.
P.O. Box 50685
Midland TX, 79710

Project: Nash Draw Battery #9
Project Number: 11-0108-03
Project Manager: Mark Larson

Fax: (432) 687-0456

Organics by GC - Quality Control
Permian Basin Environmental Lab, L.P.

Analyte	Result	Reporting Limit	Units	Spike Level	Source Result	%REC	%REC Limits	RPD	RPD Limit	Notes
---------	--------	--------------------	-------	----------------	------------------	------	----------------	-----	--------------	-------

Batch P6K1502 - General Preparation (GC)

LCS Dup (P6K1502-BSD1)

Prepared & Analyzed: 11/15/16

Benzene	0.0869	0.00100	mg/kg wet	0.100		86.9	70-130	2.37	20	
Toluene	0.0928	0.00200	"	0.100		92.8	70-130	0.452	20	
Ethylbenzene	0.109	0.00100	"	0.100		109	70-130	3.00	20	
Xylene (p/m)	0.193	0.00200	"	0.200		96.3	70-130	0.451	20	
Xylene (o)	0.0958	0.00100	"	0.100		95.8	70-130	0.167	20	
Surrogate: 1,4-Difluorobenzene	0.0603		"	0.0800		75.3	75-125			
Surrogate: 4-Bromofluorobenzene	0.0630		"	0.0800		78.8	75-125			

Larson & Associates, Inc.
P.O. Box 50685
Midland TX, 79710

Project: Nash Draw Battery #9
Project Number: 11-0108-03
Project Manager: Mark Larson

Fax: (432) 687-0456

General Chemistry Parameters by EPA / Standard Methods - Quality Control
Permian Basin Environmental Lab, L.P.

Analyte	Result	Reporting Limit	Units	Spike Level	Source Result	%REC	%REC Limits	RPD	RPD Limit	Notes
Batch P6K1505 - *** DEFAULT PREP ***										
Blank (P6K1505-BLK1)					Prepared & Analyzed: 11/15/16					
% Moisture	ND	0.1	%							
Duplicate (P6K1505-DUP1)					Source: 6K14002-12 Prepared & Analyzed: 11/15/16					
% Moisture	11.0	0.1	%		10.0			9.52	20	

Larson & Associates, Inc.
P.O. Box 50685
Midland TX, 79710

Project: Nash Draw Battery #9
Project Number: 11-0108-03
Project Manager: Mark Larson

Fax: (432) 687-0456

Total Petroleum Hydrocarbons C6-C35 by EPA Method 8015M - Quality Control
Permian Basin Environmental Lab, L.P.

Analyte	Result	Reporting Limit	Units	Spike Level	Source Result	%REC	%REC Limits	RPD	RPD Limit	Notes
Batch P6K1504 - TX 1005										
Blank (P6K1504-BLK1)				Prepared: 11/14/16 Analyzed: 11/15/16						
C6-C12	ND	25.0	mg/kg wet							
>C12-C28	ND	25.0	"							
>C28-C35	ND	25.0	"							
Surrogate: 1-Chlorooctane	115		"	100		115	70-130			
Surrogate: o-Terphenyl	70.5		"	50.0		141	70-130			S-GC
LCS (P6K1504-BS1)				Prepared: 11/14/16 Analyzed: 11/15/16						
C6-C12	1050	25.0	mg/kg wet	1000		105	75-125			
>C12-C28	1050	25.0	"	1000		105	75-125			
Surrogate: 1-Chlorooctane	122		"	100		122	70-130			
Surrogate: o-Terphenyl	64.4		"	50.0		129	70-130			
LCS Dup (P6K1504-BSD1)				Prepared: 11/14/16 Analyzed: 11/15/16						
C6-C12	1070	25.0	mg/kg wet	1000		107	75-125	1.74	20	
>C12-C28	1040	25.0	"	1000		104	75-125	1.44	20	
Surrogate: 1-Chlorooctane	113		"	100		113	70-130			
Surrogate: o-Terphenyl	64.4		"	50.0		129	70-130			
Matrix Spike (P6K1504-MS1)				Source: 6K14002-09	Prepared: 11/14/16 Analyzed: 11/15/16					
C6-C12	1030	26.6	mg/kg dry	1060	24.4	94.1	75-125			
>C12-C28	1040	26.6	"	1060	ND	98.0	75-125			
Surrogate: 1-Chlorooctane	111		"	106		104	70-130			
Surrogate: o-Terphenyl	51.8		"	53.2		97.4	70-130			
Matrix Spike Dup (P6K1504-MSD1)				Source: 6K14002-09	Prepared: 11/14/16 Analyzed: 11/15/16					
C6-C12	1040	26.6	mg/kg dry	1060	24.4	95.5	75-125	1.44	20	
>C12-C28	1070	26.6	"	1060	ND	101	75-125	2.51	20	
Surrogate: 1-Chlorooctane	114		"	106		107	70-130			
Surrogate: o-Terphenyl	48.2		"	53.2		90.7	70-130			

Permian Basin Environmental Lab, L.P.

The results in this report apply to the samples analyzed in accordance with the samples received in the laboratory. This analytical report must be reproduced in its entirety, with written approval of Permian Basin Environmental Lab.

1400 Rankin HWY Midland, TX 79701 432-686-7235

Larson & Associates, Inc.
P.O. Box 50685
Midland TX, 79710

Project: Nash Draw Battery #9
Project Number: 11-0108-03
Project Manager: Mark Larson

Fax: (432) 687-0456

Notes and Definitions

S-GC Surrogate recovery outside of control limits. The data was accepted based on valid recovery of the remaining surrogate.

QM-07 The spike recovery was outside acceptance limits for the MS and/or MSD. The batch was accepted based on acceptable LCS recovery.

BULK Samples received in Bulk soil containers

DET Analyte DETECTED

ND Analyte NOT DETECTED at or above the reporting limit

NR Not Reported

dry Sample results reported on a dry weight basis

RPD Relative Percent Difference

LCS Laboratory Control Spike

MS Matrix Spike

Dup Duplicate

Report Approved By: 

Date: 11/15/2016

Brent Barron, Laboratory Director/Technical Director

This material is intended only for the use of the individual (s) or entity to whom it is addressed, and may contain information that is privileged and confidential.

If you have received this material in error, please notify us immediately at 432-686-7235.

106114002

CHAIN-OF-CUSTODY

Arson & Associates, Inc.
Environmental Consultants

507 N. Marienfeld, Ste. 200
Midland, TX 79701
432-687-0901

Data Reported to:

DATE: 11-11-2016
PO #: LAB WORK ORDER # 8449
PROJECT LOCATION OR NAME: Nash Brown/Eddy Co, NM
LAI PROJECT #: 11-0108-03 COLLECTOR: JM

TRRP report?
☐ Yes ☒ No

S=SOIL
W=WATER
A=AIR

P=PAINT
SL=SLUDGE
OT=OTHER

TIME ZONE:
Time zone/State:

THU/NM

Field
Sample I.D.

Lab #

Date

Time

Matrix

of Containers

HCl
HNO₃
H₂SO₄ ☐ NaOH ☐

ICE
UNPRESERVED

ANALYSES

BTEX ☒ MTBE ☒

TRPH 418.1 ☒ TPH 1005 ☒ TPH 1006 ☒

GASOLINE MOD 8015 ☒

DIESEL - MOD 8015 ☒

VOC 8260 ☒

SVOC 8270 ☒

8081 PESTICIDES ☒

8082 PCBs ☒

TCLP METALS (RCRA) ☒

TCLP - PEST ☒

TCLP - METALS (RCRA) ☒

TCLP - PEST ☒

TCLP - METALS (RCRA) ☒

TCLP - PEST ☒

TCLP - METALS (RCRA) ☒

TCLP - PEST ☒

TCLP - METALS (RCRA) ☒

TCLP - PEST ☒

TCLP - METALS (RCRA) ☒

TCLP - PEST ☒

TCLP - METALS (RCRA) ☒

TCLP - PEST ☒

TCLP - METALS (RCRA) ☒

TCLP - PEST ☒

TCLP - METALS (RCRA) ☒

TCLP - PEST ☒

TCLP - METALS (RCRA) ☒

TCLP - PEST ☒

TCLP - METALS (RCRA) ☒

TCLP - PEST ☒

TCLP - METALS (RCRA) ☒

TCLP - PEST ☒

TCLP - METALS (RCRA) ☒

TCLP - PEST ☒

TCLP - METALS (RCRA) ☒

TCLP - PEST ☒

TCLP - METALS (RCRA) ☒

TCLP - PEST ☒

TCLP - METALS (RCRA) ☒

TCLP - PEST ☒

TCLP - METALS (RCRA) ☒

TCLP - PEST ☒

TCLP - METALS (RCRA) ☒

TCLP - PEST ☒

TCLP - METALS (RCRA) ☒

TCLP - PEST ☒

TCLP - METALS (RCRA) ☒

TCLP - PEST ☒

TCLP - METALS (RCRA) ☒

TCLP - PEST ☒

TCLP - METALS (RCRA) ☒

TCLP - PEST ☒

TCLP - METALS (RCRA) ☒

TCLP - PEST ☒

TCLP - METALS (RCRA) ☒

TCLP - PEST ☒

TCLP - METALS (RCRA) ☒

TCLP - PEST ☒

TCLP - METALS (RCRA) ☒

TCLP - PEST ☒

TCLP - METALS (RCRA) ☒

TCLP - PEST ☒

TCLP - METALS (RCRA) ☒

TCLP - PEST ☒

TCLP - METALS (RCRA) ☒

TCLP - PEST ☒

TCLP - METALS (RCRA) ☒

TCLP - PEST ☒

TCLP - METALS (RCRA) ☒

TCLP - PEST ☒

TCLP - METALS (RCRA) ☒

TCLP - PEST ☒

TCLP - METALS (RCRA) ☒

TCLP - PEST ☒

TCLP - METALS (RCRA) ☒

TCLP - PEST ☒

TCLP - METALS (RCRA) ☒

TCLP - PEST ☒

TCLP - METALS (RCRA) ☒

TCLP - PEST ☒

TCLP - METALS (RCRA) ☒

TCLP - PEST ☒

TCLP - METALS (RCRA) ☒

TCLP - PEST ☒

TCLP - METALS (RCRA) ☒

TCLP - PEST ☒

TCLP - METALS (RCRA) ☒

TCLP - PEST ☒

TCLP - METALS (RCRA) ☒

TCLP - PEST ☒

TCLP - METALS (RCRA) ☒

TCLP - PEST ☒

TCLP - METALS (RCRA) ☒

TCLP - PEST ☒

TCLP - METALS (RCRA) ☒

TCLP - PEST ☒

TCLP - METALS (RCRA) ☒

TCLP - PEST ☒

TCLP - METALS (RCRA) ☒

TCLP - PEST ☒

TCLP - METALS (RCRA) ☒

TCLP - PEST ☒

TCLP - METALS (RCRA) ☒

TCLP - PEST ☒

TCLP - METALS (RCRA) ☒

TCLP - PEST ☒

TCLP - METALS (RCRA) ☒

TCLP - PEST ☒

TCLP - METALS (RCRA) ☒

TCLP - PEST ☒

TCLP - METALS (RCRA) ☒

TCLP - PEST ☒

TCLP - METALS (RCRA) ☒

TCLP - PEST ☒

TCLP - METALS (RCRA) ☒

TCLP - PEST ☒

TCLP - METALS (RCRA) ☒

TCLP - PEST ☒

TCLP - METALS (RCRA) ☒

TCLP - PEST ☒

TCLP - METALS (RCRA) ☒

TCLP - PEST ☒

TCLP - METALS (RCRA) ☒

TCLP - PEST ☒

TCLP - METALS (RCRA) ☒

TCLP - PEST ☒

TCLP - METALS (RCRA) ☒

TCLP - PEST ☒

TCLP - METALS (RCRA) ☒

TCLP - PEST ☒

TCLP - METALS (RCRA) ☒

TCLP - PEST ☒

TCLP - METALS (RCRA) ☒

TCLP - PEST ☒

TCLP - METALS (RCRA) ☒

TCLP - PEST ☒

TCLP - METALS (RCRA) ☒

TCLP - PEST ☒

TCLP - METALS (RCRA) ☒

TCLP - PEST ☒

TCLP - METALS (RCRA) ☒

TCLP - PEST ☒

TCLP - METALS (RCRA) ☒

TCLP - PEST ☒

TCLP - METALS (RCRA) ☒

TCLP - PEST ☒

TCLP - METALS (RCRA) ☒

TCLP - PEST ☒

TCLP - METALS (RCRA) ☒

TCLP - PEST ☒

TCLP - METALS (RCRA) ☒

TCLP - PEST ☒

TCLP - METALS (RCRA) ☒

TCLP - PEST ☒

TCLP - METALS (RCRA) ☒

TCLP - PEST ☒

TCLP - METALS (RCRA) ☒

TCLP - PEST ☒

TCLP - METALS (RCRA) ☒

TCLP - PEST ☒

TCLP - METALS (RCRA) ☒

TCLP - PEST ☒

TCLP - METALS (RCRA) ☒

TCLP - PEST ☒

TCLP - METALS (RCRA) ☒

TCLP - PEST ☒

TCLP - METALS (RCRA) ☒

TCLP - PEST ☒

TCLP - METALS (RCRA) ☒

TCLP - PEST ☒

TCLP - METALS (RCRA) ☒

TCLP - PEST ☒

TCLP - METALS (RCRA) ☒

TCLP - PEST ☒

TCLP - METALS (RCRA) ☒

TCLP - PEST ☒

TCLP - METALS (RCRA) ☒

TCLP - PEST ☒

TCLP - METALS (RCRA) ☒

TCLP - PEST ☒

TCLP - METALS (RCRA) ☒

TCLP - PEST ☒

TCLP - METALS (RCRA) ☒

TCLP - PEST ☒

TCLP - METALS (RCRA) ☒

TCLP - PEST ☒

TCLP - METALS (RCRA) ☒

TCLP - PEST ☒

TCLP - METALS (RCRA) ☒

TCLP - PEST ☒

TCLP - METALS (RCRA) ☒

TCLP - PEST ☒

TCLP - METALS (RCRA) ☒

TCLP - PEST ☒

TCLP - METALS (RCRA) ☒

TCLP - PEST ☒

TCLP - METALS (RCRA) ☒

TCLP - PEST ☒

TCLP - METALS (RCRA) ☒

TCLP - PEST ☒

TCLP - METALS (RCRA) ☒

TCLP - PEST ☒

TCLP - METALS (RCRA) ☒

TCLP - PEST ☒

TCLP - METALS (RCRA) ☒

TCLP - PEST ☒

TCLP - METALS (RCRA) ☒

TCLP - PEST ☒

TCLP - METALS (RCRA) ☒

TCLP - PEST ☒

TCLP - METALS (RCRA) ☒

TCLP - PEST ☒

TCLP - METALS (RCRA) ☒

TCLP - PEST ☒

TCLP - METALS (RCRA) ☒

TCLP - PEST ☒

TCLP - METALS (RCRA) ☒

TCLP - PEST ☒

TCLP - METALS (RCRA) ☒

TCLP - PEST ☒

TCLP - METALS (RCRA) ☒

TCLP - PEST ☒

TCLP - METALS (RCRA) ☒

TCLP - PEST ☒

TCLP - METALS (RCRA) ☒

TCLP - PEST ☒

TCLP - METALS (RCRA) ☒

TCLP - PEST ☒

TCLP - METALS (RCRA) ☒

TCLP - PEST ☒

TCLP - METALS (RCRA) ☒

TCLP - PEST

**PERMIAN BASIN
ENVIRONMENTAL LAB, LP
1400 Rankin Hwy
Midland, TX 79701**



Analytical Report

Prepared for:

Mark Larson
Larson & Associates, Inc.
P.O. Box 50685
Midland, TX 79710

Project: XTO Nash Draw Site #9

Project Number: 16-0108-03

Location: New Mexico

Lab Order Number: 6K21001



NELAP/TCEQ # T104704156-13-3

Report Date: 11/22/16

Larson & Associates, Inc.
P.O. Box 50685
Midland TX, 79710

Project: XTO Nash Draw Site #9
Project Number: 16-0108-03
Project Manager: Mark Larson

Fax: (432) 687-0456

ANALYTICAL REPORT FOR SAMPLES

Sample ID	Laboratory ID	Matrix	Date Sampled	Date Received
DP-03-01-E3	6K21001-01	Soil	11/18/16 08:50	11-21-2016 09:30
DP-03-01-N5	6K21001-02	Soil	11/18/16 08:33	11-21-2016 09:30
DP-03-01-S3	6K21001-03	Soil	11/18/16 08:30	11-21-2016 09:30
DP-03-02-E4	6K21001-04	Soil	11/18/16 10:00	11-21-2016 09:30
DP-03-05-W4	6K21001-05	Soil	11/18/16 14:15	11-21-2016 09:30
DP-03-05-S4	6K21001-06	Soil	11/18/16 14:20	11-21-2016 09:30
DP-03-05-E4	6K21001-07	Soil	11/18/16 14:25	11-21-2016 09:30

Larson & Associates, Inc.
P.O. Box 50685
Midland TX, 79710

Project: XTO Nash Draw Site #9
Project Number: 16-0108-03
Project Manager: Mark Larson

Fax: (432) 687-0456

DP-03-01-E3
6K21001-01 (Soil)

Analyte	Result	Reporting Limit	Units	Dilution	Batch	Prepared	Analyzed	Method	Notes
---------	--------	--------------------	-------	----------	-------	----------	----------	--------	-------

Permian Basin Environmental Lab, L.P.

General Chemistry Parameters by EPA / Standard Methods

% Moisture	11.0	0.1	%	1	P6K2201	11/22/16	11/22/16	% calculation	
------------	------	-----	---	---	---------	----------	----------	---------------	--

Total Petroleum Hydrocarbons C6-C35 by EPA Method 8015M

C6-C12	ND	28.1	mg/kg dry	1	P6K2202	11/21/16	11/21/16	TPH 8015M	
>C12-C28	ND	28.1	mg/kg dry	1	P6K2202	11/21/16	11/21/16	TPH 8015M	
>C28-C35	ND	28.1	mg/kg dry	1	P6K2202	11/21/16	11/21/16	TPH 8015M	
Surrogate: 1-Chlorooctane		123 %	70-130		P6K2202	11/21/16	11/21/16	TPH 8015M	
Surrogate: o-Terphenyl		138 %	70-130		P6K2202	11/21/16	11/21/16	TPH 8015M	S-GC
Total Petroleum Hydrocarbon C6-C35	ND	28.1	mg/kg dry	1	[CALC]	11/21/16	11/21/16	calc	

Larson & Associates, Inc.
P.O. Box 50685
Midland TX, 79710

Project: XTO Nash Draw Site #9
Project Number: 16-0108-03
Project Manager: Mark Larson

Fax: (432) 687-0456

DP-03-01-N5
6K21001-02 (Soil)

Analyte	Result	Reporting Limit	Units	Dilution	Batch	Prepared	Analyzed	Method	Notes
---------	--------	--------------------	-------	----------	-------	----------	----------	--------	-------

Permian Basin Environmental Lab, L.P.

General Chemistry Parameters by EPA / Standard Methods

% Moisture	9.0	0.1	%	1	P6K2201	11/22/16	11/22/16	% calculation
------------	-----	-----	---	---	---------	----------	----------	---------------

Total Petroleum Hydrocarbons C6-C35 by EPA Method 8015M

C6-C12	ND	27.5	mg/kg dry	1	P6K2202	11/21/16	11/21/16	TPH 8015M
>C12-C28	ND	27.5	mg/kg dry	1	P6K2202	11/21/16	11/21/16	TPH 8015M
>C28-C35	ND	27.5	mg/kg dry	1	P6K2202	11/21/16	11/21/16	TPH 8015M
Surrogate: 1-Chlorooctane		88.3 %	70-130		P6K2202	11/21/16	11/21/16	TPH 8015M
Surrogate: o-Terphenyl		99.3 %	70-130		P6K2202	11/21/16	11/21/16	TPH 8015M
Total Petroleum Hydrocarbon C6-C35	ND	27.5	mg/kg dry	1	[CALC]	11/21/16	11/21/16	calc

Larson & Associates, Inc.
P.O. Box 50685
Midland TX, 79710

Project: XTO Nash Draw Site #9
Project Number: 16-0108-03
Project Manager: Mark Larson

Fax: (432) 687-0456

DP-03-01-S3
6K21001-03 (Soil)

Analyte	Result	Reporting Limit	Units	Dilution	Batch	Prepared	Analyzed	Method	Notes
---------	--------	--------------------	-------	----------	-------	----------	----------	--------	-------

Permian Basin Environmental Lab, L.P.

General Chemistry Parameters by EPA / Standard Methods

% Moisture	12.0	0.1	%	1	P6K2201	11/22/16	11/22/16	% calculation
------------	------	-----	---	---	---------	----------	----------	---------------

Total Petroleum Hydrocarbons C6-C35 by EPA Method 8015M

C6-C12	ND	28.4	mg/kg dry	1	P6K2202	11/21/16	11/21/16	TPH 8015M
>C12-C28	ND	28.4	mg/kg dry	1	P6K2202	11/21/16	11/21/16	TPH 8015M
>C28-C35	ND	28.4	mg/kg dry	1	P6K2202	11/21/16	11/21/16	TPH 8015M
Surrogate: 1-Chlorooctane		88.2 %	70-130		P6K2202	11/21/16	11/21/16	TPH 8015M
Surrogate: o-Terphenyl		101 %	70-130		P6K2202	11/21/16	11/21/16	TPH 8015M
Total Petroleum Hydrocarbon C6-C35	ND	28.4	mg/kg dry	1	[CALC]	11/21/16	11/21/16	calc

Larson & Associates, Inc.
P.O. Box 50685
Midland TX, 79710

Project: XTO Nash Draw Site #9
Project Number: 16-0108-03
Project Manager: Mark Larson

Fax: (432) 687-0456

DP-03-02-E4
6K21001-04 (Soil)

Analyte	Result	Reporting Limit	Units	Dilution	Batch	Prepared	Analyzed	Method	Notes
---------	--------	--------------------	-------	----------	-------	----------	----------	--------	-------

Permian Basin Environmental Lab, L.P.

General Chemistry Parameters by EPA / Standard Methods

% Moisture	12.0	0.1	%	1	P6K2201	11/22/16	11/22/16	% calculation	
------------	------	-----	---	---	---------	----------	----------	---------------	--

Total Petroleum Hydrocarbons C6-C35 by EPA Method 8015M

C6-C12	ND	28.4	mg/kg dry	1	P6K2202	11/21/16	11/21/16	TPH 8015M	
>C12-C28	ND	28.4	mg/kg dry	1	P6K2202	11/21/16	11/21/16	TPH 8015M	
>C28-C35	ND	28.4	mg/kg dry	1	P6K2202	11/21/16	11/21/16	TPH 8015M	
Surrogate: 1-Chlorooctane		123 %	70-130		P6K2202	11/21/16	11/21/16	TPH 8015M	
Surrogate: o-Terphenyl		141 %	70-130		P6K2202	11/21/16	11/21/16	TPH 8015M	S-GC
Total Petroleum Hydrocarbon C6-C35	ND	28.4	mg/kg dry	1	[CALC]	11/21/16	11/21/16	calc	

Permian Basin Environmental Lab, L.P.

The results in this report apply to the samples analyzed in accordance with the samples received in the laboratory. This analytical report must be reproduced in its entirety, with written approval of Permian Basin Environmental Lab.

1400 Rankin HWY Midland, TX 79701 432-686-7235

Larson & Associates, Inc.
P.O. Box 50685
Midland TX, 79710

Project: XTO Nash Draw Site #9
Project Number: 16-0108-03
Project Manager: Mark Larson

Fax: (432) 687-0456

DP-03-05-W4
6K21001-05 (Soil)

Analyte	Result	Reporting Limit	Units	Dilution	Batch	Prepared	Analyzed	Method	Notes
---------	--------	--------------------	-------	----------	-------	----------	----------	--------	-------

Permian Basin Environmental Lab, L.P.

General Chemistry Parameters by EPA / Standard Methods

% Moisture	8.0	0.1	%	1	P6K2201	11/22/16	11/22/16	% calculation
------------	-----	-----	---	---	---------	----------	----------	---------------

Total Petroleum Hydrocarbons C6-C35 by EPA Method 8015M

C6-C12	ND	27.2	mg/kg dry	1	P6K2202	11/21/16	11/21/16	TPH 8015M
>C12-C28	ND	27.2	mg/kg dry	1	P6K2202	11/21/16	11/21/16	TPH 8015M
>C28-C35	ND	27.2	mg/kg dry	1	P6K2202	11/21/16	11/21/16	TPH 8015M
Surrogate: 1-Chlorooctane		126 %	70-130		P6K2202	11/21/16	11/21/16	TPH 8015M
Surrogate: o-Terphenyl		145 %	70-130		P6K2202	11/21/16	11/21/16	TPH 8015M
Total Petroleum Hydrocarbon C6-C35	ND	27.2	mg/kg dry	1	[CALC]	11/21/16	11/21/16	calc

Larson & Associates, Inc.
P.O. Box 50685
Midland TX, 79710

Project: XTO Nash Draw Site #9
Project Number: 16-0108-03
Project Manager: Mark Larson

Fax: (432) 687-0456

DP-03-05-S4
6K21001-06 (Soil)

Analyte	Result	Reporting Limit	Units	Dilution	Batch	Prepared	Analyzed	Method	Notes
---------	--------	--------------------	-------	----------	-------	----------	----------	--------	-------

Permian Basin Environmental Lab, L.P.

General Chemistry Parameters by EPA / Standard Methods

% Moisture	9.0	0.1	%	1	P6K2201	11/22/16	11/22/16	% calculation
------------	-----	-----	---	---	---------	----------	----------	---------------

Total Petroleum Hydrocarbons C6-C35 by EPA Method 8015M

C6-C12	ND	27.5	mg/kg dry	1	P6K2202	11/21/16	11/21/16	TPH 8015M	
>C12-C28	ND	27.5	mg/kg dry	1	P6K2202	11/21/16	11/21/16	TPH 8015M	
>C28-C35	ND	27.5	mg/kg dry	1	P6K2202	11/21/16	11/21/16	TPH 8015M	
Surrogate: 1-Chlorooctane		125 %	70-130		P6K2202	11/21/16	11/21/16	TPH 8015M	
Surrogate: o-Terphenyl		143 %	70-130		P6K2202	11/21/16	11/21/16	TPH 8015M	S-GC
Total Petroleum Hydrocarbon C6-C35	ND	27.5	mg/kg dry	1	[CALC]	11/21/16	11/21/16	calc	

Larson & Associates, Inc.
P.O. Box 50685
Midland TX, 79710

Project: XTO Nash Draw Site #9
Project Number: 16-0108-03
Project Manager: Mark Larson

Fax: (432) 687-0456

DP-03-05-E4
6K21001-07 (Soil)

Analyte	Result	Reporting Limit	Units	Dilution	Batch	Prepared	Analyzed	Method	Notes
---------	--------	--------------------	-------	----------	-------	----------	----------	--------	-------

Permian Basin Environmental Lab, L.P.

General Chemistry Parameters by EPA / Standard Methods

% Moisture	8.0	0.1	%	1	P6K2201	11/22/16	11/22/16	% calculation
------------	-----	-----	---	---	---------	----------	----------	---------------

Total Petroleum Hydrocarbons C6-C35 by EPA Method 8015M

C6-C12	ND	27.2	mg/kg dry	1	P6K2202	11/21/16	11/21/16	TPH 8015M
>C12-C28	ND	27.2	mg/kg dry	1	P6K2202	11/21/16	11/21/16	TPH 8015M
>C28-C35	ND	27.2	mg/kg dry	1	P6K2202	11/21/16	11/21/16	TPH 8015M
Surrogate: 1-Chlorooctane		87.5 %	70-130		P6K2202	11/21/16	11/21/16	TPH 8015M
Surrogate: o-Terphenyl		99.7 %	70-130		P6K2202	11/21/16	11/21/16	TPH 8015M
Total Petroleum Hydrocarbon C6-C35	ND	27.2	mg/kg dry	1	[CALC]	11/21/16	11/21/16	calc

Larson & Associates, Inc.
P.O. Box 50685
Midland TX, 79710

Project: XTO Nash Draw Site #9
Project Number: 16-0108-03
Project Manager: Mark Larson

Fax: (432) 687-0456

General Chemistry Parameters by EPA / Standard Methods - Quality Control
Permian Basin Environmental Lab, L.P.

Analyte	Result	Reporting Limit	Units	Spike Level	Source Result	%REC	%REC Limits	RPD	RPD Limit	Notes
---------	--------	--------------------	-------	----------------	------------------	------	----------------	-----	--------------	-------

Batch P6K2201 - * DEFAULT PREP *****

Blank (P6K2201-BLK1)

Prepared & Analyzed: 11/22/16

% Moisture ND 0.1 %

Duplicate (P6K2201-DUP1)

Source: 6K18011-09

Prepared & Analyzed: 11/22/16

% Moisture 12.0 0.1 % 12.0 0.00 20

Larson & Associates, Inc.
P.O. Box 50685
Midland TX, 79710

Project: XTO Nash Draw Site #9
Project Number: 16-0108-03
Project Manager: Mark Larson

Fax: (432) 687-0456

Total Petroleum Hydrocarbons C6-C35 by EPA Method 8015M - Quality Control

Permian Basin Environmental Lab, L.P.

Analyte	Result	Reporting Limit	Units	Spike Level	Source Result	%REC	%REC Limits	RPD	RPD Limit	Notes
---------	--------	--------------------	-------	----------------	------------------	------	----------------	-----	--------------	-------

Batch P6K2202 - TX 1005

Blank (P6K2202-BLK1)

Prepared & Analyzed: 11/21/16

C6-C12	ND	25.0	mg/kg wet							
>C12-C28	ND	25.0	"							
>C28-C35	ND	25.0	"							
Surrogate: 1-Chlorooctane	114		"	100		114	70-130			
Surrogate: o-Terphenyl	64.2		"	50.0		128	70-130			

LCS (P6K2202-BS1)

Prepared & Analyzed: 11/21/16

C6-C12	883	25.0	mg/kg wet	1000		88.3	75-125			
>C12-C28	991	25.0	"	1000		99.1	75-125			
Surrogate: 1-Chlorooctane	127		"	100		127	70-130			
Surrogate: o-Terphenyl	69.2		"	50.0		138	70-130			S-GC

LCS Dup (P6K2202-BSD1)

Prepared & Analyzed: 11/21/16

C6-C12	867	25.0	mg/kg wet	1000		86.7	75-125	1.83	20	
>C12-C28	968	25.0	"	1000		96.8	75-125	2.33	20	
Surrogate: 1-Chlorooctane	126		"	100		126	70-130			
Surrogate: o-Terphenyl	60.4		"	50.0		121	70-130			

Larson & Associates, Inc.
P.O. Box 50685
Midland TX, 79710

Project: XTO Nash Draw Site #9
Project Number: 16-0108-03
Project Manager: Mark Larson

Fax: (432) 687-0456

Notes and Definitions

S-GC Surrogate recovery outside of control limits. The data was accepted based on valid recovery of the remaining surrogate.

BULK Samples received in Bulk soil containers

DET Analyte DETECTED

ND Analyte NOT DETECTED at or above the reporting limit

NR Not Reported

dry Sample results reported on a dry weight basis

RPD Relative Percent Difference

LCS Laboratory Control Spike

MS Matrix Spike

Dup Duplicate

Report Approved By: 

Date: 11/22/2016

Brent Barron, Laboratory Director/Technical Director

This material is intended only for the use of the individual (s) or entity to whom it is addressed, and may contain information that is privileged and confidential.

If you have received this material in error, please notify us immediately at 432-686-7235.

CHAIN-OF-CUSTODY

PAGE 1 OF 1

507 N. Marientfeld, Ste. 200
Midland, TX 79701
432-687-0901

DATE: 11/21/2016 PAGE 1 OF 1
PO #: LAB WORK ORDER #:
PROJECT LOCATION OR NAME: XTO Mash Draw # 9
PROJECT #: 16-0108-03 COLLECTOR: Michael Gary

Page 13 of 13

TRRP report? ☐ Yes ☒ No

S=SOL
W=WATER
A=AIR

P=PAINT
SL=SLUDGE
OT=OTHER

Field
Sample I.D.

Tin

285

[illegible]

LABORATORY USE ONLY
RECEIVING TEMP. -8.8 THERM #: _____
CUSTODY SEALS - ☐ BROKEN ☒ INTACT ☐ NOT USE

☐ CARRIER BILL # _____

☒ HAND DELIVERED

Appendix C

Photographs



Location Sign



Location Viewing Northwest Prior to Remediation, February 4, 2016



Location Viewing East Prior to Remediation, February 4, 2016



Initial Excavation at DP-03-01 and DP-03-02 Viewing South, November 9, 2016



Excavation (1 ft.) at DP-03-04 Viewing West, November 9, 2016



Initial Excavation at DP-03-05 Viewing South, November 10, 2016



Expanded Excavation at DP-03-02 and DP-03-01 Viewing West, November 22, 2016



Expanded Excavation at DP-03-05 Viewing North, November 22, 2016



Completed Remediation Viewing East, December 15, 2016



Completed Remediation Viewing East, December 15, 2016



Completed Remediation Viewing South, December 15, 2016

Appendix D
Waste Manifests

LEA LAND DISPOSAL SITE NEW MEXICO

MILE MARKER #64 US HWY 62/180 • 30 MILES EAST OF CARLSBAD, NM • PHONE (575) 887-4048

LEA LAND, LLC

1300 WEST MAIN STREET • OKLAHOMA CITY, OK 73106 • PHONE (405) 236-4257

NON-HAZARDOUS WASTE MANIFEST

NO

116180

1. PAGE ___ OF ___

2. TRAILER NO.

G

3. COMPANY NAME

4. ADDRESS

5. PICK-UP DATE

PHONE NO.

CITY

STATE

ZIP

6. TNRCC I.D. NO.

E

7. NAME OR DESCRIPTION OF WASTE SHIPPED:

8. CONTAINERS

No.

Type

9. TOTAL

QUANTITY

10. UNIT

Wt/Vol.

11. TEXAS

WASTE ID #

N

a.

b.

c.

d.

R

12. COMMENTS OR SPECIAL INSTRUCTIONS:

13. WASTE PROFILE NO.

A

14.

IN CASE OF EMERGENCY OR SPILL, CONTACT

NAME

PHONE NO

24-HOUR EMERGENCY NO.

T

O

15. **GENERATOR'S CERTIFICATION:** I hereby declare that the contents of this consignment are fully and accurately described above by proper shipping name and are classified, packed, marked, and labeled, and are in all respects in proper condition for transport by highway according to applicable international and national government regulations, including applicable state regulations, and are the same materials previously approved by LEA LAND, LLC

R

PRINTED/TYPED NAME

SIGNATURE

DATE

T

16.

TRANSPORTER (1)

NAME:

TEXAS I.D. NO.

IN CASE OF EMERGENCY CONTACT:

EMERGENCY PHONE:

R

A

N

S

P

O

R

T

E

R

S

18. **TRANSPORTER (1):** Acknowledgment of receipt of material

PRINTED/TYPED NAME

SIGNATURE

DATE

17.

TRANSPORTER (2)

NAME:

TEXAS I.D. NO.

IN CASE OF EMERGENCY CONTACT:

EMERGENCY PHONE:

19. **TRANSPORTER (2):** Acknowledgment of receipt of material

PRINTED/TYPED NAME

SIGNATURE

DATE

D

F

I

A

S

C

P

I

O

L

PERMIT NO.

WM-01-035 - New Mexico

ADDRESS:

Mile Marker 64, U.S. Hwy 62/180,
30 Miles East of Carlsbad, NM

PHONE:

575-887-4048

21. **DISPOSAL FACILITY'S CERTIFICATION:** I hereby certify that the above described wastes were delivered to this facility, that the facility is authorized and permitted to receive such wastes.

AUTHORIZED SIGNATURE

CELL NO.

DATE

TIME

LEA LAND DISPOSAL SITE NEW MEXICO

MILE MARKER #64 US HWY 62/180 • 30 MILES EAST OF CARLSBAD, NM • PHONE (575) 887-4048

LEA LAND, LLC

1300 WEST MAIN STREET • OKLAHOMA CITY, OK 73106 • PHONE (405) 236-4257

NON-HAZARDOUS WASTE MANIFEST

NO **116181**

1. PAGE OF

2. TRAILER NO.

G

3. COMPANY NAME

4. ADDRESS

5. PICK-UP DATE

PHONE NO.

CITY

STATE

ZIP

6. TNRCC I.D. NO.

E

7. NAME OR DESCRIPTION OF WASTE SHIPPED:

8. CONTAINERS
No. Type

9. TOTAL
QUANTITY

10. UNIT
Wt/Vol.

11. TEXAS
WASTE ID #

N

a.

b.

E

c.

R

d.

12. COMMENTS OR SPECIAL INSTRUCTIONS:

13. WASTE PROFILE NO.

A

14.

IN CASE OF EMERGENCY OR SPILL, CONTACT

NAME

PHONE NO.

24-HOUR EMERGENCY NO.

T

15. **GENERATOR'S CERTIFICATION:** I Hereby declare that the contents of this consignment are fully and accurately described above by proper shipping name and are classified, packed, marked, and labeled, and are in all respects in proper condition for transport by highway according to applicable international and national government regulations, including applicable state regulations, and are the same materials previously approved by LEA LAND, LLC

R

PRINTED/TYPED NAME

SIGNATURE

DATE

T

16.

TRANSPORTER (1)

NAME:

TEXAS I.D. NO.

IN CASE OF EMERGENCY CONTACT:

EMERGENCY PHONE:

R

17.

TRANSPORTER (2)

NAME:

TEXAS I.D. NO.

IN CASE OF EMERGENCY CONTACT:

EMERGENCY PHONE:

N

S

P

O

R

T

E

R

S

18. **TRANSPORTER (1):** Acknowledgment of receipt of material

PRINTED/TYPED NAME

SIGNATURE

DATE

19. **TRANSPORTER (2):** Acknowledgment of receipt of material

PRINTED/TYPED NAME

SIGNATURE

DATE

D

F

I

A

S

C

P

I

O

L

PERMIT NO.

WM-01-035 - New Mexico

ADDRESS:

Mile Marker 64, U.S. Hwy 62/180,
30 Miles East of Carlsbad, NM

PHONE:

575-887-4048

21. **DISPOSAL FACILITY'S CERTIFICATION:** I Hereby certify that the above described wastes were delivered to this facility, that the facility is authorized and permitted to receive such wastes.

AUTHORIZED SIGNATURE

CELL NO.

DATE

TIME

LEA LAND DISPOSAL SITE NEW MEXICO

MILE MARKER #64 US HWY 62/180 • 30 MILES EAST OF CARLSBAD, NM • PHONE (575) 887-4048

LEA LAND, LLC

1300 WEST MAIN STREET • OKLAHOMA CITY, OK 73106 • PHONE (405) 236-4257

NON-HAZARDOUS WASTE MANIFEST

NO 116182

1. PAGE ___ OF ___

2. TRAILER NO. 12

G

3. COMPANY NAME

4. ADDRESS

5. PICK-UP DATE

E

PHONE NO.

CITY

STATE

ZIP

6. TNRCC I.D. NO.

N

7. NAME OR DESCRIPTION OF WASTE SHIPPED:

8. CONTAINERS
No. Type

9. TOTAL
QUANTITY

10. UNIT
Wt/Vol.

11. TEXAS
WASTE ID #

E

a.

b.

c.

R

d.

A

12. COMMENTS OR SPECIAL INSTRUCTIONS:

13. WASTE PROFILE NO.

T

14.

IN CASE OF EMERGENCY OR SPILL, CONTACT

NAME

PHONE NO

24-HOUR EMERGENCY NO.

O

15. **GENERATOR'S CERTIFICATION:** I Hereby declare that the contents of this consignment are fully and accurately described above by proper shipping name and are classified, packed, marked, and labeled, and are in all respects in proper condition for transport by highway according to applicable international and national government regulations, including applicable state regulations, and are the same materials previously approved by LEA LAND, LLC

R

PRINTED/TYPED NAME

SIGNATURE

DATE

T

16.

TRANSPORTER (1)

NAME:

TEXAS I.D. NO.

IN CASE OF EMERGENCY CONTACT:

EMERGENCY PHONE:

R

18. **TRANSPORTER (1):** Acknowledgment of receipt of material

PRINTED/TYPED NAME

SIGNATURE

DATE

D

Lea Land, LLC

ADDRESS:

Mile Marker 64, U.S. Hwy 62/180,
30 Miles East of Carlsbad, NM

PHONE:

575-887-4048

F

PERMIT NO.

WM-01-035 - New Mexico

20. COMMENTS

S

21. **DISPOSAL FACILITY'S CERTIFICATION:** I Hereby certify that the above described wastes were delivered to this facility, that the facility is authorized and permitted to receive such wastes.

I

AUTHORIZED SIGNATURE

CELL NO.

DATE

TIME

LEA LAND DISPOSAL SITE NEW MEXICO

MILE MARKER #64 US HWY 62/180 • 30 MILES EAST OF CARLSBAD, NM • PHONE (575) 887-4048

LEA LAND, LLC

1300 WEST MAIN STREET • OKLAHOMA CITY, OK 73106 • PHONE (405) 236-4257

NON-HAZARDOUS WASTE MANIFEST

NO

116183

1. PAGE ___ OF ___

2. TRAILER NO. 0000

G

3. COMPANY NAME

4. ADDRESS

5. PICK-UP DATE

PHONE NO.

CITY

STATE

ZIP

6. TNRCC I.D. NO.

E

7. NAME OR DESCRIPTION OF WASTE SHIPPED:

8. CONTAINERS
No. Type

9. TOTAL
QUANTITY

10. UNIT
Wt/Vol.

11. TEXAS
WASTE ID #

N

a.

b.

E

c.

R

d.

12. COMMENTS OR SPECIAL INSTRUCTIONS:

13. WASTE PROFILE NO.

A

14.

IN CASE OF EMERGENCY OR SPILL, CONTACT

NAME

PHONE NO

24-HOUR EMERGENCY NO.

T

O

15. **GENERATOR'S CERTIFICATION:** I hereby declare that the contents of this consignment are fully and accurately described above by proper shipping name and are classified, packed, marked, and labeled, and are in all respects in proper condition for transport by highway according to applicable international and national government regulations, including applicable state regulations, and are the same materials previously approved by LEA LAND, LLC

R

PRINTED/TYPED NAME

SIGNATURE

DATE

T

16.

TRANSPORTER (1)

NAME:

TEXAS I.D. NO.

IN CASE OF EMERGENCY CONTACT:

EMERGENCY PHONE:

R

17.

TRANSPORTER (2)

NAME:

TEXAS I.D. NO.

IN CASE OF EMERGENCY CONTACT:

EMERGENCY PHONE:

N

S

P

O

R

T

E

R

S

18. **TRANSPORTER (1):** Acknowledgment of receipt of material

PRINTED/TYPED NAME _____

SIGNATURE _____ DATE _____

19. **TRANSPORTER (2):** Acknowledgment of receipt of material

PRINTED/TYPED NAME _____

SIGNATURE _____ DATE _____

D

F

A

S

C

P

I

O

L

Lea Land, LLC

ADDRESS:

Mile Marker 64, U.S. Hwy 62/180,
30 Miles East of Carlsbad, NM

PHONE:

575-887-4048

PERMIT NO.

WM-01-035 - New Mexico

20. COMMENTS

21. **DISPOSAL FACILITY'S CERTIFICATION:** I hereby certify that the above described wastes were delivered to this facility, that the facility is authorized and permitted to receive such wastes.

AUTHORIZED SIGNATURE

CELL NO.

DATE

TIME

LEA LAND DISPOSAL SITE NEW MEXICO

MILE MARKER #64 US HWY 62/180 • 30 MILES EAST OF CARLSBAD, NM • PHONE (575) 887-4048

LEA LAND, LLC

1300 WEST MAIN STREET • OKLAHOMA CITY, OK 73106 • PHONE (405) 236-4257

NON-HAZARDOUS WASTE MANIFEST

NO 116267

1. PAGE ___ OF ___

2. TRAILER NO. 116267

G

3. COMPANY NAME

4. ADDRESS

5. PICK-UP DATE

PHONE NO.

CITY

STATE

ZIP

6. TNRCC I.D. NO.

E

7. NAME OR DESCRIPTION OF WASTE SHIPPED:

8. CONTAINERS

9. TOTAL

10. UNIT

11. TEXAS

N

a.

No.

Type

QUANTITY

Wt/Vol.

WASTE ID #

E

b.

R

c.

A

12. COMMENTS OR SPECIAL INSTRUCTIONS:

13. WASTE PROFILE NO.

T

14.

IN CASE OF EMERGENCY OR SPILL, CONTACT

NAME

PHONE NO.

24-HOUR EMERGENCY NO.

O

15. **GENERATOR'S CERTIFICATION:** I hereby declare that the contents of this consignment are fully and accurately described above by proper shipping name and are classified, packed, marked, and labeled, and are in all respects in proper condition for transport by highway according to applicable international and national government regulations, including applicable state regulations, and are the same materials previously approved by LEA LAND, LLC

R

PRINTED/TYPED NAME

SIGNATURE

DATE

T

16.

TRANSPORTER (1)

17.

TRANSPORTER (2)

NAME:

NAME:

TEXAS I.D. NO.

TEXAS I.D. NO.

IN CASE OF EMERGENCY CONTACT:

IN CASE OF EMERGENCY CONTACT:

EMERGENCY PHONE:

EMERGENCY PHONE:

R

18. **TRANSPORTER (1):** Acknowledgment of receipt of material

19. **TRANSPORTER (2):** Acknowledgment of receipt of material

PRINTED/TYPED NAME

PRINTED/TYPED NAME

SIGNATURE

DATE

SIGNATURE

DATE

D

Lea Land, LLC

ADDRESS:

Mile Marker 64, U.S. Hwy 62/180,
30 Miles East of Carlsbad, NM

PHONE:

575-887-4048

I

PERMIT NO.

WM-01-035 - New Mexico

20. COMMENTS

S

21. **DISPOSAL FACILITY'S CERTIFICATION:** I hereby certify that the above described wastes were delivered to this facility, that the facility is authorized and permitted to receive such wastes.

A

AUTHORIZED SIGNATURE

CELL NO.

DATE

TIME

GENERATOR: COPIES 1 & 6

DISPOSAL SITE: COPIES 2 & 3

TRANSPORTERS: COPIES 4 & 5

COPY 4

LEA LAND DISPOSAL SITE NEW MEXICO

MILE MARKER #64 US HWY 62/180 • 30 MILES EAST OF CARLSBAD, NM • PHONE (575) 887-4048

LEA LAND, LLC

1300 WEST MAIN STREET • OKLAHOMA CITY, OK 73106 • PHONE (405) 236-4257

NON-HAZARDOUS WASTE MANIFEST

NO 116271

1. PAGE OF

2. TRAILER NO.

G

3. COMPANY NAME

4. ADDRESS

5. PICK-UP DATE

PHONE NO.

CITY

STATE

ZIP

6. TNRCC I.D. NO.

E

7. NAME OR DESCRIPTION OF WASTE SHIPPED:

8. CONTAINERS
No. Type

9. TOTAL
QUANTITY

10. UNIT
Wt/Vol

11. TEXAS
WASTE ID #

N

a.

b.

E

c.

R

d. 41,520

12. COMMENTS OR SPECIAL INSTRUCTIONS:

13. WASTE PROFILE NO.

A

14.

IN CASE OF EMERGENCY OR SPILL, CONTACT

NAME

PHONE NO

24-HOUR EMERGENCY NO.

T

15. **GENERATOR'S CERTIFICATION:** I hereby declare that the contents of this consignment are fully and accurately described above by proper shipping name and are classified, packed, marked, and labeled, and are in all respects in proper condition for transport by highway according to applicable international and national government regulations, including applicable state regulations, and are the same materials previously approved by LEA LAND, LLC

R

PRINTED/TYPED NAME

SIGNATURE

DATE

T

16.

TRANSPORTER (1)

NAME:

TEXAS I.D. NO.

IN CASE OF EMERGENCY CONTACT:

EMERGENCY PHONE:

17.

TRANSPORTER (2)

NAME:

TEXAS I.D. NO.

IN CASE OF EMERGENCY CONTACT:

EMERGENCY PHONE:

R

18. **TRANSPORTER (1):** Acknowledgment of receipt of material

PRINTED/TYPED NAME

SIGNATURE

DATE

19. **TRANSPORTER (2):** Acknowledgment of receipt of material

PRINTED/TYPED NAME

SIGNATURE

DATE

D
I
S
P
O
S
I
T
I
O
N

Lea Land, LLC

ADDRESS:

Mile Marker 64, U.S. Hwy 62/180,
30 Miles East of Carlsbad, NM

PHONE:

575-887-4048

PERMIT NO.

WM-01-035 - New Mexico

20. COMMENTS

21. **DISPOSAL FACILITY'S CERTIFICATION:** I hereby certify that the above described wastes were delivered to this facility, that the facility is authorized and permitted to receive such wastes.

AUTHORIZED SIGNATURE

CELL NO.

DATE

TIME

LEA LAND DISPOSAL SITE NEW MEXICO

MILE MARKER #64 US HWY 62/180 • 30 MILES EAST OF CARLSBAD, NM • PHONE (575) 887-4048

LEA LAND, LLC

1300 WEST MAIN STREET • OKLAHOMA CITY, OK 73106 • PHONE (405) 236-4257

NON-HAZARDOUS WASTE MANIFEST

NO

116273

1. PAGE ___ OF ___

2. TRAILER NO. 13

G

3. COMPANY NAME

4. ADDRESS

5. PICK-UP DATE

E

PHONE NO.

CITY

STATE

ZIP

6. TNRCC I.D. NO.

N

7. NAME OR DESCRIPTION OF WASTE SHIPPED:

8. CONTAINERS
No. Type

9. TOTAL
QUANTITY

10. UNIT
Wt/Vol.

11. TEXAS
WASTE ID #

E

a.

b.

c.

R

d.

A

12. COMMENTS OR SPECIAL INSTRUCTIONS:

13. WASTE PROFILE NO.

T

14.

IN CASE OF EMERGENCY OR SPILL, CONTACT

NAME

PHONE NO

24-HOUR EMERGENCY NO.

O

15. **GENERATOR'S CERTIFICATION:** I hereby declare that the contents of this consignment are fully and accurately described above by proper shipping name and are classified, packed, marked, and labeled, and are in all respects in proper condition for transport by highway according to applicable international and national government regulations, including applicable state regulations, and are the same materials previously approved by LEA LAND, LLC

R

PRINTED/TYPED NAME

SIGNATURE

DATE

T

16.

TRANSPORTER (1)

NAME:

TEXAS I.D. NO.

IN CASE OF EMERGENCY CONTACT:

EMERGENCY PHONE:

R

18. **TRANSPORTER (1):** Acknowledgment of receipt of material

PRINTED/TYPED NAME

SIGNATURE

DATE

17.

TRANSPORTER (2)

NAME:

TEXAS I.D. NO.

IN CASE OF EMERGENCY CONTACT:

EMERGENCY PHONE:

19. **TRANSPORTER (2):** Acknowledgment of receipt of material

PRINTED/TYPED NAME

SIGNATURE

DATE

D

Lea Land, LLC

ADDRESS:

Mile Marker 64, U.S. Hwy 62/180,
30 Miles East of Carlsbad, NM

PHONE:

575-887-4048

F

PERMIT NO.

WM-01-035 - New Mexico

20. COMMENTS

A

21. **DISPOSAL FACILITY'S CERTIFICATION:** I hereby certify that the above described wastes were delivered to this facility, that the facility is authorized and permitted to receive such wastes.

S

AUTHORIZED SIGNATURE

CELL NO.

DATE

TIME

LEA LAND DISPOSAL SITE NEW MEXICO

MILE MARKER #64 US HWY 62/180 • 30 MILES EAST OF CARLSBAD, NM • PHONE (575) 887-4048

LEA LAND, LLC

1300 WEST MAIN STREET • OKLAHOMA CITY, OK 73106 • PHONE (405) 236-4257

NON-HAZARDOUS WASTE MANIFEST

NO

116274

1. PAGE ___ OF ___

2. TRAILER NO. 488

G

3. COMPANY NAME

4. ADDRESS

5. PICK-UP DATE

PHONE NO.

CITY

STATE

ZIP

6. TNRCC I.D. NO.

E

7. NAME OR DESCRIPTION OF WASTE SHIPPED:

8. CONTAINERS
No. Type

9. TOTAL
QUANTITY

10. UNIT
Wt/Vol.

11. TEXAS
WASTE ID #

N

a.

b.

E

c.

R

d.

12. COMMENTS OR SPECIAL INSTRUCTIONS:

13. WASTE PROFILE NO.

A

14.

IN CASE OF EMERGENCY OR SPILL, CONTACT

NAME

PHONE NO

24-HOUR EMERGENCY NO.

T

O

15. **GENERATOR'S CERTIFICATION:** I Hereby declare that the contents of this consignment are fully and accurately described above by proper shipping name and are classified, packed, marked, and labeled, and are in all respects in proper condition for transport by highway according to applicable international and national government regulations, including applicable state regulations, and are the same materials previously approved by LEA LAND, LLC

R

PRINTED/TYPED NAME

SIGNATURE

DATE

T

16.

TRANSPORTER (1)

NAME:

TEXAS I.D. NO.

IN CASE OF EMERGENCY CONTACT:

EMERGENCY PHONE:

R

18. **TRANSPORTER (1):** Acknowledgment of receipt of material

PRINTED/TYPED NAME

SIGNATURE

DATE

S

17.

TRANSPORTER (2)

NAME:

TEXAS I.D. NO.

IN CASE OF EMERGENCY CONTACT:

EMERGENCY PHONE:

19. **TRANSPORTER (2):** Acknowledgment of receipt of material

PRINTED/TYPED NAME

SIGNATURE

DATE

D

Lea Land, LLC

ADDRESS:

Mile Marker 64, U.S. Hwy 62/180,
30 Miles East of Carlsbad, NM

PHONE:

575-887-4048

F

PERMIT NO.

WM-01-035 - New Mexico

20. COMMENTS

S

I

C

P

O

L

S

I

A

T

21. **DISPOSAL FACILITY'S CERTIFICATION:** I Hereby certify that the above described wastes were delivered to this facility, that the facility is authorized and permitted to receive such wastes.

AUTHORIZED SIGNATURE

CELL NO.

DATE

TIME

LEA LAND DISPOSAL SITE NEW MEXICO

MILE MARKER #64 US HWY 62/180 • 30 MILES EAST OF CARLSBAD, NM • PHONE (575) 887-4048

LEA LAND, LLC

1300 WEST MAIN STREET • OKLAHOMA CITY, OK 73106 • PHONE (405) 236-4257

NON-HAZARDOUS WASTE MANIFEST

NO

116168

1. PAGE ___ OF ___

2. TRAILER NO. _____

G

3. COMPANY NAME

4. ADDRESS

5. PICK-UP DATE

E

PHONE NO.

CITY

STATE

ZIP

6. TNRCC I.D. NO.

N

7. NAME OR DESCRIPTION OF WASTE SHIPPED:

8. CONTAINERS
No. Type

9. TOTAL
QUANTITY

10. UNIT
Wt/Vol.

11. TEXAS
WASTE ID #

E

a.

b.

c.

R

d.

A

12. COMMENTS OR SPECIAL INSTRUCTIONS:

13. WASTE PROFILE NO.

T

14.

IN CASE OF EMERGENCY OR SPILL, CONTACT

NAME

PHONE NO

24-HOUR EMERGENCY NO.

O

15. **GENERATOR'S CERTIFICATION:** I Hereby declare that the contents of this consignment are fully and accurately described above by proper shipping name and are classified, packed, marked, and labeled, and are in all respects in proper condition for transport by highway according to applicable international and national government regulations, including applicable state regulations, and are the same materials previously approved by LEA LAND, LLC

R

PRINTED/TYPED NAME

SIGNATURE

DATE

T

16.

TRANSPORTER (1)

NAME:

TEXAS I.D. NO.

IN CASE OF EMERGENCY CONTACT:

EMERGENCY PHONE:

R

18. **TRANSPORTER (1):** Acknowledgment of receipt of material

PRINTED/TYPED NAME

SIGNATURE

DATE

D

F

I

S

C

P

I

O

L

L

Y

Lea Land, LLC

ADDRESS:

Mile Marker 64, U.S. Hwy 62/180,
30 Miles East of Carlsbad, NM

PHONE:

575-887-4048

PERMIT NO.

WM-01-035 - New Mexico

20. COMMENTS

21. **DISPOSAL FACILITY'S CERTIFICATION:** I Hereby certify that the above described wastes were delivered to this facility, that the facility is authorized and permitted to receive such wastes.

AUTHORIZED SIGNATURE

CELL NO.

DATE

TIME

LEA LAND DISPOSAL SITE NEW MEXICO

MILE MARKER #64 US HWY 62/180 • 30 MILES EAST OF CARLSBAD, NM • PHONE (575) 887-4048

LEA LAND, LLC

1300 WEST MAIN STREET • OKLAHOMA CITY, OK 73106 • PHONE (405) 236-4257

NON-HAZARDOUS WASTE MANIFEST

NO **116169**

1. PAGE OF

2. TRAILER NO.

G

3. COMPANY NAME

4. ADDRESS

5. PICK-UP DATE

PHONE NO.

CITY

STATE

ZIP

6. TNRCC I.D. NO.

E

7. NAME OR DESCRIPTION OF WASTE SHIPPED:

8. CONTAINERS
No. Type

9. TOTAL
QUANTITY

10. UNIT
Wt/Vol.

11. TEXAS
WASTE ID #

N

a.

b.

E

c.

R

d.

12. COMMENTS OR SPECIAL INSTRUCTIONS:

13. WASTE PROFILE NO.

A

14.

IN CASE OF EMERGENCY OR SPILL, CONTACT

NAME

PHONE NO.

24-HOUR EMERGENCY NO.

T

O

15. **GENERATOR'S CERTIFICATION:** I Hereby declare that the contents of this consignment are fully and accurately described above by proper shipping name and are classified, packed, marked, and labeled, and are in all respects in proper condition for transport by highway according to applicable international and national government regulations, including applicable state regulations, and are the same materials previously approved by LEA LAND, LLC

R

PRINTED/TYPED NAME

SIGNATURE

DATE

T

16.

TRANSPORTER (1)

NAME:

TEXAS I.D. NO.

IN CASE OF EMERGENCY CONTACT:

EMERGENCY PHONE:

R

18. **TRANSPORTER (1):** Acknowledgment of receipt of material

PRINTED/TYPED NAME

SIGNATURE

DATE

D

F

I

S

C

P

I

O

L

S

I

T

L

Y

Lea Land, LLC

ADDRESS:

Mile Marker 64, U.S. Hwy 62/180,
30 Miles East of Carlsbad, NM

PHONE:

575-887-4048

PERMIT NO.

WM-01-035 - New Mexico

20. COMMENTS

21. **DISPOSAL FACILITY'S CERTIFICATION:** I Hereby certify that the above described wastes were delivered to this facility, that the facility is authorized and permitted to receive such wastes.

AUTHORIZED SIGNATURE

CELL NO.

DATE

TIME

LEA LAND DISPOSAL SITE NEW MEXICO

MILE MARKER #64 US HWY 62/180 • 30 MILES EAST OF CARLSBAD, NM • PHONE (575) 887-4048

LEA LAND, LLC

1300 WEST MAIN STREET • OKLAHOMA CITY, OK 73106 • PHONE (405) 236-4257

NON-HAZARDOUS WASTE MANIFEST

NO

116170

1. PAGE ___ OF ___

2. TRAILER NO.

G

3. COMPANY NAME

4. ADDRESS

5. PICK-UP DATE

E

PHONE NO.

CITY

STATE

ZIP

6. TNRCC I.D. NO.

N

7. NAME OR DESCRIPTION OF WASTE SHIPPED:

8. CONTAINERS
No. Type

9. TOTAL
QUANTITY

10. UNIT
Wt/Vol.

11. TEXAS
WASTE ID #

E

a.

b.

c.

R

d.

A

12. COMMENTS OR SPECIAL INSTRUCTIONS:

13. WASTE PROFILE NO.

T

14.

IN CASE OF EMERGENCY OR SPILL, CONTACT

NAME

PHONE NO.

24-HOUR EMERGENCY NO.

O

15. **GENERATOR'S CERTIFICATION:** I Hereby declare that the contents of this consignment are fully and accurately described above by proper shipping name and are classified, packed, marked, and labeled, and are in all respects in proper condition for transport by highway according to applicable international and national government regulations, including applicable state regulations, and are the same materials previously approved by LEA LAND, LLC

R

PRINTED/TYPED NAME

SIGNATURE

DATE

T

16.

TRANSPORTER (1)

NAME:

TEXAS I.D. NO.

IN CASE OF EMERGENCY CONTACT:

EMERGENCY PHONE:

R

18. **TRANSPORTER (1):** Acknowledgment of receipt of material

PRINTED/TYPED NAME

SIGNATURE

DATE

D

Lea Land, LLC

ADDRESS:

Mile Marker 64, U.S. Hwy 62/180,
30 Miles East of Carlsbad, NM

PHONE:

575-887-4048

F

PERMIT NO.

WM-01-035 - New Mexico

20. COMMENTS

I

21. **DISPOSAL FACILITY'S CERTIFICATION:** I Hereby certify that the above described wastes were delivered to this facility, that the facility is authorized and permitted to receive such wastes.

S

AUTHORIZED SIGNATURE

CELL NO.

DATE

TIME

LEA LAND DISPOSAL SITE NEW MEXICO

MILE MARKER #64 US HWY 62/180 • 30 MILES EAST OF CARLSBAD, NM • PHONE (575) 887-4048

LEA LAND, LLC

1300 WEST MAIN STREET • OKLAHOMA CITY, OK 73106 • PHONE (405) 236-4257

NON-HAZARDOUS WASTE MANIFEST

NO

116171

1. PAGE ___ OF ___

2. TRAILER NO. _____

G

3. COMPANY NAME

4. ADDRESS

5. PICK-UP DATE

PHONE NO.

CITY

STATE

ZIP

6. TNRC ID. NO.

E

7. NAME OR DESCRIPTION OF WASTE SHIPPED:

8. CONTAINERS
No. Type

9. TOTAL
QUANTITY

10. UNIT
Wt/Vol.

11. TEXAS
WASTE ID #

N

a.

b.

E

c.

R

d.

12. COMMENTS OR SPECIAL INSTRUCTIONS:

13. WASTE PROFILE NO.

A

14.

IN CASE OF EMERGENCY OR SPILL, CONTACT

NAME

PHONE NO.

24-HOUR EMERGENCY NO.

T

O

15. **GENERATOR'S CERTIFICATION:** I hereby declare that the contents of this consignment are fully and accurately described above by proper shipping name and are classified, packed, marked, and labeled, and are in all respects in proper condition for transport by highway according to applicable international and national government regulations, including applicable state regulations, and are the same materials previously approved by LEA LAND, LLC

R

PRINTED/TYPED NAME

SIGNATURE

DATE

T

16. **TRANSPORTER (1)**

NAME:

TEXAS I.D. NO.

IN CASE OF EMERGENCY CONTACT:

EMERGENCY PHONE:

18. **TRANSPORTER (1):** Acknowledgment of receipt of material

PRINTED/TYPED NAME

SIGNATURE

DATE

17. **TRANSPORTER (2)**

NAME:

TEXAS I.D. NO.

IN CASE OF EMERGENCY CONTACT:

EMERGENCY PHONE:

19. **TRANSPORTER (2):** Acknowledgment of receipt of material

PRINTED/TYPED NAME

SIGNATURE

DATE

D

Lea Land, LLC

ADDRESS:

Mile Marker 64, U.S. Hwy 62/180,
30 Miles East of Carlsbad, NM

PHONE:

575-887-4048

F

PERMIT NO.

WM-01-035 - New Mexico

20. COMMENTS

S

21. **DISPOSAL FACILITY'S CERTIFICATION:** I hereby certify that the above described wastes were delivered to this facility, that the facility is authorized and permitted to receive such wastes.

L

AUTHORIZED SIGNATURE

CELL NO.

DATE

TIME

LEA LAND DISPOSAL SITE NEW MEXICO

MILE MARKER #64 US HWY 62/180 • 30 MILES EAST OF CARLSBAD, NM • PHONE (575) 887-4048

LEA LAND, LLC

1300 WEST MAIN STREET • OKLAHOMA CITY, OK 73106 • PHONE (405) 236-4257

NON-HAZARDOUS WASTE MANIFEST

NO

116172

1. PAGE ___ OF ___

2. TRAILER NO. _____

G

3. COMPANY NAME

4. ADDRESS

5. PICK-UP DATE

E

PHONE NO.

CITY

STATE

ZIP

6. TNRCC I.D. NO.

N

7. NAME OR DESCRIPTION OF WASTE SHIPPED:

8. CONTAINERS
No. | Type

9. TOTAL
QUANTITY

10. UNIT
Wt/Vol.

11. TEXAS
WASTE ID #

E

a.

b.

c.

R

d.

A

12. COMMENTS OR SPECIAL INSTRUCTIONS:

13. WASTE PROFILE NO.

T

14.

IN CASE OF EMERGENCY OR SPILL, CONTACT

NAME

PHONE NO.

24-HOUR EMERGENCY NO.

O

15. **GENERATOR'S CERTIFICATION:** I Herby declare that the contents of this consignment are fully and accurately described above by proper shipping name and are classified, packed, marked, and labeled, and are in all respects in proper condition for transport by highway according to applicable international and national government regulations, including applicable state regulations, and are the same materials previously approved by LEA LAND, LLC

R

PRINTED/TYPED NAME

SIGNATURE

DATE

T

16.

TRANSPORTER (1)

NAME:

TEXAS I.D. NO.

IN CASE OF EMERGENCY CONTACT:

EMERGENCY PHONE:

R

18. **TRANSPORTER (1):** Acknowledgment of receipt of material

PRINTED/TYPED NAME

SIGNATURE

DATE

17.

TRANSPORTER (2)

NAME:

TEXAS I.D. NO.

IN CASE OF EMERGENCY CONTACT:

EMERGENCY PHONE:

R

19. **TRANSPORTER (2):** Acknowledgment of receipt of material

PRINTED/TYPED NAME

SIGNATURE

DATE

D

Lea Land, LLC

ADDRESS:

Mile Marker 64, U.S. Hwy 62/180,
30 Miles East of Carlsbad, NM

PHONE:

575-887-4048

F

PERMIT NO.

WM-01-035 - New Mexico

20. COMMENTS

S

21. **DISPOSAL FACILITY'S CERTIFICATION:** I Herby certify that the above described wastes were delivered to this facility, that the facility is authorized and permitted to receive such wastes.

A

AUTHORIZED SIGNATURE

CELL NO.

DATE

TIME

LEA LAND DISPOSAL SITE NEW MEXICO

MILE MARKER #64 US HWY 62/180 • 30 MILES EAST OF CARLSBAD, NM • PHONE (575) 887-4048

LEA LAND, LLC

1300 WEST MAIN STREET • OKLAHOMA CITY, OK 73106 • PHONE (405) 236-4257

NON-HAZARDOUS WASTE MANIFEST

NO 116173

1. PAGE ___ OF ___

2. TRAILER NO. 0000

G

3. COMPANY NAME

4. ADDRESS

5. PICK-UP DATE

PHONE NO.

CITY

STATE

ZIP

6. TNRCC I.D. NO.

E

7. NAME OR DESCRIPTION OF WASTE SHIPPED:

8. CONTAINERS
No. Type

9. TOTAL
QUANTITY

10. UNIT
Wt/Vol.

11. TEXAS
WASTE ID #

N

a.

b.

E

c.

R

d.

12. COMMENTS OR SPECIAL INSTRUCTIONS:

13. WASTE PROFILE NO.

A

14. IN CASE OF EMERGENCY OR SPILL, CONTACT

NAME

PHONE NO

24-HOUR EMERGENCY NO.

T

O

15. **GENERATOR'S CERTIFICATION:** I Hereby declare that the contents of this consignment are fully and accurately described above by proper shipping name and are classified, packed, marked, and labeled, and are in all respects in proper condition for transport by highway according to applicable international and national government regulations, including applicable state regulations, and are the same materials previously approved by LEA LAND, LLC

R

PRINTED/TYPED NAME

SIGNATURE

DATE

T

16.

TRANSPORTER (1)

17.

TRANSPORTER (2)

NAME:

NAME:

TEXAS I.D. NO.

TEXAS I.D. NO.

IN CASE OF EMERGENCY CONTACT:

IN CASE OF EMERGENCY CONTACT:

EMERGENCY PHONE:

EMERGENCY PHONE:

R

18. **TRANSPORTER (1):** Acknowledgment of receipt of material

19. **TRANSPORTER (2):** Acknowledgment of receipt of material

PRINTED/TYPED NAME

PRINTED/TYPED NAME

SIGNATURE

DATE

SIGNATURE

DATE

D

Lea Land, LLC

ADDRESS:

Mile Marker 64, U.S. Hwy 62/180,
30 Miles East of Carlsbad, NM

PHONE:

575-887-4048

F

PERMIT NO.

WM-01-035 - New Mexico

20. COMMENTS

I

S

C

P

I

O

L

21. **DISPOSAL FACILITY'S CERTIFICATION:** I Hereby certify that the above described wastes were delivered to this facility, that the facility is authorized and permitted to receive such wastes.

AUTHORIZED SIGNATURE

CELL NO.

DATE

TIME

LEA LAND DISPOSAL SITE NEW MEXICO

MILE MARKER #64 US HWY 62/180 • 30 MILES EAST OF CARLSBAD, NM • PHONE (575) 887-4048

LEA LAND, LLC

1300 WEST MAIN STREET • OKLAHOMA CITY, OK 73106 • PHONE (405) 236-4257

NON-HAZARDOUS WASTE MANIFEST

NO

116174

1. PAGE ___ OF ___

2. TRAILER NO. 112

G

3. COMPANY NAME

4. ADDRESS

5. PICK-UP DATE

PHONE NO.

CITY

STATE

ZIP

6. TNRCC I.D. NO.

E

7. NAME OR DESCRIPTION OF WASTE SHIPPED:

8. CONTAINERS
No. Type

9. TOTAL
QUANTITY

10. UNIT
Wt/Vol.

11. TEXAS
WASTE ID #

N

a.

b.

E

c.

R

d.

12. COMMENTS OR SPECIAL INSTRUCTIONS:

13. WASTE PROFILE NO.

A

14.

IN CASE OF EMERGENCY OR SPILL, CONTACT

NAME

PHONE NO.

24-HOUR EMERGENCY NO.

T

O

15. **GENERATOR'S CERTIFICATION:** I Hereby declare that the contents of this consignment are fully and accurately described above by proper shipping name and are classified, packed, marked, and labeled, and are in all respects in proper condition for transport by highway according to applicable international and national government regulations, including applicable state regulations, and are the same materials previously approved by LEA LAND, LLC

R

PRINTED/TYPED NAME

SIGNATURE

DATE

T

16.

TRANSPORTER (1)

NAME:

TEXAS I.D. NO.

IN CASE OF EMERGENCY CONTACT:

EMERGENCY PHONE:

R

18. **TRANSPORTER (1):** Acknowledgment of receipt of material

PRINTED/TYPED NAME

SIGNATURE

DATE

D

Lea Land, LLC

ADDRESS:

Mile Marker 64, U.S. Hwy 62/180,
30 Miles East of Carlsbad, NM

PHONE:

575-887-4048

F

S

PERMIT NO.

WM-01-035 - New Mexico

20. COMMENTS

P

I

O

L

S

I

A

T

21. **DISPOSAL FACILITY'S CERTIFICATION:** I Hereby certify that the above described wastes were delivered to this facility, that the facility is authorized and permitted to receive such wastes.

AUTHORIZED SIGNATURE

CELL NO.

DATE

TIME

LEA LAND DISPOSAL SITE NEW MEXICO

MILE MARKER #64 US HWY 62/180 • 30 MILES EAST OF CARLSBAD, NM • PHONE (575) 887-4048

LEA LAND, LLC

1300 WEST MAIN STREET • OKLAHOMA CITY, OK 73106 • PHONE (405) 236-4257

NON-HAZARDOUS WASTE MANIFEST

NO

116175

1. PAGE ___ OF ___

2. TRAILER NO. 12

G

3. COMPANY NAME

4. ADDRESS

5. PICK-UP DATE

PHONE NO.

CITY

STATE

ZIP

6. TNRCC I.D. NO.

E

7. NAME OR DESCRIPTION OF WASTE SHIPPED:

8. CONTAINERS

9. TOTAL

10. UNIT

11. TEXAS

N

a.

No.

Type

QUANTITY

Wt/Vol.

WASTE ID #

E

b.

R

c.

A

12. COMMENTS OR SPECIAL INSTRUCTIONS:

13. WASTE PROFILE NO.

T

NAME

PHONE NO

24-HOUR EMERGENCY NO.

O

15. **GENERATOR'S CERTIFICATION:** I Hereby declare that the contents of this consignment are fully and accurately described above by proper shipping name and are classified, packed, marked, and labeled, and are in all respects in proper condition for transport by highway according to applicable international and national government regulations, including applicable state regulations, and are the same materials previously approved by LEA LAND, LLC

R

PRINTED/TYPED NAME

SIGNATURE

DATE

T

16.

TRANSPORTER (1)

17.

TRANSPORTER (2)

NAME:

NAME:

TEXAS I.D. NO.

TEXAS I.D. NO.

IN CASE OF EMERGENCY CONTACT:

IN CASE OF EMERGENCY CONTACT:

EMERGENCY PHONE:

EMERGENCY PHONE:

R

18. **TRANSPORTER (1):** Acknowledgment of receipt of material

19. **TRANSPORTER (2):** Acknowledgment of receipt of material

PRINTED/TYPED NAME

PRINTED/TYPED NAME

SIGNATURE

DATE

SIGNATURE

DATE

D
F
I
A
S
C
P
I
O
L
S
I
A
T
Y

Lea Land, LLC

ADDRESS:

Mile Marker 64, U.S. Hwy 62/180,
30 Miles East of Carlsbad, NM

PHONE:

575-887-4048

PERMIT NO.

WM-01-035 - New Mexico

20. COMMENTS

21. **DISPOSAL FACILITY'S CERTIFICATION:** I Hereby certify that the above described wastes were delivered to this facility, that the facility is authorized and permitted to receive such wastes.

AUTHORIZED SIGNATURE

CELL NO.

DATE

TIME

LEA LAND DISPOSAL SITE NEW MEXICO

MILE MARKER #64 US HWY 62/180 • 30 MILES EAST OF CARLSBAD, NM • PHONE (575) 887-4048

LEA LAND, LLC

1300 WEST MAIN STREET • OKLAHOMA CITY, OK 73106 • PHONE (405) 236-4257

NON-HAZARDOUS WASTE MANIFEST

NO

116178

1. PAGE ___ OF ___

2. TRAILER NO.

G

3. COMPANY NAME

4. ADDRESS

5. PICK-UP DATE

PHONE NO.

CITY

STATE

ZIP

6. TNRCC I.D. NO.

E

7. NAME OR DESCRIPTION OF WASTE SHIPPED:

8. CONTAINERS
No. Type

9. TOTAL
QUANTITY

10. UNIT
Wt/Vol.

11. TEXAS
WASTE ID #

N

a.

b.

E

c.

R

d.

12. COMMENTS OR SPECIAL INSTRUCTIONS:

13. WASTE PROFILE NO.

A

14.

IN CASE OF EMERGENCY OR SPILL, CONTACT

NAME

PHONE NO

24-HOUR EMERGENCY NO.

T

O

15. **GENERATOR'S CERTIFICATION:** I hereby declare that the contents of this consignment are fully and accurately described above by proper shipping name and are classified, packed, marked, and labeled, and are in all respects in proper condition for transport by highway according to applicable international and national government regulations, including applicable state regulations, and are the same materials previously approved by LEA LAND, LLC

R

PRINTED/TYPED NAME

SIGNATURE

DATE

T

16. TRANSPORTER (1)

17. TRANSPORTER (2)

NAME:

NAME:

TEXAS I.D. NO.

TEXAS I.D. NO.

IN CASE OF EMERGENCY CONTACT:

IN CASE OF EMERGENCY CONTACT:

EMERGENCY PHONE:

EMERGENCY PHONE:

R

18. **TRANSPORTER (1):** Acknowledgment of receipt of material

19. **TRANSPORTER (2):** Acknowledgment of receipt of material

PRINTED/TYPED NAME

PRINTED/TYPED NAME

SIGNATURE

DATE

SIGNATURE

DATE

D

Lea Land, LLC

ADDRESS:

Mile Marker 64, U.S. Hwy 62/180,
30 Miles East of Carlsbad, NM

PHONE:

575-887-4048

F

PERMIT NO.

WM-01-035 - New Mexico

20. COMMENTS

S

21. **DISPOSAL FACILITY'S CERTIFICATION:** I hereby certify that the above described wastes were delivered to this facility, that the facility is authorized and permitted to receive such wastes.

A

AUTHORIZED SIGNATURE

CELL NO.

DATE

TIME

LEA LAND DISPOSAL SITE NEW MEXICO

MILE MARKER #64 US HWY 62/180 • 30 MILES EAST OF CARLSBAD, NM • PHONE (575) 887-4048

LEA LAND, LLC

1300 WEST MAIN STREET • OKLAHOMA CITY, OK 73106 • PHONE (405) 236-4257

NON-HAZARDOUS WASTE MANIFEST

NO

118179

1. PAGE ___ OF ___

2. TRAILER NO.

G

3. COMPANY NAME

4. ADDRESS

5. PICK-UP DATE

PHONE NO.

CITY

STATE

ZIP

6. TNRCC I.D. NO.

E

7. NAME OR DESCRIPTION OF WASTE SHIPPED:

8. CONTAINERS
No. Type

9. TOTAL
QUANTITY

10. UNIT
Wt/Vol.

11. TEXAS
WASTE ID #

N

a.

E

b.

R

c.

A

12. COMMENTS OR SPECIAL INSTRUCTIONS:

13. WASTE PROFILE NO.

T

14.

IN CASE OF EMERGENCY OR SPILL, CONTACT

NAME

PHONE NO

24-HOUR EMERGENCY NO.

O

15. **GENERATOR'S CERTIFICATION:** I hereby declare that the contents of this consignment are fully and accurately described above by proper shipping name and are classified, packed, marked, and labeled, and are in all respects in proper condition for transport by highway according to applicable international and national government regulations, including applicable state regulations, and are the same materials previously approved by LEA LAND, LLC

R

PRINTED/TYPED NAME

SIGNATURE

DATE

T

16. TRANSPORTER (1)

17. TRANSPORTER (2)

NAME:

NAME:

TEXAS I.D. NO.

TEXAS I.D. NO.

IN CASE OF EMERGENCY CONTACT:

IN CASE OF EMERGENCY CONTACT:

EMERGENCY PHONE:

EMERGENCY PHONE:

R

18. **TRANSPORTER (1):** Acknowledgment of receipt of material

19. **TRANSPORTER (2):** Acknowledgment of receipt of material

PRINTED/TYPED NAME

PRINTED/TYPED NAME

SIGNATURE

DATE

SIGNATURE

DATE

D

Lea Land, LLC

ADDRESS:

Mile Marker 64, U.S. Hwy 62/180,
30 Miles East of Carlsbad, NM

PHONE:

575-887-4048

F

PERMIT NO.

WM-01-035 - New Mexico

20. COMMENTS

S

21. **DISPOSAL FACILITY'S CERTIFICATION:** I hereby certify that the above described wastes were delivered to this facility, that the facility is authorized and permitted to receive such wastes.

A

AUTHORIZED SIGNATURE

CELL NO.

DATE

TIME

Appendix E

Initial and Final C-141

NM OIL CONSERVATION

ARTESIA DISTRICT

District I
1625 N. French Dr., Hobbs, NM 88240
District II
811 S. First St., Artesia, NM 88210
District III
1000 Rio Brazos Road, Aztec, NM 87410
District IV
1220 S. St. Francis Dr., Santa Fe, NM 87505

State of New Mexico
Energy Minerals and Natural Resources

SEP 07 2016

Form C-141
Revised August 8, 2011

Oil Conservation Division
1220 South St. Francis Dr.
Santa Fe, NM 87505

Submit to appropriate District Office in accordance with 19.15.29 NMAC.

RECEIVED

Release Notification and Corrective Action

DAB1625332986 OPERATOR ☒ Initial Report ☐ Final Report

Name of Company: XTO Energy, Inc.	Contact: Dudley McMinn
Address: 500 W. Illinois Ave., Suite 100, Midland, TX 70701	Telephone No.: (432) 682-8873
Facility Name: Nash Draw Unit Battery #9	Facility Type: Tank Battery (Equipment Removed)
Surface Owner: Federal	Mineral Owner: Federal
API No. 30-015-26991	

LOCATION OF RELEASE

Unit Letter B	Section 13	Township 23S	Range 29E	Feet from the 860	North/South Line North	Feet from the 2210	East/West Line East	County: Eddy
------------------	---------------	-----------------	--------------	----------------------	---------------------------	-----------------------	------------------------	--------------

Latitude 32.309722 Longitude -103.936944

NATURE OF RELEASE

Type of Release: Crude Oil/Produced Water	Volume of Release: Unknown	Volume Recovered: None
Source of Release: Spills	Date and Hour of Occurrence Unknown	Date and Hour of Discovery 07-20-2016
Was Immediate Notice Given? <input type="checkbox"/> Yes <input type="checkbox"/> No <input checked="" type="checkbox"/> Not Required	If YES, To Whom?	
By Whom?	Date and Hour	
Was a Watercourse Reached? <input type="checkbox"/> Yes <input checked="" type="checkbox"/> No	If YES, Volume Impacting the Watercourse.	

If a Watercourse was Impacted, Describe Fully.*

Describe Cause of Problem and Remedial Action Taken.* Hydrocarbons and chloride in soil due to historic use of tank battery reported in soil samples by laboratory following removal of tanks and equipment. Will remediate to OCD and BLM requirements.

Describe Area Affected and Cleanup Action Taken.*

Affected soil to be excavated, treated onsite treatment or disposed offsite at OCD approved facility. Refer to attached analytical data summary.

I hereby certify that the information given above is true and complete to the best of my knowledge and understand that pursuant to NMOC rules and regulations all operators are required to report and/or file certain release notifications and perform corrective actions for releases which may endanger public health or the environment. The acceptance of a C-141 report by the NMOC marked as "Final Report" does not relieve the operator of liability should their operations have failed to adequately investigate and remediate contamination that pose a threat to ground water, surface water, human health or the environment. In addition, NMOC acceptance of a C-141 report does not relieve the operator of responsibility for compliance with any other federal, state, or local laws and/or regulations.

Signature: <u>[Signature]</u>		OIL CONSERVATION DIVISION	
Printed Name: Luke Williams		Approved by Environmental Specialist: <u>[Signature]</u>	
Title: EH&S Coordinator		Approval Date: <u>9/8/16</u>	Expiration Date: <u>N/A</u>
E-mail Address: Luke.Williams@xtoenergy.com		Conditions of Approval: Remediation per O.C.D. Rules & Guidelines <input type="checkbox"/>	
Date: 09-07-2016 Phone: (432) 683-8873		SUBMIT REMEDIATION PROPOSAL NO <u>1019116</u>	

* Attach Additional Sheets If Necessary

LATER THAN: 10/19/16 2RD-3876

Patterson, Heather, EMNRD

From: Mark Larson <Mark@laenvironmental.com>
Sent: Wednesday, September 07, 2016 4:54 PM
To: Patterson, Heather, EMNRD
Cc: McMinn, Dudley; Williams, Luke
Subject: Re: Initial C-141s for XTO Energy, Inc., Nash Draw Unit Tank Batteries (8), Eddy County, New Mexico
Attachments: Initial C-141, XTO Energy, Inc., Nash Draw unit Battery 1 & 6, September 7, 2016.pdf; Initial C-141, XTO Energy, Inc., Nash Draw Unit Battery 10, September 7, 2016.pdf; Initial C-141, XTO Energy, Inc., Nash Draw Unit Battery 9, September 7, 2016.pdf; Initial C-141, XTO Energy, Inc., Nash Draw Unit Battery 15 & 33, September 7, 2016.pdf; Initial C-141, XTO Energy, Inc., Nash Draw Unit Battery 24, September 7, 2016.pdf; Initial C-141, XTO Energy, Inc., Nash Draw Unit Battery 36, September 7, 2016.pdf; Initial C-141, XTO Energy, Inc., Nash Draw Unit Battery 19 & 34, September 7, 2016.pdf; Initial C-141, XTO Energy, Inc., Nash Draw Unit Battery 38, September 7, 2016.pdf

Dear Heather,
The attached C-141s and supporting documentation are submitted on behalf of XTO Energy, Inc., for eight (8) tank batteries located in the Nash Draw Unit, Eddy County, New Mexico. Please contact Dudley McMinn with XTO Energy, Inc. at (432) 682-8873 or me if you have questions.
Respectfully,

Mark J. Larson

From: Mark Larson
Sent: Wednesday, September 07, 2016 10:59 AM
To: 'heather.patterson@state.nm.us'
Cc: 'McMinn, Dudley'; 'Luke_Williams@xtoenergy.com'
Subject: Re: Meeting Confirmation

Dear Heather,
This message is to confirm our meeting at your office on September 15, 2016 at 10:00 AM (Mountain Time). Please contact me if you have questions. See you then!
Respectfully,

Mark J. Larson, P.G.
President/Sr. Project Manager
507 N. Marienfeld St., Suite 205
Midland, Texas 79701
(432) 687-0901 (O)
(432) 556-8656 (C)



www.LAEnvironmental.com

"Serving the Permian Basin Since 2000"

District I
1625 N. French Dr., Hobbs, NM 88240
District II
811 S. First St., Artesia, NM 88210
District III
1000 Rio Brazos Road, Aztec, NM 87410
District IV
1220 S. St. Francis Dr., Santa Fe, NM 87505

State of New Mexico
Energy Minerals and Natural Resources

Oil Conservation Division
1220 South St. Francis Dr.
Santa Fe, NM 87505

Form C-141
Revised August 8, 2011

Submit 1 Copy to appropriate District Office in
accordance with 19.15.29 NMAC.

Release Notification and Corrective Action

OPERATOR

☐ Initial Report ☒ Final Report

Name of Company: XTO Energy, Inc.	Contact: Dudley McMinn	
Address: 500 W. Illinois Ave., Suite 100, Midland, TX 70701	Telephone No.: (432) 682-8873	
Facility Name: Nash Draw Unit Battery #9	Facility Type: Tank Battery (Equipment Removed)	
Surface Owner: Federal	Mineral Owner: Federal	API No. 30-015-26991

LOCATION OF RELEASE

Unit Letter B	Section 13	Township 23S	Range 29E	Feet from the 860	North/South Line North	Feet from the 2210	East/West Line East	County: Eddy
------------------	---------------	-----------------	--------------	----------------------	---------------------------	-----------------------	------------------------	--------------

Latitude 32.309722 Longitude -103.936944

NATURE OF RELEASE

Type of Release: Crude Oil/Produced Water	Volume of Release: Unknown	Volume Recovered: None
Source of Release: Spills	Date and Hour of Occurrence Unknown	Date and Hour of Discovery 07-20-2016
Was Immediate Notice Given? <input type="checkbox"/> Yes <input type="checkbox"/> No <input checked="" type="checkbox"/> Not Required	If YES, To Whom?	
By Whom?	Date and Hour	
Was a Watercourse Reached? <input type="checkbox"/> Yes <input checked="" type="checkbox"/> No	If YES, Volume Impacting the Watercourse.	

If a Watercourse was Impacted, Describe Fully.*

Describe Cause of Problem and Remedial Action Taken.* Hydrocarbons and chloride in soil due to historic use of tank battery reported in soil samples by laboratory following removal of tanks and equipment. Will remediate to OCD and BLM requirements.

Describe Area Affected and Cleanup Action Taken.* Soil was excavated to a maximum depth of 5 feet at DP-03-02 over an area measuring approximately 45 x 50 feet. Location DP-03-04 was excavated to a maximum depth of 2 feet over area measuring about 15 x 20 feet. Location DP-03-05 excavated to a maximum depth of 4 feet over area measuring about 35 x 50 feet Laboratory results confirmed BTEX and TPH below RRAL. The excavations were backfilled with caliche. Approximately 1,423 cubic yards of contaminated soil was disposed at Lea Land Landfill, LLC.

I hereby certify that the information given above is true and complete to the best of my knowledge and understand that pursuant to NMOCD rules and regulations all operators are required to report and/or file certain release notifications and perform corrective actions for releases which may endanger public health or the environment. The acceptance of a C-141 report by the NMOCD marked as "Final Report" does not relieve the operator of liability should their operations have failed to adequately investigate and remediate contamination that pose a threat to ground water, surface water, human health or the environment. In addition, NMOCD acceptance of a C-141 report does not relieve the operator of responsibility for compliance with any other federal, state, or local laws and/or regulations.

		OIL CONSERVATION DIVISION	
Signature:		Approved by Environmental Specialist:	
Printed Name: Luke Williams			
Title: EH&S Coordinator		Approval Date:	Expiration Date:
E-mail Address: Luke_Williams@xtoenergy.com		Conditions of Approval:	Attached <input type="checkbox"/>
Date: 03-23-2016		Phone: (432) 683-8873	

* Attach Additional Sheets If Necessary

District I
1625 N. French Dr., Hobbs, NM 88240
District II
811 S. First St., Artesia, NM 88210
District III
1000 Rio Brazos Road, Aztec, NM 87410
District IV
1220 S. St. Francis Dr., Santa Fe, NM 87505

State of New Mexico
Energy Minerals and Natural Resources

Oil Conservation Division
1220 South St. Francis Dr.
Santa Fe, NM 87505

Form C-141
Revised August 8, 2011

Submit 1 Copy to appropriate District Office in
accordance with 19.15.29 NMAC.

Release Notification and Corrective Action

OPERATOR

☐ Initial Report ☒ Final Report

Name of Company: XTO Energy, Inc.	Contact: Dudley McMinn	
Address: 500 W. Illinois Ave., Suite 100, Midland, TX 70701	Telephone No.: (432) 682-8873	
Facility Name: Nash Draw Unit Battery #9	Facility Type: Tank Battery (Equipment Removed)	
Surface Owner: Federal	Mineral Owner: Federal	API No. 30-015-26991

LOCATION OF RELEASE

Unit Letter B	Section 13	Township 23S	Range 29E	Feet from the 860	North/South Line North	Feet from the 2210	East/West Line East	County: Eddy
------------------	---------------	-----------------	--------------	----------------------	---------------------------	-----------------------	------------------------	--------------

Latitude 32.309722 Longitude -103.936944

NATURE OF RELEASE

Type of Release: Crude Oil/Produced Water	Volume of Release: Unknown	Volume Recovered: None
Source of Release: Spills	Date and Hour of Occurrence Unknown	Date and Hour of Discovery 07-20-2016
Was Immediate Notice Given? <input type="checkbox"/> Yes <input type="checkbox"/> No <input checked="" type="checkbox"/> Not Required	If YES, To Whom?	
By Whom?	Date and Hour	
Was a Watercourse Reached? <input type="checkbox"/> Yes <input checked="" type="checkbox"/> No	If YES, Volume Impacting the Watercourse.	
If a Watercourse was Impacted, Describe Fully.*		
Describe Cause of Problem and Remedial Action Taken.* Hydrocarbons and chloride in soil due to historic use of tank battery reported in soil samples by laboratory following removal of tanks and equipment. Will remediate to OCD and BLM requirements.		
Describe Area Affected and Cleanup Action Taken.* Soil was excavated to a maximum depth of 5 feet at DP-03-02 over an area measuring approximately 45 x 50 feet. Location DP-03-04 was excavated to a maximum depth of 2 feet over area measuring about 15 x 20 feet. Location DP-03-05 excavated to a maximum depth of 4 feet over area measuring about 35 x 50 feet Laboratory results confirmed BTEX and TPH below RRAL. The excavations were backfilled with caliche. Approximately 1,423 cubic yards of contaminated soil was disposed at Lea Land Landfill, LLC.		
I hereby certify that the information given above is true and complete to the best of my knowledge and understand that pursuant to NMOCD rules and regulations all operators are required to report and/or file certain release notifications and perform corrective actions for releases which may endanger public health or the environment. The acceptance of a C-141 report by the NMOCD marked as "Final Report" does not relieve the operator of liability should their operations have failed to adequately investigate and remediate contamination that pose a threat to ground water, surface water, human health or the environment. In addition, NMOCD acceptance of a C-141 report does not relieve the operator of responsibility for compliance with any other federal, state, or local laws and/or regulations.		
Signature:		OIL CONSERVATION DIVISION
Printed Name: Luke Williams		Approved by Environmental Specialist: <i>Bradford Billings</i>
Title: EH&S Coordinator	Approval Date: 11/19/2019	Expiration Date:
E-mail Address: Luke_Williams@xtoenergy.com	Conditions of Approval:	Attached <input type="checkbox"/>
Date: 03-21-2016	Phone: (432) 683-8873	

* Attach Additional Sheets If Necessary