



PHONE (575) 397-6388 • FAX (575) 397- 0397 • 1324 W. MARLAND • P.O. BOX 805 • HOBBS, NM 88241-0805
E-MAIL: cbrunson@bbcinternational.com

DELINEATION WORKPLAN

OXY – WEST DOLLARHIDE DEVONIAN UNIT #102 (Leak Date: 3/24/19)

RP # 1RP-5471

This delineation workplan and remediation proposal addresses the releases associated with RP # 2RP-5471.

The following information includes:

1. Appropriate completed and signed C-141 pages.
2. Scaled digital site map with spill area demarcated and leak point identified along with sample point locations and areas of remediation at appropriate depths.
3. GPS information for sample points and sample methodology.
4. Depth to groundwater information (i.e., pdf of OSE search results, USGS search results, and/or copy of Chevron groundwater trend map).
5. Watercourse/features map within 1000 feet.
6. BLM Cave Karst map.
7. FEMA National Flood map.
8. Laboratory analysis results summary table and original laboratory analysis reports.
9. Potentially other pertinent information as necessary for site specific purposes.

Based on the information included in this package and the NMOCD rules, the following remediation is proposed:

OXY will excavate the spill area as depicted on the following site diagram. The entire leak area (BLUE shade on diagram) will be excavated to a depth of 6 inches.

Bottom confirmation samples will be collected at no greater than 75 ft. intervals. Estimated volume of material to be removed is 43 cubic yards. The remediation will be completed within 90 days of plan approval.

The entire site will then be backfilled with clean soil and revegetated (if warranted) to the standards of the appropriate regulatory agency or private surface owner.

All excavated materials will be disposed of at an NMOCD-approved disposal facility.

SF6TX-191118-C-1410

Form C-141

Page 3

State of New Mexico
Oil Conservation Division

Incident ID	
District RP	1RP-5471
Facility ID	
Application ID	

Site Assessment/Characterization*This information must be provided to the appropriate district office no later than 90 days after the release discovery date.*

What is the shallowest depth to groundwater beneath the area affected by the release?	300 (ft bgs)
Did this release impact groundwater or surface water?	<input type="checkbox"/> Yes <input checked="" type="checkbox"/> No
Are the lateral extents of the release within 300 feet of a continuously flowing watercourse or any other significant watercourse?	<input type="checkbox"/> Yes <input checked="" type="checkbox"/> No
Are the lateral extents of the release within 200 feet of any lakebed, sinkhole, or playa lake (measured from the ordinary high-water mark)?	<input type="checkbox"/> Yes <input checked="" type="checkbox"/> No
Are the lateral extents of the release within 300 feet of an occupied permanent residence, school, hospital, institution, or church?	<input type="checkbox"/> Yes <input checked="" type="checkbox"/> No
Are the lateral extents of the release within 500 horizontal feet of a spring or a private domestic fresh water well used by less than five households for domestic or stock watering purposes?	<input type="checkbox"/> Yes <input checked="" type="checkbox"/> No
Are the lateral extents of the release within 1000 feet of any other fresh water well or spring?	<input type="checkbox"/> Yes <input checked="" type="checkbox"/> No
Are the lateral extents of the release within incorporated municipal boundaries or within a defined municipal fresh water well field?	<input type="checkbox"/> Yes <input checked="" type="checkbox"/> No
Are the lateral extents of the release within 300 feet of a wetland?	<input type="checkbox"/> Yes <input checked="" type="checkbox"/> No
Are the lateral extents of the release overlying a subsurface mine?	<input type="checkbox"/> Yes <input checked="" type="checkbox"/> No
Are the lateral extents of the release overlying an unstable area such as karst geology?	<input type="checkbox"/> Yes <input checked="" type="checkbox"/> No
Are the lateral extents of the release within a 100-year floodplain?	<input type="checkbox"/> Yes <input checked="" type="checkbox"/> No
Did the release impact areas not on an exploration, development, production, or storage site?	<input checked="" type="checkbox"/> Yes <input type="checkbox"/> No

Attach a comprehensive report (electronic submittals in .pdf format are preferred) demonstrating the lateral and vertical extents of soil contamination associated with the release have been determined. Refer to 19.15.29.11 NMAC for specifics.

Characterization Report Checklist: *Each of the following items must be included in the report.*

- ☒ Scaled site map showing impacted area, surface features, subsurface features, delineation points, and monitoring wells.
- ☐ Field data
- ☒ Data table of soil contaminant concentration data
- ☒ Depth to water determination
- ☒ Determination of water sources and significant watercourses within ½-mile of the lateral extents of the release
- ☐ Boring or excavation logs
- ☐ Photographs including date and GIS information
- ☒ Topographic/Aerial maps
- ☒ Laboratory data including chain of custody

If the site characterization report does not include completed efforts at remediation of the release, the report must include a proposed remediation plan. That plan must include the estimated volume of material to be remediated, the proposed remediation technique, proposed sampling plan and methods, anticipated timelines for beginning and completing the remediation. The closure criteria for a release are contained in Table 1 of 19.15.29.12 NMAC, however, use of the table is modified by site- and release-specific parameters.

Form C-141

Page 4

State of New Mexico
Oil Conservation Division

Incident ID	
District RP	1RP-5471
Facility ID	
Application ID	

I hereby certify that the information given above is true and complete to the best of my knowledge and understand that pursuant to OCD rules and regulations all operators are required to report and/or file certain release notifications and perform corrective actions for releases which may endanger public health or the environment. The acceptance of a C-141 report by the OCD does not relieve the operator of liability should their operations have failed to adequately investigate and remediate contamination that pose a threat to groundwater, surface water, human health or the environment. In addition, OCD acceptance of a C-141 report does not relieve the operator of responsibility for compliance with any other federal, state, or local laws and/or regulations.

Printed Name: Wade Dittrich Title: Environmental CoordinatorSignature:  Date: 5-20-19email: wade_dittrich@oxy.com Telephone: (575) 390-2828**OCD Only**

Received by: _____ Date: _____

Form C-141

Page 5

State of New Mexico
Oil Conservation Division

Incident ID	
District RP	1RP-5471
Facility ID	
Application ID	

Remediation Plan

Remediation Plan Checklist: Each of the following items must be included in the plan.

- ☒ Detailed description of proposed remediation technique
- ☒ Scaled sitemap with GPS coordinates showing delineation points
- ☒ Estimated volume of material to be remediated
- ☒ Closure criteria is to Table 1 specifications subject to 19.15.29.12(C)(4) NMAC
- ☒ Proposed schedule for remediation (note if remediation plan timeline is more than 90 days OCD approval is required)

Deferral Requests Only: Each of the following items must be confirmed as part of any request for deferral of remediation.

- ☐ Contamination must be in areas immediately under or around production equipment where remediation could cause a major facility deconstruction.
- ☐ Extents of contamination must be fully delineated.
- ☐ Contamination does not cause an imminent risk to human health, the environment, or groundwater.

I hereby certify that the information given above is true and complete to the best of my knowledge and understand that pursuant to OCD rules and regulations all operators are required to report and/or file certain release notifications and perform corrective actions for releases which may endanger public health or the environment. The acceptance of a C-141 report by the OCD does not relieve the operator of liability should their operations have failed to adequately investigate and remediate contamination that pose a threat to groundwater, surface water, human health or the environment. In addition, OCD acceptance of a C-141 report does not relieve the operator of responsibility for compliance with any other federal, state, or local laws and/or regulations.

Printed Name: Wade Dittrich Title: Environmental Coordinator
Signature:  Date: 5-20-19
email: wade_dittrich@oxy.com Telephone: (575) 390-2828

OCD Only

Received by: _____ Date: _____

☐ Approved ☐ Approved with Attached Conditions of Approval ☐ Denied ☐ Deferral Approved

Signature: _____ Date: _____

Oxy, WDDU #102

Leak date: 3/24/19
Lea County, NM
1RP-5471

Legend

- 6 inch Excavation
- Sample points
- Leak area



Google Earth

© 2018 Google

Oxy, WDDU #102

Sample points

SP1, N 32.17184 W-103.07020

SP2, N 32.17203 W-103.07023

SP3, N 32.17221 W-103.07025

SP4, N 32.17234 W-103.07026

SP5, N 32.17251 W-103.07026

SP6, N 32.17270 W-103.07026

SP7, N 32.17284 W-103.07026

SP8, N 32.17301 W-103.07025

NORTH, N 32.17303 W-103.07023

SOUTH, N 32.17180 W-103.07019

EAST, N 32.17194 W-103.07020

WEST, N 32.17238 W-103.07029

Oxy, West Dollarhide Drinkard Unit Well #102
U/L L, Section 33, T24S, R38E
Groundwater: 300'





USGS Home
Contact USGS
Search USGS

National Water Information System: Web Interface

[USGS Water Resources](#)

Data Category: Geographic Area:

Click to hide News Bulletins

- [Introducing The Next Generation of USGS Water Data for the Nation](#)
- [Full News](#) 

Groundwater levels for New Mexico

Click to hide state-specific text

Search Results -- 1 sites found

Agency code = usgs

site_no list =

- 320946103040101

Minimum number of levels = 1

[Save file of selected sites](#) to local disk for future upload

USGS 320946103040101 24S.38E.33.344114

Lea County, New Mexico

Latitude 32°09'46", Longitude 103°04'01" NAD27

Land-surface elevation 3,157 feet above NAVD88

The depth of the well is 765 feet below land surface.

This well is completed in the Santa Rosa Sandstone (231SNRS) local aquifer.

Output formats

Table of data
Tab-separated data
Graph of data
Reselect period

Date	Time	? Water-level date-time accuracy	Water level, feet below land surface	Water level, feet above specific vertical datum	Referenced vertical datum	? Water-level accuracy	? Status	? Method of measurement	? Measuring agency	? Source of measurement
1968-02-22		D	590.42			2	R		U	
1970-12-15		D	415.35			2	R		U	
1976-01-14		D	329.11			2			U	

Explanation

Section	Code	Description
Water-level date-time accuracy	D	Date is accurate to the Day
Water-level accuracy	2	Water level accuracy to nearest hundredth of a foot
Status		The reported water-level measurement represents a static level
Status	R	Site had been pumped recently.
Method of measurement	U	Unknown method.
Measuring agency		Not determined
Source of measurement	U	Source is unknown.
Water-level approval status	A	Approved for publication -- Processing and review completed.

[Questions about sites/data?](#)

[Feedback on this web site](#)

[Automated retrievals](#)
[Help](#)
[Data Tips](#)
[Explanation of terms](#)
[Subscribe for system changes](#)
[News](#)

[Accessibility](#) [Plug-Ins](#) [FOIA](#) [Privacy](#) [Policies and Notices](#)

[U.S. Department of the Interior](#) | [U.S. Geological Survey](#)

Title: Groundwater for New Mexico: Water Levels

URL: <https://nwis.waterdata.usgs.gov/nm/nwis/gwlevels?>



Page Contact Information: [New Mexico Water Data Maintainer](#)

Page Last Modified: 2019-04-10 12:28:42 EDT

0.49 0.46 nadww02

Oxy, WDDU #102

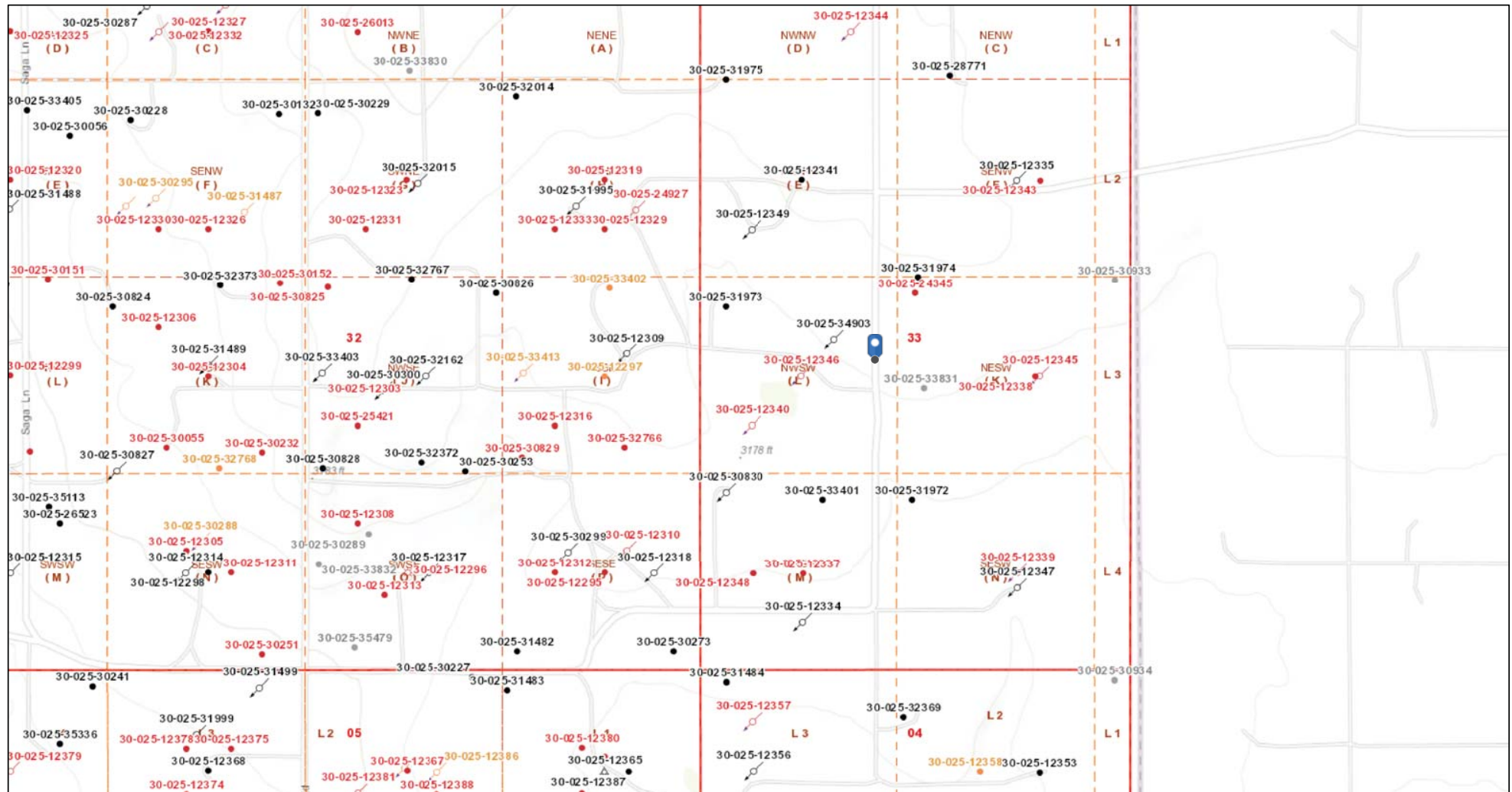

4/10/2019 10:15:27 AM

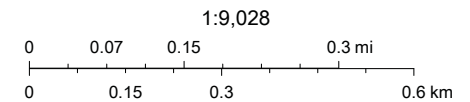
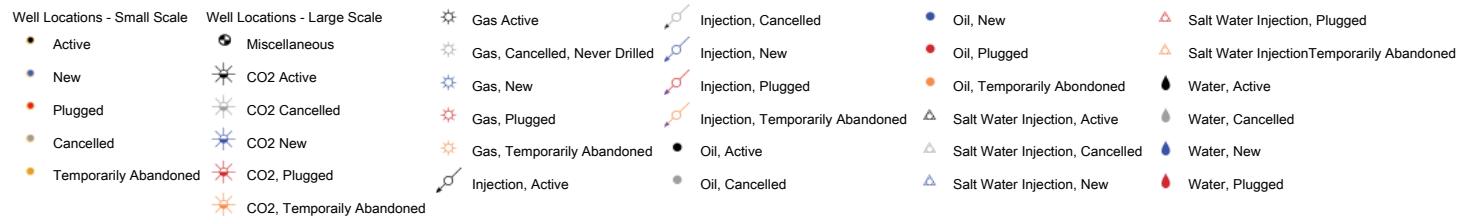



Bureau of Land Management, Texas Parks & Wildlife, Esri, HERE, Garmin, INCREMENT P, Intermap, USGS, METI/NASA, EPA, USDA, OCD, BLM

Oxy, WDDU #102

Leak date: 3/24/19
Lea County, NM

BLM CAVE KARST MAP

Legend

-  Leak area
-  Low potential

Google Earth

© 2018 Google



1000 ft

National Flood Hazard Layer FIRMette



32°10'35.58"N

103°4'31.66"W

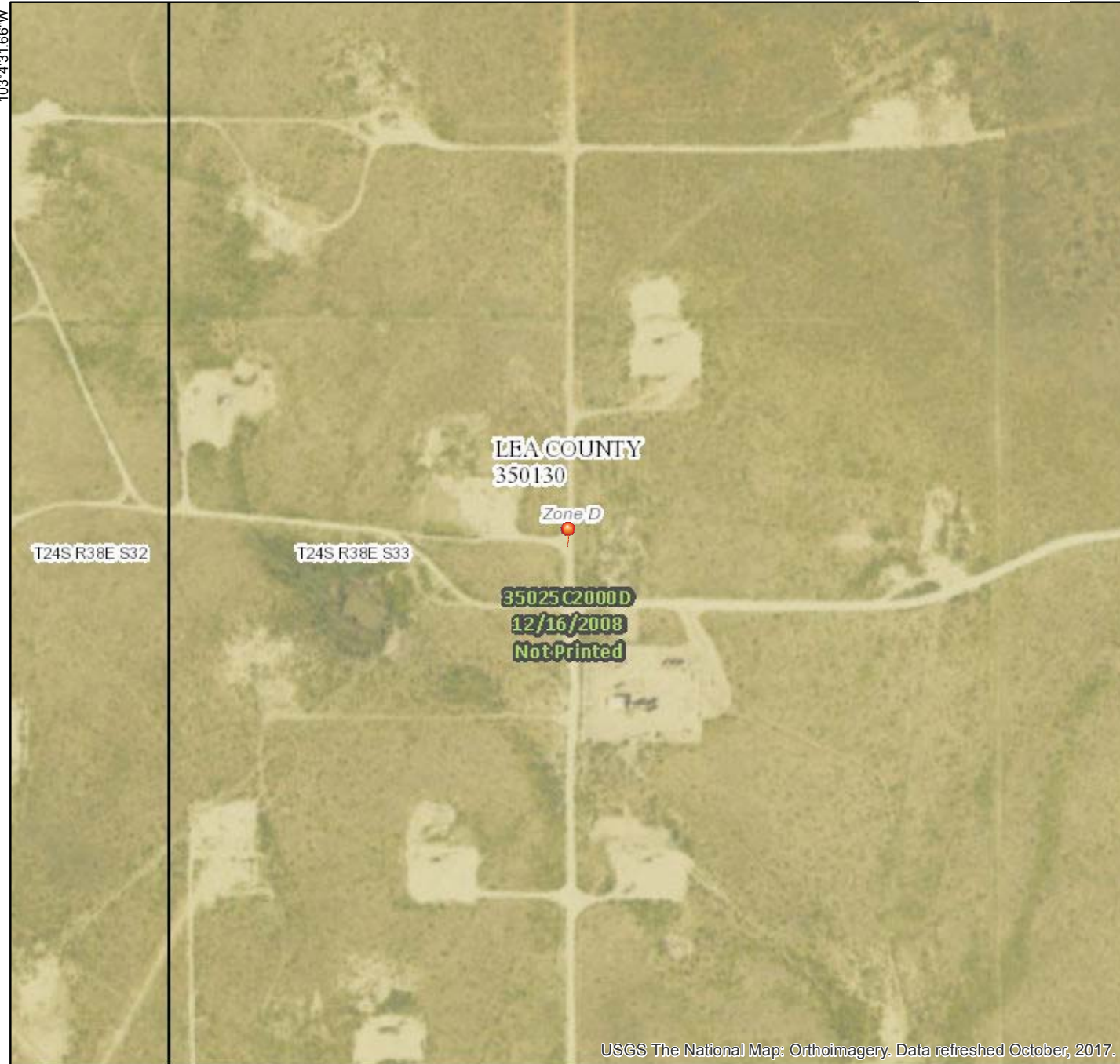

USGS The National Map: Orthoimagery. Data refreshed October, 2017.

0 250 500 1,000 1,500 2,000 Feet 1:6,000

32°10'5.12"N

Legend

SEE FIS REPORT FOR DETAILED LEGEND AND INDEX MAP FOR FIRM PANEL LAYOUT

SPECIAL FLOOD HAZARD AREAS		Without Base Flood Elevation (BFE) Zone A, V, A99
		With BFE or Depth Zone AE, AO, AH, VE, AR
		Regulatory Floodway
OTHER AREAS OF FLOOD HAZARD		0.2% Annual Chance Flood Hazard, Areas of 1% annual chance flood with average depth less than one foot or with drainage areas of less than one square mile Zone X
		Future Conditions 1% Annual Chance Flood Hazard Zone X
		Area with Reduced Flood Risk due to Levee. See Notes. Zone X
		Area with Flood Risk due to Levee Zone D
OTHER AREAS		Area of Minimal Flood Hazard Zone X
		Effective LOMRs
		Area of Undetermined Flood Hazard Zone D
GENERAL STRUCTURES		Channel, Culvert, or Storm Sewer
		Levee, Dike, or Floodwall
OTHER FEATURES		Cross Sections with 1% Annual Chance Water Surface Elevation
		Coastal Transect
		Base Flood Elevation Line (BFE)
		Limit of Study
		Jurisdiction Boundary
		Coastal Transect Baseline
		Profile Baseline
MAP PANELS		Digital Data Available
		No Digital Data Available
		Unmapped



The pin displayed on the map is an approximate point selected by the user and does not represent an authoritative property location.

This map complies with FEMA's standards for the use of digital flood maps if it is not void as described below. The basemap shown complies with FEMA's basemap accuracy standards

The flood hazard information is derived directly from the authoritative NFHL web services provided by FEMA. This map was exported on 4/10/2019 at 12:44:17 PM and does not reflect changes or amendments subsequent to this date and time. The NFHL and effective information may change or become superseded by new data over time.

This map image is void if the one or more of the following map elements do not appear: basemap imagery, flood zone labels, legend, scale bar, map creation date, community identifiers, FIRM panel number, and FIRM effective date. Map images for unmapped and unmodernized areas cannot be used for regulatory purposes.



Laboratory Analytical Results Summary
West Dollarhide Devonian Unit #102

		Sample ID	SP1 @ SURFACE	SP1 @ 1'	SP1 @ 1.5'	SP1 @ 2'
Analyte	Method	Date	4/18/19	4/18/19	4/18/19	4/18/19
			mg/kg	mg/kg	mg/kg	mg/kg
Benzene	BTEX 8021B		<0.050	<0.050	n/a	n/a
Toluene	BTEX 8021B		<0.050	<0.050	n/a	n/a
Ethylbenzene	BTEX 8021B		<0.050	<0.050	n/a	n/a
Total Xylenes	BTEX 8021B		<0.150	<0.150	n/a	n/a
Total BTEX	BTEX 8021B		<0.300	<0.300	n/a	n/a
Chloride	SM4500Cl-B		3800	800	800	224
GRO	TPH 8015M		<10.0	<10.0	n/a	n/a
DRO	TPH 8015M		<10.0	<10.0	n/a	n/a
EXT DRO	TPH 8015M		<10.0	<10.0	n/a	n/a

		Sample ID	SP2 @ SURFACE	SP2 @ 1'	SP2 @ 1.5'	SP2 @ 2'
Analyte	Method	Date	4/18/19	4/18/19	4/18/19	4/18/19
			mg/kg	mg/kg	mg/kg	mg/kg
Benzene	BTEX 8021B		<0.050	<0.050	n/a	n/a
Toluene	BTEX 8021B		<0.050	<0.050	n/a	n/a
Ethylbenzene	BTEX 8021B		<0.050	<0.050	n/a	n/a
Total Xylenes	BTEX 8021B		<0.150	<0.150	n/a	n/a
Total BTEX	BTEX 8021B		<0.300	<0.300	n/a	n/a
Chloride	SM4500Cl-B		3520	784	800	128
GRO	TPH 8015M		<10.0	<10.0	n/a	n/a
DRO	TPH 8015M		<10.0	<10.0	n/a	n/a
EXT DRO	TPH 8015M		<10.0	<10.0	n/a	n/a

		Sample ID	SP3 @ SURFACE	SP3 @ 1'	SP3 @ 1.5'	SP3 @ 2'
Analyte	Method	Date	4/18/19	4/18/19	4/18/19	4/18/19
			mg/kg	mg/kg	mg/kg	mg/kg
Benzene	BTEX 8021B		<0.050	<0.050	n/a	n/a
Toluene	BTEX 8021B		<0.050	<0.050	n/a	n/a
Ethylbenzene	BTEX 8021B		<0.050	<0.050	n/a	n/a
Total Xylenes	BTEX 8021B		<0.150	<0.150	n/a	n/a
Total BTEX	BTEX 8021B		<0.300	<0.300	n/a	n/a
Chloride	SM4500Cl-B		4120	864	384	448
GRO	TPH 8015M		<10.0	<10.0	n/a	n/a
DRO	TPH 8015M		<10.0	<10.0	n/a	n/a
EXT DRO	TPH 8015M		<10.0	<10.0	n/a	n/a

		Sample ID	SP4 @ SURFACE	SP4 @ 1'	SP4 @ 1.5'
Analyte	Method	Date	4/18/19	4/18/19	4/18/19
			mg/kg	mg/kg	mg/kg
Benzene	BTEX 8021B		<0.050	<0.050	n/a
Toluene	BTEX 8021B		<0.050	<0.050	n/a
Ethylbenzene	BTEX 8021B		<0.050	<0.050	n/a
Total Xylenes	BTEX 8021B		<0.150	<0.150	n/a
Total BTEX	BTEX 8021B		<0.300	<0.300	n/a
Chloride	SM4500Cl-B		3680	288	288
GRO	TPH 8015M		<10.0	<10.0	n/a
DRO	TPH 8015M		<10.0	<10.0	n/a
EXT DRO	TPH 8015M		<10.0	<10.0	n/a

		Sample ID	SP5 @ SURFACE	SP5 @ 1'	SP5 @ 1.5'	SP5 @ 2'
Analyte	Method	Date	4/18/19	4/19/19	4/19/19	4/19/19
			mg/kg	mg/kg	mg/kg	mg/kg
Benzene	BTEX 8021B		<0.050	<0.050	n/a	n/a
Toluene	BTEX 8021B		<0.050	<0.050	n/a	n/a
Ethylbenzene	BTEX 8021B		<0.050	<0.050	n/a	n/a
Total Xylenes	BTEX 8021B		<0.150	<0.150	n/a	n/a
Total BTEX	BTEX 8021B		<0.300	<0.300	n/a	n/a
Chloride	SM4500Cl-B		3120	640	352	544
GRO	TPH 8015M		<10.0	<10.0	n/a	n/a
DRO	TPH 8015M		<10.0	<10.0	n/a	n/a
EXT DRO	TPH 8015M		<10.0	<10.0	n/a	n/a

		Sample ID	SP6 @ SURFACE	SP6 @ 1'	SP6 @ 1.5'	SP6 @ 2'	SP6 @ 2.5'
Analyte	Method	Date	4/19/19	4/19/19	4/19/19	4/19/19	4/19/19
			mg/kg	mg/kg	mg/kg	mg/kg	mg/kg
Benzene	BTEX 8021B		<0.050	<0.050	n/a	n/a	n/a
Toluene	BTEX 8021B		<0.050	<0.050	n/a	n/a	n/a
Ethylbenzene	BTEX 8021B		<0.050	<0.050	n/a	n/a	n/a
Total Xylenes	BTEX 8021B		<0.150	<0.150	n/a	n/a	n/a
Total BTEX	BTEX 8021B		<0.300	<0.300	n/a	n/a	n/a
Chloride	SM4500Cl-B		3080	608	688	640	688
GRO	TPH 8015M		<10.0	<10.0	n/a	n/a	n/a
DRO	TPH 8015M		<10.0	<10.0	n/a	n/a	n/a
EXT DRO	TPH 8015M		<10.0	<10.0	n/a	n/a	n/a

		Sample ID	SP7 @ SURFACE	SP7 @ 1'	SP7 @ 1.5'	SP7 @ 2'
Analyte	Method	Date	4/19/19	4/19/19	4/19/19	4/19/19
			mg/kg	mg/kg	mg/kg	mg/kg
Benzene	BTEX 8021B		<0.050	<0.050	n/a	n/a
Toluene	BTEX 8021B		<0.050	<0.050	n/a	n/a
Ethylbenzene	BTEX 8021B		<0.050	<0.050	n/a	n/a
Total Xylenes	BTEX 8021B		<0.150	<0.150	n/a	n/a
Total BTEX	BTEX 8021B		<0.300	<0.300	n/a	n/a
Chloride	SM4500Cl-B		2320	752	400	304
GRO	TPH 8015M		<10.0	<10.0	n/a	n/a
DRO	TPH 8015M		<10.0	<10.0	n/a	n/a
EXT DRO	TPH 8015M		<10.0	<10.0	n/a	n/a

		Sample ID	SP8 @ SURFACE	SP8 @ 1'	SP8 @ 1.5'	SP8 @ 2'
Analyte	Method	Date	4/19/19	4/19/19	4/19/19	4/19/19
			mg/kg	mg/kg	mg/kg	mg/kg
Benzene	BTEX 8021B		<0.050	<0.050	n/a	n/a
Toluene	BTEX 8021B		<0.050	<0.050	n/a	n/a
Ethylbenzene	BTEX 8021B		<0.050	<0.050	n/a	n/a
Total Xylenes	BTEX 8021B		<0.150	<0.150	n/a	n/a
Total BTEX	BTEX 8021B		<0.300	<0.300	n/a	n/a
Chloride	SM4500Cl-B		464	800	368	240
GRO	TPH 8015M		<10.0	<10.0	n/a	n/a
DRO	TPH 8015M		<10.0	<10.0	n/a	n/a
EXT DRO	TPH 8015M		<10.0	<10.0	n/a	n/a

		Sample ID	NORTH @ SURFACE	EAST @ SURFACE	WEST @ SURFACE	SOUTH @ SURFACE
Analyte	Method	Date	4/18/19	4/19/19	4/19/19	4/19/19
			mg/kg	mg/kg	mg/kg	mg/kg
Benzene	BTEX 8021B		<0.050	<0.050	<0.050	<0.050
Toluene	BTEX 8021B		<0.050	<0.050	<0.050	<0.050
Ethylbenzene	BTEX 8021B		<0.050	<0.050	<0.050	<0.050
Total Xylenes	BTEX 8021B		<0.150	<0.150	<0.150	<0.150
Total BTEX	BTEX 8021B		<0.300	<0.300	<0.300	<0.300
Chloride	SM4500Cl-B		96	160	160	144
GRO	TPH 8015M		<10.0	<10.0	<10.0	<10.0
DRO	TPH 8015M		<10.0	<10.0	<10.0	<10.0
EXT DRO	TPH 8015M		<10.0	<10.0	<10.0	<10.0



PHONE (575) 393-2326 ° 101 E. MARLAND ° HOBBS, NM 88240

May 01, 2019

Cliff Brunson

BBC International, Inc.

P.O. Box 805

Hobbs, NM 88241

RE: WDDU - 102

Enclosed are the results of analyses for samples received by the laboratory on 04/23/19 16:45.

Cardinal Laboratories is accredited through Texas NELAP under certificate number T104704398-18-11. Accreditation applies to drinking water, non-potable water and solid and chemical materials. All accredited analytes are denoted by an asterisk (*). For a complete list of accredited analytes and matrices visit the TCEQ website at www.tceq.texas.gov/field/qa/lab_accred_certif.html.

Cardinal Laboratories is accredited through the State of Colorado Department of Public Health and Environment for:

Method EPA 552.2	Total Haloacetic Acids (HAA-5)
Method EPA 524.2	Total Trihalomethanes (TTHM)
Method EPA 524.4	Regulated VOCs (V1, V2, V3)

Cardinal Laboratories is accredited through the State of New Mexico Environment Department for:

Method SM 9223-B	Total Coliform and E. coli (Colilert MMO-MUG)
Method EPA 524.2	Regulated VOCs and Total Trihalomethanes (TTHM)
Method EPA 552.2	Total Haloacetic Acids (HAA-5)

Accreditation applies to public drinking water matrices for State of Colorado and New Mexico.

This report meets NELAP requirements and is made up of a cover page, analytical results, and a copy of the original chain-of-custody. If you have any questions concerning this report, please feel free to contact me.

Sincerely,

A handwritten signature in black ink that reads "Celey D. Keene". The signature is written in a cursive, flowing style.

Celey D. Keene

Lab Director/Quality Manager



PHONE (575) 393-2326 ° 101 E. MARLAND ° HOBBS, NM 88240

Analytical Results For:

BBC International, Inc.
P.O. Box 805
Hobbs NM, 88241

Project: WDDU - 102
Project Number: 3-24-19
Project Manager: Cliff Brunson
Fax To: (575) 397-0397

Reported:
01-May-19 11:27

Sample ID	Laboratory ID	Matrix	Date Sampled	Date Received
NORTH	H901449-01	Soil	18-Apr-19 09:09	23-Apr-19 16:45
EAST	H901449-02	Soil	18-Apr-19 09:15	23-Apr-19 16:45
WEST	H901449-03	Soil	18-Apr-19 09:22	23-Apr-19 16:45
SOUTH	H901449-04	Soil	18-Apr-19 09:32	23-Apr-19 16:45
SP 1 @ SURFACE	H901449-05	Soil	18-Apr-19 09:41	23-Apr-19 16:45
SP 1 @ 1	H901449-06	Soil	18-Apr-19 10:16	23-Apr-19 16:45
SP 1 @ 1.5	H901449-07	Soil	18-Apr-19 10:39	23-Apr-19 16:45
SP 1 @ 2	H901449-08	Soil	18-Apr-19 11:08	23-Apr-19 16:45
SP 2 @ SURFACE	H901449-09	Soil	18-Apr-19 11:15	23-Apr-19 16:45
SP 2 @ 1	H901449-10	Soil	18-Apr-19 11:38	23-Apr-19 16:45
SP 2 @ 1.5	H901449-11	Soil	18-Apr-19 11:57	23-Apr-19 16:45
SP 2 @ 2	H901449-12	Soil	18-Apr-19 13:15	23-Apr-19 16:45
SP 3 @ SURFACE	H901449-13	Soil	18-Apr-19 13:20	23-Apr-19 16:45
SP 3 @ 1	H901449-14	Soil	18-Apr-19 13:40	23-Apr-19 16:45
SP 3 @ 1.5	H901449-15	Soil	18-Apr-19 14:01	23-Apr-19 16:45
SP 3 @ 2	H901449-16	Soil	18-Apr-19 14:39	23-Apr-19 16:45
SP 4 @ SURFACE	H901449-17	Soil	18-Apr-19 14:45	23-Apr-19 16:45
SP 4 @ 1	H901449-18	Soil	18-Apr-19 15:01	23-Apr-19 16:45
SP 4 @ 1.5	H901449-19	Soil	18-Apr-19 15:25	23-Apr-19 16:45
SP 5 @ SURFACE	H901449-20	Soil	18-Apr-19 15:26	23-Apr-19 16:45
SP 5 @ 1	H901449-21	Soil	19-Apr-19 09:19	23-Apr-19 16:45
SP 5 @ 1.5	H901449-22	Soil	19-Apr-19 09:41	23-Apr-19 16:45
SP 5 @ 2	H901449-23	Soil	19-Apr-19 10:22	23-Apr-19 16:45
SP 6 @ SURFACE	H901449-24	Soil	19-Apr-19 10:30	23-Apr-19 16:45
SP 6 @ 1	H901449-25	Soil	19-Apr-19 10:50	23-Apr-19 16:45
SP 6 @ 1.5	H901449-26	Soil	19-Apr-19 11:15	23-Apr-19 16:45
SP 6 @ 2	H901449-27	Soil	19-Apr-19 11:33	23-Apr-19 16:45

Cardinal Laboratories

*=Accredited Analyte

PLEASE NOTE: Liability and Damages. Cardinal's liability and client's exclusive remedy for any claim arising, whether based in contract or tort, shall be limited to the amount paid by client for analyses. All claims, including those for negligence or any other cause whatsoever shall be deemed waived unless made in writing and received by Cardinal within thirty (30) days after completion of the applicable service. In no event shall Cardinal be liable for incidental or consequential damage including, without limitation, business interruptions, loss of use, or loss of profits incurred by client, its subsidiaries, affiliates or successors arising out of or related to the performance of the services hereunder by Cardinal, regardless of whether such claim is based upon any of the above stated reasons or otherwise. Results relate only to the samples identified above. This report shall not be reproduced except in full with written approval of Cardinal Laboratories.

Celey D. Keene, Lab Director/Quality Manager



PHONE (575) 393-2326 ° 101 E. MARLAND ° HOBBS, NM 88240

Analytical Results For:

BBC International, Inc.
P.O. Box 805
Hobbs NM, 88241

Project: WDDU - 102
Project Number: 3-24-19
Project Manager: Cliff Brunson
Fax To: (575) 397-0397

Reported:
01-May-19 11:27

SP 6 @ 2.5	H901449-28	Soil	19-Apr-19 12:01	23-Apr-19 16:45
SP 7 @ SURFACE	H901449-29	Soil	19-Apr-19 12:11	23-Apr-19 16:45
SP 7 @ 1	H901449-30	Soil	19-Apr-19 13:11	23-Apr-19 16:45
SP 7 @ 1.5	H901449-31	Soil	19-Apr-19 13:25	23-Apr-19 16:45
SP 7 @ 2	H901449-32	Soil	19-Apr-19 13:40	23-Apr-19 16:45
SP 8 @ SURFACE	H901449-33	Soil	19-Apr-19 13:45	23-Apr-19 16:45
SP 8 @ 1	H901449-34	Soil	19-Apr-19 14:11	23-Apr-19 16:45
SP 8 @ 1.5	H901449-35	Soil	19-Apr-19 14:30	23-Apr-19 16:45
SP 8 @ 2	H901449-36	Soil	19-Apr-19 15:08	23-Apr-19 16:45

Sample -30 was left off the original report for BTEX and TPH. This is the revised report with results for -30 for BTEX and TPH. This report will replace the one sent on 04/26/19.

Cardinal Laboratories

*=Accredited Analyte

PLEASE NOTE: Liability and Damages. Cardinal's liability and client's exclusive remedy for any claim arising, whether based in contract or tort, shall be limited to the amount paid by client for analyses. All claims, including those for negligence or any other cause whatsoever shall be deemed waived unless made in writing and received by Cardinal within thirty (30) days after completion of the applicable service. In no event shall Cardinal be liable for incidental or consequential damage including, without limitation, business interruptions, loss of use, or loss of profits incurred by client, its subsidiaries, affiliates or successors arising out of or related to the performance of the services hereunder by Cardinal, regardless of whether such claim is based upon any of the above stated reasons or otherwise. Results relate only to the samples identified above. This report shall not be reproduced except in full with written approval of Cardinal Laboratories.

Celey D. Keene, Lab Director/Quality Manager



PHONE (575) 393-2326 ° 101 E. MARLAND ° HOBBS, NM 88240

Analytical Results For:

BBC International, Inc.
P.O. Box 805
Hobbs NM, 88241

Project: WDDU - 102
Project Number: 3-24-19
Project Manager: Cliff Brunson
Fax To: (575) 397-0397

Reported:
01-May-19 11:27

NORTH
H901449-01 (Soil)

Analyte	Result	MDL	Reporting Limit	Units	Dilution	Batch	Analyst	Analyzed	Method	Notes
---------	--------	-----	-----------------	-------	----------	-------	---------	----------	--------	-------

Cardinal Laboratories**Inorganic Compounds**

Chloride	96.0		16.0	mg/kg	4	9042612	AC	26-Apr-19	4500-Cl-B	
----------	------	--	------	-------	---	---------	----	-----------	-----------	--

Volatile Organic Compounds by EPA Method 8021

Benzene*	<0.050		0.050	mg/kg	50	9042404	ms	24-Apr-19	8021B	
Toluene*	<0.050		0.050	mg/kg	50	9042404	ms	24-Apr-19	8021B	
Ethylbenzene*	<0.050		0.050	mg/kg	50	9042404	ms	24-Apr-19	8021B	
Total Xylenes*	<0.150		0.150	mg/kg	50	9042404	ms	24-Apr-19	8021B	
Total BTEX	<0.300		0.300	mg/kg	50	9042404	ms	24-Apr-19	8021B	

Surrogate: 4-Bromofluorobenzene (PID)			95.4 %		73.3-129	9042404	ms	24-Apr-19	8021B	
---------------------------------------	--	--	--------	--	----------	---------	----	-----------	-------	--

Petroleum Hydrocarbons by GC FID

GRO C6-C10*	<10.0		10.0	mg/kg	1	9042409	MS	25-Apr-19	8015B	
DRO >C10-C28*	<10.0		10.0	mg/kg	1	9042409	MS	25-Apr-19	8015B	
EXT DRO >C28-C36	<10.0		10.0	mg/kg	1	9042409	MS	25-Apr-19	8015B	

Surrogate: 1-Chlorooctane			114 %		41-142	9042409	MS	25-Apr-19	8015B	
---------------------------	--	--	-------	--	--------	---------	----	-----------	-------	--

Surrogate: 1-Chlorooctadecane			113 %		37.6-147	9042409	MS	25-Apr-19	8015B	
-------------------------------	--	--	-------	--	----------	---------	----	-----------	-------	--

Cardinal Laboratories

*=Accredited Analyte

PLEASE NOTE: Liability and Damages. Cardinal's liability and client's exclusive remedy for any claim arising, whether based in contract or tort, shall be limited to the amount paid by client for analyses. All claims, including those for negligence or any other cause whatsoever shall be deemed waived unless made in writing and received by Cardinal within thirty (30) days after completion of the applicable service. In no event shall Cardinal be liable for incidental or consequential damage including, without limitation, business interruptions, loss of use, or loss of profits incurred by client, its subsidiaries, affiliates or successors arising out of or related to the performance of the services hereunder by Cardinal, regardless of whether such claim is based upon any of the above stated reasons or otherwise. Results relate only to the samples identified above. This report shall not be reproduced except in full with written approval of Cardinal Laboratories.

Celey D. Keene, Lab Director/Quality Manager



PHONE (575) 393-2326 ° 101 E. MARLAND ° HOBBS, NM 88240

Analytical Results For:

BBC International, Inc.
P.O. Box 805
Hobbs NM, 88241

Project: WDDU - 102
Project Number: 3-24-19
Project Manager: Cliff Brunson
Fax To: (575) 397-0397

Reported:
01-May-19 11:27

EAST
H901449-02 (Soil)

Analyte	Result	MDL	Reporting Limit	Units	Dilution	Batch	Analyst	Analyzed	Method	Notes
---------	--------	-----	-----------------	-------	----------	-------	---------	----------	--------	-------

Cardinal Laboratories**Inorganic Compounds**

Chloride	160		16.0	mg/kg	4	9042612	AC	26-Apr-19	4500-Cl-B	
-----------------	------------	--	------	-------	---	---------	----	-----------	-----------	--

Volatile Organic Compounds by EPA Method 8021

Benzene*	<0.050	0.050	mg/kg	50	9042404	ms	24-Apr-19	8021B	
Toluene*	<0.050	0.050	mg/kg	50	9042404	ms	24-Apr-19	8021B	
Ethylbenzene*	<0.050	0.050	mg/kg	50	9042404	ms	24-Apr-19	8021B	
Total Xylenes*	<0.150	0.150	mg/kg	50	9042404	ms	24-Apr-19	8021B	
Total BTEX	<0.300	0.300	mg/kg	50	9042404	ms	24-Apr-19	8021B	

Surrogate: 4-Bromofluorobenzene (PID)		96.1 %		73.3-129	9042404	ms	24-Apr-19	8021B	
---------------------------------------	--	--------	--	----------	---------	----	-----------	-------	--

Petroleum Hydrocarbons by GC FID

GRO C6-C10*	<10.0	10.0	mg/kg	1	9042409	MS	25-Apr-19	8015B	
DRO >C10-C28*	<10.0	10.0	mg/kg	1	9042409	MS	25-Apr-19	8015B	
EXT DRO >C28-C36	<10.0	10.0	mg/kg	1	9042409	MS	25-Apr-19	8015B	

Surrogate: 1-Chlorooctane		105 %		41-142	9042409	MS	25-Apr-19	8015B	
---------------------------	--	-------	--	--------	---------	----	-----------	-------	--

Surrogate: 1-Chlorooctadecane		105 %		37.6-147	9042409	MS	25-Apr-19	8015B	
-------------------------------	--	-------	--	----------	---------	----	-----------	-------	--

Cardinal Laboratories

*=Accredited Analyte

PLEASE NOTE: Liability and Damages. Cardinal's liability and client's exclusive remedy for any claim arising, whether based in contract or tort, shall be limited to the amount paid by client for analyses. All claims, including those for negligence or any other cause whatsoever shall be deemed waived unless made in writing and received by Cardinal within thirty (30) days after completion of the applicable service. In no event shall Cardinal be liable for incidental or consequential damage including, without limitation, business interruptions, loss of use, or loss of profits incurred by client, its subsidiaries, affiliates or successors arising out of or related to the performance of the services hereunder by Cardinal, regardless of whether such claim is based upon any of the above stated reasons or otherwise. Results relate only to the samples identified above. This report shall not be reproduced except in full with written approval of Cardinal Laboratories.

Celey D. Keene, Lab Director/Quality Manager



PHONE (575) 393-2326 ° 101 E. MARLAND ° HOBBS, NM 88240

Analytical Results For:

BBC International, Inc.
P.O. Box 805
Hobbs NM, 88241

Project: WDDU - 102
Project Number: 3-24-19
Project Manager: Cliff Brunson
Fax To: (575) 397-0397

Reported:
01-May-19 11:27

WEST
H901449-03 (Soil)

Analyte	Result	MDL	Reporting Limit	Units	Dilution	Batch	Analyst	Analyzed	Method	Notes
---------	--------	-----	-----------------	-------	----------	-------	---------	----------	--------	-------

Cardinal Laboratories**Inorganic Compounds**

Chloride	160		16.0	mg/kg	4	9042612	AC	26-Apr-19	4500-Cl-B	
-----------------	------------	--	------	-------	---	---------	----	-----------	-----------	--

Volatile Organic Compounds by EPA Method 8021

Benzene*	<0.050	0.050	mg/kg	50	9042404	ms	24-Apr-19	8021B	
Toluene*	<0.050	0.050	mg/kg	50	9042404	ms	24-Apr-19	8021B	
Ethylbenzene*	<0.050	0.050	mg/kg	50	9042404	ms	24-Apr-19	8021B	
Total Xylenes*	<0.150	0.150	mg/kg	50	9042404	ms	24-Apr-19	8021B	
Total BTEX	<0.300	0.300	mg/kg	50	9042404	ms	24-Apr-19	8021B	

Surrogate: 4-Bromofluorobenzene (PID)		96.2 %		73.3-129	9042404	ms	24-Apr-19	8021B	
---------------------------------------	--	--------	--	----------	---------	----	-----------	-------	--

Petroleum Hydrocarbons by GC FID

GRO C6-C10*	<10.0	10.0	mg/kg	1	9042409	MS	25-Apr-19	8015B	
DRO >C10-C28*	<10.0	10.0	mg/kg	1	9042409	MS	25-Apr-19	8015B	
EXT DRO >C28-C36	<10.0	10.0	mg/kg	1	9042409	MS	25-Apr-19	8015B	

Surrogate: 1-Chlorooctane		119 %		41-142	9042409	MS	25-Apr-19	8015B	
---------------------------	--	-------	--	--------	---------	----	-----------	-------	--

Surrogate: 1-Chlorooctadecane		119 %		37.6-147	9042409	MS	25-Apr-19	8015B	
-------------------------------	--	-------	--	----------	---------	----	-----------	-------	--

Cardinal Laboratories

*=Accredited Analyte

PLEASE NOTE: Liability and Damages. Cardinal's liability and client's exclusive remedy for any claim arising, whether based in contract or tort, shall be limited to the amount paid by client for analyses. All claims, including those for negligence or any other cause whatsoever shall be deemed waived unless made in writing and received by Cardinal within thirty (30) days after completion of the applicable service. In no event shall Cardinal be liable for incidental or consequential damage including, without limitation, business interruptions, loss of use, or loss of profits incurred by client, its subsidiaries, affiliates or successors arising out of or related to the performance of the services hereunder by Cardinal, regardless of whether such claim is based upon any of the above stated reasons or otherwise. Results relate only to the samples identified above. This report shall not be reproduced except in full with written approval of Cardinal Laboratories.

Celey D. Keene, Lab Director/Quality Manager



PHONE (575) 393-2326 ° 101 E. MARLAND ° HOBBS, NM 88240

Analytical Results For:

BBC International, Inc.
P.O. Box 805
Hobbs NM, 88241

Project: WDDU - 102
Project Number: 3-24-19
Project Manager: Cliff Brunson
Fax To: (575) 397-0397

Reported:
01-May-19 11:27

SOUTH
H901449-04 (Soil)

Analyte	Result	MDL	Reporting Limit	Units	Dilution	Batch	Analyst	Analyzed	Method	Notes
---------	--------	-----	-----------------	-------	----------	-------	---------	----------	--------	-------

Cardinal Laboratories**Inorganic Compounds**

Chloride	144		16.0	mg/kg	4	9042612	AC	26-Apr-19	4500-Cl-B	
-----------------	------------	--	------	-------	---	---------	----	-----------	-----------	--

Volatile Organic Compounds by EPA Method 8021

Benzene*	<0.050	0.050	mg/kg	50	9042404	ms	24-Apr-19	8021B	
Toluene*	<0.050	0.050	mg/kg	50	9042404	ms	24-Apr-19	8021B	
Ethylbenzene*	<0.050	0.050	mg/kg	50	9042404	ms	24-Apr-19	8021B	
Total Xylenes*	<0.150	0.150	mg/kg	50	9042404	ms	24-Apr-19	8021B	
Total BTEX	<0.300	0.300	mg/kg	50	9042404	ms	24-Apr-19	8021B	

Surrogate: 4-Bromofluorobenzene (PID)		95.3 %		73.3-129	9042404	ms	24-Apr-19	8021B	
---------------------------------------	--	--------	--	----------	---------	----	-----------	-------	--

Petroleum Hydrocarbons by GC FID

GRO C6-C10*	<10.0	10.0	mg/kg	1	9042409	MS	25-Apr-19	8015B	
DRO >C10-C28*	<10.0	10.0	mg/kg	1	9042409	MS	25-Apr-19	8015B	
EXT DRO >C28-C36	<10.0	10.0	mg/kg	1	9042409	MS	25-Apr-19	8015B	

Surrogate: 1-Chlorooctane		112 %		41-142	9042409	MS	25-Apr-19	8015B	
---------------------------	--	-------	--	--------	---------	----	-----------	-------	--

Surrogate: 1-Chlorooctadecane		112 %		37.6-147	9042409	MS	25-Apr-19	8015B	
-------------------------------	--	-------	--	----------	---------	----	-----------	-------	--

Cardinal Laboratories

*=Accredited Analyte

PLEASE NOTE: Liability and Damages. Cardinal's liability and client's exclusive remedy for any claim arising, whether based in contract or tort, shall be limited to the amount paid by client for analyses. All claims, including those for negligence or any other cause whatsoever shall be deemed waived unless made in writing and received by Cardinal within thirty (30) days after completion of the applicable service. In no event shall Cardinal be liable for incidental or consequential damage including, without limitation, business interruptions, loss of use, or loss of profits incurred by client, its subsidiaries, affiliates or successors arising out of or related to the performance of the services hereunder by Cardinal, regardless of whether such claim is based upon any of the above stated reasons or otherwise. Results relate only to the samples identified above. This report shall not be reproduced except in full with written approval of Cardinal Laboratories.

Celey D. Keene, Lab Director/Quality Manager



PHONE (575) 393-2326 ° 101 E. MARLAND ° HOBBS, NM 88240

Analytical Results For:

BBC International, Inc.
P.O. Box 805
Hobbs NM, 88241

Project: WDDU - 102
Project Number: 3-24-19
Project Manager: Cliff Brunson
Fax To: (575) 397-0397

Reported:
01-May-19 11:27

SP 1 @ SURFACE
H901449-05 (Soil)

Analyte	Result	MDL	Reporting Limit	Units	Dilution	Batch	Analyst	Analyzed	Method	Notes
---------	--------	-----	-----------------	-------	----------	-------	---------	----------	--------	-------

Cardinal Laboratories**Inorganic Compounds**

Chloride	3800		16.0	mg/kg	4	9042612	AC	26-Apr-19	4500-Cl-B	
-----------------	-------------	--	------	-------	---	---------	----	-----------	-----------	--

Volatile Organic Compounds by EPA Method 8021

Benzene*	<0.050	0.050	mg/kg	50	9042404	ms	24-Apr-19	8021B	
Toluene*	<0.050	0.050	mg/kg	50	9042404	ms	24-Apr-19	8021B	
Ethylbenzene*	<0.050	0.050	mg/kg	50	9042404	ms	24-Apr-19	8021B	
Total Xylenes*	<0.150	0.150	mg/kg	50	9042404	ms	24-Apr-19	8021B	
Total BTEX	<0.300	0.300	mg/kg	50	9042404	ms	24-Apr-19	8021B	

<i>Surrogate: 4-Bromofluorobenzene (PID)</i>		95.9 %		73.3-129	9042404	ms	24-Apr-19	8021B	
--	--	--------	--	----------	---------	----	-----------	-------	--

Petroleum Hydrocarbons by GC FID

GRO C6-C10*	<10.0	10.0	mg/kg	1	9042409	MS	25-Apr-19	8015B	
DRO >C10-C28*	<10.0	10.0	mg/kg	1	9042409	MS	25-Apr-19	8015B	
EXT DRO >C28-C36	<10.0	10.0	mg/kg	1	9042409	MS	25-Apr-19	8015B	

<i>Surrogate: 1-Chlorooctane</i>		110 %		41-142	9042409	MS	25-Apr-19	8015B	
----------------------------------	--	-------	--	--------	---------	----	-----------	-------	--

<i>Surrogate: 1-Chlorooctadecane</i>		111 %		37.6-147	9042409	MS	25-Apr-19	8015B	
--------------------------------------	--	-------	--	----------	---------	----	-----------	-------	--

Cardinal Laboratories

*=Accredited Analyte

PLEASE NOTE: Liability and Damages. Cardinal's liability and client's exclusive remedy for any claim arising, whether based in contract or tort, shall be limited to the amount paid by client for analyses. All claims, including those for negligence or any other cause whatsoever shall be deemed waived unless made in writing and received by Cardinal within thirty (30) days after completion of the applicable service. In no event shall Cardinal be liable for incidental or consequential damage including, without limitation, business interruptions, loss of use, or loss of profits incurred by client, its subsidiaries, affiliates or successors arising out of or related to the performance of the services hereunder by Cardinal, regardless of whether such claim is based upon any of the above stated reasons or otherwise. Results relate only to the samples identified above. This report shall not be reproduced except in full with written approval of Cardinal Laboratories.

Celey D. Keene, Lab Director/Quality Manager



PHONE (575) 393-2326 ° 101 E. MARLAND ° HOBBS, NM 88240

Analytical Results For:

BBC International, Inc.
P.O. Box 805
Hobbs NM, 88241

Project: WDDU - 102
Project Number: 3-24-19
Project Manager: Cliff Brunson
Fax To: (575) 397-0397

Reported:
01-May-19 11:27

SP 1 @ 1
H901449-06 (Soil)

Analyte	Result	MDL	Reporting Limit	Units	Dilution	Batch	Analyst	Analyzed	Method	Notes
---------	--------	-----	-----------------	-------	----------	-------	---------	----------	--------	-------

Cardinal Laboratories**Inorganic Compounds**

Chloride	800		16.0	mg/kg	4	9042612	AC	26-Apr-19	4500-Cl-B	
-----------------	------------	--	------	-------	---	---------	----	-----------	-----------	--

Volatile Organic Compounds by EPA Method 8021

Benzene*	<0.050	0.050	mg/kg	50	9042404	ms	24-Apr-19	8021B	
Toluene*	<0.050	0.050	mg/kg	50	9042404	ms	24-Apr-19	8021B	
Ethylbenzene*	<0.050	0.050	mg/kg	50	9042404	ms	24-Apr-19	8021B	
Total Xylenes*	<0.150	0.150	mg/kg	50	9042404	ms	24-Apr-19	8021B	
Total BTEX	<0.300	0.300	mg/kg	50	9042404	ms	24-Apr-19	8021B	

Surrogate: 4-Bromofluorobenzene (PID)		96.9 %		73.3-129	9042404	ms	24-Apr-19	8021B	
---------------------------------------	--	--------	--	----------	---------	----	-----------	-------	--

Petroleum Hydrocarbons by GC FID

GRO C6-C10*	<10.0	10.0	mg/kg	1	9042409	MS	25-Apr-19	8015B	
DRO >C10-C28*	<10.0	10.0	mg/kg	1	9042409	MS	25-Apr-19	8015B	
EXT DRO >C28-C36	<10.0	10.0	mg/kg	1	9042409	MS	25-Apr-19	8015B	

Surrogate: 1-Chlorooctane		99.5 %		41-142	9042409	MS	25-Apr-19	8015B	
---------------------------	--	--------	--	--------	---------	----	-----------	-------	--

Surrogate: 1-Chlorooctadecane		101 %		37.6-147	9042409	MS	25-Apr-19	8015B	
-------------------------------	--	-------	--	----------	---------	----	-----------	-------	--

Cardinal Laboratories

*=Accredited Analyte

PLEASE NOTE: Liability and Damages. Cardinal's liability and client's exclusive remedy for any claim arising, whether based in contract or tort, shall be limited to the amount paid by client for analyses. All claims, including those for negligence or any other cause whatsoever shall be deemed waived unless made in writing and received by Cardinal within thirty (30) days after completion of the applicable service. In no event shall Cardinal be liable for incidental or consequential damage including, without limitation, business interruptions, loss of use, or loss of profits incurred by client, its subsidiaries, affiliates or successors arising out of or related to the performance of the services hereunder by Cardinal, regardless of whether such claim is based upon any of the above stated reasons or otherwise. Results relate only to the samples identified above. This report shall not be reproduced except in full with written approval of Cardinal Laboratories.

Celey D. Keene, Lab Director/Quality Manager



PHONE (575) 393-2326 ° 101 E. MARLAND ° HOBBS, NM 88240

Analytical Results For:

BBC International, Inc.
P.O. Box 805
Hobbs NM, 88241

Project: WDDU - 102
Project Number: 3-24-19
Project Manager: Cliff Brunson
Fax To: (575) 397-0397

Reported:
01-May-19 11:27

SP 1 @ 1.5
H901449-07 (Soil)

Analyte	Result	MDL	Reporting Limit	Units	Dilution	Batch	Analyst	Analyzed	Method	Notes
---------	--------	-----	-----------------	-------	----------	-------	---------	----------	--------	-------

Cardinal Laboratories**Inorganic Compounds**

Chloride	800		16.0	mg/kg	4	9042613	AC	26-Apr-19	4500-Cl-B	
-----------------	------------	--	------	-------	---	---------	----	-----------	-----------	--

Cardinal Laboratories

*=Accredited Analyte

PLEASE NOTE: Liability and Damages. Cardinal's liability and client's exclusive remedy for any claim arising, whether based in contract or tort, shall be limited to the amount paid by client for analyses. All claims, including those for negligence or any other cause whatsoever shall be deemed waived unless made in writing and received by Cardinal within thirty (30) days after completion of the applicable service. In no event shall Cardinal be liable for incidental or consequential damage including, without limitation, business interruptions, loss of use, or loss of profits incurred by client, its subsidiaries, affiliates or successors arising out of or related to the performance of the services hereunder by Cardinal, regardless of whether such claim is based upon any of the above stated reasons or otherwise. Results relate only to the samples identified above. This report shall not be reproduced except in full with written approval of Cardinal Laboratories.

Celey D. Keene, Lab Director/Quality Manager



PHONE (575) 393-2326 ° 101 E. MARLAND ° HOBBS, NM 88240

Analytical Results For:

BBC International, Inc.
P.O. Box 805
Hobbs NM, 88241

Project: WDDU - 102
Project Number: 3-24-19
Project Manager: Cliff Brunson
Fax To: (575) 397-0397

Reported:
01-May-19 11:27

SP 1 @ 2
H901449-08 (Soil)

Analyte	Result	MDL	Reporting Limit	Units	Dilution	Batch	Analyst	Analyzed	Method	Notes
---------	--------	-----	-----------------	-------	----------	-------	---------	----------	--------	-------

Cardinal Laboratories**Inorganic Compounds**

Chloride	224		16.0	mg/kg	4	9042613	AC	26-Apr-19	4500-Cl-B	
-----------------	------------	--	------	-------	---	---------	----	-----------	-----------	--

Cardinal Laboratories

*=Accredited Analyte

PLEASE NOTE: Liability and Damages. Cardinal's liability and client's exclusive remedy for any claim arising, whether based in contract or tort, shall be limited to the amount paid by client for analyses. All claims, including those for negligence or any other cause whatsoever shall be deemed waived unless made in writing and received by Cardinal within thirty (30) days after completion of the applicable service. In no event shall Cardinal be liable for incidental or consequential damage including, without limitation, business interruptions, loss of use, or loss of profits incurred by client, its subsidiaries, affiliates or successors arising out of or related to the performance of the services hereunder by Cardinal, regardless of whether such claim is based upon any of the above stated reasons or otherwise. Results relate only to the samples identified above. This report shall not be reproduced except in full with written approval of Cardinal Laboratories.

Celey D. Keene, Lab Director/Quality Manager



PHONE (575) 393-2326 ° 101 E. MARLAND ° HOBBS, NM 88240

Analytical Results For:

BBC International, Inc.
P.O. Box 805
Hobbs NM, 88241

Project: WDDU - 102
Project Number: 3-24-19
Project Manager: Cliff Brunson
Fax To: (575) 397-0397

Reported:
01-May-19 11:27

SP 2 @ SURFACE
H901449-09 (Soil)

Analyte	Result	MDL	Reporting Limit	Units	Dilution	Batch	Analyst	Analyzed	Method	Notes
---------	--------	-----	-----------------	-------	----------	-------	---------	----------	--------	-------

Cardinal Laboratories**Inorganic Compounds**

Chloride	3520		16.0	mg/kg	4	9042613	AC	26-Apr-19	4500-Cl-B	
-----------------	-------------	--	------	-------	---	---------	----	-----------	-----------	--

Volatile Organic Compounds by EPA Method 8021

Benzene*	<0.050	0.050	mg/kg	50	9042404	ms	24-Apr-19	8021B	
Toluene*	<0.050	0.050	mg/kg	50	9042404	ms	24-Apr-19	8021B	
Ethylbenzene*	<0.050	0.050	mg/kg	50	9042404	ms	24-Apr-19	8021B	
Total Xylenes*	<0.150	0.150	mg/kg	50	9042404	ms	24-Apr-19	8021B	
Total BTEX	<0.300	0.300	mg/kg	50	9042404	ms	24-Apr-19	8021B	

Surrogate: 4-Bromofluorobenzene (PID)		95.8 %		73.3-129	9042404	ms	24-Apr-19	8021B	
---------------------------------------	--	--------	--	----------	---------	----	-----------	-------	--

Petroleum Hydrocarbons by GC FID

GRO C6-C10*	<10.0	10.0	mg/kg	1	9042409	MS	25-Apr-19	8015B	
DRO >C10-C28*	<10.0	10.0	mg/kg	1	9042409	MS	25-Apr-19	8015B	
EXT DRO >C28-C36	<10.0	10.0	mg/kg	1	9042409	MS	25-Apr-19	8015B	

Surrogate: 1-Chlorooctane		108 %		41-142	9042409	MS	25-Apr-19	8015B	
---------------------------	--	-------	--	--------	---------	----	-----------	-------	--

Surrogate: 1-Chlorooctadecane		109 %		37.6-147	9042409	MS	25-Apr-19	8015B	
-------------------------------	--	-------	--	----------	---------	----	-----------	-------	--

Cardinal Laboratories

*=Accredited Analyte

PLEASE NOTE: Liability and Damages. Cardinal's liability and client's exclusive remedy for any claim arising, whether based in contract or tort, shall be limited to the amount paid by client for analyses. All claims, including those for negligence or any other cause whatsoever shall be deemed waived unless made in writing and received by Cardinal within thirty (30) days after completion of the applicable service. In no event shall Cardinal be liable for incidental or consequential damage including, without limitation, business interruptions, loss of use, or loss of profits incurred by client, its subsidiaries, affiliates or successors arising out of or related to the performance of the services hereunder by Cardinal, regardless of whether such claim is based upon any of the above stated reasons or otherwise. Results relate only to the samples identified above. This report shall not be reproduced except in full with written approval of Cardinal Laboratories.

Celey D. Keene, Lab Director/Quality Manager



PHONE (575) 393-2326 ° 101 E. MARLAND ° HOBBS, NM 88240

Analytical Results For:

BBC International, Inc.
P.O. Box 805
Hobbs NM, 88241

Project: WDDU - 102
Project Number: 3-24-19
Project Manager: Cliff Brunson
Fax To: (575) 397-0397

Reported:
01-May-19 11:27

SP 2 @ 1
H901449-10 (Soil)

Analyte	Result	MDL	Reporting Limit	Units	Dilution	Batch	Analyst	Analyzed	Method	Notes
---------	--------	-----	-----------------	-------	----------	-------	---------	----------	--------	-------

Cardinal Laboratories**Inorganic Compounds**

Chloride	784		16.0	mg/kg	4	9042613	AC	26-Apr-19	4500-Cl-B	
-----------------	------------	--	------	-------	---	---------	----	-----------	-----------	--

Volatile Organic Compounds by EPA Method 8021

Benzene*	<0.050	0.050	mg/kg	50	9042410	ms	24-Apr-19	8021B	
Toluene*	<0.050	0.050	mg/kg	50	9042410	ms	24-Apr-19	8021B	
Ethylbenzene*	<0.050	0.050	mg/kg	50	9042410	ms	24-Apr-19	8021B	
Total Xylenes*	<0.150	0.150	mg/kg	50	9042410	ms	24-Apr-19	8021B	
Total BTEX	<0.300	0.300	mg/kg	50	9042410	ms	24-Apr-19	8021B	

Surrogate: 4-Bromofluorobenzene (PID)		97.0 %		73.3-129	9042410	ms	24-Apr-19	8021B	
---------------------------------------	--	--------	--	----------	---------	----	-----------	-------	--

Petroleum Hydrocarbons by GC FID

GRO C6-C10*	<10.0	10.0	mg/kg	1	9042409	MS	25-Apr-19	8015B	
DRO >C10-C28*	<10.0	10.0	mg/kg	1	9042409	MS	25-Apr-19	8015B	
EXT DRO >C28-C36	<10.0	10.0	mg/kg	1	9042409	MS	25-Apr-19	8015B	

Surrogate: 1-Chlorooctane		105 %		41-142	9042409	MS	25-Apr-19	8015B	
---------------------------	--	-------	--	--------	---------	----	-----------	-------	--

Surrogate: 1-Chlorooctadecane		106 %		37.6-147	9042409	MS	25-Apr-19	8015B	
-------------------------------	--	-------	--	----------	---------	----	-----------	-------	--

Cardinal Laboratories

*=Accredited Analyte

PLEASE NOTE: Liability and Damages. Cardinal's liability and client's exclusive remedy for any claim arising, whether based in contract or tort, shall be limited to the amount paid by client for analyses. All claims, including those for negligence or any other cause whatsoever shall be deemed waived unless made in writing and received by Cardinal within thirty (30) days after completion of the applicable service. In no event shall Cardinal be liable for incidental or consequential damage including, without limitation, business interruptions, loss of use, or loss of profits incurred by client, its subsidiaries, affiliates or successors arising out of or related to the performance of the services hereunder by Cardinal, regardless of whether such claim is based upon any of the above stated reasons or otherwise. Results relate only to the samples identified above. This report shall not be reproduced except in full with written approval of Cardinal Laboratories.

Celey D. Keene, Lab Director/Quality Manager



PHONE (575) 393-2326 ° 101 E. MARLAND ° HOBBS, NM 88240

Analytical Results For:

BBC International, Inc.
P.O. Box 805
Hobbs NM, 88241

Project: WDDU - 102
Project Number: 3-24-19
Project Manager: Cliff Brunson
Fax To: (575) 397-0397

Reported:
01-May-19 11:27

SP 2 @ 1.5
H901449-11 (Soil)

Analyte	Result	MDL	Reporting Limit	Units	Dilution	Batch	Analyst	Analyzed	Method	Notes
---------	--------	-----	--------------------	-------	----------	-------	---------	----------	--------	-------

Cardinal Laboratories**Inorganic Compounds**

Chloride	800		16.0	mg/kg	4	9042613	AC	26-Apr-19	4500-Cl-B	
-----------------	------------	--	------	-------	---	---------	----	-----------	-----------	--

Cardinal Laboratories

*=Accredited Analyte

PLEASE NOTE: Liability and Damages. Cardinal's liability and client's exclusive remedy for any claim arising, whether based in contract or tort, shall be limited to the amount paid by client for analyses. All claims, including those for negligence or any other cause whatsoever shall be deemed waived unless made in writing and received by Cardinal within thirty (30) days after completion of the applicable service. In no event shall Cardinal be liable for incidental or consequential damage including, without limitation, business interruptions, loss of use, or loss of profits incurred by client, its subsidiaries, affiliates or successors arising out of or related to the performance of the services hereunder by Cardinal, regardless of whether such claim is based upon any of the above stated reasons or otherwise. Results relate only to the samples identified above. This report shall not be reproduced except in full with written approval of Cardinal Laboratories.

Celey D. Keene, Lab Director/Quality Manager



PHONE (575) 393-2326 ° 101 E. MARLAND ° HOBBS, NM 88240

Analytical Results For:

BBC International, Inc.
P.O. Box 805
Hobbs NM, 88241

Project: WDDU - 102
Project Number: 3-24-19
Project Manager: Cliff Brunson
Fax To: (575) 397-0397

Reported:
01-May-19 11:27

SP 2 @ 2
H901449-12 (Soil)

Analyte	Result	MDL	Reporting Limit	Units	Dilution	Batch	Analyst	Analyzed	Method	Notes
---------	--------	-----	--------------------	-------	----------	-------	---------	----------	--------	-------

Cardinal Laboratories**Inorganic Compounds**

Analyte	Result	MDL	Reporting Limit	Units	Dilution	Batch	Analyst	Analyzed	Method	Notes
Chloride	128		16.0	mg/kg	4	9042613	AC	26-Apr-19	4500-Cl-B	

Cardinal Laboratories

*=Accredited Analyte

PLEASE NOTE: Liability and Damages. Cardinal's liability and client's exclusive remedy for any claim arising, whether based in contract or tort, shall be limited to the amount paid by client for analyses. All claims, including those for negligence or any other cause whatsoever shall be deemed waived unless made in writing and received by Cardinal within thirty (30) days after completion of the applicable service. In no event shall Cardinal be liable for incidental or consequential damage including, without limitation, business interruptions, loss of use, or loss of profits incurred by client, its subsidiaries, affiliates or successors arising out of or related to the performance of the services hereunder by Cardinal, regardless of whether such claim is based upon any of the above stated reasons or otherwise. Results relate only to the samples identified above. This report shall not be reproduced except in full with written approval of Cardinal Laboratories.

Celey D. Keene, Lab Director/Quality Manager



PHONE (575) 393-2326 ° 101 E. MARLAND ° HOBBS, NM 88240

Analytical Results For:

BBC International, Inc.
P.O. Box 805
Hobbs NM, 88241

Project: WDDU - 102
Project Number: 3-24-19
Project Manager: Cliff Brunson
Fax To: (575) 397-0397

Reported:
01-May-19 11:27

SP 3 @ SURFACE
H901449-13 (Soil)

Analyte	Result	MDL	Reporting Limit	Units	Dilution	Batch	Analyst	Analyzed	Method	Notes
---------	--------	-----	-----------------	-------	----------	-------	---------	----------	--------	-------

Cardinal Laboratories**Inorganic Compounds**

Chloride	4120		16.0	mg/kg	4	9042613	AC	26-Apr-19	4500-Cl-B	
-----------------	-------------	--	------	-------	---	---------	----	-----------	-----------	--

Volatile Organic Compounds by EPA Method 8021

Benzene*	<0.050	0.050	mg/kg	50	9042410	ms	24-Apr-19	8021B	
Toluene*	<0.050	0.050	mg/kg	50	9042410	ms	24-Apr-19	8021B	
Ethylbenzene*	<0.050	0.050	mg/kg	50	9042410	ms	24-Apr-19	8021B	
Total Xylenes*	<0.150	0.150	mg/kg	50	9042410	ms	24-Apr-19	8021B	
Total BTEX	<0.300	0.300	mg/kg	50	9042410	ms	24-Apr-19	8021B	

Surrogate: 4-Bromofluorobenzene (PID)		95.6 %		73.3-129	9042410	ms	24-Apr-19	8021B	
---------------------------------------	--	--------	--	----------	---------	----	-----------	-------	--

Petroleum Hydrocarbons by GC FID

GRO C6-C10*	<10.0	10.0	mg/kg	1	9042409	MS	25-Apr-19	8015B	
DRO >C10-C28*	<10.0	10.0	mg/kg	1	9042409	MS	25-Apr-19	8015B	
EXT DRO >C28-C36	<10.0	10.0	mg/kg	1	9042409	MS	25-Apr-19	8015B	

Surrogate: 1-Chlorooctane		105 %		41-142	9042409	MS	25-Apr-19	8015B	
---------------------------	--	-------	--	--------	---------	----	-----------	-------	--

Surrogate: 1-Chlorooctadecane		104 %		37.6-147	9042409	MS	25-Apr-19	8015B	
-------------------------------	--	-------	--	----------	---------	----	-----------	-------	--

Cardinal Laboratories

*=Accredited Analyte

PLEASE NOTE: Liability and Damages. Cardinal's liability and client's exclusive remedy for any claim arising, whether based in contract or tort, shall be limited to the amount paid by client for analyses. All claims, including those for negligence or any other cause whatsoever shall be deemed waived unless made in writing and received by Cardinal within thirty (30) days after completion of the applicable service. In no event shall Cardinal be liable for incidental or consequential damage including, without limitation, business interruptions, loss of use, or loss of profits incurred by client, its subsidiaries, affiliates or successors arising out of or related to the performance of the services hereunder by Cardinal, regardless of whether such claim is based upon any of the above stated reasons or otherwise. Results relate only to the samples identified above. This report shall not be reproduced except in full with written approval of Cardinal Laboratories.

Celey D. Keene, Lab Director/Quality Manager



PHONE (575) 393-2326 ° 101 E. MARLAND ° HOBBS, NM 88240

Analytical Results For:

BBC International, Inc.
P.O. Box 805
Hobbs NM, 88241

Project: WDDU - 102
Project Number: 3-24-19
Project Manager: Cliff Brunson
Fax To: (575) 397-0397

Reported:
01-May-19 11:27

SP 3 @ 1
H901449-14 (Soil)

Analyte	Result	MDL	Reporting Limit	Units	Dilution	Batch	Analyst	Analyzed	Method	Notes
---------	--------	-----	-----------------	-------	----------	-------	---------	----------	--------	-------

Cardinal Laboratories**Inorganic Compounds**

Chloride	864		16.0	mg/kg	4	9042613	AC	26-Apr-19	4500-Cl-B	
-----------------	------------	--	------	-------	---	---------	----	-----------	-----------	--

Volatile Organic Compounds by EPA Method 8021

Benzene*	<0.050	0.050	mg/kg	50	9042410	ms	24-Apr-19	8021B	
Toluene*	<0.050	0.050	mg/kg	50	9042410	ms	24-Apr-19	8021B	
Ethylbenzene*	<0.050	0.050	mg/kg	50	9042410	ms	24-Apr-19	8021B	
Total Xylenes*	<0.150	0.150	mg/kg	50	9042410	ms	24-Apr-19	8021B	
Total BTEX	<0.300	0.300	mg/kg	50	9042410	ms	24-Apr-19	8021B	

Surrogate: 4-Bromofluorobenzene (PID)		97.2 %		73.3-129	9042410	ms	24-Apr-19	8021B	
---------------------------------------	--	--------	--	----------	---------	----	-----------	-------	--

Petroleum Hydrocarbons by GC FID

GRO C6-C10*	<10.0	10.0	mg/kg	1	9042409	MS	25-Apr-19	8015B	
DRO >C10-C28*	<10.0	10.0	mg/kg	1	9042409	MS	25-Apr-19	8015B	
EXT DRO >C28-C36	<10.0	10.0	mg/kg	1	9042409	MS	25-Apr-19	8015B	

Surrogate: 1-Chlorooctane		112 %		41-142	9042409	MS	25-Apr-19	8015B	
---------------------------	--	-------	--	--------	---------	----	-----------	-------	--

Surrogate: 1-Chlorooctadecane		110 %		37.6-147	9042409	MS	25-Apr-19	8015B	
-------------------------------	--	-------	--	----------	---------	----	-----------	-------	--

Cardinal Laboratories

*=Accredited Analyte

PLEASE NOTE: Liability and Damages. Cardinal's liability and client's exclusive remedy for any claim arising, whether based in contract or tort, shall be limited to the amount paid by client for analyses. All claims, including those for negligence or any other cause whatsoever shall be deemed waived unless made in writing and received by Cardinal within thirty (30) days after completion of the applicable service. In no event shall Cardinal be liable for incidental or consequential damage including, without limitation, business interruptions, loss of use, or loss of profits incurred by client, its subsidiaries, affiliates or successors arising out of or related to the performance of the services hereunder by Cardinal, regardless of whether such claim is based upon any of the above stated reasons or otherwise. Results relate only to the samples identified above. This report shall not be reproduced except in full with written approval of Cardinal Laboratories.

Celey D. Keene, Lab Director/Quality Manager



PHONE (575) 393-2326 ° 101 E. MARLAND ° HOBBS, NM 88240

Analytical Results For:

BBC International, Inc.
P.O. Box 805
Hobbs NM, 88241

Project: WDDU - 102
Project Number: 3-24-19
Project Manager: Cliff Brunson
Fax To: (575) 397-0397

Reported:
01-May-19 11:27

SP 3 @ 1.5
H901449-15 (Soil)

Analyte	Result	MDL	Reporting Limit	Units	Dilution	Batch	Analyst	Analyzed	Method	Notes
---------	--------	-----	-----------------	-------	----------	-------	---------	----------	--------	-------

Cardinal Laboratories**Inorganic Compounds**

Chloride	384		16.0	mg/kg	4	9042613	AC	26-Apr-19	4500-Cl-B	
-----------------	------------	--	------	-------	---	---------	----	-----------	-----------	--

Cardinal Laboratories

*=Accredited Analyte

PLEASE NOTE: Liability and Damages. Cardinal's liability and client's exclusive remedy for any claim arising, whether based in contract or tort, shall be limited to the amount paid by client for analyses. All claims, including those for negligence or any other cause whatsoever shall be deemed waived unless made in writing and received by Cardinal within thirty (30) days after completion of the applicable service. In no event shall Cardinal be liable for incidental or consequential damage including, without limitation, business interruptions, loss of use, or loss of profits incurred by client, its subsidiaries, affiliates or successors arising out of or related to the performance of the services hereunder by Cardinal, regardless of whether such claim is based upon any of the above stated reasons or otherwise. Results relate only to the samples identified above. This report shall not be reproduced except in full with written approval of Cardinal Laboratories.

Celey D. Keene, Lab Director/Quality Manager



PHONE (575) 393-2326 ° 101 E. MARLAND ° HOBBS, NM 88240

Analytical Results For:

BBC International, Inc.
P.O. Box 805
Hobbs NM, 88241

Project: WDDU - 102
Project Number: 3-24-19
Project Manager: Cliff Brunson
Fax To: (575) 397-0397

Reported:
01-May-19 11:27

SP 3 @ 2
H901449-16 (Soil)

Analyte	Result	MDL	Reporting Limit	Units	Dilution	Batch	Analyst	Analyzed	Method	Notes
---------	--------	-----	-----------------	-------	----------	-------	---------	----------	--------	-------

Cardinal Laboratories**Inorganic Compounds**

Analyte	Result	MDL	Reporting Limit	Units	Dilution	Batch	Analyst	Analyzed	Method	Notes
Chloride	448		16.0	mg/kg	4	9042613	AC	26-Apr-19	4500-Cl-B	

Cardinal Laboratories

*=Accredited Analyte

PLEASE NOTE: Liability and Damages. Cardinal's liability and client's exclusive remedy for any claim arising, whether based in contract or tort, shall be limited to the amount paid by client for analyses. All claims, including those for negligence or any other cause whatsoever shall be deemed waived unless made in writing and received by Cardinal within thirty (30) days after completion of the applicable service. In no event shall Cardinal be liable for incidental or consequential damage including, without limitation, business interruptions, loss of use, or loss of profits incurred by client, its subsidiaries, affiliates or successors arising out of or related to the performance of the services hereunder by Cardinal, regardless of whether such claim is based upon any of the above stated reasons or otherwise. Results relate only to the samples identified above. This report shall not be reproduced except in full with written approval of Cardinal Laboratories.

Celey D. Keene, Lab Director/Quality Manager



PHONE (575) 393-2326 ° 101 E. MARLAND ° HOBBS, NM 88240

Analytical Results For:

BBC International, Inc.
P.O. Box 805
Hobbs NM, 88241

Project: WDDU - 102
Project Number: 3-24-19
Project Manager: Cliff Brunson
Fax To: (575) 397-0397

Reported:
01-May-19 11:27

SP 4 @ SURFACE
H901449-17 (Soil)

Analyte	Result	MDL	Reporting Limit	Units	Dilution	Batch	Analyst	Analyzed	Method	Notes
---------	--------	-----	-----------------	-------	----------	-------	---------	----------	--------	-------

Cardinal Laboratories**Inorganic Compounds**

Chloride	3680		16.0	mg/kg	4	9042613	AC	26-Apr-19	4500-Cl-B
-----------------	-------------	--	------	-------	---	---------	----	-----------	-----------

Volatile Organic Compounds by EPA Method 8021

Benzene*	<0.050	0.050	mg/kg	50	9042410	ms	24-Apr-19	8021B
Toluene*	<0.050	0.050	mg/kg	50	9042410	ms	24-Apr-19	8021B
Ethylbenzene*	<0.050	0.050	mg/kg	50	9042410	ms	24-Apr-19	8021B
Total Xylenes*	<0.150	0.150	mg/kg	50	9042410	ms	24-Apr-19	8021B
Total BTEX	<0.300	0.300	mg/kg	50	9042410	ms	24-Apr-19	8021B

Surrogate: 4-Bromofluorobenzene (PID)		95.7 %		73.3-129	9042410	ms	24-Apr-19	8021B
---------------------------------------	--	--------	--	----------	---------	----	-----------	-------

Petroleum Hydrocarbons by GC FID

GRO C6-C10*	<10.0	10.0	mg/kg	1	9042409	MS	25-Apr-19	8015B
DRO >C10-C28*	<10.0	10.0	mg/kg	1	9042409	MS	25-Apr-19	8015B
EXT DRO >C28-C36	<10.0	10.0	mg/kg	1	9042409	MS	25-Apr-19	8015B

Surrogate: 1-Chlorooctane		93.1 %		41-142	9042409	MS	25-Apr-19	8015B
---------------------------	--	--------	--	--------	---------	----	-----------	-------

Surrogate: 1-Chlorooctadecane		89.6 %		37.6-147	9042409	MS	25-Apr-19	8015B
-------------------------------	--	--------	--	----------	---------	----	-----------	-------

Cardinal Laboratories

*=Accredited Analyte

PLEASE NOTE: Liability and Damages. Cardinal's liability and client's exclusive remedy for any claim arising, whether based in contract or tort, shall be limited to the amount paid by client for analyses. All claims, including those for negligence or any other cause whatsoever shall be deemed waived unless made in writing and received by Cardinal within thirty (30) days after completion of the applicable service. In no event shall Cardinal be liable for incidental or consequential damage including, without limitation, business interruptions, loss of use, or loss of profits incurred by client, its subsidiaries, affiliates or successors arising out of or related to the performance of the services hereunder by Cardinal, regardless of whether such claim is based upon any of the above stated reasons or otherwise. Results relate only to the samples identified above. This report shall not be reproduced except in full with written approval of Cardinal Laboratories.

Celey D. Keene, Lab Director/Quality Manager



PHONE (575) 393-2326 ° 101 E. MARLAND ° HOBBS, NM 88240

Analytical Results For:

BBC International, Inc.
P.O. Box 805
Hobbs NM, 88241

Project: WDDU - 102
Project Number: 3-24-19
Project Manager: Cliff Brunson
Fax To: (575) 397-0397

Reported:
01-May-19 11:27

SP 4 @ 1
H901449-18 (Soil)

Analyte	Result	MDL	Reporting Limit	Units	Dilution	Batch	Analyst	Analyzed	Method	Notes
---------	--------	-----	-----------------	-------	----------	-------	---------	----------	--------	-------

Cardinal Laboratories**Inorganic Compounds**

Chloride	288		16.0	mg/kg	4	9042613	AC	26-Apr-19	4500-Cl-B	
-----------------	------------	--	------	-------	---	---------	----	-----------	-----------	--

Volatile Organic Compounds by EPA Method 8021

Benzene*	<0.050	0.050	mg/kg	50	9042410	ms	24-Apr-19	8021B	
Toluene*	<0.050	0.050	mg/kg	50	9042410	ms	24-Apr-19	8021B	
Ethylbenzene*	<0.050	0.050	mg/kg	50	9042410	ms	24-Apr-19	8021B	
Total Xylenes*	<0.150	0.150	mg/kg	50	9042410	ms	24-Apr-19	8021B	
Total BTEX	<0.300	0.300	mg/kg	50	9042410	ms	24-Apr-19	8021B	

Surrogate: 4-Bromofluorobenzene (PID)		97.2 %		73.3-129	9042410	ms	24-Apr-19	8021B	
---------------------------------------	--	--------	--	----------	---------	----	-----------	-------	--

Petroleum Hydrocarbons by GC FID

GRO C6-C10*	<10.0	10.0	mg/kg	1	9042409	MS	25-Apr-19	8015B	
DRO >C10-C28*	<10.0	10.0	mg/kg	1	9042409	MS	25-Apr-19	8015B	
EXT DRO >C28-C36	<10.0	10.0	mg/kg	1	9042409	MS	25-Apr-19	8015B	

Surrogate: 1-Chlorooctane		95.5 %		41-142	9042409	MS	25-Apr-19	8015B	
---------------------------	--	--------	--	--------	---------	----	-----------	-------	--

Surrogate: 1-Chlorooctadecane		92.9 %		37.6-147	9042409	MS	25-Apr-19	8015B	
-------------------------------	--	--------	--	----------	---------	----	-----------	-------	--

Cardinal Laboratories

*=Accredited Analyte

PLEASE NOTE: Liability and Damages. Cardinal's liability and client's exclusive remedy for any claim arising, whether based in contract or tort, shall be limited to the amount paid by client for analyses. All claims, including those for negligence or any other cause whatsoever shall be deemed waived unless made in writing and received by Cardinal within thirty (30) days after completion of the applicable service. In no event shall Cardinal be liable for incidental or consequential damage including, without limitation, business interruptions, loss of use, or loss of profits incurred by client, its subsidiaries, affiliates or successors arising out of or related to the performance of the services hereunder by Cardinal, regardless of whether such claim is based upon any of the above stated reasons or otherwise. Results relate only to the samples identified above. This report shall not be reproduced except in full with written approval of Cardinal Laboratories.

Celey D. Keene, Lab Director/Quality Manager



PHONE (575) 393-2326 ° 101 E. MARLAND ° HOBBS, NM 88240

Analytical Results For:

BBC International, Inc.
P.O. Box 805
Hobbs NM, 88241

Project: WDDU - 102
Project Number: 3-24-19
Project Manager: Cliff Brunson
Fax To: (575) 397-0397

Reported:
01-May-19 11:27

SP 4 @ 1.5
H901449-19 (Soil)

Analyte	Result	MDL	Reporting Limit	Units	Dilution	Batch	Analyst	Analyzed	Method	Notes
---------	--------	-----	-----------------	-------	----------	-------	---------	----------	--------	-------

Cardinal Laboratories**Inorganic Compounds**

Chloride	288		16.0	mg/kg	4	9042613	AC	26-Apr-19	4500-Cl-B	
-----------------	------------	--	------	-------	---	---------	----	-----------	-----------	--

Cardinal Laboratories

*=Accredited Analyte

PLEASE NOTE: Liability and Damages. Cardinal's liability and client's exclusive remedy for any claim arising, whether based in contract or tort, shall be limited to the amount paid by client for analyses. All claims, including those for negligence or any other cause whatsoever shall be deemed waived unless made in writing and received by Cardinal within thirty (30) days after completion of the applicable service. In no event shall Cardinal be liable for incidental or consequential damage including, without limitation, business interruptions, loss of use, or loss of profits incurred by client, its subsidiaries, affiliates or successors arising out of or related to the performance of the services hereunder by Cardinal, regardless of whether such claim is based upon any of the above stated reasons or otherwise. Results relate only to the samples identified above. This report shall not be reproduced except in full with written approval of Cardinal Laboratories.

Celey D. Keene, Lab Director/Quality Manager



PHONE (575) 393-2326 ° 101 E. MARLAND ° HOBBS, NM 88240

Analytical Results For:

BBC International, Inc.
P.O. Box 805
Hobbs NM, 88241

Project: WDDU - 102
Project Number: 3-24-19
Project Manager: Cliff Brunson
Fax To: (575) 397-0397

Reported:
01-May-19 11:27

SP 5 @ SURFACE
H901449-20 (Soil)

Analyte	Result	MDL	Reporting Limit	Units	Dilution	Batch	Analyst	Analyzed	Method	Notes
---------	--------	-----	-----------------	-------	----------	-------	---------	----------	--------	-------

Cardinal Laboratories**Inorganic Compounds**

Chloride	3120		16.0	mg/kg	4	9042613	AC	26-Apr-19	4500-Cl-B	
-----------------	-------------	--	------	-------	---	---------	----	-----------	-----------	--

Volatile Organic Compounds by EPA Method 8021

Benzene*	<0.050	0.050	mg/kg	50	9042410	ms	24-Apr-19	8021B	
Toluene*	<0.050	0.050	mg/kg	50	9042410	ms	24-Apr-19	8021B	
Ethylbenzene*	<0.050	0.050	mg/kg	50	9042410	ms	24-Apr-19	8021B	
Total Xylenes*	<0.150	0.150	mg/kg	50	9042410	ms	24-Apr-19	8021B	
Total BTEX	<0.300	0.300	mg/kg	50	9042410	ms	24-Apr-19	8021B	

Surrogate: 4-Bromofluorobenzene (PID)		96.4 %		73.3-129	9042410	ms	24-Apr-19	8021B	
---------------------------------------	--	--------	--	----------	---------	----	-----------	-------	--

Petroleum Hydrocarbons by GC FID

GRO C6-C10*	<10.0	10.0	mg/kg	1	9042409	MS	25-Apr-19	8015B	
DRO >C10-C28*	<10.0	10.0	mg/kg	1	9042409	MS	25-Apr-19	8015B	
EXT DRO >C28-C36	<10.0	10.0	mg/kg	1	9042409	MS	25-Apr-19	8015B	

Surrogate: 1-Chlorooctane		85.1 %		41-142	9042409	MS	25-Apr-19	8015B	
---------------------------	--	--------	--	--------	---------	----	-----------	-------	--

Surrogate: 1-Chlorooctadecane		85.1 %		37.6-147	9042409	MS	25-Apr-19	8015B	
-------------------------------	--	--------	--	----------	---------	----	-----------	-------	--

Cardinal Laboratories

*=Accredited Analyte

PLEASE NOTE: Liability and Damages. Cardinal's liability and client's exclusive remedy for any claim arising, whether based in contract or tort, shall be limited to the amount paid by client for analyses. All claims, including those for negligence or any other cause whatsoever shall be deemed waived unless made in writing and received by Cardinal within thirty (30) days after completion of the applicable service. In no event shall Cardinal be liable for incidental or consequential damage including, without limitation, business interruptions, loss of use, or loss of profits incurred by client, its subsidiaries, affiliates or successors arising out of or related to the performance of the services hereunder by Cardinal, regardless of whether such claim is based upon any of the above stated reasons or otherwise. Results relate only to the samples identified above. This report shall not be reproduced except in full with written approval of Cardinal Laboratories.

Celey D. Keene, Lab Director/Quality Manager



PHONE (575) 393-2326 ° 101 E. MARLAND ° HOBBS, NM 88240

Analytical Results For:

BBC International, Inc.
P.O. Box 805
Hobbs NM, 88241

Project: WDDU - 102
Project Number: 3-24-19
Project Manager: Cliff Brunson
Fax To: (575) 397-0397

Reported:
01-May-19 11:27

SP 5 @ 1
H901449-21 (Soil)

Analyte	Result	MDL	Reporting Limit	Units	Dilution	Batch	Analyst	Analyzed	Method	Notes
---------	--------	-----	-----------------	-------	----------	-------	---------	----------	--------	-------

Cardinal Laboratories**Inorganic Compounds**

Chloride	640		16.0	mg/kg	4	9042613	AC	26-Apr-19	4500-Cl-B	
-----------------	------------	--	------	-------	---	---------	----	-----------	-----------	--

Volatile Organic Compounds by EPA Method 8021

Benzene*	<0.050	0.050	mg/kg	50	9042410	ms	25-Apr-19	8021B	
Toluene*	<0.050	0.050	mg/kg	50	9042410	ms	25-Apr-19	8021B	
Ethylbenzene*	<0.050	0.050	mg/kg	50	9042410	ms	25-Apr-19	8021B	
Total Xylenes*	<0.150	0.150	mg/kg	50	9042410	ms	25-Apr-19	8021B	
Total BTEX	<0.300	0.300	mg/kg	50	9042410	ms	25-Apr-19	8021B	

Surrogate: 4-Bromofluorobenzene (PID)		96.0 %		73.3-129	9042410	ms	25-Apr-19	8021B	
---------------------------------------	--	--------	--	----------	---------	----	-----------	-------	--

Petroleum Hydrocarbons by GC FID

GRO C6-C10*	<10.0	10.0	mg/kg	1	9042409	MS	25-Apr-19	8015B	
DRO >C10-C28*	<10.0	10.0	mg/kg	1	9042409	MS	25-Apr-19	8015B	
EXT DRO >C28-C36	<10.0	10.0	mg/kg	1	9042409	MS	25-Apr-19	8015B	

Surrogate: 1-Chlorooctane		111 %		41-142	9042409	MS	25-Apr-19	8015B	
---------------------------	--	-------	--	--------	---------	----	-----------	-------	--

Surrogate: 1-Chlorooctadecane		106 %		37.6-147	9042409	MS	25-Apr-19	8015B	
-------------------------------	--	-------	--	----------	---------	----	-----------	-------	--

Cardinal Laboratories

*=Accredited Analyte

PLEASE NOTE: Liability and Damages. Cardinal's liability and client's exclusive remedy for any claim arising, whether based in contract or tort, shall be limited to the amount paid by client for analyses. All claims, including those for negligence or any other cause whatsoever shall be deemed waived unless made in writing and received by Cardinal within thirty (30) days after completion of the applicable service. In no event shall Cardinal be liable for incidental or consequential damage including, without limitation, business interruptions, loss of use, or loss of profits incurred by client, its subsidiaries, affiliates or successors arising out of or related to the performance of the services hereunder by Cardinal, regardless of whether such claim is based upon any of the above stated reasons or otherwise. Results relate only to the samples identified above. This report shall not be reproduced except in full with written approval of Cardinal Laboratories.

Celey D. Keene, Lab Director/Quality Manager



PHONE (575) 393-2326 ° 101 E. MARLAND ° HOBBS, NM 88240

Analytical Results For:

BBC International, Inc.
P.O. Box 805
Hobbs NM, 88241

Project: WDDU - 102
Project Number: 3-24-19
Project Manager: Cliff Brunson
Fax To: (575) 397-0397

Reported:
01-May-19 11:27

SP 5 @ 1.5
H901449-22 (Soil)

Analyte	Result	MDL	Reporting Limit	Units	Dilution	Batch	Analyst	Analyzed	Method	Notes
---------	--------	-----	--------------------	-------	----------	-------	---------	----------	--------	-------

Cardinal Laboratories**Inorganic Compounds**

Analyte	Result	MDL	Reporting Limit	Units	Dilution	Batch	Analyst	Analyzed	Method	Notes
Chloride	352		16.0	mg/kg	4	9042613	AC	26-Apr-19	4500-Cl-B	

Cardinal Laboratories

*=Accredited Analyte

PLEASE NOTE: Liability and Damages. Cardinal's liability and client's exclusive remedy for any claim arising, whether based in contract or tort, shall be limited to the amount paid by client for analyses. All claims, including those for negligence or any other cause whatsoever shall be deemed waived unless made in writing and received by Cardinal within thirty (30) days after completion of the applicable service. In no event shall Cardinal be liable for incidental or consequential damage including, without limitation, business interruptions, loss of use, or loss of profits incurred by client, its subsidiaries, affiliates or successors arising out of or related to the performance of the services hereunder by Cardinal, regardless of whether such claim is based upon any of the above stated reasons or otherwise. Results relate only to the samples identified above. This report shall not be reproduced except in full with written approval of Cardinal Laboratories.

Celey D. Keene, Lab Director/Quality Manager



PHONE (575) 393-2326 ° 101 E. MARLAND ° HOBBS, NM 88240

Analytical Results For:

BBC International, Inc.
P.O. Box 805
Hobbs NM, 88241

Project: WDDU - 102
Project Number: 3-24-19
Project Manager: Cliff Brunson
Fax To: (575) 397-0397

Reported:
01-May-19 11:27

SP 5 @ 2
H901449-23 (Soil)

Analyte	Result	MDL	Reporting Limit	Units	Dilution	Batch	Analyst	Analyzed	Method	Notes
---------	--------	-----	-----------------	-------	----------	-------	---------	----------	--------	-------

Cardinal Laboratories**Inorganic Compounds**

Chloride	544		16.0	mg/kg	4	9042613	AC	26-Apr-19	4500-Cl-B	
-----------------	------------	--	------	-------	---	---------	----	-----------	-----------	--

Cardinal Laboratories

*=Accredited Analyte

PLEASE NOTE: Liability and Damages. Cardinal's liability and client's exclusive remedy for any claim arising, whether based in contract or tort, shall be limited to the amount paid by client for analyses. All claims, including those for negligence or any other cause whatsoever shall be deemed waived unless made in writing and received by Cardinal within thirty (30) days after completion of the applicable service. In no event shall Cardinal be liable for incidental or consequential damage including, without limitation, business interruptions, loss of use, or loss of profits incurred by client, its subsidiaries, affiliates or successors arising out of or related to the performance of the services hereunder by Cardinal, regardless of whether such claim is based upon any of the above stated reasons or otherwise. Results relate only to the samples identified above. This report shall not be reproduced except in full with written approval of Cardinal Laboratories.

Celey D. Keene, Lab Director/Quality Manager



PHONE (575) 393-2326 ° 101 E. MARLAND ° HOBBS, NM 88240

Analytical Results For:

BBC International, Inc.
P.O. Box 805
Hobbs NM, 88241

Project: WDDU - 102
Project Number: 3-24-19
Project Manager: Cliff Brunson
Fax To: (575) 397-0397

Reported:
01-May-19 11:27

SP 6 @ SURFACE
H901449-24 (Soil)

Analyte	Result	MDL	Reporting Limit	Units	Dilution	Batch	Analyst	Analyzed	Method	Notes
---------	--------	-----	-----------------	-------	----------	-------	---------	----------	--------	-------

Cardinal Laboratories**Inorganic Compounds**

Chloride	3080		16.0	mg/kg	4	9042613	AC	26-Apr-19	4500-Cl-B	
-----------------	-------------	--	------	-------	---	---------	----	-----------	-----------	--

Volatile Organic Compounds by EPA Method 8021

Benzene*	<0.050	0.050	mg/kg	50	9042410	ms	25-Apr-19	8021B	
Toluene*	<0.050	0.050	mg/kg	50	9042410	ms	25-Apr-19	8021B	
Ethylbenzene*	<0.050	0.050	mg/kg	50	9042410	ms	25-Apr-19	8021B	
Total Xylenes*	<0.150	0.150	mg/kg	50	9042410	ms	25-Apr-19	8021B	
Total BTEX	<0.300	0.300	mg/kg	50	9042410	ms	25-Apr-19	8021B	

Surrogate: 4-Bromofluorobenzene (PID)		98.0 %		73.3-129	9042410	ms	25-Apr-19	8021B	
---------------------------------------	--	--------	--	----------	---------	----	-----------	-------	--

Petroleum Hydrocarbons by GC FID

GRO C6-C10*	<10.0	10.0	mg/kg	1	9042409	MS	25-Apr-19	8015B	
DRO >C10-C28*	<10.0	10.0	mg/kg	1	9042409	MS	25-Apr-19	8015B	
EXT DRO >C28-C36	<10.0	10.0	mg/kg	1	9042409	MS	25-Apr-19	8015B	

Surrogate: 1-Chlorooctane		97.0 %		41-142	9042409	MS	25-Apr-19	8015B	
---------------------------	--	--------	--	--------	---------	----	-----------	-------	--

Surrogate: 1-Chlorooctadecane		94.1 %		37.6-147	9042409	MS	25-Apr-19	8015B	
-------------------------------	--	--------	--	----------	---------	----	-----------	-------	--

Cardinal Laboratories

*=Accredited Analyte

PLEASE NOTE: Liability and Damages. Cardinal's liability and client's exclusive remedy for any claim arising, whether based in contract or tort, shall be limited to the amount paid by client for analyses. All claims, including those for negligence or any other cause whatsoever shall be deemed waived unless made in writing and received by Cardinal within thirty (30) days after completion of the applicable service. In no event shall Cardinal be liable for incidental or consequential damage including, without limitation, business interruptions, loss of use, or loss of profits incurred by client, its subsidiaries, affiliates or successors arising out of or related to the performance of the services hereunder by Cardinal, regardless of whether such claim is based upon any of the above stated reasons or otherwise. Results relate only to the samples identified above. This report shall not be reproduced except in full with written approval of Cardinal Laboratories.

Celey D. Keene, Lab Director/Quality Manager



PHONE (575) 393-2326 ° 101 E. MARLAND ° HOBBS, NM 88240

Analytical Results For:

BBC International, Inc.
P.O. Box 805
Hobbs NM, 88241

Project: WDDU - 102
Project Number: 3-24-19
Project Manager: Cliff Brunson
Fax To: (575) 397-0397

Reported:
01-May-19 11:27

SP 6 @ 1
H901449-25 (Soil)

Analyte	Result	MDL	Reporting Limit	Units	Dilution	Batch	Analyst	Analyzed	Method	Notes
---------	--------	-----	-----------------	-------	----------	-------	---------	----------	--------	-------

Cardinal Laboratories**Inorganic Compounds**

Chloride	608		16.0	mg/kg	4	9042613	AC	26-Apr-19	4500-Cl-B	
-----------------	------------	--	------	-------	---	---------	----	-----------	-----------	--

Volatile Organic Compounds by EPA Method 8021

Benzene*	<0.050	0.050	mg/kg	50	9042410	ms	25-Apr-19	8021B	
Toluene*	<0.050	0.050	mg/kg	50	9042410	ms	25-Apr-19	8021B	
Ethylbenzene*	<0.050	0.050	mg/kg	50	9042410	ms	25-Apr-19	8021B	
Total Xylenes*	<0.150	0.150	mg/kg	50	9042410	ms	25-Apr-19	8021B	
Total BTEX	<0.300	0.300	mg/kg	50	9042410	ms	25-Apr-19	8021B	

Surrogate: 4-Bromofluorobenzene (PID)		96.7 %		73.3-129	9042410	ms	25-Apr-19	8021B	
---------------------------------------	--	--------	--	----------	---------	----	-----------	-------	--

Petroleum Hydrocarbons by GC FID

GRO C6-C10*	<10.0	10.0	mg/kg	1	9042409	MS	25-Apr-19	8015B	
DRO >C10-C28*	<10.0	10.0	mg/kg	1	9042409	MS	25-Apr-19	8015B	
EXT DRO >C28-C36	<10.0	10.0	mg/kg	1	9042409	MS	25-Apr-19	8015B	

Surrogate: 1-Chlorooctane		105 %		41-142	9042409	MS	25-Apr-19	8015B	
---------------------------	--	-------	--	--------	---------	----	-----------	-------	--

Surrogate: 1-Chlorooctadecane		109 %		37.6-147	9042409	MS	25-Apr-19	8015B	
-------------------------------	--	-------	--	----------	---------	----	-----------	-------	--

Cardinal Laboratories

*=Accredited Analyte

PLEASE NOTE: Liability and Damages. Cardinal's liability and client's exclusive remedy for any claim arising, whether based in contract or tort, shall be limited to the amount paid by client for analyses. All claims, including those for negligence or any other cause whatsoever shall be deemed waived unless made in writing and received by Cardinal within thirty (30) days after completion of the applicable service. In no event shall Cardinal be liable for incidental or consequential damage including, without limitation, business interruptions, loss of use, or loss of profits incurred by client, its subsidiaries, affiliates or successors arising out of or related to the performance of the services hereunder by Cardinal, regardless of whether such claim is based upon any of the above stated reasons or otherwise. Results relate only to the samples identified above. This report shall not be reproduced except in full with written approval of Cardinal Laboratories.

Celey D. Keene, Lab Director/Quality Manager



PHONE (575) 393-2326 ° 101 E. MARLAND ° HOBBS, NM 88240

Analytical Results For:

BBC International, Inc.
P.O. Box 805
Hobbs NM, 88241

Project: WDDU - 102
Project Number: 3-24-19
Project Manager: Cliff Brunson
Fax To: (575) 397-0397

Reported:
01-May-19 11:27

SP 6 @ 1.5
H901449-26 (Soil)

Analyte	Result	MDL	Reporting Limit	Units	Dilution	Batch	Analyst	Analyzed	Method	Notes
---------	--------	-----	--------------------	-------	----------	-------	---------	----------	--------	-------

Cardinal Laboratories**Inorganic Compounds**

Chloride	688		16.0	mg/kg	4	9042613	AC	26-Apr-19	4500-Cl-B	
-----------------	------------	--	------	-------	---	---------	----	-----------	-----------	--

Cardinal Laboratories

*=Accredited Analyte

PLEASE NOTE: Liability and Damages. Cardinal's liability and client's exclusive remedy for any claim arising, whether based in contract or tort, shall be limited to the amount paid by client for analyses. All claims, including those for negligence or any other cause whatsoever shall be deemed waived unless made in writing and received by Cardinal within thirty (30) days after completion of the applicable service. In no event shall Cardinal be liable for incidental or consequential damage including, without limitation, business interruptions, loss of use, or loss of profits incurred by client, its subsidiaries, affiliates or successors arising out of or related to the performance of the services hereunder by Cardinal, regardless of whether such claim is based upon any of the above stated reasons or otherwise. Results relate only to the samples identified above. This report shall not be reproduced except in full with written approval of Cardinal Laboratories.

Celey D. Keene, Lab Director/Quality Manager



PHONE (575) 393-2326 ° 101 E. MARLAND ° HOBBS, NM 88240

Analytical Results For:

BBC International, Inc.
P.O. Box 805
Hobbs NM, 88241

Project: WDDU - 102
Project Number: 3-24-19
Project Manager: Cliff Brunson
Fax To: (575) 397-0397

Reported:
01-May-19 11:27

SP 6 @ 2
H901449-27 (Soil)

Analyte	Result	MDL	Reporting Limit	Units	Dilution	Batch	Analyst	Analyzed	Method	Notes
---------	--------	-----	-----------------	-------	----------	-------	---------	----------	--------	-------

Cardinal Laboratories**Inorganic Compounds**

Chloride	640		16.0	mg/kg	4	9042504	AC	26-Apr-19	4500-Cl-B	
-----------------	------------	--	------	-------	---	---------	----	-----------	-----------	--

Cardinal Laboratories

*=Accredited Analyte

PLEASE NOTE: Liability and Damages. Cardinal's liability and client's exclusive remedy for any claim arising, whether based in contract or tort, shall be limited to the amount paid by client for analyses. All claims, including those for negligence or any other cause whatsoever shall be deemed waived unless made in writing and received by Cardinal within thirty (30) days after completion of the applicable service. In no event shall Cardinal be liable for incidental or consequential damage including, without limitation, business interruptions, loss of use, or loss of profits incurred by client, its subsidiaries, affiliates or successors arising out of or related to the performance of the services hereunder by Cardinal, regardless of whether such claim is based upon any of the above stated reasons or otherwise. Results relate only to the samples identified above. This report shall not be reproduced except in full with written approval of Cardinal Laboratories.

Celey D. Keene, Lab Director/Quality Manager



PHONE (575) 393-2326 ° 101 E. MARLAND ° HOBBS, NM 88240

Analytical Results For:

BBC International, Inc.
P.O. Box 805
Hobbs NM, 88241

Project: WDDU - 102
Project Number: 3-24-19
Project Manager: Cliff Brunson
Fax To: (575) 397-0397

Reported:
01-May-19 11:27

SP 6 @ 2.5
H901449-28 (Soil)

Analyte	Result	MDL	Reporting Limit	Units	Dilution	Batch	Analyst	Analyzed	Method	Notes
---------	--------	-----	--------------------	-------	----------	-------	---------	----------	--------	-------

Cardinal Laboratories**Inorganic Compounds**

Chloride	688		16.0	mg/kg	4	9042504	AC	26-Apr-19	4500-Cl-B	
-----------------	------------	--	------	-------	---	---------	----	-----------	-----------	--

Cardinal Laboratories

*=Accredited Analyte

PLEASE NOTE: Liability and Damages. Cardinal's liability and client's exclusive remedy for any claim arising, whether based in contract or tort, shall be limited to the amount paid by client for analyses. All claims, including those for negligence or any other cause whatsoever shall be deemed waived unless made in writing and received by Cardinal within thirty (30) days after completion of the applicable service. In no event shall Cardinal be liable for incidental or consequential damage including, without limitation, business interruptions, loss of use, or loss of profits incurred by client, its subsidiaries, affiliates or successors arising out of or related to the performance of the services hereunder by Cardinal, regardless of whether such claim is based upon any of the above stated reasons or otherwise. Results relate only to the samples identified above. This report shall not be reproduced except in full with written approval of Cardinal Laboratories.

Celey D. Keene, Lab Director/Quality Manager



PHONE (575) 393-2326 ° 101 E. MARLAND ° HOBBS, NM 88240

Analytical Results For:

BBC International, Inc.
P.O. Box 805
Hobbs NM, 88241

Project: WDDU - 102
Project Number: 3-24-19
Project Manager: Cliff Brunson
Fax To: (575) 397-0397

Reported:
01-May-19 11:27

SP 7 @ SURFACE
H901449-29 (Soil)

Analyte	Result	MDL	Reporting Limit	Units	Dilution	Batch	Analyst	Analyzed	Method	Notes
---------	--------	-----	-----------------	-------	----------	-------	---------	----------	--------	-------

Cardinal Laboratories**Inorganic Compounds**

Chloride	2320		16.0	mg/kg	4	9042504	AC	26-Apr-19	4500-Cl-B	
-----------------	-------------	--	------	-------	---	---------	----	-----------	-----------	--

Volatile Organic Compounds by EPA Method 8021

Benzene*	<0.050	0.050	mg/kg	50	9042410	ms	25-Apr-19	8021B	
Toluene*	<0.050	0.050	mg/kg	50	9042410	ms	25-Apr-19	8021B	
Ethylbenzene*	<0.050	0.050	mg/kg	50	9042410	ms	25-Apr-19	8021B	
Total Xylenes*	<0.150	0.150	mg/kg	50	9042410	ms	25-Apr-19	8021B	
Total BTEX	<0.300	0.300	mg/kg	50	9042410	ms	25-Apr-19	8021B	

<i>Surrogate: 4-Bromofluorobenzene (PID)</i>		97.3 %		73.3-129	9042410	ms	25-Apr-19	8021B	
--	--	--------	--	----------	---------	----	-----------	-------	--

Petroleum Hydrocarbons by GC FID

GRO C6-C10*	<10.0	10.0	mg/kg	1	9042503	MS	25-Apr-19	8015B	
DRO >C10-C28*	<10.0	10.0	mg/kg	1	9042503	MS	25-Apr-19	8015B	
EXT DRO >C28-C36	<10.0	10.0	mg/kg	1	9042503	MS	25-Apr-19	8015B	

<i>Surrogate: 1-Chlorooctane</i>		85.2 %		41-142	9042503	MS	25-Apr-19	8015B	
----------------------------------	--	--------	--	--------	---------	----	-----------	-------	--

<i>Surrogate: 1-Chlorooctadecane</i>		91.4 %		37.6-147	9042503	MS	25-Apr-19	8015B	
--------------------------------------	--	--------	--	----------	---------	----	-----------	-------	--

Cardinal Laboratories

*=Accredited Analyte

PLEASE NOTE: Liability and Damages. Cardinal's liability and client's exclusive remedy for any claim arising, whether based in contract or tort, shall be limited to the amount paid by client for analyses. All claims, including those for negligence or any other cause whatsoever shall be deemed waived unless made in writing and received by Cardinal within thirty (30) days after completion of the applicable service. In no event shall Cardinal be liable for incidental or consequential damage including, without limitation, business interruptions, loss of use, or loss of profits incurred by client, its subsidiaries, affiliates or successors arising out of or related to the performance of the services hereunder by Cardinal, regardless of whether such claim is based upon any of the above stated reasons or otherwise. Results relate only to the samples identified above. This report shall not be reproduced except in full with written approval of Cardinal Laboratories.

Celey D. Keene, Lab Director/Quality Manager



PHONE (575) 393-2326 ° 101 E. MARLAND ° HOBBS, NM 88240

Analytical Results For:

BBC International, Inc.
P.O. Box 805
Hobbs NM, 88241

Project: WDDU - 102
Project Number: 3-24-19
Project Manager: Cliff Brunson
Fax To: (575) 397-0397

Reported:
01-May-19 11:27

SP 7 @ 1
H901449-30 (Soil)

Analyte	Result	MDL	Reporting Limit	Units	Dilution	Batch	Analyst	Analyzed	Method	Notes
---------	--------	-----	-----------------	-------	----------	-------	---------	----------	--------	-------

Cardinal Laboratories**Inorganic Compounds**

Chloride	752		16.0	mg/kg	4	9042504	AC	26-Apr-19	4500-Cl-B	
-----------------	------------	--	------	-------	---	---------	----	-----------	-----------	--

Volatile Organic Compounds by EPA Method 8021

Benzene*	<0.050	0.050	mg/kg	50	9043019	ms	01-May-19	8021B	
Toluene*	<0.050	0.050	mg/kg	50	9043019	ms	01-May-19	8021B	
Ethylbenzene*	<0.050	0.050	mg/kg	50	9043019	ms	01-May-19	8021B	
Total Xylenes*	<0.150	0.150	mg/kg	50	9043019	ms	01-May-19	8021B	
Total BTEX	<0.300	0.300	mg/kg	50	9043019	ms	01-May-19	8021B	

Surrogate: 4-Bromofluorobenzene (PID)		94.3 %		73.3-129	9043019	ms	01-May-19	8021B	
---------------------------------------	--	--------	--	----------	---------	----	-----------	-------	--

Petroleum Hydrocarbons by GC FID

GRO C6-C10*	<10.0	10.0	mg/kg	1	9043010	MS	01-May-19	8015B	
DRO >C10-C28*	<10.0	10.0	mg/kg	1	9043010	MS	01-May-19	8015B	
EXT DRO >C28-C36	<10.0	10.0	mg/kg	1	9043010	MS	01-May-19	8015B	

Surrogate: 1-Chlorooctane		104 %		41-142	9043010	MS	01-May-19	8015B	
---------------------------	--	-------	--	--------	---------	----	-----------	-------	--

Surrogate: 1-Chlorooctadecane		116 %		37.6-147	9043010	MS	01-May-19	8015B	
-------------------------------	--	-------	--	----------	---------	----	-----------	-------	--

Cardinal Laboratories

*=Accredited Analyte

PLEASE NOTE: Liability and Damages. Cardinal's liability and client's exclusive remedy for any claim arising, whether based in contract or tort, shall be limited to the amount paid by client for analyses. All claims, including those for negligence or any other cause whatsoever shall be deemed waived unless made in writing and received by Cardinal within thirty (30) days after completion of the applicable service. In no event shall Cardinal be liable for incidental or consequential damage including, without limitation, business interruptions, loss of use, or loss of profits incurred by client, its subsidiaries, affiliates or successors arising out of or related to the performance of the services hereunder by Cardinal, regardless of whether such claim is based upon any of the above stated reasons or otherwise. Results relate only to the samples identified above. This report shall not be reproduced except in full with written approval of Cardinal Laboratories.

Celey D. Keene, Lab Director/Quality Manager



PHONE (575) 393-2326 ° 101 E. MARLAND ° HOBBS, NM 88240

Analytical Results For:

BBC International, Inc.
P.O. Box 805
Hobbs NM, 88241

Project: WDDU - 102
Project Number: 3-24-19
Project Manager: Cliff Brunson
Fax To: (575) 397-0397

Reported:
01-May-19 11:27

SP 7 @ 1.5
H901449-31 (Soil)

Analyte	Result	MDL	Reporting Limit	Units	Dilution	Batch	Analyst	Analyzed	Method	Notes
---------	--------	-----	--------------------	-------	----------	-------	---------	----------	--------	-------

Cardinal Laboratories**Inorganic Compounds**

Chloride	400		16.0	mg/kg	4	9042504	AC	26-Apr-19	4500-Cl-B	
-----------------	------------	--	------	-------	---	---------	----	-----------	-----------	--

Cardinal Laboratories

*=Accredited Analyte

PLEASE NOTE: Liability and Damages. Cardinal's liability and client's exclusive remedy for any claim arising, whether based in contract or tort, shall be limited to the amount paid by client for analyses. All claims, including those for negligence or any other cause whatsoever shall be deemed waived unless made in writing and received by Cardinal within thirty (30) days after completion of the applicable service. In no event shall Cardinal be liable for incidental or consequential damage including, without limitation, business interruptions, loss of use, or loss of profits incurred by client, its subsidiaries, affiliates or successors arising out of or related to the performance of the services hereunder by Cardinal, regardless of whether such claim is based upon any of the above stated reasons or otherwise. Results relate only to the samples identified above. This report shall not be reproduced except in full with written approval of Cardinal Laboratories.

Celey D. Keene, Lab Director/Quality Manager



PHONE (575) 393-2326 ° 101 E. MARLAND ° HOBBS, NM 88240

Analytical Results For:

BBC International, Inc.
P.O. Box 805
Hobbs NM, 88241

Project: WDDU - 102
Project Number: 3-24-19
Project Manager: Cliff Brunson
Fax To: (575) 397-0397

Reported:
01-May-19 11:27

SP 7 @ 2
H901449-32 (Soil)

Analyte	Result	MDL	Reporting Limit	Units	Dilution	Batch	Analyst	Analyzed	Method	Notes
---------	--------	-----	--------------------	-------	----------	-------	---------	----------	--------	-------

Cardinal Laboratories**Inorganic Compounds**

Chloride	304		16.0	mg/kg	4	9042504	AC	26-Apr-19	4500-Cl-B	
-----------------	------------	--	------	-------	---	---------	----	-----------	-----------	--

Cardinal Laboratories

*=Accredited Analyte

PLEASE NOTE: Liability and Damages. Cardinal's liability and client's exclusive remedy for any claim arising, whether based in contract or tort, shall be limited to the amount paid by client for analyses. All claims, including those for negligence or any other cause whatsoever shall be deemed waived unless made in writing and received by Cardinal within thirty (30) days after completion of the applicable service. In no event shall Cardinal be liable for incidental or consequential damage including, without limitation, business interruptions, loss of use, or loss of profits incurred by client, its subsidiaries, affiliates or successors arising out of or related to the performance of the services hereunder by Cardinal, regardless of whether such claim is based upon any of the above stated reasons or otherwise. Results relate only to the samples identified above. This report shall not be reproduced except in full with written approval of Cardinal Laboratories.

Celey D. Keene, Lab Director/Quality Manager



PHONE (575) 393-2326 ° 101 E. MARLAND ° HOBBS, NM 88240

Analytical Results For:

BBC International, Inc.
P.O. Box 805
Hobbs NM, 88241

Project: WDDU - 102
Project Number: 3-24-19
Project Manager: Cliff Brunson
Fax To: (575) 397-0397

Reported:
01-May-19 11:27

SP 8 @ SURFACE
H901449-33 (Soil)

Analyte	Result	MDL	Reporting Limit	Units	Dilution	Batch	Analyst	Analyzed	Method	Notes
---------	--------	-----	-----------------	-------	----------	-------	---------	----------	--------	-------

Cardinal Laboratories**Inorganic Compounds**

Chloride	464		16.0	mg/kg	4	9042504	AC	26-Apr-19	4500-Cl-B	
-----------------	------------	--	------	-------	---	---------	----	-----------	-----------	--

Volatile Organic Compounds by EPA Method 8021

Benzene*	<0.050	0.050	mg/kg	50	9042410	ms	25-Apr-19	8021B	
Toluene*	<0.050	0.050	mg/kg	50	9042410	ms	25-Apr-19	8021B	
Ethylbenzene*	<0.050	0.050	mg/kg	50	9042410	ms	25-Apr-19	8021B	
Total Xylenes*	<0.150	0.150	mg/kg	50	9042410	ms	25-Apr-19	8021B	
Total BTEX	<0.300	0.300	mg/kg	50	9042410	ms	25-Apr-19	8021B	

Surrogate: 4-Bromofluorobenzene (PID)		96.5 %		73.3-129	9042410	ms	25-Apr-19	8021B	
---------------------------------------	--	--------	--	----------	---------	----	-----------	-------	--

Petroleum Hydrocarbons by GC FID

GRO C6-C10*	<10.0	10.0	mg/kg	1	9042503	MS	25-Apr-19	8015B	
DRO >C10-C28*	<10.0	10.0	mg/kg	1	9042503	MS	25-Apr-19	8015B	
EXT DRO >C28-C36	<10.0	10.0	mg/kg	1	9042503	MS	25-Apr-19	8015B	

Surrogate: 1-Chlorooctane		92.1 %		41-142	9042503	MS	25-Apr-19	8015B	
---------------------------	--	--------	--	--------	---------	----	-----------	-------	--

Surrogate: 1-Chlorooctadecane		98.9 %		37.6-147	9042503	MS	25-Apr-19	8015B	
-------------------------------	--	--------	--	----------	---------	----	-----------	-------	--

Cardinal Laboratories

*=Accredited Analyte

PLEASE NOTE: Liability and Damages. Cardinal's liability and client's exclusive remedy for any claim arising, whether based in contract or tort, shall be limited to the amount paid by client for analyses. All claims, including those for negligence or any other cause whatsoever shall be deemed waived unless made in writing and received by Cardinal within thirty (30) days after completion of the applicable service. In no event shall Cardinal be liable for incidental or consequential damage including, without limitation, business interruptions, loss of use, or loss of profits incurred by client, its subsidiaries, affiliates or successors arising out of or related to the performance of the services hereunder by Cardinal, regardless of whether such claim is based upon any of the above stated reasons or otherwise. Results relate only to the samples identified above. This report shall not be reproduced except in full with written approval of Cardinal Laboratories.

Celey D. Keene, Lab Director/Quality Manager



PHONE (575) 393-2326 ° 101 E. MARLAND ° HOBBS, NM 88240

Analytical Results For:

BBC International, Inc.
P.O. Box 805
Hobbs NM, 88241

Project: WDDU - 102
Project Number: 3-24-19
Project Manager: Cliff Brunson
Fax To: (575) 397-0397

Reported:
01-May-19 11:27

SP 8 @ 1
H901449-34 (Soil)

Analyte	Result	MDL	Reporting Limit	Units	Dilution	Batch	Analyst	Analyzed	Method	Notes
---------	--------	-----	-----------------	-------	----------	-------	---------	----------	--------	-------

Cardinal Laboratories**Inorganic Compounds**

Chloride	800		16.0	mg/kg	4	9042504	AC	26-Apr-19	4500-Cl-B	
-----------------	------------	--	------	-------	---	---------	----	-----------	-----------	--

Volatile Organic Compounds by EPA Method 8021

Benzene*	<0.050	0.050	mg/kg	50	9042410	ms	25-Apr-19	8021B	
Toluene*	<0.050	0.050	mg/kg	50	9042410	ms	25-Apr-19	8021B	
Ethylbenzene*	<0.050	0.050	mg/kg	50	9042410	ms	25-Apr-19	8021B	
Total Xylenes*	<0.150	0.150	mg/kg	50	9042410	ms	25-Apr-19	8021B	
Total BTEX	<0.300	0.300	mg/kg	50	9042410	ms	25-Apr-19	8021B	

Surrogate: 4-Bromofluorobenzene (PID)		97.2 %		73.3-129	9042410	ms	25-Apr-19	8021B	
---------------------------------------	--	--------	--	----------	---------	----	-----------	-------	--

Petroleum Hydrocarbons by GC FID

GRO C6-C10*	<10.0	10.0	mg/kg	1	9042503	MS	25-Apr-19	8015B	
DRO >C10-C28*	<10.0	10.0	mg/kg	1	9042503	MS	25-Apr-19	8015B	
EXT DRO >C28-C36	<10.0	10.0	mg/kg	1	9042503	MS	25-Apr-19	8015B	

Surrogate: 1-Chlorooctane		74.4 %		41-142	9042503	MS	25-Apr-19	8015B	
---------------------------	--	--------	--	--------	---------	----	-----------	-------	--

Surrogate: 1-Chlorooctadecane		85.3 %		37.6-147	9042503	MS	25-Apr-19	8015B	
-------------------------------	--	--------	--	----------	---------	----	-----------	-------	--

Cardinal Laboratories

*=Accredited Analyte

PLEASE NOTE: Liability and Damages. Cardinal's liability and client's exclusive remedy for any claim arising, whether based in contract or tort, shall be limited to the amount paid by client for analyses. All claims, including those for negligence or any other cause whatsoever shall be deemed waived unless made in writing and received by Cardinal within thirty (30) days after completion of the applicable service. In no event shall Cardinal be liable for incidental or consequential damage including, without limitation, business interruptions, loss of use, or loss of profits incurred by client, its subsidiaries, affiliates or successors arising out of or related to the performance of the services hereunder by Cardinal, regardless of whether such claim is based upon any of the above stated reasons or otherwise. Results relate only to the samples identified above. This report shall not be reproduced except in full with written approval of Cardinal Laboratories.

Celey D. Keene, Lab Director/Quality Manager



PHONE (575) 393-2326 ° 101 E. MARLAND ° HOBBS, NM 88240

Analytical Results For:

BBC International, Inc.
P.O. Box 805
Hobbs NM, 88241

Project: WDDU - 102
Project Number: 3-24-19
Project Manager: Cliff Brunson
Fax To: (575) 397-0397

Reported:
01-May-19 11:27

SP 8 @ 1.5
H901449-35 (Soil)

Analyte	Result	MDL	Reporting Limit	Units	Dilution	Batch	Analyst	Analyzed	Method	Notes
---------	--------	-----	-----------------	-------	----------	-------	---------	----------	--------	-------

Cardinal Laboratories**Inorganic Compounds**

Chloride	368		16.0	mg/kg	4	9042504	AC	26-Apr-19	4500-Cl-B	
-----------------	------------	--	------	-------	---	---------	----	-----------	-----------	--

Cardinal Laboratories

*=Accredited Analyte

PLEASE NOTE: Liability and Damages. Cardinal's liability and client's exclusive remedy for any claim arising, whether based in contract or tort, shall be limited to the amount paid by client for analyses. All claims, including those for negligence or any other cause whatsoever shall be deemed waived unless made in writing and received by Cardinal within thirty (30) days after completion of the applicable service. In no event shall Cardinal be liable for incidental or consequential damage including, without limitation, business interruptions, loss of use, or loss of profits incurred by client, its subsidiaries, affiliates or successors arising out of or related to the performance of the services hereunder by Cardinal, regardless of whether such claim is based upon any of the above stated reasons or otherwise. Results relate only to the samples identified above. This report shall not be reproduced except in full with written approval of Cardinal Laboratories.

Celey D. Keene, Lab Director/Quality Manager



PHONE (575) 393-2326 ° 101 E. MARLAND ° HOBBS, NM 88240

Analytical Results For:

BBC International, Inc.
P.O. Box 805
Hobbs NM, 88241

Project: WDDU - 102
Project Number: 3-24-19
Project Manager: Cliff Brunson
Fax To: (575) 397-0397

Reported:
01-May-19 11:27

SP 8 @ 2
H901449-36 (Soil)

Analyte	Result	MDL	Reporting Limit	Units	Dilution	Batch	Analyst	Analyzed	Method	Notes
---------	--------	-----	-----------------	-------	----------	-------	---------	----------	--------	-------

Cardinal Laboratories**Inorganic Compounds**

Chloride	240		16.0	mg/kg	4	9042504	AC	26-Apr-19	4500-Cl-B	
-----------------	------------	--	------	-------	---	---------	----	-----------	-----------	--

Cardinal Laboratories

*=Accredited Analyte

PLEASE NOTE: Liability and Damages. Cardinal's liability and client's exclusive remedy for any claim arising, whether based in contract or tort, shall be limited to the amount paid by client for analyses. All claims, including those for negligence or any other cause whatsoever shall be deemed waived unless made in writing and received by Cardinal within thirty (30) days after completion of the applicable service. In no event shall Cardinal be liable for incidental or consequential damage including, without limitation, business interruptions, loss of use, or loss of profits incurred by client, its subsidiaries, affiliates or successors arising out of or related to the performance of the services hereunder by Cardinal, regardless of whether such claim is based upon any of the above stated reasons or otherwise. Results relate only to the samples identified above. This report shall not be reproduced except in full with written approval of Cardinal Laboratories.

Celey D. Keene, Lab Director/Quality Manager



PHONE (575) 393-2326 ° 101 E. MARLAND ° HOBBS, NM 88240

Analytical Results For:

BBC International, Inc.
P.O. Box 805
Hobbs NM, 88241

Project: WDDU - 102
Project Number: 3-24-19
Project Manager: Cliff Brunson
Fax To: (575) 397-0397

Reported:
01-May-19 11:27

Inorganic Compounds - Quality Control**Cardinal Laboratories**

Analyte	Result	Reporting Limit	Units	Spike Level	Source Result	%REC	%REC Limits	RPD	RPD Limit	Notes
---------	--------	-----------------	-------	-------------	---------------	------	-------------	-----	-----------	-------

Batch 9042504 - General Prep - Wet Chem**Blank (9042504-BLK1)**

Prepared & Analyzed: 25-Apr-19

Chloride	ND	16.0	mg/kg
----------	----	------	-------

LCS (9042504-BS1)

Prepared & Analyzed: 25-Apr-19

Chloride	400	16.0	mg/kg	400	100	80-120
----------	-----	------	-------	-----	-----	--------

LCS Dup (9042504-BSD1)

Prepared & Analyzed: 25-Apr-19

Chloride	400	16.0	mg/kg	400	100	80-120	0.00	20
----------	-----	------	-------	-----	-----	--------	------	----

Batch 9042612 - General Prep - Wet Chem**Blank (9042612-BLK1)**

Prepared & Analyzed: 26-Apr-19

Chloride	ND	16.0	mg/kg
----------	----	------	-------

LCS (9042612-BS1)

Prepared & Analyzed: 26-Apr-19

Chloride	432	16.0	mg/kg	400	108	80-120
----------	-----	------	-------	-----	-----	--------

LCS Dup (9042612-BSD1)

Prepared & Analyzed: 26-Apr-19

Chloride	416	16.0	mg/kg	400	104	80-120	3.77	20
----------	-----	------	-------	-----	-----	--------	------	----

Batch 9042613 - General Prep - Wet Chem**Blank (9042613-BLK1)**

Prepared & Analyzed: 26-Apr-19

Chloride	ND	16.0	mg/kg
----------	----	------	-------

LCS (9042613-BS1)

Prepared & Analyzed: 26-Apr-19

Chloride	400	16.0	mg/kg	400	100	80-120
----------	-----	------	-------	-----	-----	--------

Cardinal Laboratories

*=Accredited Analyte

PLEASE NOTE: Liability and Damages. Cardinal's liability and client's exclusive remedy for any claim arising, whether based in contract or tort, shall be limited to the amount paid by client for analyses. All claims, including those for negligence or any other cause whatsoever shall be deemed waived unless made in writing and received by Cardinal within thirty (30) days after completion of the applicable service. In no event shall Cardinal be liable for incidental or consequential damage including, without limitation, business interruptions, loss of use, or loss of profits incurred by client, its subsidiaries, affiliates or successors arising out of or related to the performance of the services hereunder by Cardinal, regardless of whether such claim is based upon any of the above stated reasons or otherwise. Results relate only to the samples identified above. This report shall not be reproduced except in full with written approval of Cardinal Laboratories.

Celey D. Keene, Lab Director/Quality Manager



PHONE (575) 393-2326 ° 101 E. MARLAND ° HOBBS, NM 88240

Analytical Results For:

BBC International, Inc.
P.O. Box 805
Hobbs NM, 88241

Project: WDDU - 102
Project Number: 3-24-19
Project Manager: Cliff Brunson
Fax To: (575) 397-0397

Reported:
01-May-19 11:27

Inorganic Compounds - Quality Control**Cardinal Laboratories**

Analyte	Result	Reporting Limit	Units	Spike Level	Source Result	%REC	%REC Limits	RPD	RPD Limit	Notes
---------	--------	--------------------	-------	----------------	------------------	------	----------------	-----	--------------	-------

Batch 9042613 - General Prep - Wet Chem**LCS Dup (9042613-BS1)**

Prepared & Analyzed: 26-Apr-19

Chloride	400	16.0	mg/kg	400		100	80-120	0.00	20	
----------	-----	------	-------	-----	--	-----	--------	------	----	--

Cardinal Laboratories

*=Accredited Analyte

PLEASE NOTE: Liability and Damages. Cardinal's liability and client's exclusive remedy for any claim arising, whether based in contract or tort, shall be limited to the amount paid by client for analyses. All claims, including those for negligence or any other cause whatsoever shall be deemed waived unless made in writing and received by Cardinal within thirty (30) days after completion of the applicable service. In no event shall Cardinal be liable for incidental or consequential damage including, without limitation, business interruptions, loss of use, or loss of profits incurred by client, its subsidiaries, affiliates or successors arising out of or related to the performance of the services hereunder by Cardinal, regardless of whether such claim is based upon any of the above stated reasons or otherwise. Results relate only to the samples identified above. This report shall not be reproduced except in full with written approval of Cardinal Laboratories.

Celey D. Keene, Lab Director/Quality Manager



PHONE (575) 393-2326 • 101 E. MARLAND • HOBBS, NM 88240

Analytical Results For:

BBC International, Inc.
P.O. Box 805
Hobbs NM, 88241

Project: WDDU - 102
Project Number: 3-24-19
Project Manager: Cliff Brunson
Fax To: (575) 397-0397

Reported:
01-May-19 11:27

Volatile Organic Compounds by EPA Method 8021 - Quality Control**Cardinal Laboratories**

Analyte	Result	Reporting Limit	Units	Spike Level	Source Result	%REC	%REC Limits	RPD	RPD Limit	Notes
---------	--------	-----------------	-------	-------------	---------------	------	-------------	-----	-----------	-------

Batch 9042404 - Volatiles**Blank (9042404-BLK1)**

Prepared & Analyzed: 24-Apr-19

Benzene	ND	0.050	mg/kg							
Toluene	ND	0.050	mg/kg							
Ethylbenzene	ND	0.050	mg/kg							
Total Xylenes	ND	0.150	mg/kg							
Total BTEX	ND	0.300	mg/kg							

Surrogate: 4-Bromofluorobenzene (PID) 0.0970 mg/kg 0.100 97.0 73.3-129

LCS (9042404-BS1)

Prepared & Analyzed: 24-Apr-19

Benzene	1.88	0.050	mg/kg	2.00		94.2	72.2-131			
Toluene	2.03	0.050	mg/kg	2.00		101	71.7-126			
Ethylbenzene	1.96	0.050	mg/kg	2.00		98.1	68.9-126			
Total Xylenes	6.03	0.150	mg/kg	6.00		101	71.4-125			

Surrogate: 4-Bromofluorobenzene (PID) 0.0961 mg/kg 0.100 96.1 73.3-129

LCS Dup (9042404-BSD1)

Prepared & Analyzed: 24-Apr-19

Benzene	1.84	0.050	mg/kg	2.00		91.8	72.2-131	2.67	6.91	
Toluene	1.94	0.050	mg/kg	2.00		97.2	71.7-126	4.11	7.12	
Ethylbenzene	1.88	0.050	mg/kg	2.00		94.1	68.9-126	4.11	7.88	
Total Xylenes	5.84	0.150	mg/kg	6.00		97.4	71.4-125	3.16	7.46	

Surrogate: 4-Bromofluorobenzene (PID) 0.0929 mg/kg 0.100 92.9 73.3-129

Batch 9042410 - Volatiles**Blank (9042410-BLK1)**

Prepared & Analyzed: 24-Apr-19

Benzene	ND	0.050	mg/kg							
Toluene	ND	0.050	mg/kg							
Ethylbenzene	ND	0.050	mg/kg							
Total Xylenes	ND	0.150	mg/kg							
Total BTEX	ND	0.300	mg/kg							

Surrogate: 4-Bromofluorobenzene (PID) 0.0947 mg/kg 0.100 94.7 73.3-129

Cardinal Laboratories

*=Accredited Analyte

PLEASE NOTE: Liability and Damages. Cardinal's liability and client's exclusive remedy for any claim arising, whether based in contract or tort, shall be limited to the amount paid by client for analyses. All claims, including those for negligence or any other cause whatsoever shall be deemed waived unless made in writing and received by Cardinal within thirty (30) days after completion of the applicable service. In no event shall Cardinal be liable for incidental or consequential damage including, without limitation, business interruptions, loss of use, or loss of profits incurred by client, its subsidiaries, affiliates or successors arising out of or related to the performance of the services hereunder by Cardinal, regardless of whether such claim is based upon any of the above stated reasons or otherwise. Results relate only to the samples identified above. This report shall not be reproduced except in full with written approval of Cardinal Laboratories.

Celey D. Keene, Lab Director/Quality Manager



PHONE (575) 393-2326 ° 101 E. MARLAND ° HOBBS, NM 88240

Analytical Results For:

BBC International, Inc.
P.O. Box 805
Hobbs NM, 88241

Project: WDDU - 102
Project Number: 3-24-19
Project Manager: Cliff Brunson
Fax To: (575) 397-0397

Reported:
01-May-19 11:27

Volatile Organic Compounds by EPA Method 8021 - Quality Control**Cardinal Laboratories**

Analyte	Result	Reporting Limit	Units	Spike Level	Source Result	%REC	%REC Limits	RPD	RPD Limit	Notes
---------	--------	-----------------	-------	-------------	---------------	------	-------------	-----	-----------	-------

Batch 9042410 - Volatiles**LCS (9042410-BS1)**

Prepared & Analyzed: 24-Apr-19

Benzene	1.87	0.050	mg/kg	2.00		93.7	72.2-131			
Toluene	2.02	0.050	mg/kg	2.00		101	71.7-126			
Ethylbenzene	1.95	0.050	mg/kg	2.00		97.4	68.9-126			
Total Xylenes	5.87	0.150	mg/kg	6.00		97.9	71.4-125			
Surrogate: 4-Bromofluorobenzene (PID)	0.0950		mg/kg	0.100		95.0	73.3-129			

LCS Dup (9042410-BSD1)

Prepared & Analyzed: 24-Apr-19

Benzene	1.83	0.050	mg/kg	2.00		91.5	72.2-131	2.30	6.91	
Toluene	1.97	0.050	mg/kg	2.00		98.4	71.7-126	2.70	7.12	
Ethylbenzene	1.90	0.050	mg/kg	2.00		94.8	68.9-126	2.64	7.88	
Total Xylenes	5.78	0.150	mg/kg	6.00		96.3	71.4-125	1.63	7.46	
Surrogate: 4-Bromofluorobenzene (PID)	0.0946		mg/kg	0.100		94.6	73.3-129			

Batch 9043019 - Volatiles**Blank (9043019-BLK1)**

Prepared & Analyzed: 30-Apr-19

Benzene	ND	0.050	mg/kg							
Toluene	ND	0.050	mg/kg							
Ethylbenzene	ND	0.050	mg/kg							
Total Xylenes	ND	0.150	mg/kg							
Total BTEX	ND	0.300	mg/kg							
Surrogate: 4-Bromofluorobenzene (PID)	0.0955		mg/kg	0.100		95.5	73.3-129			

LCS (9043019-BS1)

Prepared & Analyzed: 30-Apr-19

Benzene	1.83	0.050	mg/kg	2.00		91.5	72.2-131			
Toluene	1.95	0.050	mg/kg	2.00		97.7	71.7-126			
Ethylbenzene	1.89	0.050	mg/kg	2.00		94.5	68.9-126			
Total Xylenes	5.73	0.150	mg/kg	6.00		95.5	71.4-125			
Surrogate: 4-Bromofluorobenzene (PID)	0.0953		mg/kg	0.100		95.3	73.3-129			

Cardinal Laboratories

*=Accredited Analyte

PLEASE NOTE: Liability and Damages. Cardinal's liability and client's exclusive remedy for any claim arising, whether based in contract or tort, shall be limited to the amount paid by client for analyses. All claims, including those for negligence or any other cause whatsoever shall be deemed waived unless made in writing and received by Cardinal within thirty (30) days after completion of the applicable service. In no event shall Cardinal be liable for incidental or consequential damage including, without limitation, business interruptions, loss of use, or loss of profits incurred by client, its subsidiaries, affiliates or successors arising out of or related to the performance of the services hereunder by Cardinal, regardless of whether such claim is based upon any of the above stated reasons or otherwise. Results relate only to the samples identified above. This report shall not be reproduced except in full with written approval of Cardinal Laboratories.

Celey D. Keene, Lab Director/Quality Manager



PHONE (575) 393-2326 • 101 E. MARLAND • HOBBS, NM 88240

Analytical Results For:

BBC International, Inc.
P.O. Box 805
Hobbs NM, 88241

Project: WDDU - 102
Project Number: 3-24-19
Project Manager: Cliff Brunson
Fax To: (575) 397-0397

Reported:
01-May-19 11:27

Volatile Organic Compounds by EPA Method 8021 - Quality Control**Cardinal Laboratories**

Analyte	Result	Reporting Limit	Units	Spike Level	Source Result	%REC	%REC Limits	RPD	RPD Limit	Notes
---------	--------	--------------------	-------	----------------	------------------	------	----------------	-----	--------------	-------

Batch 9043019 - Volatiles**LCS Dup (9043019-BSD1)**

Prepared & Analyzed: 30-Apr-19

Benzene	1.87	0.050	mg/kg	2.00		93.4	72.2-131	2.15	6.91	
Toluene	1.96	0.050	mg/kg	2.00		98.1	71.7-126	0.451	7.12	
Ethylbenzene	1.93	0.050	mg/kg	2.00		96.5	68.9-126	2.06	7.88	
Total Xylenes	5.86	0.150	mg/kg	6.00		97.6	71.4-125	2.12	7.46	
Surrogate: 4-Bromofluorobenzene (PID)	0.0924		mg/kg	0.100		92.4	73.3-129			

Cardinal Laboratories

*=Accredited Analyte

PLEASE NOTE: Liability and Damages. Cardinal's liability and client's exclusive remedy for any claim arising, whether based in contract or tort, shall be limited to the amount paid by client for analyses. All claims, including those for negligence or any other cause whatsoever shall be deemed waived unless made in writing and received by Cardinal within thirty (30) days after completion of the applicable service. In no event shall Cardinal be liable for incidental or consequential damage including, without limitation, business interruptions, loss of use, or loss of profits incurred by client, its subsidiaries, affiliates or successors arising out of or related to the performance of the services hereunder by Cardinal, regardless of whether such claim is based upon any of the above stated reasons or otherwise. Results relate only to the samples identified above. This report shall not be reproduced except in full with written approval of Cardinal Laboratories.

Celey D. Keene, Lab Director/Quality Manager



PHONE (575) 393-2326 ° 101 E. MARLAND ° HOBBS, NM 88240

Analytical Results For:

BBC International, Inc.
P.O. Box 805
Hobbs NM, 88241

Project: WDDU - 102
Project Number: 3-24-19
Project Manager: Cliff Brunson
Fax To: (575) 397-0397

Reported:
01-May-19 11:27

Petroleum Hydrocarbons by GC FID - Quality Control**Cardinal Laboratories**

Analyte	Result	Reporting Limit	Units	Spike Level	Source Result	%REC	%REC Limits	RPD	RPD Limit	Notes
---------	--------	-----------------	-------	-------------	---------------	------	-------------	-----	-----------	-------

Batch 9042409 - General Prep - Organics**Blank (9042409-BLK1)**

Prepared: 24-Apr-19 Analyzed: 25-Apr-19

GRO C6-C10	ND	10.0	mg/kg							
DRO >C10-C28	ND	10.0	mg/kg							
EXT DRO >C28-C36	ND	10.0	mg/kg							
Surrogate: 1-Chlorooctane	53.6		mg/kg	50.0		107	41-142			
Surrogate: 1-Chlorooctadecane	57.6		mg/kg	50.0		115	37.6-147			

LCS (9042409-BS1)

Prepared: 24-Apr-19 Analyzed: 25-Apr-19

GRO C6-C10	191	10.0	mg/kg	200		95.6	76.5-133			
DRO >C10-C28	183	10.0	mg/kg	200		91.3	72.9-138			
Total TPH C6-C28	374	10.0	mg/kg	400		93.4	78-132			
Surrogate: 1-Chlorooctane	55.6		mg/kg	50.0		111	41-142			
Surrogate: 1-Chlorooctadecane	54.5		mg/kg	50.0		109	37.6-147			

LCS Dup (9042409-BS1)

Prepared: 24-Apr-19 Analyzed: 25-Apr-19

GRO C6-C10	218	10.0	mg/kg	200		109	76.5-133	13.0	20.6	
DRO >C10-C28	210	10.0	mg/kg	200		105	72.9-138	14.1	20.6	
Total TPH C6-C28	428	10.0	mg/kg	400		107	78-132	13.5	18	
Surrogate: 1-Chlorooctane	61.5		mg/kg	50.0		123	41-142			
Surrogate: 1-Chlorooctadecane	60.2		mg/kg	50.0		120	37.6-147			

Batch 9042503 - General Prep - Organics**Blank (9042503-BLK1)**

Prepared & Analyzed: 25-Apr-19

GRO C6-C10	ND	10.0	mg/kg							
DRO >C10-C28	ND	10.0	mg/kg							
EXT DRO >C28-C36	ND	10.0	mg/kg							
Surrogate: 1-Chlorooctane	48.2		mg/kg	50.0		96.4	41-142			
Surrogate: 1-Chlorooctadecane	53.9		mg/kg	50.0		108	37.6-147			

Cardinal Laboratories

*=Accredited Analyte

PLEASE NOTE: Liability and Damages. Cardinal's liability and client's exclusive remedy for any claim arising, whether based in contract or tort, shall be limited to the amount paid by client for analyses. All claims, including those for negligence or any other cause whatsoever shall be deemed waived unless made in writing and received by Cardinal within thirty (30) days after completion of the applicable service. In no event shall Cardinal be liable for incidental or consequential damage including, without limitation, business interruptions, loss of use, or loss of profits incurred by client, its subsidiaries, affiliates or successors arising out of or related to the performance of the services hereunder by Cardinal, regardless of whether such claim is based upon any of the above stated reasons or otherwise. Results relate only to the samples identified above. This report shall not be reproduced except in full with written approval of Cardinal Laboratories.

Celey D. Keene, Lab Director/Quality Manager



PHONE (575) 393-2326 • 101 E. MARLAND • HOBBS, NM 88240

Analytical Results For:

BBC International, Inc.
P.O. Box 805
Hobbs NM, 88241

Project: WDDU - 102
Project Number: 3-24-19
Project Manager: Cliff Brunson
Fax To: (575) 397-0397

Reported:
01-May-19 11:27

Petroleum Hydrocarbons by GC FID - Quality Control**Cardinal Laboratories**

Analyte	Result	Reporting Limit	Units	Spike Level	Source Result	%REC	%REC Limits	RPD	RPD Limit	Notes
---------	--------	-----------------	-------	-------------	---------------	------	-------------	-----	-----------	-------

Batch 9042503 - General Prep - Organics**LCS (9042503-BS1)**

Prepared & Analyzed: 25-Apr-19

GRO C6-C10	178	10.0	mg/kg	200		89.2	76.5-133			
DRO >C10-C28	182	10.0	mg/kg	200		90.8	72.9-138			
Total TPH C6-C28	360	10.0	mg/kg	400		90.0	78-132			
Surrogate: 1-Chlorooctane	50.9		mg/kg	50.0		102	41-142			
Surrogate: 1-Chlorooctadecane	53.3		mg/kg	50.0		107	37.6-147			

LCS Dup (9042503-BSD1)

Prepared & Analyzed: 25-Apr-19

GRO C6-C10	184	10.0	mg/kg	200		91.8	76.5-133	2.80	20.6	
DRO >C10-C28	188	10.0	mg/kg	200		94.2	72.9-138	3.69	20.6	
Total TPH C6-C28	372	10.0	mg/kg	400		93.0	78-132	3.25	18	
Surrogate: 1-Chlorooctane	50.8		mg/kg	50.0		102	41-142			
Surrogate: 1-Chlorooctadecane	52.9		mg/kg	50.0		106	37.6-147			

Batch 9043010 - General Prep - Organics**Blank (9043010-BLK1)**

Prepared & Analyzed: 30-Apr-19

GRO C6-C10	ND	10.0	mg/kg							
DRO >C10-C28	ND	10.0	mg/kg							
EXT DRO >C28-C36	ND	10.0	mg/kg							
Surrogate: 1-Chlorooctane	56.5		mg/kg	50.0		113	41-142			
Surrogate: 1-Chlorooctadecane	59.2		mg/kg	50.0		118	37.6-147			

LCS (9043010-BS1)

Prepared & Analyzed: 30-Apr-19

GRO C6-C10	207	10.0	mg/kg	200		104	76.5-133			
DRO >C10-C28	213	10.0	mg/kg	200		106	72.9-138			
Total TPH C6-C28	420	10.0	mg/kg	400		105	78-132			
Surrogate: 1-Chlorooctane	61.6		mg/kg	50.0		123	41-142			
Surrogate: 1-Chlorooctadecane	68.4		mg/kg	50.0		137	37.6-147			

Cardinal Laboratories

*=Accredited Analyte

PLEASE NOTE: Liability and Damages. Cardinal's liability and client's exclusive remedy for any claim arising, whether based in contract or tort, shall be limited to the amount paid by client for analyses. All claims, including those for negligence or any other cause whatsoever shall be deemed waived unless made in writing and received by Cardinal within thirty (30) days after completion of the applicable service. In no event shall Cardinal be liable for incidental or consequential damage including, without limitation, business interruptions, loss of use, or loss of profits incurred by client, its subsidiaries, affiliates or successors arising out of or related to the performance of the services hereunder by Cardinal, regardless of whether such claim is based upon any of the above stated reasons or otherwise. Results relate only to the samples identified above. This report shall not be reproduced except in full with written approval of Cardinal Laboratories.

Celey D. Keene, Lab Director/Quality Manager



PHONE (575) 393-2326 ° 101 E. MARLAND ° HOBBS, NM 88240

Analytical Results For:

BBC International, Inc.
P.O. Box 805
Hobbs NM, 88241

Project: WDDU - 102
Project Number: 3-24-19
Project Manager: Cliff Brunson
Fax To: (575) 397-0397

Reported:
01-May-19 11:27

Petroleum Hydrocarbons by GC FID - Quality Control**Cardinal Laboratories**

Analyte	Result	Reporting Limit	Units	Spike Level	Source Result	%REC	%REC Limits	RPD	RPD Limit	Notes
---------	--------	--------------------	-------	----------------	------------------	------	----------------	-----	--------------	-------

Batch 9043010 - General Prep - Organics**LCS Dup (9043010-BSD1)**

Prepared & Analyzed: 30-Apr-19

GRO C6-C10	210	10.0	mg/kg	200		105	76.5-133	1.28	20.6	
DRO >C10-C28	213	10.0	mg/kg	200		107	72.9-138	0.138	20.6	
Total TPH C6-C28	423	10.0	mg/kg	400		106	78-132	0.705	18	
Surrogate: 1-Chlorooctane	62.2		mg/kg	50.0		124	41-142			
Surrogate: 1-Chlorooctadecane	68.6		mg/kg	50.0		137	37.6-147			

Cardinal Laboratories

*=Accredited Analyte

PLEASE NOTE: Liability and Damages. Cardinal's liability and client's exclusive remedy for any claim arising, whether based in contract or tort, shall be limited to the amount paid by client for analyses. All claims, including those for negligence or any other cause whatsoever shall be deemed waived unless made in writing and received by Cardinal within thirty (30) days after completion of the applicable service. In no event shall Cardinal be liable for incidental or consequential damage including, without limitation, business interruptions, loss of use, or loss of profits incurred by client, its subsidiaries, affiliates or successors arising out of or related to the performance of the services hereunder by Cardinal, regardless of whether such claim is based upon any of the above stated reasons or otherwise. Results relate only to the samples identified above. This report shall not be reproduced except in full with written approval of Cardinal Laboratories.

Celey D. Keene, Lab Director/Quality Manager



PHONE (575) 393-2326 ° 101 E. MARLAND ° HOBBS, NM 88240

Notes and Definitions

- ND Analyte NOT DETECTED at or above the reporting limit
- RPD Relative Percent Difference
- ** Samples not received at proper temperature of 6°C or below.
- *** Insufficient time to reach temperature.
- Chloride by SM4500Cl-B does not require samples be received at or below 6°C
- Samples reported on an as received basis (wet) unless otherwise noted on report

Cardinal Laboratories

*=Accredited Analyte

PLEASE NOTE: Liability and Damages. Cardinal's liability and client's exclusive remedy for any claim arising, whether based in contract or tort, shall be limited to the amount paid by client for analyses. All claims, including those for negligence or any other cause whatsoever shall be deemed waived unless made in writing and received by Cardinal within thirty (30) days after completion of the applicable service. In no event shall Cardinal be liable for incidental or consequential damage including, without limitation, business interruptions, loss of use, or loss of profits incurred by client, its subsidiaries, affiliates or successors arising out of or related to the performance of the services hereunder by Cardinal, regardless of whether such claim is based upon any of the above stated reasons or otherwise. Results relate only to the samples identified above. This report shall not be reproduced except in full with written approval of Cardinal Laboratories.



A handwritten signature in black ink that reads "Celey D. Keene".

Celey D. Keene, Lab Director/Quality Manager

(505) 393-2326 FAX (505) 393-2476

1/4

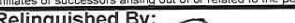
PLEASE NOTE: Liability and Damages. Cardinal's liability and client's exclusive remedy for any claim arising whether based in contract or tort, shall be limited to the amount paid by client for the applicable fee. All claims, including those for negligence and any other cause whatsoever shall be deemed waived unless made in writing and received by Cardinal within 30 days after completion of the applicable service. In no event shall Cardinal be liable for incidental or consequential damages, including without limitation, business interruptions, loss of use, or loss of profits incurred by client, its subsidiaries, affiliates or successors arising out of or related to the performance of services hereunder by Cardinal, regardless of whether such claim is based upon any of the above stated reasons or otherwise.

Relinquished By: 		Date: 7-23-19 Received By:		Phone Result: <input type="checkbox"/> Yes <input type="checkbox"/> No Add'l Phone #:			
Time:				Fax Result: <input type="checkbox"/> Yes <input type="checkbox"/> No Add'l Fax #:			
Relinquished By: 		Date: 7-23-19 Received By:		REMARKS:			
Time: 16:45							
Delivered By: (Circle One)		Sample Condition				CHECKED BY:	
Sampler - UPS - Bus - Other:		Cool Intact				(Initials)	
3.3c #97		<input checked="" type="checkbox"/> Yes <input checked="" type="checkbox"/> Yes <input type="checkbox"/> No <input type="checkbox"/> No		10.			

† Cardinal cannot accept verbal changes. Please fax written changes to 505-393-2476



(505) 393-2326 FAX (505) 393-2476

TPH-Extended
BTEX
cl-

PLEASE NOTE: Liability and Damages: Cardinal's liability and client's exclusive remedy for any claim arising whether based in contract or tort, shall be limited to the amount paid by the client for the analyses. All claims, including those for negligence and any other cause whatsoever shall be deemed waived unless made in writing and received by Cardinal within 30 days after completion of the applicable service. In no event shall Cardinal be liable for incidental or consequential damages, including without limitation, business interruptions, loss of use, or loss of profits incurred by client, its subsidiaries, affiliates or successors arising out of or related to the performance of services hereunder by Cardinal, regardless of whether such claim is based upon any of the above stated reasons or otherwise.

† Cardinal cannot accept verbal changes. Please fax written changes to 505-393-2476

Page 51 of 52

**CARDINAL LABORATORIES**

101 East Marland, Hobbs, NM 88240

(505) 393-2326 FAX (505) 393-2476

CHAIN-OF-CUSTODY AND ANALYSIS REQUEST

3/4

Company Name: BBC International, Inc.				BILL TO				ANALYSIS REQUEST											
Project Manager: Cliff Brunson				P.O. #:				<div style="display: flex; flex-direction: column; align-items: center;"> <div style="writing-mode: vertical-rl; transform: rotate(180deg);">TPH-Extended</div> <div style="writing-mode: vertical-rl; transform: rotate(180deg);">BTEX</div> <div style="writing-mode: vertical-rl; transform: rotate(180deg);">CL-</div> </div>											
Address: P.O. Box 805				Company:															
City: Hobbs State: NM Zip: 88241				Attn:															
Phone #: 575-397-6388 Fax #: 575-397-0397				Address:															
Project #: Project Owner: <i>oxy</i>				City:															
Project Name: <i>WDDU-102 - 3-29-19</i>				State: Zip:															
Project Location: <i>31</i>				Phone #:															
Sampler Name: <i>10</i>				Fax #:															
FOR LAB USE ONLY																			
Lab I.D.	Sample I.D.	(G)RAB OR (C)OMP.	# CONTAINERS	MATRIX				PRESERV.		SAMPLING									
				GROUNDWATER	WASTEWATER	SOIL	OIL	SLUDGE	OTHER :	ACID/BASE:	ICE / COOL	OTHER :	DATE	TIME					
<i>H901449</i>																			
<i>21</i>	<i>SP50 1</i>	<i>G</i>	<i>1</i>			<i>X</i>				<i>X</i>			<i>4-19</i>	<i>919</i>	<i>X</i>	<i>X</i>	<i>X</i>		
<i>22</i>	<i>1 1/2</i>	<i>G</i>	<i>1</i>			<i>X</i>				<i>X</i>				<i>941</i>			<i>X</i>		
<i>23</i>	<i>2 1/2</i>	<i>G</i>	<i>1</i>			<i>X</i>				<i>X</i>				<i>1022</i>			<i>X</i>		
<i>24</i>	<i>SP60 SUR</i>	<i>G</i>	<i>1</i>			<i>X</i>				<i>X</i>				<i>1030</i>	<i>X</i>	<i>X</i>	<i>X</i>		
<i>25</i>	<i>1</i>	<i>G</i>	<i>1</i>			<i>X</i>				<i>X</i>				<i>1650</i>	<i>X</i>	<i>X</i>	<i>X</i>		
<i>26</i>	<i>1 1/2</i>	<i>G</i>	<i>1</i>			<i>X</i>				<i>X</i>				<i>1115</i>			<i>X</i>		
<i>27</i>	<i>2</i>	<i>G</i>	<i>1</i>			<i>X</i>				<i>X</i>				<i>1133</i>			<i>X</i>		
<i>28</i>	<i>2 1/2</i>	<i>G</i>	<i>1</i>			<i>X</i>				<i>X</i>				<i>1201</i>			<i>X</i>		
<i>29</i>	<i>SP 70 SUR</i>	<i>G</i>	<i>1</i>			<i>X</i>				<i>X</i>				<i>1211</i>	<i>X</i>	<i>X</i>	<i>X</i>		
<i>30</i>	<i>1</i>	<i>G</i>	<i>1</i>			<i>X</i>				<i>X</i>				<i>111</i>	<i>X</i>	<i>X</i>	<i>X</i>		

PLEASE NOTE: Liability and Damages. Cardinal's liability and client's exclusive remedy for any claim arising whether based in contract or tort, shall be limited to the amount paid by the client for the analyses. All claims including those for negligence and any other cause whatsoever shall be deemed waived unless made in writing and received by Cardinal within 30 days after completion of the applicable service. In no event shall Cardinal be liable for incidental or consequential damages, including without limitation, business interruptions, loss of use, or loss of profits incurred by client, its subsidiaries, affiliates or successors arising out of or related to the performance of services hereunder by Cardinal, regardless of whether such claim is based upon any of the above stated reasons or otherwise.

Relinquished By: <i>[Signature]</i>	Date: <i>4-23-19</i>	Received By: <i>[Signature]</i>	Phone Result: <input type="checkbox"/> Yes <input type="checkbox"/> No	Add'l Phone #:
Relinquished By: <i>[Signature]</i>	Date: <i>4-23-19</i>	Received By: <i>[Signature]</i>	Fax Result: <input type="checkbox"/> Yes <input type="checkbox"/> No	Add'l Fax #:
Delivered By: (Circle One)	Time: <i>16:45</i>	Sample Condition	CHECKED BY: (Initials)	
Sampler - UPS - Bus - Other: <i>3.3c #97</i>		Cool Intact <input type="checkbox"/> Yes <input type="checkbox"/> No	<i>TO</i>	
REMARKS:				

† Cardinal cannot accept verbal changes. Please fax written changes to 505-393-2476



(505) 393-2326 FAX (505) 393-2476

CHAIN-OF-CUSTODY AND ANALYSIS REQUEST

PLEASE NOTE: Liability and Damages. Cardinal's liability and client's exclusive remedy for any claim arising whether based in contract or tort, shall be limited to the amount paid by the client for the analyses. All claims, including those for negligence and any other cause whatsoever shall be deemed waived unless made in writing and received by Cardinal within 30 days after completion of the applicable service. In no event shall Cardinal be liable for incidental or consequential damages, including without limitation, business interruptions, loss of use, or loss of profits incurred by client, its subsidiaries, affiliates or successors arising out of or related to the performance of services hereunder by Cardinal, regardless of whether such claim is based upon any of the above stated reasons or otherwise.

† Cardinal cannot accept verbal changes. Please fax written changes to 505-393-2476