

County HARDING

Pool DUEYEROS (00₂)

TOWNSHIP 20 North RANGE 31 East, NEW MEXICO PRINCIPAL MERIDIAN

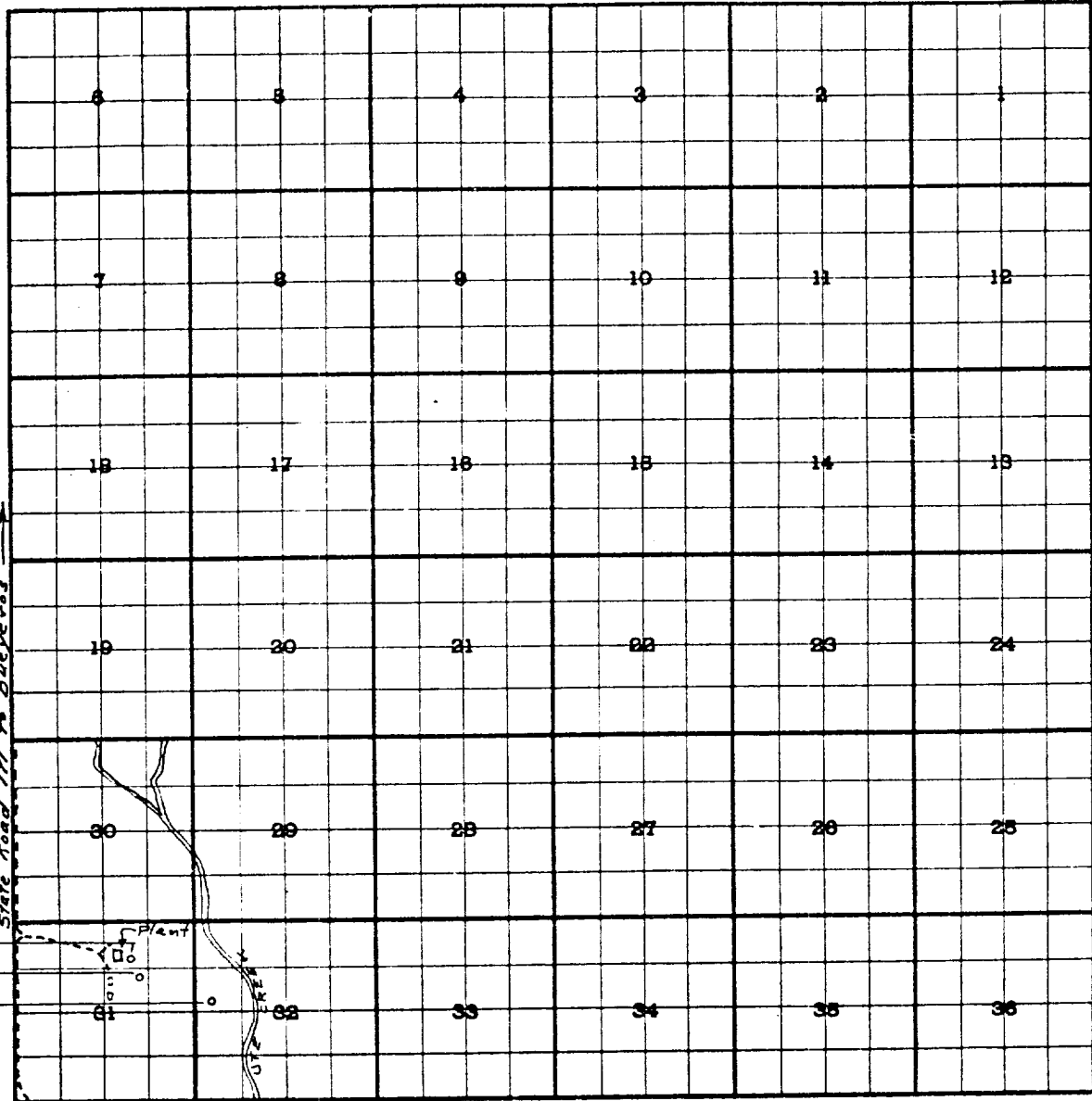

Libby #1—SW NE Sec. 31-T20N-R31E (1650' N & E lines)

Libby #2—SW NW Sec. 31-T20N-R31E

De Baca #2—NW NE Sec. 31-T20N-R31E (675' N & 336' E lines)