

NO. OF COPIES RECEIVED	
DISTRIBUTION	
SANTA FE	
FILE	
U.S.G.S.	
LAND OFFICE	
OPERATOR	

NEW MEXICO OIL CONSERVATION COMMISSION

Form C-101
Revised 12-65

APR 18
30-071-20181

3A. Indicate Type of Lease
STATE FEE
3. State Oil & Gas Lease No.
L-5889

APPLICATION FOR PERMIT TO DRILL, DEEPEN, OR PLUG BACK

a. Type of Work
b. Type of Well
DRILL DEEPEN PLUG BACK
OIL WELL GAS WELL CO2 OTHER
c. Name of Operator
Amoco Production Company
d. Address of Operator
P. O. Box 68, Hobbs, New Mexico 88240
e. Location of Well
UNIT LETTER G LOCATED 1650 FEET FROM THE North LINE
1650 FEET FROM THE East LINE OF SEC. 16 TWP. 18-N 33-E

7. Unit Agreement Name
BDCDGU
8. Form of Lease Name
BDCDGU
9. Well No.
1833 161G

10. Field and Pool, or Wildcat
Und. Tubb
12. County
Harding

19. Proposed Depth 2900'
19A. Formation Tubb
20. Rotary or C.C.
Rotary
21A. Kind & Status of Plug Bond Blanket on File
21B. Drilling Contractor N/A
22. Approx. Date Work will start
4th Quarter-1983
Elevations (Show whether in Ft. or M.)
4750'

PROPOSED CASING AND CEMENT PROGRAM

SIZE OF HOLE	SIZE OF CASING	WEIGHT PER FOOT	SETTING DEPTH	SACKS OF CEMENT	EST. TOP
12-1/4"	9-5/8"	32.30#	700'	Circ.	Surface
8-3/4"	7"	15.#-20.#	2900'	Tieback to 9-5/8"	Surface

Propose to drill and equip well in the Tubb formation. After reaching TD logs will be run and evaluated. Perforate and stimulate as necessary in attempting commercial production.

Mud Program: 0-700' Native Spud Mud
700'-TD KCL-Salt Water Gel-Starch

BOP program attached
Gas is not dedicated

APPROVAL VALID FOR 90 DAYS
PERMIT EXPIRES 1-16-84
UNLESS DRILLING UNDERWAY

- O+2-NMOCD, SF; 1-HOU R. E. Ogden Rm 21.150; 1-SUSP; 1-PJS; 1-Amerada; 1-Amerigas;
- 1-Cities Service; 1-Conoco; 1-CO2 in Action; 1-Excelsior; 1-Sun. Tex.; 1-Exxon;
- 1-Jim Russell, Clayton; 1-F. J. Nash, HOU Rm 4.206

PLEASE DESCRIBE PROPOSED PROGRAM: IF PROPOSAL IS TO DEEPEN OR PLUG BACK, GIVE DATA ON PRESENT PRODUCTIVE ZONE AND PROPOSED NEW PRODUCTION. GIVE BLOWOUT PREVENTER PROGRAM, IF ANY.

I certify that the information above is true and complete to the best of my knowledge and belief.
Carl Wilcox Title Assistant Administrative Analyst Date 10-14-83

APPROVED BY Carl Wilcox TITLE _____ DATE 10/17/83

OIL CONSERVATION COMMISSION TO BE NOTIFIED
WITHIN 24 HOURS OF BEGINNING OPERATIONS

NEW MEXICO OIL CONSERVATION COMMISSION
WELL LOCATION AND ACREAGE DEDICATION PLAT

Form C-102
Supersedes C-128
Effective 1-1-80

All distances must be from the outer boundaries of the Section.

Operator AMOCO		Lease			Well No. 1833161G
Unit Letter G	Section 16	Township T18N	Range R33E	County HARDING	
Actual Footage Location of Well: 1650 feet from the NORTH line and 1650 feet from the EAST line					
Ground Level Elev. 4750	Producing Formation Tubb	Pool Und. Tubb		Dedicated Acreage: 160 Acres	

1. Outline the acreage dedicated to the subject well by colored pencil or hachure marks on the plat below.
2. If more than one lease is dedicated to the well, outline each and identify the ownership thereof (both as to working interest and royalty).
3. If more than one lease of different ownership is dedicated to the well, have the interests of all owners been consolidated by communitization, unitization, force-pooling, etc?

Yes No If answer is "yes," type of consolidation _____

If answer is "no," list the owners and tract descriptions which have actually been consolidated. (Use reverse side of this form if necessary.) _____

No allowable will be assigned to the well until all interests have been consolidated (by communitization, unitization, forced-pooling, or otherwise) or until a non-standard unit, eliminating such interests, has been approved by the Commission.

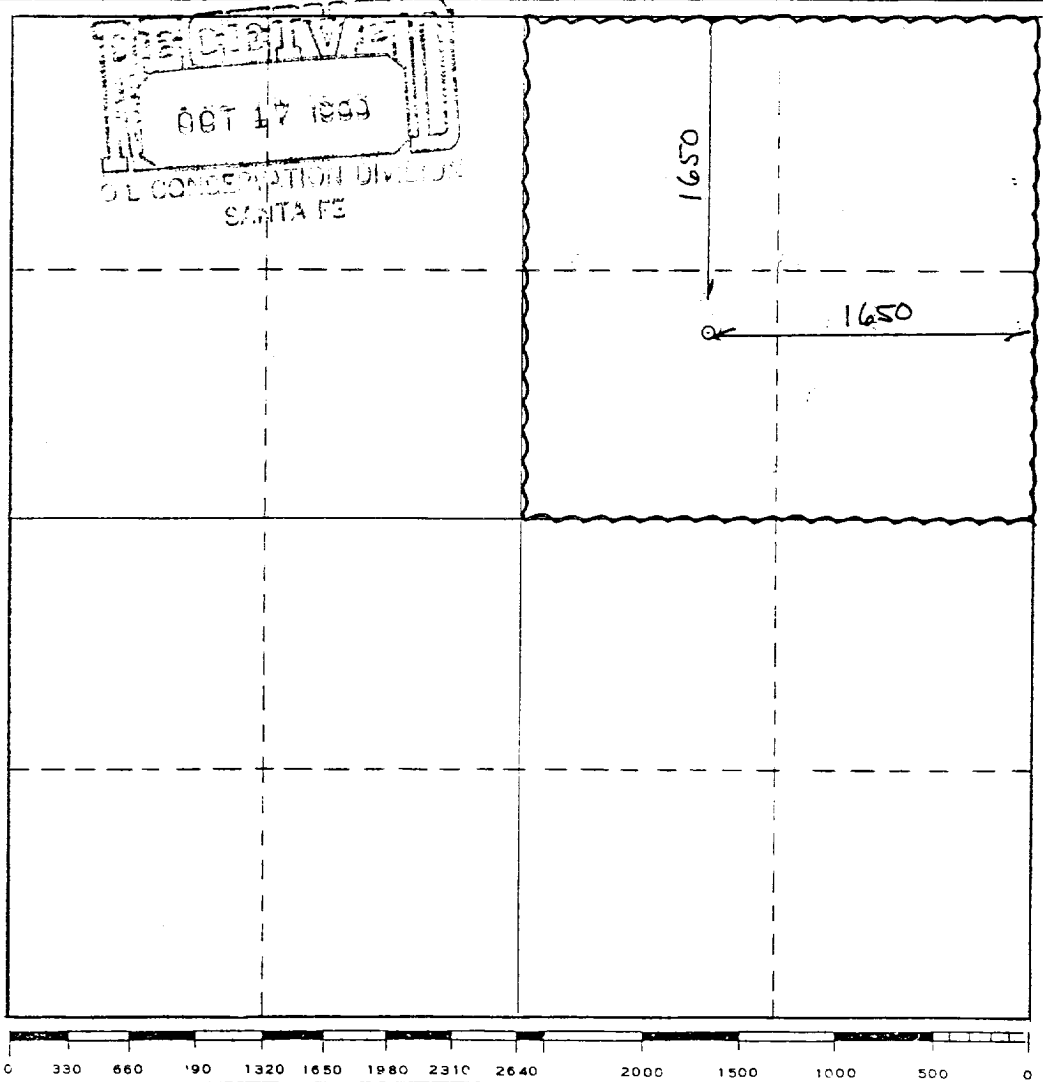

CERTIFICATION

I hereby certify that the information contained herein is true and complete to the best of my knowledge and belief.

Name
Assist. Admin. Analyst
Position
AMOCO PRODUCTION COMPANY
Company
10-14-83
Date

I hereby certify that the well location shown on this plat was plotted from field notes of actual surveys made by me or under my supervision, and that the same is true and correct to the best of my knowledge and belief.

OC
Date
Registered Professional Engineer
and/or Land Surveyor
5103
N. M. LAND SURVEYORS
NE. SHIELDS 5103
Certificate No.

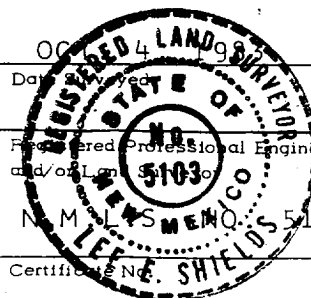

STANDARD 2000 PSI W.P. BOP STACK

1. Blow-out preventers may be manually operated.
2. All equipment must be in good condition, 2,000 psi W.P. (4,000 psi test) minimum.
3. Bell nipple above blow-out preventer shall be same size as casing being drilled through.
4. Kelly cock to be installed on kelly.
5. Full opening safety valve 2,000 psi w.p. (4,000 psi test) minimum must be available on rig floor at all times with proper connection or subs to fit any tool joint in string.
6. Spool or cross may be eliminated if connections are available in the lower part of the blow-out preventer body.
7. Double or space saver type preventers may be used in lieu of two single preventers.
8. BOP rams to be installed as follows:
 - Top preventer - Drill pipe or casing rams
 - Bottom preventer - Blind rams

*Amoco District Superintendent may reverse location of rams.
9. Extensions and hand wheels to be installed and braced at all times.
10. Manifold valves may be gate or plug metal to metal seal 2" minimum.

