

NO. OF COPIES RECEIVED	
DISTRIBUTION	
SANTA FE	
FILE	✓
U.S.G.S.	
LAND OFFICE	
OPERATOR	

NEW MEXICO OIL CONSERVATION COMMISSION

Form C-101  
Revised 1-1-65

API # 30-037-20041

5A. Indicate Type of Lease  
STATE  FEE

5. State Oil & Gas Lease No.

APPLICATION FOR PERMIT TO DRILL, DEEPEN, OR PLUG BACK

1a. Type of Work DRILL <input checked="" type="checkbox"/> DEEPEN <input type="checkbox"/> PLUG BACK <input type="checkbox"/>		7. Unit Agreement Name	
b. Type of Well OIL WELL <input checked="" type="checkbox"/> GAS WELL <input type="checkbox"/> OTHER <input type="checkbox"/>		8. Firm or Lease Name T. Whitley, ET UX	
2. Name of Operator Gulf Oil Corp		9. Well No. 1	
3. Address of Operator P.O. Box 670 Hobbs NM 88240		10. Field and Pool, or Wellcat Wildcat	
4. Location of Well UNIT LETTER M LOCATED 660 FEET FROM THE South LINE AND 660 FEET FROM THE West LINE OF SEC. 15 TWP. 10N RGE. 32E NMPM		12. County Quay	
19. Proposed Depth 8500		19A. Formation Strawn	20. Rotary or Bit Rotary
21. Elevations (Show whether DF, RT, etc.) GLE: 3993	21A. Kind & Status of Plug Bond Blanket	21B. Drilling Contractor UNKNOWN	22. Approx. Date work will start ASAP

PROPOSED CASING AND CEMENT PROGRAM

SIZE OF HOLE	SIZE OF CASING	WEIGHT PER FOOT	SETTING DEPTH	SACKS OF CEMENT	EST. TOP
14 3/4	11 3/4	42	400	300	C/C
11	8 5/8	24+32	2650	600	C/C
7 7/8	5 1/2	15.5	8150	600	2000'

Mod Program: 0-400' FW/spud 8.6-9.0 ppg 35-40 vis NC WL  
 400-2650 BW 10 ppg 28 vis NC WL  
 2650-TD BW/STARCH 10.1 ppg 29-32 vis 5-20 WL

ROP controls: 3000 psi WP 3000 psi Test see attachment.  
 COLLECT AND SACK SAMPLES FOR  
 NEW MEXICO BUREAU OF MINES, SOCORRO  
 AT AT LEAST TEN FOOT INTERVALS

APPROVAL VALID FOR 90 DAYS  
 PERMIT EXPIRES 6-18-85  
 UNLESS DRILLING UNDERWAY

IN ABOVE SPACE DESCRIBE PROPOSED PROGRAM; IF PROPOSAL IS TO DEEPEN OR PLUG BACK, GIVE DATA ON PRESENT PRODUCTIVE ZONE AND PROPOSED NEW PRODUCTIVE ZONE. GIVE BLOWOUT PREVENTER PROGRAM, IF ANY.

I hereby certify that the information above is true and complete to the best of my knowledge and belief.  
 Signed L.C. Under Title AREA PROD MGR Date 3-14-85

(This space for State Use)  
 APPROVED BY [Signature] TITLE DISTRICT SUPERVISOR DATE 3-20-85

CONDITIONS OF APPROVAL, IF ANY:

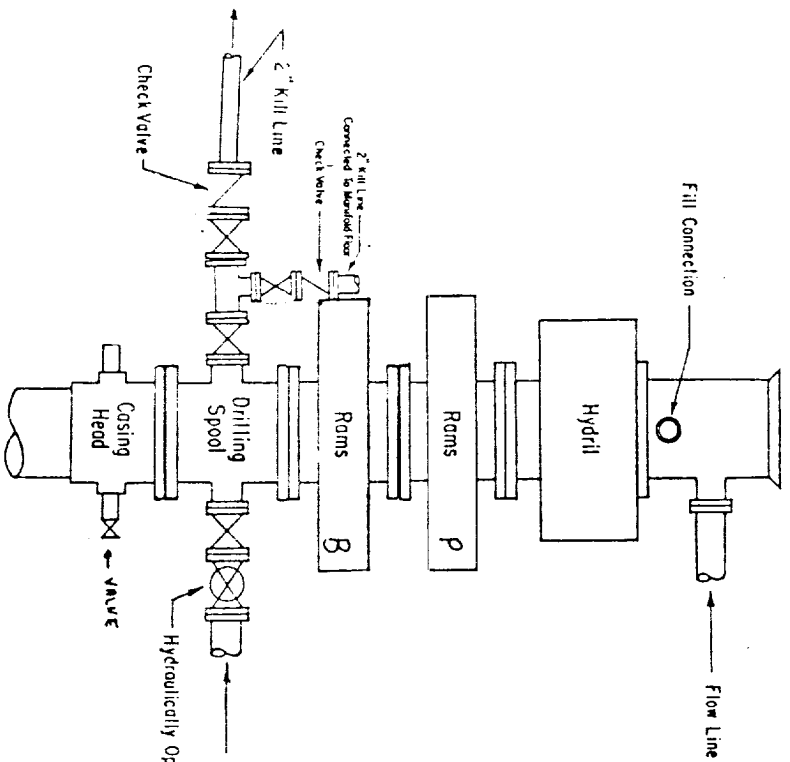

**2000-3000 PSI WORKING PRESSURE  
BOP HOOK - UP FOR LARGE CASINGS**

**SPECIFY WORKING PRESSURE**

The closing manifold and remote closing manifold shall have a separate control for each pressure-operated device. Controls are to be labeled, with control handles to indicate open and closed positions. A pressure reducer and regulator must be provided for operating the Hydril preventer. When requested, a second pressure reducer shall be available to limit operating fluid pressures to ram preventers. Gulf Legion No. 38 hydraulic oil, an equivalent or better, is to be used as the fluid to operate the hydraulic equipment.

The choke manifold, the choke flow line, the choke lines and the relief lines are to be supported by metal stands and adequately anchored. The choke flow line, relief lines and choke lines shall be constructed as straight as possible and without sharp bends. Easy and safe access shall be maintained to the choke manifold. All valves are to be selected for operation in the presence of oil, gas, and drilling fluids. The choke flow line valves and valves of the relief lines connected to the drilling spool and all ram type preventers must be equipped with stem extensions, universal joints if needed and hand wheels which are to extend beyond the edge of the derrick substructure. All other valves shall be equipped with handles.

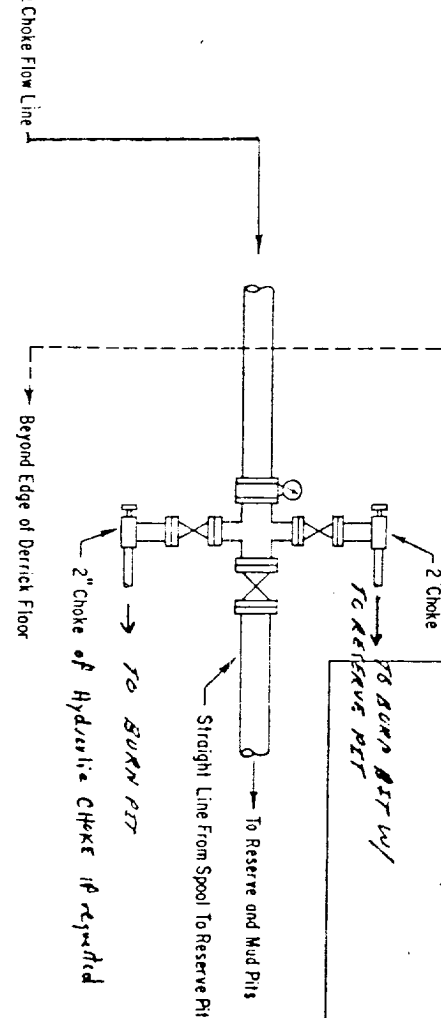

**Blowout preventer assembly shall consist of one blind ram preventer and one pipe ram preventer, both hydraulically operated, a Hydril preventer, valves, chokes and connections, as illustrated. If a tapered drill string is used, a ram preventer shall be provided for each size of drill pipe. Casing and tubing rams to fit the preventers are to be available as needed. The ram preventers may be two singles or a double type. If correct in size, the flanged outlets of the ram preventer may be used for connecting to the 4-inch 1. D. choke flow line and to the kill line. The substructure height shall be sufficient to install a rotating blowout preventer.**

Minimum operating equipment for the preventers and hydraulically operated valves shall be as follows: (1) multiple pumps, driven by a continuous source of power, capable of fluid changing the total accumulator volume from the nitrogen precharge pressure to its rated pressure within 2 minutes. Also, the pumps are to be connected to the hydraulic operating system which is to be a closed system. (2) accumulators with a precharge of nitrogen of not less than 750 PSI and connected so as to receive the deaerated fluid charge. With the charging pumps shut down, the pressurized fluid volume stored in the accumulators shall be sufficient to close all the pressure-operated devices simultaneously within 9 seconds after closure, the remaining accumulator pressure shall be not less than 1000 PSI with the remaining accumulator fluid volume at least 50 percent of the original. When requested, either an additional source of power, remote and equivalent, is to be available to operate the above pumps, or there shall be additional pumps operated by separate power and equal in performance capabilities.

**ADDITIONS - DELETIONS - CHANGES  
SPECIFY**

*NOTE: "When Requested" means at any time the Gulf Supervisor can, may, or will require the equipment to be installed during operations.*

NEW MEXICO OIL CONSERVATION COMMISSION  
WELL LOCATION AND ACREAGE DEDICATION PLAT

Form 10-1  
Supersedes C-128  
1-1-1965

All distances must be from the outer boundaries of the Section

Lessee <b>GULF OIL CORP.</b>		Owner <b>F. WHATLEY, ET UX</b>		Acres <b>1</b>
Map Letter <b>M</b>	Section <b>15</b>	Township <b>10N</b>	Range <b>32E</b>	County <b>QUAY</b>
Actual Surface Location of Well:				
<b>660</b>	feet from the	<b>SOUTH</b>	line and	<b>660</b>
				feet from the
				<b>WEST</b>
Ground Level Elev. <b>3993.0</b>	Producing Formation <b>Strawn</b>		Depth <b>Wildcat</b>	Estimated Acres <b>40</b>

1. Outline the acreage dedicated to the subject well by colored pencil or hachure marks on the plat below.
2. If more than one lease is dedicated to the well, outline each and identify the ownership thereof (both as to working interest and royalty)
3. If more than one lease of different ownership is dedicated to the well, have the interests of all owners been consolidated by communitization, unitization, force-pooling, etc?  
 Yes     No    If answer is "yes," type of consolidation \_\_\_\_\_

If answer is "no," list the owners and tract descriptions which have actually been consolidated. (Use reverse side of this form if necessary.) \_\_\_\_\_

No allowable will be assigned to the well until all interests have been consolidated (by communitization, unitization, forced-pooling, or otherwise) or until a non-standard unit, eliminating such interests, has been approved by the Commission.

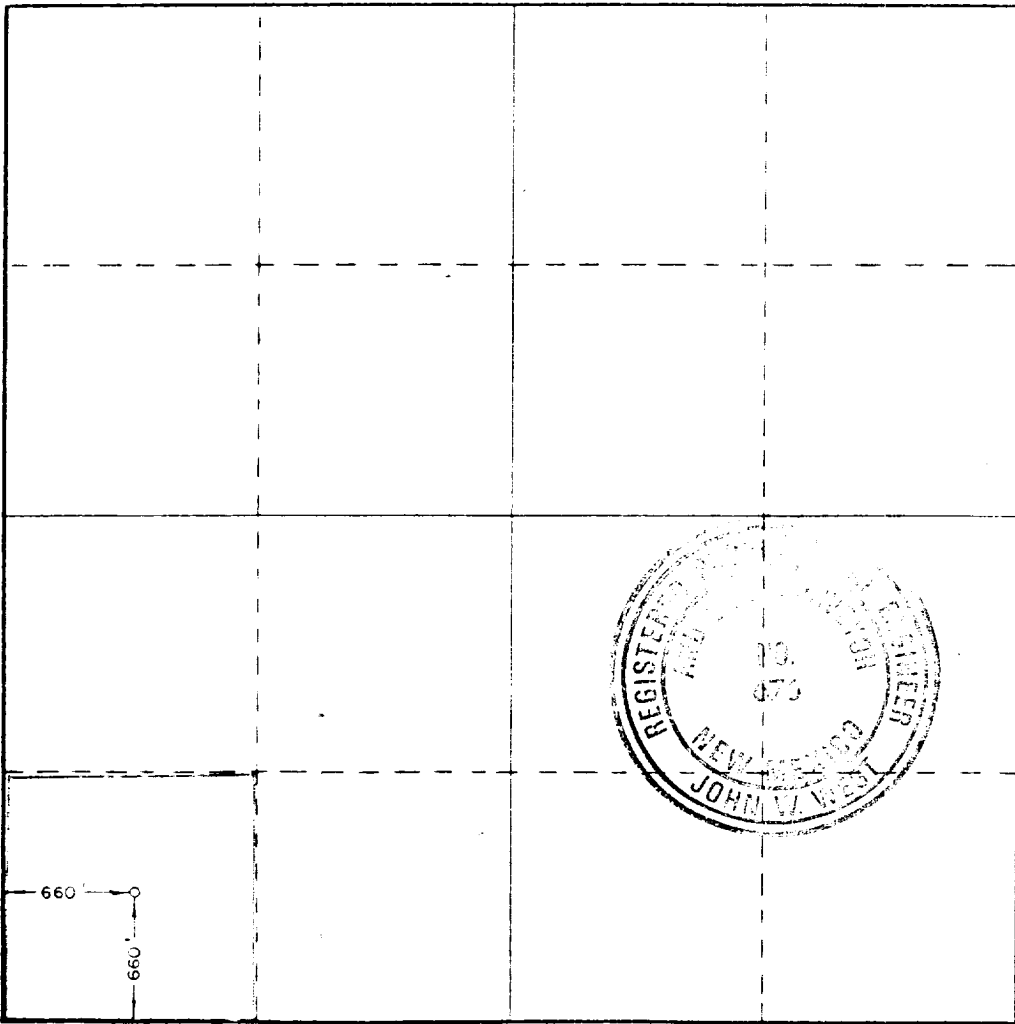

CERTIFICATION

I hereby certify that the information contained herein is true and complete to the best of my knowledge and belief.

*John Powell*  
Name

Lamar Powell  
Position

D. L. Engle  
Company

Gulf Oil  
Title

3-14-85  
Date

I hereby certify that the well location shown on this plat was plotted from field notes of actual surveys made by me or under my supervision, and that the same is true and correct to the best of my knowledge and belief.

Date Surveyed

3/13/85

Registered Professional Engineer and Land Surveyor

*John W. West*

Certificate No. JOHN W. WEST, 676  
RONALD J. EIDSON, 3239