

DISTRIBUTION	
STATE	
FEE	
REMARKS	
LAND OFFICE	
OPERATOR	

NEW MEXICO OIL CONSERVATION COMMISSION

API# 30-059-20026

Form O-101
Revised 11-6-77

TITLE	
STATE	X
OPERATOR	

APPLICATION FOR PERMIT TO DRILL, DEEPEN, OR PLUG BACK

1. Type of Well: DRILL DEEPEN PLUG BACK

2. Well Purpose: Co2 SINGLE MULTIPLE

3. Applicant: Amoco Production Company

4. Address of Applicant: P.O. Drawer "A", Levelland, Texas 79336

5. Location of Well: UNIT LETTER 0 LOCATED 1315 FEET FROM THE South LINE 1980 FEET FROM THE East LINE OF SEC. 36 T20-N R34-E

6. Well Depth: 2590'

7. Well Completion: Tubw Rotary

8. Approx. Date Well will start: April 20, 1979

9. Blanket-On File: Blanket-On File

10. Existing Conditions: N/A

11. Field Name: State FI

12. Well No.: 3

13. Field No. (if any): Und. Tubw

14. County: Union

PROPOSED CASING AND CEMENT PROGRAM

SIZE OF HOLE	SIZE OF CASING	WEIGHT PER FOOT	SETTING DEPTH	SACKS OF CEMENT	EST. TOP
12 1/4"	8 5/8"	24#	350'	Circ to Surf	Surface
7 7/8"	4 1/2"	9.5#	2590'	Tie back to 8 5/8"	Btm of 8 5/8"

After drilling well, logs will be run and evaluation made. Perforating and/or stimulating as necessary in attempting commercial production.

Mud Program: 0 - 350' Native mud and water.
350' - 2590' Commercial mud to maintain good hole conditions.

OIL CONSERVATION COMMISSION TO BE NOTIFIED WITHIN 24 HOURS OF FINISHING OPERATIONS

BOP program is attached.

Gas is not dedicated.

90
7/30/79

IN ABOVE SPACE DESCRIBE PROPOSED PROGRAM; IF PROPOSAL IS TO DEEPEN OR PLUG BACK, GIVE DATA ON PRESENT PRODUCTIVE ZONE AND PROPOSED NEW PRODUCTIVE ZONE; GIVE FLOORSET PREVENTER PROGRAM, IF ANY.

I hereby certify that the information above is true and complete to the best of my knowledge and belief.

Signed Randy Atkins Title Administrative Analyst Date April 6, 1979

(This space for State Use)

APPROVED BY Carl King TITLE _____ DATE 5/1/79

CONDITIONS OF APPROVAL, IF ANY:
0+5-NMOC, Sf 1-RWA 1-JA
1-Houston 1-Susp

COPIES OF THIS PERMIT SHALL BE FURNISHED TO THE OPERATOR AT LEAST 10 DAYS BEFORE COMMENCEMENT OF OPERATIONS.

WELL LOCATION AND DEDICATION STATEMENT

Section 36

Amoco Production Co.

State "E. I."

3

1. Well No. 4-29-77, Section 36, T10N, R10E, S1E, Union, South, East

4-29-77 TUBE UND. UNION TUBE

- 2. If more than one lease is dedicated to the well, outline each and identify the ownership thereof (including interest and royalty)
3. If more than one lease of different ownership is dedicated to the well, have the interests of all owners been consolidated by communitization, unitization, force pooling, etc?

Yes No If answer is "yes" type of consolidation

If answer is "no," list the owners and tract descriptions which have actually been consolidated. Use reverse side of this form if necessary.

No allowable will be assigned to the well until all interests have been consolidated by communitization, unitization, force pooling, or otherwise and all a consistent plan for unitizing said interests, as to be approved by the Commission.

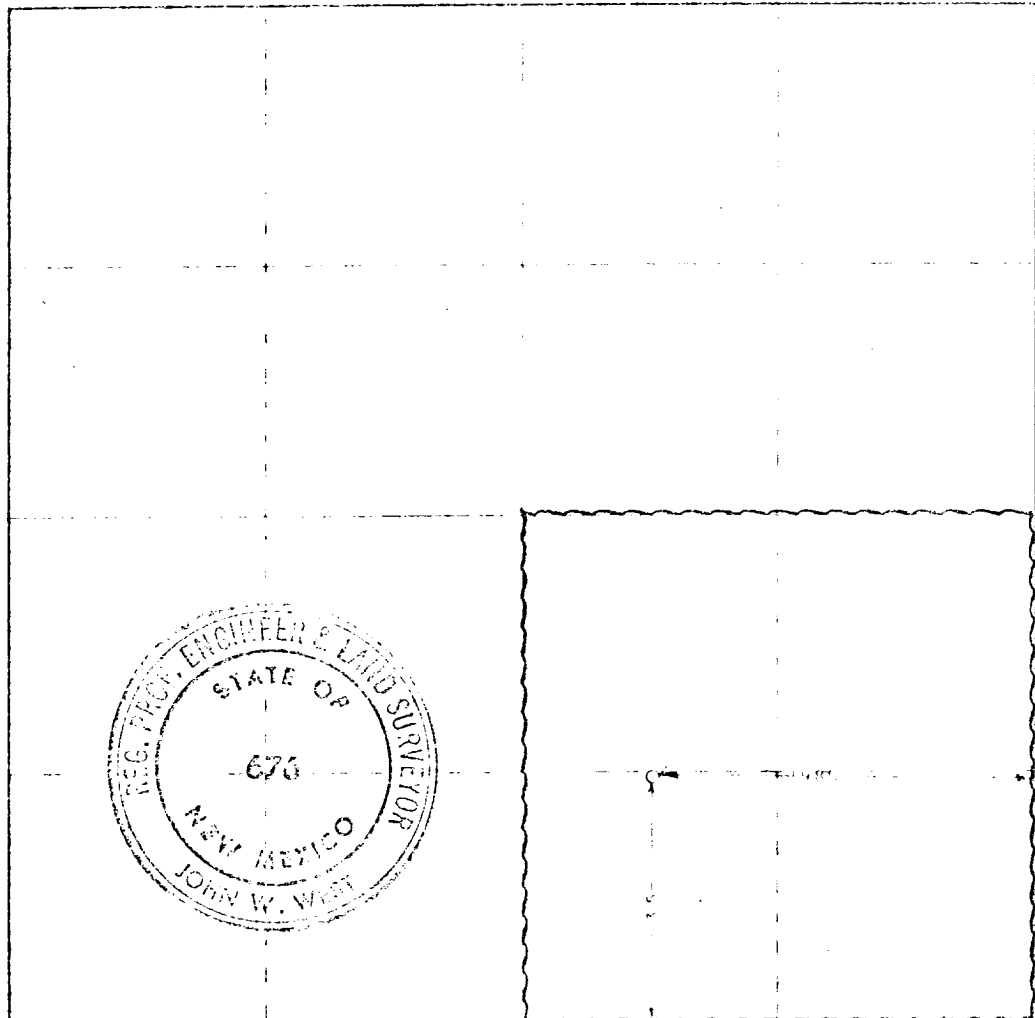

DECLARATION

I hereby certify that the location shown on this plat was plotted from the notes of the surveys made by me under my supervision and that the same is true and correct to the best of my knowledge and belief.

Randy Atkins
ADMIN. ANALYST
AMOCO PRODUCTION CO.
3-23-79

I hereby certify that the well location shown on this plat was plotted from the notes of the surveys made by me under my supervision and that the same is true and correct to the best of my knowledge and belief.

March 25, 1979

John W. West

John W. West 676
Donald J. Lingen 5249

ATTACHMENT "B"
NOTES

1. Blow-out preventers and master valve to be fluid operated and oil fittings must be in good condition, 3,000# W.P. (6,000 p.s.i. test), minimum.
2. Equipment through which bit must pass shall be as large as the inside diameter of the casing that is being drilled through.
3. Nipple above blow-out preventer shall be same size as casing being drilled through.
4. Kelly cock required, 3,000# W.P. (6,000 p.s.i. test) minimum.
5. OMSCO or comparable safety valve must be available on rig floor at all times with proper connection or sub, 3,000# W.P. (6,000 p.s.i. test), minimum.
6. Blow-out preventers and master valve while drilling intermediate hole to 6000' may be 2,000# W.P. (4,000 p.s.i. test), minimum.
7. Choke assembly, beyond second valve from cross, may be positioned (optional) outside of derrick foundation.
8. Spool or cross may be eliminated if connections are available in the lower part of the blow-out preventer body.
9. Plug valves - gate valves are optional. Valves shown as 2" are minimum size.
10. Casing head and casing head spool, including attached valves, to be furnished by Amoco.
11. Rams in preventers will be installed as follows:

When drilling, use:	When running casing, use:
Top Preventer - Drill pipe rams	Top Preventer - Casing rams
Bottom Preventer - Blind rams or master valve	Bottom Preventer - Blind rams or master valve

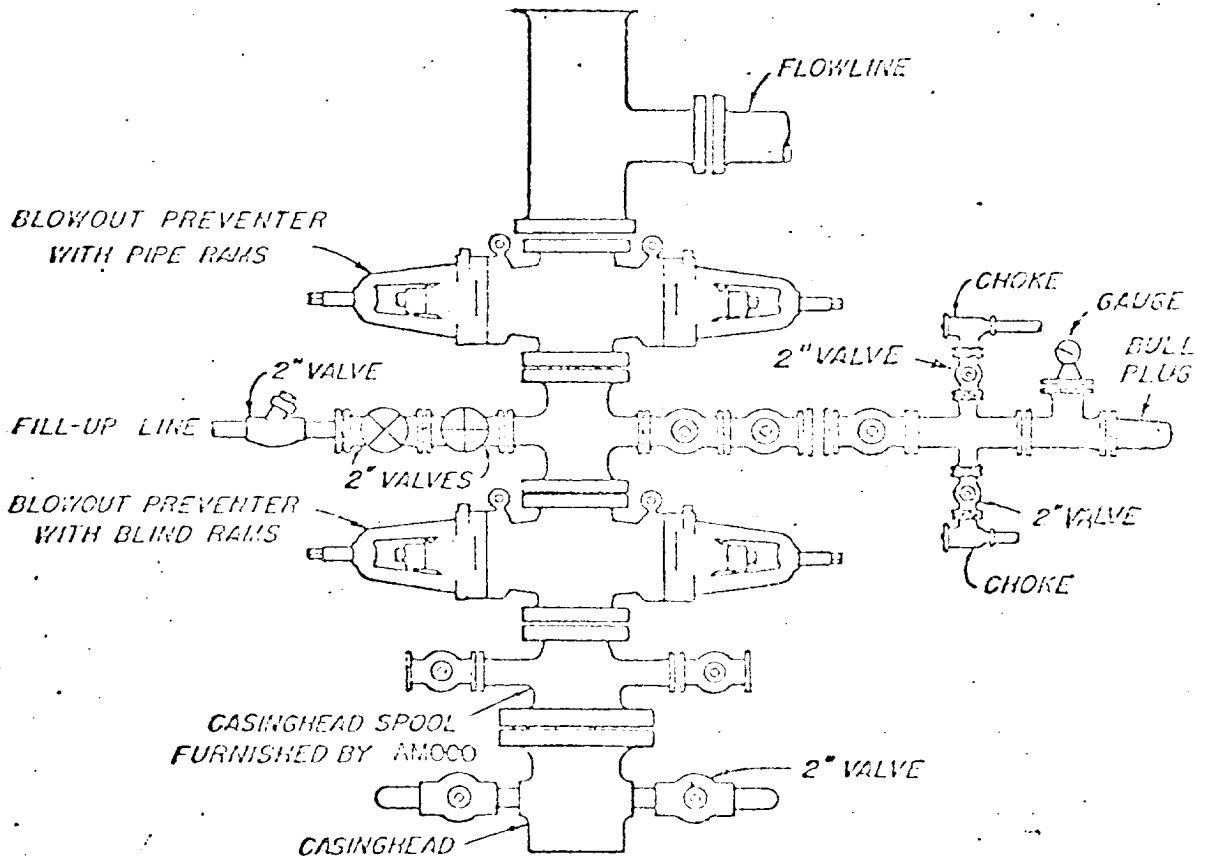

BLOWOUT PREVENTER HOOK-UP

AMOCO PRODUCTION COMPANY

EXHIBIT D-1 MODIFIED

JUNE 1, 1962