

AMOCO PRODUCTION COMPANY
 BRADLEY COUNTY, MISSISSIPPI
 BRADLEY COUNTY AIRSPACE DEDICATION PLAT

All distances must be in feet, or feet and inches, or miles.

AMOCO PRODUCTION COMPANY		Bravo Dome Carbon Dioxide Gas Unit		Well No. 1834181G
Section: 6	Range: 18	Township: 18N	Meridian: R34E	County: UNION
Section 1650		Line 1880		Line EAST
Truss Level Elev. 4765	Producing Formation: Tubb	Well: Bravo Dome 640-acre area	Dedicated Acreage: 640 Acres	

- Outline the acreage dedicated to the subject well by colored pencil or hatchure marks on the plat below.
- If more than one lease is dedicated to the well, outline each and identify the ownership thereof (both as to working interest and royalty).
- If more than one lease of different ownership is dedicated to the well, have the interests of all owners been consolidated by communitization, unitization, force-pooling, etc?

RECEIVED
 AUG 13 1984
 OIL CONSERVATION DIVISION

Yes No If answer is "yes," type of consolidation Pooling Declaration

If answer is "no," list the owners and tract descriptions which have actually been consolidated. (Use reverse side of this form if necessary.)

No allowable will be assigned to the well until all interests have been consolidated (by communitization, unitization, forced-pooling, or otherwise) or until a non-standard unit, eliminating such interests, has been approved by the Commission.

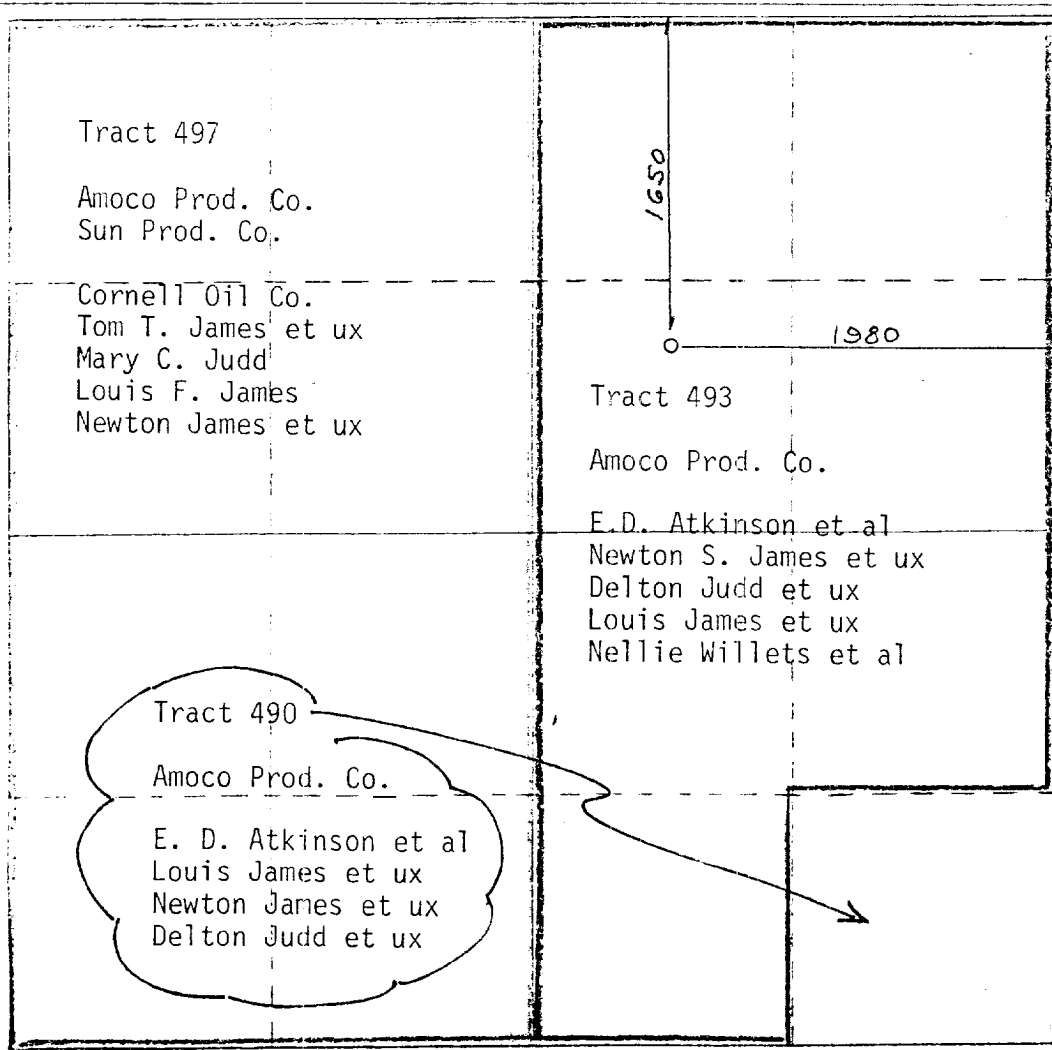

CERTIFICATION

I hereby certify that the information contained herein is true and complete to the best of my knowledge and belief.

Name: John S. McElroy

Position: Assist. Admin. Analyst

Company: Amoco Production Company

Date: 8-8-84

I hereby certify that the well location shown on this plat was plotted from field notes of actual surveys made by me or under my supervision, and that the same is true and correct to the best of my knowledge and belief.

JULY 9, 1984

Date Surveyed: 8-8-84

John S. McElroy
 Registered Professional Engineer
 and/or Land Surveyor

N.M.S. NO. 5103
 Certificate No. 5103

