

UNITED STATES
DEPARTMENT OF THE INTERIOR
GEOLOGICAL SURVEY

APPLICATION FOR PERMIT TO DRILL, DEEPEN, OR PLUG BACK

1a. TYPE OF WORK
 DRILL DEEPEN PLUG BACK

b. TYPE OF WELL
 OIL WELL GAS WELL OTHER SINGLE ZONE MULTIPLE ZONE

2. NAME OF OPERATOR
 REESE & JONES

3. ADDRESS OF OPERATOR
 900 Bank of New Mexico Building, Albuquerque, New Mexico 87102

4. LOCATION OF WELL (Report location clearly and in accordance with any State requirements.)*
 At surface: 990' fsl, 2050' fwl
 At proposed prod. zone: 990' fsl, 2050' fwl

14. DISTANCE IN MILES AND DIRECTION FROM NEAREST TOWN OR POST OFFICE*
 17 miles south of Laguna, New Mexico

15. DISTANCE FROM PROPOSED* LOCATION TO NEAREST PROPERTY OR LEASE LINE, FT. (Also to nearest drlg. unit line, if any) 990'

16. NO. OF ACRES IN LEASE 796.83

17. NO. OF ACRES ASSIGNED TO THIS WELL 40

18. DISTANCE FROM PROPOSED LOCATION* TO NEAREST WELL, DRILLING COMPLETED, OR APPLIED FOR, ON THIS LEASE, FT. None

19. PROPOSED DEPTH 4000'

20. ROTARY OR CABLE TOOLS Rotary

21. ELEVATIONS (Show whether DF, RT, GR, etc.) 6185' GR

22. APPROX. DATE WORK WILL START* March 15, 1974

5. LEASE DESIGNATION AND SERIAL NO. NM 11835

6. IF INDIAN, ALLOTTEE OR TRIBE NAME Federal

7. UNIT AGREEMENT NAME None

8. FARM OR LEASE NAME Carrizo

9. WELL NO. 1

10. FIELD AND POOL, OR WILDCAT Wildeat

11. SEC., T., R., N., OR BLK. AND SURVEY OR AREA Sec 34, T7N, R3W, NMPM

12. COUNTY OR PARISH Valencia

13. STATE New Mexico

23. PROPOSED CASING AND CEMENTING PROGRAM

SIZE OF HOLE	SIZE OF CASING	WEIGHT PER FOOT	SETTING DEPTH	QUANTITY OF CEMENT
10-3/4"	8-5/8"	32#	100'	100 sacks
7-7/8"	5-1/2"	14#	4000'	200 sacks

Plan to drill 10-3/4" hole to 100', set surface casing @ 100', and circulate cement to surface. Will drill to total depth of approximately 4000' to test the Pennsylvanian. If production is encountered, plan to run 5 1/2" casing to total depth and complete by selective perforation.

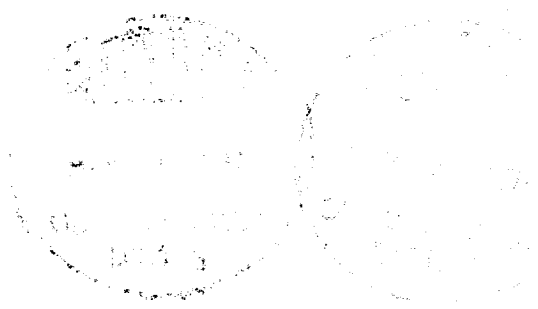

IN ABOVE SPACE DESCRIBE PROPOSED PROGRAM: If proposal is to deepen or plug back, give data on present productive zone and proposed new productive zone. If proposal is to drill or deepen directionally, give pertinent data on subsurface locations and measured and true vertical depths. Give blowout preventer program, if any.

24. SIGNED Morris Jones TITLE Partner DATE 2/19/74
 (This space for Federal or State office use)

PERMIT NO. _____ APPROVAL DATE _____

APPROVED BY _____ TITLE _____ DATE _____

CONDITIONS OF APPROVAL, IF ANY _____

*See Instructions On Reverse Side

[Handwritten signature]

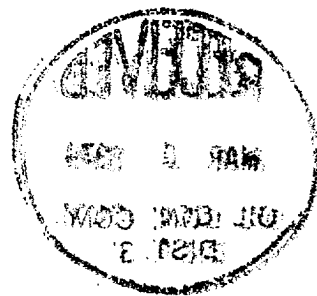

NEW MEXICO OIL CONSERVATION COMMISSION
WELL LOCATION AND ACREAGE DEDICATION PLAT

Form O-102
Supersedes C-128
Effective 1-4-65

All dedications must be filed in the office of the State Engineer.

Operator REESE & JONES		County Carrizo		Well No. 1
Unit N	34	7 NORTH	3 WEST	VALENCIA
Section 990		SOUTH	2050	WEST
Section No. 6185	Section Name Pennsylvanian	Section No. Wildcat	Total Acreage 40 Acres	

1. Outline the acreage dedicated to the subject well by colored pencil or hachure marks on the plat below.
2. If more than one lease is dedicated to the well, outline each and identify the ownership thereof (both as to working interest and royalty).

One Lease Only
3. If more than one lease of different ownership is dedicated to the well, have the interests of all owners been consolidated by communitization, unitization, force-pooling, etc?

One Lease Only

Yes No. If answer is "yes," type of consolidation _____

If answer is "no," list the owners and tract descriptions which have actually been consolidated. (Use reverse side of this form if necessary.) _____

No allowable will be assigned to the well until all interests have been consolidated (by communitization, unitization, forced-pooling, or otherwise) or until a non-standard unit, eliminating such interests, has been approved by the Commission.

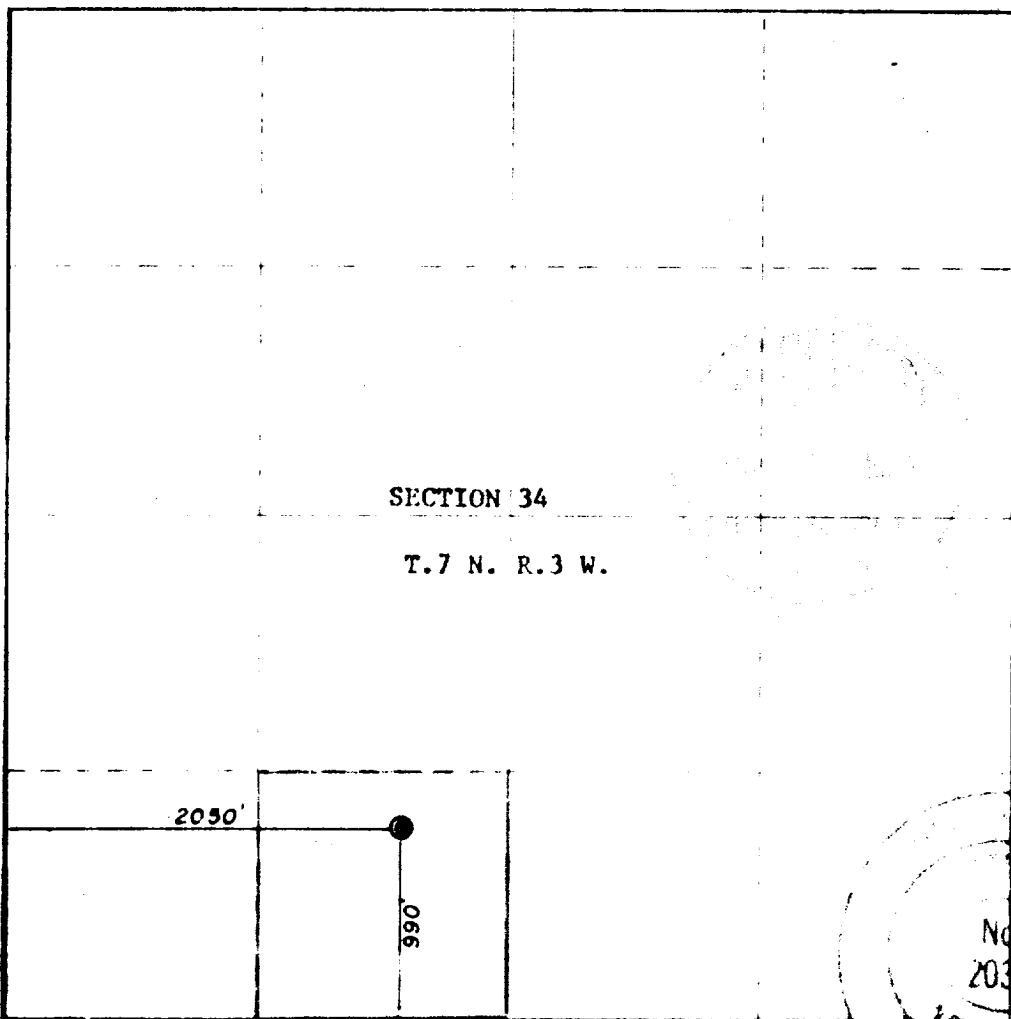

CERTIFICATION

I hereby certify that the information contained herein is true and complete to the best of my knowledge and belief.

Morris B. Jones

Morris B. Jones
Partner
Reese & Jones

February 19, 1974

I hereby certify that the well location shown on this plat was plotted from field notes of actual surveys made by me or under my supervision and that the same is true and correct to the best of my knowledge and belief.

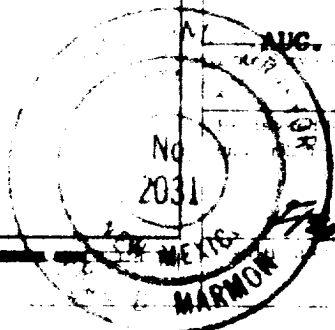

AUG. 18, 1973

2031

UNITED STATES
DEPARTMENT OF THE INTERIOR
GEOLOGICAL SURVEY

SUBMIT IN TRIPPLICATE*
(Other instructions on reverse side)

Form approved,
Budget Bureau No. 42-R1424.

SUNDRY NOTICES AND REPORTS ON WELLS

(Do not use this form for proposals to drill or to deepen or plug back to a different reservoir. Use "APPLICATION FOR PERMIT--" for such proposals.)

1. OIL WELL <input checked="" type="checkbox"/> GAS WELL <input type="checkbox"/> OTHER <input type="checkbox"/>		5. LEASE DESIGNATION AND SERIAL NO. 12-2035
2. NAME OF OPERATOR		6. IF INDIAN, ALLOTTEE OR TRIBE NAME Federal
3. ADDRESS OF OPERATOR		7. UNIT AGREEMENT NAME None
4. LOCATION OF WELL (Report location clearly and in accordance with any State requirements.* See also space 17 below.) At surface 29' 1st, 200' 2d.		8. FARM OR LEASE NAME 12-2035
14. PERMIT NO. U.S.G.S. 3-7-74		9. WELL NO. 1
15. ELEVATIONS (Show whether DF, RT, GR, etc.) 200' 0		10. FIELD AND POOL, OR WILDCAT 12-2035
		11. SEC., T., R., M., OR BLK. AND SURVEY OR AREA 12, 17, 28, 111A
		12. COUNTY OR PARISH Glendia Co., New Jersey
		13. STATE New Jersey

16. Check Appropriate Box To Indicate Nature of Notice, Report, or Other Data

NOTICE OF INTENTION TO:		SUBSEQUENT REPORT OF:	
TEST WATER SHUT-OFF <input type="checkbox"/>	PULL OR ALTER CASING <input type="checkbox"/>	WATER SHUT-OFF <input type="checkbox"/>	REPAIRING WELL <input type="checkbox"/>
FRACTURE TREAT <input type="checkbox"/>	MULTIPLE COMPLETE <input type="checkbox"/>	FRACTURE TREATMENT <input type="checkbox"/>	ALTERING CASING <input type="checkbox"/>
SHOOT OR ACIDIZE <input type="checkbox"/>	ABANDON* <input type="checkbox"/>	SHOOTING OR ACIDIZING <input type="checkbox"/>	ABANDONMENT* <input type="checkbox"/>
REPAIR WELL <input type="checkbox"/>	CHANGE PLANS <input type="checkbox"/>	(Other) <input checked="" type="checkbox"/> <u>at permit</u>	
(Other) <input type="checkbox"/>		(NOTE: Report results of multiple completion on Well Completion or Recompletion Report and Log form.)	

17. DESCRIBE PROPOSED OR COMPLETED OPERATIONS (Clearly state all pertinent details, and give pertinent dates, including estimated date of starting any proposed work. If well is directionally drilled, give subsurface locations and measured and true vertical depths for all markers and zones pertinent to this work.) *

Reamed well at 1:10 p.m. 3-7-74. Drilled to 200'. Set 5 joints 3-7/8" (10'), 2d, set to 207'. Cemented with 100 sacks Class C with 1 calcium chloride. Circulated. Plug on bottom at 1:15 p.m. 3-7-74. After 8 hours tested casing with 500# p.p.i. Held okay.

ILLEGIBLE

18. I hereby certify that the foregoing is true and correct

SIGNED _____ TITLE _____ DATE _____

(This space for Federal or State office use)

APPROVED BY _____ TITLE _____ DATE _____

CONDITIONS OF APPROVAL, IF ANY:

W. S. Te
*See Instructions on Reverse Side

Instructions

General: This form is designed for submitting proposals to perform certain well operations, and reports of such operations when completed, as indicated, on Federal and Indian lands pursuant to applicable Federal law and regulations, and, if approved or accepted by any State, on all lands in such State, pursuant to applicable State law and regulations. Any necessary special instructions concerning the use of this form and the number of copies to be submitted, particularly with regard to local, area, or regional procedures and practices, either are shown below or will be issued by, or may be obtained from, the local Federal and/or State office.

Item 4: If there are no applicable State requirements, locations on Federal or Indian land should be described in accordance with Federal requirements. Consult local State or Federal office for specific instructions.

Item 17: Proposals to abandon a well and subsequent reports of abandonment should include such special information as is required by local Federal and/or State offices. In addition, such proposals and reports should include reasons for the abandonment; data on any former or present productive zones, or other zones with present significant fluid contents not sealed off by cement or otherwise; depths (top and bottom) and method of placement of cement plugs; mud or other material placed below, between and above plugs; amount, size, method of parting of any casing, liner or tubing pulled and the depth to top of any left in the hole; method of closing top of well; and date well site conditioned for final inspection looking to approval of the abandonment.