

Closure Report

Site Description

Site Name:	Cypress 33 Federal #6H
Company:	Oxy Permian Ltd.
Legal Description:	U/L A, Section 33, T23S, R29E
County:	Eddy County, NM
GPS Coordinates:	N 32.26731° W 103.98449°

Release Data

Date of Release:	11/06/2014
Type of Release:	Oil
Source of Release:	Excess pressure caused stuffing box packing to blow out
Volume of Release:	10 bbls
Volume Recovered:	0 bbls

Remediation Specifications

Remediation Parameters:	Backdrag the overspray area. Excavate the leak area to a depth of 1.5 feet. Collect a confirmation sample from SP2, SP3, and SP4 and combine the samples to make a composite confirmation sample. Backfill the site with clean soil.	
Remediation Activities:	04/23/2015 to 04/30/2015	
Plan Sent to OCD:	04/08/2015	Email from Cliff Brunson to Mike Bratcher
OCD Approval of Plan:	04/09/2015	Email from Mike Bratcher to Cliff Brunson
Plan Sent to BLM:	04/09/2015	Email from Cliff Brunson to Sol Hughes
BLM Approval of Plan:	04/13/2015	Email from Sol Hughes to Cliff Brunson

Supporting Documentation

Initial C-141	Signed 11/13/2014
Final C-141	Signed 05/02/2015
Site Diagram	November 2014
Groundwater Plot	50'-75'
TOPO Maps	November 2014
Lab Summary	03/05/2015 and 04/27/2015
Lab Analysis	03/05/2015 and 04/27/2015
Correspondence	Request and approval of remediation plan via email

Request for Closure

Based on the completion of the remediation plan as agreed upon, BBC International requests closure approval from NMOCD.

Cliff Brunson, President of BBC International Inc.

05/08/2015

District I
1625 N. French Dr., Hobbs, NM 88240
District II
1301 W. Grand Avenue, Artesia, NM 88210
District III
1000 Rio Brazos Road, Aztec, NM 87410
District IV
1220 S. St. Francis Dr., Santa Fe, NM 87505

State of New Mexico
Energy Minerals and Natural Resources

Oil Conservation Division
1220 South St. Francis Dr.
Santa Fe, NM 87505

Form C-141
Revised October 10, 2003

Submit 2 Copies to appropriate
District Office in accordance
with Rule 116 on back
side of form

Release Notification and Corrective Action

OPERATOR		<input checked="" type="checkbox"/> Initial Report	<input type="checkbox"/> Final Report
Name of Company	Oxy Permian Ltd.	Contact	CJ Summers
Address	1017 W. Stanolind Rd, Hobbs, NM	Telephone No.	(575) 397-8216
Facility Name	Cypress 33 Federal #6H	Facility Type	Well location
Surface Owner	BLM	Mineral Owner	
		API No. 30-015-41557	

LOCATION OF RELEASE

Unit Letter	Section	Township	Range	Feet from the	North/South Line	Feet from the	East/West Line	County
A	33	23S	29E	466	North	1040	East	Eddy

Latitude N 32.26685° Longitude W 103.98463°

NATURE OF RELEASE

Type of Release	Oil	Volume of Release	10 bbls	Volume Recovered	0 bbls
Source of Release	Excess pressure caused the stuffing box packing on the well head to blow off	Date and Hour of Occurrence	11/06/2014	Date and Hour of Discovery	
Was Immediate Notice Given?	<input checked="" type="checkbox"/> Yes <input type="checkbox"/> No <input type="checkbox"/> Not Required	If YES, To Whom?	Mike Bratcher, Heather Patterson-NMOCD; Sol Hughes-BLM		
By Whom?	Kathy Purvis, BBC International	Date and Hour	11/07/2014 @ 9:42 am		
Was a Watercourse Reached?	<input type="checkbox"/> Yes <input checked="" type="checkbox"/> No	If YES, Volume Impacting the Watercourse.			

If a Watercourse was Impacted, Describe Fully.*

Describe Cause of Problem and Remedial Action Taken.*

Excess pressure caused the stuffing box packing on the well head to blow off and leak 10 bbls of oil onto the ground. No fluids were recovered and the stuffing box packing was replaced.

Describe Area Affected and Cleanup Action Taken.*

The affected area is approximately 50' x 150' on location. Remediation will be completed in accordance a remediation plan approved by NMOCD and the BLM.

I hereby certify that the information given above is true and complete to the best of my knowledge and understand that pursuant to NMOCD rules and regulations all operators are required to report and/or file certain release notifications and perform corrective actions for releases which may endanger public health or the environment. The acceptance of a C-141 report by the NMOCD marked as "Final Report" does not relieve the operator of liability should their operations have failed to adequately investigate and remediate contamination that pose a threat to ground water, surface water, human health or the environment. In addition, NMOCD acceptance of a C-141 report does not relieve the operator of responsibility for compliance with any other federal, state, or local laws and/or regulations.

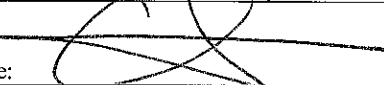
Signature: 		OIL CONSERVATION DIVISION	
Printed Name: Chancey Summers		Approved by District Supervisor:	
Title: HES Specialist		Approval Date:	Expiration Date:
E-mail Address: Chancey.Summers@oxy.com		Conditions of Approval:	
Date: 11/13/14 Phone: (575) 397-8216		Attached <input type="checkbox"/>	

* Attach Additional Sheets If Necessary

District I
1625 N. French Dr., Hobbs, NM 88240
District II
811 S. First St., Artesia, NM 88210
District III
1000 Rio Brazos Road, Aztec, NM 87410
District IV
1220 S. St. Francis Dr., Santa Fe, NM 87505

State of New Mexico
Energy Minerals and Natural Resources

Form C-141
Revised August 8, 2011

Oil Conservation Division
1220 South St. Francis Dr.
Santa Fe, NM 87505

Submit 1 Copy to appropriate District Office in
accordance with 19.15.29 NMAC.

Release Notification and Corrective Action

OPERATOR

☐ Initial Report ☒ Final Report

Name of Company	Oxy Permian Ltd.	Contact	Christopher Jones
Address	1502 W. Commerce Dr., Carlsbad, NM	Telephone No.	(575) 628-4121
Facility Name	Cypress 33 Federal #6H	Facility Type	Well location
Surface Owner	BLM	Mineral Owner	
		API No.	30-015-41557

LOCATION OF RELEASE

Unit Letter	Section	Township	Range	Feet from the	North/South Line	Feet from the	East/West Line	County
A	33	23S	29E					Eddy County, NM

Latitude N 32.26731° Longitude W 103.98449°

NATURE OF RELEASE

Type of Release	Oil	Volume of Release	10 bbls	Volume Recovered	0 bbls
Source of Release	Excess pressure caused the stuffing box packing on the well head to blow off	Date and Hour of Occurrence	11/06/2014	Date and Hour of Discovery	
Was Immediate Notice Given?	<input checked="" type="checkbox"/> Yes <input type="checkbox"/> No <input type="checkbox"/> Not Required	If YES, To Whom?	Mike Bratcher, Heather Patterson-NMOCD; Sol Hughes-BLM		
By Whom?	Kathy Purvis, BBC International	Date and Hour	11/07/2014 @ 9:42am		
Was a Watercourse Reached?	<input type="checkbox"/> Yes <input checked="" type="checkbox"/> No	If YES, Volume Impacting the Watercourse.			

If a Watercourse was Impacted, Describe Fully.*

Describe Cause of Problem and Remedial Action Taken.*

Excess pressure caused the stuffing box packing on the well head to blow off and leak 10 bbls of oil onto the ground. No fluids were recovered and the stuffing box packing was replaced.

Describe Area Affected and Cleanup Action Taken.*

The affected area is approximately 50' x 150' on location. Remediation was completed in accordance with the remediation plan approved by Mike Bratcher of NMOCD via email on 04/09/2015 and approved by Sol Hughes of the BLM via email on 04/13/2015.

I hereby certify that the information given above is true and complete to the best of my knowledge and understand that pursuant to NMOCD rules and regulations all operators are required to report and/or file certain release notifications and perform corrective actions for releases which may endanger public health or the environment. The acceptance of a C-141 report by the NMOCD marked as "Final Report" does not relieve the operator of liability should their operations have failed to adequately investigate and remediate contamination that pose a threat to ground water, surface water, human health or the environment. In addition, NMOCD acceptance of a C-141 report does not relieve the operator of responsibility for compliance with any other federal, state, or local laws and/or regulations.

OIL CONSERVATION DIVISION

Signature: **Chris Jones**
Digitally signed by Chris Jones
DN: cn=Chris Jones, o=ou,
email=ckjones888@yahoo.com,
c=US
Date: 2015.05.02 06:39:42 -05'00'

Printed Name: Christopher Jones

Approved by Environmental Specialist:

Title: HES Specialist

Approval Date:

Expiration Date:

E-mail Address: Christopher_Jones@oxy.com

Conditions of Approval:

Attached ☐

Date: Phone: (575) 628-4121

* Attach Additional Sheets If Necessary



Oxy
Cypress 33 Federal #6H

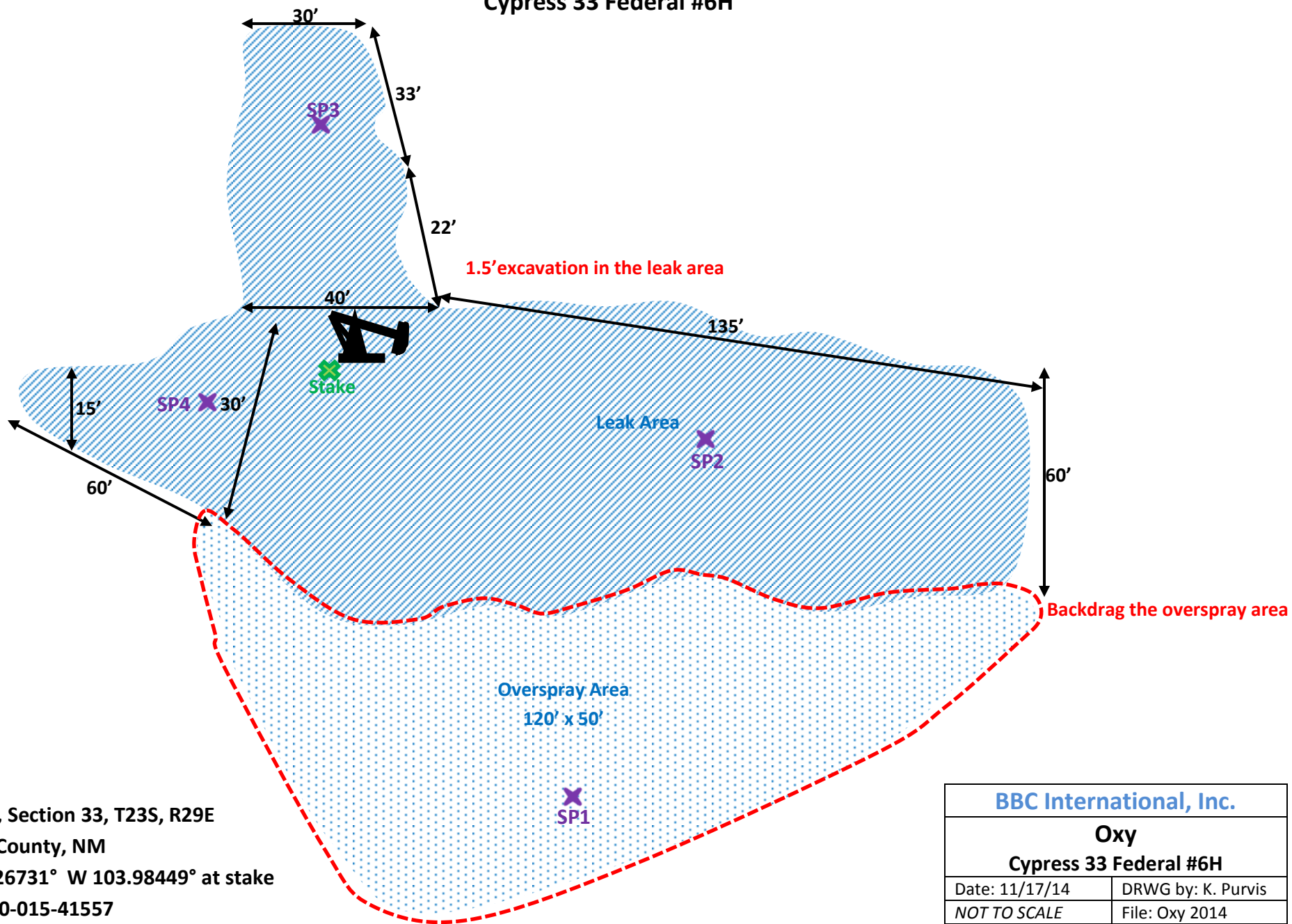

Groundwater Plot

Oxy Cypress 33 Federal #6H

County
Eddy

Unit Letter
A

Section
33

Township
23S

Range
29E

Trend Map 50'-75'

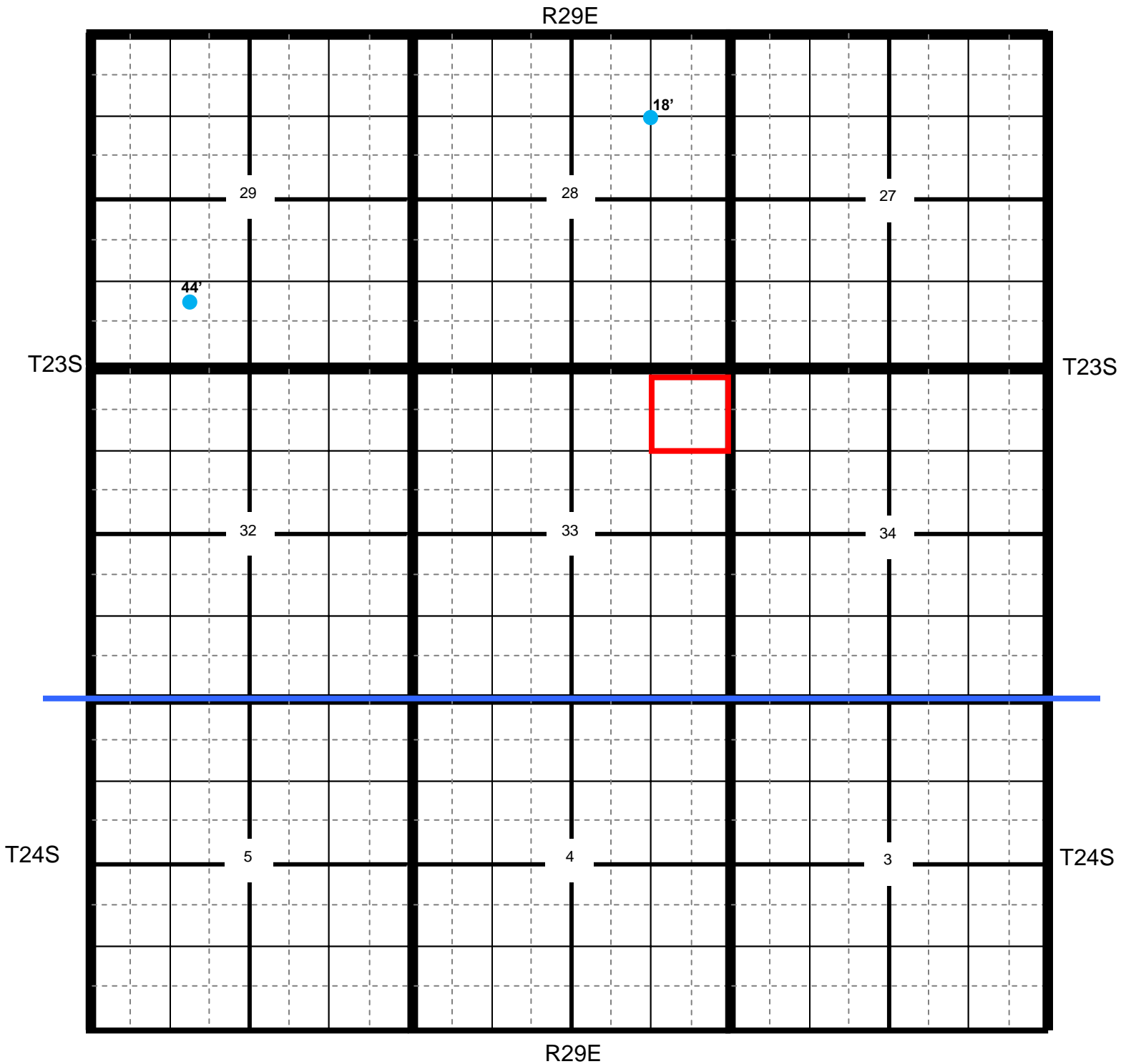

Location

OCD

USGS

SEO

All Databases

Oxy Cypress 33 Federal #6H

County Eddy Unit Letter A Section 33 Township 23S Range 29E

Trend Map 50'-75'

1

2

NW/NW None found	NE/NW	NW/NE	NE/NE
Unit Letter D	Unit Letter C	Unit Letter B	Unit Letter A
SW/NW	SE/NW	SW/NE	SE/NE
Unit Letter E	Unit Letter F	Unit Letter G	Unit Letter H
NW/SW	NE/SW	NW/SE	NE/SE
Unit Letter L	Unit Letter K	Unit Letter J	Unit Letter I
SW/SW	SE/SW	SW/SE	SE/SE
Unit Letter M	Unit Letter N	Unit Letter O	Unit Letter P

3

4

Oxy

Cypress 33 Federal #6H

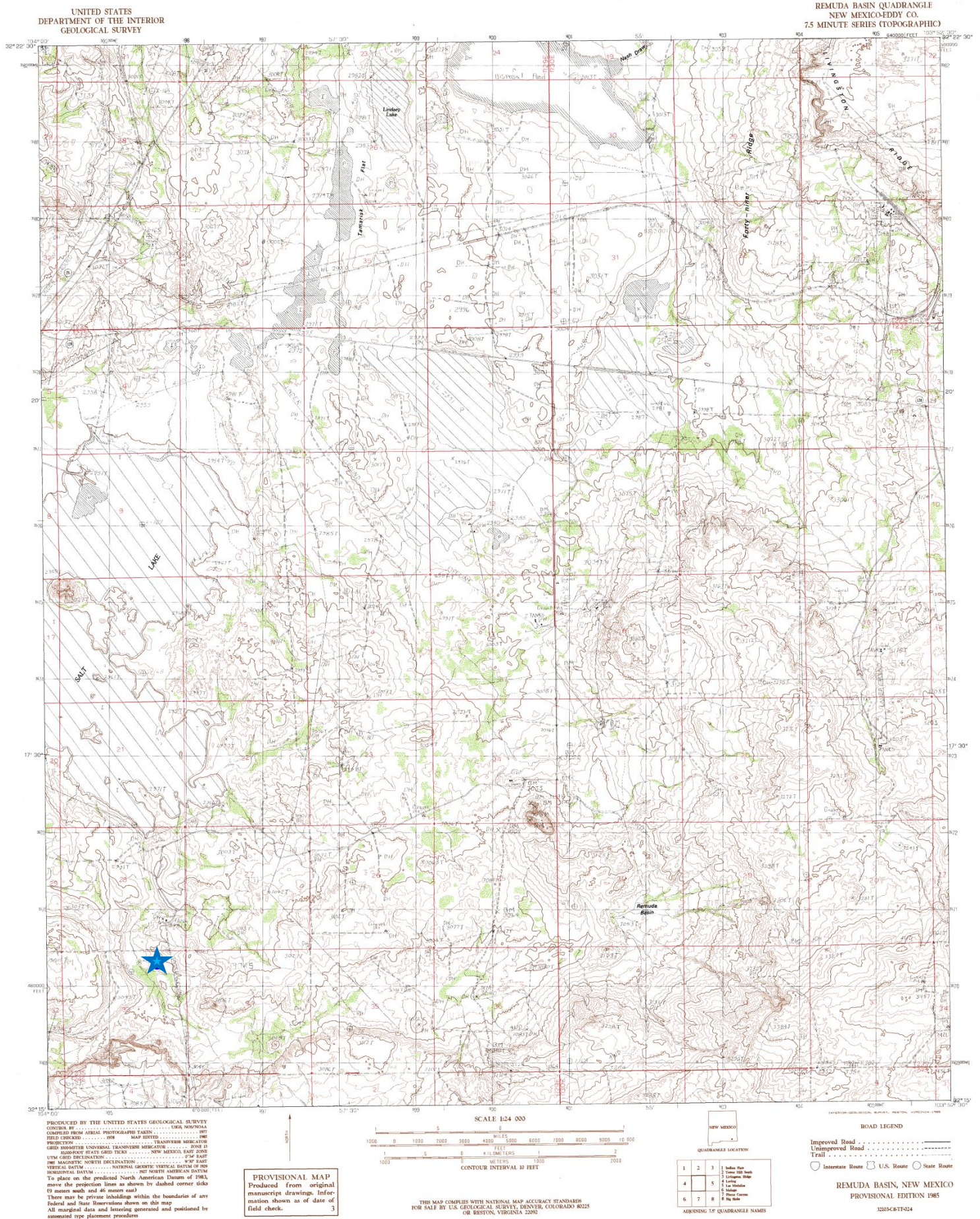

Oxy

Cypress 33 Federal #6H



Laboratory Analytical Results Summary
Cypress 33 Fed #6H (11-6-14)

		Sample	SP1 @ 1'	SP1 @ 2'
Analyte	Method	Date	3/5/15	3/5/15
			mg/Kg	mg/Kg
Benzene	BTEX 8021B		<0.050	<0.050
Toluene	BTEX 8021B		<0.050	<0.050
Ethylbenzene	BTEX 8021B		<0.050	<0.050
Total Xylenes	BTEX 8021B		<0.150	<0.150
Total BTEX	BTEX 8021B		<0.300	<0.300
Chloride	SM4500Cl-B		240	<16.0
GRO	TPH 8015M		<10.0	<10.0
DRO	TPH 8015M		<10.0	<10.0

		Sample	SP2 @ 1'	SP2 @ 2'	SP2 @ 3'
Analyte	Method	Date	3/5/15	3/5/15	3/5/15
			mg/Kg	mg/Kg	mg/Kg
Benzene	BTEX 8021B		<0.050	<0.050	<0.050
Toluene	BTEX 8021B		<0.050	<0.050	<0.050
Ethylbenzene	BTEX 8021B		<0.050	<0.050	<0.050
Total Xylenes	BTEX 8021B		0.249	<0.150	<0.150
Total BTEX	BTEX 8021B		<0.300	<0.300	<0.300
Chloride	SM4500Cl-B		1630	256	<16.0
GRO	TPH 8015M		10.8	<10.0	<10.0
DRO	TPH 8015M		431	<10.0	<10.0

		Sample	SP3 @ 1'	SP3 @ 2'	SP3 @ 3'
Analyte	Method	Date	3/5/15	3/5/15	3/5/15
			mg/Kg	mg/Kg	mg/Kg
Benzene	BTEX 8021B		<0.050	<0.050	<0.050
Toluene	BTEX 8021B		0.077	<0.050	<0.050
Ethylbenzene	BTEX 8021B		0.087	<0.050	<0.050
Total Xylenes	BTEX 8021B		1.23	<0.150	<0.150
Total BTEX	BTEX 8021B		1.4	<0.300	<0.300
Chloride	SM4500Cl-B		2840	272	64
GRO	TPH 8015M		32.6	<10.0	<10.0
DRO	TPH 8015M		2090	272	<10.0

		Sample	SP4 @ 1'	SP4 @ 2'	SP2 @ 3'
Analyte	Method	Date	3/5/15	3/5/15	3/5/15
			mg/Kg	mg/Kg	mg/Kg
Benzene	BTEX 8021B		<0.050	<0.050	<0.050
Toluene	BTEX 8021B		<0.050	<0.050	<0.050
Ethylbenzene	BTEX 8021B		<0.050	<0.050	<0.050
Total Xylenes	BTEX 8021B		<0.150	<0.150	<0.150
Total BTEX	BTEX 8021B		<0.300	<0.300	<0.300
Chloride	SM4500Cl-B		6320	208	64
GRO	TPH 8015M		11	<10.0	<10.0
DRO	TPH 8015M		372	<10.0	<10.0

Laboratory Analytical Results Summary
Cypress 33 Federal #6H

Confirmation		Sample	Composite 1
Analyte	Method	Date	4/27/15
			mg/Kg
Chloride	SM4500Cl-B		96

March 11, 2015

Cliff Brunson

BBC International, Inc.

P.O. Box 805

Hobbs, NM 88241

RE: CYPRESS 33 FEDERAL #6H

Enclosed are the results of analyses for samples received by the laboratory on 03/06/15 10:20.

Cardinal Laboratories is accredited through Texas NELAP under certificate number T104704398-13-5. Accreditation applies to drinking water, non-potable water and solid and chemical materials. All accredited analytes are denoted by an asterisk (*). For a complete list of accredited analytes and matrices visit the TCEQ website at www.tceq.texas.gov/field/qa/lab_accred_certif.html.

Cardinal Laboratories is accredited through the State of Colorado Department of Public Health and Environment for:

Method EPA 552.2	Haloacetic Acids (HAA-5)
Method EPA 524.2	Total Trihalomethanes (TTHM)
Method EPA 524.4	Regulated VOCs (V1, V2, V3)

Accreditation applies to public drinking water matrices.

This report meets NELAP requirements and is made up of a cover page, analytical results, and a copy of the original chain-of-custody. If you have any questions concerning this report, please feel free to contact me.

Sincerely,



Celey D. Keene

Lab Director/Quality Manager

Analytical Results For:

BBC International, Inc.
Cliff Brunson
P.O. Box 805
Hobbs NM, 88241
Fax To: (575) 397-0397

Received:	03/06/2015	Sampling Date:	03/04/2015
Reported:	03/11/2015	Sampling Type:	Soil
Project Name:	CYPRESS 33 FEDERAL #6H	Sampling Condition:	Cool & Intact
Project Number:	OXY	Sample Received By:	Jodi Henson
Project Location:	RAWHIDE RD		

Sample ID: SP 1 @ 1' (H500624-01)

BTX 8021B		mg/kg		Analyzed By: ms					
Analyte	Result	Reporting Limit	Analyzed	Method Blank	BS	% Recovery	True Value QC	RPD	Qualifier
Benzene*	<0.050	0.050	03/10/2015	ND	2.06	103	2.00	5.50	
Toluene*	<0.050	0.050	03/10/2015	ND	1.86	93.2	2.00	5.62	
Ethylbenzene*	<0.050	0.050	03/10/2015	ND	2.18	109	2.00	5.78	
Total Xylenes*	<0.150	0.150	03/10/2015	ND	6.03	100	6.00	5.94	
Total BTX	<0.300	0.300	03/10/2015	ND					

Surrogate: 4-Bromofluorobenzene (PID) 116 % 61-154

Chloride, SM4500Cl-B		mg/kg		Analyzed By: AP					
Analyte	Result	Reporting Limit	Analyzed	Method Blank	BS	% Recovery	True Value QC	RPD	Qualifier
Chloride	240	16.0	03/09/2015	ND	400	100	400	3.92	

TPH 8015M		mg/kg		Analyzed By: MS					
Analyte	Result	Reporting Limit	Analyzed	Method Blank	BS	% Recovery	True Value QC	RPD	Qualifier
GRO C6-C10	<10.0	10.0	03/09/2015	ND	209	104	200	4.63	
DRO >C10-C28	<10.0	10.0	03/09/2015	ND	220	110	200	4.65	

Surrogate: 1-Chlorooctane 83.1 % 47.2-157

Surrogate: 1-Chlorooctadecane 91.9 % 52.1-176

Cardinal Laboratories

*=Accredited Analyte

PLEASE NOTE: Liability and Damages. Cardinal's liability and client's exclusive remedy for any claim arising, whether based in contract or tort, shall be limited to the amount paid by client for analyses. All claims, including those for negligence and any other cause whatsoever shall be deemed waived unless made in writing and received by Cardinal within thirty (30) days after completion of the applicable service. In no event shall Cardinal be liable for incidental or consequential damages, including, without limitation, business interruptions, loss of use, or loss of profits incurred by client, its subsidiaries, affiliates or successors arising out of or related to the performance of the services hereunder by Cardinal, regardless of whether such claim is based upon any of the above stated reasons or otherwise. Results relate only to the samples identified above. This report shall not be reproduced except in full with written approval of Cardinal Laboratories.



Celey D. Keene, Lab Director/Quality Manager

Analytical Results For:

BBC International, Inc.
Cliff Brunson
P.O. Box 805
Hobbs NM, 88241
Fax To: (575) 397-0397

Received:	03/06/2015	Sampling Date:	03/04/2015
Reported:	03/11/2015	Sampling Type:	Soil
Project Name:	CYPRESS 33 FEDERAL #6H	Sampling Condition:	Cool & Intact
Project Number:	OXY	Sample Received By:	Jodi Henson
Project Location:	RAWHIDE RD		

Sample ID: SP 1 @ 2' (H500624-02)

BTEx 8021B		mg/kg		Analyzed By: ms					
Analyte	Result	Reporting Limit	Analyzed	Method Blank	BS	% Recovery	True Value QC	RPD	Qualifier
Benzene*	<0.050	0.050	03/10/2015	ND	2.06	103	2.00	5.50	
Toluene*	<0.050	0.050	03/10/2015	ND	1.86	93.2	2.00	5.62	
Ethylbenzene*	<0.050	0.050	03/10/2015	ND	2.18	109	2.00	5.78	
Total Xylenes*	<0.150	0.150	03/10/2015	ND	6.03	100	6.00	5.94	
Total BTEx	<0.300	0.300	03/10/2015	ND					

Surrogate: 4-Bromofluorobenzene (PID) 116 % 61-154

Chloride, SM4500CI-B		mg/kg		Analyzed By: AP						
Analyte	Result	Reporting Limit	Analyzed	Method Blank	BS	% Recovery	True Value QC	RPD	Qualifier	
Chloride	<16.0	16.0	03/09/2015	ND	400	100	400	3.92		

TPH 8015M		mg/kg		Analyzed By: MS					
Analyte	Result	Reporting Limit	Analyzed	Method Blank	BS	% Recovery	True Value QC	RPD	Qualifier
GRO C6-C10	<10.0	10.0	03/09/2015	ND	209	104	200	4.63	
DRO >C10-C28	<10.0	10.0	03/09/2015	ND	220	110	200	4.65	

Surrogate: 1-Chlorooctane 85.3 % 47.2-157

Surrogate: 1-Chlorooctadecane 91.9 % 52.1-176

Cardinal Laboratories

*=Accredited Analyte

PLEASE NOTE: Liability and Damages. Cardinal's liability and client's exclusive remedy for any claim arising, whether based in contract or tort, shall be limited to the amount paid by client for analyses. All claims, including those for negligence and any other cause whatsoever shall be deemed waived unless made in writing and received by Cardinal within thirty (30) days after completion of the applicable service. In no event shall Cardinal be liable for incidental or consequential damages, including, without limitation, business interruptions, loss of use, or loss of profits incurred by client, its subsidiaries, affiliates or successors arising out of or related to the performance of the services hereunder by Cardinal, regardless of whether such claim is based upon any of the above stated reasons or otherwise. Results relate only to the samples identified above. This report shall not be reproduced except in full with written approval of Cardinal Laboratories.



Celey D. Keene, Lab Director/Quality Manager

Analytical Results For:

BBC International, Inc.
Cliff Brunson
P.O. Box 805
Hobbs NM, 88241
Fax To: (575) 397-0397

Received:	03/06/2015	Sampling Date:	03/04/2015
Reported:	03/11/2015	Sampling Type:	Soil
Project Name:	CYPRESS 33 FEDERAL #6H	Sampling Condition:	Cool & Intact
Project Number:	OXY	Sample Received By:	Jodi Henson
Project Location:	RAWHIDE RD		

Sample ID: SP 2 @ 1' (H500624-03)

BTX 8021B		mg/kg		Analyzed By: ms					
Analyte	Result	Reporting Limit	Analyzed	Method Blank	BS	% Recovery	True Value QC	RPD	Qualifier
Benzene*	<0.050	0.050	03/10/2015	ND	2.06	103	2.00	5.50	
Toluene*	<0.050	0.050	03/10/2015	ND	1.86	93.2	2.00	5.62	
Ethylbenzene*	<0.050	0.050	03/10/2015	ND	2.18	109	2.00	5.78	
Total Xylenes*	0.249	0.150	03/10/2015	ND	6.03	100	6.00	5.94	
Total BTX	<0.300	0.300	03/10/2015	ND					

Surrogate: 4-Bromofluorobenzene (PID) 124 % 61-154

Chloride, SM4500CI-B		mg/kg		Analyzed By: AP						
Analyte	Result	Reporting Limit	Analyzed	Method Blank	BS	% Recovery	True Value QC	RPD	Qualifier	
Chloride	1630	16.0	03/09/2015	ND	400	100	400	3.92		

TPH 8015M		mg/kg		Analyzed By: MS					
Analyte	Result	Reporting Limit	Analyzed	Method Blank	BS	% Recovery	True Value QC	RPD	Qualifier
GRO C6-C10	10.8	10.0	03/09/2015	ND	209	104	200	4.63	
DRO >C10-C28	431	10.0	03/09/2015	ND	220	110	200	4.65	

Surrogate: 1-Chlorooctane 95.1 % 47.2-157

Surrogate: 1-Chlorooctadecane 102 % 52.1-176

Cardinal Laboratories

*=Accredited Analyte

PLEASE NOTE: Liability and Damages. Cardinal's liability and client's exclusive remedy for any claim arising, whether based in contract or tort, shall be limited to the amount paid by client for analyses. All claims, including those for negligence and any other cause whatsoever shall be deemed waived unless made in writing and received by Cardinal within thirty (30) days after completion of the applicable service. In no event shall Cardinal be liable for incidental or consequential damages, including, without limitation, business interruptions, loss of use, or loss of profits incurred by client, its subsidiaries, affiliates or successors arising out of or related to the performance of the services hereunder by Cardinal, regardless of whether such claim is based upon any of the above stated reasons or otherwise. Results relate only to the samples identified above. This report shall not be reproduced except in full with written approval of Cardinal Laboratories.



Celey D. Keene, Lab Director/Quality Manager

Analytical Results For:

BBC International, Inc.
Cliff Brunson
P.O. Box 805
Hobbs NM, 88241
Fax To: (575) 397-0397

Received:	03/06/2015	Sampling Date:	03/04/2015
Reported:	03/11/2015	Sampling Type:	Soil
Project Name:	CYPRESS 33 FEDERAL #6H	Sampling Condition:	Cool & Intact
Project Number:	OXY	Sample Received By:	Jodi Henson
Project Location:	RAWHIDE RD		

Sample ID: SP 2 @ 2' (H500624-04)

BTX 8021B		mg/kg		Analyzed By: ms					
Analyte	Result	Reporting Limit	Analyzed	Method Blank	BS	% Recovery	True Value QC	RPD	Qualifier
Benzene*	<0.050	0.050	03/10/2015	ND	2.06	103	2.00	5.50	
Toluene*	<0.050	0.050	03/10/2015	ND	1.86	93.2	2.00	5.62	
Ethylbenzene*	<0.050	0.050	03/10/2015	ND	2.18	109	2.00	5.78	
Total Xylenes*	<0.150	0.150	03/10/2015	ND	6.03	100	6.00	5.94	
Total BTX	<0.300	0.300	03/10/2015	ND					

Surrogate: 4-Bromofluorobenzene (PID) 114 % 61-154

Chloride, SM4500CI-B		mg/kg		Analyzed By: AP					
Analyte	Result	Reporting Limit	Analyzed	Method Blank	BS	% Recovery	True Value QC	RPD	Qualifier
Chloride	256	16.0	03/09/2015	ND	400	100	400	3.92	

TPH 8015M		mg/kg		Analyzed By: MS					
Analyte	Result	Reporting Limit	Analyzed	Method Blank	BS	% Recovery	True Value QC	RPD	Qualifier
GRO C6-C10	<10.0	10.0	03/09/2015	ND	209	104	200	4.63	
DRO >C10-C28	<10.0	10.0	03/09/2015	ND	220	110	200	4.65	

Surrogate: 1-Chlorooctane 91.0 % 47.2-157

Surrogate: 1-Chlorooctadecane 96.8 % 52.1-176

Cardinal Laboratories

*=Accredited Analyte

PLEASE NOTE: Liability and Damages. Cardinal's liability and client's exclusive remedy for any claim arising, whether based in contract or tort, shall be limited to the amount paid by client for analyses. All claims, including those for negligence and any other cause whatsoever shall be deemed waived unless made in writing and received by Cardinal within thirty (30) days after completion of the applicable service. In no event shall Cardinal be liable for incidental or consequential damages, including, without limitation, business interruptions, loss of use, or loss of profits incurred by client, its subsidiaries, affiliates or successors arising out of or related to the performance of the services hereunder by Cardinal, regardless of whether such claim is based upon any of the above stated reasons or otherwise. Results relate only to the samples identified above. This report shall not be reproduced except in full with written approval of Cardinal Laboratories.



Celey D. Keene, Lab Director/Quality Manager

Analytical Results For:

BBC International, Inc.
Cliff Brunson
P.O. Box 805
Hobbs NM, 88241
Fax To: (575) 397-0397

Received:	03/06/2015	Sampling Date:	03/04/2015
Reported:	03/11/2015	Sampling Type:	Soil
Project Name:	CYPRESS 33 FEDERAL #6H	Sampling Condition:	Cool & Intact
Project Number:	OXY	Sample Received By:	Jodi Henson
Project Location:	RAWHIDE RD		

Sample ID: SP 2 @ 3' (H500624-05)

BTX 8021B		mg/kg		Analyzed By: ms						
Analyte	Result	Reporting Limit	Analyzed	Method Blank	BS	% Recovery	True Value QC	RPD	Qualifier	
Benzene*	<0.050	0.050	03/10/2015	ND	2.06	103	2.00	5.50		
Toluene*	<0.050	0.050	03/10/2015	ND	1.86	93.2	2.00	5.62		
Ethylbenzene*	<0.050	0.050	03/10/2015	ND	2.18	109	2.00	5.78		
Total Xylenes*	<0.150	0.150	03/10/2015	ND	6.03	100	6.00	5.94		
Total BTX	<0.300	0.300	03/10/2015	ND						

Surrogate: 4-Bromofluorobenzene (PID) 114 % 61-154

Chloride, SM4500CI-B		mg/kg		Analyzed By: AP						
Analyte	Result	Reporting Limit	Analyzed	Method Blank	BS	% Recovery	True Value QC	RPD	Qualifier	
Chloride	<16.0	16.0	03/09/2015	ND	416	104	400	3.77		

TPH 8015M		mg/kg		Analyzed By: MS						
Analyte	Result	Reporting Limit	Analyzed	Method Blank	BS	% Recovery	True Value QC	RPD	Qualifier	
GRO C6-C10	<10.0	10.0	03/09/2015	ND	209	104	200	4.63		
DRO >C10-C28	<10.0	10.0	03/09/2015	ND	220	110	200	4.65		

Surrogate: 1-Chlorooctane 91.4 % 47.2-157

Surrogate: 1-Chlorooctadecane 93.6 % 52.1-176

Cardinal Laboratories

*=Accredited Analyte

PLEASE NOTE: Liability and Damages. Cardinal's liability and client's exclusive remedy for any claim arising, whether based in contract or tort, shall be limited to the amount paid by client for analyses. All claims, including those for negligence and any other cause whatsoever shall be deemed waived unless made in writing and received by Cardinal within thirty (30) days after completion of the applicable service. In no event shall Cardinal be liable for incidental or consequential damages, including, without limitation, business interruptions, loss of use, or loss of profits incurred by client, its subsidiaries, affiliates or successors arising out of or related to the performance of the services hereunder by Cardinal, regardless of whether such claim is based upon any of the above stated reasons or otherwise. Results relate only to the samples identified above. This report shall not be reproduced except in full with written approval of Cardinal Laboratories.



Celey D. Keene, Lab Director/Quality Manager

Analytical Results For:

BBC International, Inc.
Cliff Brunson
P.O. Box 805
Hobbs NM, 88241
Fax To: (575) 397-0397

Received: 03/06/2015
Reported: 03/11/2015
Project Name: CYPRESS 33 FEDERAL #6H
Project Number: OXY
Project Location: RAWHIDE RD

Sampling Date: 03/04/2015
Sampling Type: Soil
Sampling Condition: Cool & Intact
Sample Received By: Jodi Henson

Sample ID: SP 3 @ 1' (H500624-06)

BTX 8021B		mg/kg		Analyzed By: ms					
Analyte	Result	Reporting Limit	Analyzed	Method Blank	BS	% Recovery	True Value QC	RPD	Qualifier
Benzene*	<0.050	0.050	03/10/2015	ND	2.06	103	2.00	5.50	
Toluene*	0.077	0.050	03/10/2015	ND	1.86	93.2	2.00	5.62	
Ethylbenzene*	0.087	0.050	03/10/2015	ND	2.18	109	2.00	5.78	
Total Xylenes*	1.23	0.150	03/10/2015	ND	6.03	100	6.00	5.94	
Total BTX	1.40	0.300	03/10/2015	ND					

Surrogate: 4-Bromofluorobenzene (PID) 152 % 61-154

Chloride, SM4500CI-B		mg/kg		Analyzed By: AP					
Analyte	Result	Reporting Limit	Analyzed	Method Blank	BS	% Recovery	True Value QC	RPD	Qualifier
Chloride	2840	16.0	03/09/2015	ND	416	104	400	3.77	

TPH 8015M		mg/kg		Analyzed By: MS					
Analyte	Result	Reporting Limit	Analyzed	Method Blank	BS	% Recovery	True Value QC	RPD	Qualifier
GRO C6-C10	32.6	10.0	03/09/2015	ND	209	104	200	4.63	
DRO >C10-C28	2090	10.0	03/09/2015	ND	220	110	200	4.65	

Surrogate: 1-Chlorooctane 102 % 47.2-157

Surrogate: 1-Chlorooctadecane 120 % 52.1-176

Cardinal Laboratories

*=Accredited Analyte

PLEASE NOTE: Liability and Damages. Cardinal's liability and client's exclusive remedy for any claim arising, whether based in contract or tort, shall be limited to the amount paid by client for analyses. All claims, including those for negligence and any other cause whatsoever shall be deemed waived unless made in writing and received by Cardinal within thirty (30) days after completion of the applicable service. In no event shall Cardinal be liable for incidental or consequential damages, including, without limitation, business interruptions, loss of use, or loss of profits incurred by client, its subsidiaries, affiliates or successors arising out of or related to the performance of the services hereunder by Cardinal, regardless of whether such claim is based upon any of the above stated reasons or otherwise. Results relate only to the samples identified above. This report shall not be reproduced except in full with written approval of Cardinal Laboratories.



Celey D. Keene, Lab Director/Quality Manager

Analytical Results For:

BBC International, Inc.
Cliff Brunson
P.O. Box 805
Hobbs NM, 88241
Fax To: (575) 397-0397

Received:	03/06/2015	Sampling Date:	03/04/2015
Reported:	03/11/2015	Sampling Type:	Soil
Project Name:	CYPRESS 33 FEDERAL #6H	Sampling Condition:	Cool & Intact
Project Number:	OXY	Sample Received By:	Jodi Henson
Project Location:	RAWHIDE RD		

Sample ID: SP 3 @ 2' (H500624-07)

BTX 8021B		mg/kg		Analyzed By: ms					
Analyte	Result	Reporting Limit	Analyzed	Method Blank	BS	% Recovery	True Value QC	RPD	Qualifier
Benzene*	<0.050	0.050	03/10/2015	ND	2.06	103	2.00	5.50	
Toluene*	<0.050	0.050	03/10/2015	ND	1.86	93.2	2.00	5.62	
Ethylbenzene*	<0.050	0.050	03/10/2015	ND	2.18	109	2.00	5.78	
Total Xylenes*	<0.150	0.150	03/10/2015	ND	6.03	100	6.00	5.94	
Total BTX	<0.300	0.300	03/10/2015	ND					

Surrogate: 4-Bromofluorobenzene (PID) 118 % 61-154

Chloride, SM4500CI-B		mg/kg		Analyzed By: AP					
Analyte	Result	Reporting Limit	Analyzed	Method Blank	BS	% Recovery	True Value QC	RPD	Qualifier
Chloride	272	16.0	03/09/2015	ND	416	104	400	3.77	

TPH 8015M		mg/kg		Analyzed By: MS					
Analyte	Result	Reporting Limit	Analyzed	Method Blank	BS	% Recovery	True Value QC	RPD	Qualifier
GRO C6-C10	<10.0	10.0	03/09/2015	ND	209	104	200	4.63	
DRO >C10-C28	272	10.0	03/09/2015	ND	220	110	200	4.65	

Surrogate: 1-Chlorooctane 95.0 % 47.2-157

Surrogate: 1-Chlorooctadecane 103 % 52.1-176

Cardinal Laboratories

*=Accredited Analyte

PLEASE NOTE: Liability and Damages. Cardinal's liability and client's exclusive remedy for any claim arising, whether based in contract or tort, shall be limited to the amount paid by client for analyses. All claims, including those for negligence and any other cause whatsoever shall be deemed waived unless made in writing and received by Cardinal within thirty (30) days after completion of the applicable service. In no event shall Cardinal be liable for incidental or consequential damages, including, without limitation, business interruptions, loss of use, or loss of profits incurred by client, its subsidiaries, affiliates or successors arising out of or related to the performance of the services hereunder by Cardinal, regardless of whether such claim is based upon any of the above stated reasons or otherwise. Results relate only to the samples identified above. This report shall not be reproduced except in full with written approval of Cardinal Laboratories.



Celey D. Keene, Lab Director/Quality Manager

Analytical Results For:

BBC International, Inc.
Cliff Brunson
P.O. Box 805
Hobbs NM, 88241
Fax To: (575) 397-0397

Received:	03/06/2015	Sampling Date:	03/04/2015
Reported:	03/11/2015	Sampling Type:	Soil
Project Name:	CYPRESS 33 FEDERAL #6H	Sampling Condition:	Cool & Intact
Project Number:	OXY	Sample Received By:	Jodi Henson
Project Location:	RAWHIDE RD		

Sample ID: SP 3 @ 3' (H500624-08)

BTEx 8021B		mg/kg		Analyzed By: ms						
Analyte	Result	Reporting Limit	Analyzed	Method Blank	BS	% Recovery	True Value QC	RPD	Qualifier	
Benzene*	<0.050	0.050	03/10/2015	ND	2.07	103	2.00	4.02		
Toluene*	<0.050	0.050	03/10/2015	ND	1.91	95.7	2.00	2.62		
Ethylbenzene*	<0.050	0.050	03/10/2015	ND	2.18	109	2.00	4.58		
Total Xylenes*	<0.150	0.150	03/10/2015	ND	5.95	99.1	6.00	5.80		
Total BTEx	<0.300	0.300	03/10/2015	ND						

Surrogate: 4-Bromofluorobenzene (PID) 114 % 61-154

Chloride, SM4500CI-B		mg/kg		Analyzed By: AP					
Analyte	Result	Reporting Limit	Analyzed	Method Blank	BS	% Recovery	True Value QC	RPD	Qualifier
Chloride	64.0	16.0	03/09/2015	ND	416	104	400	3.77	

TPH 8015M		mg/kg		Analyzed By: MS					
Analyte	Result	Reporting Limit	Analyzed	Method Blank	BS	% Recovery	True Value QC	RPD	Qualifier
GRO C6-C10	<10.0	10.0	03/09/2015	ND	209	104	200	4.63	
DRO >C10-C28	<10.0	10.0	03/09/2015	ND	220	110	200	4.65	

Surrogate: 1-Chlorooctane 90.5 % 47.2-157

Surrogate: 1-Chlorooctadecane 99.7 % 52.1-176

Cardinal Laboratories

*=Accredited Analyte

PLEASE NOTE: Liability and Damages. Cardinal's liability and client's exclusive remedy for any claim arising, whether based in contract or tort, shall be limited to the amount paid by client for analyses. All claims, including those for negligence and any other cause whatsoever shall be deemed waived unless made in writing and received by Cardinal within thirty (30) days after completion of the applicable service. In no event shall Cardinal be liable for incidental or consequential damages, including, without limitation, business interruptions, loss of use, or loss of profits incurred by client, its subsidiaries, affiliates or successors arising out of or related to the performance of the services hereunder by Cardinal, regardless of whether such claim is based upon any of the above stated reasons or otherwise. Results relate only to the samples identified above. This report shall not be reproduced except in full with written approval of Cardinal Laboratories.



Celey D. Keene, Lab Director/Quality Manager

Analytical Results For:

BBC International, Inc.
Cliff Brunson
P.O. Box 805
Hobbs NM, 88241
Fax To: (575) 397-0397

Received:	03/06/2015	Sampling Date:	03/05/2015
Reported:	03/11/2015	Sampling Type:	Soil
Project Name:	CYPRESS 33 FEDERAL #6H	Sampling Condition:	Cool & Intact
Project Number:	OXY	Sample Received By:	Jodi Henson
Project Location:	RAWHIDE RD		

Sample ID: SP 4 @ 1' (H500624-09)

BTEx 8021B		mg/kg		Analyzed By: ms						
Analyte	Result	Reporting Limit	Analyzed	Method Blank	BS	% Recovery	True Value QC	RPD	Qualifier	
Benzene*	<0.050	0.050	03/10/2015	ND	2.07	103	2.00	4.02		
Toluene*	<0.050	0.050	03/10/2015	ND	1.91	95.7	2.00	2.62		
Ethylbenzene*	<0.050	0.050	03/10/2015	ND	2.18	109	2.00	4.58		
Total Xylenes*	<0.150	0.150	03/10/2015	ND	5.95	99.1	6.00	5.80		
Total BTEx	<0.300	0.300	03/10/2015	ND						

Surrogate: 4-Bromofluorobenzene (PID) 119 % 61-154

Chloride, SM4500CI-B		mg/kg		Analyzed By: AP					
Analyte	Result	Reporting Limit	Analyzed	Method Blank	BS	% Recovery	True Value QC	RPD	Qualifier
Chloride	6320	16.0	03/09/2015	ND	416	104	400	3.77	

TPH 8015M		mg/kg		Analyzed By: MS					
Analyte	Result	Reporting Limit	Analyzed	Method Blank	BS	% Recovery	True Value QC	RPD	Qualifier
GRO C6-C10	11.0	10.0	03/09/2015	ND	209	104	200	4.63	
DRO >C10-C28	372	10.0	03/09/2015	ND	220	110	200	4.65	

Surrogate: 1-Chlorooctane 90.6 % 47.2-157

Surrogate: 1-Chlorooctadecane 88.2 % 52.1-176

Cardinal Laboratories

*=Accredited Analyte

PLEASE NOTE: Liability and Damages. Cardinal's liability and client's exclusive remedy for any claim arising, whether based in contract or tort, shall be limited to the amount paid by client for analyses. All claims, including those for negligence and any other cause whatsoever shall be deemed waived unless made in writing and received by Cardinal within thirty (30) days after completion of the applicable service. In no event shall Cardinal be liable for incidental or consequential damages, including, without limitation, business interruptions, loss of use, or loss of profits incurred by client, its subsidiaries, affiliates or successors arising out of or related to the performance of the services hereunder by Cardinal, regardless of whether such claim is based upon any of the above stated reasons or otherwise. Results relate only to the samples identified above. This report shall not be reproduced except in full with written approval of Cardinal Laboratories.



Celey D. Keene, Lab Director/Quality Manager

Analytical Results For:

BBC International, Inc.
Cliff Brunson
P.O. Box 805
Hobbs NM, 88241
Fax To: (575) 397-0397

Received:	03/06/2015	Sampling Date:	03/05/2015
Reported:	03/11/2015	Sampling Type:	Soil
Project Name:	CYPRESS 33 FEDERAL #6H	Sampling Condition:	Cool & Intact
Project Number:	OXY	Sample Received By:	Jodi Henson
Project Location:	RAWHIDE RD		

Sample ID: SP 4 @ 2' (H500624-10)

BTEx 8021B		mg/kg		Analyzed By: ms						
Analyte	Result	Reporting Limit	Analyzed	Method Blank	BS	% Recovery	True Value QC	RPD	Qualifier	
Benzene*	<0.050	0.050	03/10/2015	ND	2.07	103	2.00	4.02		
Toluene*	<0.050	0.050	03/10/2015	ND	1.91	95.7	2.00	2.62		
Ethylbenzene*	<0.050	0.050	03/10/2015	ND	2.18	109	2.00	4.58		
Total Xylenes*	<0.150	0.150	03/10/2015	ND	5.95	99.1	6.00	5.80		
Total BTEx	<0.300	0.300	03/10/2015	ND						

Surrogate: 4-Bromofluorobenzene (PID) 116 % 61-154

Chloride, SM4500CI-B		mg/kg		Analyzed By: AP					
Analyte	Result	Reporting Limit	Analyzed	Method Blank	BS	% Recovery	True Value QC	RPD	Qualifier
Chloride	208	16.0	03/09/2015	ND	416	104	400	3.77	

TPH 8015M		mg/kg		Analyzed By: MS					
Analyte	Result	Reporting Limit	Analyzed	Method Blank	BS	% Recovery	True Value QC	RPD	Qualifier
GRO C6-C10	<10.0	10.0	03/09/2015	ND	209	104	200	4.63	
DRO >C10-C28	<10.0	10.0	03/09/2015	ND	220	110	200	4.65	

Surrogate: 1-Chlorooctane 84.3 % 47.2-157

Surrogate: 1-Chlorooctadecane 89.5 % 52.1-176

Cardinal Laboratories

*=Accredited Analyte

PLEASE NOTE: Liability and Damages. Cardinal's liability and client's exclusive remedy for any claim arising, whether based in contract or tort, shall be limited to the amount paid by client for analyses. All claims, including those for negligence and any other cause whatsoever shall be deemed waived unless made in writing and received by Cardinal within thirty (30) days after completion of the applicable service. In no event shall Cardinal be liable for incidental or consequential damages, including, without limitation, business interruptions, loss of use, or loss of profits incurred by client, its subsidiaries, affiliates or successors arising out of or related to the performance of the services hereunder by Cardinal, regardless of whether such claim is based upon any of the above stated reasons or otherwise. Results relate only to the samples identified above. This report shall not be reproduced except in full with written approval of Cardinal Laboratories.



Celey D. Keene, Lab Director/Quality Manager

Analytical Results For:

BBC International, Inc.
Cliff Brunson
P.O. Box 805
Hobbs NM, 88241
Fax To: (575) 397-0397

Received:	03/06/2015	Sampling Date:	03/05/2015
Reported:	03/11/2015	Sampling Type:	Soil
Project Name:	CYPRESS 33 FEDERAL #6H	Sampling Condition:	Cool & Intact
Project Number:	OXY	Sample Received By:	Jodi Henson
Project Location:	RAWHIDE RD		

Sample ID: SP 4 @ 3' (H500624-11)

BTEx 8021B		mg/kg		Analyzed By: ms						
Analyte	Result	Reporting Limit	Analyzed	Method Blank	BS	% Recovery	True Value QC	RPD	Qualifier	
Benzene*	<0.050	0.050	03/10/2015	ND	2.07	103	2.00	4.02		
Toluene*	<0.050	0.050	03/10/2015	ND	1.91	95.7	2.00	2.62		
Ethylbenzene*	<0.050	0.050	03/10/2015	ND	2.18	109	2.00	4.58		
Total Xylenes*	<0.150	0.150	03/10/2015	ND	5.95	99.1	6.00	5.80		
Total BTEx	<0.300	0.300	03/10/2015	ND						

Surrogate: 4-Bromofluorobenzene (PID) 114 % 61-154

Chloride, SM4500CI-B		mg/kg		Analyzed By: AP						
Analyte	Result	Reporting Limit	Analyzed	Method Blank	BS	% Recovery	True Value QC	RPD	Qualifier	
Chloride	64.0	16.0	03/09/2015	ND	416	104	400	3.77		

TPH 8015M		mg/kg		Analyzed By: MS					
Analyte	Result	Reporting Limit	Analyzed	Method Blank	BS	% Recovery	True Value QC	RPD	Qualifier
GRO C6-C10	<10.0	10.0	03/09/2015	ND	209	104	200	4.63	
DRO >C10-C28	<10.0	10.0	03/09/2015	ND	220	110	200	4.65	

Surrogate: 1-Chlorooctane 83.2 % 47.2-157

Surrogate: 1-Chlorooctadecane 87.7 % 52.1-176

Cardinal Laboratories

*=Accredited Analyte

PLEASE NOTE: Liability and Damages. Cardinal's liability and client's exclusive remedy for any claim arising, whether based in contract or tort, shall be limited to the amount paid by client for analyses. All claims, including those for negligence and any other cause whatsoever shall be deemed waived unless made in writing and received by Cardinal within thirty (30) days after completion of the applicable service. In no event shall Cardinal be liable for incidental or consequential damages, including, without limitation, business interruptions, loss of use, or loss of profits incurred by client, its subsidiaries, affiliates or successors arising out of or related to the performance of the services hereunder by Cardinal, regardless of whether such claim is based upon any of the above stated reasons or otherwise. Results relate only to the samples identified above. This report shall not be reproduced except in full with written approval of Cardinal Laboratories.



Celey D. Keene, Lab Director/Quality Manager

Notes and Definitions

ND	Analyte NOT DETECTED at or above the reporting limit
RPD	Relative Percent Difference
**	Samples not received at proper temperature of 6°C or below.
***	Insufficient time to reach temperature.
-	Chloride by SM4500Cl-B does not require samples be received at or below 6°C Samples reported on an as received basis (wet) unless otherwise noted on report

Cardinal Laboratories

*=Accredited Analyte

PLEASE NOTE: Liability and Damages. Cardinal's liability and client's exclusive remedy for any claim arising, whether based in contract or tort, shall be limited to the amount paid by client for analyses. All claims, including those for negligence and any other cause whatsoever shall be deemed waived unless made in writing and received by Cardinal within thirty (30) days after completion of the applicable service. In no event shall Cardinal be liable for incidental or consequential damages, including, without limitation, business interruptions, loss of use, or loss of profits incurred by client, its subsidiaries, affiliates or successors arising out of or related to the performance of the services hereunder by Cardinal, regardless of whether such claim is based upon any of the above stated reasons or otherwise. Results relate only to the samples identified above. This report shall not be reproduced except in full with written approval of Cardinal Laboratories.



Celey D. Keene, Lab Director/Quality Manager



ARDINAL LABORATORIES

101 East Marland, Hobbs, NM 88240
(505) 393-2326 FAX (505) 393-2476

CHAIN-OF-CUSTODY AND ANALYSIS REQUEST

12

Company Name: BBC International, Inc.

Project Manager: Cliff Brunson

Address: P.O. Box 805

City: Hobbs

Phone #: 575-397-6388

Project #:

Project Name: Cypress 33

Project Location: Fairchild

Sampler Name: Cliff Brunson

P.O. #:

Company:

Attn:

Address:

City:

State:

Phone #:

Fax #:

BILL TO

ANALYSIS REQUEST

Lab I.D.	Sample I.D.	(G)RAB OR (C)OMP.	# CONTAINERS	GROUNDWATER	WASTEWATER	SOIL	OIL	SLUDGE	OTHER :	ACID/BASE:	ICE / COOL	OTHER :	DATE	TIME	BTEX	TPH	CL-
150064	SP101	G-1	1			X							3-4	1150	X	X	X
2	SP201	G-1	1			X							120	1219	X	X	X
3	SP202	G-1	1			X							138	1408	X	X	X
4	SP301	G-1	1			X							237	257	X	X	X
5	SP401	G-1	1			X							316	901	X	X	X
6	SP402	G-1	1			X							315	933	X	X	X
7																	
8																	
9																	
10																	

PLEASE NOTE: Liability and Damages: Cardinal's liability and client's exclusive remedy for any claim arising whether based in contract or tort, shall be limited to the amount paid by the client for the analyses. All claims, including those for negligence and any other cause whatsoever shall be deemed waived unless made in writing and received by Cardinal within 30 days after completion of the applicable service. In no event shall Cardinal be liable for incidental or consequential damages, including without limitation, business interruptions, loss of use, or loss of profits incurred by client, its subsidiaries, affiliates or successors arising out of or related to the performance of services hereunder by Cardinal, regardless of whether such claim is based upon any of the above stated reasons or otherwise.

Relinquished By:

Received By:

Phone Result:

Fax Result:

Add'l Phone #:

Add'l Fax #:

Relinquished By:

Received By:

Phone Result:

Fax Result:

Add'l Phone #:

Add'l Fax #:

Delivered By: (Circle One)

Sample Condition

CHECKED BY:

Sampler - UPS - Bus - Other:

Cool Intact

Yes No

† Cardinal cannot accept verbal changes. Please fax written changes to 505-393-2476



PHONE (575) 393-2326 ° 101 E. MARLAND ° HOBBS, NM 88240

April 28, 2015

Cliff Brunson

BBC International, Inc.

P.O. Box 805

Hobbs, NM 88241

RE: CYPRESS 33 FEDERAL #6H

Enclosed are the results of analyses for samples received by the laboratory on 04/28/15 8:00.

Cardinal Laboratories is accredited through Texas NELAP under certificate number T104704398-13-5. Accreditation applies to drinking water, non-potable water and solid and chemical materials. All accredited analytes are denoted by an asterisk (*). For a complete list of accredited analytes and matrices visit the TCEQ website at www.tceq.texas.gov/field/qa/lab_accred_certif.html.

Cardinal Laboratories is accredited through the State of Colorado Department of Public Health and Environment for:

Method EPA 552.2	Haloacetic Acids (HAA-5)
Method EPA 524.2	Total Trihalomethanes (TTHM)
Method EPA 524.4	Regulated VOCs (V1, V2, V3)

Accreditation applies to public drinking water matrices.

This report meets NELAP requirements and is made up of a cover page, analytical results, and a copy of the original chain-of-custody. If you have any questions concerning this report, please feel free to contact me.

Sincerely,

A handwritten signature in black ink that reads "Celey D. Keene". The signature is written in a cursive, flowing style.

Celey D. Keene

Lab Director/Quality Manager

Analytical Results For:

BBC International, Inc.
Cliff Brunson
P.O. Box 805
Hobbs NM, 88241
Fax To: (575) 397-0397

Received:	04/28/2015	Sampling Date:	04/27/2015
Reported:	04/28/2015	Sampling Type:	Soil
Project Name:	CYPRESS 33 FEDERAL #6H	Sampling Condition:	** (See Notes)
Project Number:	OXY	Sample Received By:	Jodi Henson
Project Location:	RAWHIDE RD		

Sample ID: COMPOSITE 1 (H501096-01)**Chloride, SM4500Cl-B****mg/kg****Analyzed By: AP**

Analyte	Result	Reporting Limit	Analyzed	Method Blank	BS	% Recovery	True Value QC	RPD	Qualifier
Chloride	96.0	16.0	04/28/2015	ND	416	104	400	3.77	

Cardinal Laboratories

*=Accredited Analyte

PLEASE NOTE: Liability and Damages. Cardinal's liability and client's exclusive remedy for any claim arising, whether based in contract or tort, shall be limited to the amount paid by client for analyses. All claims, including those for negligence and any other cause whatsoever shall be deemed waived unless made in writing and received by Cardinal within thirty (30) days after completion of the applicable service. In no event shall Cardinal be liable for incidental or consequential damages, including, without limitation, business interruptions, loss of use, or loss of profits incurred by client, its subsidiaries, affiliates or successors arising out of or related to the performance of the services hereunder by Cardinal, regardless of whether such claim is based upon any of the above stated reasons or otherwise. Results relate only to the samples identified above. This report shall not be reproduced except in full with written approval of Cardinal Laboratories.



Celey D. Keene, Lab Director/Quality Manager

Notes and Definitions

ND	Analyte NOT DETECTED at or above the reporting limit
RPD	Relative Percent Difference
**	Samples not received at proper temperature of 6°C or below.
***	Insufficient time to reach temperature.
-	Chloride by SM4500Cl-B does not require samples be received at or below 6°C Samples reported on an as received basis (wet) unless otherwise noted on report

Cardinal Laboratories

*=Accredited Analyte

PLEASE NOTE: Liability and Damages. Cardinal's liability and client's exclusive remedy for any claim arising, whether based in contract or tort, shall be limited to the amount paid by client for analyses. All claims, including those for negligence and any other cause whatsoever shall be deemed waived unless made in writing and received by Cardinal within thirty (30) days after completion of the applicable service. In no event shall Cardinal be liable for incidental or consequential damages, including, without limitation, business interruptions, loss of use, or loss of profits incurred by client, its subsidiaries, affiliates or successors arising out of or related to the performance of the services hereunder by Cardinal, regardless of whether such claim is based upon any of the above stated reasons or otherwise. Results relate only to the samples identified above. This report shall not be reproduced except in full with written approval of Cardinal Laboratories.



Celey D. Keene, Lab Director/Quality Manager

Kathy Purvis

From: Hughes, Solomon <shughes@blm.gov>
Sent: Monday, April 13, 2015 11:38 AM
To: Cliff Brunson
Cc: Chris Jones; Ken Swinney; Jennifer Gilkey; Kathy Purvis
Subject: Re: FW: OXY-Cypress 33 Federal #6H - Remediation Plan

Mr. Brunson,

This plan is approved as written with the following conditions:

- After the excavation is complete, collect a final sample from SP2, SP3, and SP4 and combine these to make a composite confirmation sample. If this composite sample shows <1000ppm chlorides, you are free to backfill.

This plan still needs to be approved by NMOCD. BLM approval of this proposal does not relieve the operator of liability, should their operations fail to adequately investigate and remediate contamination that may pose a threat to groundwater, surface water, any other aspects of the natural environment, human health, or if the location does not properly reclaim. In such an event that location does not re-vegetate, or future issues with contaminants are encountered, the operator will be asked to address the location until contaminant issues are fully mitigated and the location is successfully reclaimed. In addition, BLM approval does not relieve the operator of responsibility for compliance with any other federal, state, or local laws/regulations.

Bests,

Sol

Sol Hughes

Environmental Protection Division
Bureau of Land Management
620 E. Greene St
Carlsbad, NM

Office: 575.234.5951
Cell: 575.499.3378

On Thu, Apr 9, 2015 at 6:53 PM, Cliff Brunson <cbrunson@bbcinternational.com> wrote:

Sol,

This e-mail is to request the BLM's approval for the following remediation plan for the above referenced site. I have attached the materials that pertain to the site and the plan. This plan has already been approved by Mike Bratcher of the NMOCD. His email follows this message.

If you will review the diagram on the attachment, it depicts the remediation plan and the areas and depths of the excavations. After the soil is excavated, the site will be backfilled with clean soil.

If you would please e-mail your concurrence with this remediation plan, it would be greatly appreciated.

Thanks, Cliff

Cliff P. Brunson, CEI, CRS

President

BBC International, Inc.

World-Wide Environmental Specialists

Mailing Address:

P. O. Box 805

Hobbs, NM 88241-0805 USA

Shipping Address:

1324 W. Marland St.

Hobbs, NM 88240 USA

Phone: (575) 397-6388

Fax: (575) 397-0397

E-Mail: cbrunson@bbcinternational.com

Confidentiality Notice: This electronic transmission (and any attached documents) is intended only for the person(s) to whom it is addressed and may contain information that is privileged, confidential, or otherwise protected from disclosure. If you have received this transmission in error, please immediately notify the sender by e-mail or by telephone call to (575) 397-6388 for handling instructions. Any disclosure or distribution of the contents of this transmission by anyone other than the named recipient(s) is strictly prohibited.

From: Bratcher, Mike, EMNRD [mailto:mike.bratcher@state.nm.us]
Sent: Thursday, April 9, 2015 9:35 AM
To: Cliff Brunson
Subject: RE: OXY-Cypress 33 Federal #6H - Remediation Plan

RE: OXY USA * Cypress 33 Fed Com 5H * 30-015-41557 * A-33-23s-29e * Eddy County, NM

NMOCD Tracking Number: **2RP-2603** * Date of release: 11/6/14

Cliff,

Your proposal for remediation of the above referenced release is approved. Federal sites will require like approval from BLM. Please notify the District 2 office once remedial operations have been scheduled. It is OCD's understanding that once mobilized to site, the 4/28/14 release (**2RP-2273**) will be addressed concurrent with this release.

OCD approval does not relieve the operator of liability should their operations fail to adequately investigate and remediate contamination that may pose a threat to ground water, surface water, human health or the environment. In addition, OCD approval does not relieve the operator of responsibility for compliance with any other federal, state, local laws and/or regulations.

If you have any questions or concerns, and for notification, please contact me or Heather Patterson.
Heather.Patterson@state.nm.us

Mike Bratcher

NMOCD District 2

811 S. First Street

Artesia, NM 88210

O: 575-748-1283 X108

C: 575-626-0857

F: 575-748-9720

From: Cliff Brunson [<mailto:cbrunson@bbcinternational.com>]
Sent: Wednesday, April 08, 2015 7:04 PM
To: Bratcher, Mike, EMNRD
Subject: OXY-Cypress 33 Federal #6H - Remediation Plan

Mike,

Please find attached the remediation plan that we discussed this afternoon. Please review and let me know if this meets with your approval. The first page is the site diagram and I have marked the areas of excavation and back dragging. The data summary table, lab data, and initial C-141 follow the diagram.

Give me a call and let me know if you have any questions.

Thanks, Cliff

Cliff P. Brunson, CEI, CRS

President

BBC International, Inc.

World-Wide Environmental Specialists

Mailing Address:

P. O. Box 805

Hobbs, NM 88241-0805 USA

Shipping Address:

1324 W. Marland St.

Hobbs, NM 88240 USA

Phone: (575) 397-6388

Fax: (575) 397-0397

E-Mail: cbrunson@bbcinternational.com

Confidentiality Notice: This electronic transmission (and any attached documents) is intended only for the person(s) to whom it is addressed and may contain information that is privileged, confidential, or otherwise protected from disclosure. If you have received this transmission in error, please immediately notify the sender by e-mail or by telephone call to (575) 397-6388 for handling instructions. Any disclosure or distribution of the contents of this transmission by anyone other than the named recipient(s) is strictly prohibited.
