

## Bratcher, Mike, EMNRD

---

**From:** Pair, Randal <rpair@blm.gov>  
**Sent:** Friday, October 02, 2015 1:52 PM  
**To:** Blair, Yvonne B  
**Cc:** Bratcher, Mike, EMNRD; Case, Nicholas L; Landenberger, Dan R; Walker, Clayton D; Gall, Sarah; Valencia, Israel; Michael, Kelley R; Tillman, Kayla; Pudim, David A  
**Subject:** Re: FW: 20200 LINE LEAK

Yvonne -

1. Regarding clean-up of this leak.

The chloride (Cl) levels are very high. I will follow OCD's lead on this, but I think we need to do further delineation,

For lateral delineation, I would suggest additional samples at this same depth at both ends of each sidewall, and probably a sample from each end wall. Once the lateral contamination is better defined, you should do further verticle delineation - either trench excavation or boring.

But as I said, I will follow OCD's requirements on that.

2. Further maintenance activity on this pipeline - replacing about 1300-ft of pipe. BLM R/W ID = NM-90176

I checked with archeology and other BLM resources. If you keep all disturbance within the DCP R/W - 25-ft on each side of the pipe - there will be no resource conflicts. I hereby give BLM permission to conduct such work. But all travel must be along the R/W - if you need any additional access points, you must contact me first, and probably amend the R/W grant.

And I would suggest you not start immediately at the leak excavation until we have further delineated the Cl contamination.

Randal "Randy" Pair  
Envir. Protection Specialist - Realty Compliance  
office: 575.234.6240  
cell: 575.361.0062  
email: [rpair@blm.gov](mailto:rpair@blm.gov)

On Fri, Oct 2, 2015 at 9:43 AM, Blair, Yvonne B <[YBBblair@dcpmidstream.com](mailto:YBBblair@dcpmidstream.com)> wrote:

Mike

Here is the report from Cardinal Labs. Our construction crew would like to replace 1300 ft. of pipe on our ROW to avoid any further issues with the line. We have removed the affected soil and would like to continue with the replacement of the pipe to the leak area.

Samples were taken at the depths below.

Sample #1 East Side Wall was done at 5 ft.

Sample #2 under pipe 10-11 ft.

Sample #3 West side wall 7-8 ft.

Yvonne Blair

Compliance Coordinator

DCP Midstream

575-361-2406

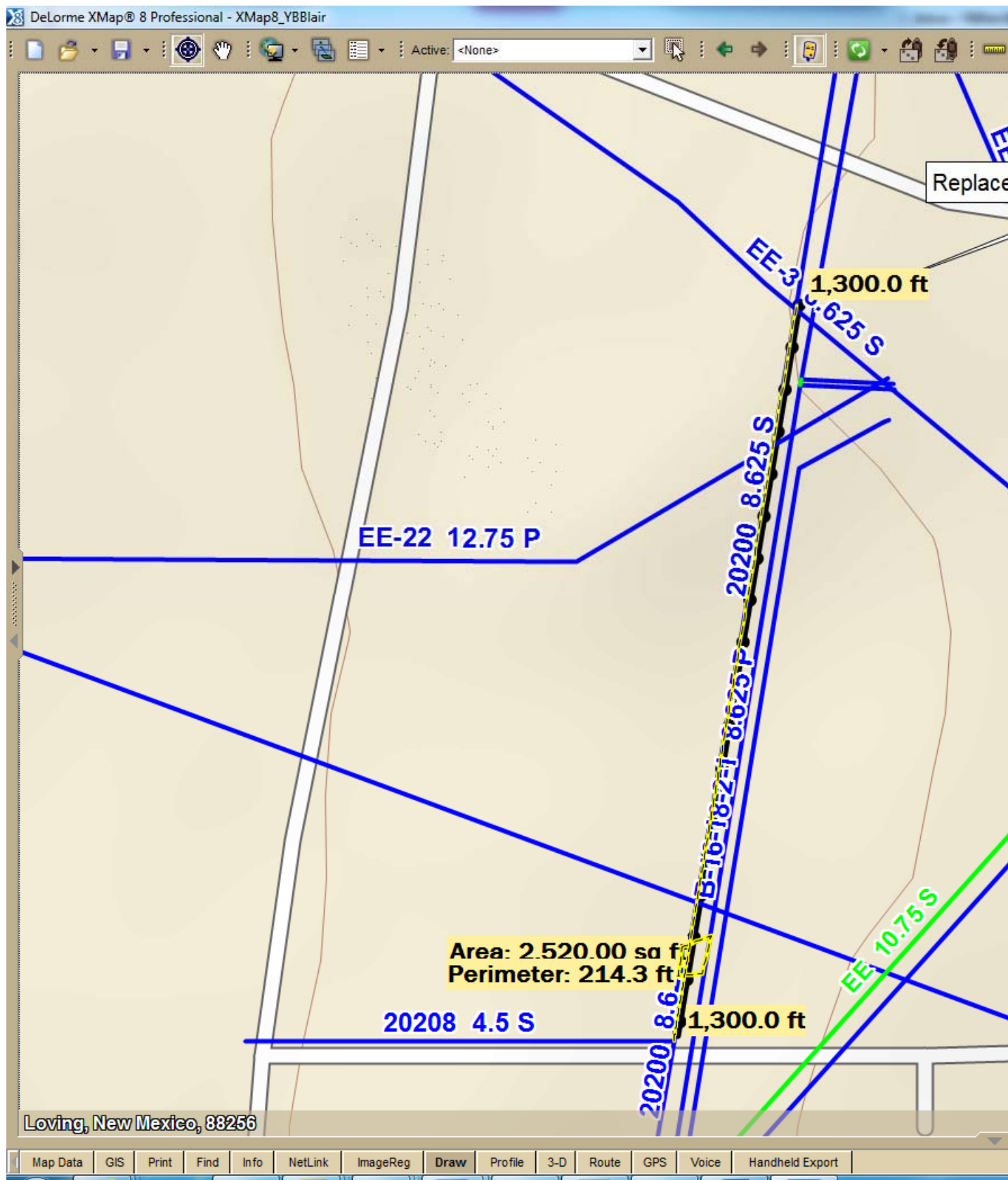

---

**From:** Celey Keene [mailto:[celey.keene@cardinallabsnm.com](mailto:celey.keene@cardinallabsnm.com)]  
**Sent:** Wednesday, September 30, 2015 11:41 AM  
**To:** Blair, Yvonne B  
**Subject:** 20200 LINE LEAK

THANK YOU,

**Celey Keene**

**Lab Director**

**Cardinal Laboratories**

**101 East Marland**

**Hobbs, NM 88240**

**T: (575) 393-2326**

**F: (575) 393-2476**

**e-mail:** [celey.keene@cardinallabsnm.com](mailto:celey.keene@cardinallabsnm.com)

*The information contained in this message is confidential and is only intended for the use of the individual/firm named above. If the reader of this message is not the intended recipient or the employee/agent responsible to deliver it to the intended recipient, you are hereby notified that any dissemination, distribution or copying of this communication is strictly prohibited. If you have received this communication in error, please notify us immediately by e-mail or telephone in order to return the message. We would like your feedback about the services you have received from Cardinal Laboratories. Click on the following link to complete a brief survey, <https://www.surveymonkey.com/s/Z7JXYQQ>. Thank you.*