



**Santo Nino 29 Fed SWD #1**

**API: 30-015-28689**

**Eddy County, NM**

**Work Plan**

Mike Bratcher  
Environmental Specialist  
NM Oil Conservation District – Division 2  
Artesia, NM 88210

**RE: Mewbourne, Santo Nino 29 Fed SWD #1 – Remediation Work Plan  
UL/G, Section 29, T18S R30E**

Mr. Bratcher,

Mewbourne has retained Diversified Field Service, Inc. (DFSI) to address environmental issues for the site detailed herein.

The site is located southwest of Loco Hills, NM, in Eddy County. The spill occurred on June 13, 2015, and a C-141 was drafted on June 18, 2015. The spill was the result of a lightning strike, causing the battery to catch fire, which burned a hole in the corner of the containment. The fire department was immediately contacted and vacuum trucks arrived to clean up the spill as soon as the location was deemed safe. An estimated total of 1,170 bbls of produced water was released, with an estimated 1,170 recovered by vacuum trucks. All visually contaminated soil was hauled to an approved NM state disposal site.

### **Site Assessment and Delineation**

Basin Environmental Service Technologies responded to the spill and sampled 8 points of the area. Clean samples were taken to a commercial laboratory for confirmation. Those results are attached on the site diagram.

On November 10, 2015, Diversified Environmental Services responded to the spill location to drill vertically to obtain confirmation samples in the areas of SP #5 and SP #8. These points were labeled SB #1 and SB #2. DFSI personnel encountered drill refusal at SB #1 at 75' BGS. The sample at 75' BGS was taken to a commercial laboratory for confirmation. A sample was taken at 53' at SB #2, and that sample was taken to a commercial laboratory for confirmation as well. Those results are attached. Each sample was tested for chloride levels as well as BTEX. The BTEX samples were performed using a Mini Rae Photoionization Detector (PID).

DFSI has conducted a groundwater study of the area and has determined that according to the Conoco-Phillips depth-to-groundwater map, the average depth to groundwater for this area is 101 feet below ground surface. Therefore, no eminent danger of groundwater impact or threat to life is anticipated.

## Conclusion

After careful review DFSI on behalf of Mewbourne would like to propose the following:

DFSI proposes to remove the contaminated soil in the areas of SP #1, SP #2, SP #5 and SP #8 to 4' BGS; then install a 20-mil liner or impervious river rock, and backfill with native topsoil. In the area of SP #3, DFSI will excavate to 1' BGS and backfill with native topsoil. In the areas of SP #4, SP #6 and SP #7, DFSI will excavate to 2' BGS and backfill with native topsoil. The spill area on the lease road will be scraped and fresh caliche will be brought in.

The pasture area will be seeded with a BLM approved seed mix. All contaminated materials will be hauled to an approved NM state disposal.

Following the approval of the above plan, DFSI will submit all proper closure documentation to the NMOCD and BLM in accordance to the State and Federal Guidelines set forth.

Please feel free to contact me with any questions concerning this remediation plan request.

Sincerely,

A handwritten signature in black ink that reads "Michael Burton". The signature is written in a cursive, flowing style.

Michael Burton  
Environmental Operations Director  
Diversified Field Service, Inc.  
206 West Snyder  
Hobbs, NM 88240

Office: (575)964-8394  
Mobile: (575)390-5454  
Fax: (575)964-8396  
Email: [Mburtont@diversifiedfsi.com](mailto:Mburtont@diversifiedfsi.com)

cc Shelly Tucker BLM

Attachments: Site/Sample Map  
Sample Data  
Initial C-141

District I  
1625 N. French Dr., Hobbs, NM 88240  
District II  
811 S. First St., Artesia, NM 88210  
District III  
1000 Rio Brazos Road, Aztec, NM 87410  
District IV  
1220 S. St. Francis Dr., Santa Fe, NM 87505

State of New Mexico  
Energy Minerals and Natural Resources

Form C-141  
Revised August 8, 2011

Oil Conservation Division  
1220 South St. Francis Dr.  
Santa Fe, NM 87505

Submit 1 Copy to appropriate District Office in  
accordance with 19.15.29 NMAC.

## Release Notification and Corrective Action

### OPERATOR

☒ Initial Report ☐ Final Report

Name of Company: Mewbourne Oil Company	Contact: Zack Thomas
Address: PO Box 5270 Hobbs NM 88241	Telephone No. 575-393-5905
Facility Name: Santo Nino 29 Fed SWD #1	Facility Type: Producing Oil Well

Surface Owner: BLM	Mineral Owner: BLM	API No. 30-015-28689
--------------------	--------------------	----------------------

### LOCATION OF RELEASE

Unit Letter G	Section 29	Township 18S	Range 30E	Feet from the 1932'	North/South Line North	Feet from the 1923'	East/West Line East	County Eddy
------------------	---------------	-----------------	--------------	------------------------	---------------------------	------------------------	------------------------	----------------

Latitude 32.720294 Longitude -103.992032

### NATURE OF RELEASE

Type of Release: Produced water	Volume of Release: 1170 bbls	Volume Recovered: 1170 bbls
Source of Release: Water Tank	Date and Hour of Occurrence 6-13-15 6:30 pm	Date and Hour of Discovery 6-13-15 7:00 pm
Was Immediate Notice Given? <input checked="" type="checkbox"/> Yes <input type="checkbox"/> No <input type="checkbox"/> Not Required	If YES, To Whom? Jim Amos (BLM)	
By Whom? Robin Terrell	Date and Hour 6-14-15 11:30 am	
Was a Watercourse Reached? <input type="checkbox"/> Yes <input checked="" type="checkbox"/> No	If YES, Volume Impacting the Watercourse.	

If a Watercourse was Impacted, Describe Fully.\*

Describe Cause of Problem and Remedial Action Taken.\*

Cause of leak: The tank battery was struck by lightning. Upon being struck, the battery caught fire and burned a hole in the corner of the containment. Fire department was immediately contacted and vacuum trucks arrived to clean the spill as soon as the location was deemed safe.

Describe Area Affected and Cleanup Action Taken.\*

Affected area: The produced water leaked out of the SW corner of the containment behind location. Vacuum trucks recovered all of the standing water and any visually contaminated soil was taken to an approved NMOCD disposal site. Final remediation will be conducted in accordance with the NMOCD's Guidelines for Remediation of Spills, Leaks and Releases.

I hereby certify that the information given above is true and complete to the best of my knowledge and understand that pursuant to NMOCD rules and regulations all operators are required to report and/or file certain release notifications and perform corrective actions for releases which may endanger public health or the environment. The acceptance of a C-141 report by the NMOCD marked as "Final Report" does not relieve the operator of liability should their operations have failed to adequately investigate and remediate contamination that pose a threat to ground water, surface water, human health or the environment. In addition, NMOCD acceptance of a C-141 report does not relieve the operator of responsibility for compliance with any other federal, state, or local laws and/or regulations.

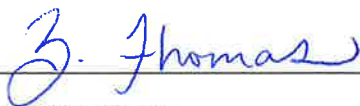
Signature: 		<u>OIL CONSERVATION DIVISION</u>	
Printed Name: Zack Thomas		Approved by Environmental Specialist:	
Title: Environmental Rep.		Approval Date:	Expiration Date:
E-mail Address: zthomas@mewbourne.com		Conditions of Approval:	
Date: 6-18-15 Phone: 575-602-2188		Attached <input type="checkbox"/>	

\* Attach Additional Sheets If Necessary



# Initial Sampling Data

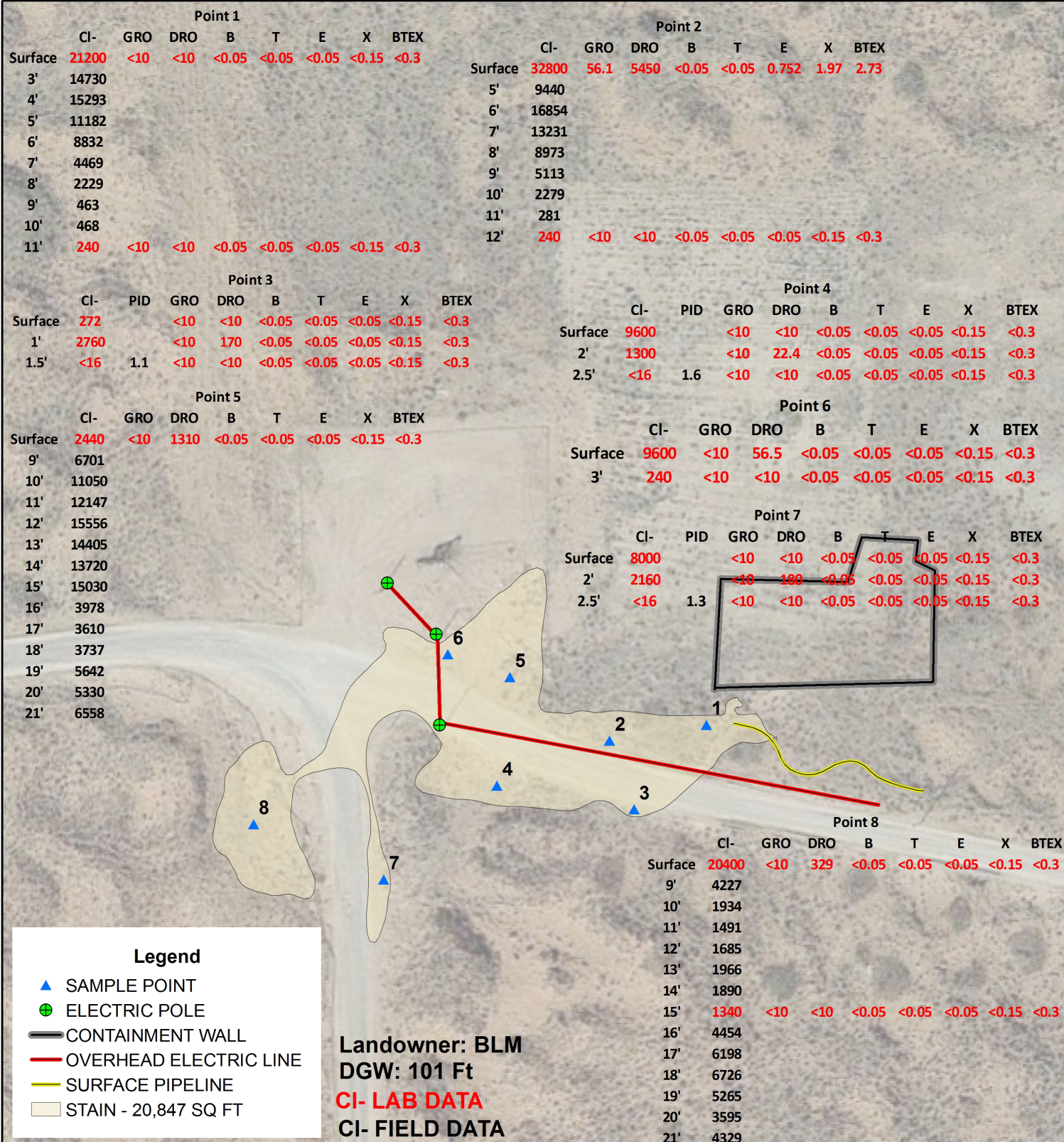

**MEWBOURNE**  
**SANTO NINO 29**  
**FEDERAL SWD #1**

**UL G SECTION 29**  
**T-18-S R-30-E**  
**EDDY COUNTY, NM**

**Underground facilities are spatially projected and need to be field verified.**

GPS Center Stain: 32.719856 -103.992104

0 50 100 Feet

GPS date: 6/30/15 KL  
 Drawing date: 7/17/15  
 Drafted by: L. Weinheimer

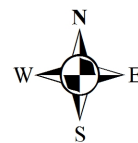

Diversified Environmental Services

Company Name: Mewbourne SP Date: 11/9/2015  
 Location Name: Santo Nino 29 Federal SWD #1 Rel Date:

SB1	CHL	PID	SB2	CHL	PID	SP3	CHL	PID	SP4	CHL	PID	SP5	CHL	PID
20'	1,544		25'	2,376										
21'	2,238		30'	1,441										
22'	2,363		35'	1,669										
25'	2,092		40'	1,505										
30'	3,869		45'	431										
35'	1,176		50'	438										
40'	944		53'	292										
45'	1,255													
50'	991		53'	240										
55'	724													
60'	551													
65'	968													
70'	826													
75'	411													
75'	320													

	Lab Confirmation Sample
	Field Sampling
	Needs Delineation and confirmation samples



PHONE (575) 393-2326 ° 101 E. MARLAND ° HOBBS, NM 88240

---

November 11, 2015

ZACK THOMAS

MEWBOURNE OIL COMPANY

P. O. BOX 5270

HOBBS, NM 88240

RE: SANTO NINO 29 FED SWD #1

Enclosed are the results of analyses for samples received by the laboratory on 11/10/15 15:20.

Cardinal Laboratories is accredited through Texas NELAP under certificate number T104704398-13-5. Accreditation applies to drinking water, non-potable water and solid and chemical materials. All accredited analytes are denoted by an asterisk (\*). For a complete list of accredited analytes and matrices visit the TCEQ website at [www.tceq.texas.gov/field/qa/lab\\_accred\\_certif.html](http://www.tceq.texas.gov/field/qa/lab_accred_certif.html).

Cardinal Laboratories is accredited through the State of Colorado Department of Public Health and Environment for:

Method EPA 552.2	Haloacetic Acids (HAA-5)
Method EPA 524.2	Total Trihalomethanes (TTHM)
Method EPA 524.4	Regulated VOCs (V1, V2, V3)

Accreditation applies to public drinking water matrices.

This report meets NELAP requirements and is made up of a cover page, analytical results, and a copy of the original chain-of-custody. If you have any questions concerning this report, please feel free to contact me.

Sincerely,

A handwritten signature in black ink that reads "Celey D. Keene". The signature is written in a cursive style with a large, stylized 'C' and 'K'.

Celey D. Keene

Lab Director/Quality Manager



**Sample ID: SOIL BORE 2 @ 53' (H502973-02)**

**Chloride, SM4500Cl-B**

**mg/kg**

**Analyzed By: AP**

Analyte	Result	Reporting Limit	Analyzed	Method Blank	BS	% Recovery	True Value QC	RPD	Qualifier
Chloride	240	16.0	11/11/2015	ND	400	100	400	7.69	

**Notes and Definitions**

ND	Analyte NOT DETECTED at or above the reporting limit
RPD	Relative Percent Difference
**	Samples not received at proper temperature of 6°C or below.
***	Insufficient time to reach temperature.
-	Chloride by SM4500Cl-B does not require samples be received at or below 6°C Samples reported on an as received basis (wet) unless otherwise noted on report

---

Cardinal Laboratories

\*=Accredited Analyte

PLEASE NOTE: Liability and Damages. Cardinal's liability and client's exclusive remedy for any claim arising, whether based in contract or tort, shall be limited to the amount paid by client for analyses. All claims, including those for negligence and any other cause whatsoever shall be deemed waived unless made in writing and received by Cardinal within thirty (30) days after completion of the applicable service. In no event shall Cardinal be liable for incidental or consequential damages, including, without limitation, business interruptions, loss of use, or loss of profits incurred by client, its subsidiaries, affiliates or successors arising out of or related to the performance of the services hereunder by Cardinal, regardless of whether such claim is based upon any of the above stated reasons or otherwise. Results relate only to the samples identified above. This report shall not be reproduced except in full with written approval of Cardinal Laboratories.



---

Celey D. Keene, Lab Director/Quality Manager



PHONE (575) 393-2326 ° 101 E. MARLAND ° HOBBS, NM 88240

---

November 12, 2015

ZACK THOMAS

MEWBOURNE OIL COMPANY

P. O. BOX 5270

HOBBS, NM 88240

RE: SANTO NINO 29 FED SWD #1

Enclosed are the results of analyses for samples received by the laboratory on 11/11/15 15:57.

Cardinal Laboratories is accredited through Texas NELAP under certificate number T104704398-13-5. Accreditation applies to drinking water, non-potable water and solid and chemical materials. All accredited analytes are denoted by an asterisk (\*). For a complete list of accredited analytes and matrices visit the TCEQ website at [www.tceq.texas.gov/field/qa/lab\\_accred\\_certif.html](http://www.tceq.texas.gov/field/qa/lab_accred_certif.html).

Cardinal Laboratories is accredited through the State of Colorado Department of Public Health and Environment for:

Method EPA 552.2	Haloacetic Acids (HAA-5)
Method EPA 524.2	Total Trihalomethanes (TTHM)
Method EPA 524.4	Regulated VOCs (V1, V2, V3)

Accreditation applies to public drinking water matrices.

This report meets NELAP requirements and is made up of a cover page, analytical results, and a copy of the original chain-of-custody. If you have any questions concerning this report, please feel free to contact me.

Sincerely,

A handwritten signature in black ink that reads "Celey D. Keene". The signature is written in a cursive style with a large, stylized 'C' and 'K'.

Celey D. Keene

Lab Director/Quality Manager

**Analytical Results For:**

MEWBOURNE OIL COMPANY  
ZACK THOMAS  
P. O. BOX 5270  
HOBBS NM, 88240  
Fax To: (575) 937-6252

Received:	11/11/2015	Sampling Date:	11/09/2015
Reported:	11/12/2015	Sampling Type:	Soil
Project Name:	SANTO NINO 29 FED SWD #1	Sampling Condition:	Cool & Intact
Project Number:	NONE GIVEN	Sample Received By:	Judy Garcia
Project Location:	NOT GIVEN		

**Sample ID: SOIL BORE 1 @ 75' (H502994-01)**

Chloride, SM4500Cl-B		mg/kg		Analyzed By: AP					
Analyte	Result	Reporting Limit	Analyzed	Method Blank	BS	% Recovery	True Value QC	RPD	Qualifier
Chloride	320	16.0	11/12/2015	ND	416	104	400	3.92	

Cardinal Laboratories

\*=Accredited Analyte

PLEASE NOTE: Liability and Damages. Cardinal's liability and client's exclusive remedy for any claim arising, whether based in contract or tort, shall be limited to the amount paid by client for analyses. All claims, including those for negligence and any other cause whatsoever shall be deemed waived unless made in writing and received by Cardinal within thirty (30) days after completion of the applicable service. In no event shall Cardinal be liable for incidental or consequential damages, including, without limitation, business interruptions, loss of use, or loss of profits incurred by client, its subsidiaries, affiliates or successors arising out of or related to the performance of the services hereunder by Cardinal, regardless of whether such claim is based upon any of the above stated reasons or otherwise. Results relate only to the samples identified above. This report shall not be reproduced except in full with written approval of Cardinal Laboratories.



Celey D. Keene, Lab Director/Quality Manager

**Notes and Definitions**

ND	Analyte NOT DETECTED at or above the reporting limit
RPD	Relative Percent Difference
**	Samples not received at proper temperature of 6°C or below.
***	Insufficient time to reach temperature.
-	Chloride by SM4500Cl-B does not require samples be received at or below 6°C Samples reported on an as received basis (wet) unless otherwise noted on report

---

Cardinal Laboratories

\*=Accredited Analyte

PLEASE NOTE: Liability and Damages. Cardinal's liability and client's exclusive remedy for any claim arising, whether based in contract or tort, shall be limited to the amount paid by client for analyses. All claims, including those for negligence and any other cause whatsoever shall be deemed waived unless made in writing and received by Cardinal within thirty (30) days after completion of the applicable service. In no event shall Cardinal be liable for incidental or consequential damages, including, without limitation, business interruptions, loss of use, or loss of profits incurred by client, its subsidiaries, affiliates or successors arising out of or related to the performance of the services hereunder by Cardinal, regardless of whether such claim is based upon any of the above stated reasons or otherwise. Results relate only to the samples identified above. This report shall not be reproduced except in full with written approval of Cardinal Laboratories.



---

Celey D. Keene, Lab Director/Quality Manager