

APACHE E.L. #5 BATTERY AD

LEGALS: UL/I sec. 21
T-17-S R-30-E
EDDY COUNTY, NM

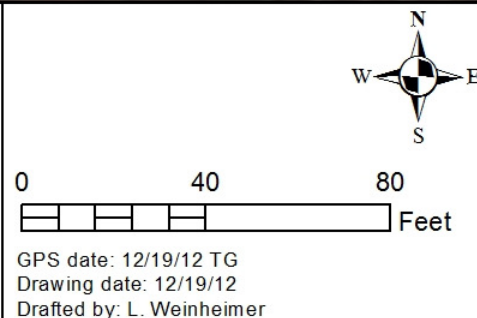

Apache E.L. #5 Battery AD

Unit Letter I, Section 21, T17S, R30E



Initial release area, facing north

10/9/12



Initial release area, facing north

10/9/12



Initial release area, facing south

10/9/12



Initial release area, facing south

10/9/12



Digging under lines, facing south

10/22/12



Excavating and loading, facing south

10/22/12



Stockpiling on plastic, facing east 10/22/12



Excavation complete, facing south 10/23/12



Excavation complete, facing south 10/23/12



Excavation complete, facing north 10/23/12



Installing SB-1, facing north

12/18/12



Plugging SB-1 in total with bentonite

12/18/12



Completed SB-1, facing west

12/18/12