



PHONE (575) 397-6388 • FAX (575) 397- 0397 • 1324 W. MARLAND • P.O. BOX 805 • HOBBS, NM 88241-0805
E-MAIL: cbrunson@bbcinternational.com

OXY – GOVERNMENT AB FEDERAL #13

REMEDIATION PLAN

OXY will excavate the spill area as depicted on the following site diagram. The ENTIRE spill area will be surface scraped to a depth of 6 inches. The entire site will be backfilled with clean soil.

All excavated materials will be disposed of at an NMOCD-approved disposal facility.



Oxy
Government AB Federal #13 (2/11/16)

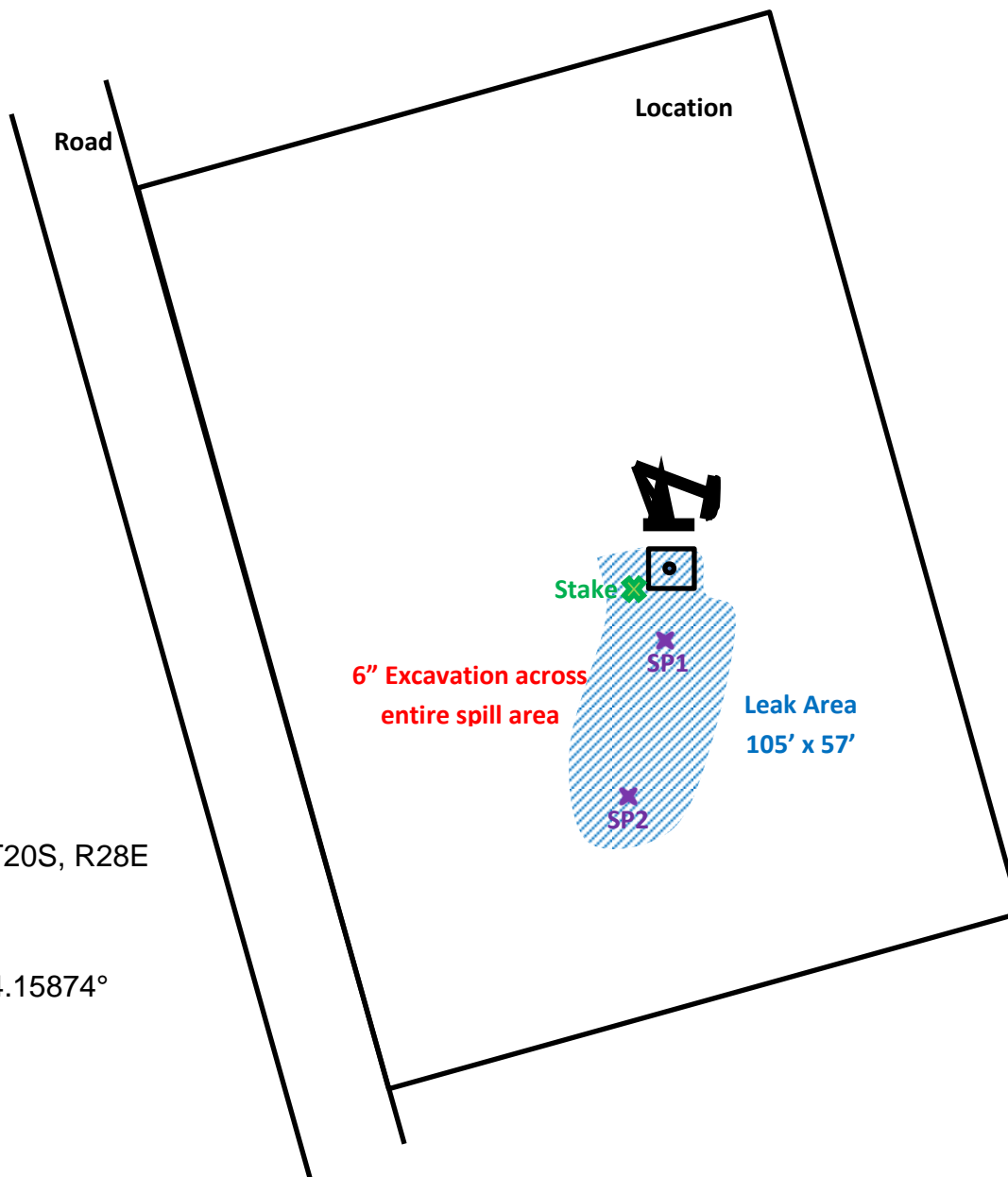

U/L H, Section 10, T20S, R28E
Eddy County, NM
N 32.58979° W 104.15874°
API#30-015-40920

BBC International, Inc.

Oxy
Government AF Fed #13

| | |
|------------------|--------------------|
| Date: 02/22/2016 | DRWG by: K. Purvis |
| NOT TO SCALE | File: Oxy 2016 |



Groundwater Plot

Oxy Government AB Federal #13

County
Eddy

Unit Letter
H

Section
10

Township
20S

Range
28E

Trend Map 50'-75'

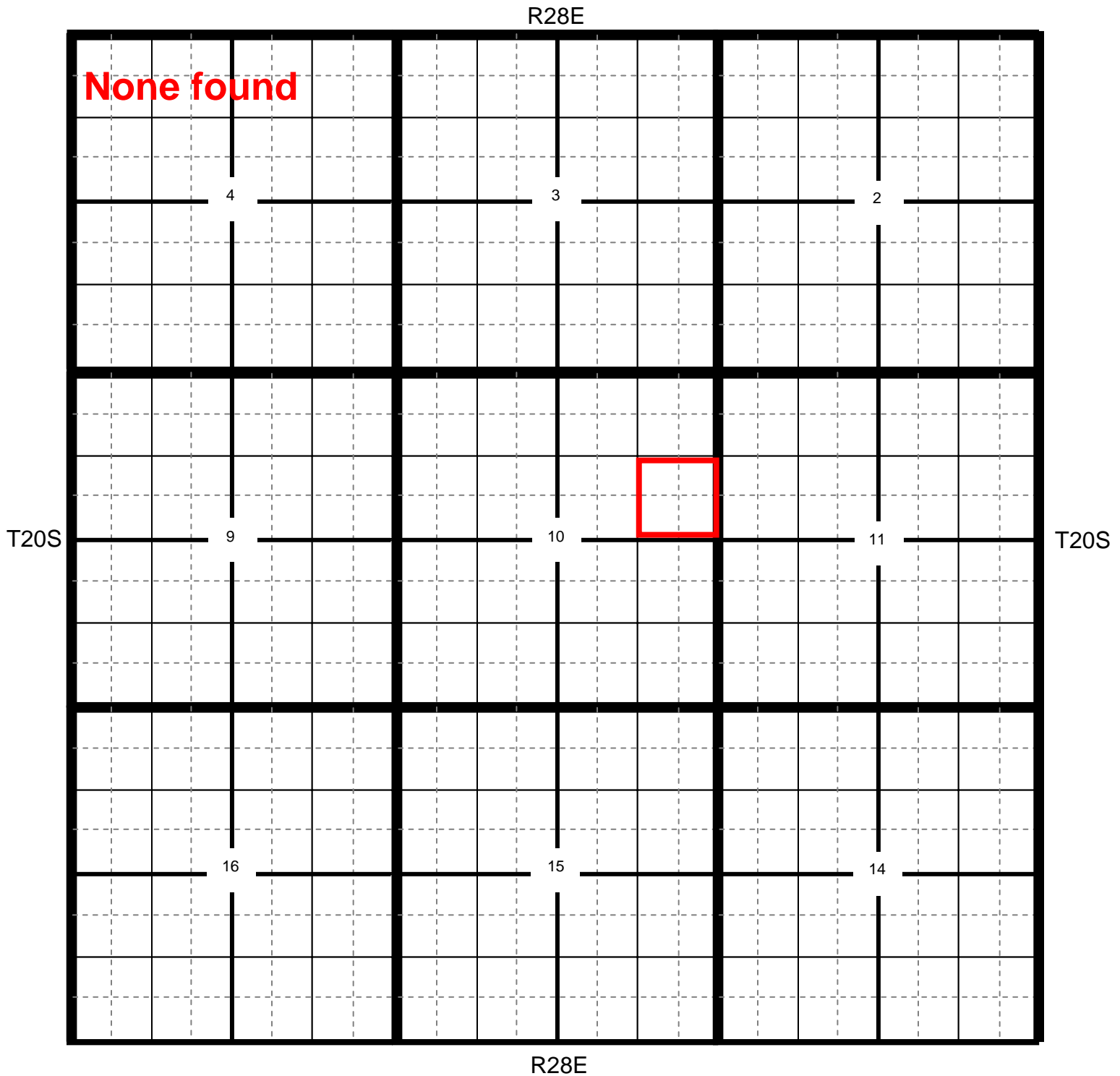

Location

OCD

USGS

SEO

All Databases

Oxy Government AB Federal #13

County Eddy Unit Letter H Section 10 Township 20S Range 28E

Trend Map 50'-75'

1

2

| | | | |
|----------------------------|---------------|---------------|---------------|
| NW/NW None found | NE/NW | NW/NE | NE/NE |
| Unit Letter D | Unit Letter C | Unit Letter B | Unit Letter A |
| SW/NW | SE/NW | SW/NE | SE/NE |
| Unit Letter E | Unit Letter F | Unit Letter G | Unit Letter H |
| NW/SW | NE/SW | NW/SE | NE/SE |
| Unit Letter L | Unit Letter K | Unit Letter J | Unit Letter I |
| SW/SW | SE/SW | SW/SE | SE/SE |
| Unit Letter M | Unit Letter N | Unit Letter O | Unit Letter P |

3

4

**Laboratory Analytical Results Summary
Government AB Federal #13**

| | | Sample | SP1 @ 1' | SP1 @ 2' | SP1 @ 3' |
|----------------------|------------|--------|------------|------------|-----------|
| Analyte | Method | Date | 3/2/16 | 3/2/16 | 3/2/16 |
| | | | mg/Kg | mg/Kg | mg/Kg |
| Benzene | BTEX 8021B | | <0.050 | <0.050 | <0.050 |
| Toluene | BTEX 8021B | | <0.050 | <0.050 | <0.050 |
| Ethylbenzene | BTEX 8021B | | <0.050 | <0.050 | <0.050 |
| Total Xylenes | BTEX 8021B | | <0.150 | <0.150 | <0.150 |
| Total BTEX | BTEX 8021B | | <0.300 | <0.300 | <0.300 |
| Chloride | SM4500Cl-B | | 944 | 640 | 64 |
| GRO | TPH 8015M | | <10.0 | <10.0 | <10.0 |
| DRO | TPH 8015M | | <10.0 | <10.0 | <10.0 |

| | | Sample | SP2 @ 1' | SP2 @ 2' | SP2 @ 3' | SP2 @ 4' | SP5 @ 2' |
|----------------------|------------|--------|-------------|-------------|-----------|-------------|-----------|
| Analyte | Method | Date | 3/2/16 | 3/2/16 | 3/2/16 | 3/2/16 | 3/2/16 |
| | | | mg/Kg | mg/Kg | mg/Kg | mg/Kg | mg/Kg |
| Benzene | BTEX 8021B | | <0.050 | <0.050 | <0.050 | <0.050 | <0.050 |
| Toluene | BTEX 8021B | | <0.050 | <0.050 | <0.050 | <0.050 | <0.050 |
| Ethylbenzene | BTEX 8021B | | <0.050 | <0.050 | <0.050 | <0.050 | <0.050 |
| Total Xylenes | BTEX 8021B | | <0.150 | <0.150 | <0.150 | <0.150 | <0.150 |
| Total BTEX | BTEX 8021B | | <0.300 | <0.300 | <0.300 | <0.300 | <0.300 |
| Chloride | SM4500Cl-B | | 32 | 48 | 64 | 80 | 80 |
| GRO | TPH 8015M | | <10.0 | <10.0 | <10.0 | <10.0 | <10.0 |
| DRO | TPH 8015M | | 93.2 | 94.5 | 32 | 76.7 | <10.0 |



PHONE (575) 393-2326 ° 101 E. MARLAND ° HOBBS, NM 88240

March 10, 2016

Cliff Brunson

BBC International, Inc.

P.O. Box 805

Hobbs, NM 88241

RE: GOVERNMENT AB FEDERAL #13

Enclosed are the results of analyses for samples received by the laboratory on 03/07/16 9:00.

Cardinal Laboratories is accredited through Texas NELAP under certificate number T104704398-15-7. Accreditation applies to drinking water, non-potable water and solid and chemical materials. All accredited analytes are denoted by an asterisk (*). For a complete list of accredited analytes and matrices visit the TCEQ website at www.tceq.texas.gov/field/qa/lab_accred_certif.html.

Cardinal Laboratories is accredited through the State of Colorado Department of Public Health and Environment for:

| | |
|------------------|------------------------------|
| Method EPA 552.2 | Haloacetic Acids (HAA-5) |
| Method EPA 524.2 | Total Trihalomethanes (TTHM) |
| Method EPA 524.4 | Regulated VOCs (V1, V2, V3) |

Accreditation applies to public drinking water matrices.

This report meets NELAP requirements and is made up of a cover page, analytical results, and a copy of the original chain-of-custody. If you have any questions concerning this report, please feel free to contact me.

Sincerely,

A handwritten signature in black ink that reads "Celey D. Keene". The signature is written in a cursive, flowing style.

Celey D. Keene

Lab Director/Quality Manager

Analytical Results For:

BBC International, Inc.
Cliff Brunson
P.O. Box 805
Hobbs NM, 88241
Fax To: (575) 397-0397

| | | | |
|-------------------|---------------------------|---------------------|---------------|
| Received: | 03/07/2016 | Sampling Date: | 03/02/2016 |
| Reported: | 03/10/2016 | Sampling Type: | Soil |
| Project Name: | GOVERNMENT AB FEDERAL #13 | Sampling Condition: | Cool & Intact |
| Project Number: | NONE GIVEN | Sample Received By: | Jodi Henson |
| Project Location: | CARLSBAD, NM | | |

Sample ID: SP 1 @ 1' (H600489-01)

| BTX 8021B | | | mg/kg | | Analyzed By: CK | | | | |
|----------------|--------|-----------------|------------|--------------|-----------------|------------|---------------|-------|-----------|
| Analyte | Result | Reporting Limit | Analyzed | Method Blank | BS | % Recovery | True Value QC | RPD | Qualifier |
| Benzene* | <0.050 | 0.050 | 03/08/2016 | ND | 2.08 | 104 | 2.00 | 0.193 | |
| Toluene* | <0.050 | 0.050 | 03/08/2016 | ND | 2.03 | 102 | 2.00 | 0.140 | |
| Ethylbenzene* | <0.050 | 0.050 | 03/08/2016 | ND | 1.83 | 91.3 | 2.00 | 0.480 | |
| Total Xylenes* | <0.150 | 0.150 | 03/08/2016 | ND | 5.63 | 93.8 | 6.00 | 0.275 | |
| Total BTX | <0.300 | 0.300 | 03/08/2016 | ND | | | | | |

Surrogate: 4-Bromofluorobenzene (PID) 98.8 % 73.6-140

| Chloride, SM4500Cl-B | | | mg/kg | | Analyzed By: AP | | | | |
|----------------------|--------|-----------------|------------|--------------|-----------------|------------|---------------|------|-----------|
| Analyte | Result | Reporting Limit | Analyzed | Method Blank | BS | % Recovery | True Value QC | RPD | Qualifier |
| Chloride | 944 | 16.0 | 03/08/2016 | ND | 432 | 108 | 400 | 7.69 | |

| TPH 8015M | | | mg/kg | | Analyzed By: CK | | | | |
|--------------|--------|-----------------|------------|--------------|-----------------|------------|---------------|------|-----------|
| Analyte | Result | Reporting Limit | Analyzed | Method Blank | BS | % Recovery | True Value QC | RPD | Qualifier |
| GRO C6-C10 | <10.0 | 10.0 | 03/08/2016 | ND | 198 | 98.8 | 200 | 3.81 | |
| DRO >C10-C28 | <10.0 | 10.0 | 03/08/2016 | ND | 209 | 104 | 200 | 4.50 | |

Surrogate: 1-Chlorooctane 99.8 % 35-147

Surrogate: 1-Chlorooctadecane 111 % 28-171

Cardinal Laboratories

*=Accredited Analyte

PLEASE NOTE: Liability and Damages. Cardinal's liability and client's exclusive remedy for any claim arising, whether based in contract or tort, shall be limited to the amount paid by client for analyses. All claims, including those for negligence and any other cause whatsoever shall be deemed waived unless made in writing and received by Cardinal within thirty (30) days after completion of the applicable service. In no event shall Cardinal be liable for incidental or consequential damages, including, without limitation, business interruptions, loss of use, or loss of profits incurred by client, its subsidiaries, affiliates or successors arising out of or related to the performance of the services hereunder by Cardinal, regardless of whether such claim is based upon any of the above stated reasons or otherwise. Results relate only to the samples identified above. This report shall not be reproduced except in full with written approval of Cardinal Laboratories.



Celey D. Keene, Lab Director/Quality Manager

Analytical Results For:

BBC International, Inc.
Cliff Brunson
P.O. Box 805
Hobbs NM, 88241
Fax To: (575) 397-0397

| | | | |
|-------------------|---------------------------|---------------------|---------------|
| Received: | 03/07/2016 | Sampling Date: | 03/02/2016 |
| Reported: | 03/10/2016 | Sampling Type: | Soil |
| Project Name: | GOVERNMENT AB FEDERAL #13 | Sampling Condition: | Cool & Intact |
| Project Number: | NONE GIVEN | Sample Received By: | Jodi Henson |
| Project Location: | CARLSBAD, NM | | |

Sample ID: SP 1 @ 2' (H600489-02)

| BTEx 8021B | | mg/kg | | Analyzed By: CK | | | | | |
|----------------|--------|-----------------|------------|-----------------|------|------------|---------------|-------|-----------|
| Analyte | Result | Reporting Limit | Analyzed | Method Blank | BS | % Recovery | True Value QC | RPD | Qualifier |
| Benzene* | <0.050 | 0.050 | 03/08/2016 | ND | 2.08 | 104 | 2.00 | 0.193 | |
| Toluene* | <0.050 | 0.050 | 03/08/2016 | ND | 2.03 | 102 | 2.00 | 0.140 | |
| Ethylbenzene* | <0.050 | 0.050 | 03/08/2016 | ND | 1.83 | 91.3 | 2.00 | 0.480 | |
| Total Xylenes* | <0.150 | 0.150 | 03/08/2016 | ND | 5.63 | 93.8 | 6.00 | 0.275 | |
| Total BTEx | <0.300 | 0.300 | 03/08/2016 | ND | | | | | |

Surrogate: 4-Bromofluorobenzene (PID) 97.8 % 73.6-140

| Chloride, SM4500CI-B | | mg/kg | | Analyzed By: AP | | | | | |
|----------------------|--------|-----------------|------------|-----------------|-----|------------|---------------|------|-----------|
| Analyte | Result | Reporting Limit | Analyzed | Method Blank | BS | % Recovery | True Value QC | RPD | Qualifier |
| Chloride | 640 | 16.0 | 03/08/2016 | ND | 432 | 108 | 400 | 7.69 | |

| TPH 8015M | | mg/kg | | Analyzed By: CK | | | | | |
|--------------|--------|-----------------|------------|-----------------|-----|------------|---------------|------|-----------|
| Analyte | Result | Reporting Limit | Analyzed | Method Blank | BS | % Recovery | True Value QC | RPD | Qualifier |
| GRO C6-C10 | <10.0 | 10.0 | 03/08/2016 | ND | 198 | 98.8 | 200 | 3.81 | |
| DRO >C10-C28 | <10.0 | 10.0 | 03/08/2016 | ND | 209 | 104 | 200 | 4.50 | |

Surrogate: 1-Chlorooctane 99.7 % 35-147

Surrogate: 1-Chlorooctadecane 110 % 28-171

Cardinal Laboratories

*=Accredited Analyte

PLEASE NOTE: Liability and Damages. Cardinal's liability and client's exclusive remedy for any claim arising, whether based in contract or tort, shall be limited to the amount paid by client for analyses. All claims, including those for negligence and any other cause whatsoever shall be deemed waived unless made in writing and received by Cardinal within thirty (30) days after completion of the applicable service. In no event shall Cardinal be liable for incidental or consequential damages, including, without limitation, business interruptions, loss of use, or loss of profits incurred by client, its subsidiaries, affiliates or successors arising out of or related to the performance of the services hereunder by Cardinal, regardless of whether such claim is based upon any of the above stated reasons or otherwise. Results relate only to the samples identified above. This report shall not be reproduced except in full with written approval of Cardinal Laboratories.



Celey D. Keene, Lab Director/Quality Manager

Analytical Results For:

BBC International, Inc.
Cliff Brunson
P.O. Box 805
Hobbs NM, 88241
Fax To: (575) 397-0397

| | | | |
|-------------------|---------------------------|---------------------|---------------|
| Received: | 03/07/2016 | Sampling Date: | 03/02/2016 |
| Reported: | 03/10/2016 | Sampling Type: | Soil |
| Project Name: | GOVERNMENT AB FEDERAL #13 | Sampling Condition: | Cool & Intact |
| Project Number: | NONE GIVEN | Sample Received By: | Jodi Henson |
| Project Location: | CARLSBAD, NM | | |

Sample ID: SP 1 @ 3' (H600489-03)

| BTEx 8021B | | mg/kg | | Analyzed By: CK | | | | | |
|----------------|--------|-----------------|------------|-----------------|------|------------|---------------|-------|-----------|
| Analyte | Result | Reporting Limit | Analyzed | Method Blank | BS | % Recovery | True Value QC | RPD | Qualifier |
| Benzene* | <0.050 | 0.050 | 03/08/2016 | ND | 2.08 | 104 | 2.00 | 0.193 | |
| Toluene* | <0.050 | 0.050 | 03/08/2016 | ND | 2.03 | 102 | 2.00 | 0.140 | |
| Ethylbenzene* | <0.050 | 0.050 | 03/08/2016 | ND | 1.83 | 91.3 | 2.00 | 0.480 | |
| Total Xylenes* | <0.150 | 0.150 | 03/08/2016 | ND | 5.63 | 93.8 | 6.00 | 0.275 | |
| Total BTEx | <0.300 | 0.300 | 03/08/2016 | ND | | | | | |

Surrogate: 4-Bromofluorobenzene (PID) 96.1 % 73.6-140

| Chloride, SM4500CI-B | | mg/kg | | Analyzed By: AP | | | | | |
|----------------------|--------|-----------------|------------|-----------------|-----|------------|---------------|------|-----------|
| Analyte | Result | Reporting Limit | Analyzed | Method Blank | BS | % Recovery | True Value QC | RPD | Qualifier |
| Chloride | 64.0 | 16.0 | 03/08/2016 | ND | 432 | 108 | 400 | 7.69 | |

| TPH 8015M | | mg/kg | | Analyzed By: CK | | | | | |
|--------------|--------|-----------------|------------|-----------------|-----|------------|---------------|------|-----------|
| Analyte | Result | Reporting Limit | Analyzed | Method Blank | BS | % Recovery | True Value QC | RPD | Qualifier |
| GRO C6-C10 | <10.0 | 10.0 | 03/08/2016 | ND | 198 | 98.8 | 200 | 3.81 | |
| DRO >C10-C28 | <10.0 | 10.0 | 03/08/2016 | ND | 209 | 104 | 200 | 4.50 | |

Surrogate: 1-Chlorooctane 95.3 % 35-147

Surrogate: 1-Chlorooctadecane 109 % 28-171

Cardinal Laboratories

*=Accredited Analyte

PLEASE NOTE: Liability and Damages. Cardinal's liability and client's exclusive remedy for any claim arising, whether based in contract or tort, shall be limited to the amount paid by client for analyses. All claims, including those for negligence and any other cause whatsoever shall be deemed waived unless made in writing and received by Cardinal within thirty (30) days after completion of the applicable service. In no event shall Cardinal be liable for incidental or consequential damages, including, without limitation, business interruptions, loss of use, or loss of profits incurred by client, its subsidiaries, affiliates or successors arising out of or related to the performance of the services hereunder by Cardinal, regardless of whether such claim is based upon any of the above stated reasons or otherwise. Results relate only to the samples identified above. This report shall not be reproduced except in full with written approval of Cardinal Laboratories.



Celey D. Keene, Lab Director/Quality Manager

Analytical Results For:

BBC International, Inc.
Cliff Brunson
P.O. Box 805
Hobbs NM, 88241
Fax To: (575) 397-0397

| | | | |
|-------------------|---------------------------|---------------------|---------------|
| Received: | 03/07/2016 | Sampling Date: | 03/02/2016 |
| Reported: | 03/10/2016 | Sampling Type: | Soil |
| Project Name: | GOVERNMENT AB FEDERAL #13 | Sampling Condition: | Cool & Intact |
| Project Number: | NONE GIVEN | Sample Received By: | Jodi Henson |
| Project Location: | CARLSBAD, NM | | |

Sample ID: SP 2 @ 1' (H600489-04)

| BTX 8021B | | mg/kg | | Analyzed By: CK | | | | | |
|----------------|--------|-----------------|------------|-----------------|------|------------|---------------|-------|-----------|
| Analyte | Result | Reporting Limit | Analyzed | Method Blank | BS | % Recovery | True Value QC | RPD | Qualifier |
| Benzene* | <0.050 | 0.050 | 03/08/2016 | ND | 2.08 | 104 | 2.00 | 0.193 | |
| Toluene* | <0.050 | 0.050 | 03/08/2016 | ND | 2.03 | 102 | 2.00 | 0.140 | |
| Ethylbenzene* | <0.050 | 0.050 | 03/08/2016 | ND | 1.83 | 91.3 | 2.00 | 0.480 | |
| Total Xylenes* | <0.150 | 0.150 | 03/08/2016 | ND | 5.63 | 93.8 | 6.00 | 0.275 | |
| Total BTX | <0.300 | 0.300 | 03/08/2016 | ND | | | | | |

Surrogate: 4-Bromofluorobenzene (PID) 98.5 % 73.6-140

| Chloride, SM4500CI-B | | mg/kg | | Analyzed By: AP | | | | | |
|----------------------|--------|-----------------|------------|-----------------|-----|------------|---------------|------|-----------|
| Analyte | Result | Reporting Limit | Analyzed | Method Blank | BS | % Recovery | True Value QC | RPD | Qualifier |
| Chloride | 32.0 | 16.0 | 03/08/2016 | ND | 432 | 108 | 400 | 7.69 | |

| TPH 8015M | | mg/kg | | Analyzed By: CK | | | | | |
|--------------|--------|-----------------|------------|-----------------|-----|------------|---------------|------|-----------|
| Analyte | Result | Reporting Limit | Analyzed | Method Blank | BS | % Recovery | True Value QC | RPD | Qualifier |
| GRO C6-C10 | <10.0 | 10.0 | 03/08/2016 | ND | 198 | 98.8 | 200 | 3.81 | |
| DRO >C10-C28 | 93.2 | 10.0 | 03/08/2016 | ND | 209 | 104 | 200 | 4.50 | |

Surrogate: 1-Chlorooctane 101 % 35-147

Surrogate: 1-Chlorooctadecane 107 % 28-171

Cardinal Laboratories

*=Accredited Analyte

PLEASE NOTE: Liability and Damages. Cardinal's liability and client's exclusive remedy for any claim arising, whether based in contract or tort, shall be limited to the amount paid by client for analyses. All claims, including those for negligence and any other cause whatsoever shall be deemed waived unless made in writing and received by Cardinal within thirty (30) days after completion of the applicable service. In no event shall Cardinal be liable for incidental or consequential damages, including, without limitation, business interruptions, loss of use, or loss of profits incurred by client, its subsidiaries, affiliates or successors arising out of or related to the performance of the services hereunder by Cardinal, regardless of whether such claim is based upon any of the above stated reasons or otherwise. Results relate only to the samples identified above. This report shall not be reproduced except in full with written approval of Cardinal Laboratories.



Celey D. Keene, Lab Director/Quality Manager

Analytical Results For:

BBC International, Inc.
Cliff Brunson
P.O. Box 805
Hobbs NM, 88241
Fax To: (575) 397-0397

| | | | |
|-------------------|---------------------------|---------------------|---------------|
| Received: | 03/07/2016 | Sampling Date: | 03/02/2016 |
| Reported: | 03/10/2016 | Sampling Type: | Soil |
| Project Name: | GOVERNMENT AB FEDERAL #13 | Sampling Condition: | Cool & Intact |
| Project Number: | NONE GIVEN | Sample Received By: | Jodi Henson |
| Project Location: | CARLSBAD, NM | | |

Sample ID: SP 2 @ 2' (H600489-05)

| BTX 8021B | | mg/kg | | Analyzed By: CK | | | | | |
|----------------|--------|-----------------|------------|-----------------|------|------------|---------------|-------|-----------|
| Analyte | Result | Reporting Limit | Analyzed | Method Blank | BS | % Recovery | True Value QC | RPD | Qualifier |
| Benzene* | <0.050 | 0.050 | 03/08/2016 | ND | 2.08 | 104 | 2.00 | 0.193 | |
| Toluene* | <0.050 | 0.050 | 03/08/2016 | ND | 2.03 | 102 | 2.00 | 0.140 | |
| Ethylbenzene* | <0.050 | 0.050 | 03/08/2016 | ND | 1.83 | 91.3 | 2.00 | 0.480 | |
| Total Xylenes* | <0.150 | 0.150 | 03/08/2016 | ND | 5.63 | 93.8 | 6.00 | 0.275 | |
| Total BTX | <0.300 | 0.300 | 03/08/2016 | ND | | | | | |

Surrogate: 4-Bromofluorobenzene (PID) 98.4 % 73.6-140

| Chloride, SM4500CI-B | | mg/kg | | Analyzed By: AP | | | | | |
|----------------------|--------|-----------------|------------|-----------------|-----|------------|---------------|------|-----------|
| Analyte | Result | Reporting Limit | Analyzed | Method Blank | BS | % Recovery | True Value QC | RPD | Qualifier |
| Chloride | 48.0 | 16.0 | 03/08/2016 | ND | 432 | 108 | 400 | 7.69 | |

| TPH 8015M | | mg/kg | | Analyzed By: CK | | | | | |
|--------------|--------|-----------------|------------|-----------------|-----|------------|---------------|------|-----------|
| Analyte | Result | Reporting Limit | Analyzed | Method Blank | BS | % Recovery | True Value QC | RPD | Qualifier |
| GRO C6-C10 | <10.0 | 10.0 | 03/08/2016 | ND | 198 | 98.8 | 200 | 3.81 | |
| DRO >C10-C28 | 94.5 | 10.0 | 03/08/2016 | ND | 209 | 104 | 200 | 4.50 | |

Surrogate: 1-Chlorooctane 102 % 35-147

Surrogate: 1-Chlorooctadecane 105 % 28-171

Cardinal Laboratories

*=Accredited Analyte

PLEASE NOTE: Liability and Damages. Cardinal's liability and client's exclusive remedy for any claim arising, whether based in contract or tort, shall be limited to the amount paid by client for analyses. All claims, including those for negligence and any other cause whatsoever shall be deemed waived unless made in writing and received by Cardinal within thirty (30) days after completion of the applicable service. In no event shall Cardinal be liable for incidental or consequential damages, including, without limitation, business interruptions, loss of use, or loss of profits incurred by client, its subsidiaries, affiliates or successors arising out of or related to the performance of the services hereunder by Cardinal, regardless of whether such claim is based upon any of the above stated reasons or otherwise. Results relate only to the samples identified above. This report shall not be reproduced except in full with written approval of Cardinal Laboratories.



Celey D. Keene, Lab Director/Quality Manager

Analytical Results For:

BBC International, Inc.
Cliff Brunson
P.O. Box 805
Hobbs NM, 88241
Fax To: (575) 397-0397

| | | | |
|-------------------|---------------------------|---------------------|---------------|
| Received: | 03/07/2016 | Sampling Date: | 03/02/2016 |
| Reported: | 03/10/2016 | Sampling Type: | Soil |
| Project Name: | GOVERNMENT AB FEDERAL #13 | Sampling Condition: | Cool & Intact |
| Project Number: | NONE GIVEN | Sample Received By: | Jodi Henson |
| Project Location: | CARLSBAD, NM | | |

Sample ID: SP 2 @ 3' (H600489-06)

| BTX 8021B | | mg/kg | | Analyzed By: CK | | | | | |
|----------------|--------|-----------------|------------|-----------------|------|------------|---------------|-------|-----------|
| Analyte | Result | Reporting Limit | Analyzed | Method Blank | BS | % Recovery | True Value QC | RPD | Qualifier |
| Benzene* | <0.050 | 0.050 | 03/09/2016 | ND | 2.08 | 104 | 2.00 | 0.193 | |
| Toluene* | <0.050 | 0.050 | 03/09/2016 | ND | 2.03 | 102 | 2.00 | 0.140 | |
| Ethylbenzene* | <0.050 | 0.050 | 03/09/2016 | ND | 1.83 | 91.3 | 2.00 | 0.480 | |
| Total Xylenes* | <0.150 | 0.150 | 03/09/2016 | ND | 5.63 | 93.8 | 6.00 | 0.275 | |
| Total BTX | <0.300 | 0.300 | 03/09/2016 | ND | | | | | |

Surrogate: 4-Bromofluorobenzene (PID) 96.8 % 73.6-140

| Chloride, SM4500CI-B | | mg/kg | | Analyzed By: AP | | | | | |
|----------------------|--------|-----------------|------------|-----------------|-----|------------|---------------|------|-----------|
| Analyte | Result | Reporting Limit | Analyzed | Method Blank | BS | % Recovery | True Value QC | RPD | Qualifier |
| Chloride | 64.0 | 16.0 | 03/08/2016 | ND | 432 | 108 | 400 | 7.69 | |

| TPH 8015M | | mg/kg | | Analyzed By: CK | | | | | |
|--------------|--------|-----------------|------------|-----------------|-----|------------|---------------|------|-----------|
| Analyte | Result | Reporting Limit | Analyzed | Method Blank | BS | % Recovery | True Value QC | RPD | Qualifier |
| GRO C6-C10 | <10.0 | 10.0 | 03/08/2016 | ND | 198 | 98.8 | 200 | 3.81 | |
| DRO >C10-C28 | 32.0 | 10.0 | 03/08/2016 | ND | 209 | 104 | 200 | 4.50 | |

Surrogate: 1-Chlorooctane 96.0 % 35-147

Surrogate: 1-Chlorooctadecane 98.6 % 28-171

Cardinal Laboratories

*=Accredited Analyte

PLEASE NOTE: Liability and Damages. Cardinal's liability and client's exclusive remedy for any claim arising, whether based in contract or tort, shall be limited to the amount paid by client for analyses. All claims, including those for negligence and any other cause whatsoever shall be deemed waived unless made in writing and received by Cardinal within thirty (30) days after completion of the applicable service. In no event shall Cardinal be liable for incidental or consequential damages, including, without limitation, business interruptions, loss of use, or loss of profits incurred by client, its subsidiaries, affiliates or successors arising out of or related to the performance of the services hereunder by Cardinal, regardless of whether such claim is based upon any of the above stated reasons or otherwise. Results relate only to the samples identified above. This report shall not be reproduced except in full with written approval of Cardinal Laboratories.



Celey D. Keene, Lab Director/Quality Manager

Analytical Results For:

BBC International, Inc.
Cliff Brunson
P.O. Box 805
Hobbs NM, 88241
Fax To: (575) 397-0397

| | | | |
|-------------------|---------------------------|---------------------|---------------|
| Received: | 03/07/2016 | Sampling Date: | 03/02/2016 |
| Reported: | 03/10/2016 | Sampling Type: | Soil |
| Project Name: | GOVERNMENT AB FEDERAL #13 | Sampling Condition: | Cool & Intact |
| Project Number: | NONE GIVEN | Sample Received By: | Jodi Henson |
| Project Location: | CARLSBAD, NM | | |

Sample ID: SP 2 @ 4' (H600489-07)

| BTX 8021B | | mg/kg | | Analyzed By: CK | | | | | |
|----------------|--------|-----------------|------------|-----------------|------|------------|---------------|-------|-----------|
| Analyte | Result | Reporting Limit | Analyzed | Method Blank | BS | % Recovery | True Value QC | RPD | Qualifier |
| Benzene* | <0.050 | 0.050 | 03/09/2016 | ND | 2.08 | 104 | 2.00 | 0.193 | |
| Toluene* | <0.050 | 0.050 | 03/09/2016 | ND | 2.03 | 102 | 2.00 | 0.140 | |
| Ethylbenzene* | <0.050 | 0.050 | 03/09/2016 | ND | 1.83 | 91.3 | 2.00 | 0.480 | |
| Total Xylenes* | <0.150 | 0.150 | 03/09/2016 | ND | 5.63 | 93.8 | 6.00 | 0.275 | |
| Total BTX | <0.300 | 0.300 | 03/09/2016 | ND | | | | | |

Surrogate: 4-Bromofluorobenzene (PID) 96.3 % 73.6-140

| Chloride, SM4500CI-B | | mg/kg | | Analyzed By: AP | | | | | |
|----------------------|--------|-----------------|------------|-----------------|-----|------------|---------------|------|-----------|
| Analyte | Result | Reporting Limit | Analyzed | Method Blank | BS | % Recovery | True Value QC | RPD | Qualifier |
| Chloride | 80.0 | 16.0 | 03/08/2016 | ND | 448 | 112 | 400 | 15.4 | |

| TPH 8015M | | mg/kg | | Analyzed By: CK | | | | | |
|--------------|--------|-----------------|------------|-----------------|-----|------------|---------------|------|-----------|
| Analyte | Result | Reporting Limit | Analyzed | Method Blank | BS | % Recovery | True Value QC | RPD | Qualifier |
| GRO C6-C10 | <10.0 | 10.0 | 03/08/2016 | ND | 198 | 98.8 | 200 | 3.81 | |
| DRO >C10-C28 | 76.7 | 10.0 | 03/08/2016 | ND | 209 | 104 | 200 | 4.50 | |

Surrogate: 1-Chlorooctane 96.5 % 35-147

Surrogate: 1-Chlorooctadecane 100 % 28-171

Cardinal Laboratories

*=Accredited Analyte

PLEASE NOTE: Liability and Damages. Cardinal's liability and client's exclusive remedy for any claim arising, whether based in contract or tort, shall be limited to the amount paid by client for analyses. All claims, including those for negligence and any other cause whatsoever shall be deemed waived unless made in writing and received by Cardinal within thirty (30) days after completion of the applicable service. In no event shall Cardinal be liable for incidental or consequential damages, including, without limitation, business interruptions, loss of use, or loss of profits incurred by client, its subsidiaries, affiliates or successors arising out of or related to the performance of the services hereunder by Cardinal, regardless of whether such claim is based upon any of the above stated reasons or otherwise. Results relate only to the samples identified above. This report shall not be reproduced except in full with written approval of Cardinal Laboratories.



Celey D. Keene, Lab Director/Quality Manager

Analytical Results For:

BBC International, Inc.
Cliff Brunson
P.O. Box 805
Hobbs NM, 88241
Fax To: (575) 397-0397

| | | | |
|-------------------|---------------------------|---------------------|---------------|
| Received: | 03/07/2016 | Sampling Date: | 03/02/2016 |
| Reported: | 03/10/2016 | Sampling Type: | Soil |
| Project Name: | GOVERNMENT AB FEDERAL #13 | Sampling Condition: | Cool & Intact |
| Project Number: | NONE GIVEN | Sample Received By: | Jodi Henson |
| Project Location: | CARLSBAD, NM | | |

Sample ID: SP 2 @ 5' (H600489-08)

| BTEx 8021B | | mg/kg | | Analyzed By: CK | | | | | |
|----------------|--------|-----------------|------------|-----------------|------|------------|---------------|-------|-----------|
| Analyte | Result | Reporting Limit | Analyzed | Method Blank | BS | % Recovery | True Value QC | RPD | Qualifier |
| Benzene* | <0.050 | 0.050 | 03/09/2016 | ND | 2.08 | 104 | 2.00 | 0.193 | |
| Toluene* | <0.050 | 0.050 | 03/09/2016 | ND | 2.03 | 102 | 2.00 | 0.140 | |
| Ethylbenzene* | <0.050 | 0.050 | 03/09/2016 | ND | 1.83 | 91.3 | 2.00 | 0.480 | |
| Total Xylenes* | <0.150 | 0.150 | 03/09/2016 | ND | 5.63 | 93.8 | 6.00 | 0.275 | |
| Total BTEx | <0.300 | 0.300 | 03/09/2016 | ND | | | | | |

Surrogate: 4-Bromofluorobenzene (PID) 98.9 % 73.6-140

| Chloride, SM4500CI-B | | mg/kg | | Analyzed By: AP | | | | | |
|----------------------|--------|-----------------|------------|-----------------|-----|------------|---------------|------|-----------|
| Analyte | Result | Reporting Limit | Analyzed | Method Blank | BS | % Recovery | True Value QC | RPD | Qualifier |
| Chloride | 80.0 | 16.0 | 03/08/2016 | ND | 448 | 112 | 400 | 15.4 | |

| TPH 8015M | | mg/kg | | Analyzed By: CK | | | | | |
|--------------|--------|-----------------|------------|-----------------|-----|------------|---------------|------|-----------|
| Analyte | Result | Reporting Limit | Analyzed | Method Blank | BS | % Recovery | True Value QC | RPD | Qualifier |
| GRO C6-C10 | <10.0 | 10.0 | 03/08/2016 | ND | 198 | 98.8 | 200 | 3.81 | |
| DRO >C10-C28 | <10.0 | 10.0 | 03/08/2016 | ND | 209 | 104 | 200 | 4.50 | |

Surrogate: 1-Chlorooctane 79.4 % 35-147

Surrogate: 1-Chlorooctadecane 87.1 % 28-171

Cardinal Laboratories

*=Accredited Analyte

PLEASE NOTE: Liability and Damages. Cardinal's liability and client's exclusive remedy for any claim arising, whether based in contract or tort, shall be limited to the amount paid by client for analyses. All claims, including those for negligence and any other cause whatsoever shall be deemed waived unless made in writing and received by Cardinal within thirty (30) days after completion of the applicable service. In no event shall Cardinal be liable for incidental or consequential damages, including, without limitation, business interruptions, loss of use, or loss of profits incurred by client, its subsidiaries, affiliates or successors arising out of or related to the performance of the services hereunder by Cardinal, regardless of whether such claim is based upon any of the above stated reasons or otherwise. Results relate only to the samples identified above. This report shall not be reproduced except in full with written approval of Cardinal Laboratories.



Celey D. Keene, Lab Director/Quality Manager

Notes and Definitions

| | |
|-----|--|
| ND | Analyte NOT DETECTED at or above the reporting limit |
| RPD | Relative Percent Difference |
| ** | Samples not received at proper temperature of 6°C or below. |
| *** | Insufficient time to reach temperature. |
| - | Chloride by SM4500Cl-B does not require samples be received at or below 6°C Samples reported on an as received basis (wet) unless otherwise noted on report |

Cardinal Laboratories

*=Accredited Analyte

PLEASE NOTE: Liability and Damages. Cardinal's liability and client's exclusive remedy for any claim arising, whether based in contract or tort, shall be limited to the amount paid by client for analyses. All claims, including those for negligence and any other cause whatsoever shall be deemed waived unless made in writing and received by Cardinal within thirty (30) days after completion of the applicable service. In no event shall Cardinal be liable for incidental or consequential damages, including, without limitation, business interruptions, loss of use, or loss of profits incurred by client, its subsidiaries, affiliates or successors arising out of or related to the performance of the services hereunder by Cardinal, regardless of whether such claim is based upon any of the above stated reasons or otherwise. Results relate only to the samples identified above. This report shall not be reproduced except in full with written approval of Cardinal Laboratories.



Celey D. Keene, Lab Director/Quality Manager



ARDINAL LABORATORIES

101 East Marland, Hobbs, NM 88240
(505) 393-2326 FAX (505) 393-2476

CHAIN-OF-CUSTODY AND ANALYSIS REQUEST

| | | | | | | | | | | | | | | | | | | | | | | | |
|---------------------------------------|--|----------------------|--|--------------------------|--|--------------|--|----------------|--|----------------|--|------|--|--|--|--|--|--|--|--|--|--|--|
| Company Name: BBC International, Inc. | | P.O. #: | | BILL TO | | | | | | | | | | | | | | | | | | | |
| Project Manager: Cliff Brunson | | Company: Pxy | | ANALYSIS REQUEST | | | | | | | | | | | | | | | | | | | |
| Address: P.O. Box 805 | | Attn: | | | | | | | | | | | | | | | | | | | | | |
| City: Hobbs | | State: NM Zip: 88241 | | | | | | | | | | | | | | | | | | | | | |
| Phone #: 575-397-6388 | | Fax #: 575-397-0397 | | | | | | | | | | | | | | | | | | | | | |
| Project #: | | Project Owner: Oxy | | | | | | | | | | | | | | | | | | | | | |
| Project Name: Government AB Field #13 | | City: | | | | | | | | | | | | | | | | | | | | | |
| Project Location: Carlsted | | State: | | | | | | | | | | | | | | | | | | | | | |
| Sample Name: P.O. | | Phone #: | | | | | | | | | | | | | | | | | | | | | |
| FOR LAB USE ONLY | | Fax #: | | | | | | | | | | | | | | | | | | | | | |
| Lab I.D. Sample I.D. | | (G)RAB OR (C)OMP. | | MATRIX | | PRESERV | | SAMPLING | | | | | | | | | | | | | | | |
| H600487 | | # CONTAINERS | | GROUNDWATER | | WASTEWATER | | DATE | | TIME | | | | | | | | | | | | | |
| 1 Sp1e1 | | X | | SOIL | | OIL | | 3-2 | | 1020 | | BTEX | | | | | | | | | | | |
| 2 Sp1e2 | | X | | SLUDGE | | OTHER : | | 1030 | | 1030 | | TPH | | | | | | | | | | | |
| 3 Sp2e1 | | X | | ACID/BASE: | | ICE / COOL | | 1018 | | 1018 | | CI- | | | | | | | | | | | |
| 4 Sp2e1 | | X | | OTHER : | | | | 1201 | | 1201 | | | | | | | | | | | | | |
| 5 Sp2e1 | | X | | | | | | 1111 | | 1111 | | | | | | | | | | | | | |
| 6 Sp2e1 | | X | | | | | | 139 | | 139 | | | | | | | | | | | | | |
| 7 Sp2e1 | | X | | | | | | 155 | | 155 | | | | | | | | | | | | | |
| 8 Sp2e1 | | X | | | | | | 215 | | 215 | | | | | | | | | | | | | |
| Relinquished By: [Signature] | | Date: 3-6-16 | | Received By: [Signature] | | Date: 3-6-16 | | Time: 5:30pm | | Time: 5:30pm | | | | | | | | | | | | | |
| Reinquired By: [Signature] | | Date: 3-6-16 | | Received By: [Signature] | | Date: 3-6-16 | | Time: 5:30pm | | Time: 5:30pm | | | | | | | | | | | | | |
| Delivered By: (Circle One) | | Sample Condition | | Checked By: [Signature] | | Cool Intact | | Yes [X] No [] | | Yes [X] No [] | | | | | | | | | | | | | |
| Sampler - UPS - Bus - Other: | | 1.02 | | 1.02 | | 1.02 | | 1.02 | | 1.02 | | | | | | | | | | | | | |

† Cardinal cannot accept verbal changes. Please fax written changes to 505-393-2476

District I
1625 N. French Dr., Hobbs, NM 88240
District II
811 S. First St., Artesia, NM 88210
District III
1000 Rio Brazos Road, Aztec, NM 87410
District IV
1220 S. St. Francis Dr., Santa Fe, NM 87505

State of New Mexico
Energy Minerals and Natural Resources
Oil Conservation Division
1220 South St. Francis Dr.
Santa Fe, NM 87505

Form C-141
Revised August 8, 2011

Submit 1 Copy to appropriate District Office in
accordance with 19.15.29 NMAC.

Release Notification and Corrective Action

OPERATOR

☒ Initial Report ☐ Final Report

| | | | |
|-----------------|----------------------------------|---------------|----------------------|
| Name of Company | Oxy Permian Ltd. | Contact | Casey Summers |
| Address | 6 Desta Drive, Midland, TX 79705 | Telephone No. | (575) 513-8289 |
| Facility Name | Government AB Federal #13 | Facility Type | Well |
| Surface Owner | BLM | Mineral Owner | API No. 30-015-40920 |

LOCATION OF RELEASE

| | | | | | | | | |
|-------------|---------|----------|-------|---------------|------------------|---------------|----------------|-----------------|
| Unit Letter | Section | Township | Range | Feet from the | North/South Line | Feet from the | East/West Line | County |
| H | 10 | 20S | 28E | | | | | Eddy County, NM |

Latitude N 32.58979° Longitude W 104.15874°

NATURE OF RELEASE

| | | | | | |
|-----------------------------|---|---|---|----------------------------|------------------------------------|
| Type of Release | Oil and Produced water | Volume of Release | 0.5 bbl oil, 15 bbls produced water | Volume Recovered | 2 bbls produced water, skim oil |
| Source of Release | Livestock opened valve at the well head | Date and Hour of Occurrence | 02/11/2016 | Date and Hour of Discovery | |
| Was Immediate Notice Given? | <input checked="" type="checkbox"/> Yes <input type="checkbox"/> No <input type="checkbox"/> Not Required | If YES, To Whom? | Mike Bratcher, Heather Patterson- NMOCD; Shelly Tucker- BLM | | |
| By Whom? | Kathy Purvis @ BBC International Inc. | Date and Hour | 02/12/2016 @ 3:16 pm | | |
| Was a Watercourse Reached? | <input type="checkbox"/> Yes <input checked="" type="checkbox"/> No | If YES, Volume Impacting the Watercourse. | | | |

If a Watercourse was Impacted, Describe Fully.*

Describe Cause of Problem and Remedial Action Taken.*

Livestock opened a valve at the well head spilling 0.5 bbl oil and 15 bbls of produced water. A vacuum truck recovered 2 bbls of produced water and skim oil and the valve was closed.

Describe Area Affected and Cleanup Action Taken.*

The affected area is approximately 105' x 57' on location around the well head. Remediation will be completed in accordance with an approved remediation plan from NMOCD and the BLM.

I hereby certify that the information given above is true and complete to the best of my knowledge and understand that pursuant to NMOCD rules and regulations all operators are required to report and/or file certain release notifications and perform corrective actions for releases which may endanger public health or the environment. The acceptance of a C-141 report by the NMOCD marked as "Final Report" does not relieve the operator of liability should their operations have failed to adequately investigate and remediate contamination that pose a threat to ground water, surface water, human health or the environment. In addition, NMOCD acceptance of a C-141 report does not relieve the operator of responsibility for compliance with any other federal, state, or local laws and/or regulations.

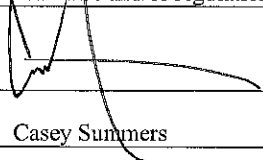
| | | | |
|--|--|---------------------------------------|------------------|
| Signature:  | | <u>OIL CONSERVATION DIVISION</u> | |
| Printed Name: Casey Summers | | Approved by Environmental Specialist: | |
| Title: NM Environmental Advisor | | Approval Date: | Expiration Date: |
| E-mail Address: Casey_Summers@oxy.com | | Conditions of Approval: | |
| Date: 2-23-16 Phone: (575) 513-8289 | | Attached <input type="checkbox"/> | |

* Attach Additional Sheets If Necessary