



PHONE (575) 397-6388 • FAX (575) 397- 0397 • 1324 W. MARLAND • P.O. BOX 805 • HOBBS, NM 88241-0805  
E-MAIL: cbrunson@bbcinternational.com

---

## DELINEATION/REMEDATION WORKPLAN

### OXY – RED TANK 30 31 34H (Leak Date: 8/22/19)

#### RP # 1RP-5713

---

This delineation workplan and remediation proposal addresses the releases associated with RP # 1RP-5713.

The following information includes:

1. Appropriate completed and signed C-141 pages.
2. Scaled digital site map with spill area demarcated and leak point identified along with sample point locations and areas of remediation at appropriate depths.
3. GPS information for sample points and sample methodology.
4. Depth to groundwater information (i.e., pdf of OSE search results, USGS search results, and/or copy of Chevron groundwater trend map).
5. Watercourse/features map within 1000 feet.
6. BLM Cave Karst map.
7. FEMA National Flood map.
8. Laboratory analysis results summary table and original laboratory analysis reports.
9. Potentially other pertinent information as necessary for site specific purposes.

***Based on the information included in this package and the NMOCD rules, the following remediation is proposed:***

***OXY will excavate the spill area as depicted on the following site diagram. The entire leak area will be excavated to a depth of 1 foot.***

***Bottom and confirmation samples will be collected every 75 feet.***

The entire site will then be backfilled with clean soil and revegetated (if warranted) to the standards of the appropriate regulatory agency or private surface owner.

All excavated materials will be disposed of at an NMOCD-approved disposal facility.



Form C-141

Page 3

State of New Mexico  
Oil Conservation Division

Incident ID	
District RP	1RP-5713
Facility ID	
Application ID	

## Site Assessment/Characterization

*This information must be provided to the appropriate district office no later than 90 days after the release discovery date.*

What is the shallowest depth to groundwater beneath the area affected by the release?	391 (ft bgs)
Did this release impact groundwater or surface water?	<input type="checkbox"/> Yes <input checked="" type="checkbox"/> No
Are the lateral extents of the release within 300 feet of a continuously flowing watercourse or any other significant watercourse?	<input type="checkbox"/> Yes <input checked="" type="checkbox"/> No
Are the lateral extents of the release within 200 feet of any lakebed, sinkhole, or playa lake (measured from the ordinary high-water mark)?	<input type="checkbox"/> Yes <input checked="" type="checkbox"/> No
Are the lateral extents of the release within 300 feet of an occupied permanent residence, school, hospital, institution, or church?	<input type="checkbox"/> Yes <input checked="" type="checkbox"/> No
Are the lateral extents of the release within 500 horizontal feet of a spring or a private domestic fresh water well used by less than five households for domestic or stock watering purposes?	<input type="checkbox"/> Yes <input checked="" type="checkbox"/> No
Are the lateral extents of the release within 1000 feet of any other fresh water well or spring?	<input type="checkbox"/> Yes <input checked="" type="checkbox"/> No
Are the lateral extents of the release within incorporated municipal boundaries or within a defined municipal fresh water well field?	<input type="checkbox"/> Yes <input checked="" type="checkbox"/> No
Are the lateral extents of the release within 300 feet of a wetland?	<input type="checkbox"/> Yes <input checked="" type="checkbox"/> No
Are the lateral extents of the release overlying a subsurface mine?	<input type="checkbox"/> Yes <input checked="" type="checkbox"/> No
Are the lateral extents of the release overlying an unstable area such as karst geology?	<input type="checkbox"/> Yes <input checked="" type="checkbox"/> No
Are the lateral extents of the release within a 100-year floodplain?	<input type="checkbox"/> Yes <input checked="" type="checkbox"/> No
Did the release impact areas <b>not</b> on an exploration, development, production, or storage site?	<input type="checkbox"/> Yes <input checked="" type="checkbox"/> No

Attach a comprehensive report (electronic submittals in .pdf format are preferred) demonstrating the lateral and vertical extents of soil contamination associated with the release have been determined. Refer to 19.15.29.11 NMAC for specifics.

**Characterization Report Checklist:** *Each of the following items must be included in the report.*

- ☒ Scaled site map showing impacted area, surface features, subsurface features, delineation points, and monitoring wells.
- ☐ Field data
- ☒ Data table of soil contaminant concentration data
- ☒ Depth to water determination
- ☒ Determination of water sources and significant watercourses within ½-mile of the lateral extents of the release
- ☐ Boring or excavation logs
- ☐ Photographs including date and GIS information
- ☒ Topographic/Aerial maps
- ☒ Laboratory data including chain of custody

If the site characterization report does not include completed efforts at remediation of the release, the report must include a proposed remediation plan. That plan must include the estimated volume of material to be remediated, the proposed remediation technique, proposed sampling plan and methods, anticipated timelines for beginning and completing the remediation. The closure criteria for a release are contained in Table 1 of 19.15.29.12 NMAC, however, use of the table is modified by site- and release-specific parameters.



Form C-141

Page 4

State of New Mexico  
Oil Conservation Division

Incident ID	
District RP	1RP-5713
Facility ID	
Application ID	

I hereby certify that the information given above is true and complete to the best of my knowledge and understand that pursuant to OCD rules and regulations all operators are required to report and/or file certain release notifications and perform corrective actions for releases which may endanger public health or the environment. The acceptance of a C-141 report by the OCD does not relieve the operator of liability should their operations have failed to adequately investigate and remediate contamination that pose a threat to groundwater, surface water, human health or the environment. In addition, OCD acceptance of a C-141 report does not relieve the operator of responsibility for compliance with any other federal, state, or local laws and/or regulations.

Printed Name: Wade Dittrich Title: Environmental CoordinatorSignature:  Date: 10-14-19email: wade\_dittrich@oxy.com Telephone: (575) 390-2828**OCD Only**

Received by: \_\_\_\_\_ Date: \_\_\_\_\_



Form C-141

Page 5

State of New Mexico  
Oil Conservation Division

Incident ID	
District RP	1RP-5713
Facility ID	
Application ID	

## Remediation Plan

**Remediation Plan Checklist:** *Each of the following items must be included in the plan.*

- ☒ Detailed description of proposed remediation technique
- ☒ Scaled sitemap with GPS coordinates showing delineation points
- ☒ Estimated volume of material to be remediated
- ☒ Closure criteria is to Table 1 specifications subject to 19.15.29.12(C)(4) NMAC
- ☒ Proposed schedule for remediation (note if remediation plan timeline is more than 90 days OCD approval is required)

**Deferral Requests Only:** *Each of the following items must be confirmed as part of any request for deferral of remediation.*

- ☐ Contamination must be in areas immediately under or around production equipment where remediation could cause a major facility deconstruction.
- ☐ Extents of contamination must be fully delineated.
- ☐ Contamination does not cause an imminent risk to human health, the environment, or groundwater.

I hereby certify that the information given above is true and complete to the best of my knowledge and understand that pursuant to OCD rules and regulations all operators are required to report and/or file certain release notifications and perform corrective actions for releases which may endanger public health or the environment. The acceptance of a C-141 report by the OCD does not relieve the operator of liability should their operations have failed to adequately investigate and remediate contamination that pose a threat to groundwater, surface water, human health or the environment. In addition, OCD acceptance of a C-141 report does not relieve the operator of responsibility for compliance with any other federal, state, or local laws and/or regulations.

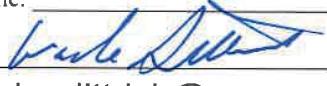
Printed Name: Wade Dittrich Title: Environmental Coordinator  
Signature:  Date: 10-14-19  
email: wade\_dittrich@oxy.com Telephone: (575) 390-2828

**OCD Only**

Received by: \_\_\_\_\_ Date: \_\_\_\_\_

☐ Approved ☐ Approved with Attached Conditions of Approval ☐ Denied ☐ Deferral Approved



Signature: \_\_\_\_\_ Date: \_\_\_\_\_



## Oxy, Red Tank 30 31 34H

Leak date: 8/22/19  
Lea County, NM  
1RP-5713

### Legend

-  1 ft excavation across entire leak area
-  Leak area
-  Sample points





Oxy, Red Tank 30 31 34H

Sample points

SP1, N 32.36958 W-103.60458

SP2, N 32.36971 W-103.60466

SP3, N 32.36981 W-103.60471

NORTH, N 32.36989 W-103.60471

SOUTH, N 32.36956 W-103.60459

EAST, N 32.36957 W-103.60453

WEST, N 32.36975 W-103.60475



**Oxy, Red Tank 30 31 34H**  
**U/L A, Section 30, T22S, R33E**  
**Groundwater: 450'**

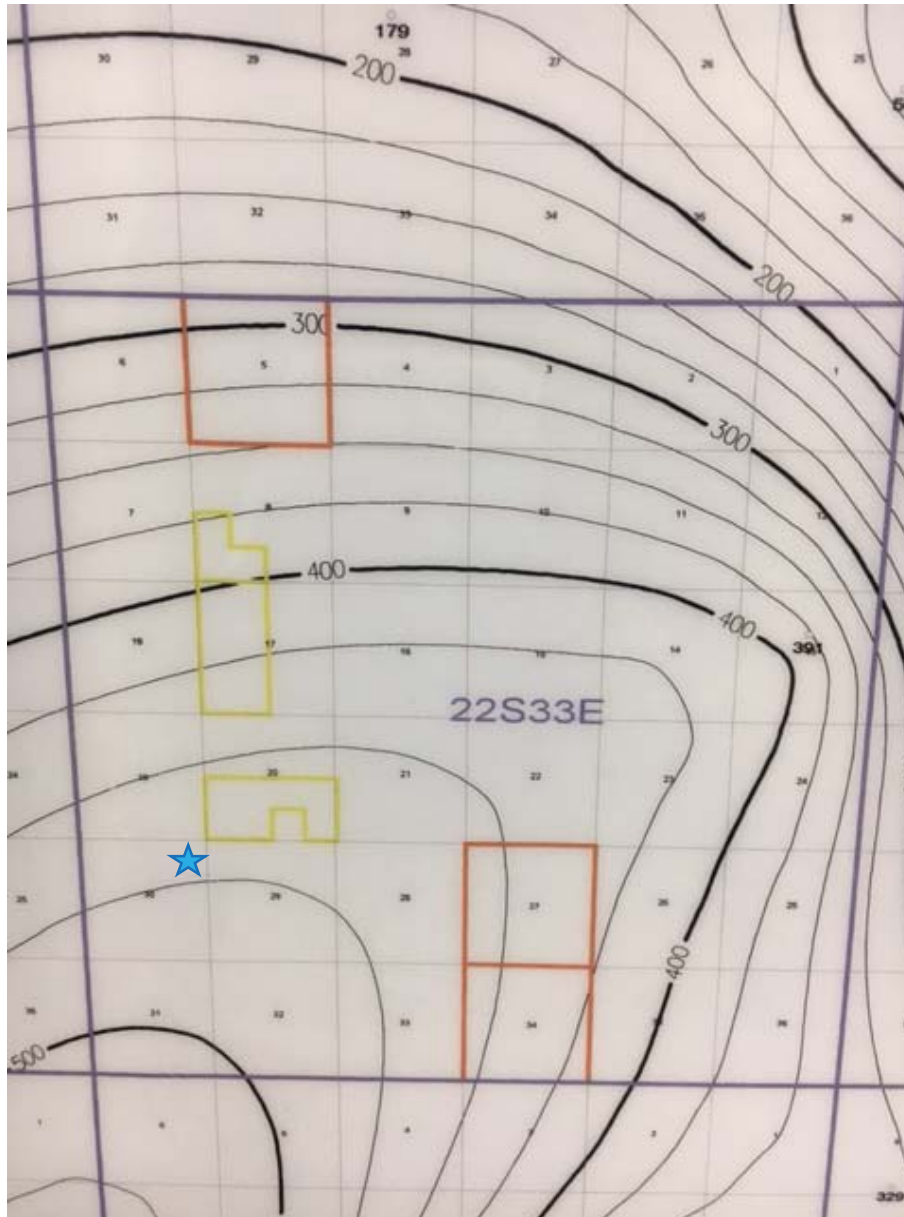





USGS Home  
Contact USGS  
Search USGS

National Water Information System: Web Interface

USGS Water Resources

Data Category:  
Groundwater

Geographic Area:  
New Mexico

GO

Click to hideNews Bulletins

- Introducing The Next Generation of USGS Water Data for the Nation
- Full News

Groundwater levels for New Mexico

Click to hide state-specific text

Search Results -- 1 sites found

Agency code = usgs  
site\_no list =

- 322325103313301

Minimum number of levels = 1  
[Save file of selected sites](#) to local disk for future upload

USGS 322325103313301 22S.33E.13.23131

Lea County, New Mexico  
Latitude 32°23'38.6", Longitude 103°31'33.6" NAD83  
Land-surface elevation 3,519 feet above NAVD88  
The depth of the well is 508 feet below land surface.  
This well is completed in the Chinle Formation (231CHNL) local aquifer.

Output formats

<a href="#">Table of data</a>
<a href="#">Tab-separated data</a>
<a href="#">Graph of data</a>
<a href="#">Reselect period</a>

Date	Time	? Water-level date-time accuracy	Water level, feet below land surface	Water level, feet above specific vertical datum	Referenced vertical datum	? Water-level accuracy	? Status	? Method of measurement	? Measuring agency	? Source of measurem
1968-06-10		D	387.08			2	S		U	
1970-12-04		D	385.19			2	S		U	
1972-09-21		D	388.35			2			U	
1976-12-16		D	388.60			2			U	
1981-03-10		D	389.83			2			U	
1986-04-10		D	383.14			2			U	
1991-05-03		D	390.28			2	P		U	
1996-02-20		D	391.13			2			S	

Explanation		
Section	Code	Description
Water-level date-time accuracy	D	Date is accurate to the Day
Water-level accuracy	2	Water level accuracy to nearest hundredth of a foot
Status		The reported water-level measurement represents a static level
Status	P	Site was being pumped.
Status	S	Nearby site that taps the same aquifer was being pumped.
Method of measurement	S	Steel-tape measurement.



Section	Code	Description
Method of measurement	U	Unknown method.
Measuring agency		Not determined
Source of measurement	U	Source is unknown.
Water-level approval status	A	Approved for publication -- Processing and review completed.

[Questions about sites/data?](#)  
[Feedback on this web site](#)  
[Automated retrievals](#)  
[Help](#)  
[Data Tips](#)  
[Explanation of terms](#)  
[Subscribe for system changes](#)  
[News](#)

[Accessibility](#)   [Plug-Ins](#)   [FOIA](#)   [Privacy](#)   [Policies and Notices](#)

[U.S. Department of the Interior](#) | [U.S. Geological Survey](#)

**Title: Groundwater for New Mexico: Water Levels**  
**URL: <https://nwis.waterdata.usgs.gov/nm/nwis/gwlevels?>**



Page Contact Information: [New Mexico Water Data Maintainer](#)  
Page Last Modified: 2019-09-09 17:10:39 EDT  
0.45 0.43 nadww02



## Red Tank 30 31 34H

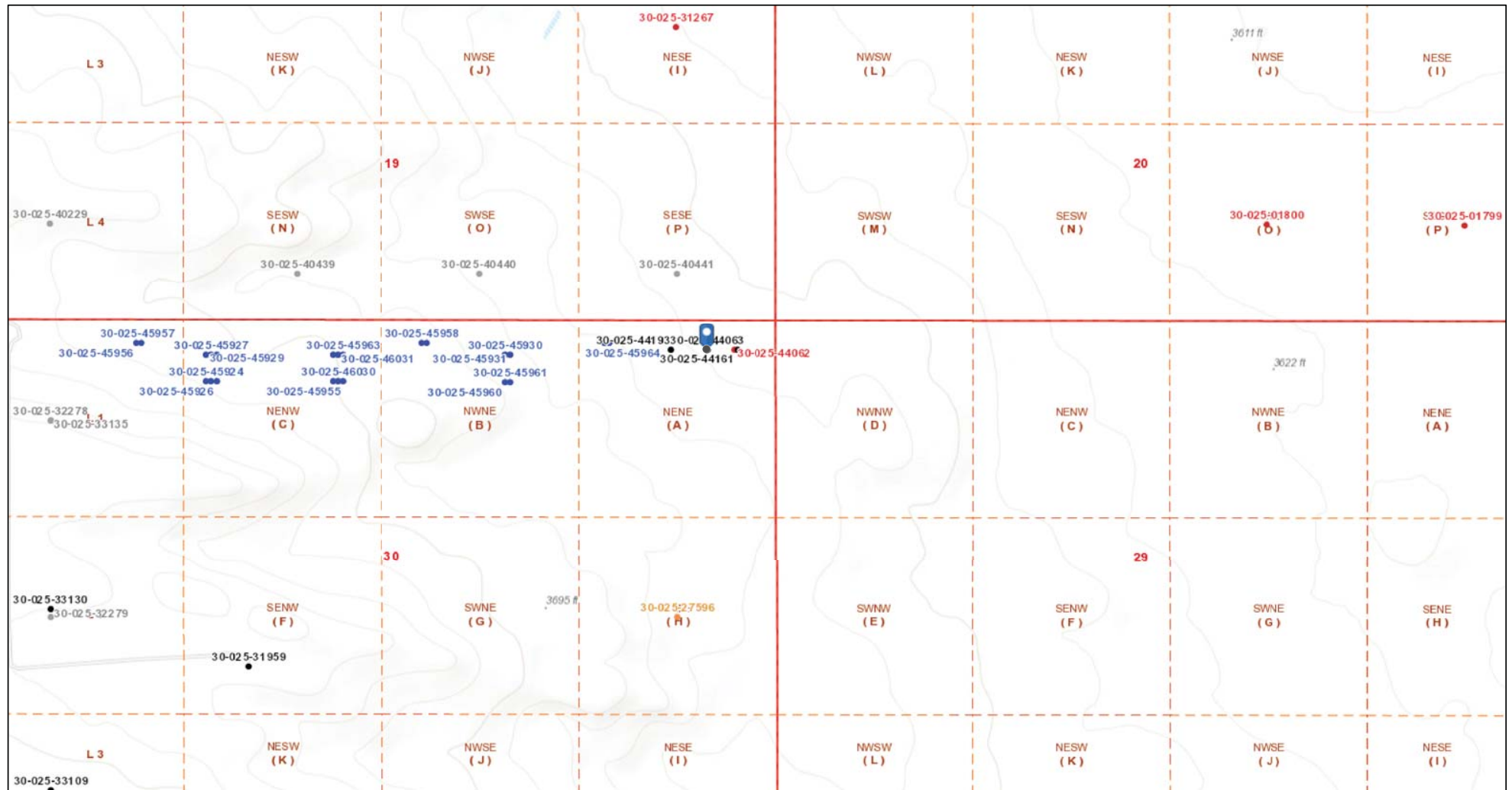

9/9/2019 2:59:33 PM

Well Locations - Small Scale

- Active
- New
- Plugged
- Cancelled
- Temporarily Abandoned

Well Locations - Large Scale

- Miscellaneous
- CO2 Active
- CO2 Cancelled
- CO2 New
- CO2 Plugged
- CO2 Temporarily Abandoned

Gas Active

- Gas, Cancelled, Never Drilled
- Gas, New
- Gas, Plugged
- Gas, Temporarily Abandoned
- Injection, Active

Injection, Cancelled

- Injection, New
- Injection, Plugged
- Injection, Temporarily Abandoned
- Oil, Active
- Oil, Cancelled

Oil, New

- Oil, Plugged
- Oil, Temporarily Abandoned
- Salt Water Injection, Active
- Salt Water Injection, Cancelled
- Salt Water Injection, New

Salt Water Injection, Plugged

- Salt Water Injection Temporarily Abandoned
- Water, Active
- Water, Cancelled
- Water, New
- Water, Plugged

1:9,028

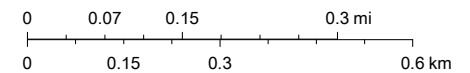

Bureau of Land Management, Texas Parks & Wildlife, Esri, HERE, Garmin, INCREMENT P, Intermap, USGS, METI/NASA, EPA, USDA, OCD, BLM





Oxy, Red Tank 30 31 34H

Leak date: 8/22/19  
Lea County, NM

BLM CAVE KARST MAP

Legend

-  Leak area
-  Low potential





## National Flood Hazard Layer FIRMette



## Legend

SEE FIS REPORT FOR DETAILED LEGEND AND INDEX MAP FOR FIRM PANEL LAYOUT

SPECIAL FLOOD HAZARD AREAS		Without Base Flood Elevation (BFE) Zone A, V, A99
		With BFE or Depth Zone AE, AO, AH, VE, AR
		Regulatory Floodway
OTHER AREAS OF FLOOD HAZARD		0.2% Annual Chance Flood Hazard, Areas of 1% annual chance flood with average depth less than one foot or with drainage areas of less than one square mile Zone X
		Future Conditions 1% Annual Chance Flood Hazard Zone X
		Area with Reduced Flood Risk due to Levee. See Notes. Zone X
		Area with Flood Risk due to Levee Zone D
OTHER AREAS		Area of Minimal Flood Hazard Zone X
		Effective LOMRs
		Area of Undetermined Flood Hazard Zone D
GENERAL STRUCTURES		Channel, Culvert, or Storm Sewer
		Levee, Dike, or Floodwall
OTHER FEATURES		Cross Sections with 1% Annual Chance Water Surface Elevation
		Coastal Transect
		Base Flood Elevation Line (BFE)
		Limit of Study
		Jurisdiction Boundary
		Coastal Transect Baseline
		Profile Baseline
MAP PANELS		Digital Data Available
		No Digital Data Available
		Unmapped



The pin displayed on the map is an approximate point selected by the user and does not represent an authoritative property location.

This map complies with FEMA's standards for the use of digital flood maps if it is not void as described below. The basemap shown complies with FEMA's basemap accuracy standards

The flood hazard information is derived directly from the authoritative NFHL web services provided by FEMA. This map was exported on 9/9/2019 at 5:20:19 PM and does not reflect changes or amendments subsequent to this date and time. The NFHL and effective information may change or become superseded by new data over time.

This map image is void if the one or more of the following map elements do not appear: basemap imagery, flood zone labels, legend, scale bar, map creation date, community identifiers, FIRM panel number, and FIRM effective date. Map images for unmapped and unmodernized areas cannot be used for regulatory purposes.

32°22'25.54"N

103°36'35.25"W

T22S R33E S19

T22S R33E S20

LEA COUNTY  
350130

Zone D

35025C1750D  
12/16/2008  
Not Printed

T22S R33E S30

T22S R33E S29

USGS The National Map: Orthoimagery. Data refreshed April, 2019.

32°21'55.15"N

103°35'57.80"W

0 250 500 1,000 1,500 2,000 Feet

1:6,000



Laboratory Analytical Results Summary  
Red Tank 30 31 34H (8/22/19)

		Sample ID	SP1 @ SURFACE	SP1 @ 1'	SP1 @ 2'	SP1 @ 3'
Analyte	Method	Date	9/19/19	9/19/19	9/19/19	9/19/19
			mg/kg	mg/kg	mg/kg	mg/kg
Benzene	BTEX 8021B		<0.050	<0.050	n/a	n/a
Toluene	BTEX 8021B		<0.050	<0.050	n/a	n/a
Ethylbenzene	BTEX 8021B		<0.050	<0.050	n/a	n/a
Total Xylenes	BTEX 8021B		<0.150	<0.150	n/a	n/a
Total BTEX	BTEX 8021B		<0.300	<0.300	n/a	n/a
Chloride	SM4500Cl-B		10000	480	48	32
GRO	TPH 8015M		<10.0	<10.0	n/a	n/a
DRO	TPH 8015M		7480	<10.0	n/a	n/a
EXT DRO	TPH 8015M		2380	<10.0	n/a	n/a

		Sample ID	SP2 @ SURFACE	SP2 @ 1'	SP2 @ 2'	SP2 @ 3'
Analyte	Method	Date	9/19/19	9/19/19	9/19/19	9/19/19
			mg/kg	mg/kg	mg/kg	mg/kg
Benzene	BTEX 8021B		<0.050	<0.050	n/a	n/a
Toluene	BTEX 8021B		<0.050	<0.050	n/a	n/a
Ethylbenzene	BTEX 8021B		<0.050	<0.050	n/a	n/a
Total Xylenes	BTEX 8021B		<0.150	<0.150	n/a	n/a
Total BTEX	BTEX 8021B		<0.300	<0.300	n/a	n/a
Chloride	SM4500Cl-B		9440	672	48	<16.0
GRO	TPH 8015M		<10.0	<10.0	n/a	n/a
DRO	TPH 8015M		9780	<10.0	n/a	n/a
EXT DRO	TPH 8015M		2960	<10.0	n/a	n/a

		Sample ID	SP3 @ SURFACE	SP3 @ 1'	SP3 @ 2'	SP3 @ 3'
Analyte	Method	Date	9/19/19	9/19/19	9/19/19	9/19/19
			mg/kg	mg/kg	mg/kg	mg/kg
Benzene	BTEX 8021B		<0.050	<0.050	n/a	n/a
Toluene	BTEX 8021B		<0.050	<0.050	n/a	n/a
Ethylbenzene	BTEX 8021B		<0.050	<0.050	n/a	n/a
Total Xylenes	BTEX 8021B		<0.150	<0.150	n/a	n/a
Total BTEX	BTEX 8021B		<0.300	<0.300	n/a	n/a
Chloride	SM4500Cl-B		8960	544	96	32
GRO	TPH 8015M		<10.0	<10.0	n/a	n/a
DRO	TPH 8015M		9130	<10.0	n/a	n/a
EXT DRO	TPH 8015M		2760	<10.0	n/a	n/a

		Sample ID	NORTH @ SURFACE	EAST @ SURFACE	WEST @ SURFACE	SOUTH @ SURFACE
Analyte	Method	Date	9/19/19	9/19/19	9/19/19	9/19/19
			mg/kg	mg/kg	mg/kg	mg/kg
Benzene	BTEX 8021B		<0.050	<0.050	<0.050	<0.050
Toluene	BTEX 8021B		<0.050	<0.050	<0.050	<0.050
Ethylbenzene	BTEX 8021B		<0.050	<0.050	<0.050	<0.050
Total Xylenes	BTEX 8021B		<0.150	<0.150	<0.150	<0.150
Total BTEX	BTEX 8021B		<0.300	<0.300	<0.300	<0.300
Chloride	SM4500Cl-B		<16.0	<16.0	<16.0	32
GRO	TPH 8015M		<10.0	<10.0	<10.0	<10.0
DRO	TPH 8015M		<10.0	<10.0	<10.0	<10.0
EXT DRO	TPH 8015M		<10.0	<10.0	<10.0	<10.0





PHONE (575) 393-2326 ° 101 E. MARLAND ° HOBBS, NM 88240

---

September 26, 2019

Cliff Brunson

BBC International, Inc.

P.O. Box 805

Hobbs, NM 88241

RE: RED TANK 30-31 34H

Enclosed are the results of analyses for samples received by the laboratory on 09/23/19 11:20.

Cardinal Laboratories is accredited through Texas NELAP under certificate number T104704398-18-11. Accreditation applies to drinking water, non-potable water and solid and chemical materials. All accredited analytes are denoted by an asterisk (\*). For a complete list of accredited analytes and matrices visit the TCEQ website at [www.tceq.texas.gov/field/qa/lab\\_accred\\_certif.html](http://www.tceq.texas.gov/field/qa/lab_accred_certif.html).

Cardinal Laboratories is accredited through the State of Colorado Department of Public Health and Environment for:

Method EPA 552.2	Haloacetic Acids (HAA-5)
Method EPA 524.2	Total Trihalomethanes (TTHM)
Method EPA 524.4	Regulated VOCs (V1, V2, V3)

Accreditation applies to public drinking water matrices.

This report meets NELAP requirements and is made up of a cover page, analytical results, and a copy of the original chain-of-custody. If you have any questions concerning this report, please feel free to contact me.

Sincerely,

A handwritten signature in black ink that reads "Coley D. Keene". The signature is written in a cursive style with a large, stylized 'C' at the beginning.

Celey D. Keene

Lab Director/Quality Manager





PHONE (575) 393-2326 ° 101 E. MARLAND ° HOBBS, NM 88240

**Analytical Results For:**

BBC International, Inc.  
 Cliff Brunson  
 P.O. Box 805  
 Hobbs NM, 88241  
 Fax To: (575) 397-0397

Received: 09/23/2019  
 Reported: 09/26/2019  
 Project Name: RED TANK 30-31 34H  
 Project Number: 8/22/19  
 Project Location: OXY

Sampling Date: 09/19/2019  
 Sampling Type: Soil  
 Sampling Condition: Cool & Intact  
 Sample Received By: Tamara Oldaker

**Sample ID: SP 1 @ SURFACE (H903259-01)**

BTEX 8021B		mg/kg		Analyzed By: BF						
Analyte	Result	Reporting Limit	Analyzed	Method Blank	BS	% Recovery	True Value QC	RPD	Qualifier	
Benzene*	<0.050	0.050	09/24/2019	ND	1.86	93.1	2.00	1.03		
Toluene*	<0.050	0.050	09/24/2019	ND	1.84	92.2	2.00	0.422		
Ethylbenzene*	<0.050	0.050	09/24/2019	ND	1.82	91.0	2.00	1.55		
Total Xylenes*	<0.150	0.150	09/24/2019	ND	5.46	91.1	6.00	1.46		
Total BTEX	<0.300	0.300	09/24/2019	ND						

Surrogate: 4-Bromofluorobenzene (PID) 81.1 % 73.3-129

Chloride, SM4500Cl-B		mg/kg		Analyzed By: AC						
Analyte	Result	Reporting Limit	Analyzed	Method Blank	BS	% Recovery	True Value QC	RPD	Qualifier	
Chloride	10000	16.0	09/24/2019	ND	432	108	400	0.00		

TPH 8015M		mg/kg		Analyzed By: MS				S-04	
Analyte	Result	Reporting Limit	Analyzed	Method Blank	BS	% Recovery	True Value QC	RPD	Qualifier
GRO C6-C10*	<10.0	10.0	09/23/2019	ND	202	101	200	0.0144	
DRO >C10-C28*	7480	10.0	09/23/2019	ND	199	99.6	200	10.3	
EXT DRO >C28-C36	2380	10.0	09/23/2019	ND					

Surrogate: 1-Chlorooctane 85.9 % 41-142

Surrogate: 1-Chlorooctadecane 382 % 37.6-147

Cardinal Laboratories

\*=Accredited Analyte

PLEASE NOTE: Liability and Damages. Cardinal's liability and client's exclusive remedy for any claim arising, whether based in contract or tort, shall be limited to the amount paid by client for analyses. All claims, including those for negligence and any other cause whatsoever shall be deemed waived unless made in writing and received by Cardinal within thirty (30) days after completion of the applicable service. In no event shall Cardinal be liable for incidental or consequential damages, including, without limitation, business interruptions, loss of use, or loss of profits incurred by client, its subsidiaries, affiliates or successors arising out of or related to the performance of the services hereunder by Cardinal, regardless of whether such claim is based upon any of the above stated reasons or otherwise. Results relate only to the samples identified above. This report shall not be reproduced except in full with written approval of Cardinal Laboratories.

Celey D. Keene, Lab Director/Quality Manager





PHONE (575) 393-2326 ° 101 E. MARLAND ° HOBBS, NM 88240

**Analytical Results For:**

BBC International, Inc.  
 Cliff Brunson  
 P.O. Box 805  
 Hobbs NM, 88241  
 Fax To: (575) 397-0397

Received: 09/23/2019  
 Reported: 09/26/2019  
 Project Name: RED TANK 30-31 34H  
 Project Number: 8/22/19  
 Project Location: OXY

Sampling Date: 09/19/2019  
 Sampling Type: Soil  
 Sampling Condition: Cool & Intact  
 Sample Received By: Tamara Oldaker

**Sample ID: SP 1 @ 1' (H903259-02)**

BTEX 8021B			mg/kg		Analyzed By: BF				
Analyte	Result	Reporting Limit	Analyzed	Method Blank	BS	% Recovery	True Value QC	RPD	Qualifier
Benzene*	<0.050	0.050	09/24/2019	ND	1.86	93.1	2.00	1.03	
Toluene*	<0.050	0.050	09/24/2019	ND	1.84	92.2	2.00	0.422	
Ethylbenzene*	<0.050	0.050	09/24/2019	ND	1.82	91.0	2.00	1.55	
Total Xylenes*	<0.150	0.150	09/24/2019	ND	5.46	91.1	6.00	1.46	
Total BTEX	<0.300	0.300	09/24/2019	ND					

Surrogate: 4-Bromofluorobenzene (PID) 83.4 % 73.3-129

Chloride, SM4500Cl-B			mg/kg		Analyzed By: AC				
Analyte	Result	Reporting Limit	Analyzed	Method Blank	BS	% Recovery	True Value QC	RPD	Qualifier
Chloride	480	16.0	09/24/2019	ND	432	108	400	0.00	

TPH 8015M			mg/kg		Analyzed By: MS				
Analyte	Result	Reporting Limit	Analyzed	Method Blank	BS	% Recovery	True Value QC	RPD	Qualifier
GRO C6-C10*	<10.0	10.0	09/24/2019	ND	202	101	200	0.0144	
DRO >C10-C28*	<10.0	10.0	09/24/2019	ND	199	99.6	200	10.3	
EXT DRO >C28-C36	<10.0	10.0	09/24/2019	ND					

Surrogate: 1-Chlorooctane 92.8 % 41-142

Surrogate: 1-Chlorooctadecane 100 % 37.6-147

Cardinal Laboratories

\*=Accredited Analyte

PLEASE NOTE: Liability and Damages. Cardinal's liability and client's exclusive remedy for any claim arising, whether based in contract or tort, shall be limited to the amount paid by client for analyses. All claims, including those for negligence and any other cause whatsoever shall be deemed waived unless made in writing and received by Cardinal within thirty (30) days after completion of the applicable service. In no event shall Cardinal be liable for incidental or consequential damages, including, without limitation, business interruptions, loss of use, or loss of profits incurred by client, its subsidiaries, affiliates or successors arising out of or related to the performance of the services hereunder by Cardinal, regardless of whether such claim is based upon any of the above stated reasons or otherwise. Results relate only to the samples identified above. This report shall not be reproduced except in full with written approval of Cardinal Laboratories.

Celey D. Keene, Lab Director/Quality Manager





PHONE (575) 393-2326 ° 101 E. MARLAND ° HOBBS, NM 88240

**Analytical Results For:**

BBC International, Inc.  
 Cliff Brunson  
 P.O. Box 805  
 Hobbs NM, 88241  
 Fax To: (575) 397-0397

Received:	09/23/2019	Sampling Date:	09/19/2019
Reported:	09/26/2019	Sampling Type:	Soil
Project Name:	RED TANK 30-31 34H	Sampling Condition:	Cool & Intact
Project Number:	8/22/19	Sample Received By:	Tamara Oldaker
Project Location:	OXY		

**Sample ID: SP 1 @ 2' (H903259-03)**

Chloride, SM4500Cl-B		mg/kg		Analyzed By: AC					
Analyte	Result	Reporting Limit	Analyzed	Method Blank	BS	% Recovery	True Value QC	RPD	Qualifier
Chloride	48.0	16.0	09/24/2019	ND	432	108	400	0.00	

**Sample ID: SP 1 @ 3' (H903259-04)**

Chloride, SM4500Cl-B		mg/kg		Analyzed By: AC						
Analyte	Result	Reporting Limit	Analyzed	Method Blank	BS	% Recovery	True Value QC	RPD	Qualifier	
Chloride	32.0	16.0	09/24/2019	ND	432	108	400	0.00		

Cardinal Laboratories

\*=Accredited Analyte

PLEASE NOTE: Liability and Damages. Cardinal's liability and client's exclusive remedy for any claim arising, whether based in contract or tort, shall be limited to the amount paid by client for analyses. All claims, including those for negligence and any other cause whatsoever shall be deemed waived unless made in writing and received by Cardinal within thirty (30) days after completion of the applicable service. In no event shall Cardinal be liable for incidental or consequential damages, including, without limitation, business interruptions, loss of use, or loss of profits incurred by client, its subsidiaries, affiliates or successors arising out of or related to the performance of the services hereunder by Cardinal, regardless of whether such claim is based upon any of the above stated reasons or otherwise. Results relate only to the samples identified above. This report shall not be reproduced except in full with written approval of Cardinal Laboratories.

Celey D. Keene, Lab Director/Quality Manager





PHONE (575) 393-2326 ° 101 E. MARLAND ° HOBBS, NM 88240

**Analytical Results For:**

BBC International, Inc.  
 Cliff Brunson  
 P.O. Box 805  
 Hobbs NM, 88241  
 Fax To: (575) 397-0397

Received: 09/23/2019  
 Reported: 09/26/2019  
 Project Name: RED TANK 30-31 34H  
 Project Number: 8/22/19  
 Project Location: OXY

Sampling Date: 09/19/2019  
 Sampling Type: Soil  
 Sampling Condition: Cool & Intact  
 Sample Received By: Tamara Oldaker

**Sample ID: SP 2 @ SURFACE (H903259-05)**

BTEX 8021B		mg/kg	Analyzed By: BF						
Analyte	Result	Reporting Limit	Analyzed	Method Blank	BS	% Recovery	True Value QC	RPD	Qualifier
Benzene*	<0.050	0.050	09/24/2019	ND	1.86	93.1	2.00	1.03	
Toluene*	<0.050	0.050	09/24/2019	ND	1.84	92.2	2.00	0.422	
Ethylbenzene*	<0.050	0.050	09/24/2019	ND	1.82	91.0	2.00	1.55	
Total Xylenes*	<0.150	0.150	09/24/2019	ND	5.46	91.1	6.00	1.46	
Total BTEX	<0.300	0.300	09/24/2019	ND					

Surrogate: 4-Bromofluorobenzene (PID) 79.1 % 73.3-129

Chloride, SM4500Cl-B		mg/kg	Analyzed By: AC						
Analyte	Result	Reporting Limit	Analyzed	Method Blank	BS	% Recovery	True Value QC	RPD	Qualifier
Chloride	9440	16.0	09/24/2019	ND	432	108	400	0.00	

TPH 8015M		mg/kg	Analyzed By: MS							S-04
Analyte	Result	Reporting Limit	Analyzed	Method Blank	BS	% Recovery	True Value QC	RPD	Qualifier	
GRO C6-C10*	<10.0	10.0	09/24/2019	ND	202	101	200	0.0144		
DRO >C10-C28*	9780	10.0	09/24/2019	ND	199	99.6	200	10.3		
EXT DRO >C28-C36	2960	10.0	09/24/2019	ND						

Surrogate: 1-Chlorooctane 91.4 % 41-142

Surrogate: 1-Chlorooctadecane 485 % 37.6-147

Cardinal Laboratories

\*=Accredited Analyte

PLEASE NOTE: Liability and Damages. Cardinal's liability and client's exclusive remedy for any claim arising, whether based in contract or tort, shall be limited to the amount paid by client for analyses. All claims, including those for negligence and any other cause whatsoever shall be deemed waived unless made in writing and received by Cardinal within thirty (30) days after completion of the applicable service. In no event shall Cardinal be liable for incidental or consequential damages, including, without limitation, business interruptions, loss of use, or loss of profits incurred by client, its subsidiaries, affiliates or successors arising out of or related to the performance of the services hereunder by Cardinal, regardless of whether such claim is based upon any of the above stated reasons or otherwise. Results relate only to the samples identified above. This report shall not be reproduced except in full with written approval of Cardinal Laboratories.

Celey D. Keene, Lab Director/Quality Manager





PHONE (575) 393-2326 ° 101 E. MARLAND ° HOBBS, NM 88240

**Analytical Results For:**

BBC International, Inc.  
 Cliff Brunson  
 P.O. Box 805  
 Hobbs NM, 88241  
 Fax To: (575) 397-0397

Received: 09/23/2019  
 Reported: 09/26/2019  
 Project Name: RED TANK 30-31 34H  
 Project Number: 8/22/19  
 Project Location: OXY

Sampling Date: 09/19/2019  
 Sampling Type: Soil  
 Sampling Condition: Cool & Intact  
 Sample Received By: Tamara Oldaker

**Sample ID: SP 2 @ 1' (H903259-06)**

BTEX 8021B			mg/kg		Analyzed By: BF				
Analyte	Result	Reporting Limit	Analyzed	Method Blank	BS	% Recovery	True Value QC	RPD	Qualifier
Benzene*	<0.050	0.050	09/24/2019	ND	1.86	93.1	2.00	1.03	
Toluene*	<0.050	0.050	09/24/2019	ND	1.84	92.2	2.00	0.422	
Ethylbenzene*	<0.050	0.050	09/24/2019	ND	1.82	91.0	2.00	1.55	
Total Xylenes*	<0.150	0.150	09/24/2019	ND	5.46	91.1	6.00	1.46	
Total BTEX	<0.300	0.300	09/24/2019	ND					

Surrogate: 4-Bromofluorobenzene (PID) 81.4 % 73.3-129

Chloride, SM4500Cl-B			mg/kg		Analyzed By: AC				
Analyte	Result	Reporting Limit	Analyzed	Method Blank	BS	% Recovery	True Value QC	RPD	Qualifier
Chloride	672	16.0	09/24/2019	ND	432	108	400	0.00	

TPH 8015M			mg/kg		Analyzed By: MS				
Analyte	Result	Reporting Limit	Analyzed	Method Blank	BS	% Recovery	True Value QC	RPD	Qualifier
GRO C6-C10*	<10.0	10.0	09/24/2019	ND	202	101	200	0.0144	
DRO >C10-C28*	<10.0	10.0	09/24/2019	ND	199	99.6	200	10.3	
EXT DRO >C28-C36	<10.0	10.0	09/24/2019	ND					

Surrogate: 1-Chlorooctane 86.7 % 41-142

Surrogate: 1-Chlorooctadecane 94.4 % 37.6-147

Cardinal Laboratories

\*=Accredited Analyte

PLEASE NOTE: Liability and Damages. Cardinal's liability and client's exclusive remedy for any claim arising, whether based in contract or tort, shall be limited to the amount paid by client for analyses. All claims, including those for negligence and any other cause whatsoever shall be deemed waived unless made in writing and received by Cardinal within thirty (30) days after completion of the applicable service. In no event shall Cardinal be liable for incidental or consequential damages, including, without limitation, business interruptions, loss of use, or loss of profits incurred by client, its subsidiaries, affiliates or successors arising out of or related to the performance of the services hereunder by Cardinal, regardless of whether such claim is based upon any of the above stated reasons or otherwise. Results relate only to the samples identified above. This report shall not be reproduced except in full with written approval of Cardinal Laboratories.

Celey D. Keene, Lab Director/Quality Manager





PHONE (575) 393-2326 ° 101 E. MARLAND ° HOBBS, NM 88240

**Analytical Results For:**

BBC International, Inc.  
 Cliff Brunson  
 P.O. Box 805  
 Hobbs NM, 88241  
 Fax To: (575) 397-0397

Received:	09/23/2019	Sampling Date:	09/19/2019
Reported:	09/26/2019	Sampling Type:	Soil
Project Name:	RED TANK 30-31 34H	Sampling Condition:	Cool & Intact
Project Number:	8/22/19	Sample Received By:	Tamara Oldaker
Project Location:	OXY		

**Sample ID: SP 2 @ 2' (H903259-07)**

Chloride, SM4500Cl-B		mg/kg		Analyzed By: AC					
Analyte	Result	Reporting Limit	Analyzed	Method Blank	BS	% Recovery	True Value QC	RPD	Qualifier
Chloride	48.0	16.0	09/24/2019	ND	432	108	400	0.00	

**Sample ID: SP 2 @ 3' (H903259-08)**

Chloride, SM4500Cl-B		mg/kg		Analyzed By: AC						
Analyte	Result	Reporting Limit	Analyzed	Method Blank	BS	% Recovery	True Value QC	RPD	Qualifier	
Chloride	<16.0	16.0	09/24/2019	ND	432	108	400	0.00		

Cardinal Laboratories

\*=Accredited Analyte

PLEASE NOTE: Liability and Damages. Cardinal's liability and client's exclusive remedy for any claim arising, whether based in contract or tort, shall be limited to the amount paid by client for analyses. All claims, including those for negligence and any other cause whatsoever shall be deemed waived unless made in writing and received by Cardinal within thirty (30) days after completion of the applicable service. In no event shall Cardinal be liable for incidental or consequential damages, including, without limitation, business interruptions, loss of use, or loss of profits incurred by client, its subsidiaries, affiliates or successors arising out of or related to the performance of the services hereunder by Cardinal, regardless of whether such claim is based upon any of the above stated reasons or otherwise. Results relate only to the samples identified above. This report shall not be reproduced except in full with written approval of Cardinal Laboratories.

Celey D. Keene, Lab Director/Quality Manager





PHONE (575) 393-2326 ° 101 E. MARLAND ° HOBBS, NM 88240

**Analytical Results For:**

BBC International, Inc.  
 Cliff Brunson  
 P.O. Box 805  
 Hobbs NM, 88241  
 Fax To: (575) 397-0397

Received: 09/23/2019  
 Reported: 09/26/2019  
 Project Name: RED TANK 30-31 34H  
 Project Number: 8/22/19  
 Project Location: OXY

Sampling Date: 09/19/2019  
 Sampling Type: Soil  
 Sampling Condition: Cool & Intact  
 Sample Received By: Tamara Oldaker

**Sample ID: SP 3 @ SURFACE (H903259-09)**

BTEX 8021B		mg/kg		Analyzed By: BF						
Analyte	Result	Reporting Limit	Analyzed	Method Blank	BS	% Recovery	True Value QC	RPD	Qualifier	
Benzene*	<0.050	0.050	09/24/2019	ND	1.86	93.1	2.00	1.03		
Toluene*	<0.050	0.050	09/24/2019	ND	1.84	92.2	2.00	0.422		
Ethylbenzene*	<0.050	0.050	09/24/2019	ND	1.82	91.0	2.00	1.55		
Total Xylenes*	<0.150	0.150	09/24/2019	ND	5.46	91.1	6.00	1.46		
Total BTEX	<0.300	0.300	09/24/2019	ND						

Surrogate: 4-Bromofluorobenzene (PID) 78.8 % 73.3-129

Chloride, SM4500Cl-B		mg/kg		Analyzed By: AC					
Analyte	Result	Reporting Limit	Analyzed	Method Blank	BS	% Recovery	True Value QC	RPD	Qualifier
Chloride	8960	16.0	09/24/2019	ND	432	108	400	0.00	

TPH 8015M		mg/kg		Analyzed By: MS					S-04	
Analyte	Result	Reporting Limit	Analyzed	Method Blank	BS	% Recovery	True Value QC	RPD	Qualifier	
GRO C6-C10*	<10.0	10.0	09/24/2019	ND	202	101	200	0.0144		
DRO >C10-C28*	9130	10.0	09/24/2019	ND	199	99.6	200	10.3		
EXT DRO >C28-C36	2760	10.0	09/24/2019	ND						

Surrogate: 1-Chlorooctane 87.1 % 41-142

Surrogate: 1-Chlorooctadecane 456 % 37.6-147

Cardinal Laboratories

\*=Accredited Analyte

PLEASE NOTE: Liability and Damages. Cardinal's liability and client's exclusive remedy for any claim arising, whether based in contract or tort, shall be limited to the amount paid by client for analyses. All claims, including those for negligence and any other cause whatsoever shall be deemed waived unless made in writing and received by Cardinal within thirty (30) days after completion of the applicable service. In no event shall Cardinal be liable for incidental or consequential damages, including, without limitation, business interruptions, loss of use, or loss of profits incurred by client, its subsidiaries, affiliates or successors arising out of or related to the performance of the services hereunder by Cardinal, regardless of whether such claim is based upon any of the above stated reasons or otherwise. Results relate only to the samples identified above. This report shall not be reproduced except in full with written approval of Cardinal Laboratories.

Celey D. Keene, Lab Director/Quality Manager





PHONE (575) 393-2326 ° 101 E. MARLAND ° HOBBS, NM 88240

**Analytical Results For:**

BBC International, Inc.  
 Cliff Brunson  
 P.O. Box 805  
 Hobbs NM, 88241  
 Fax To: (575) 397-0397

Received:	09/23/2019	Sampling Date:	09/19/2019
Reported:	09/26/2019	Sampling Type:	Soil
Project Name:	RED TANK 30-31 34H	Sampling Condition:	Cool & Intact
Project Number:	8/22/19	Sample Received By:	Tamara Oldaker
Project Location:	OXY		

**Sample ID: SP 3 @ 1' (H903259-10)**

BTEX 8021B			mg/kg		Analyzed By: BF				
Analyte	Result	Reporting Limit	Analyzed	Method Blank	BS	% Recovery	True Value QC	RPD	Qualifier
Benzene*	<0.050	0.050	09/24/2019	ND	1.86	93.1	2.00	1.03	
Toluene*	<0.050	0.050	09/24/2019	ND	1.84	92.2	2.00	0.422	
Ethylbenzene*	<0.050	0.050	09/24/2019	ND	1.82	91.0	2.00	1.55	
Total Xylenes*	<0.150	0.150	09/24/2019	ND	5.46	91.1	6.00	1.46	
Total BTEX	<0.300	0.300	09/24/2019	ND					

Surrogate: 4-Bromofluorobenzene (PID) 81.4 % 73.3-129

Chloride, SM4500Cl-B			mg/kg		Analyzed By: AC				
Analyte	Result	Reporting Limit	Analyzed	Method Blank	BS	% Recovery	True Value QC	RPD	Qualifier
Chloride	544	16.0	09/24/2019	ND	432	108	400	0.00	

TPH 8015M			mg/kg		Analyzed By: MS				
Analyte	Result	Reporting Limit	Analyzed	Method Blank	BS	% Recovery	True Value QC	RPD	Qualifier
GRO C6-C10*	<10.0	10.0	09/24/2019	ND	202	101	200	0.0144	
DRO >C10-C28*	<10.0	10.0	09/24/2019	ND	199	99.6	200	10.3	
EXT DRO >C28-C36	<10.0	10.0	09/24/2019	ND					

Surrogate: 1-Chlorooctane 88.6 % 41-142

Surrogate: 1-Chlorooctadecane 97.0 % 37.6-147

Cardinal Laboratories

\*=Accredited Analyte

PLEASE NOTE: Liability and Damages. Cardinal's liability and client's exclusive remedy for any claim arising, whether based in contract or tort, shall be limited to the amount paid by client for analyses. All claims, including those for negligence and any other cause whatsoever shall be deemed waived unless made in writing and received by Cardinal within thirty (30) days after completion of the applicable service. In no event shall Cardinal be liable for incidental or consequential damages, including, without limitation, business interruptions, loss of use, or loss of profits incurred by client, its subsidiaries, affiliates or successors arising out of or related to the performance of the services hereunder by Cardinal, regardless of whether such claim is based upon any of the above stated reasons or otherwise. Results relate only to the samples identified above. This report shall not be reproduced except in full with written approval of Cardinal Laboratories.

Celey D. Keene, Lab Director/Quality Manager





PHONE (575) 393-2326 ° 101 E. MARLAND ° HOBBS, NM 88240

**Analytical Results For:**

BBC International, Inc.  
 Cliff Brunson  
 P.O. Box 805  
 Hobbs NM, 88241  
 Fax To: (575) 397-0397

Received:	09/23/2019	Sampling Date:	09/19/2019
Reported:	09/26/2019	Sampling Type:	Soil
Project Name:	RED TANK 30-31 34H	Sampling Condition:	Cool & Intact
Project Number:	8/22/19	Sample Received By:	Tamara Oldaker
Project Location:	OXY		

**Sample ID: SP 3 @ 2' (H903259-11)**

Chloride, SM4500Cl-B		mg/kg		Analyzed By: AC					
Analyte	Result	Reporting Limit	Analyzed	Method Blank	BS	% Recovery	True Value QC	RPD	Qualifier
Chloride	96.0	16.0	09/24/2019	ND	432	108	400	0.00	

**Sample ID: SP 3 @ 3' (H903259-12)**

Chloride, SM4500Cl-B		mg/kg		Analyzed By: AC						
Analyte	Result	Reporting Limit	Analyzed	Method Blank	BS	% Recovery	True Value QC	RPD	Qualifier	
Chloride	32.0	16.0	09/24/2019	ND	432	108	400	0.00		

Cardinal Laboratories

\*=Accredited Analyte

PLEASE NOTE: Liability and Damages. Cardinal's liability and client's exclusive remedy for any claim arising, whether based in contract or tort, shall be limited to the amount paid by client for analyses. All claims, including those for negligence and any other cause whatsoever shall be deemed waived unless made in writing and received by Cardinal within thirty (30) days after completion of the applicable service. In no event shall Cardinal be liable for incidental or consequential damages, including, without limitation, business interruptions, loss of use, or loss of profits incurred by client, its subsidiaries, affiliates or successors arising out of or related to the performance of the services hereunder by Cardinal, regardless of whether such claim is based upon any of the above stated reasons or otherwise. Results relate only to the samples identified above. This report shall not be reproduced except in full with written approval of Cardinal Laboratories.

Celey D. Keene, Lab Director/Quality Manager





PHONE (575) 393-2326 ° 101 E. MARLAND ° HOBBS, NM 88240

**Analytical Results For:**

BBC International, Inc.  
 Cliff Brunson  
 P.O. Box 805  
 Hobbs NM, 88241  
 Fax To: (575) 397-0397

Received:	09/23/2019	Sampling Date:	09/19/2019
Reported:	09/26/2019	Sampling Type:	Soil
Project Name:	RED TANK 30-31 34H	Sampling Condition:	Cool & Intact
Project Number:	8/22/19	Sample Received By:	Tamara Oldaker
Project Location:	OXY		

**Sample ID: NORTH @ SURFACE (H903259-13)**

BTEX 8021B			mg/kg		Analyzed By: BF				
Analyte	Result	Reporting Limit	Analyzed	Method Blank	BS	% Recovery	True Value QC	RPD	Qualifier
Benzene*	<0.050	0.050	09/24/2019	ND	1.86	93.1	2.00	1.03	
Toluene*	<0.050	0.050	09/24/2019	ND	1.84	92.2	2.00	0.422	
Ethylbenzene*	<0.050	0.050	09/24/2019	ND	1.82	91.0	2.00	1.55	
Total Xylenes*	<0.150	0.150	09/24/2019	ND	5.46	91.1	6.00	1.46	
Total BTEX	<0.300	0.300	09/24/2019	ND					

Surrogate: 4-Bromofluorobenzene (PID) 80.3 % 73.3-129

Chloride, SM4500Cl-B			mg/kg		Analyzed By: AC				
Analyte	Result	Reporting Limit	Analyzed	Method Blank	BS	% Recovery	True Value QC	RPD	Qualifier
Chloride	<16.0	16.0	09/24/2019	ND	432	108	400	0.00	

TPH 8015M			mg/kg		Analyzed By: MS				
Analyte	Result	Reporting Limit	Analyzed	Method Blank	BS	% Recovery	True Value QC	RPD	Qualifier
GRO C6-C10*	<10.0	10.0	09/24/2019	ND	202	101	200	0.0144	
DRO >C10-C28*	<10.0	10.0	09/24/2019	ND	199	99.6	200	10.3	
EXT DRO >C28-C36	<10.0	10.0	09/24/2019	ND					

Surrogate: 1-Chlorooctane 88.5 % 41-142

Surrogate: 1-Chlorooctadecane 96.1 % 37.6-147

Cardinal Laboratories

\*=Accredited Analyte

PLEASE NOTE: Liability and Damages. Cardinal's liability and client's exclusive remedy for any claim arising, whether based in contract or tort, shall be limited to the amount paid by client for analyses. All claims, including those for negligence and any other cause whatsoever shall be deemed waived unless made in writing and received by Cardinal within thirty (30) days after completion of the applicable service. In no event shall Cardinal be liable for incidental or consequential damages, including, without limitation, business interruptions, loss of use, or loss of profits incurred by client, its subsidiaries, affiliates or successors arising out of or related to the performance of the services hereunder by Cardinal, regardless of whether such claim is based upon any of the above stated reasons or otherwise. Results relate only to the samples identified above. This report shall not be reproduced except in full with written approval of Cardinal Laboratories.

Celey D. Keene, Lab Director/Quality Manager





PHONE (575) 393-2326 ° 101 E. MARLAND ° HOBBS, NM 88240

**Analytical Results For:**

BBC International, Inc.  
 Cliff Brunson  
 P.O. Box 805  
 Hobbs NM, 88241  
 Fax To: (575) 397-0397

Received: 09/23/2019  
 Reported: 09/26/2019  
 Project Name: RED TANK 30-31 34H  
 Project Number: 8/22/19  
 Project Location: OXY

Sampling Date: 09/19/2019  
 Sampling Type: Soil  
 Sampling Condition: Cool & Intact  
 Sample Received By: Tamara Oldaker

**Sample ID: EAST @ SURFACE (H903259-14)**

BTEX 8021B		mg/kg		Analyzed By: BF						
Analyte	Result	Reporting Limit	Analyzed	Method Blank	BS	% Recovery	True Value QC	RPD	Qualifier	
Benzene*	<0.050	0.050	09/24/2019	ND	1.86	93.1	2.00	1.03		
Toluene*	<0.050	0.050	09/24/2019	ND	1.84	92.2	2.00	0.422		
Ethylbenzene*	<0.050	0.050	09/24/2019	ND	1.82	91.0	2.00	1.55		
Total Xylenes*	<0.150	0.150	09/24/2019	ND	5.46	91.1	6.00	1.46		
Total BTEX	<0.300	0.300	09/24/2019	ND						

Surrogate: 4-Bromofluorobenzene (PID) 82.2 % 73.3-129

Chloride, SM4500Cl-B		mg/kg		Analyzed By: AC						
Analyte	Result	Reporting Limit	Analyzed	Method Blank	BS	% Recovery	True Value QC	RPD	Qualifier	
Chloride	<16.0	16.0	09/24/2019	ND	432	108	400	0.00		

TPH 8015M		mg/kg		Analyzed By: MS					
Analyte	Result	Reporting Limit	Analyzed	Method Blank	BS	% Recovery	True Value QC	RPD	Qualifier
GRO C6-C10*	<10.0	10.0	09/24/2019	ND	202	101	200	0.0144	
DRO >C10-C28*	<10.0	10.0	09/24/2019	ND	199	99.6	200	10.3	
EXT DRO >C28-C36	<10.0	10.0	09/24/2019	ND					

Surrogate: 1-Chlorooctane 80.6 % 41-142

Surrogate: 1-Chlorooctadecane 87.7 % 37.6-147

Cardinal Laboratories

\*=Accredited Analyte

PLEASE NOTE: Liability and Damages. Cardinal's liability and client's exclusive remedy for any claim arising, whether based in contract or tort, shall be limited to the amount paid by client for analyses. All claims, including those for negligence and any other cause whatsoever shall be deemed waived unless made in writing and received by Cardinal within thirty (30) days after completion of the applicable service. In no event shall Cardinal be liable for incidental or consequential damages, including, without limitation, business interruptions, loss of use, or loss of profits incurred by client, its subsidiaries, affiliates or successors arising out of or related to the performance of the services hereunder by Cardinal, regardless of whether such claim is based upon any of the above stated reasons or otherwise. Results relate only to the samples identified above. This report shall not be reproduced except in full with written approval of Cardinal Laboratories.

Celey D. Keene, Lab Director/Quality Manager





PHONE (575) 393-2326 ° 101 E. MARLAND ° HOBBS, NM 88240

**Analytical Results For:**

BBC International, Inc.  
 Cliff Brunson  
 P.O. Box 805  
 Hobbs NM, 88241  
 Fax To: (575) 397-0397

Received:	09/23/2019	Sampling Date:	09/19/2019
Reported:	09/26/2019	Sampling Type:	Soil
Project Name:	RED TANK 30-31 34H	Sampling Condition:	Cool & Intact
Project Number:	8/22/19	Sample Received By:	Tamara Oldaker
Project Location:	OXY		

**Sample ID: WEST @ SURFACE (H903259-15)**

BTEX 8021B			mg/kg		Analyzed By: BF				
Analyte	Result	Reporting Limit	Analyzed	Method Blank	BS	% Recovery	True Value QC	RPD	Qualifier
Benzene*	<0.050	0.050	09/24/2019	ND	1.86	93.1	2.00	1.03	
Toluene*	<0.050	0.050	09/24/2019	ND	1.84	92.2	2.00	0.422	
Ethylbenzene*	<0.050	0.050	09/24/2019	ND	1.82	91.0	2.00	1.55	
Total Xylenes*	<0.150	0.150	09/24/2019	ND	5.46	91.1	6.00	1.46	
Total BTEX	<0.300	0.300	09/24/2019	ND					

Surrogate: 4-Bromofluorobenzene (PID) 79.3 % 73.3-129

Chloride, SM4500Cl-B			mg/kg		Analyzed By: AC				
Analyte	Result	Reporting Limit	Analyzed	Method Blank	BS	% Recovery	True Value QC	RPD	Qualifier
Chloride	<16.0	16.0	09/24/2019	ND	432	108	400	0.00	

TPH 8015M			mg/kg		Analyzed By: MS				
Analyte	Result	Reporting Limit	Analyzed	Method Blank	BS	% Recovery	True Value QC	RPD	Qualifier
GRO C6-C10*	<10.0	10.0	09/24/2019	ND	202	101	200	0.0144	
DRO >C10-C28*	<10.0	10.0	09/24/2019	ND	199	99.6	200	10.3	
EXT DRO >C28-C36	<10.0	10.0	09/24/2019	ND					

Surrogate: 1-Chlorooctane 91.3 % 41-142

Surrogate: 1-Chlorooctadecane 98.6 % 37.6-147

Cardinal Laboratories

\*=Accredited Analyte

PLEASE NOTE: Liability and Damages. Cardinal's liability and client's exclusive remedy for any claim arising, whether based in contract or tort, shall be limited to the amount paid by client for analyses. All claims, including those for negligence and any other cause whatsoever shall be deemed waived unless made in writing and received by Cardinal within thirty (30) days after completion of the applicable service. In no event shall Cardinal be liable for incidental or consequential damages, including, without limitation, business interruptions, loss of use, or loss of profits incurred by client, its subsidiaries, affiliates or successors arising out of or related to the performance of the services hereunder by Cardinal, regardless of whether such claim is based upon any of the above stated reasons or otherwise. Results relate only to the samples identified above. This report shall not be reproduced except in full with written approval of Cardinal Laboratories.

Celey D. Keene, Lab Director/Quality Manager





PHONE (575) 393-2326 ° 101 E. MARLAND ° HOBBS, NM 88240

**Analytical Results For:**

BBC International, Inc.  
 Cliff Brunson  
 P.O. Box 805  
 Hobbs NM, 88241  
 Fax To: (575) 397-0397

Received:	09/23/2019	Sampling Date:	09/19/2019
Reported:	09/26/2019	Sampling Type:	Soil
Project Name:	RED TANK 30-31 34H	Sampling Condition:	Cool & Intact
Project Number:	8/22/19	Sample Received By:	Tamara Oldaker
Project Location:	OXY		

**Sample ID: SOUTH @ SURFACE (H903259-16)**

BTEX 8021B		mg/kg		Analyzed By: BF						
Analyte	Result	Reporting Limit	Analyzed	Method Blank	BS	% Recovery	True Value QC	RPD	Qualifier	
Benzene*	<0.050	0.050	09/24/2019	ND	1.86	93.1	2.00	1.03		
Toluene*	<0.050	0.050	09/24/2019	ND	1.84	92.2	2.00	0.422		
Ethylbenzene*	<0.050	0.050	09/24/2019	ND	1.82	91.0	2.00	1.55		
Total Xylenes*	<0.150	0.150	09/24/2019	ND	5.46	91.1	6.00	1.46		
Total BTEX	<0.300	0.300	09/24/2019	ND						

Surrogate: 4-Bromofluorobenzene (PID) 81.0 % 73.3-129

Chloride, SM4500Cl-B		mg/kg		Analyzed By: AC					
Analyte	Result	Reporting Limit	Analyzed	Method Blank	BS	% Recovery	True Value QC	RPD	Qualifier
Chloride	32.0	16.0	09/24/2019	ND	432	108	400	0.00	

TPH 8015M		mg/kg		Analyzed By: MS					
Analyte	Result	Reporting Limit	Analyzed	Method Blank	BS	% Recovery	True Value QC	RPD	Qualifier
GRO C6-C10*	<10.0	10.0	09/24/2019	ND	202	101	200	0.0144	
DRO >C10-C28*	<10.0	10.0	09/24/2019	ND	199	99.6	200	10.3	
EXT DRO >C28-C36	<10.0	10.0	09/24/2019	ND					

Surrogate: 1-Chlorooctane 91.2 % 41-142

Surrogate: 1-Chlorooctadecane 97.8 % 37.6-147

Cardinal Laboratories

\*=Accredited Analyte

PLEASE NOTE: Liability and Damages. Cardinal's liability and client's exclusive remedy for any claim arising, whether based in contract or tort, shall be limited to the amount paid by client for analyses. All claims, including those for negligence and any other cause whatsoever shall be deemed waived unless made in writing and received by Cardinal within thirty (30) days after completion of the applicable service. In no event shall Cardinal be liable for incidental or consequential damages, including, without limitation, business interruptions, loss of use, or loss of profits incurred by client, its subsidiaries, affiliates or successors arising out of or related to the performance of the services hereunder by Cardinal, regardless of whether such claim is based upon any of the above stated reasons or otherwise. Results relate only to the samples identified above. This report shall not be reproduced except in full with written approval of Cardinal Laboratories.

Celey D. Keene, Lab Director/Quality Manager





---

PHONE (575) 393-2326 ° 101 E. MARLAND ° HOBBS, NM 88240

---

### Notes and Definitions

S-04	The surrogate recovery for this sample is outside of established control limits due to a sample matrix effect.
ND	Analyte NOT DETECTED at or above the reporting limit
RPD	Relative Percent Difference
**	Samples not received at proper temperature of 6°C or below.
***	Insufficient time to reach temperature.
-	Chloride by SM4500Cl-B does not require samples be received at or below 6°C Samples reported on an as received basis (wet) unless otherwise noted on report

---

Cardinal Laboratories

\*=Accredited Analyte

PLEASE NOTE: Liability and Damages. Cardinal's liability and client's exclusive remedy for any claim arising, whether based in contract or tort, shall be limited to the amount paid by client for analyses. All claims, including those for negligence and any other cause whatsoever shall be deemed waived unless made in writing and received by Cardinal within thirty (30) days after completion of the applicable service. In no event shall Cardinal be liable for incidental or consequential damages, including, without limitation, business interruptions, loss of use, or loss of profits incurred by client, its subsidiaries, affiliates or successors arising out of or related to the performance of the services hereunder by Cardinal, regardless of whether such claim is based upon any of the above stated reasons or otherwise. Results relate only to the samples identified above. This report shall not be reproduced except in full with written approval of Cardinal Laboratories.

---

Celey D. Keene, Lab Director/Quality Manager



Page 16 of 17

**ARDINAL LABORATORIES**

101 East Marland, Hobbs, NM 88240

(505) 393-2326 FAX (505) 393-2476

**CHAIN-OF-CUSTODY AND ANALYSIS REQUEST**

Company Name: BBC International, Inc.				<b>BILL TO</b>				<b>ANALYSIS REQUEST</b>																																	
Project Manager: Cliff Brunson				P.O. #:																																					
Address: P.O. Box 805				Company: <i>Oxy</i>																																					
City: Hobbs		State: NM		Zip: 88241		Attn: <i>W. D. Hrich</i>																																			
Phone #: 575-397-6388		Fax #: 575-397-0397		Address:																																					
Project #:		Project Owner: <i>Oxy</i>		City:																																					
Project Name: RED TANK 30-31 34H - 8-22-19				State:      Zip:																																					
Project Location:				Phone #:																																					
Sampler Name: JEFF ORNELAS				Fax #:																																					
FOR LAB USE ONLY																																									
Lab I.D.		Sample I.D.		G/RAB OR (C)OMP.		# CONTAINERS		MATRIX		PRESERV.		SAMPLING																													
								GROUNDWATER		WASTEWATER		SOIL		OIL		SLUDGE		OTHER:		ACID/BASE:		ICE / COOL		OTHER:		DATE		TIME													
<i>H903259</i>				<i>G</i>		<i>1</i>						<i>✓</i>								<i>✓</i>						<i>9-19-19</i>		<i>8:50</i>		<i>Chloride</i>											
<i>1</i>		SP1 @ SURFACE																								<i>9-19-19</i>		<i>9:10</i>		<i>TPH Ext</i>											
<i>2</i>		SP1 @ 1'																								<i>9-19-19</i>		<i>9:20</i>		<i>BTX</i>											
<i>3</i>		SP1 @ 2'																								<i>9-19-19</i>		<i>9:41</i>													
<i>4</i>		SP1 @ 3'																								<i>9-19-19</i>		<i>9:59</i>													
<i>5</i>		SP2 @ SURFACE																								<i>9-19-19</i>		<i>10:16</i>													
<i>6</i>		SP2 @ 1'																								<i>9-19-19</i>		<i>10:30</i>													
<i>7</i>		SP2 @ 2'																								<i>9-19-19</i>		<i>10:50</i>													
<i>8</i>		SP2 @ 3'																								<i>9-19-19</i>		<i>11:11</i>													
<i>9</i>		SP3 @ SURFACE																								<i>9-19-19</i>		<i>11:33</i>													
<i>10</i>		SP3 @ 1'																								<i>9-19-19</i>		<i>11:33</i>													

PLEASE NOTE: Liability and Damages. Cardinal's liability and client's exclusive remedy for any claim arising whether based in contract or tort, shall be limited to the amount paid by the client for the analyses. All claims including those for negligence and any other cause whatsoever shall be deemed waived unless made in writing and received by Cardinal within 30 days after completion of the applicable service. In no event shall Cardinal be liable for incidental or consequential damages, including without limitation, business interruptions, loss of use, or loss of profits incurred by client, its subsidiaries, affiliates or successors arising out of or related to the performance of services hereunder by Cardinal, regardless of whether such claim is based upon any of the above stated reasons or otherwise.

Relinquished By:		Date: <i>9-23-19</i>		Received By: <i>Israel Per...</i>		Phone Result: <input type="checkbox"/> Yes <input type="checkbox"/> No		Add'l Phone #:	
		Time: <i>11:20</i>				Fax Result: <input type="checkbox"/> Yes <input type="checkbox"/> No		Add'l Fax #:	
Relinquished By: <i>Israel Per...</i>		Date: <i>9-23-19</i>		Received By: <i>Janora...</i>		REMARKS:			
		Time: <i>11:20</i>							
Delivered By: (Circle One) <i>-4.0°C</i>		<i>#97</i>		Sample Condition					
Sampler - UPS - Bus - Other: <i>Corrected -4.4°C</i>				Cool Intact		CHECKED BY: (Initials) <i>TO</i>			
				<input checked="" type="checkbox"/> Yes <input type="checkbox"/> No		<input type="checkbox"/> Yes <input type="checkbox"/> No			

† Cardinal cannot accept verbal changes. Please fax written changes to 505-393-2476







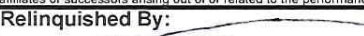

(505) 393-2326 FAX (505) 393-2476

[illegible]

**PLEASE NOTE:** Liability and Damages. Cardinal's liability and client's exclusive remedy for any claim arising whether based in contract or tort, shall be limited to the amount paid by the client for the analyses. All claims, including those for negligence and any other cause whatsoever shall be deemed waived unless made in writing and received by Cardinal within 30 days after completion of the applicable service. In no event shall Cardinal be liable for incidental or consequential damages, including without limitation, business interruptions, loss of use, or loss of profits incurred by client, its subsidiaries, affiliates or successors arising out of or related to the performance of services hereunder by Cardinal, regardless of whether such claims are based upon any of the above stated reasons or otherwise.

Relinquished By: 		Date: 9-23-19	Received By: 	Phone Result: <input type="checkbox"/> Yes <input type="checkbox"/> No	Add'l Phone #: _____
Time: _____				Fax Result: <input type="checkbox"/> Yes <input type="checkbox"/> No	Add'l Fax #: _____
Relinquished By: 		Date: 9-23-19	Received By: 	REMARKS: _____	
Time: 11:20					
Delivered By: (Circle One) <u>-4.0°C</u> <u>#97</u>		Sample Condition	CHECKED BY: (Initials)		
Sampler - UPS - Bus - Other: <u>Corrected -4.4°C</u>		Cool <input checked="" type="checkbox"/> Yes <input type="checkbox"/> No Intact <input type="checkbox"/> Yes <input type="checkbox"/> No	7.0°C		

† Cardinal cannot accept verbal changes. Please fax written changes to 505-393-2476