



PHONE (575) 397-6388 • FAX (575) 397- 0397 • 1324 W. MARLAND • P.O. BOX 805 • HOBBS, NM 88241-0805  
E-MAIL: cbrunson@bbcinternational.com

## DELINEATION/REMEDATION WORKPLAN

### OXY – LENGTH CC 6-7 FED COM 22H (Leak Date: 6/11/19)

**2RP-5521**

**7RLOP-200211-C-1410**

This delineation workplan and remediation proposal addresses the releases associated with 2RP-5521.

The following information includes:

**NAB1919055677**

1. Appropriate completed and signed C-141 pages.
2. Scaled digital site map with spill area demarcated and leak point identified along with sample point locations and areas of remediation at appropriate depths.
3. GPS information for sample points and sample methodology.
4. Depth to groundwater information (i.e., pdf of OSE search results, USGS search results, and/or copy of Chevron groundwater trend map).
5. Watercourse/features map within 1000 feet.
6. BLM Cave Karst map.
7. FEMA National Flood map.
8. Laboratory analysis results summary table and original laboratory analysis reports.
9. Potentially other pertinent information as necessary for site specific purposes.

***Based on the information included in this package and the NMOCD rules, the following remediation is proposed:***

***OXY will excavate the spill area as depicted on the following site diagram. The entire leak area (PINK shade on diagram) will be excavated to a depth of 4 feet.***

***Bottom and sidewall confirmation samples will be collected every 75 feet. The estimated amount of soil to be excavated is 575 cubic yards. The remediation will be completed within 90 days of approval.***

The entire site will then be backfilled with clean soil and revegetated (if warranted) to the standards of the appropriate regulatory agency or private surface owner.

All excavated materials will be disposed of at an NMOCD-approved disposal facility.

Form C-141

State of New Mexico

Oil Conservation Division

Page 3

Incident ID	
District RP	2RP-5521
Facility ID	
Application ID	

## Site Assessment/Characterization

*This information must be provided to the appropriate district office no later than 90 days after the release discovery date.*

What is the shallowest depth to groundwater beneath the area affected by the release?	52 (ft bgs)
Did this release impact groundwater or surface water?	<input type="checkbox"/> Yes <input checked="" type="checkbox"/> No
Are the lateral extents of the release within 300 feet of a continuously flowing watercourse or any other significant watercourse?	<input type="checkbox"/> Yes <input checked="" type="checkbox"/> No
Are the lateral extents of the release within 200 feet of any lakebed, sinkhole, or playa lake (measured from the ordinary high-water mark)?	<input type="checkbox"/> Yes <input checked="" type="checkbox"/> No
Are the lateral extents of the release within 300 feet of an occupied permanent residence, school, hospital, institution, or church?	<input type="checkbox"/> Yes <input checked="" type="checkbox"/> No
Are the lateral extents of the release within 500 horizontal feet of a spring or a private domestic fresh water well used by less than five households for domestic or stock watering purposes?	<input type="checkbox"/> Yes <input checked="" type="checkbox"/> No
Are the lateral extents of the release within 1000 feet of any other fresh water well or spring?	<input type="checkbox"/> Yes <input checked="" type="checkbox"/> No
Are the lateral extents of the release within incorporated municipal boundaries or within a defined municipal fresh water well field?	<input type="checkbox"/> Yes <input checked="" type="checkbox"/> No
Are the lateral extents of the release within 300 feet of a wetland?	<input type="checkbox"/> Yes <input checked="" type="checkbox"/> No
Are the lateral extents of the release overlying a subsurface mine?	<input type="checkbox"/> Yes <input checked="" type="checkbox"/> No
Are the lateral extents of the release overlying an unstable area such as karst geology?	<input checked="" type="checkbox"/> Yes <input type="checkbox"/> No
Are the lateral extents of the release within a 100-year floodplain?	<input type="checkbox"/> Yes <input checked="" type="checkbox"/> No
Did the release impact areas <b>not</b> on an exploration, development, production, or storage site?	<input checked="" type="checkbox"/> Yes <input type="checkbox"/> No

Attach a comprehensive report (electronic submittals in .pdf format are preferred) demonstrating the lateral and vertical extents of soil contamination associated with the release have been determined. Refer to 19.15.29.11 NMAC for specifics.

### **Characterization Report Checklist:** *Each of the following items must be included in the report.*

- ☒ Scaled site map showing impacted area, surface features, subsurface features, delineation points, and monitoring wells.
- ☐ Field data
- ☒ Data table of soil contaminant concentration data
- ☒ Depth to water determination
- ☒ Determination of water sources and significant watercourses within ½-mile of the lateral extents of the release
- ☐ Boring or excavation logs
- ☐ Photographs including date and GIS information
- ☒ Topographic/Aerial maps
- ☒ Laboratory data including chain of custody

If the site characterization report does not include completed efforts at remediation of the release, the report must include a proposed remediation plan. That plan must include the estimated volume of material to be remediated, the proposed remediation technique, proposed sampling plan and methods, anticipated timelines for beginning and completing the remediation. The closure criteria for a release are contained in Table 1 of 19.15.29.12 NMAC, however, use of the table is modified by site- and release-specific parameters.

Form C-141

State of New Mexico

Page 4

Oil Conservation Division

Incident ID	
District RP	2RP-5521
Facility ID	
Application ID	

I hereby certify that the information given above is true and complete to the best of my knowledge and understand that pursuant to OCD rules and regulations all operators are required to report and/or file certain release notifications and perform corrective actions for releases which may endanger public health or the environment. The acceptance of a C-141 report by the OCD does not relieve the operator of liability should their operations have failed to adequately investigate and remediate contamination that pose a threat to groundwater, surface water, human health or the environment. In addition, OCD acceptance of a C-141 report does not relieve the operator of responsibility for compliance with any other federal, state, or local laws and/or regulations.

Printed Name: Wade Dittrich Title: Environmental Coordinator  
Signature:  Date: 12-11-19  
email: wade\_dittrich@oxy.com Telephone: (575) 390-2828

**OCD Only**

Received by: \_\_\_\_\_ Date: \_\_\_\_\_

Form C-141

State of New Mexico

Page 5

Oil Conservation Division

Incident ID	NAB1919055677
District RP	2RP-5521
Facility ID	
Application ID	

## Remediation Plan

**Remediation Plan Checklist:** Each of the following items must be included in the plan.

- ☒ Detailed description of proposed remediation technique
- ☒ Scaled sitemap with GPS coordinates showing delineation points
- ☒ Estimated volume of material to be remediated
- ☒ Closure criteria is to Table 1 specifications subject to 19.15.29.12(C)(4) NMAC
- ☒ Proposed schedule for remediation (note if remediation plan timeline is more than 90 days OCD approval is required)

**Deferral Requests Only:** Each of the following items must be confirmed as part of any request for deferral of remediation.

- ☐ Contamination must be in areas immediately under or around production equipment where remediation could cause a major facility deconstruction.
- ☐ Extents of contamination must be fully delineated.
- ☐ Contamination does not cause an imminent risk to human health, the environment, or groundwater.

I hereby certify that the information given above is true and complete to the best of my knowledge and understand that pursuant to OCD rules and regulations all operators are required to report and/or file certain release notifications and perform corrective actions for releases which may endanger public health or the environment. The acceptance of a C-141 report by the OCD does not relieve the operator of liability should their operations have failed to adequately investigate and remediate contamination that pose a threat to groundwater, surface water, human health or the environment. In addition, OCD acceptance of a C-141 report does not relieve the operator of responsibility for compliance with any other federal, state, or local laws and/or regulations.

Printed Name: Wade Dittrich Title: Environmental Coordinator  
Signature:  Date: 12-11-19  
email: wade\_dittrich@oxy.com Telephone: (575) 390-2828

### OCD Only

Received by: Victoria Venegas Date: 02/11/2020

☐ Approved ☒ Approved with Attached Conditions of Approval ☐ Denied ☐ Deferral Approved

Signature:  Date: 03/18/2020



# Oxy, Length CC 6-7 Fed Com 22H

Leak Date: 4/2/19  
Eddy County, NM  
API 30-015-45565  
2RP-5521

## Legend

- 4 ft Excavation
- Leak Area (4/2/19)
- Location Pad
- Sample Points





Oxy, Length CC 6-7 Fed Com 22H

Sample points

SP1, N 32.25257 W-104.03009

SP2, N 32.25263 W-104.02998

SP3, N 32.25267 W-104.03008

NORTH, N 32.25276 W-104.03008

SOUTH, N 32.25248 W-104.03009

EAST, N 32.25266 W-104.02993

WEST, N 32.25260 W-104.03017

**Oxy, Length CC 6-7 Fed Com 22H**  
**U/L D, Section 6, T24S, R29E**  
**Groundwater: <50'**





USGS Home  
Contact USGS  
Search USGS

National Water Information System: Web Interface

USGS Water Resources

Data Category:  
Groundwater

Geographic Area:  
New Mexico

GO

Click to hideNews Bulletins

- Introducing The Next Generation of USGS Water Data for the Nation
- Full News

Groundwater levels for New Mexico

Click to hide state-specific text

Search Results -- 1 sites found

Agency code = usgs  
site\_no list =

- 321355104012001

Minimum number of levels = 1  
[Save file of selected sites](#) to local disk for future upload

USGS 321355104012001 24S.29E.07.14444

Eddy County, New Mexico  
Latitude 32°13'55", Longitude 104°01'20" NAD27  
Land-surface elevation 2,983 feet above NAVD88  
The depth of the well is 160 feet below land surface.  
This well is completed in the Castile Formation (312CSTL) local aquifer.

Output formats

Table of data

Tab-separated data

Graph of data

Reselect period

Date	Time	? Water-level date-time accuracy	Water level, feet below land surface	Water level, feet above specific vertical datum	Referenced vertical datum	? Water-level accuracy	? Status	? Method of measurement	? Measuring agency	? Source of measurem
1983-02-01		D	47.14			2			U	
1987-10-16		D	51.84			2			U	
1988-02-11		D	52.19			2			U	
1992-10-20		D	51.78			2			S	

Explanation

Section	Code	Description
Water-level date-time accuracy	D	Date is accurate to the Day
Water-level accuracy	2	Water level accuracy to nearest hundredth of a foot
Status		The reported water-level measurement represents a static level
Method of measurement	S	Steel-tape measurement.
Method of measurement	U	Unknown method.
Measuring agency		Not determined
Source of measurement	U	Source is unknown.
Water-level approval status	A	Approved for publication -- Processing and review completed.



Received by OCD: 2/11/2020 5:48:26 PM

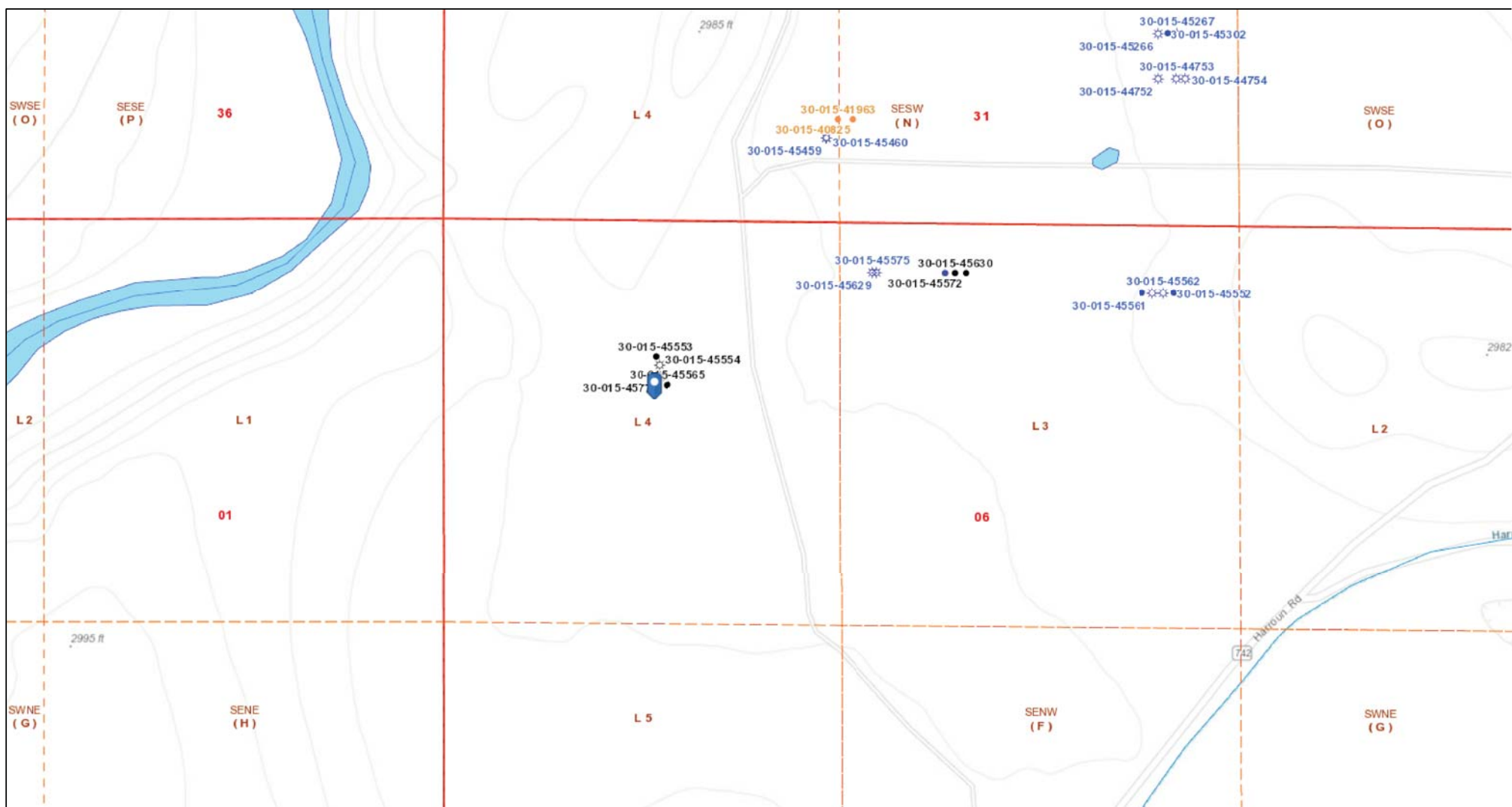

1:4,514

A horizontal number line with two scales. The top scale is in miles, with labels 0, 0.05, 0.1, and 0.19 mi. The bottom scale is in kilometers, with labels 0, 0.07, 0.15, and 0.3 km. Vertical tick marks connect the two scales at corresponding values.

0                      0.07                      0.15                      0.3 km

OCD, Bureau of Land Management, Texas Parks & Wildlife, Esri.

HERE, Garmin, INCREMENT P, USGS, EPA, USDA, BLM

New Mexico Oil Conservation Division



Page 9 of 37

# Oxy, Length CC 6-7 Fed Com 22H

Leak date: 4/2/19  
Eddy County, NM  
2RP-5521

## BLM CAVE KARST MAP

### Legend

-  Leak Area
-  Medium potential



742

Harroun Rd

Google Earth

© 2018 Google

1000 ft



# National Flood Hazard Layer FIRMette



32°15'24.83"N



## Legend

SEE FIS REPORT FOR DETAILED LEGEND AND INDEX MAP FOR FIRM PANEL LAYOUT

SPECIAL FLOOD HAZARD AREAS		Without Base Flood Elevation (BFE) Zone A, V, A99
		With BFE or Depth Zone AE, AO, AH, VE, AR
		Regulatory Floodway
OTHER AREAS OF FLOOD HAZARD		0.2% Annual Chance Flood Hazard, Areas of 1% annual chance flood with average depth less than one foot or with drainage areas of less than one square mile Zone X
		Future Conditions 1% Annual Chance Flood Hazard Zone X
		Area with Reduced Flood Risk due to Levee. See Notes. Zone X
		Area with Flood Risk due to Levee Zone X
OTHER AREAS		NO SCREEN Area of Minimal Flood Hazard Zone X
		Effective LOMRs
GENERAL STRUCTURES		Area of Undetermined Flood Hazard Zone D
		Channel, Culvert, or Storm Sewer
		Levee, Dike, or Floodwall
		Cross Sections with 1% Annual Chance Water Surface Elevation
		Coastal Transect
OTHER FEATURES		Base Flood Elevation Line (BFE)
		Limit of Study
		Jurisdiction Boundary
		Coastal Transect Baseline
		Profile Baseline
		Hydrographic Feature
		Digital Data Available
		No Digital Data Available
MAP PANELS		Unmapped
		The pin displayed on the map is an approximate point selected by the user and does not represent an authoritative property location.



This map complies with FEMA's standards for the use of digital flood maps if it is not void as described below. The basemap shown complies with FEMA's basemap accuracy standards

The flood hazard information is derived directly from the authoritative NFHL web services provided by FEMA. This map was exported on **11/22/2019 at 12:14:52 PM** and does not reflect changes or amendments subsequent to this date and time. The NFHL and effective information may change or become superseded by new data over time.

This map image is void if the one or more of the following map elements do not appear: basemap imagery, flood zone labels, legend, scale bar, map creation date, community identifiers, FIRM panel number, and FIRM effective date. Map images for unmapped and unmodernized areas cannot be used for regulatory purposes.

USGS The National Map: Orthoimagery. Data refreshed April, 2019.

0 250 500 1,000 1,500 2,000 Feet 1:6,000

32°14'54.40"N



Laboratory Analytical Results Summary  
Length CC 67 Fed Com 22H (4/2/19)

		Sample ID	NORTH @ SURFACE	EAST @ SURFACE	WEST @ SURFACE	SOUTH @ SURFACE
Analyte	Method	Date	11/19/19	11/19/19	11/19/19	11/19/19
			mg/kg	mg/kg	mg/kg	mg/kg
Benzene	BTEX 8021B		<0.050	<0.050	<0.050	<0.050
Toluene	BTEX 8021B		<0.050	<0.050	<0.050	<0.050
Ethylbenzene	BTEX 8021B		<0.050	<0.050	<0.050	<0.050
Total Xylenes	BTEX 8021B		<0.150	<0.150	<0.150	<0.150
Total BTEX	BTEX 8021B		<0.300	<0.300	<0.300	<0.300
Chloride	SM4500Cl-B		32	48	48	32
GRO	TPH 8015M		<10.0	<10.0	<10.0	<10.0
DRO	TPH 8015M		<10.0	<10.0	<10.0	<10.0
EXT DRO	TPH 8015M		<10.0	<10.0	<10.0	<10.0

		Sample ID	SP1 @ SURFACE	SP1 @ 1'	SP1 @ 2'	SP1 @ 3'	SP1 @ 4'	SP1 @ 5'	SP1 @ 6'	SP1 @ 7'	SP1 @ 8'	SP1 @ 9'	SP1 @ 10'	SP1 @ 11'
Analyte	Method	Date	11/14/19	11/14/19	11/19/19	11/19/19	11/19/19	11/19/19	11/19/19	11/19/19	11/19/19	11/19/19	11/19/19	11/19/19
			mg/kg	mg/kg	mg/kg	mg/kg	mg/kg	mg/kg	mg/kg	mg/kg	mg/kg	mg/kg	mg/kg	mg/kg
Benzene	BTEX 8021B		<0.050	<0.050	<0.050	n/a	n/a	n/a	n/a	n/a	n/a	n/a	n/a	n/a
Toluene	BTEX 8021B		<0.050	<0.050	<0.050	n/a	n/a	n/a	n/a	n/a	n/a	n/a	n/a	n/a
Ethylbenzene	BTEX 8021B		<0.050	<0.050	<0.050	n/a	n/a	n/a	n/a	n/a	n/a	n/a	n/a	n/a
Total Xylenes	BTEX 8021B		<0.150	<0.150	<0.150	n/a	n/a	n/a	n/a	n/a	n/a	n/a	n/a	n/a
Total BTEX	BTEX 8021B		<0.300	<0.300	<0.300	n/a	n/a	n/a	n/a	n/a	n/a	n/a	n/a	n/a
Chloride	SM4500Cl-B		880	640	480	2280	2480	2200	2280	2200	2400	464	48	48
GRO	TPH 8015M		<10.0	<10.0	<10.0	n/a	n/a	n/a	n/a	n/a	n/a	n/a	n/a	n/a
DRO	TPH 8015M		2540	<10.0	<10.0	n/a	n/a	n/a	n/a	n/a	n/a	n/a	n/a	n/a
EXT DRO	TPH 8015M		71.6	<10.0	<10.0	n/a	n/a	n/a	n/a	n/a	n/a	n/a	n/a	n/a

		Sample ID	SP2 @ SURFACE	SP2 @ 1'	SP2 @ 2'	SP2 @ 3'	SP2 @ 4'	SP2 @ 5'	SP2 @ 6'
Analyte	Method	Date	11/14/19	11/14/19	11/14/19	11/14/19	11/19/19	11/19/19	11/19/19
			mg/kg	mg/kg	mg/kg	mg/kg	mg/kg	mg/kg	mg/kg
Benzene	BTEX 8021B		<0.050	<0.050	<0.050	<0.050	<0.050	n/a	n/a
Toluene	BTEX 8021B		<0.050	<0.050	<0.050	<0.050	<0.050	n/a	n/a
Ethylbenzene	BTEX 8021B		<0.050	<0.050	<0.050	<0.050	<0.050	n/a	n/a
Total Xylenes	BTEX 8021B		<0.150	<0.150	<0.150	<0.150	<0.150	n/a	n/a
Total BTEX	BTEX 8021B		<0.300	<0.300	<0.300	<0.300	<0.300	n/a	n/a
Chloride	SM4500Cl-B		4560	352	432	608	496	32	48
GRO	TPH 8015M		<10.0	<10.0	<10.0	<10.0	<10.0	n/a	n/a
DRO	TPH 8015M		399	<10.0	164	71.8	<10.0	n/a	n/a
EXT DRO	TPH 8015M		114	<10.0	<10.0	<10.0	<10.0	n/a	n/a

		Sample ID	SP3 @ SURFACE	SP3 @ 1'	SP3 @ 2'	SP3 @ 3'	SP3 @ 4'	SP3 @ 5'	SP3 @ 6'
Analyte	Method	Date	11/14/19	11/14/19	11/20/19	11/20/19	11/20/19	11/20/19	11/20/19
			mg/kg	mg/kg	mg/kg	mg/kg	mg/kg	mg/kg	mg/kg
Benzene	BTEX 8021B		<0.050	<0.050	<0.050	<0.050	n/a	n/a	n/a
Toluene	BTEX 8021B		<0.050	<0.050	<0.050	<0.050	n/a	n/a	n/a
Ethylbenzene	BTEX 8021B		<0.050	<0.050	<0.050	<0.050	n/a	n/a	n/a
Total Xylenes	BTEX 8021B		<0.150	<0.150	<0.150	<0.150	n/a	n/a	n/a
Total BTEX	BTEX 8021B		<0.300	<0.300	<0.300	<0.300	n/a	n/a	n/a
Chloride	SM4500Cl-B		10500	1390	304	816	912	48	48
GRO	TPH 8015M		<10.0	<10.0	<10.0	<10.0	n/a	n/a	n/a
DRO	TPH 8015M		3360	331	<10.0	<10.0	n/a	n/a	n/a
EXT DRO	TPH 8015M		136	<10.0	<10.0	<10.0	n/a	n/a	n/a



PHONE (575) 393-2326 ° 101 E. MARLAND ° HOBBS, NM 88240

---

November 26, 2019

Cliff Brunson

BBC International, Inc.

P.O. Box 805

Hobbs, NM 88241

RE: LENGTH CC 6-7 FED COM #22H

Enclosed are the results of analyses for samples received by the laboratory on 11/21/19 16:45.

Cardinal Laboratories is accredited through Texas NELAP under certificate number T104704398-19-12. Accreditation applies to drinking water, non-potable water and solid and chemical materials. All accredited analytes are denoted by an asterisk (\*). For a complete list of accredited analytes and matrices visit the TCEQ website at [www.tceq.texas.gov/field/qa/lab\\_accred\\_certif.html](http://www.tceq.texas.gov/field/qa/lab_accred_certif.html).

Cardinal Laboratories is accredited through the State of Colorado Department of Public Health and Environment for:

Method EPA 552.2	Haloacetic Acids (HAA-5)
Method EPA 524.2	Total Trihalomethanes (TTHM)
Method EPA 524.4	Regulated VOCs (V1, V2, V3)

Accreditation applies to public drinking water matrices.

This report meets NELAP requirements and is made up of a cover page, analytical results, and a copy of the original chain-of-custody. If you have any questions concerning this report, please feel free to contact me.

Sincerely,

A handwritten signature in black ink that reads "Mike Snyder". The signature is fluid and cursive, with the first name "Mike" and last name "Snyder" clearly distinguishable.

Mike Snyder For Celey D. Keene

Lab Director/Quality Manager



PHONE (575) 393-2326 ° 101 E. MARLAND ° HOBBS, NM 88240

**Analytical Results For:**

BBC International, Inc.  
 Cliff Brunson  
 P.O. Box 805  
 Hobbs NM, 88241  
 Fax To: (575) 397-0397

Received:	11/21/2019	Sampling Date:	11/19/2019
Reported:	11/26/2019	Sampling Type:	Soil
Project Name:	LENGTH CC 6-7 FED COM #22H	Sampling Condition:	Cool & Intact
Project Number:	NONE GIVEN	Sample Received By:	Jodi Henson
Project Location:	OXY		

**Sample ID: N @ SURFACE (H903965-01)**

BTEX 8021B		mg/kg		Analyzed By: MS						
Analyte	Result	Reporting Limit	Analyzed	Method Blank	BS	% Recovery	True Value QC	RPD	Qualifier	
Benzene*	<0.050	0.050	11/23/2019	ND	1.69	84.6	2.00	7.13		
Toluene*	<0.050	0.050	11/23/2019	ND	1.67	83.6	2.00	6.81		
Ethylbenzene*	<0.050	0.050	11/23/2019	ND	1.62	81.2	2.00	7.53		
Total Xylenes*	<0.150	0.150	11/23/2019	ND	4.76	79.3	6.00	7.58		
Total BTEX	<0.300	0.300	11/23/2019	ND						

Surrogate: 4-Bromofluorobenzene (PID) 99.3 % 73.3-129

Chloride, SM4500Cl-B		mg/kg		Analyzed By: AC						
Analyte	Result	Reporting Limit	Analyzed	Method Blank	BS	% Recovery	True Value QC	RPD	Qualifier	
Chloride	32.0	16.0	11/26/2019	ND	432	108	400	0.00		

TPH 8015M		mg/kg		Analyzed By: MS					
Analyte	Result	Reporting Limit	Analyzed	Method Blank	BS	% Recovery	True Value QC	RPD	Qualifier
GRO C6-C10*	<10.0	10.0	11/23/2019	ND	207	103	200	3.25	
DRO >C10-C28*	<10.0	10.0	11/23/2019	ND	210	105	200	0.814	
EXT DRO >C28-C36	<10.0	10.0	11/23/2019	ND					

Surrogate: 1-Chlorooctane 90.2 % 41-142

Surrogate: 1-Chlorooctadecane 95.2 % 37.6-147

Cardinal Laboratories

\*=Accredited Analyte

PLEASE NOTE: Liability and Damages. Cardinal's liability and client's exclusive remedy for any claim arising, whether based in contract or tort, shall be limited to the amount paid by client for analyses. All claims, including those for negligence and any other cause whatsoever shall be deemed waived unless made in writing and received by Cardinal within thirty (30) days after completion of the applicable service. In no event shall Cardinal be liable for incidental or consequential damages, including, without limitation, business interruptions, loss of use, or loss of profits incurred by client, its subsidiaries, affiliates or successors arising out of or related to the performance of the services hereunder by Cardinal, regardless of whether such claim is based upon any of the above stated reasons or otherwise. Results relate only to the samples identified above. This report shall not be reproduced except in full with written approval of Cardinal Laboratories.

Mike Snyder For Celey D. Keene, Lab Director/Quality Manager





PHONE (575) 393-2326 ° 101 E. MARLAND ° HOBBS, NM 88240

**Analytical Results For:**

BBC International, Inc.  
 Cliff Brunson  
 P.O. Box 805  
 Hobbs NM, 88241  
 Fax To: (575) 397-0397

Received:	11/21/2019	Sampling Date:	11/19/2019
Reported:	11/26/2019	Sampling Type:	Soil
Project Name:	LENGTH CC 6-7 FED COM #22H	Sampling Condition:	Cool & Intact
Project Number:	NONE GIVEN	Sample Received By:	Jodi Henson
Project Location:	OXY		

**Sample ID: E @ SURFACE (H903965-02)**

BTX 8021B		mg/kg		Analyzed By: MS						
Analyte	Result	Reporting Limit	Analyzed	Method Blank	BS	% Recovery	True Value QC	RPD	Qualifier	
Benzene*	<0.050	0.050	11/23/2019	ND	1.69	84.6	2.00	7.13		
Toluene*	<0.050	0.050	11/23/2019	ND	1.67	83.6	2.00	6.81		
Ethylbenzene*	<0.050	0.050	11/23/2019	ND	1.62	81.2	2.00	7.53		
Total Xylenes*	<0.150	0.150	11/23/2019	ND	4.76	79.3	6.00	7.58		
Total BTX	<0.300	0.300	11/23/2019	ND						

Surrogate: 4-Bromofluorobenzene (PID) 97.0 % 73.3-129

Chloride, SM4500CI-B		mg/kg		Analyzed By: AC						
Analyte	Result	Reporting Limit	Analyzed	Method Blank	BS	% Recovery	True Value QC	RPD	Qualifier	
Chloride	48.0	16.0	11/26/2019	ND	432	108	400	0.00		

TPH 8015M		mg/kg		Analyzed By: MS					
Analyte	Result	Reporting Limit	Analyzed	Method Blank	BS	% Recovery	True Value QC	RPD	Qualifier
GRO C6-C10*	<10.0	10.0	11/23/2019	ND	207	103	200	3.25	
DRO >C10-C28*	<10.0	10.0	11/23/2019	ND	210	105	200	0.814	
EXT DRO >C28-C36	<10.0	10.0	11/23/2019	ND					

Surrogate: 1-Chlorooctane 89.9 % 41-142

Surrogate: 1-Chlorooctadecane 93.4 % 37.6-147

Cardinal Laboratories

\*=Accredited Analyte

PLEASE NOTE: Liability and Damages. Cardinal's liability and client's exclusive remedy for any claim arising, whether based in contract or tort, shall be limited to the amount paid by client for analyses. All claims, including those for negligence and any other cause whatsoever shall be deemed waived unless made in writing and received by Cardinal within thirty (30) days after completion of the applicable service. In no event shall Cardinal be liable for incidental or consequential damages, including, without limitation, business interruptions, loss of use, or loss of profits incurred by client, its subsidiaries, affiliates or successors arising out of or related to the performance of the services hereunder by Cardinal, regardless of whether such claim is based upon any of the above stated reasons or otherwise. Results relate only to the samples identified above. This report shall not be reproduced except in full with written approval of Cardinal Laboratories.

Mike Snyder For Celey D. Keene, Lab Director/Quality Manager



PHONE (575) 393-2326 ° 101 E. MARLAND ° HOBBS, NM 88240

**Analytical Results For:**

BBC International, Inc.  
 Cliff Brunson  
 P.O. Box 805  
 Hobbs NM, 88241  
 Fax To: (575) 397-0397

Received:	11/21/2019	Sampling Date:	11/19/2019
Reported:	11/26/2019	Sampling Type:	Soil
Project Name:	LENGTH CC 6-7 FED COM #22H	Sampling Condition:	Cool & Intact
Project Number:	NONE GIVEN	Sample Received By:	Jodi Henson
Project Location:	OXY		

**Sample ID: W @ SURFACE (H903965-03)**

BTX 8021B			mg/kg							
			Analyzed By: MS							
Analyte	Result	Reporting Limit	Analyzed	Method Blank	BS	% Recovery	True Value QC	RPD	Qualifier	
Benzene*	<0.050	0.050	11/23/2019	ND	1.69	84.6	2.00	7.13		
Toluene*	<0.050	0.050	11/23/2019	ND	1.67	83.6	2.00	6.81		
Ethylbenzene*	<0.050	0.050	11/23/2019	ND	1.62	81.2	2.00	7.53		
Total Xylenes*	<0.150	0.150	11/23/2019	ND	4.76	79.3	6.00	7.58		
Total BTX	<0.300	0.300	11/23/2019	ND						

Surrogate: 4-Bromofluorobenzene (PID) 99.7 % 73.3-129

Chloride, SM4500CI-B			mg/kg							
			Analyzed By: AC							
Analyte	Result	Reporting Limit	Analyzed	Method Blank	BS	% Recovery	True Value QC	RPD	Qualifier	
Chloride	48.0	16.0	11/26/2019	ND	432	108	400	0.00		

TPH 8015M			mg/kg							
			Analyzed By: MS							
Analyte	Result	Reporting Limit	Analyzed	Method Blank	BS	% Recovery	True Value QC	RPD	Qualifier	
GRO C6-C10*	<10.0	10.0	11/23/2019	ND	207	103	200	3.25		
DRO >C10-C28*	<10.0	10.0	11/23/2019	ND	210	105	200	0.814		
EXT DRO >C28-C36	<10.0	10.0	11/23/2019	ND						

Surrogate: 1-Chlorooctane 83.9 % 41-142

Surrogate: 1-Chlorooctadecane 87.6 % 37.6-147

Cardinal Laboratories

\*=Accredited Analyte

PLEASE NOTE: Liability and Damages. Cardinal's liability and client's exclusive remedy for any claim arising, whether based in contract or tort, shall be limited to the amount paid by client for analyses. All claims, including those for negligence and any other cause whatsoever shall be deemed waived unless made in writing and received by Cardinal within thirty (30) days after completion of the applicable service. In no event shall Cardinal be liable for incidental or consequential damages, including, without limitation, business interruptions, loss of use, or loss of profits incurred by client, its subsidiaries, affiliates or successors arising out of or related to the performance of the services hereunder by Cardinal, regardless of whether such claim is based upon any of the above stated reasons or otherwise. Results relate only to the samples identified above. This report shall not be reproduced except in full with written approval of Cardinal Laboratories.

Mike Snyder For Celey D. Keene, Lab Director/Quality Manager



PHONE (575) 393-2326 • 101 E. MARLAND • HOBBS, NM 88240

**Analytical Results For:**

BBC International, Inc.  
 Cliff Brunson  
 P.O. Box 805  
 Hobbs NM, 88241  
 Fax To: (575) 397-0397

Received:	11/21/2019	Sampling Date:	11/19/2019
Reported:	11/26/2019	Sampling Type:	Soil
Project Name:	LENGTH CC 6-7 FED COM #22H	Sampling Condition:	Cool & Intact
Project Number:	NONE GIVEN	Sample Received By:	Jodi Henson
Project Location:	OXY		

**Sample ID: S @ SURFACE (H903965-04)**

BTX 8021B		mg/kg		Analyzed By: MS						
Analyte	Result	Reporting Limit	Analyzed	Method Blank	BS	% Recovery	True Value QC	RPD	Qualifier	
Benzene*	<0.050	0.050	11/23/2019	ND	1.69	84.6	2.00	7.13		
Toluene*	<0.050	0.050	11/23/2019	ND	1.67	83.6	2.00	6.81		
Ethylbenzene*	<0.050	0.050	11/23/2019	ND	1.62	81.2	2.00	7.53		
Total Xylenes*	<0.150	0.150	11/23/2019	ND	4.76	79.3	6.00	7.58		
Total BTX	<0.300	0.300	11/23/2019	ND						

Surrogate: 4-Bromofluorobenzene (PID) 98.6 % 73.3-129

Chloride, SM4500CI-B		mg/kg		Analyzed By: AC						
Analyte	Result	Reporting Limit	Analyzed	Method Blank	BS	% Recovery	True Value QC	RPD	Qualifier	
Chloride	32.0	16.0	11/26/2019	ND	432	108	400	0.00		

TPH 8015M		mg/kg		Analyzed By: MS					
Analyte	Result	Reporting Limit	Analyzed	Method Blank	BS	% Recovery	True Value QC	RPD	Qualifier
GRO C6-C10*	<10.0	10.0	11/23/2019	ND	207	103	200	3.25	
DRO >C10-C28*	<10.0	10.0	11/23/2019	ND	210	105	200	0.814	
EXT DRO >C28-C36	<10.0	10.0	11/23/2019	ND					

Surrogate: 1-Chlorooctane 85.9 % 41-142

Surrogate: 1-Chlorooctadecane 91.9 % 37.6-147

Cardinal Laboratories

\*=Accredited Analyte

PLEASE NOTE: Liability and Damages. Cardinal's liability and client's exclusive remedy for any claim arising, whether based in contract or tort, shall be limited to the amount paid by client for analyses. All claims, including those for negligence and any other cause whatsoever shall be deemed waived unless made in writing and received by Cardinal within thirty (30) days after completion of the applicable service. In no event shall Cardinal be liable for incidental or consequential damages, including, without limitation, business interruptions, loss of use, or loss of profits incurred by client, its subsidiaries, affiliates or successors arising out of or related to the performance of the services hereunder by Cardinal, regardless of whether such claim is based upon any of the above stated reasons or otherwise. Results relate only to the samples identified above. This report shall not be reproduced except in full with written approval of Cardinal Laboratories.

Mike Snyder For Celey D. Keene, Lab Director/Quality Manager





PHONE (575) 393-2326 • 101 E. MARLAND • HOBBS, NM 88240

**Analytical Results For:**

BBC International, Inc.  
 Cliff Brunson  
 P.O. Box 805  
 Hobbs NM, 88241  
 Fax To: (575) 397-0397

Received:	11/21/2019	Sampling Date:	11/14/2019
Reported:	11/26/2019	Sampling Type:	Soil
Project Name:	LENGTH CC 6-7 FED COM #22H	Sampling Condition:	Cool & Intact
Project Number:	NONE GIVEN	Sample Received By:	Jodi Henson
Project Location:	OXY		

**Sample ID: SP 1 @ SURFACE (H903965-05)**

BTX 8021B		mg/kg		Analyzed By: MS						
Analyte	Result	Reporting Limit	Analyzed	Method Blank	BS	% Recovery	True Value QC	RPD	Qualifier	
Benzene*	<0.050	0.050	11/23/2019	ND	1.69	84.6	2.00	7.13		
Toluene*	<0.050	0.050	11/23/2019	ND	1.67	83.6	2.00	6.81		
Ethylbenzene*	<0.050	0.050	11/23/2019	ND	1.62	81.2	2.00	7.53		
Total Xylenes*	<0.150	0.150	11/23/2019	ND	4.76	79.3	6.00	7.58		
Total BTX	<0.300	0.300	11/23/2019	ND						

Surrogate: 4-Bromofluorobenzene (PID) 99.4 % 73.3-129

Chloride, SM4500CI-B		mg/kg		Analyzed By: AC						
Analyte	Result	Reporting Limit	Analyzed	Method Blank	BS	% Recovery	True Value QC	RPD	Qualifier	
Chloride	880	16.0	11/26/2019	ND	432	108	400	0.00		

TPH 8015M		mg/kg		Analyzed By: MS				S-06	
Analyte	Result	Reporting Limit	Analyzed	Method Blank	BS	% Recovery	True Value QC	RPD	Qualifier
GRO C6-C10*	<10.0	10.0	11/23/2019	ND	207	103	200	3.25	
DRO >C10-C28*	2540	10.0	11/23/2019	ND	210	105	200	0.814	
EXT DRO >C28-C36	71.6	10.0	11/23/2019	ND					

Surrogate: 1-Chlorooctane 72.0 % 41-142

Surrogate: 1-Chlorooctadecane 206 % 37.6-147

Cardinal Laboratories

\*=Accredited Analyte

PLEASE NOTE: Liability and Damages. Cardinal's liability and client's exclusive remedy for any claim arising, whether based in contract or tort, shall be limited to the amount paid by client for analyses. All claims, including those for negligence and any other cause whatsoever shall be deemed waived unless made in writing and received by Cardinal within thirty (30) days after completion of the applicable service. In no event shall Cardinal be liable for incidental or consequential damages, including, without limitation, business interruptions, loss of use, or loss of profits incurred by client, its subsidiaries, affiliates or successors arising out of or related to the performance of the services hereunder by Cardinal, regardless of whether such claim is based upon any of the above stated reasons or otherwise. Results relate only to the samples identified above. This report shall not be reproduced except in full with written approval of Cardinal Laboratories.

Mike Snyder For Celey D. Keene, Lab Director/Quality Manager



PHONE (575) 393-2326 ° 101 E. MARLAND ° HOBBS, NM 88240

**Analytical Results For:**

BBC International, Inc.  
 Cliff Brunson  
 P.O. Box 805  
 Hobbs NM, 88241  
 Fax To: (575) 397-0397

Received:	11/21/2019	Sampling Date:	11/14/2019
Reported:	11/26/2019	Sampling Type:	Soil
Project Name:	LENGTH CC 6-7 FED COM #22H	Sampling Condition:	Cool & Intact
Project Number:	NONE GIVEN	Sample Received By:	Jodi Henson
Project Location:	OXY		

**Sample ID: SP 1 @ 1' (H903965-06)**

BTEx 8021B		mg/kg		Analyzed By: MS					
Analyte	Result	Reporting Limit	Analyzed	Method Blank	BS	% Recovery	True Value QC	RPD	Qualifier
Benzene*	<0.050	0.050	11/23/2019	ND	1.69	84.6	2.00	7.13	
Toluene*	<0.050	0.050	11/23/2019	ND	1.67	83.6	2.00	6.81	
Ethylbenzene*	<0.050	0.050	11/23/2019	ND	1.62	81.2	2.00	7.53	
Total Xylenes*	<0.150	0.150	11/23/2019	ND	4.76	79.3	6.00	7.58	
Total BTEX	<0.300	0.300	11/23/2019	ND					

Surrogate: 4-Bromofluorobenzene (PID) 97.9 % 73.3-129

Chloride, SM4500Cl-B		mg/kg		Analyzed By: AC						
Analyte	Result	Reporting Limit	Analyzed	Method Blank	BS	% Recovery	True Value QC	RPD	Qualifier	
Chloride	640	16.0	11/26/2019	ND	432	108	400	0.00		

TPH 8015M		mg/kg		Analyzed By: MS					
Analyte	Result	Reporting Limit	Analyzed	Method Blank	BS	% Recovery	True Value QC	RPD	Qualifier
GRO C6-C10*	<10.0	10.0	11/23/2019	ND	207	103	200	3.25	
DRO >C10-C28*	<10.0	10.0	11/23/2019	ND	210	105	200	0.814	
EXT DRO >C28-C36	<10.0	10.0	11/23/2019	ND					

Surrogate: 1-Chlorooctane 93.7 % 41-142

Surrogate: 1-Chlorooctadecane 99.6 % 37.6-147

Cardinal Laboratories

\*=Accredited Analyte

PLEASE NOTE: Liability and Damages. Cardinal's liability and client's exclusive remedy for any claim arising, whether based in contract or tort, shall be limited to the amount paid by client for analyses. All claims, including those for negligence and any other cause whatsoever shall be deemed waived unless made in writing and received by Cardinal within thirty (30) days after completion of the applicable service. In no event shall Cardinal be liable for incidental or consequential damages, including, without limitation, business interruptions, loss of use, or loss of profits incurred by client, its subsidiaries, affiliates or successors arising out of or related to the performance of the services hereunder by Cardinal, regardless of whether such claim is based upon any of the above stated reasons or otherwise. Results relate only to the samples identified above. This report shall not be reproduced except in full with written approval of Cardinal Laboratories.

Mike Snyder For Celey D. Keene, Lab Director/Quality Manager



PHONE (575) 393-2326 ° 101 E. MARLAND ° HOBBS, NM 88240

**Analytical Results For:**

BBC International, Inc.  
 Cliff Brunson  
 P.O. Box 805  
 Hobbs NM, 88241  
 Fax To: (575) 397-0397

Received:	11/21/2019	Sampling Date:	11/19/2019
Reported:	11/26/2019	Sampling Type:	Soil
Project Name:	LENGTH CC 6-7 FED COM #22H	Sampling Condition:	Cool & Intact
Project Number:	NONE GIVEN	Sample Received By:	Jodi Henson
Project Location:	OXY		

**Sample ID: SP 1 @ 2' (H903965-07)**

BTX 8021B			mg/kg		Analyzed By: MS				
Analyte	Result	Reporting Limit	Analyzed	Method Blank	BS	% Recovery	True Value QC	RPD	Qualifier
Benzene*	<0.050	0.050	11/23/2019	ND	1.69	84.6	2.00	7.13	
Toluene*	<0.050	0.050	11/23/2019	ND	1.67	83.6	2.00	6.81	
Ethylbenzene*	<0.050	0.050	11/23/2019	ND	1.62	81.2	2.00	7.53	
Total Xylenes*	<0.150	0.150	11/23/2019	ND	4.76	79.3	6.00	7.58	
Total BTX	<0.300	0.300	11/23/2019	ND					

Surrogate: 4-Bromofluorobenzene (PID) 99.1 % 73.3-129

Chloride, SM4500CI-B			mg/kg		Analyzed By: AC				
Analyte	Result	Reporting Limit	Analyzed	Method Blank	BS	% Recovery	True Value QC	RPD	Qualifier
Chloride	480	16.0	11/26/2019	ND	416	104	400	7.41	

TPH 8015M			mg/kg		Analyzed By: MS				
Analyte	Result	Reporting Limit	Analyzed	Method Blank	BS	% Recovery	True Value QC	RPD	Qualifier
GRO C6-C10*	<10.0	10.0	11/23/2019	ND	207	103	200	3.25	
DRO >C10-C28*	<10.0	10.0	11/23/2019	ND	210	105	200	0.814	
EXT DRO >C28-C36	<10.0	10.0	11/23/2019	ND					

Surrogate: 1-Chlorooctane 85.4 % 41-142

Surrogate: 1-Chlorooctadecane 89.5 % 37.6-147

Cardinal Laboratories

\*=Accredited Analyte

PLEASE NOTE: Liability and Damages. Cardinal's liability and client's exclusive remedy for any claim arising, whether based in contract or tort, shall be limited to the amount paid by client for analyses. All claims, including those for negligence and any other cause whatsoever shall be deemed waived unless made in writing and received by Cardinal within thirty (30) days after completion of the applicable service. In no event shall Cardinal be liable for incidental or consequential damages, including, without limitation, business interruptions, loss of use, or loss of profits incurred by client, its subsidiaries, affiliates or successors arising out of or related to the performance of the services hereunder by Cardinal, regardless of whether such claim is based upon any of the above stated reasons or otherwise. Results relate only to the samples identified above. This report shall not be reproduced except in full with written approval of Cardinal Laboratories.

Mike Snyder For Celey D. Keene, Lab Director/Quality Manager



PHONE (575) 393-2326 ° 101 E. MARLAND ° HOBBS, NM 88240

**Analytical Results For:**

BBC International, Inc.  
 Cliff Brunson  
 P.O. Box 805  
 Hobbs NM, 88241  
 Fax To: (575) 397-0397

Received:	11/21/2019	Sampling Date:	11/19/2019
Reported:	11/26/2019	Sampling Type:	Soil
Project Name:	LENGTH CC 6-7 FED COM #22H	Sampling Condition:	Cool & Intact
Project Number:	NONE GIVEN	Sample Received By:	Jodi Henson
Project Location:	OXY		

**Sample ID: SP 1 @ 3' (H903965-08)**

Chloride, SM4500Cl-B		mg/kg		Analyzed By: AC						
Analyte	Result	Reporting Limit	Analyzed	Method Blank	BS	% Recovery	True Value QC	RPD	Qualifier	
Chloride	2280	16.0	11/26/2019	ND	416	104	400	7.41		

**Sample ID: SP 1 @ 4' (H903965-09)**

Chloride, SM4500Cl-B		mg/kg		Analyzed By: AC						
Analyte	Result	Reporting Limit	Analyzed	Method Blank	BS	% Recovery	True Value QC	RPD	Qualifier	
Chloride	2480	16.0	11/26/2019	ND	416	104	400	7.41		

**Sample ID: SP 1 @ 5' (H903965-10)**

Chloride, SM4500Cl-B		mg/kg		Analyzed By: AC						
Analyte	Result	Reporting Limit	Analyzed	Method Blank	BS	% Recovery	True Value QC	RPD	Qualifier	
Chloride	2200	16.0	11/26/2019	ND	416	104	400	7.41		

**Sample ID: SP 1 @ 6' (H903965-11)**

Chloride, SM4500Cl-B		mg/kg		Analyzed By: AC						
Analyte	Result	Reporting Limit	Analyzed	Method Blank	BS	% Recovery	True Value QC	RPD	Qualifier	
Chloride	2280	16.0	11/26/2019	ND	416	104	400	7.41		

**Sample ID: SP 1 @ 7' (H903965-12)**

Chloride, SM4500Cl-B		mg/kg		Analyzed By: AC						
Analyte	Result	Reporting Limit	Analyzed	Method Blank	BS	% Recovery	True Value QC	RPD	Qualifier	
Chloride	2200	16.0	11/26/2019	ND	416	104	400	7.41		

Cardinal Laboratories

\*=Accredited Analyte

PLEASE NOTE: Liability and Damages. Cardinal's liability and client's exclusive remedy for any claim arising, whether based in contract or tort, shall be limited to the amount paid by client for analyses. All claims, including those for negligence and any other cause whatsoever shall be deemed waived unless made in writing and received by Cardinal within thirty (30) days after completion of the applicable service. In no event shall Cardinal be liable for incidental or consequential damages, including, without limitation, business interruptions, loss of use, or loss of profits incurred by client, its subsidiaries, affiliates or successors arising out of or related to the performance of the services hereunder by Cardinal, regardless of whether such claim is based upon any of the above stated reasons or otherwise. Results relate only to the samples identified above. This report shall not be reproduced except in full with written approval of Cardinal Laboratories.

Mike Snyder For Celey D. Keene, Lab Director/Quality Manager





PHONE (575) 393-2326 ° 101 E. MARLAND ° HOBBS, NM 88240

**Analytical Results For:**

BBC International, Inc.  
 Cliff Brunson  
 P.O. Box 805  
 Hobbs NM, 88241  
 Fax To: (575) 397-0397

Received:	11/21/2019	Sampling Date:	11/19/2019
Reported:	11/26/2019	Sampling Type:	Soil
Project Name:	LENGTH CC 6-7 FED COM #22H	Sampling Condition:	Cool & Intact
Project Number:	NONE GIVEN	Sample Received By:	Jodi Henson
Project Location:	OXY		

**Sample ID: SP 1 @ 8' (H903965-13)**

Chloride, SM4500Cl-B		mg/kg		Analyzed By: AC						
Analyte	Result	Reporting Limit	Analyzed	Method Blank	BS	% Recovery	True Value QC	RPD	Qualifier	
Chloride	2400	16.0	11/26/2019	ND	416	104	400	7.41		

**Sample ID: SP 1 @ 9' (H903965-14)**

Chloride, SM4500Cl-B		mg/kg		Analyzed By: AC						
Analyte	Result	Reporting Limit	Analyzed	Method Blank	BS	% Recovery	True Value QC	RPD	Qualifier	
Chloride	464	16.0	11/26/2019	ND	416	104	400	7.41		

**Sample ID: SP 1 @ 10' (H903965-15)**

Chloride, SM4500Cl-B		mg/kg		Analyzed By: AC						
Analyte	Result	Reporting Limit	Analyzed	Method Blank	BS	% Recovery	True Value QC	RPD	Qualifier	
Chloride	48.0	16.0	11/26/2019	ND	416	104	400	7.41		

**Sample ID: SP 1 @ 11' (H903965-16)**

Chloride, SM4500Cl-B		mg/kg		Analyzed By: AC						
Analyte	Result	Reporting Limit	Analyzed	Method Blank	BS	% Recovery	True Value QC	RPD	Qualifier	
Chloride	48.0	16.0	11/26/2019	ND	416	104	400	7.41		

Cardinal Laboratories

\*=Accredited Analyte

PLEASE NOTE: Liability and Damages. Cardinal's liability and client's exclusive remedy for any claim arising, whether based in contract or tort, shall be limited to the amount paid by client for analyses. All claims, including those for negligence and any other cause whatsoever shall be deemed waived unless made in writing and received by Cardinal within thirty (30) days after completion of the applicable service. In no event shall Cardinal be liable for incidental or consequential damages, including, without limitation, business interruptions, loss of use, or loss of profits incurred by client, its subsidiaries, affiliates or successors arising out of or related to the performance of the services hereunder by Cardinal, regardless of whether such claim is based upon any of the above stated reasons or otherwise. Results relate only to the samples identified above. This report shall not be reproduced except in full with written approval of Cardinal Laboratories.

Mike Snyder For Celey D. Keene, Lab Director/Quality Manager



PHONE (575) 393-2326 • 101 E. MARLAND • HOBBS, NM 88240

**Analytical Results For:**

BBC International, Inc.  
 Cliff Brunson  
 P.O. Box 805  
 Hobbs NM, 88241  
 Fax To: (575) 397-0397

Received:	11/21/2019	Sampling Date:	11/14/2019
Reported:	11/26/2019	Sampling Type:	Soil
Project Name:	LENGTH CC 6-7 FED COM #22H	Sampling Condition:	Cool & Intact
Project Number:	NONE GIVEN	Sample Received By:	Jodi Henson
Project Location:	OXY		

**Sample ID: SP 2 @ SURFACE (H903965-17)**

BTX 8021B		mg/kg		Analyzed By: MS					
Analyte	Result	Reporting Limit	Analyzed	Method Blank	BS	% Recovery	True Value QC	RPD	Qualifier
Benzene*	<0.050	0.050	11/23/2019	ND	1.69	84.6	2.00	7.13	
Toluene*	<0.050	0.050	11/23/2019	ND	1.67	83.6	2.00	6.81	
Ethylbenzene*	<0.050	0.050	11/23/2019	ND	1.62	81.2	2.00	7.53	
Total Xylenes*	<0.150	0.150	11/23/2019	ND	4.76	79.3	6.00	7.58	
Total BTX	<0.300	0.300	11/23/2019	ND					

Surrogate: 4-Bromofluorobenzene (PID) 98.6 % 73.3-129

Chloride, SM4500CI-B		mg/kg		Analyzed By: AC					
Analyte	Result	Reporting Limit	Analyzed	Method Blank	BS	% Recovery	True Value QC	RPD	Qualifier
Chloride	4560	16.0	11/26/2019	ND	416	104	400	7.41	

TPH 8015M		mg/kg		Analyzed By: MS					
Analyte	Result	Reporting Limit	Analyzed	Method Blank	BS	% Recovery	True Value QC	RPD	Qualifier
GRO C6-C10*	<10.0	10.0	11/23/2019	ND	207	103	200	3.25	
DRO >C10-C28*	399	10.0	11/23/2019	ND	210	105	200	0.814	
EXT DRO >C28-C36	114	10.0	11/23/2019	ND					

Surrogate: 1-Chlorooctane 87.1 % 41-142

Surrogate: 1-Chlorooctadecane 112 % 37.6-147

Cardinal Laboratories

\*=Accredited Analyte

PLEASE NOTE: Liability and Damages. Cardinal's liability and client's exclusive remedy for any claim arising, whether based in contract or tort, shall be limited to the amount paid by client for analyses. All claims, including those for negligence and any other cause whatsoever shall be deemed waived unless made in writing and received by Cardinal within thirty (30) days after completion of the applicable service. In no event shall Cardinal be liable for incidental or consequential damages, including, without limitation, business interruptions, loss of use, or loss of profits incurred by client, its subsidiaries, affiliates or successors arising out of or related to the performance of the services hereunder by Cardinal, regardless of whether such claim is based upon any of the above stated reasons or otherwise. Results relate only to the samples identified above. This report shall not be reproduced except in full with written approval of Cardinal Laboratories.

Mike Snyder For Celey D. Keene, Lab Director/Quality Manager



PHONE (575) 393-2326 • 101 E. MARLAND • HOBBS, NM 88240

**Analytical Results For:**

BBC International, Inc.  
 Cliff Brunson  
 P.O. Box 805  
 Hobbs NM, 88241  
 Fax To: (575) 397-0397

Received:	11/21/2019	Sampling Date:	11/14/2019
Reported:	11/26/2019	Sampling Type:	Soil
Project Name:	LENGTH CC 6-7 FED COM #22H	Sampling Condition:	Cool & Intact
Project Number:	NONE GIVEN	Sample Received By:	Jodi Henson
Project Location:	OXY		

**Sample ID: SP 2 @ 1' (H903965-18)**

BTX 8021B		mg/kg		Analyzed By: MS					
Analyte	Result	Reporting Limit	Analyzed	Method Blank	BS	% Recovery	True Value QC	RPD	Qualifier
Benzene*	<0.050	0.050	11/23/2019	ND	1.69	84.6	2.00	7.13	
Toluene*	<0.050	0.050	11/23/2019	ND	1.67	83.6	2.00	6.81	
Ethylbenzene*	<0.050	0.050	11/23/2019	ND	1.62	81.2	2.00	7.53	
Total Xylenes*	<0.150	0.150	11/23/2019	ND	4.76	79.3	6.00	7.58	
Total BTX	<0.300	0.300	11/23/2019	ND					

Surrogate: 4-Bromofluorobenzene (PID) 99.6 % 73.3-129

Chloride, SM4500Cl-B		mg/kg		Analyzed By: AC						
Analyte	Result	Reporting Limit	Analyzed	Method Blank	BS	% Recovery	True Value QC	RPD	Qualifier	
Chloride	352	16.0	11/26/2019	ND	416	104	400	7.41		

TPH 8015M		mg/kg		Analyzed By: MS					
Analyte	Result	Reporting Limit	Analyzed	Method Blank	BS	% Recovery	True Value QC	RPD	Qualifier
GRO C6-C10*	<10.0	10.0	11/23/2019	ND	207	103	200	3.25	
DRO >C10-C28*	<10.0	10.0	11/23/2019	ND	210	105	200	0.814	
EXT DRO >C28-C36	<10.0	10.0	11/23/2019	ND					

Surrogate: 1-Chlorooctane 97.3 % 41-142

Surrogate: 1-Chlorooctadecane 103 % 37.6-147

Cardinal Laboratories

\*=Accredited Analyte

PLEASE NOTE: Liability and Damages. Cardinal's liability and client's exclusive remedy for any claim arising, whether based in contract or tort, shall be limited to the amount paid by client for analyses. All claims, including those for negligence and any other cause whatsoever shall be deemed waived unless made in writing and received by Cardinal within thirty (30) days after completion of the applicable service. In no event shall Cardinal be liable for incidental or consequential damages, including, without limitation, business interruptions, loss of use, or loss of profits incurred by client, its subsidiaries, affiliates or successors arising out of or related to the performance of the services hereunder by Cardinal, regardless of whether such claim is based upon any of the above stated reasons or otherwise. Results relate only to the samples identified above. This report shall not be reproduced except in full with written approval of Cardinal Laboratories.

Mike Snyder For Celey D. Keene, Lab Director/Quality Manager



PHONE (575) 393-2326 ° 101 E. MARLAND ° HOBBS, NM 88240

**Analytical Results For:**

BBC International, Inc.  
 Cliff Brunson  
 P.O. Box 805  
 Hobbs NM, 88241  
 Fax To: (575) 397-0397

Received:	11/21/2019	Sampling Date:	11/14/2019
Reported:	11/26/2019	Sampling Type:	Soil
Project Name:	LENGTH CC 6-7 FED COM #22H	Sampling Condition:	Cool & Intact
Project Number:	NONE GIVEN	Sample Received By:	Jodi Henson
Project Location:	OXY		

**Sample ID: SP 2 @ 2' (H903965-19)**

BTX 8021B		mg/kg		Analyzed By: MS					
Analyte	Result	Reporting Limit	Analyzed	Method Blank	BS	% Recovery	True Value QC	RPD	Qualifier
Benzene*	<0.050	0.050	11/23/2019	ND	1.69	84.6	2.00	7.13	
Toluene*	<0.050	0.050	11/23/2019	ND	1.67	83.6	2.00	6.81	
Ethylbenzene*	<0.050	0.050	11/23/2019	ND	1.62	81.2	2.00	7.53	
Total Xylenes*	<0.150	0.150	11/23/2019	ND	4.76	79.3	6.00	7.58	
Total BTX	<0.300	0.300	11/23/2019	ND					

Surrogate: 4-Bromofluorobenzene (PID) 98.4 % 73.3-129

Chloride, SM4500CI-B		mg/kg		Analyzed By: AC					
Analyte	Result	Reporting Limit	Analyzed	Method Blank	BS	% Recovery	True Value QC	RPD	Qualifier
Chloride	432	16.0	11/26/2019	ND	416	104	400	7.41	

TPH 8015M		mg/kg		Analyzed By: MS					
Analyte	Result	Reporting Limit	Analyzed	Method Blank	BS	% Recovery	True Value QC	RPD	Qualifier
GRO C6-C10*	<10.0	10.0	11/23/2019	ND	207	103	200	3.25	
DRO >C10-C28*	164	10.0	11/23/2019	ND	210	105	200	0.814	
EXT DRO >C28-C36	<10.0	10.0	11/23/2019	ND					

Surrogate: 1-Chlorooctane 102 % 41-142

Surrogate: 1-Chlorooctadecane 111 % 37.6-147

Cardinal Laboratories

\*=Accredited Analyte

PLEASE NOTE: Liability and Damages. Cardinal's liability and client's exclusive remedy for any claim arising, whether based in contract or tort, shall be limited to the amount paid by client for analyses. All claims, including those for negligence and any other cause whatsoever shall be deemed waived unless made in writing and received by Cardinal within thirty (30) days after completion of the applicable service. In no event shall Cardinal be liable for incidental or consequential damages, including, without limitation, business interruptions, loss of use, or loss of profits incurred by client, its subsidiaries, affiliates or successors arising out of or related to the performance of the services hereunder by Cardinal, regardless of whether such claim is based upon any of the above stated reasons or otherwise. Results relate only to the samples identified above. This report shall not be reproduced except in full with written approval of Cardinal Laboratories.

Mike Snyder For Celey D. Keene, Lab Director/Quality Manager





PHONE (575) 393-2326 ° 101 E. MARLAND ° HOBBS, NM 88240

**Analytical Results For:**

BBC International, Inc.  
 Cliff Brunson  
 P.O. Box 805  
 Hobbs NM, 88241  
 Fax To: (575) 397-0397

Received:	11/21/2019	Sampling Date:	11/14/2019
Reported:	11/26/2019	Sampling Type:	Soil
Project Name:	LENGTH CC 6-7 FED COM #22H	Sampling Condition:	Cool & Intact
Project Number:	NONE GIVEN	Sample Received By:	Jodi Henson
Project Location:	OXY		

**Sample ID: SP 2 @ 3' (H903965-20)**

BTX 8021B		mg/kg		Analyzed By: MS					
Analyte	Result	Reporting Limit	Analyzed	Method Blank	BS	% Recovery	True Value QC	RPD	Qualifier
Benzene*	<0.050	0.050	11/23/2019	ND	1.69	84.6	2.00	7.13	
Toluene*	<0.050	0.050	11/23/2019	ND	1.67	83.6	2.00	6.81	
Ethylbenzene*	<0.050	0.050	11/23/2019	ND	1.62	81.2	2.00	7.53	
Total Xylenes*	<0.150	0.150	11/23/2019	ND	4.76	79.3	6.00	7.58	
Total BTX	<0.300	0.300	11/23/2019	ND					

Surrogate: 4-Bromofluorobenzene (PID) 98.5 % 73.3-129

Chloride, SM4500CI-B		mg/kg		Analyzed By: AC						
Analyte	Result	Reporting Limit	Analyzed	Method Blank	BS	% Recovery	True Value QC	RPD	Qualifier	
Chloride	608	16.0	11/26/2019	ND	416	104	400	7.41		

TPH 8015M		mg/kg		Analyzed By: MS					
Analyte	Result	Reporting Limit	Analyzed	Method Blank	BS	% Recovery	True Value QC	RPD	Qualifier
GRO C6-C10*	<10.0	10.0	11/23/2019	ND	207	103	200	3.25	
DRO >C10-C28*	71.8	10.0	11/23/2019	ND	210	105	200	0.814	
EXT DRO >C28-C36	<10.0	10.0	11/23/2019	ND					

Surrogate: 1-Chlorooctane 96.2 % 41-142

Surrogate: 1-Chlorooctadecane 104 % 37.6-147

Cardinal Laboratories

\*=Accredited Analyte

PLEASE NOTE: Liability and Damages. Cardinal's liability and client's exclusive remedy for any claim arising, whether based in contract or tort, shall be limited to the amount paid by client for analyses. All claims, including those for negligence and any other cause whatsoever shall be deemed waived unless made in writing and received by Cardinal within thirty (30) days after completion of the applicable service. In no event shall Cardinal be liable for incidental or consequential damages, including, without limitation, business interruptions, loss of use, or loss of profits incurred by client, its subsidiaries, affiliates or successors arising out of or related to the performance of the services hereunder by Cardinal, regardless of whether such claim is based upon any of the above stated reasons or otherwise. Results relate only to the samples identified above. This report shall not be reproduced except in full with written approval of Cardinal Laboratories.

Mike Snyder For Celey D. Keene, Lab Director/Quality Manager



PHONE (575) 393-2326 ° 101 E. MARLAND ° HOBBS, NM 88240

**Analytical Results For:**

BBC International, Inc.  
 Cliff Brunson  
 P.O. Box 805  
 Hobbs NM, 88241  
 Fax To: (575) 397-0397

Received:	11/21/2019	Sampling Date:	11/19/2019
Reported:	11/26/2019	Sampling Type:	Soil
Project Name:	LENGTH CC 6-7 FED COM #22H	Sampling Condition:	Cool & Intact
Project Number:	NONE GIVEN	Sample Received By:	Jodi Henson
Project Location:	OXY		

**Sample ID: SP 2 @ 4' (H903965-21)**

BTX 8021B		mg/kg		Analyzed By: MS						
Analyte	Result	Reporting Limit	Analyzed	Method Blank	BS	% Recovery	True Value QC	RPD	Qualifier	
Benzene*	<0.050	0.050	11/23/2019	ND	1.69	84.6	2.00	7.13		
Toluene*	<0.050	0.050	11/23/2019	ND	1.67	83.6	2.00	6.81		
Ethylbenzene*	<0.050	0.050	11/23/2019	ND	1.62	81.2	2.00	7.53		
Total Xylenes*	<0.150	0.150	11/23/2019	ND	4.76	79.3	6.00	7.58		
Total BTX	<0.300	0.300	11/23/2019	ND						

Surrogate: 4-Bromofluorobenzene (PID) 98.6 % 73.3-129

Chloride, SM4500Cl-B		mg/kg		Analyzed By: AC						
Analyte	Result	Reporting Limit	Analyzed	Method Blank	BS	% Recovery	True Value QC	RPD	Qualifier	
Chloride	496	16.0	11/26/2019	ND	416	104	400	7.41		

TPH 8015M		mg/kg		Analyzed By: MS					
Analyte	Result	Reporting Limit	Analyzed	Method Blank	BS	% Recovery	True Value QC	RPD	Qualifier
GRO C6-C10*	<10.0	10.0	11/23/2019	ND	207	103	200	3.25	
DRO >C10-C28*	<10.0	10.0	11/23/2019	ND	210	105	200	0.814	
EXT DRO >C28-C36	<10.0	10.0	11/23/2019	ND					

Surrogate: 1-Chlorooctane 96.3 % 41-142

Surrogate: 1-Chlorooctadecane 101 % 37.6-147

Cardinal Laboratories

\*=Accredited Analyte

PLEASE NOTE: Liability and Damages. Cardinal's liability and client's exclusive remedy for any claim arising, whether based in contract or tort, shall be limited to the amount paid by client for analyses. All claims, including those for negligence and any other cause whatsoever shall be deemed waived unless made in writing and received by Cardinal within thirty (30) days after completion of the applicable service. In no event shall Cardinal be liable for incidental or consequential damages, including, without limitation, business interruptions, loss of use, or loss of profits incurred by client, its subsidiaries, affiliates or successors arising out of or related to the performance of the services hereunder by Cardinal, regardless of whether such claim is based upon any of the above stated reasons or otherwise. Results relate only to the samples identified above. This report shall not be reproduced except in full with written approval of Cardinal Laboratories.

Mike Snyder For Celey D. Keene, Lab Director/Quality Manager



PHONE (575) 393-2326 ° 101 E. MARLAND ° HOBBS, NM 88240

**Analytical Results For:**

BBC International, Inc.  
 Cliff Brunson  
 P.O. Box 805  
 Hobbs NM, 88241  
 Fax To: (575) 397-0397

Received:	11/21/2019	Sampling Date:	11/19/2019
Reported:	11/26/2019	Sampling Type:	Soil
Project Name:	LENGTH CC 6-7 FED COM #22H	Sampling Condition:	Cool & Intact
Project Number:	NONE GIVEN	Sample Received By:	Jodi Henson
Project Location:	OXY		

**Sample ID: SP 2 @ 5' (H903965-22)**

Chloride, SM4500Cl-B		mg/kg		Analyzed By: AC						
Analyte	Result	Reporting Limit	Analyzed	Method Blank	BS	% Recovery	True Value QC	RPD	Qualifier	
Chloride	32.0	16.0	11/26/2019	ND	416	104	400	7.41		

**Sample ID: SP 2 @ 6' (H903965-23)**

Chloride, SM4500Cl-B		mg/kg		Analyzed By: AC					
Analyte	Result	Reporting Limit	Analyzed	Method Blank	BS	% Recovery	True Value QC	RPD	Qualifier
Chloride	48.0	16.0	11/26/2019	ND	416	104	400	7.41	

Cardinal Laboratories

\*=Accredited Analyte

PLEASE NOTE: Liability and Damages. Cardinal's liability and client's exclusive remedy for any claim arising, whether based in contract or tort, shall be limited to the amount paid by client for analyses. All claims, including those for negligence and any other cause whatsoever shall be deemed waived unless made in writing and received by Cardinal within thirty (30) days after completion of the applicable service. In no event shall Cardinal be liable for incidental or consequential damages, including, without limitation, business interruptions, loss of use, or loss of profits incurred by client, its subsidiaries, affiliates or successors arising out of or related to the performance of the services hereunder by Cardinal, regardless of whether such claim is based upon any of the above stated reasons or otherwise. Results relate only to the samples identified above. This report shall not be reproduced except in full with written approval of Cardinal Laboratories.

Mike Snyder For Celey D. Keene, Lab Director/Quality Manager



PHONE (575) 393-2326 ° 101 E. MARLAND ° HOBBS, NM 88240

**Analytical Results For:**

BBC International, Inc.  
 Cliff Brunson  
 P.O. Box 805  
 Hobbs NM, 88241  
 Fax To: (575) 397-0397

Received:	11/21/2019	Sampling Date:	11/14/2019
Reported:	11/26/2019	Sampling Type:	Soil
Project Name:	LENGTH CC 6-7 FED COM #22H	Sampling Condition:	Cool & Intact
Project Number:	NONE GIVEN	Sample Received By:	Jodi Henson
Project Location:	OXY		

**Sample ID: SP 3 @ SURFACE (H903965-24)**

BTEX 8021B		mg/kg		Analyzed By: MS						
Analyte	Result	Reporting Limit	Analyzed	Method Blank	BS	% Recovery	True Value QC	RPD	Qualifier	
Benzene*	<0.050	0.050	11/23/2019	ND	1.69	84.6	2.00	7.13		
Toluene*	<0.050	0.050	11/23/2019	ND	1.67	83.6	2.00	6.81		
Ethylbenzene*	<0.050	0.050	11/23/2019	ND	1.62	81.2	2.00	7.53		
Total Xylenes*	<0.150	0.150	11/23/2019	ND	4.76	79.3	6.00	7.58		
Total BTEX	<0.300	0.300	11/23/2019	ND						

Surrogate: 4-Bromofluorobenzene (PID) 101 % 73.3-129

Chloride, SM4500Cl-B		mg/kg		Analyzed By: AC						
Analyte	Result	Reporting Limit	Analyzed	Method Blank	BS	% Recovery	True Value QC	RPD	Qualifier	
Chloride	10500	16.0	11/26/2019	ND	416	104	400	7.41		

TPH 8015M		mg/kg		Analyzed By: MS				S-04	
Analyte	Result	Reporting Limit	Analyzed	Method Blank	BS	% Recovery	True Value QC	RPD	Qualifier
GRO C6-C10*	<10.0	10.0	11/23/2019	ND	207	103	200	3.25	
DRO >C10-C28*	3360	10.0	11/23/2019	ND	210	105	200	0.814	
EXT DRO >C28-C36	136	10.0	11/23/2019	ND					

Surrogate: 1-Chlorooctane 92.6 % 41-142

Surrogate: 1-Chlorooctadecane 234 % 37.6-147

Cardinal Laboratories

\*=Accredited Analyte

PLEASE NOTE: Liability and Damages. Cardinal's liability and client's exclusive remedy for any claim arising, whether based in contract or tort, shall be limited to the amount paid by client for analyses. All claims, including those for negligence and any other cause whatsoever shall be deemed waived unless made in writing and received by Cardinal within thirty (30) days after completion of the applicable service. In no event shall Cardinal be liable for incidental or consequential damages, including, without limitation, business interruptions, loss of use, or loss of profits incurred by client, its subsidiaries, affiliates or successors arising out of or related to the performance of the services hereunder by Cardinal, regardless of whether such claim is based upon any of the above stated reasons or otherwise. Results relate only to the samples identified above. This report shall not be reproduced except in full with written approval of Cardinal Laboratories.

Mike Snyder For Celey D. Keene, Lab Director/Quality Manager





PHONE (575) 393-2326 ° 101 E. MARLAND ° HOBBS, NM 88240

**Analytical Results For:**

BBC International, Inc.  
 Cliff Brunson  
 P.O. Box 805  
 Hobbs NM, 88241  
 Fax To: (575) 397-0397

Received:	11/21/2019	Sampling Date:	11/14/2019
Reported:	11/26/2019	Sampling Type:	Soil
Project Name:	LENGTH CC 6-7 FED COM #22H	Sampling Condition:	Cool & Intact
Project Number:	NONE GIVEN	Sample Received By:	Jodi Henson
Project Location:	OXY		

**Sample ID: SP 3 @ 1' (H903965-25)**

BTX 8021B		mg/kg		Analyzed By: MS					
Analyte	Result	Reporting Limit	Analyzed	Method Blank	BS	% Recovery	True Value QC	RPD	Qualifier
Benzene*	<0.050	0.050	11/23/2019	ND	1.69	84.6	2.00	7.13	
Toluene*	<0.050	0.050	11/23/2019	ND	1.67	83.6	2.00	6.81	
Ethylbenzene*	<0.050	0.050	11/23/2019	ND	1.62	81.2	2.00	7.53	
Total Xylenes*	<0.150	0.150	11/23/2019	ND	4.76	79.3	6.00	7.58	
Total BTX	<0.300	0.300	11/23/2019	ND					

Surrogate: 4-Bromofluorobenzene (PID) 98.6 % 73.3-129

Chloride, SM4500CI-B		mg/kg		Analyzed By: AC						
Analyte	Result	Reporting Limit	Analyzed	Method Blank	BS	% Recovery	True Value QC	RPD	Qualifier	
Chloride	1390	16.0	11/26/2019	ND	416	104	400	7.41		

TPH 8015M		mg/kg		Analyzed By: MS					
Analyte	Result	Reporting Limit	Analyzed	Method Blank	BS	% Recovery	True Value QC	RPD	Qualifier
GRO C6-C10*	<10.0	10.0	11/23/2019	ND	207	103	200	3.25	
DRO >C10-C28*	331	10.0	11/23/2019	ND	210	105	200	0.814	
EXT DRO >C28-C36	<10.0	10.0	11/23/2019	ND					

Surrogate: 1-Chlorooctane 99.8 % 41-142

Surrogate: 1-Chlorooctadecane 121 % 37.6-147

Cardinal Laboratories

\*=Accredited Analyte

PLEASE NOTE: Liability and Damages. Cardinal's liability and client's exclusive remedy for any claim arising, whether based in contract or tort, shall be limited to the amount paid by client for analyses. All claims, including those for negligence and any other cause whatsoever shall be deemed waived unless made in writing and received by Cardinal within thirty (30) days after completion of the applicable service. In no event shall Cardinal be liable for incidental or consequential damages, including, without limitation, business interruptions, loss of use, or loss of profits incurred by client, its subsidiaries, affiliates or successors arising out of or related to the performance of the services hereunder by Cardinal, regardless of whether such claim is based upon any of the above stated reasons or otherwise. Results relate only to the samples identified above. This report shall not be reproduced except in full with written approval of Cardinal Laboratories.

Mike Snyder For Celey D. Keene, Lab Director/Quality Manager



PHONE (575) 393-2326 ° 101 E. MARLAND ° HOBBS, NM 88240

**Analytical Results For:**

BBC International, Inc.  
 Cliff Brunson  
 P.O. Box 805  
 Hobbs NM, 88241  
 Fax To: (575) 397-0397

Received:	11/21/2019	Sampling Date:	11/20/2019
Reported:	11/26/2019	Sampling Type:	Soil
Project Name:	LENGTH CC 6-7 FED COM #22H	Sampling Condition:	Cool & Intact
Project Number:	NONE GIVEN	Sample Received By:	Jodi Henson
Project Location:	OXY		

**Sample ID: SP 3 @ 2' (H903965-26)**

BTX 8021B		mg/kg		Analyzed By: MS						
Analyte	Result	Reporting Limit	Analyzed	Method Blank	BS	% Recovery	True Value QC	RPD	Qualifier	
Benzene*	<0.050	0.050	11/23/2019	ND	1.69	84.6	2.00	7.13		
Toluene*	<0.050	0.050	11/23/2019	ND	1.67	83.6	2.00	6.81		
Ethylbenzene*	<0.050	0.050	11/23/2019	ND	1.62	81.2	2.00	7.53		
Total Xylenes*	<0.150	0.150	11/23/2019	ND	4.76	79.3	6.00	7.58		
Total BTX	<0.300	0.300	11/23/2019	ND						

Surrogate: 4-Bromofluorobenzene (PID) 97.4 % 73.3-129

Chloride, SM4500CI-B		mg/kg		Analyzed By: AC					
Analyte	Result	Reporting Limit	Analyzed	Method Blank	BS	% Recovery	True Value QC	RPD	Qualifier
Chloride	304	16.0	11/26/2019	ND	416	104	400	7.41	

TPH 8015M		mg/kg		Analyzed By: MS					
Analyte	Result	Reporting Limit	Analyzed	Method Blank	BS	% Recovery	True Value QC	RPD	Qualifier
GRO C6-C10*	<10.0	10.0	11/23/2019	ND	207	103	200	3.25	
DRO >C10-C28*	<10.0	10.0	11/23/2019	ND	210	105	200	0.814	
EXT DRO >C28-C36	<10.0	10.0	11/23/2019	ND					

Surrogate: 1-Chlorooctane 99.3 % 41-142

Surrogate: 1-Chlorooctadecane 104 % 37.6-147

Cardinal Laboratories

\*=Accredited Analyte

PLEASE NOTE: Liability and Damages. Cardinal's liability and client's exclusive remedy for any claim arising, whether based in contract or tort, shall be limited to the amount paid by client for analyses. All claims, including those for negligence and any other cause whatsoever shall be deemed waived unless made in writing and received by Cardinal within thirty (30) days after completion of the applicable service. In no event shall Cardinal be liable for incidental or consequential damages, including, without limitation, business interruptions, loss of use, or loss of profits incurred by client, its subsidiaries, affiliates or successors arising out of or related to the performance of the services hereunder by Cardinal, regardless of whether such claim is based upon any of the above stated reasons or otherwise. Results relate only to the samples identified above. This report shall not be reproduced except in full with written approval of Cardinal Laboratories.

Mike Snyder For Celey D. Keene, Lab Director/Quality Manager



PHONE (575) 393-2326 ° 101 E. MARLAND ° HOBBS, NM 88240

**Analytical Results For:**

BBC International, Inc.  
 Cliff Brunson  
 P.O. Box 805  
 Hobbs NM, 88241  
 Fax To: (575) 397-0397

Received:	11/21/2019	Sampling Date:	11/20/2019
Reported:	11/26/2019	Sampling Type:	Soil
Project Name:	LENGTH CC 6-7 FED COM #22H	Sampling Condition:	Cool & Intact
Project Number:	NONE GIVEN	Sample Received By:	Jodi Henson
Project Location:	OXY		

**Sample ID: SP 3 @ 3' (H903965-27)**

BTX 8021B		mg/kg		Analyzed By: MS					
Analyte	Result	Reporting Limit	Analyzed	Method Blank	BS	% Recovery	True Value QC	RPD	Qualifier
Benzene*	<0.050	0.050	11/23/2019	ND	1.69	84.6	2.00	7.13	
Toluene*	<0.050	0.050	11/23/2019	ND	1.67	83.6	2.00	6.81	
Ethylbenzene*	<0.050	0.050	11/23/2019	ND	1.62	81.2	2.00	7.53	
Total Xylenes*	<0.150	0.150	11/23/2019	ND	4.76	79.3	6.00	7.58	
Total BTX	<0.300	0.300	11/23/2019	ND					

Surrogate: 4-Bromofluorobenzene (PID) 99.1 % 73.3-129

Chloride, SM4500CI-B		mg/kg		Analyzed By: AC					
Analyte	Result	Reporting Limit	Analyzed	Method Blank	BS	% Recovery	True Value QC	RPD	Qualifier
Chloride	816	16.0	11/26/2019	ND	416	104	400	3.77	

TPH 8015M		mg/kg		Analyzed By: MS					
Analyte	Result	Reporting Limit	Analyzed	Method Blank	BS	% Recovery	True Value QC	RPD	Qualifier
GRO C6-C10*	<10.0	10.0	11/23/2019	ND	207	103	200	3.25	
DRO >C10-C28*	<10.0	10.0	11/23/2019	ND	210	105	200	0.814	
EXT DRO >C28-C36	<10.0	10.0	11/23/2019	ND					

Surrogate: 1-Chlorooctane 102 % 41-142

Surrogate: 1-Chlorooctadecane 108 % 37.6-147

Cardinal Laboratories

\*=Accredited Analyte

PLEASE NOTE: Liability and Damages. Cardinal's liability and client's exclusive remedy for any claim arising, whether based in contract or tort, shall be limited to the amount paid by client for analyses. All claims, including those for negligence and any other cause whatsoever shall be deemed waived unless made in writing and received by Cardinal within thirty (30) days after completion of the applicable service. In no event shall Cardinal be liable for incidental or consequential damages, including, without limitation, business interruptions, loss of use, or loss of profits incurred by client, its subsidiaries, affiliates or successors arising out of or related to the performance of the services hereunder by Cardinal, regardless of whether such claim is based upon any of the above stated reasons or otherwise. Results relate only to the samples identified above. This report shall not be reproduced except in full with written approval of Cardinal Laboratories.

Mike Snyder For Celey D. Keene, Lab Director/Quality Manager



PHONE (575) 393-2326 ° 101 E. MARLAND ° HOBBS, NM 88240

**Analytical Results For:**

BBC International, Inc.  
 Cliff Brunson  
 P.O. Box 805  
 Hobbs NM, 88241  
 Fax To: (575) 397-0397

Received:	11/21/2019	Sampling Date:	11/20/2019
Reported:	11/26/2019	Sampling Type:	Soil
Project Name:	LENGTH CC 6-7 FED COM #22H	Sampling Condition:	Cool & Intact
Project Number:	NONE GIVEN	Sample Received By:	Jodi Henson
Project Location:	OXY		

**Sample ID: SP 3 @ 4' (H903965-28)**

Chloride, SM4500Cl-B		mg/kg		Analyzed By: AC						
Analyte	Result	Reporting Limit	Analyzed	Method Blank	BS	% Recovery	True Value QC	RPD	Qualifier	
Chloride	912	16.0	11/26/2019	ND	416	104	400	3.77		

**Sample ID: SP 3 @ 5' (H903965-29)**

Chloride, SM4500CI-B		mg/kg		Analyzed By: AC					
Analyte	Result	Reporting Limit	Analyzed	Method Blank	BS	% Recovery	True Value QC	RPD	Qualifier
Chloride	48.0	16.0	11/26/2019	ND	416	104	400	3.77	

**Sample ID: SP 3 @ 6' (H903965-30)**

Chloride, SM4500CI-B		mg/kg		Analyzed By: AC						
Analyte	Result	Reporting Limit	Analyzed	Method Blank	BS	% Recovery	True Value QC	RPD	Qualifier	
Chloride	48.0	16.0	11/26/2019	ND	416	104	400	3.77		

Cardinal Laboratories

\*=Accredited Analyte

PLEASE NOTE: Liability and Damages. Cardinal's liability and client's exclusive remedy for any claim arising, whether based in contract or tort, shall be limited to the amount paid by client for analyses. All claims, including those for negligence and any other cause whatsoever shall be deemed waived unless made in writing and received by Cardinal within thirty (30) days after completion of the applicable service. In no event shall Cardinal be liable for incidental or consequential damages, including, without limitation, business interruptions, loss of use, or loss of profits incurred by client, its subsidiaries, affiliates or successors arising out of or related to the performance of the services hereunder by Cardinal, regardless of whether such claim is based upon any of the above stated reasons or otherwise. Results relate only to the samples identified above. This report shall not be reproduced except in full with written approval of Cardinal Laboratories.

Mike Snyder For Celey D. Keene, Lab Director/Quality Manager





---

PHONE (575) 393-2326 • 101 E. MARLAND • HOBBS, NM 88240

---

### Notes and Definitions

S-06	The recovery of this surrogate is outside control limits due to sample dilution required from high analyte concentration and/or matrix interference's.
S-04	The surrogate recovery for this sample is outside of established control limits due to a sample matrix effect.
ND	Analyte NOT DETECTED at or above the reporting limit
RPD	Relative Percent Difference
**	Samples not received at proper temperature of 6°C or below.
***	Insufficient time to reach temperature.
-	Chloride by SM4500Cl-B does not require samples be received at or below 6°C Samples reported on an as received basis (wet) unless otherwise noted on report

---

Cardinal Laboratories

\*=Accredited Analyte

PLEASE NOTE: Liability and Damages. Cardinal's liability and client's exclusive remedy for any claim arising, whether based in contract or tort, shall be limited to the amount paid by client for analyses. All claims, including those for negligence and any other cause whatsoever shall be deemed waived unless made in writing and received by Cardinal within thirty (30) days after completion of the applicable service. In no event shall Cardinal be liable for incidental or consequential damages, including, without limitation, business interruptions, loss of use, or loss of profits incurred by client, its subsidiaries, affiliates or successors arising out of or related to the performance of the services hereunder by Cardinal, regardless of whether such claim is based upon any of the above stated reasons or otherwise. Results relate only to the samples identified above. This report shall not be reproduced except in full with written approval of Cardinal Laboratories.

A handwritten signature in black ink, appearing to read "Mike Snyder", is written over a horizontal line.

---

Mike Snyder For Celey D. Keene, Lab Director/Quality Manager

**ARDINAL LABORATORIES**

101 East Marland, Hobbs, NM 88240

(505) 393-2326 FAX (505) 393-2476

**CHAIN-OF-CUSTODY AND ANALYSIS REQUEST**

Company Name: BBC International, Inc.				<b>BILL TO</b>				<b>ANALYSIS REQUEST</b>																		
Project Manager: Cliff Brunson				P.O. #:				<div style="display: flex; flex-direction: column; align-items: center; justify-content: center;"> <div>CL</div> <div>BTEX</div> <div>TPH Extended</div> </div>																		
Address: P.O. Box 805				Company:																						
City: Hobbs		State: NM Zip: 88241		Attn:																						
Phone #: 575-397-6388		Fax #: 575-397-0397		Address:																						
Project #:		Project Owner: Oxy		City:																						
Project Name:				State: Zip:																						
Project Location: Length CE 6-7 Feet Con #22 H				Phone #:																						
Sampler Name:				Fax #:																						
FOR LAB USE ONLY																										
Lab I.D.	Sample I.D.	(GRAB OR (COMP. # CONTAINERS	GROUNDWATER	WASTEWATER	SOIL	OIL	SLUDGE	OTHER :	ACID/BASE:	ICE / COOL	OTHER :	DATE	TIME													
H903965	N @ Surface				✓					✓		11-19	8:59	✓	✓	✓										
	E @ Surface											11-19	9:11	✓	✓	✓										
	W @ Surface											11-19	9:20	✓	✓	✓										
	S @ Surface											11-19	9:30	✓	✓	✓										
	SP 1 @ Surface											11-19	11:00	✓	✓	✓										
	SP 1 @ 1'											11-19	12:30	✓	✓	✓										
	SP 1 @ 2'											11-19	9:45	✓	✓	✓										
	SP 1 @ 3'											11-19	9:55	✓												
	SP 1 @ 4'											11-19	10:15	✓												
	SP 1 @ 5'											11-19	10:33	✓												

PLEASE NOTE: Liability and Damages. Cardinal's liability and client's exclusive remedy for any claim arising whether based in contract or tort, shall be limited to the amount paid by the client for the analyses. All claims including those for negligence and any other cause whatsoever shall be deemed waived unless made in writing and received by Cardinal within 30 days after completion of the applicable service. In no event shall Cardinal be liable for incidental or consequential damages, including without limitation, business interruptions, loss of use, or loss of profits incurred by client, its subsidiaries, affiliates or successors arising out of or related to the performance of services hereunder by Cardinal, regardless of whether such claim is based upon any of the above stated reasons or otherwise.

Relinquished By:	Date: 11/21/19	Received By:	Phone Result: <input type="checkbox"/> Yes <input type="checkbox"/> No	Add'l Phone #:
	Time: 16:45	Jodi Henson	Fax Result: <input type="checkbox"/> Yes <input type="checkbox"/> No	Add'l Fax #:
Relinquished By:	Date:	Received By:	REMARKS:	
	Time:			
Delivered By: (Circle One)	+4 correction	Sample Condition	CHECKED BY: (Initials)	
Sampler - UPS - Bus - Other:	-2.6%/-2.2% #7	Cool Intact <input type="checkbox"/> Yes <input type="checkbox"/> No	JH	

† Cardinal cannot accept verbal changes. Please fax written changes to 505-393-2476

**CARDINAL LABORATORIES**

101 East Marland, Hobbs, NM 88240

(505) 393-2326 FAX (505) 393-2476

**CHAIN-OF-CUSTODY AND ANALYSIS REQUEST**

Company Name: BBC International, Inc.				<b>BILL TO</b>				<b>ANALYSIS REQUEST</b>																									
Project Manager: Cliff Brunson				P.O. #:				<div style="display: flex; flex-direction: column; align-items: center; justify-content: center;"> <div style="writing-mode: vertical-rl; transform: rotate(180deg);">CL</div> <div style="writing-mode: vertical-rl; transform: rotate(180deg);">BTEx</div> <div style="writing-mode: vertical-rl; transform: rotate(180deg);">T9H Extended</div> </div>																									
Address: P.O. Box 805				Company: <i>Qry</i>																													
City: Hobbs State: NM Zip: 88241				Attn: <i>W. Dittich</i>																													
Phone #: 575-397-6388 Fax #: 575-397-0397				Address:																													
Project #: Project Owner: <i>Qry</i>				City:																													
Project Name:				State: Zip:																													
Project Location: <i>Length CC 6-7 Foot Cam #2 H</i>				Phone #:																													
Sampler Name: <i>Simon Borden Jr</i>				Fax #:																													
FOR LAB USE ONLY				MATRIX		PRESERV.		SAMPLING																									
Lab I.D.	Sample I.D.	(GRAB OR COMP.)	# CONTAINERS	GROUNDWATER	WASTEWATER	SOIL	OIL	SLUDGE	OTHER :	ACID/BASE:	ICE / COOL	OTHER :	DATE	TIME																			
<i>H903965</i>																																	
<i>11</i>	<i>SP 1 @ 6'</i>												<i>11-19</i>	<i>10:50</i>	<input checked="" type="checkbox"/>																		
<i>12</i>	<i>SP 1 @ 7'</i>												<i>11-19</i>	<i>10:59</i>	<input checked="" type="checkbox"/>																		
<i>13</i>	<i>SP 1 @ 8'</i>												<i>11-19</i>	<i>11:15</i>	<input checked="" type="checkbox"/>																		
<i>14</i>	<i>SP 1 @ 9'</i>												<i>11-19</i>	<i>12:15</i>	<input checked="" type="checkbox"/>																		
<i>15</i>	<i>SP 1 @ 10'</i>												<i>11-19</i>	<i>1:20</i>	<input checked="" type="checkbox"/>																		
<i>16</i>	<i>SP 1 @ 11'</i>												<i>11-19</i>	<i>1:50</i>	<input checked="" type="checkbox"/>																		
<i>17</i>	<i>SP 2 @ Surface</i>												<i>11-19</i>	<i>1:00</i>	<input checked="" type="checkbox"/>	<input checked="" type="checkbox"/>	<input checked="" type="checkbox"/>																
<i>18</i>	<i>SP 2 @ 1'</i>												<i>11-14</i>	<i>1:25</i>	<input checked="" type="checkbox"/>	<input checked="" type="checkbox"/>	<input checked="" type="checkbox"/>																
<i>19</i>	<i>SP 2 @ 2'</i>												<i>11-14</i>	<i>1:55</i>	<input checked="" type="checkbox"/>	<input checked="" type="checkbox"/>	<input checked="" type="checkbox"/>																
<i>20</i>	<i>SP 2 @ 3'</i>												<i>11-14</i>	<i>2:20</i>	<input checked="" type="checkbox"/>	<input checked="" type="checkbox"/>	<input checked="" type="checkbox"/>																

PLEASE NOTE: Liability and Damages. Cardinal's liability and client's exclusive remedy for any claim arising whether based in contract or tort, shall be limited to the amount paid by the client for the analyses. All claims including those for negligence and any other cause whatsoever shall be deemed waived unless made in writing and received by Cardinal within 30 days after completion of the applicable service. In no event shall Cardinal be liable for incidental or consequential damages, including without limitation, business interruptions, loss of use, or loss of profits incurred by client, its subsidiaries, affiliates or successors arising out of or related to the performance of services hereunder by Cardinal, regardless of whether such claim is based upon any of the above stated reasons or otherwise.

Relinquished By:	Date: <i>11/21/19</i>	Received By:	Phone Result: <input type="checkbox"/> Yes <input type="checkbox"/> No	Add'l Phone #:
<i>[Signature]</i>	Time: <i>16:45</i>	<i>Joan Hanson</i>	Fax Result: <input type="checkbox"/> Yes <input type="checkbox"/> No	Add'l Fax #:
Relinquished By:	Date:	Received By:	REMARKS:	
	Time:			
Delivered By: (Circle One)	Sample Condition	CHECKED BY:		
Sampler - UPS - Bus - Other: <i>-2.60/-2.22 #91</i>	Cool Intact <input checked="" type="checkbox"/> Yes <input type="checkbox"/> No <input type="checkbox"/> Yes <input type="checkbox"/> No	<i>[Signature]</i>		

† Cardinal cannot accept verbal changes. Please fax written changes to 505-393-2476





(505) 393-2326 FAX (505) 393-2476

## Received by OCD: 2/11/2020 5:48:26 PM

**PLEASE NOTE:** Liability and Damages. Cardinal's liability and client's exclusive remedy for any claim arising whether based in contract or tort, shall be limited to the amount paid by the client for the analyses. All claims including those for negligence and any other cause whatsoever shall be deemed waived unless made in writing and received by Cardinal within 30 days after completion of the applicable service. In no event shall Cardinal be liable for incidental or consequential damages, including without limitation, business interruptions, loss of use, or loss of profits incurred by client, its subsidiaries, affiliates or successors arising out of or related to the performance of services hereunder by Cardinal, regardless of whether such claim is based upon any of the above stated reasons or otherwise.

† Cardinal cannot accept verbal changes. Please fax written changes to 505-393-2476