

N.M. Oil Cons. DIV-Dist. 2

1301 W. Grand Avenue

Artesia, NM 88210

Form 3160-5
(August 1999)UNITED STATES
DEPARTMENT OF THE INTERIOR
BUREAU OF LAND MANAGEMENTFORM APPROVED
OMB No. 1004-0135
Expires November 30, 2000

SUNDRY NOTICES AND REPORTS ON WELLS

Do not use this form for proposals to drill or to re-enter an
abandoned well. Use Form 3160-3 (APD) for such proposals.

SUBMIT IN TRIPLICATE - Other instructions on reverse side

1. Type of Well

☐ Oil Well ☒ Gas Well ☐ Other

2. Name of Operator

LATIGO PETROLEUM INC

3a. Address

415 W. WALL, SUITE 1900, MIDLAND, TX 79701

3b. Phone No. (include area code)

(432)684-4293

4. Location of Well(Footage, Sec., T., R., M., or Survey Description)

660' FSL & 2180' FWL
Sec 35 (N), T23S, R29E

RECEIVED

JUN 25 2004

OCD-ARTESIA

5. Lease Serial No.

NM103604

6. If Indian, Allottee or Tribe Name

7. If Unit or CA/Agreement, Name and/or No.

8. Well Name and No.

Goodnight 35 Federal #1

9. API Well No.

30-015-31096

10. Field and Pool, or Exploratory Area

Wildcat-Wolfcamp Gas

11. County or Parish, State

EDDY

NM

12. CHECK APPROPRIATE BOX(ES) TO INDICATE NATURE OF NOTICE, REPORT, OR OTHER DATA

TYPE OF SUBMISSION	TYPE OF ACTION			
<input checked="" type="checkbox"/> Notice of Intent	<input type="checkbox"/> Acidize	<input checked="" type="checkbox"/> Deepen	<input type="checkbox"/> Production (Start/ Resume)	<input type="checkbox"/> Water Shut-Off
<input type="checkbox"/> Subsequent Report	<input type="checkbox"/> Alter Casing	<input type="checkbox"/> Fracture Treat	<input type="checkbox"/> Reclamation	<input type="checkbox"/> Well Integrity
<input type="checkbox"/> Final Abandonment Notice	<input type="checkbox"/> Casing Repair	<input type="checkbox"/> New Construction	<input checked="" type="checkbox"/> Recomplete	<input type="checkbox"/> Other _____
	<input type="checkbox"/> Change Plans	<input type="checkbox"/> Plug and Abandon	<input type="checkbox"/> Temporarily Abandon	
	<input type="checkbox"/> Convert to Injection	<input type="checkbox"/> Plug Back	<input type="checkbox"/> Water Disposal	

13. Describe Proposed or Completed Operation (clearly state all pertinent details, including estimated starting date of any proposed work and approximate duration thereof. If the proposal is to deepen directionally or recompleate horizontally, give subsurface locations measured and true vertical depths of all pertinent markers and zones. Attach the Bond under which the work will be performed or provide the Bond No. on file with BLM/BIA. Required subsequent reports shall be filed within 30 days following completion of the involved operations. If the operation results in a multiple completion or recompleation in a new interval, a Form 3160-4 shall be filed once testing has been completed. Final Abandonment Notices shall be filed only after all requirements, including reclamation, have been completed, and the operator has determined that the site is ready for final inspection.)

WELL IS CURRENTLY SHUT IN

Intent to re-enter well, kick off @ 5000', directional drill & complete as Morrow. Wellbore on back of form

RU Basic Well Service. Cut and pull 7" casing @ 5300'.

Spot 200 sx cmt plug @ 5350'. RU Grey Wolf #514, RIH w/ 8-1/2" bit.

Kick off @ 5000'. Drill a curve as described on attached directional plan. Drill to 7" TD @ 11000' TVD.

RIH w/6-1/4" bit, drill to TD of 14000' TVD, run 4 1/2" liner.

continued, pg 2

APPROVAL SUBJECT TO
GENERAL REQUIREMENTS AND
SPECIAL STIPULATIONS ATTACHED

14. I hereby certify that the foregoing is true and correct

Name (Printed/Typed)

Bonnie Husband

Title

Production Analyst

Signature

Bonnie Husband

Date

06/11/2004

THIS SPACE FOR FEDERAL OR STATE OFFICE USE

Approved by

(ORIG. SGD.) ALEXIS C. SWCBODA

PETROLEUM ENGINEER

Date JUN 24 2004

Conditions of approval, if any, are attached. Approval of this notice does not warrant or
certify that the applicant holds legal or equitable title to those rights in the subject lease
which would entitle the applicant to conduct operations thereon.

Office

Title 18 U.S.C. Section 1001, makes it a crime for any person knowingly and willfully to make to any department or agency of the United States any false, fictitious or
fraudulent statements or representations as to any matter within its jurisdiction.

(Instructions on reverse)

Well Schematic and History

Lease: Goodnight 35 Federal Well: 1 Field: _____
 Location: 660' From South Line and 2180' From West Line
Unit N, Section 35 - T23S - R29E County: Eddy State: New Mexico
 API No.: 30-015-31096 Spud Date: 4/28/00
 Compl. Date: 9/6/01

GL: 3100'
 DF: _____
 KB: _____

SURF CSG

13 3/8" 54.5# @ 581'
 Cmt'd w/ 470 sx (17 1/4" hole)
 TOC @ surface by circ.

9 5/8" TOC @ 3990' by TS

7" TOC @ 5350' by CBL

INTER CSG

9 5/8" 36# @ 3150'
 Cmt'd w/ 1000 sx (12 1/4" hole)
 TOC @ 3990' by TS.

Delaware perms 5874-90"

Delaware perms 6400-20'

Delaware perms 6580-6600'

Delaware perms 6740-78'
 7" DV tool @ 7197'

Bone Spring perms 7966-72'

Bone Spring perms 8050-8058'

Bone Spring perms 8172-8242'

PROD CSG

7" 26# P110 LT&C @ 10934'
 Cmt'd w/ 1015 sx (8 3/4" hole)
 TOC @ 5350' by CBL

Squeeze liner top w/ 50 sx

Wolfcamp perms 11414-464'

Liner - Top @ 10512'

4 1/2" 13.5 P110 LT&C @ 11571'
 Cmt'd w/ 100 sx (6 1/8" hole)
 ECP @ 11335'

PBTD 11516'

DATE	INITIAL COMPLETION DATA:
8/10/00	PERF Wolfcamp 11439-464' w/ 2 ispf (50 holes) Natural completion? CAOF 9368 MCFGPD
11/16/00	PERF Bone Spring 8220-42', 8158-72' w/ 2 ispf Acidize w/ 1500 gal. 15% Frac w/ 57513 gal. gel & 81784# 20/40 sand AIR 25 BPM @ 973#
11/16/00	PERF Bone Spring 7966-72', 8050-58' w/ 4 ispf Acidize w/ 1500 gal. 15% Frac w/ 53008 gal. gel & 57028# 20/40 sand AIR 25 BPM @
8/8/01	PERF Delaware 6740-48', 6770-78' w/ 4 ispf Acidize w/ 1800 gal. 15%
8/14/01	PERF Delaware 6580-6600' w/ 4 ispf Acidize w/ 1800 gal. 15% Frac w/ 430 bbl YF 130 gel & 28533# 16/30 sand AIR 10.9 @ 2479#, ISIP 870#
12/11/01	PERF Delaware 6400-20' w/ 4 ispf Acidize w/ 1500 gal. 15% Frac w/ 22000 gal YF 130 gel & 26700# 16/30 sand AIR 11.7 @ 1918#, ISIP 732#
1/12/02	PERF Delaware 5874-90' w/ 4 ispf Acidize w/ 1000 gal. 15% Frac w/ 14000 gal YF 130 gel & 25642# 16/30 sand AIR 1902 @ 1672#, ISIP 732#

186 jts 2 7/8" tubing

CIBP @ 6350' w/ 10' cement

CIBP @ 6530' w/ 10' cement

CIBP @ 6730' w/ 10' cement

CIBP @ 7900' w/ 20' cement

CIBP @ 8045' w/ 1 sx cement

Cement retainer @ 10316' w/ 400' of cement

Attached to Sundry Notice dated 6-11-2004 "Intent to Recomplete"

Goodnight 35 Fed #1

API No: 30-015-31096

Set CIBP @ 5835 w/35' cmt on top

Spot 200 sx cmt plug from 5350'-4819'

Cmt 4-1/2" liner w/250 sx Class H

Grey Wolf BOP Information

Annular Preventer: Hydril GK 13-5/8" x 5,000 psi WP

Ram Preventers:

Cameron Type U double ram, 13-5/8" x 10,000 psi WP

Cameron Type U single ram, 13-5/8" x 10,000 psi WP

Company: Latigo Petroleum

Lease/Well: Goodnight Federal 35 #1

Location: Eddy County

Rig Name:

State/Country: New Mexico

Declination:

Grid: Referenced to True North

Date/Time: 05/20/04

Latigo Petroleum

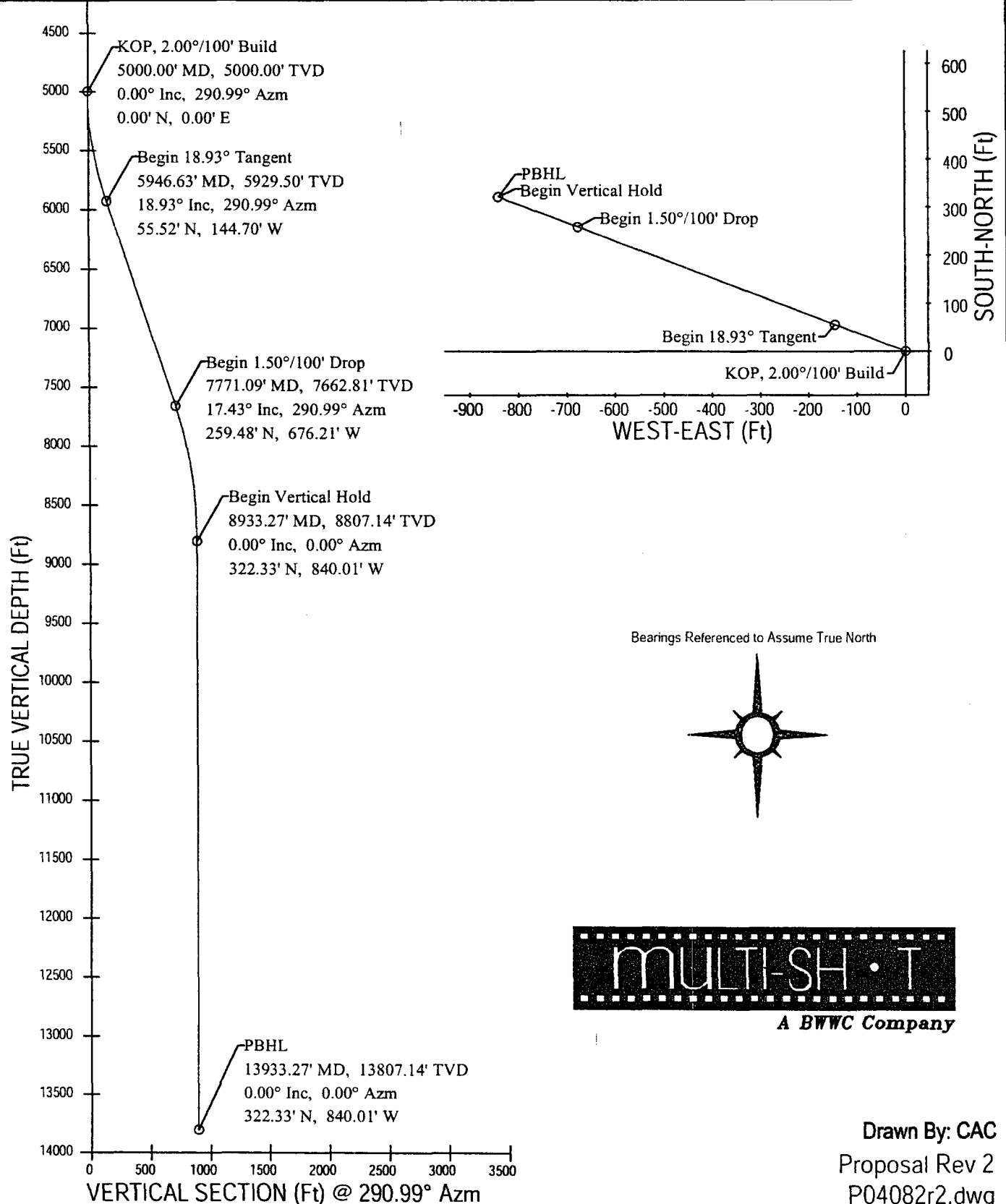



Job Number: P04-082
 Company: Latigo Petroleum
 Lease/Well: Goodnight Federal 35 #1
 Location: Eddy County
 Rig Name:
 RKB:
 G.L. or M.S.L.:

State/Country: New Mexico
 Declination:
 Grid:
 File name: F:\WELLPL-1\2004\PO4080\S\PO4082\04082.SVY
 Date/Time: 20-May-04 / 08:13
 Curve Name: Prop Rev 2

WINSERVE SURVEY CALCULATIONS
Minimum Curvature Method
Vertical Section Plane 290.99
Vertical Section Referenced to Wellhead
Rectangular Coordinates Referenced to Wellhead

Measured Depth FT	Incl Angle Deg	Drift Direction Deg	True Vertical Depth	N-S FT	E-W FT	Vertical Section FT	CLOSURE Distance FT	Direction Deg	Dogleg Severity Deg/100
KOP, 2.00°/100' Build									
5000.00	.00	290.99	5000.00	.00	.00	.00	.00	.00	.00
5100.00	2.00	290.99	5099.98	.63	-1.63	1.75	1.75	290.99	2.00
5200.00	4.00	290.99	5199.84	2.50	-6.52	6.98	6.98	290.99	2.00
5300.00	6.00	290.99	5299.45	5.62	-14.65	15.69	15.69	290.99	2.00
5400.00	8.00	290.99	5398.70	9.99	-26.03	27.88	27.88	290.99	2.00
5500.00	10.00	290.99	5497.47	15.59	-40.63	43.52	43.52	290.99	2.00
5600.00	12.00	290.99	5595.62	22.43	-58.45	62.60	62.60	290.99	2.00
5700.00	14.00	290.99	5693.06	30.49	-79.45	85.10	85.10	290.99	2.00
5800.00	16.00	290.99	5789.64	39.76	-103.61	110.98	110.98	290.99	2.00
5900.00	18.00	290.99	5885.27	50.23	-130.91	140.21	140.21	290.99	2.00
Begin 18.93° Tangent									
5946.63	18.93	290.99	5929.50	55.52	-144.70	154.98	154.98	290.99	2.00
Begin 1.50°/100' Drop									
7771.09	17.43	290.99	7662.81	259.48	-676.21	724.29	724.29	290.99	.08
7871.09	15.93	290.99	7758.60	269.76	-703.01	752.99	752.99	290.99	1.50
7971.09	14.43	290.99	7855.10	279.14	-727.46	779.18	779.18	290.99	1.50
8071.09	12.93	290.99	7952.26	287.62	-749.55	802.83	802.83	290.99	1.50
8171.09	11.43	290.99	8050.01	295.18	-769.25	823.94	823.94	290.99	1.50
8271.09	9.93	290.99	8148.27	301.82	-786.55	842.47	842.47	290.99	1.50
8371.09	8.43	290.99	8246.99	307.53	-801.45	858.43	858.43	290.99	1.50

Measured Depth FT	Incl Angle Deg	Drift Direction Deg	True Vertical Depth	N-S FT	E-W FT	Vertical Section FT	CLOSURE		Dogleg Severity Deg/100
							Distance FT	Direction Deg	
8471.09	6.93	290.99	8346.09	312.32	-813.93	871.80	871.80	290.99	1.50
8571.09	5.43	290.99	8445.50	316.18	-823.99	882.57	882.57	290.99	1.50
8671.09	3.93	290.99	8545.17	319.11	-831.61	890.73	890.73	290.99	1.50
8771.09	2.43	290.99	8645.01	321.09	-836.79	896.28	896.28	290.99	1.50
8871.09	.93	290.99	8744.96	322.15	-839.53	899.22	899.22	290.99	1.50

Begin Vertical Hold

8933.27	.00	.00	8807.14	322.33	-840.01	899.73	899.73	290.99	1.50
---------	-----	-----	---------	--------	---------	--------	--------	--------	------

PBHL

13933.27	.00	.00	13807.14	322.33	-840.01	899.73	899.73	290.99	.00
----------	-----	-----	----------	--------	---------	--------	--------	--------	-----

CONDITIONS OF APPROVAL - DRILLING

Operator's Name: Latigo Petroleum Inc.
Well Name & No. Goodnight 35 Federal #1 – PLUG BACK AND DEEPEN
Location: 660' FSL, 2180' FwL, Section 35, T. 23 S., R. 29 E., Eddy County, New Mexico
Lease: NM-103604

I. DRILLING OPERATIONS REQUIREMENTS:

1. The Bureau of Land Management (BLM) is to be notified at the Carlsbad Field Office, 620 East Greene St., Carlsbad, NM 88220, (505) 361-2822 for wells in Eddy County in sufficient time for a representative to witness:

A. Well spud

B. Cementing casing: 13-3/8 inch 9-5/8 inch 7 inch – ALL CASINGS IN PLACE

C. BOP tests

2. Unless the production casing has been run and cemented or the well has been properly plugged, the drilling rig shall not be removed from over the hole without prior approval.

3. Submit a Sundry Notice (Form 3160-5, one original and five copies) for each casing string, describing the casing and cementing operations. Include pertinent information such as; spud date, hole size, casing (size, weight, grade and thread type), cement (type, quantity and top), water zones and problems or hazards encountered. The Sundry shall be submitted within 15 days of completion of each casing string. The reports may be combined into the same Sundry if they fall within the same 15-day time frame.

4. The API No. assigned to the well by NMOCD shall be included on the subsequent report of setting the first casing string.

II. CASING:

1. The 13-3/8 inch surface casing is set at 581 feet and cement circulated to the surface.

2. The 9-5/8 inch intermediate casing is set at 3150 feet and cement circulated to the surface.

3. The 7 inch production casing is set at 10,609 feet and cement circulated to the surface.

4. Well bore has been plugged back to 6340'. (Highest plug is a CIBP at 6350' w/10' cement on top.) An additional CIBP will be set at 5835' w/35' of cement on top above the Delaware perms at 5874-90' and a 200 sx cement plug will be set from 5350-4819' prior to drilling out and kicking off.

5. The minimum required fill of cement behind the 4-1/2 inch production liner is to be circulated to the top of the liner.

III. PRESSURE CONTROL:

1. All BOP systems and related equipment shall comply with well control requirements as described in Onshore Oil and Gas Order No. 2. The BOP and related equipment shall be installed and operational before drilling below the 13-3/8 inch casing shoe and shall be tested as described in Onshore Order No. 2. Any equipment failing to test satisfactorily shall be repaired or replaced.

2. Minimum working pressure of the blowout preventer and related equipment (BOPE) shall be 5000 psi.

3. The appropriate BLM office shall be notified in sufficient time for a representative to witness the tests.

- The tests shall be done by an independent service company.
- The results of the test shall be reported to the appropriate BLM office.
- Testing fluid must be water or an appropriate clear liquid suitable for sub-freezing temperatures. Use of drilling mud for testing is not permitted since it can mask small leaks.
- Testing must be done in a safe workman-like manner. Hard line connections shall be required.