

District I
1625 N. French Dr., Hobbs, NM 88240
District II
811 South First, Artesia, NM 88210
District III
1000 Rio Brazos Road, Aztec, NM 87410
District IV
2040 South Pacheco, Santa Fe, NM 87505

State of New Mexico
Energy Minerals and Natural Resources

Oil Conservation Division
2040 South Pacheco
Santa Fe, NM 87505

RECEIVED

SEP 16 2004

OOB-ARTESIA

Form C-101
Revised March 17, 1999

Submit to appropriate District Office
State Lease - 6 Copies
Fee Lease - 5 Copies

☐ AMENDED REPORT

APPLICATION FOR PERMIT TO DRILL, RE-ENTER, DEEPEN, PLUGBACK, OR ADD A ZONE

¹ Operator Name and Address Mewbourne Oil Company P. O. Box 7698 Tyler, TX 75711		² OGRID Number 14744
³ Property Code 32522		⁴ API Number 30-015-32845
⁵ Property Name Winchester "36" State		⁶ Well No. 1

⁷ Surface Location

UL or lot no.	Section	Township	Range	Lot Idn	Feet from the	North/South line	Feet from the	East/West line	County
K	36	19S	28E		1880	South	1980	West	Eddy

⁸ Proposed Bottom Hole Location If Different From Surface

UL or lot no.	Section	Township	Range	Lot Idn	Feet from the	North/South line	Feet from the	East/West line	County
⁹ Proposed Pool 1 B Winchester, Atoka (Gas)						¹⁰ Proposed Pool 2			

¹¹ Work Type Code P	¹² Well Type Code G	¹³ Cable/Rotary R	¹⁴ Lease Type Code S	¹⁵ Ground Level Elevation 3293'
¹⁶ Multiple No	¹⁷ Proposed Depth 11,600'	¹⁸ Formation Atoka	¹⁹ Contractor	²⁰ Spud Date

²¹ Proposed Casing and Cement Program

Hole Size	Casing Size	Casing weight/foot	Setting Depth	Sacks of Cement	Estimated TOC
17 1/2"	13 3/8"	48#	350'	400	Circ to Surface
12 1/4"	8 5/8"	32#	2,500'	1200	Circ to Surface
7 7/8"	5 1/2"	17#	11,600'	1000	500' above Wolfcamp

²² Describe the proposed program. If this application is to DEEPEN or PLUG BACK, give the data on the present productive zone and proposed new productive zone.

Describe the blowout prevention program, if any. Use additional sheets if necessary.

Initial completion was in Morrow perms 10,751-11,366'.

Plan to set plug and test Atoka perms 10,540-10,564'.

Intend to request permission to commingle production downhole.

²³ I hereby certify that the information given above is true and complete to the best of my knowledge and belief. Signature: 		OIL CONSERVATION DIVISION	
Printed name: Janet Burns		Approved by: TIM W. GUM	
Title: Reg. Tech.		Title: DISTRICT II SUPERVISOR	
Date: 9/10/04		Approval Date: SEP 23 2004 Expiration Date: SEP 23 2006	
Phone: (903) 561-2900		Conditions of Approval: Attached <input type="checkbox"/>	

DISTRICT II
811 South First, Artesia, NM 88210
DISTRICT III
1000 Rio Brazos Rd., Aztec, NM 87410
DISTRICT IV
2040 South Pacheco, Santa Fe, NM 87505

NEW MEXICO OIL FIELD SURVEYING DEPARTMENT

Instruction on back
Submit to Appropriate District Office
State Lease - 4 Copies
Fee Lease - 3 Copies

OIL CONSERVATION DIVISION
P.O. Box 2088
Santa Fe, New Mexico 87504-2088

☐ AMENDED REPORT

WELL LOCATION AND ACREAGE DEDICATION PLAT

API Number 30-015-32845	Pool Code 73200	Pool Name Burton Flat; Atoka, East
Property Code 32522	Property Name WINCHESTER "36" STATE	Well Number 1
OGRD No. 14744	Operator Name MEWBOURNE OIL COMPANY	Elevation 3293

Surface Location

UL or lot No. K	Section 36	Township 19S	Range 28E	Lot Idn	Feet from the 1880	North/South line SOUTH	Feet from the 1980	East/West line WEST	County EDDY
--------------------	---------------	-----------------	--------------	---------	-----------------------	---------------------------	-----------------------	------------------------	----------------

Bottom Hole Location If Different From Surface

UL or lot No.	Section	Township	Range	Lot Idn	Feet from the	North/South line	Feet from the	East/West line	County
Dedicated Acres 320	Joint or Infill	Consolidation Code	Order No.						

NO ALLOWABLE WILL BE ASSIGNED TO THIS COMPLETION UNTIL ALL INTERESTS HAVE BEEN CONSOLIDATED
OR A NON-STANDARD UNIT HAS BEEN APPROVED BY THE DIVISION

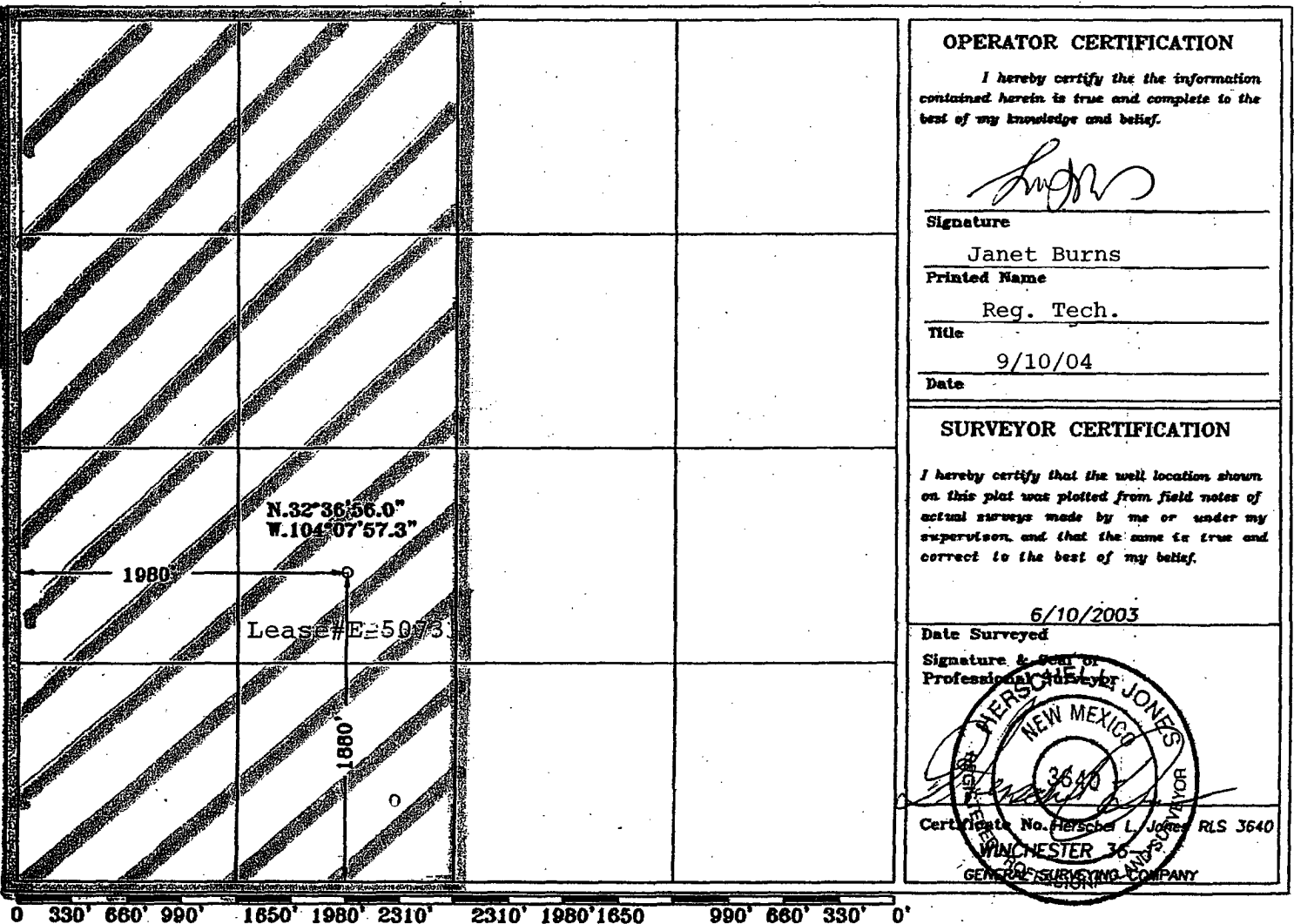

OPERATOR CERTIFICATION

I hereby certify the the information
contained herein is true and complete to the
best of my knowledge and belief.

Signature

Janet Burns

Printed Name

Reg. Tech.

Title

9/10/04

Date

SURVEYOR CERTIFICATION

I hereby certify that the well location shown
on this plat was plotted from field notes of
actual surveys made by me or under my
supervision, and that the same is true and
correct to the best of my belief.

6/10/2003

Date Surveyed

Signature & Seal of
Professional Surveyor

Certificate No. Herschel L. Jones RLS 3640
WINCHESTER 36
GENERAL SURVEYING COMPANY

MEWBOURNE OIL COMPANY

P.O. BOX 7698
TYLER, TEXAS 75711
903 - 561-2900
FAX 903 - 561-1870

September 21, 2004

UPS NEXT DAY AIR #N454 762 415 7

Mr. Brian Arrant
New Mexico Oil Conservation Division, District II
1301 W. Grand Ave.
Artesia, NM 88210

RECEIVED
SEP 22 2004
OOD-ARTESIA

RE: Winchester "36" State #1
Sec 36 T19S R28E
Undesignated Winchester; Atoka (Gas)
Eddy Co., NM

Dear Mr. Arrant:

In reference to our telephone conversation of September 16, 2004, and to Form C-101 filed 9/10/04 for the recompletion of the referenced well, the following statements apply:

H2S Contingency Plan: Mewbourne Oil Company has done a study of this area, and there are no H2S concerns in the Atoka or the Morrow.

Pressure Control Devices: The tubing is landed, and the wellhead is in place. We will perforate through the tubing and will have a lubricator and grease-head on the wellhead.

Pits: No earthen pit is to be utilized during the workover procedure.

Thank you very much for all your help. If you need further information, please call me at (903) 561-2900.

Yours truly,



Janet Burns
Reg. Tech.

Enclosures
cc: Hobbs
Midland