

1625 N. French Dr., Hobbs, NM 88240  
 District II  
 1301 W. Grand Avenue, Artesia, NM 88210  
 District III  
 1000 Rio Brazos Road, Aztec, NM 87410  
 District IV  
 1220 S. St. Francis Dr., Santa Fe, NM 87505

State of New Mexico  
 Energy Minerals and Natural Resources

Form C-1  
 March 12, 2005

Oil Conservation Division  
 1220 South St. Francis Dr.  
 Santa Fe, NM 87505

For drilling and production facilities, submit appropriate NMOCD District Office.  
 For downstream facilities, submit to Santa Fe office

**Pit or Below-Grade Tank Registration or Closure**

Is pit or below-grade tank covered by a "general plan"? Yes  No

Type of action: Registration of a pit or below-grade tank  Closure of a pit or below-grade tank

Operator: Pogo Producing Company Telephone: 432-685-8100 e-mail address: wrightc@pogoproducing.com  
 Address: P.O. Box 10340, Midland, TX 79702-7340  
 Facility or well name: McMillan 24 State #2 API #: 30-015-32336 U/L or Qtr/Qtr I Sec 24 T 20 R 26  
 County: Eddy Latitude 32:33:434N Longitude 104:19:615W NAD: 1927  1983  Surface Owner Federal  State  Private  Indian

<b>Pit</b> Type: Drilling <input type="checkbox"/> Production <input type="checkbox"/> Disposal <input type="checkbox"/> Workover <input type="checkbox"/> Emergency <input type="checkbox"/> Lined <input type="checkbox"/> Unlined <input type="checkbox"/> Liner type: Synthetic <input type="checkbox"/> Thickness _____ mil Clay <input type="checkbox"/> Volume _____ bbl	<b>Below-grade tank</b> Volume: _____ bbl Type of fluid: _____ Construction material: _____ Double-walled, with leak detection? Yes <input type="checkbox"/> If not, explain why not. _____	
Depth to ground water (vertical distance from bottom of pit to seasonal high water elevation of ground water.)	Less than 50 feet 50 feet or more, but less than 100 feet 100 feet or more	(20 points) (10 points) ( 0 points) <b>RECEIVED</b> <b>FEB 02 2005</b> OGD-ARTESIA
Wellhead protection area: (Less than 200 feet from a private domestic water source, or less than 1000 feet from all other water sources.)	Yes No	(20 points) ( 0 points)
Distance to surface water: (horizontal distance to all wetlands, playas, irrigation canals, ditches, and perennial and ephemeral watercourses.)	Less than 200 feet 200 feet or more, but less than 1000 feet 1000 feet or more	(20 points) (10 points) ( 0 points)
<b>Ranking Score (Total Points)</b>		<b>0</b>

**If this is a pit closure:** (1) attach a diagram of the facility showing the pit's relationship to other equipment and tanks. (2) Indicate disposal location: onsite  offsite  If offsite, name of facility \_\_\_\_\_. (3) Attach a general description of remedial action taken including remediation start date and end date. (4) Groundwater encountered: No  Yes  If yes, show depth below ground surface \_\_\_\_\_ ft. and attach sample results. (5) Attach soil sample results and a diagram of sample locations and excavations.

I hereby certify that the information above is true and complete to the best of my knowledge and belief. I further certify that the above-described pit or below-grade tank has been/will be constructed or closed according to NMOCD guidelines , a general permit , or an (attached) alternative OCD-approved plan .

Date: 1/26/05  
 Printed Name/Title Cathy Wright, Sr Eng Tech Signature *Cathy Wright*

Your certification and NMOCD approval of this application/closure does not relieve the operator of liability should the contents of the pit or tank contaminate ground water or otherwise endanger public health or the environment. Nor does it relieve the operator of its responsibility for compliance with any other federal, state, or local laws and/or regulations.

Approval:  
 Date FEB 7 2005 *Field Rep*  
 Printed Name/Title \_\_\_\_\_ Signature *AK*

Pit Closing Procedure:

Pits are dewatered. Dirt contractor digs a deep bury pit adjacent to the drilling pit. Deep bury pit is lined with 12 mil plastic. Dirt contractor pushes contents of drilling pit into the deep bury pit. Deep bury pit is capped with 20 mil plastic then covered with 3 feet of fill dirt. *LINER*

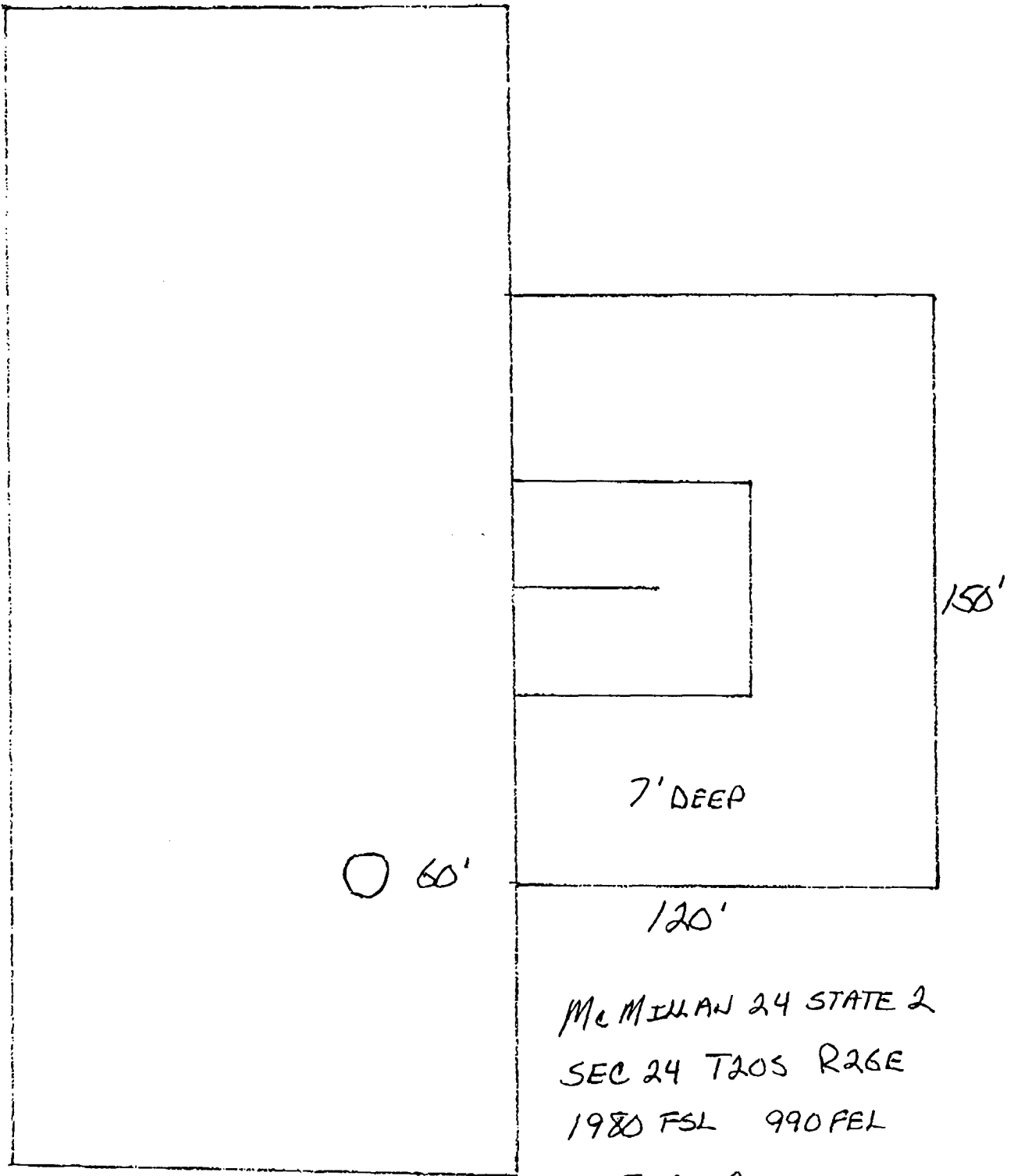

○ 60'

150'

7' DEEP

120'

McMILLAN 24 STATE 2  
 SEC 24 T20S R26E  
 1980 FSL 990 FEL

EDDY CO.

30 - 015 - 32336  
 32: 33: 434 N  
 104: 19: 615 W