

District I  
1625 N. French Dr., Hobbs, NM 88240  
District II  
1301 W. Grand Avenue, Artesia, NM 88210  
District III  
1000 Rio Brazos Road, Aztec, NM 87410  
District IV  
1220 S. St. Francis Dr., Santa Fe, NM 87505

State of New Mexico  
Energy Minerals and Natural  
Resources

Oil Conservation Division  
1220 South St. Francis Dr.  
Santa Fe, NM 87505

Form C-144  
June 1, 2004

For drilling and production facilities, submit  
to appropriate NMOCD District Office.  
For downstream facilities, submit to Santa Fe  
office

Pit or Below-Grade Tank Registration or Closure

Is pit or below-grade tank covered by a "general plan"? Yes ☒ No ☐

Type of action: Registration of a pit or below-grade tank ☐ Closure of a pit or below-grade tank ☒

Operator: Yates Petroleum Corporation Telephone: 505-748-4500 e-mail address: mikes@ypc.com

Address: 105. South 4<sup>th</sup> street, Artesia, N.M. 88210

Facility or well name: Harvest ABR State #3 API #: 30-005-63446 U/L or Qtr/Qtr J Sec 36 T 9s R 24e

County: Chaves Latitude 33.48885 Longitude 104.45567 NAD: 1927 ☐ 1983 ☒

Surface Owner: Federal State ☒ Private Indian ☐

Pit

Type: Drilling ☒ Production ☐ Disposal ☐

Work over ☐ Emergency ☐

Lined ☒ Unlined ☐

Liner type: Synthetic ☐ Thickness 12 mil Clay ☐

Pit Volume 15,000 bbl

Below-grade tank

Volume: bbl Type of fluid:

Construction material:

Double-walled, with leak detection? Yes ☐ If not, explain why not.

Depth to ground water (vertical distance from bottom of pit to seasonal high water elevation of ground water.)

Less than 50 feet

(20 points)

50 feet or more, but less than 100 feet

(10 points)

100 feet or more

( 0 points)X

Wellhead protection area: (Less than 200 feet from a private domestic water source, or less than 1000 feet from all other water sources.)

Yes

(20 points)

No

( 0 points)X

Distance to surface water: (horizontal distance to all wetlands, playas, irrigation canals, ditches, and perennial and ephemeral watercourses.)

Less than 200 feet

(20 points)

200 feet or more, but less than 1000 feet

(10 points)

1000 feet or more

( 0 points)X

**Ranking Score (Total Points)**

0 Points

**If this is a pit closure:** (1) Attach a diagram of the facility showing the pit's relationship to other equipment and tanks. (2) Indicate disposal location: (check the onsite box if you are burying in place) onsite ☒ offsite ☐ If offsite, name of facility. (3) Attach a general description of remedial action taken including remediation start date and end date. (4) Groundwater encountered: No ☐ Yes ☐ If yes, show depth below ground surface ft. and attach sample results. (5) Attach soil sample results and a diagram of sample locations and excavations.

Additional Comments: Workplan closure for encapsulation trench. The drilling pit contents will be mixed to stiffen the pit contents. Encapsulation trench will be excavated and lined with a 12 mil. Synthetic liner on former drilling pit site. Drilling pit contents will then be emplaced into the encapsulation trench. A 20 mil. Synthetic liner will then be placed over the pit contents with a min. of a 3' over lap of the underlying trench areas. The encapsulation trenches will then backfilled back to grade using a min. of 3' of clean soil and like material. A one call & 48 hour notice will be provide to the Oil Conservation Division before pit closure actions began.

Pit Closure actions to begin by NA. Ending date NA.

I hereby certify that the information above is true and complete to the best of my knowledge and belief. I further certify that the above-described pit or below-grade tank has been/will be constructed or closed according to NMOCD guidelines ☐, a general permit ☒, or an (attached) alternative OCD-approved plan ☐.

Date: 2/9/2005

Printed Name/Title Don Ddon PRS AGENT

Signature [Signature] ENV. & DEPT

Your certification and NMOCD approval of this application/closure does not relieve the operator of liability should the contents of the pit or tank contaminate ground water or otherwise endanger public health or the environment. Nor does it relieve the operator of its responsibility for compliance with any other federal, state, or local laws and/or regulations.

Approval:

Printed Name/Title

Signature [Signature]

FEB 9 2005  
Date:

30-005-63600  
Selden BDN Com #1  
30-005-63446  
HARVEST ABR St. #4  
HARVEST ABR St. #3

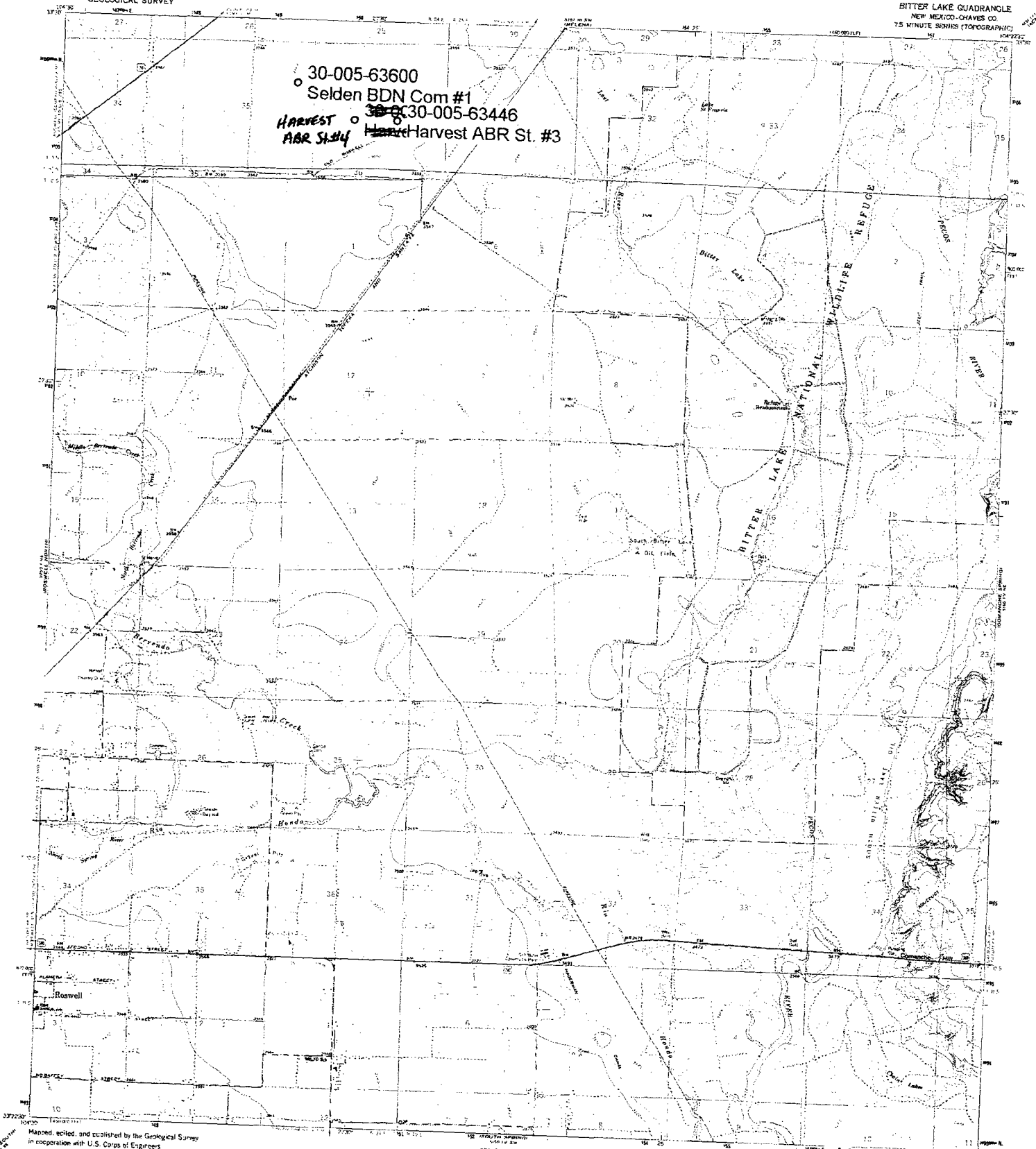

Maped, edited, and published by the Geological Survey  
in cooperation with U.S. Corps of Engineers  
Control by USGS and USACE

Photometry by photogrammetric methods from aerial photographs  
taken 1948. Topography by aneroid survey 1950. Revised 1962.  
Platting prepared 1967. North arrow datum  
12,000 feet and based on New Mexico meridional datum, zone 10  
1000 meters Universal Transverse Mercator with 1960  
mean sea level datum in blue.  
Faint and dashed lines indicate unproved survey lines.  
Area covered by dashed line may be subject  
to change in position.  
This map is not a legal document and should not be used  
for legal purposes.



SCALE 1:24,000  
CONTOUR INTERVAL 20 FEET  
BUTTER LAKES NATIONAL WILDLIFE REFUGE  
NATIONAL GEODETIC VERTICAL DATUM OF 1929



ROAD CLASSIFICATION  
Heavy duty Light duty  
Medium duty Unimproved dirt  
U.S. Route State Route

THIS MAP COMPLETES WITH NATIONAL MAP ACCURACY STANDARDS  
FOR SALE BY U.S. GEOLOGICAL SURVEY, DENVER, COLORADO 80225 OR RESTON, VIRGINIA 22092  
A FOLDER DESCRIBING TOPOGRAPHIC MAPS AND DRAWINGS IS AVAILABLE ON REQUEST

BITTER LAKE, N. MEX.  
1:24,000 to NAD83 5/7/5  
1962  
ACTUAL DATE 1962  
ANS 500 IV 5W - SERIES 1961

**New Mexico Office of the State Engineer  
Well Reports and Downloads**

Township: 09S Range: 24E Sections:

NAD27 X: Y: Zone: Search Radius:

County: Basin: Number: Suffix:

Owner Name: (First) (Last) ☐ Non-Domestic ☐ Domestic  
☒ All

Well / Surface Data Report

Avg Depth to Water Report

Water Column Report

Clear Form

WATERS Menu

Help

**AVERAGE DEPTH OF WATER REPORT 02/04/2005**

Bsn	Tws	Rng	Sec	Zone	X	Y	Wells	(Depth Water in Feet)		
								Min	Max	Avg
RA	09S	24E	01				1	75	75	75
RA	09S	24E	02				7	34	70	53
RA	09S	24E	03				1	29	29	29
RA	09S	24E	05				4	133	165	145
RA	09S	24E	09				3	100	126	117
RA	09S	24E	10				1	35	35	35
RA	09S	24E	11				10	17	80	53
RA	09S	24E	14				7	28	67	41
RA	09S	24E	15				4	47	66	55
RA	09S	24E	17				1	40	40	40
RA	09S	24E	23				1	25	25	25
RA	09S	24E	26				1	50	50	50
RA	09S	24E	32				4	40	103	77
RA	09S	24E	33				8	40	100	70
RA	09S	24E	34				6	46	70	59
RA	09S	24E	35				1	150	150	150

Record Count: 60

30-005-63600  
Selden BDN Com #1  
30-005-63446  
HARVEST ABR St. #3  
HARVEST ABR St. #4

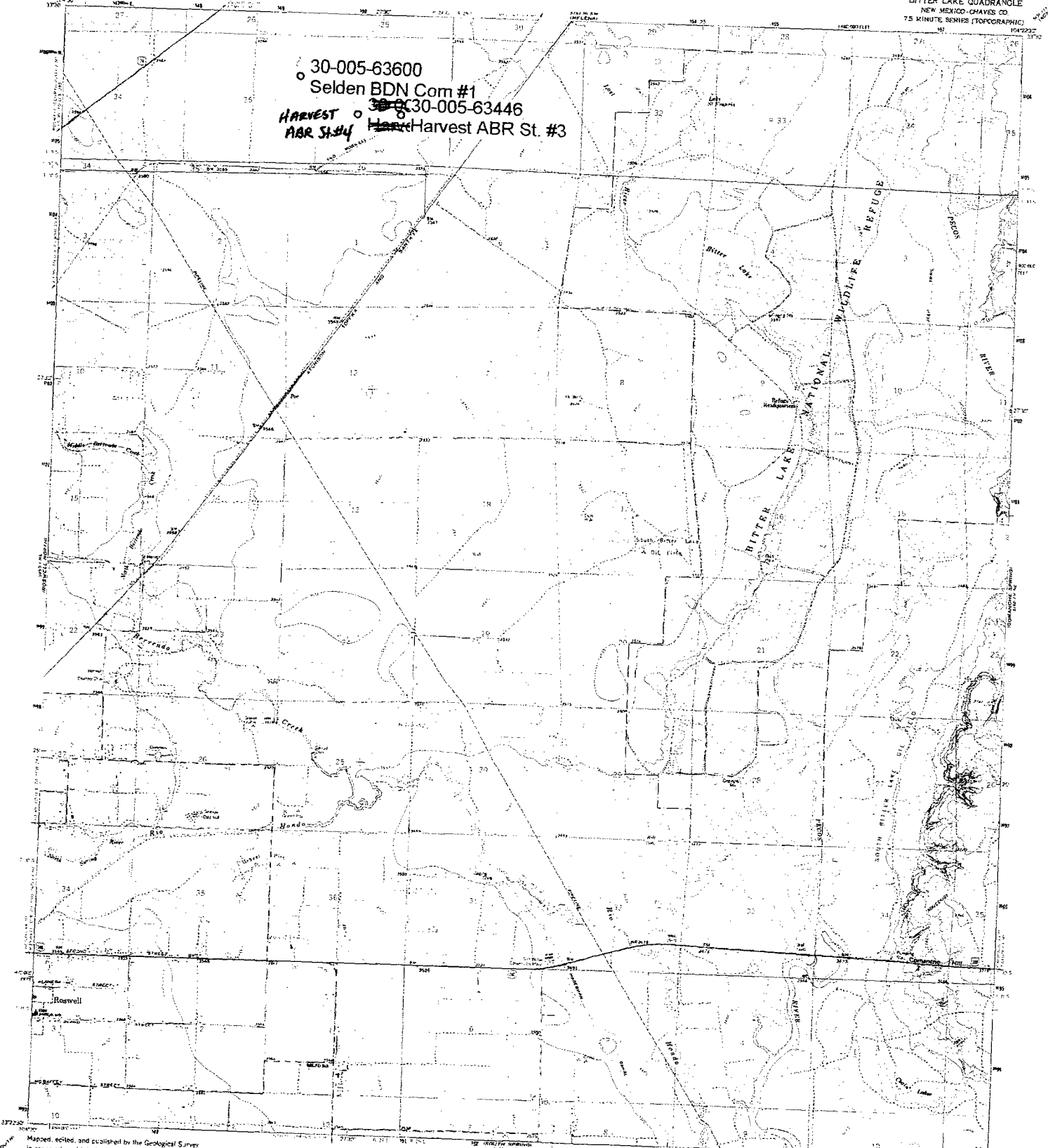

Maped, edited, and published by the Geological Survey  
in cooperation with U.S. Corps of Engineers  
Control by 1950 and 1954  
Plan made by photogrammetric methods using aerial photographs  
taken 1967. Contours by stereoscopic survey 1970. Revised 1962  
No graphic projection. 1967 North American datum  
12,000 foot grid based on New Mexico coordinate system and zone  
1000 contour interval. Elevation in feet. Contour interval 100  
feet. 1:50,000 scale. Contour interval 100 feet  
Plan and dashed lines indicate surface water features  
Area covered by dashed line blue pattern is subject  
to confirmation in 1968  
This is a preliminary map. It is not a final map. It is not a  
final map. It is not a final map. It is not a final map.

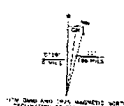

SCALE 1:24,000  
CONTOUR INTERVAL 10 FEET  
BITTER LAKE NATIONAL WILDLIFE REFUGE  
NATIONAL GEOGRAPHIC MAPS  
NATIONAL GEOGRAPHIC MAPS  
NATIONAL GEOGRAPHIC MAPS

ROAD CLASSIFICATION  
Heavy duty Light duty  
Medium duty Unimproved dirt  
U.S. Route State Route

FOR SALE BY U.S. GEOLOGICAL SURVEY, DENVER, COLORADO 80226, OR RESTON, VIRGINIA 22092  
A 10000 DESIGNED TOPOGRAPHIC MAPS AND SYMBOLS IS AVAILABLE ON REQUEST

BITTER LAKE, N. MEX.  
1962  
AMERICAN MAP COMPANY