

District I
1625 N. French Dr., Hobbs, NM 88240
District II
1301 W. Grand Avenue, Artesia, NM 88210
District III
1000 Rio Brazos Road, Aztec, NM 87410
District IV
1220 S. St. Francis Dr., Santa Fe, NM 87505

State of New Mexico
Energy Minerals and Natural
Resources

Oil Conservation Division
1220 South St. Francis Dr.
Santa Fe, NM 87505

Form C-144
June 1, 2004

For drilling and production facilities, submit
to appropriate NMOCD District Office.
For downstream facilities, submit to Santa Fe
office

Pit or Below-Grade Tank Registration or Closure

Is pit or below-grade tank covered by a "general plan"? Yes ☒ No ☐

Type of action: Registration of a pit or below-grade tank ☐ Closure of a pit or below-grade tank ☒

Operator: Yates Petroleum Corporation Telephone: 505-748-4500 e-mail address: mikes@ypc.com

Address: 105 South 4th Street, Artesia, N.M. 88210

Facility or well name: General AWL St #1 API #: 30-005-60755 U/L or Qtr/Qtr H Sec 36 T 7S R 28E

County: Chaves Latitude 33.66451 Longitude 104.03424 NAD: 1927 ☐ 1983 ☒

Surface Owner: Federal ☐ State ☒ Private ☐ Indian ☐

RECEIVED

Pit Type: Drilling <input checked="" type="checkbox"/> Production <input type="checkbox"/> Disposal <input type="checkbox"/> Work over <input checked="" type="checkbox"/> Emergency <input type="checkbox"/> Lined <input checked="" type="checkbox"/> Unlined <input type="checkbox"/> Liner type: Synthetic <input type="checkbox"/> Thickness <u>NA</u> mil Clay <input type="checkbox"/> Pit Volume <u>NA</u> bbl	Below-grade tank Volume: <u> </u> bbl Type of fluid: <u> </u> Construction material: <u> </u> Double-walled, with leak detection? Yes <input type="checkbox"/> If not, explain why not. <u> </u>	
Depth to ground water (vertical distance from bottom of pit to seasonal high water elevation of ground water.)	Less than 50 feet	(20 points)
	50 feet or more, but less than 100 feet	(10 points)
	100 feet or more	(0 points) XXXX
Wellhead protection area: (Less than 200 feet from a private domestic water source, or less than 1000 feet from all other water sources.)	Yes	(20 points)
	No	(0 points)XXXX
Distance to surface water: (horizontal distance to all wetlands, playas, irrigation canals, ditches, and perennial and ephemeral watercourses.)	Less than 200 feet	(20 points)
	200 feet or more, but less than 1000 feet	(10 points)
	1000 feet or more	(0 points)XXXX
Ranking Score (Total Points)		0 Points

If this is a pit closure: (1) Attach a diagram of the facility showing the pit's relationship to other equipment and tanks. (2) Indicate disposal location: (check the onsite box if you are burying in place) onsite ☒ offsite ☐ If offsite, name of facility: . (3) Attach a general description of remedial action taken including remediation start date and end date. (4) Groundwater encountered: No ☐ Yes ☐ If yes, show depth below ground surface ft. and attach sample results. (5) Attach soil sample results and a diagram of sample locations and excavations.

Additional Comments: Work plan for the closure of Workover Pit. A 20 mil synthetic liner will be placed 3' below grade with a min. 3' over lap of the underlaying pit. The workover pit will be backfilled to grade using a minimum of 3' of clean soil and like material.

I hereby certify that the information above is true and complete to the best of my knowledge and belief. I further certify that the above-described pit or below-grade tank has been/will be constructed or closed according to NMOCD guidelines ☐, a general permit ☐, or an (attached) alternative OCD-approved plan ☐.

Date: 03/17/05

Printed Name/Title Dan Dolan / Regulatory Agent

Signature [Signature]

Your certification and NMOCD approval of this application/closure does not relieve the operator of liability should the contents of the pit or tank contaminate ground water or otherwise endanger public health or the environment. Nor does it relieve the operator of its responsibility for compliance with any other federal, state, or local laws and/or regulations.

Approval:

Printed Name/Title [Signature]

Signature [Signature]

Date: MAR 23 2005

New Mexico Office of the State Engineer
Well Reports and Downloads

General AWD St. #1

Township: 07S Range: 28E Sections:

NAD27 X: Y: Zone: Search Radius:

County: Basin: Number: Suffix:

Owner Name: (First) (Last) ☐ Non-Domestic ☐ Domestic
☒ All

Well / Surface Data Report

Avg Depth to Water Report

Water Column Report

Clear Form

WATERS Menu

Help

AVERAGE DEPTH OF WATER REPORT 03/16/2005

Bsn	Tws	Rng	Sec	Zone	X	Y	Wells	(Depth Water in Feet)		
								Min	Max	Avg
RA	07S	28E	34				1	600	600	600

Record Count: 1

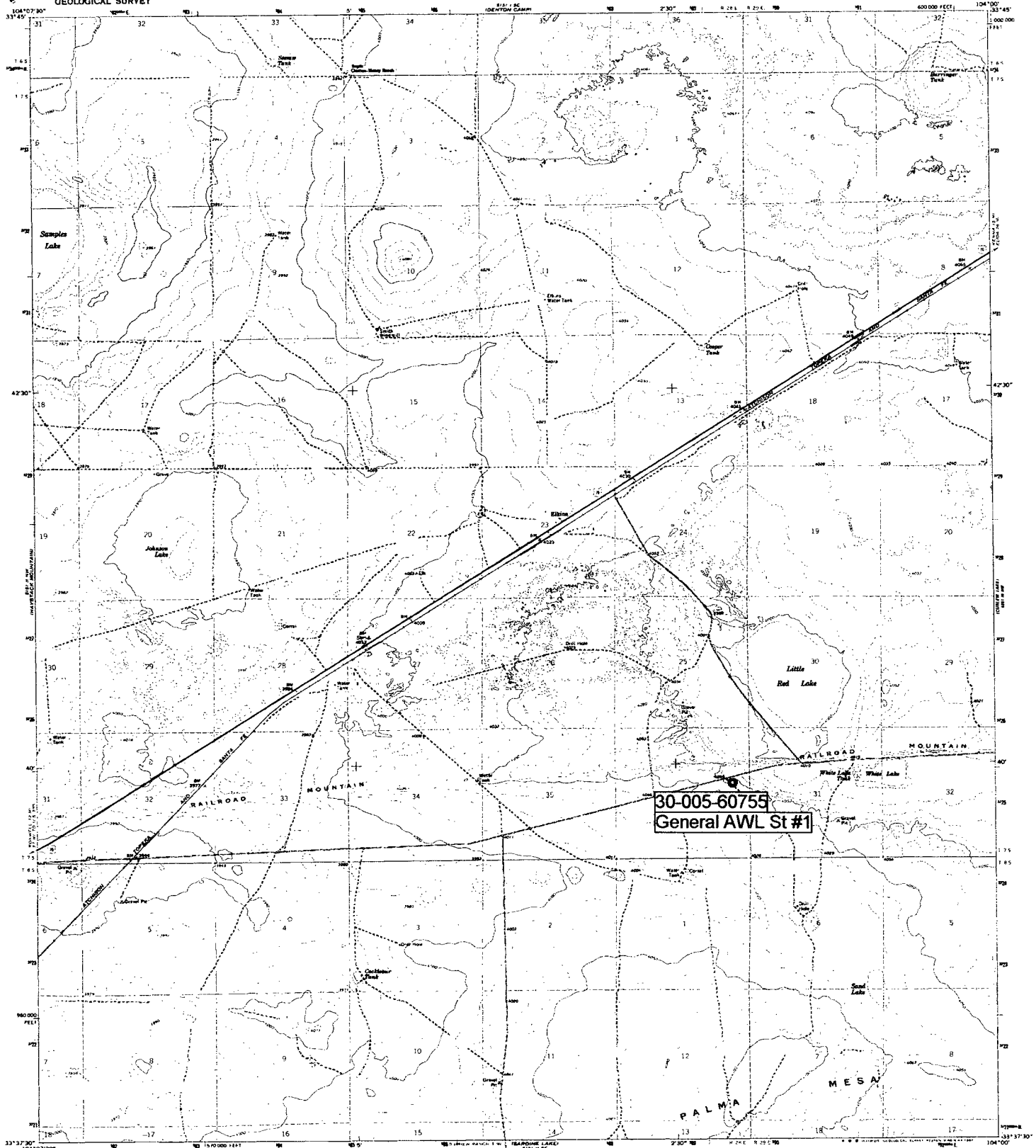

Mapped, edited, and published by the Geological Survey
Control by USGS and NGS/NOAA
Topography by photogrammetric methods from aerial
photographs taken 1966. Field checked 1967
Polyconic projection. 10,000-foot grid ticks based on New Mexico
coordinate system, and zone. 1000-meter Universal Transverse
Mercator grid ticks, zone 13, shown in blue. 1927 North American
Datum. To place on the projected North American Datum 1983
use the projection base 6 meters shift and 47 system and as
shown by dashed corner ticks
Fine red dashed lines indicate selected fence lines
Revisions shown in red and associated with the
photographic revision of the original map
This communication is for informational purposes only

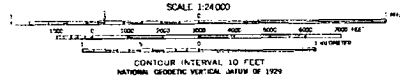

ROAD CLASSIFICATION
Heavy-duty
Light-duty
Unimproved dirt
U.S. Route

"THIS MAP COMPLETS WITH NATIONAL MAP ACCURACY STANDARDS
FOR SALE BY U.S. GEOLOGICAL SURVEY, DENVER, COLORADO 80225, OR RESTON, VIRGINIA 22092
A FOLDER DESCRIBING TOPOGRAPHIC MAPS AND SYMBOLS IS AVAILABLE ON REQUEST

ELKINS, N. MEX.
N3337.5-W10400.7.5
1967
DMS 815 11 N.E. SERIES 7501