

Form 3160-3  
(June 2015)UNITED STATES  
DEPARTMENT OF THE INTERIOR  
BUREAU OF LAND MANAGEMENT

## APPLICATION FOR PERMIT TO DRILL OR REENTER

FORM APPROVED  
OMB No. 1004-0137  
Expires: January 31, 2018

1a. Type of work: <input checked="" type="checkbox"/> DRILL <input type="checkbox"/> REENTER		5. Lease Serial No. NMNM0405444
1b. Type of Well: <input checked="" type="checkbox"/> Oil Well <input type="checkbox"/> Gas Well <input type="checkbox"/> Other		6. If Indian, Allottee or Tribe Name
1c. Type of Completion: <input type="checkbox"/> Hydraulic Fracturing <input checked="" type="checkbox"/> Single Zone <input type="checkbox"/> Multiple Zone		7. If Unit or CA Agreement, Name and No.
2. Name of Operator DEVON ENERGY PRODUCTION COMPANY LP		8. Lease Name and Well No. ALEUTIAN 10-3 FED COM 334H
3a. Address 333 West Sheridan Avenue, Oklahoma City, OK 73102	3b. Phone No. (include area code) (800) 583-3866	9. API Well No. 30 015 47556
4. Location of Well (Report location clearly and in accordance with any State requirements. *) At surface SESE / 315 FSL / 430 FEL / LAT 32.3126113 / LONG -103.7585154 At proposed prod. zone LOT 1 / 20 FNL / 330 FEL / LAT 32.3406813 / LONG -103.7582285		10. Field and Pool, or Exploratory Livingston Ridge Bone Spring/BONESPRI
14. Distance in miles and direction from nearest town or post office*		11. Sec., T. R. M. or Blk. and Survey or Area SEC 10/T23S/R31E/NMP
15. Distance from proposed* location to nearest property or lease line, ft. (Also to nearest drig. unit line, if any) 315 feet		12. County or Parish EDDY
16. No of acres in lease 1320		13. State NM
17. Spacing Unit dedicated to this well 320.0		
18. Distance from proposed location* to nearest well, drilling, completed, applied for, on this lease, ft. 376 feet		20. BLM/BIA Bond No. in file FED: NMB000801
21. Elevations (Show whether DF, KDB, RT, GL, etc.) 3421 feet		22. Approximate date work will start* 06/26/2021
		23. Estimated duration 45 days
24. Attachments		

The following, completed in accordance with the requirements of Onshore Oil and Gas Order No. 1, and the Hydraulic Fracturing rule per 43 CFR 3162.3-3 (as applicable)

- |  |   |
|--|---|
| 1. Well plat certified by a registered surveyor.   | 4. Bond to cover the operations unless covered by an existing bond on file (see Item 20 above). |
| 2. A Drilling Plan.  | 5. Operator certification.  |
| 3. A Surface Use Plan (if the location is on National Forest System Lands, the SUPO must be filed with the appropriate Forest Service Office). | 6. Such other site specific information and/or plans as may be requested by the BLM.            |

25. Signature (Electronic Submission)	Name (Printed/Typed) JENNY HARMS / Ph: (800) 583-3866	Date 06/25/2020
Title Regulatory Compliance Professional		
Approved by (Signature) (Electronic Submission)	Name (Printed/Typed) Cody Layton / Ph: (575) 234-5959	Date 09/29/2020
Title Assistant Field Manager Lands & Minerals Carlsbad Field Office		

Application approval does not warrant or certify that the applicant holds legal or equitable title to those rights in the subject lease which would entitle the applicant to conduct operations thereon.  
Conditions of approval, if any, are attached.

Title 18 U.S.C. Section 1001 and Title 43 U.S.C. Section 1212, make it a crime for any person knowingly and willfully to make to any department or agency of the United States any false, fictitious or fraudulent statements or representations as to any matter within its jurisdiction.

- Oil base muds are not to be used until fresh water zones are cased and cemented providing isolation from the oil or diesel. This includes synthetic oils. Oil based mud, drilling fluids and solids must be contained in a steel closed loop system.
- Will require a directional survey with the C-104

Once the well is spud, to prevent ground water contamination through whole or partial conduits from the surface, the operator shall drill without interruption through the fresh water zone or zones and shall immediately set in cement the water protection string

**APPROVED WITH CONDITIONS**

Approval Date: 09/29/2020

SL

(Continued on page 2)

KP 10/13/2020 GEO Review

\*(Instructions on page 2)

Entered - KMS NMOC

**17 OPERATOR CERTIFICATION**

I hereby certify that the information contained herein is true and complete to the best of my knowledge and belief, and that this organization either owns a working interest or unleased mineral interest in the land including the proposed bottom hole location or has a right to drill this well at this location pursuant to a contract with an owner of such a mineral or working interest, or to a voluntary pooling agreement or a compulsory pooling order heretofore entered by the division.

*Jenny Harms* 6-8-2020  
Signature Date

**JENNY HARMS**  
Printed Name

**JENNY.HARMS@DVN.COM**  
E-mail Address

**18 SURVEYOR CERTIFICATION**

I hereby certify that the well location shown on this plat was plotted from field notes of actual surveys made by me or under my supervision, and that the same is true and correct to the best of my belief.

JUNE 3, 2020  
Date of Survey

*Jenny Harms*  
Signature and Seal of Professional Surveyor

Certificate Number: FILLION F. JARAMILLO, PLS 12797  
SPELLEY NO.8171A

Intent ☒ As Drilled ☐

API #

Operator Name:	Property Name:	Well Number
<b>DEVON ENERGY PRODUCTION CO., L.P.</b>	<b>ALEUTIAN 10-3 FED COM</b>	<b>334H</b>

Kick Off Point (KOP)

UL P	Section 10	Township 23S	Range 31E	Lot	Feet 50 FSL	From N/S	Feet 330 FEL	From E/W	County EDDY
Latitude 32.31188100					Longitude -103.75819700			NAD 83	

First Take Point (FTP)

UL P	Section 10	Township 23S	Range 31E	Lot	Feet 100	From N/S SOUTH	Feet 330	From E/W EAST	County EDDY
Latitude 32.3120206					Longitude 103.7581917			NAD 83	

Last Take Point (LTP)

UL	Section 3	Township 23S	Range 31E	Lot 1	Feet 100	From N/S NORTH	Feet 330	From E/W EAST	County EDDY
Latitude 32.3404614					Longitude 103.7582280			NAD 83	

Is this well the defining well for the Horizontal Spacing Unit?

Is this well an infill well?

If infill is yes please provide API if available, Operator Name and well number for Defining well for Horizontal Spacing Unit.

API #

Operator Name:	Property Name:	Well Number

KZ 06/29/2018

District I  
1625 N. French Dr., Hobbs, NM 88240  
District II  
811 S. First St., Artesia, NM 88210  
District III  
1000 Rio Brazos Road, Aztec, NM 87410  
District IV  
1220 S. St. Francis Dr., Santa Fe, NM 87505

State of New Mexico  
Energy, Minerals and Natural Resources Department

Submit Original  
to Appropriate  
District Office

Oil Conservation Division  
1220 South St. Francis Dr.  
Santa Fe, NM 87505

## GAS CAPTURE PLAN

Date: June 8, 2020

☒ Original Devon & OGRID No.: Devon Energy Production Co., L.P. 6137  
☐ Amended - Reason for Amendment: \_\_\_\_\_

This Gas Capture Plan outlines actions to be taken by the Devon to reduce well/production facility flaring/venting for new completion (new drill, recomple to new zone, re-frac) activity.

*Note: Form C-129 must be submitted and approved prior to exceeding 60 days allowed by Rule (Subsection A of 19.15.18.12 NMAC).*

### Well(s)/Production Facility – Name of facility

The well(s) that will be located at the production facility are shown in the table below.

Well Name	API	SHL FOOTAGES					Expected MCF/D	Flared or Vented	COMMENTS
Aleutian 10-3 Fed Com 614H		10-23S-31E	490	FEL	315	FSL			GALAPAGOS 14 CTB 2
Aleutian 10-3 Fed Com 714H		10-23S-31E	460	FEL	315	FSL			GALAPAGOS 14 CTB 2
Aleutian 10-3 Fed Com 334H		10-23S-31E	430	FEL	315	FSL			GALAPAGOS 14 CTB 2
Aleutian 10-3 Fed Com 613H		10-23S-31E	1747	FEL	640	FSL			ALEUTIAN 10 CTB 3
Aleutian 10-3 Fed Com 713H		10-23S-31E	1717	FEL	640	FSL			ALEUTIAN 10 CTB 3
Aleutian 10-3 Fed Com 333H		10-23S-31E	1687	FEL	640	FSL			ALEUTIAN 10 CTB 3
Aleutian 10-3 Fed Com 612H		10-23S-31E	1859	FWL	325	FSL			ALEUTIAN 10 CTB 3
Aleutian 10-3 Fed Com 712H		10-23S-31E	1889	FWL	325	FSL			ALEUTIAN 10 CTB 3
Aleutian 10-3 Fed Com 332H		10-23S-31E	1919	FWL	325	FSL			ALEUTIAN 10 CTB 3
Aleutian 10-3 Fed Com 611H		10-23S-31E	730	FWL	375	FSL			ALEUTIAN 10 CTB 3
Aleutian 10-3 Fed Com 711H		10-23S-31E	760	FWL	375	FSL			ALEUTIAN 10 CTB 3
Aleutian 10-3 Fed Com 331H		10-23S-31E	790	FWL	375	FSL			ALEUTIAN 10 CTB 3

### Gathering System and Pipeline Notification

Well(s) will be connected to a production facility after flowback operations are complete, if DCP system is in place. The gas produced from production facility is dedicated to DCP and will be connected to DCP low/high pressure gathering system located in Lea County, New Mexico. It will require 0' of pipeline to connect the facility to low/high pressure gathering system. Devon provides (periodically) to DCP a drilling, completion and estimated first production date for wells that are scheduled to be drilled in the foreseeable future. In addition, Devon and DCP have periodic conference calls to discuss changes to drilling and completion schedules. Gas from these wells will be processed at DCP Processing Plant located in the reference table. The actual flow of the gas will be based on compression operating parameters and gathering system pressures.

**Flowback Strategy:** After the fracture treatment/completion operations, well(s) will be produced to temporary production tanks and gas will be flared or vented. During flowback, the fluids and sand content will be monitored. When the produced fluids contain minimal sand, the wells will be turned to production facilities. Gas sales should start as soon as the wells start flowing through the production facilities, unless there are operational issues on DCP system at that time. Based on current information, it is Devon's belief the system can take this gas upon completion of the well(s).

Safety requirements during cleanout operations from the use of underbalanced air cleanout systems may necessitate that sand and non-pipeline quality gas be vented and/or flared rather than sold on a temporary basis.

**Alternatives to Reduce Flaring**

Below are alternatives considered from a conceptual standpoint to reduce the amount of gas flared.

- Power Generation – On lease
  - Only a portion of gas is consumed operating the generator, remainder of gas will be flared
- Compressed Natural Gas – On lease
  - Gas flared would be minimal, but might be uneconomical to operate when gas volume declines
- NGL Removal – On lease
  - Plants are expensive, residue gas is still flared, and uneconomical to operate when gas volume declines

**Reference Table:**

DCP Plant locations

Artesia Sec. 7, T18S, R28E,

Eunice Sec. 5, T21S, R36E

Linam Sec. 6, T19S, R37E

Zia II Sec. 19, T19S, R32E

1. Geologic Formations

TVD of target	11415	Pilot hole depth	N/A
MD at TD:	21652	Deepest expected fresh water	

Basin

Formation	Depth (TVD) from KB	Water/Mineral Bearing/Target Zone?	Hazards*
Rustler	545		
Salt	885		
Base of Salt	4060		
Delaware	4285		
Bone Spring 1st	9235		
Bone Spring 2nd	9735		
Bone Spring 3rd	10985		
Wolfcamp	11455		

\*H2S, water flows, loss of circulation, abnormal pressures, etc.

# **WCDSC Permian NM**

**Eddy County (NAD 83 NM Eastern)**

**Sec 10-T23S-R31E**

**Aleutian 10-3 Fed Com 334H**

**Wellbore #1**

**Plan: Permit Plan 1**

## **Standard Planning Report - Geographic**

**09 June, 2020**

# Planning Report - Geographic

<b>Database:</b>	EDM r5000.141_Prod US	<b>Local Co-ordinate Reference:</b>	Well Aleutian 10-3 Fed Com 334H
<b>Company:</b>	WCDSC Permian NM	<b>TVD Reference:</b>	RKB @ 3446.10ft
<b>Project:</b>	Eddy County (NAD 83 NM Eastern)	<b>MD Reference:</b>	RKB @ 3446.10ft
<b>Site:</b>	Sec 10-T23S-R31E	<b>North Reference:</b>	Grid
<b>Well:</b>	Aleutian 10-3 Fed Com 334H	<b>Survey Calculation Method:</b>	Minimum Curvature
<b>Wellbore:</b>	Wellbore #1		
<b>Design:</b>	Permit Plan 1		

<b>Project</b>	Eddy County (NAD 83 NM Eastern)		
<b>Map System:</b>	US State Plane 1983	<b>System Datum:</b>	Mean Sea Level
<b>Geo Datum:</b>	North American Datum 1983		
<b>Map Zone:</b>	New Mexico Eastern Zone		

Site		Sec 10-T23S-R31E			
Site Position:		Northing:	488,145.31 usft	Latitude:	32.340744
From:	Map	Easting:	714,000.60 usft	Longitude:	-103.774261
Position Uncertainty:	0.00 ft	Slot Radius:	13-3/16 "	Grid Convergence:	0.30 °

Well	Aleutian 10-3 Fed Com 334H					
Well Position	+N/-S	0.00 ft	Northing:	477,936.52 usft	Latitude:	32.312611
	+E/-W	0.00 ft	Easting:	718,918.25 usft	Longitude:	-103.758516
Position Uncertainty		0.50 ft	Wellhead Elevation:		Ground Level:	3,421.10 ft

<b>Wellbore</b>	Wellbore #1				
<b>Magnetics</b>	<b>Model Name</b>	<b>Sample Date</b>	<b>Declination (°)</b>	<b>Dip Angle (°)</b>	<b>Field Strength (nT)</b>
	IGRF2015	6/8/2020	6.72	60.08	47,664.93099323

<b>Design</b>	Permit Plan 1			
<b>Audit Notes:</b>				
<b>Version:</b>	<b>Phase:</b>	PROTOTYPE	<b>Tie On Depth:</b>	0.00
<b>Vertical Section:</b>	<b>Depth From (TVD) (ft)</b>	<b>+N/-S (ft)</b>	<b>+E/-W (ft)</b>	<b>Direction (°)</b>
	0.00	0.00	0.00	0.19

<b>Plan Survey Tool Program</b>	<b>Date</b>	6/9/2020		
<b>Depth From (ft)</b>	<b>Depth To (ft)</b>	<b>Survey (Wellbore)</b>	<b>Tool Name</b>	<b>Remarks</b>
1	0.00	21,651.58 Permit Plan 1 (Wellbore #1)	MWD+HDGM	
			OWSG MWD + HDGM	

<b>Plan Sections</b>										
<b>Measured Depth (ft)</b>	<b>Inclination (°)</b>	<b>Azimuth (°)</b>	<b>Vertical Depth (ft)</b>	<b>+N/-S (ft)</b>	<b>+E/-W (ft)</b>	<b>Dogleg Rate (°/100usft)</b>	<b>Build Rate (°/100usft)</b>	<b>Turn Rate (°/100usft)</b>	<b>TFO (°)</b>	<b>Target</b>
0.00	0.00	0.00	0.00	0.00	0.00	0.00	0.00	0.00	0.00	
2,500.00	0.00	0.00	2,500.00	0.00	0.00	0.00	0.00	0.00	0.00	
2,707.46	2.07	159.33	2,707.41	-3.51	1.33	1.00	1.00	0.00	159.33	
10,358.79	2.07	159.33	10,353.72	-262.66	99.12	0.00	0.00	0.00	0.00	
10,497.09	0.00	0.00	10,492.00	-265.00	100.00	1.50	-1.50	0.00	180.00	
10,847.13	0.00	0.00	10,842.04	-265.00	100.00	0.00	0.00	0.00	0.00	
11,747.13	90.00	359.64	11,415.00	307.95	96.38	10.00	10.00	0.00	359.64	PBHL - Aleutian 10-3
21,651.58	90.00	359.64	11,415.00	10,212.20	33.84	0.00	0.00	0.00	0.00	PBHL - Aleutian 10-3



# Planning Report - Geographic

<b>Database:</b>	EDM r5000.141_Prod US	<b>Local Co-ordinate Reference:</b>	Well Aleutian 10-3 Fed Com 334H
<b>Company:</b>	WCDSC Permian NM	<b>TVD Reference:</b>	RKB @ 3446.10ft
<b>Project:</b>	Eddy County (NAD 83 NM Eastern)	<b>MD Reference:</b>	RKB @ 3446.10ft
<b>Site:</b>	Sec 10-T23S-R31E	<b>North Reference:</b>	Grid
<b>Well:</b>	Aleutian 10-3 Fed Com 334H	<b>Survey Calculation Method:</b>	Minimum Curvature
<b>Wellbore:</b>	Wellbore #1		
<b>Design:</b>	Permit Plan 1		

Planned Survey									
Measured Depth (ft)	Inclination (°)	Azimuth (°)	Vertical Depth (ft)	+N/-S (ft)	+E/-W (ft)	Map Northing (usft)	Map Easting (usft)	Latitude	Longitude
0.00	0.00	0.00	0.00	0.00	0.00	477,936.52	718,918.25	32.312611	-103.758516
100.00	0.00	0.00	100.00	0.00	0.00	477,936.52	718,918.25	32.312611	-103.758516
200.00	0.00	0.00	200.00	0.00	0.00	477,936.52	718,918.25	32.312611	-103.758516
300.00	0.00	0.00	300.00	0.00	0.00	477,936.52	718,918.25	32.312611	-103.758516
400.00	0.00	0.00	400.00	0.00	0.00	477,936.52	718,918.25	32.312611	-103.758516
500.00	0.00	0.00	500.00	0.00	0.00	477,936.52	718,918.25	32.312611	-103.758516
600.00	0.00	0.00	600.00	0.00	0.00	477,936.52	718,918.25	32.312611	-103.758516
700.00	0.00	0.00	700.00	0.00	0.00	477,936.52	718,918.25	32.312611	-103.758516
800.00	0.00	0.00	800.00	0.00	0.00	477,936.52	718,918.25	32.312611	-103.758516
900.00	0.00	0.00	900.00	0.00	0.00	477,936.52	718,918.25	32.312611	-103.758516
1,000.00	0.00	0.00	1,000.00	0.00	0.00	477,936.52	718,918.25	32.312611	-103.758516
1,100.00	0.00	0.00	1,100.00	0.00	0.00	477,936.52	718,918.25	32.312611	-103.758516
1,200.00	0.00	0.00	1,200.00	0.00	0.00	477,936.52	718,918.25	32.312611	-103.758516
1,300.00	0.00	0.00	1,300.00	0.00	0.00	477,936.52	718,918.25	32.312611	-103.758516
1,400.00	0.00	0.00	1,400.00	0.00	0.00	477,936.52	718,918.25	32.312611	-103.758516
1,500.00	0.00	0.00	1,500.00	0.00	0.00	477,936.52	718,918.25	32.312611	-103.758516
1,600.00	0.00	0.00	1,600.00	0.00	0.00	477,936.52	718,918.25	32.312611	-103.758516
1,700.00	0.00	0.00	1,700.00	0.00	0.00	477,936.52	718,918.25	32.312611	-103.758516
1,800.00	0.00	0.00	1,800.00	0.00	0.00	477,936.52	718,918.25	32.312611	-103.758516
1,900.00	0.00	0.00	1,900.00	0.00	0.00	477,936.52	718,918.25	32.312611	-103.758516
2,000.00	0.00	0.00	2,000.00	0.00	0.00	477,936.52	718,918.25	32.312611	-103.758516
2,100.00	0.00	0.00	2,100.00	0.00	0.00	477,936.52	718,918.25	32.312611	-103.758516
2,200.00	0.00	0.00	2,200.00	0.00	0.00	477,936.52	718,918.25	32.312611	-103.758516
2,300.00	0.00	0.00	2,300.00	0.00	0.00	477,936.52	718,918.25	32.312611	-103.758516
2,400.00	0.00	0.00	2,400.00	0.00	0.00	477,936.52	718,918.25	32.312611	-103.758516
2,500.00	0.00	0.00	2,500.00	0.00	0.00	477,936.52	718,918.25	32.312611	-103.758516
2,600.00	1.00	159.33	2,599.99	-0.82	0.31	477,935.70	718,918.55	32.312609	-103.758515
2,700.00	2.00	159.33	2,699.96	-3.27	1.23	477,933.26	718,919.48	32.312602	-103.758512
2,707.46	2.07	159.33	2,707.41	-3.51	1.33	477,933.01	718,919.57	32.312602	-103.758511
2,800.00	2.07	159.33	2,799.89	-6.65	2.51	477,929.87	718,920.75	32.312593	-103.758508
2,900.00	2.07	159.33	2,899.83	-10.03	3.79	477,926.49	718,922.03	32.312584	-103.758504
3,000.00	2.07	159.33	2,999.76	-13.42	5.06	477,923.10	718,923.31	32.312574	-103.758500
3,100.00	2.07	159.33	3,099.70	-16.81	6.34	477,919.71	718,924.59	32.312565	-103.758495
3,200.00	2.07	159.33	3,199.63	-20.20	7.62	477,916.33	718,925.87	32.312556	-103.758491
3,300.00	2.07	159.33	3,299.57	-23.58	8.90	477,912.94	718,927.15	32.312546	-103.758487
3,400.00	2.07	159.33	3,399.50	-26.97	10.18	477,909.55	718,928.42	32.312537	-103.758483
3,500.00	2.07	159.33	3,499.44	-30.36	11.46	477,906.16	718,929.70	32.312528	-103.758479
3,600.00	2.07	159.33	3,599.37	-33.74	12.73	477,902.78	718,930.98	32.312518	-103.758475
3,700.00	2.07	159.33	3,699.30	-37.13	14.01	477,899.39	718,932.26	32.312509	-103.758471
3,800.00	2.07	159.33	3,799.24	-40.52	15.29	477,896.00	718,933.54	32.312500	-103.758467
3,900.00	2.07	159.33	3,899.17	-43.90	16.57	477,892.62	718,934.81	32.312490	-103.758463
4,000.00	2.07	159.33	3,999.11	-47.29	17.85	477,889.23	718,936.09	32.312481	-103.758459
4,100.00	2.07	159.33	4,099.04	-50.68	19.12	477,885.84	718,937.37	32.312472	-103.758455
4,200.00	2.07	159.33	4,198.98	-54.06	20.40	477,882.46	718,938.65	32.312462	-103.758451
4,300.00	2.07	159.33	4,298.91	-57.45	21.68	477,879.07	718,939.93	32.312453	-103.758447
4,400.00	2.07	159.33	4,398.85	-60.84	22.96	477,875.68	718,941.20	32.312444	-103.758442
4,500.00	2.07	159.33	4,498.78	-64.23	24.24	477,872.30	718,942.48	32.312434	-103.758438
4,600.00	2.07	159.33	4,598.71	-67.61	25.51	477,868.91	718,943.76	32.312425	-103.758434
4,700.00	2.07	159.33	4,698.65	-71.00	26.79	477,865.52	718,945.04	32.312416	-103.758430
4,800.00	2.07	159.33	4,798.58	-74.39	28.07	477,862.13	718,946.32	32.312407	-103.758426
4,900.00	2.07	159.33	4,898.52	-77.77	29.35	477,858.75	718,947.59	32.312397	-103.758422
5,000.00	2.07	159.33	4,998.45	-81.16	30.63	477,855.36	718,948.87	32.312388	-103.758418
5,100.00	2.07	159.33	5,098.39	-84.55	31.90	477,851.97	718,950.15	32.312379	-103.758414
5,200.00	2.07	159.33	5,198.32	-87.93	33.18	477,848.59	718,951.43	32.312369	-103.758410
5,300.00	2.07	159.33	5,298.26	-91.32	34.46	477,845.20	718,952.71	32.312360	-103.758406

# Planning Report - Geographic

<b>Database:</b>	EDM r5000.141_Prod US	<b>Local Co-ordinate Reference:</b>	Well Aleutian 10-3 Fed Com 334H
<b>Company:</b>	WCDSC Permian NM	<b>TVD Reference:</b>	RKB @ 3446.10ft
<b>Project:</b>	Eddy County (NAD 83 NM Eastern)	<b>MD Reference:</b>	RKB @ 3446.10ft
<b>Site:</b>	Sec 10-T23S-R31E	<b>North Reference:</b>	Grid
<b>Well:</b>	Aleutian 10-3 Fed Com 334H	<b>Survey Calculation Method:</b>	Minimum Curvature
<b>Wellbore:</b>	Wellbore #1		
<b>Design:</b>	Permit Plan 1		

Planned Survey									
Measured Depth (ft)	Inclination (°)	Azimuth (°)	Vertical Depth (ft)	+N/-S (ft)	+E/-W (ft)	Map Northing (usft)	Map Easting (usft)	Latitude	Longitude
5,400.00	2.07	159.33	5,398.19	-94.71	35.74	477,841.81	718,953.98	32.312351	-103.758402
5,500.00	2.07	159.33	5,498.12	-98.09	37.02	477,838.43	718,955.26	32.312341	-103.758398
5,600.00	2.07	159.33	5,598.06	-101.48	38.29	477,835.04	718,956.54	32.312332	-103.758394
5,700.00	2.07	159.33	5,697.99	-104.87	39.57	477,831.65	718,957.82	32.312323	-103.758389
5,800.00	2.07	159.33	5,797.93	-108.26	40.85	477,828.27	718,959.10	32.312313	-103.758385
5,900.00	2.07	159.33	5,897.86	-111.64	42.13	477,824.88	718,960.38	32.312304	-103.758381
6,000.00	2.07	159.33	5,997.80	-115.03	43.41	477,821.49	718,961.65	32.312295	-103.758377
6,100.00	2.07	159.33	6,097.73	-118.42	44.69	477,818.10	718,962.93	32.312285	-103.758373
6,200.00	2.07	159.33	6,197.67	-121.80	45.96	477,814.72	718,964.21	32.312276	-103.758369
6,300.00	2.07	159.33	6,297.60	-125.19	47.24	477,811.33	718,965.49	32.312267	-103.758365
6,400.00	2.07	159.33	6,397.53	-128.58	48.52	477,807.94	718,966.77	32.312257	-103.758361
6,500.00	2.07	159.33	6,497.47	-131.96	49.80	477,804.56	718,968.04	32.312248	-103.758357
6,600.00	2.07	159.33	6,597.40	-135.35	51.08	477,801.17	718,969.32	32.312239	-103.758353
6,700.00	2.07	159.33	6,697.34	-138.74	52.35	477,797.78	718,970.60	32.312229	-103.758349
6,800.00	2.07	159.33	6,797.27	-142.12	53.63	477,794.40	718,971.88	32.312220	-103.758345
6,900.00	2.07	159.33	6,897.21	-145.51	54.91	477,791.01	718,973.16	32.312211	-103.758341
7,000.00	2.07	159.33	6,997.14	-148.90	56.19	477,787.62	718,974.43	32.312201	-103.758336
7,100.00	2.07	159.33	7,097.08	-152.29	57.47	477,784.24	718,975.71	32.312192	-103.758332
7,200.00	2.07	159.33	7,197.01	-155.67	58.74	477,780.85	718,976.99	32.312183	-103.758328
7,300.00	2.07	159.33	7,296.94	-159.06	60.02	477,777.46	718,978.27	32.312173	-103.758324
7,400.00	2.07	159.33	7,396.88	-162.45	61.30	477,774.07	718,979.55	32.312164	-103.758320
7,500.00	2.07	159.33	7,496.81	-165.83	62.58	477,770.69	718,980.82	32.312155	-103.758316
7,600.00	2.07	159.33	7,596.75	-169.22	63.86	477,767.30	718,982.10	32.312145	-103.758312
7,700.00	2.07	159.33	7,696.68	-172.61	65.13	477,763.91	718,983.38	32.312136	-103.758308
7,800.00	2.07	159.33	7,796.62	-175.99	66.41	477,760.53	718,984.66	32.312127	-103.758304
7,900.00	2.07	159.33	7,896.55	-179.38	67.69	477,757.14	718,985.94	32.312117	-103.758300
8,000.00	2.07	159.33	7,996.49	-182.77	68.97	477,753.75	718,987.21	32.312108	-103.758296
8,100.00	2.07	159.33	8,096.42	-186.15	70.25	477,750.37	718,988.49	32.312099	-103.758292
8,200.00	2.07	159.33	8,196.35	-189.54	71.53	477,746.98	718,989.77	32.312089	-103.758287
8,300.00	2.07	159.33	8,296.29	-192.93	72.80	477,743.59	718,991.05	32.312080	-103.758283
8,400.00	2.07	159.33	8,396.22	-196.32	74.08	477,740.21	718,992.33	32.312071	-103.758279
8,500.00	2.07	159.33	8,496.16	-199.70	75.36	477,736.82	718,993.61	32.312061	-103.758275
8,600.00	2.07	159.33	8,596.09	-203.09	76.64	477,733.43	718,994.88	32.312052	-103.758271
8,700.00	2.07	159.33	8,696.03	-206.48	77.92	477,730.05	718,996.16	32.312043	-103.758267
8,800.00	2.07	159.33	8,795.96	-209.86	79.19	477,726.66	718,997.44	32.312033	-103.758263
8,900.00	2.07	159.33	8,895.90	-213.25	80.47	477,723.27	718,998.72	32.312024	-103.758259
9,000.00	2.07	159.33	8,995.83	-216.64	81.75	477,719.88	719,000.00	32.312015	-103.758255
9,100.00	2.07	159.33	9,095.76	-220.02	83.03	477,716.50	719,001.27	32.312005	-103.758251
9,200.00	2.07	159.33	9,195.70	-223.41	84.31	477,713.11	719,002.55	32.311996	-103.758247
9,300.00	2.07	159.33	9,295.63	-226.80	85.58	477,709.72	719,003.83	32.311987	-103.758243
9,400.00	2.07	159.33	9,395.57	-230.18	86.86	477,706.34	719,005.11	32.311977	-103.758239
9,500.00	2.07	159.33	9,495.50	-233.57	88.14	477,702.95	719,006.39	32.311968	-103.758234
9,600.00	2.07	159.33	9,595.44	-236.96	89.42	477,699.56	719,007.66	32.311959	-103.758230
9,700.00	2.07	159.33	9,695.37	-240.35	90.70	477,696.18	719,008.94	32.311949	-103.758226
9,800.00	2.07	159.33	9,795.31	-243.73	91.97	477,692.79	719,010.22	32.311940	-103.758222
9,900.00	2.07	159.33	9,895.24	-247.12	93.25	477,689.40	719,011.50	32.311931	-103.758218
10,000.00	2.07	159.33	9,995.18	-250.51	94.53	477,686.02	719,012.78	32.311921	-103.758214
10,100.00	2.07	159.33	10,095.11	-253.89	95.81	477,682.63	719,014.05	32.311912	-103.758210
10,200.00	2.07	159.33	10,195.04	-257.28	97.09	477,679.24	719,015.33	32.311903	-103.758206
10,300.00	2.07	159.33	10,294.98	-260.67	98.36	477,675.85	719,016.61	32.311893	-103.758202
10,358.79	2.07	159.33	10,353.72	-262.66	99.12	477,673.86	719,017.36	32.311888	-103.758199
10,400.00	1.46	159.33	10,394.92	-263.85	99.56	477,672.68	719,017.81	32.311885	-103.758198
10,497.09	0.00	0.00	10,492.00	-265.00	100.00	477,671.52	719,018.25	32.311881	-103.758197
10,500.00	0.00	0.00	10,494.91	-265.00	100.00	477,671.52	719,018.25	32.311881	-103.758197
10,600.00	0.00	0.00	10,594.91	-265.00	100.00	477,671.52	719,018.25	32.311881	-103.758197

# Planning Report - Geographic

<b>Database:</b>	EDM r5000.141_Prod US	<b>Local Co-ordinate Reference:</b>	Well Aleutian 10-3 Fed Com 334H
<b>Company:</b>	WCDCS Permian NM	<b>TVD Reference:</b>	RKB @ 3446.10ft
<b>Project:</b>	Eddy County (NAD 83 NM Eastern)	<b>MD Reference:</b>	RKB @ 3446.10ft
<b>Site:</b>	Sec 10-T23S-R31E	<b>North Reference:</b>	Grid
<b>Well:</b>	Aleutian 10-3 Fed Com 334H	<b>Survey Calculation Method:</b>	Minimum Curvature
<b>Wellbore:</b>	Wellbore #1		
<b>Design:</b>	Permit Plan 1		

Planned Survey									
Measured Depth (ft)	Inclination (°)	Azimuth (°)	Vertical Depth (ft)	+N/-S (ft)	+E/-W (ft)	Map Northing (usft)	Map Easting (usft)	Latitude	Longitude
10,700.00	0.00	0.00	10,694.91	-265.00	100.00	477,671.52	719,018.25	32.311881	-103.758197
10,800.00	0.00	0.00	10,794.91	-265.00	100.00	477,671.52	719,018.25	32.311881	-103.758197
10,847.00	0.00	0.00	10,841.91	-265.00	100.00	477,671.52	719,018.25	32.311881	-103.758197
<b>KOP @ 10847' MD, 50' FSL, 330' FEL</b>									
10,847.13	0.00	0.00	10,842.04	-265.00	100.00	477,671.52	719,018.25	32.311881	-103.758197
10,900.00	5.29	359.64	10,894.83	-262.56	99.98	477,673.96	719,018.23	32.311888	-103.758197
11,000.00	15.29	359.64	10,993.10	-244.73	99.87	477,691.79	719,018.12	32.311937	-103.758197
11,088.00	24.09	359.64	11,075.88	-215.11	99.68	477,721.41	719,017.93	32.312019	-103.758197
<b>FTP @ 11088' MD, 100' FSL, 330' FEL</b>									
11,100.00	25.29	359.64	11,086.78	-210.10	99.65	477,726.42	719,017.90	32.312032	-103.758197
11,200.00	35.29	359.64	11,173.02	-159.73	99.34	477,776.79	719,017.58	32.312171	-103.758197
11,300.00	45.29	359.64	11,249.21	-95.15	98.93	477,841.37	719,017.17	32.312348	-103.758197
11,400.00	55.29	359.64	11,313.02	-18.33	98.44	477,918.19	719,016.69	32.312560	-103.758197
11,500.00	65.29	359.64	11,362.52	68.41	97.89	478,004.93	719,016.14	32.312798	-103.758198
11,600.00	75.29	359.64	11,396.21	162.43	97.30	478,098.95	719,015.55	32.313056	-103.758198
11,700.00	85.29	359.64	11,413.06	260.87	96.68	478,197.39	719,014.93	32.313327	-103.758198
11,747.13	90.00	359.64	11,415.00	307.95	96.38	478,244.47	719,014.63	32.313456	-103.758198
11,800.00	90.00	359.64	11,415.00	360.81	96.05	478,297.33	719,014.29	32.313602	-103.758199
11,900.00	90.00	359.64	11,415.00	460.81	95.42	478,397.33	719,013.66	32.313877	-103.758199
12,000.00	90.00	359.64	11,415.00	560.81	94.79	478,497.33	719,013.03	32.314151	-103.758199
12,100.00	90.00	359.64	11,415.00	660.81	94.15	478,597.33	719,012.40	32.314426	-103.758199
12,200.00	90.00	359.64	11,415.00	760.81	93.52	478,697.33	719,011.77	32.314701	-103.758200
12,300.00	90.00	359.64	11,415.00	860.80	92.89	478,797.32	719,011.14	32.314976	-103.758200
12,400.00	90.00	359.64	11,415.00	960.80	92.26	478,897.32	719,010.51	32.315251	-103.758200
12,445.00	90.00	359.64	11,415.00	1,005.80	91.98	478,942.32	719,010.22	32.315375	-103.758201
<b>Cross NM077046 @ 12445' MD, 1321' FSL, 330' FEL</b>									
12,500.00	90.00	359.64	11,415.00	1,060.80	91.63	478,997.32	719,009.87	32.315526	-103.758201
12,600.00	90.00	359.64	11,415.00	1,160.80	91.00	479,097.32	719,009.24	32.315801	-103.758201
12,700.00	90.00	359.64	11,415.00	1,260.80	90.37	479,197.31	719,008.61	32.316076	-103.758201
12,800.00	90.00	359.64	11,415.00	1,360.79	89.73	479,297.31	719,007.98	32.316351	-103.758202
12,900.00	90.00	359.64	11,415.00	1,460.79	89.10	479,397.31	719,007.35	32.316625	-103.758202
13,000.00	90.00	359.64	11,415.00	1,560.79	88.47	479,497.31	719,006.72	32.316900	-103.758202
13,100.00	90.00	359.64	11,415.00	1,660.79	87.84	479,597.31	719,006.09	32.317175	-103.758203
13,200.00	90.00	359.64	11,415.00	1,760.79	87.21	479,697.30	719,005.45	32.317450	-103.758203
13,300.00	90.00	359.64	11,415.00	1,860.78	86.58	479,797.30	719,004.82	32.317725	-103.758203
13,400.00	90.00	359.64	11,415.00	1,960.78	85.94	479,897.30	719,004.19	32.318000	-103.758203
13,500.00	90.00	359.64	11,415.00	2,060.78	85.31	479,997.30	719,003.56	32.318275	-103.758204
13,600.00	90.00	359.64	11,415.00	2,160.78	84.68	480,097.29	719,002.93	32.318550	-103.758204
13,700.00	90.00	359.64	11,415.00	2,260.78	84.05	480,197.29	719,002.30	32.318824	-103.758204
13,766.00	90.00	359.64	11,415.00	2,326.77	83.63	480,263.29	719,001.88	32.319006	-103.758205
<b>Cross NM121955 @ 13766' MD, 2641' FNL, 330' FEL</b>									
13,800.00	90.00	359.64	11,415.00	2,360.77	83.42	480,297.29	719,001.67	32.319099	-103.758205
13,900.00	90.00	359.64	11,415.00	2,460.77	82.79	480,397.29	719,001.03	32.319374	-103.758205
14,000.00	90.00	359.64	11,415.00	2,560.77	82.16	480,497.29	719,000.40	32.319649	-103.758205
14,100.00	90.00	359.64	11,415.00	2,660.77	81.52	480,597.28	718,999.77	32.319924	-103.758206
14,200.00	90.00	359.64	11,415.00	2,760.77	80.89	480,697.28	718,999.14	32.320199	-103.758206
14,300.00	90.00	359.64	11,415.00	2,860.76	80.26	480,797.28	718,998.51	32.320474	-103.758206
14,400.00	90.00	359.64	11,415.00	2,960.76	79.63	480,897.28	718,997.88	32.320749	-103.758207
14,500.00	90.00	359.64	11,415.00	3,060.76	79.00	480,997.27	718,997.24	32.321023	-103.758207
14,600.00	90.00	359.64	11,415.00	3,160.76	78.37	481,097.27	718,996.61	32.321298	-103.758207
14,700.00	90.00	359.64	11,415.00	3,260.76	77.74	481,197.27	718,995.98	32.321573	-103.758207
14,800.00	90.00	359.64	11,415.00	3,360.75	77.10	481,297.27	718,995.35	32.321848	-103.758208
14,900.00	90.00	359.64	11,415.00	3,460.75	76.47	481,397.27	718,994.72	32.322123	-103.758208
15,000.00	90.00	359.64	11,415.00	3,560.75	75.84	481,497.26	718,994.09	32.322398	-103.758208

# Planning Report - Geographic

<b>Database:</b>	EDM r5000.141_Prod US	<b>Local Co-ordinate Reference:</b>	Well Aleutian 10-3 Fed Com 334H
<b>Company:</b>	WCDSC Permian NM	<b>TVD Reference:</b>	RKB @ 3446.10ft
<b>Project:</b>	Eddy County (NAD 83 NM Eastern)	<b>MD Reference:</b>	RKB @ 3446.10ft
<b>Site:</b>	Sec 10-T23S-R31E	<b>North Reference:</b>	Grid
<b>Well:</b>	Aleutian 10-3 Fed Com 334H	<b>Survey Calculation Method:</b>	Minimum Curvature
<b>Wellbore:</b>	Wellbore #1		
<b>Design:</b>	Permit Plan 1		

Planned Survey									
Measured Depth (ft)	Inclination (°)	Azimuth (°)	Vertical Depth (ft)	+N/-S (ft)	+E/-W (ft)	Map Northing (usft)	Map Easting (usft)	Latitude	Longitude
15,100.00	90.00	359.64	11,415.00	3,660.75	75.21	481,597.26	718,993.46	32.322673	-103.758209
15,200.00	90.00	359.64	11,415.00	3,760.75	74.58	481,697.26	718,992.82	32.322948	-103.758209
15,300.00	90.00	359.64	11,415.00	3,860.74	73.95	481,797.26	718,992.19	32.323222	-103.758209
15,400.00	90.00	359.64	11,415.00	3,960.74	73.32	481,897.26	718,991.56	32.323497	-103.758210
15,500.00	90.00	359.64	11,415.00	4,060.74	72.68	481,997.25	718,990.93	32.323772	-103.758210
15,600.00	90.00	359.64	11,415.00	4,160.74	72.05	482,097.25	718,990.30	32.324047	-103.758210
15,700.00	90.00	359.64	11,415.00	4,260.74	71.42	482,197.25	718,989.67	32.324322	-103.758211
15,800.00	90.00	359.64	11,415.00	4,360.73	70.79	482,297.25	718,989.04	32.324597	-103.758211
15,900.00	90.00	359.64	11,415.00	4,460.73	70.16	482,397.24	718,988.40	32.324872	-103.758211
16,000.00	90.00	359.64	11,415.00	4,560.73	69.53	482,497.24	718,987.77	32.325147	-103.758211
16,100.00	90.00	359.64	11,415.00	4,660.73	68.90	482,597.24	718,987.14	32.325421	-103.758212
16,200.00	90.00	359.64	11,415.00	4,760.73	68.26	482,697.24	718,986.51	32.325696	-103.758212
16,300.00	90.00	359.64	11,415.00	4,860.72	67.63	482,797.24	718,985.88	32.325971	-103.758212
16,400.00	90.00	359.64	11,415.00	4,960.72	67.00	482,897.23	718,985.25	32.326246	-103.758213
16,407.00	90.00	359.64	11,415.00	4,967.72	66.96	482,904.23	718,985.20	32.326265	-103.758213
Cross section @ 16407' MD, 0' FSL, 330' FEL									
16,500.00	90.00	359.64	11,415.00	5,060.72	66.37	482,997.23	718,984.62	32.326521	-103.758213
16,600.00	90.00	359.64	11,415.00	5,160.72	65.74	483,097.23	718,983.98	32.326796	-103.758213
16,700.00	90.00	359.64	11,415.00	5,260.72	65.11	483,197.23	718,983.35	32.327071	-103.758214
16,800.00	90.00	359.64	11,415.00	5,360.71	64.48	483,297.22	718,982.72	32.327346	-103.758214
16,900.00	90.00	359.64	11,415.00	5,460.71	63.84	483,397.22	718,982.09	32.327620	-103.758214
17,000.00	90.00	359.64	11,415.00	5,560.71	63.21	483,497.22	718,981.46	32.327895	-103.758215
17,100.00	90.00	359.64	11,415.00	5,660.71	62.58	483,597.22	718,980.83	32.328170	-103.758215
17,200.00	90.00	359.64	11,415.00	5,760.71	61.95	483,697.22	718,980.20	32.328445	-103.758215
17,300.00	90.00	359.64	11,415.00	5,860.70	61.32	483,797.21	718,979.56	32.328720	-103.758215
17,400.00	90.00	359.64	11,415.00	5,960.70	60.69	483,897.21	718,978.93	32.328995	-103.758216
17,500.00	90.00	359.64	11,415.00	6,060.70	60.06	483,997.21	718,978.30	32.329270	-103.758216
17,600.00	90.00	359.64	11,415.00	6,160.70	59.42	484,097.21	718,977.67	32.329545	-103.758216
17,700.00	90.00	359.64	11,415.00	6,260.70	58.79	484,197.20	718,977.04	32.329819	-103.758217
17,800.00	90.00	359.64	11,415.00	6,360.69	58.16	484,297.20	718,976.41	32.330094	-103.758217
17,900.00	90.00	359.64	11,415.00	6,460.69	57.53	484,397.20	718,975.78	32.330369	-103.758217
18,000.00	90.00	359.64	11,415.00	6,560.69	56.90	484,497.20	718,975.14	32.330644	-103.758218
18,100.00	90.00	359.64	11,415.00	6,660.69	56.27	484,597.20	718,974.51	32.330919	-103.758218
18,200.00	90.00	359.64	11,415.00	6,760.69	55.64	484,697.19	718,973.88	32.331194	-103.758218
18,300.00	90.00	359.64	11,415.00	6,860.68	55.00	484,797.19	718,973.25	32.331469	-103.758218
18,400.00	90.00	359.64	11,415.00	6,960.68	54.37	484,897.19	718,972.62	32.331744	-103.758219
18,500.00	90.00	359.64	11,415.00	7,060.68	53.74	484,997.19	718,971.99	32.332018	-103.758219
18,600.00	90.00	359.64	11,415.00	7,160.68	53.11	485,097.18	718,971.36	32.332293	-103.758219
18,700.00	90.00	359.64	11,415.00	7,260.68	52.48	485,197.18	718,970.72	32.332568	-103.758220
18,800.00	90.00	359.64	11,415.00	7,360.67	51.85	485,297.18	718,970.09	32.332843	-103.758220
18,900.00	90.00	359.64	11,415.00	7,460.67	51.22	485,397.18	718,969.46	32.333118	-103.758220
19,000.00	90.00	359.64	11,415.00	7,560.67	50.58	485,497.18	718,968.83	32.333393	-103.758221
19,100.00	90.00	359.64	11,415.00	7,660.67	49.95	485,597.17	718,968.20	32.333668	-103.758221
19,200.00	90.00	359.64	11,415.00	7,760.67	49.32	485,697.17	718,967.57	32.333943	-103.758221
19,300.00	90.00	359.64	11,415.00	7,860.66	48.69	485,797.17	718,966.94	32.334217	-103.758222
19,400.00	90.00	359.64	11,415.00	7,960.66	48.06	485,897.17	718,966.30	32.334492	-103.758222
19,500.00	90.00	359.64	11,415.00	8,060.66	47.43	485,997.17	718,965.67	32.334767	-103.758222
19,600.00	90.00	359.64	11,415.00	8,160.66	46.79	486,097.16	718,965.04	32.335042	-103.758222
19,700.00	90.00	359.64	11,415.00	8,260.66	46.16	486,197.16	718,964.41	32.335317	-103.758223
19,800.00	90.00	359.64	11,415.00	8,360.65	45.53	486,297.16	718,963.78	32.335592	-103.758223
19,900.00	90.00	359.64	11,415.00	8,460.65	44.90	486,397.16	718,963.15	32.335867	-103.758223
20,000.00	90.00	359.64	11,415.00	8,560.65	44.27	486,497.15	718,962.52	32.336142	-103.758224
20,100.00	90.00	359.64	11,415.00	8,660.65	43.64	486,597.15	718,961.88	32.336416	-103.758224
20,200.00	90.00	359.64	11,415.00	8,760.65	43.01	486,697.15	718,961.25	32.336691	-103.758224

# Planning Report - Geographic

<b>Database:</b>	EDM r5000.141_Prod US	<b>Local Co-ordinate Reference:</b>	Well Aleutian 10-3 Fed Com 334H
<b>Company:</b>	WCDSC Permian NM	<b>TVD Reference:</b>	RKB @ 3446.10ft
<b>Project:</b>	Eddy County (NAD 83 NM Eastern)	<b>MD Reference:</b>	RKB @ 3446.10ft
<b>Site:</b>	Sec 10-T23S-R31E	<b>North Reference:</b>	Grid
<b>Well:</b>	Aleutian 10-3 Fed Com 334H	<b>Survey Calculation Method:</b>	Minimum Curvature
<b>Wellbore:</b>	Wellbore #1		
<b>Design:</b>	Permit Plan 1		

Planned Survey									
Measured Depth (ft)	Inclination (°)	Azimuth (°)	Vertical Depth (ft)	+N/-S (ft)	+E/-W (ft)	Map Northing (usft)	Map Easting (usft)	Latitude	Longitude
20,300.00	90.00	359.64	11,415.00	8,860.64	42.37	486,797.15	718,960.62	32.336966	-103.758225
20,400.00	90.00	359.64	11,415.00	8,960.64	41.74	486,897.15	718,959.99	32.337241	-103.758225
20,500.00	90.00	359.64	11,415.00	9,060.64	41.11	486,997.14	718,959.36	32.337516	-103.758225
20,600.00	90.00	359.64	11,415.00	9,160.64	40.48	487,097.14	718,958.73	32.337791	-103.758226
20,700.00	90.00	359.64	11,415.00	9,260.64	39.85	487,197.14	718,958.09	32.338066	-103.758226
20,800.00	90.00	359.64	11,415.00	9,360.63	39.22	487,297.14	718,957.46	32.338341	-103.758226
20,900.00	90.00	359.64	11,415.00	9,460.63	38.59	487,397.13	718,956.83	32.338615	-103.758226
21,000.00	90.00	359.64	11,415.00	9,560.63	37.95	487,497.13	718,956.20	32.338890	-103.758227
21,100.00	90.00	359.64	11,415.00	9,660.63	37.32	487,597.13	718,955.57	32.339165	-103.758227
21,200.00	90.00	359.64	11,415.00	9,760.63	36.69	487,697.13	718,954.94	32.339440	-103.758227
21,300.00	90.00	359.64	11,415.00	9,860.62	36.06	487,797.13	718,954.31	32.339715	-103.758228
21,400.00	90.00	359.64	11,415.00	9,960.62	35.43	487,897.12	718,953.67	32.339990	-103.758228
21,500.00	90.00	359.64	11,415.00	10,060.62	34.80	487,997.12	718,953.04	32.340265	-103.758228
21,572.00	90.00	359.64	11,415.00	10,132.62	34.34	488,069.12	718,952.59	32.340463	-103.758229
LTP @ 21572' MD, 100' FNL, 330' FEL									
21,600.00	90.00	359.64	11,415.00	10,160.62	34.17	488,097.12	718,952.41	32.340540	-103.758229
21,651.57	90.00	359.64	11,415.00	10,212.19	33.84	488,148.69	718,952.09	32.340681	-103.758229
PBHL; 20' FNL, 330' FEL									
21,651.58	90.00	359.64	11,415.00	10,212.20	33.84	488,148.70	718,952.09	32.340681	-103.758229

Design Targets									
Target Name	Dip Angle (°)	Dip Dir. (°)	TVD (ft)	+N/-S (ft)	+E/-W (ft)	Northing (usft)	Easting (usft)	Latitude	Longitude
- hit/miss target									
- Shape									
PBHL - Aleutian 10-3 Fe	0.00	0.00	0.00	10,212.20	33.84	488,148.70	718,952.09	32.340681	-103.758229
- plan misses target center by 10212.26ft at 0.00ft MD (0.00 TVD, 0.00 N, 0.00 E)									
- Point									

Plan Annotations					
Measured Depth (ft)	Vertical Depth (ft)	Local Coordinates			
		+N/-S (ft)	+E/-W (ft)	Comment	
10,847.00	10,841.91	-265.00	100.00	KOP @ 10847' MD, 50' FSL, 330' FEL	
11,088.00	11,075.88	-215.11	99.68	FTP @ 11088' MD, 100' FSL, 330' FEL	
12,445.00	11,415.00	1,005.80	91.98	Cross NM077046 @ 12445' MD, 1321' FSL, 330' FEL	
13,766.00	11,415.00	2,326.77	83.63	Cross NM121955 @ 13766' MD, 2641' FNL, 330' FEL	
16,407.00	11,415.00	4,967.72	66.96	Cross section @ 16407' MD, 0' FSL, 330' FEL	
21,572.00	11,415.00	10,132.62	34.34	LTP @ 21572' MD, 100' FNL, 330' FEL	
21,651.57	11,415.00	10,212.19	33.84	PBHL; 20' FNL, 330' FEL	

# PECOS DISTRICT

## DRILLING CONDITIONS OF APPROVAL

<b>OPERATOR'S NAME:</b>	<b>Devon Energy Production Company LP</b>
<b>LEASE NO.:</b>	<b>NMNM0405444</b>
<b>WELL NAME &amp; NO.:</b>	<b>Aleutian 10-3 Fed Com 334H</b>
<b>SURFACE HOLE FOOTAGE:</b>	<b>315'/S &amp; 430'/E</b>
<b>BOTTOM HOLE FOOTAGE:</b>	<b>20'/N &amp; 330'/E</b>
<b>LOCATION:</b>	<b>Section 10, T.23 S., R.31 E., NMPM</b>
<b>COUNTY:</b>	<b>Eddy County, New Mexico</b>

COA

H2S	<input checked="" type="checkbox"/> Yes	<input type="checkbox"/> No	
Potash	<input type="checkbox"/> None	<input type="checkbox"/> Secretary	<input checked="" type="checkbox"/> R-111-P
Cave/Karst Potential	<input type="checkbox"/> Low	<input type="checkbox"/> Medium	<input type="checkbox"/> High
Cave/Karst Potential	<input type="checkbox"/> Critical		
Variance	<input type="checkbox"/> None	<input checked="" type="checkbox"/> Flex Hose	<input type="checkbox"/> Other
Wellhead	<input type="checkbox"/> Conventional	<input checked="" type="checkbox"/> Multibowl	<input type="checkbox"/> Both
Other	<input checked="" type="checkbox"/> 4 String Area	<input type="checkbox"/> Capitan Reef	<input type="checkbox"/> WIPP
Other	<input checked="" type="checkbox"/> Fluid Filled	<input checked="" type="checkbox"/> Cement Squeeze	<input type="checkbox"/> Pilot Hole
Special Requirements	<input type="checkbox"/> Water Disposal	<input checked="" type="checkbox"/> COM	<input type="checkbox"/> Unit

**OPERATOR IS ONLY APPROVED FOR THE FOLLOWING DESIGN, OTHER DESIGNS SUBMITTED WILL BE VOID.**

### A. HYDROGEN SULFIDE

A Hydrogen Sulfide (H2S) Drilling Plan shall be activated 500 feet prior to drilling into the **Salado** formation. As a result, the Hydrogen Sulfide area must meet Onshore Order 6 requirements, which includes equipment and personnel/public protection items. If Hydrogen Sulfide is encountered, please provide measured values and formations to the BLM.

### B. CASING

#### Alternate Casing Design:

1. The **13-3/8** inch surface casing shall be set at approximately **725 feet** (a minimum of **70 feet (Eddy County)** into the Rustler Anhydrite and above the salt) and cemented to the surface.
  - a. If cement does not circulate to the surface, the appropriate BLM office shall be notified and a temperature survey utilizing an electronic type temperature



survey with surface log readout will be used or a cement bond log shall be run to verify the top of the cement. Temperature survey will be run a minimum of six hours after pumping cement and ideally between 8-10 hours after completing the cement job.

- b. Wait on cement (WOC) time for a primary cement job will be a minimum of **24 hours in the Potash Area** or 500 pounds compressive strength, whichever is greater. (This is to include the lead cement)
  - c. Wait on cement (WOC) time for a remedial job will be a minimum of 4 hours after bringing cement to surface or 500 pounds compressive strength, whichever is greater.
  - d. If cement falls back, remedial cementing will be done prior to drilling out that string.
2. The minimum required fill of cement behind the **10-3/4** inch intermediate casing shall be set at approximately **4350 feet** is:
    - Cement to surface. If cement does not circulate see B.1.a, c-d above.  
**Wait on cement (WOC) time for a primary cement job is to include the lead cement slurry due to cave/karst or potash.**  
**Cement excess is less than 25%, more cement might be required.**

- ❖ In R111 Potash Areas if cement does not circulate to surface on the first two salt protection casing strings, the cement on the 3rd casing string must come to surface.

**Intermediate casing must be kept fluid filled to meet BLM minimum collapse requirement.**

3. The minimum required fill of cement behind the **8-5/8** inch intermediate casing is:
  - Cement to surface. If cement does not circulate see B.1.a, c-d above.  
**Wait on cement (WOC) time for a primary cement job is to include the lead cement slurry due to cave/karst or potash.**  
**Cement excess is less than 25%, more cement might be required.**

**Operator has proposed to pump down 10-3/4" X 8-5/8" annulus. Operator must run a CBL from TD of the 8-5/8" casing to surface. Submit results to BLM.**

4. The minimum required fill of cement behind the **5-1/2** inch production casing is:
  - Cement should tie-back at least **500 feet** into previous casing string.  
Operator shall provide method of verification.

### C. PRESSURE CONTROL

1. Variance approved to use flex line from BOP to choke manifold. Manufacturer's specification to be readily available. No external damage to flex line. Flex line to be installed as straight as possible (no hard bends).'
2. Operator has proposed a multi-bowl wellhead assembly. This assembly will only be tested when installed on the surface casing. Minimum working pressure of the blowout preventer (BOP) and related equipment (BOPE) required for drilling below the surface casing shoe shall be **5000 (5M)** psi.
  - a. Wellhead shall be installed by manufacturer's representatives, submit documentation with subsequent sundry.
  - b. If the welding is performed by a third party, the manufacturer's representative shall monitor the temperature to verify that it does not exceed the maximum temperature of the seal.
  - c. Manufacturer representative shall install the test plug for the initial BOP test.
  - d. If the cement does not circulate and one inch operations would have been possible with a standard wellhead, the well head shall be cut off, cementing operations performed and another wellhead installed.
  - e. Whenever any seal subject to test pressure is broken, all the tests in OOGO2.III.A.2.i must be followed.

### D. SPECIAL REQUIREMENT (S)

#### **Communitization Agreement**

- The operator will submit a Communitization Agreement to the Santa Fe Office, 301 Dinosaur Trail Santa Fe, New Mexico 87508, at least 90 days before the anticipated date of first production from a well subject to a spacing order issued by the New Mexico Oil Conservation Division. The Communitization Agreement will include the signatures of all working interest owners in all Federal and Indian leases subject to the Communitization Agreement (i.e., operating rights owners and lessees of record), or certification that the operator has obtained the written signatures of all such owners and will make those signatures available to the BLM immediately upon request.
- If the operator does not comply with this condition of approval, the BLM may take enforcement actions that include, but are not limited to, those specified in 43 CFR 3163.1.
- In addition, the well sign shall include the surface and bottom hole lease numbers. When the Communitization Agreement number is known, it shall also be on the sign.



## GENERAL REQUIREMENTS

The BLM is to be notified in advance for a representative to witness:

- a. Spudding well (minimum of 24 hours)
- b. Setting and/or Cementing of all casing strings (minimum of 4 hours)
- c. BOPE tests (minimum of 4 hours)

☒ Eddy County

Call the Carlsbad Field Office, 620 East Greene St., Carlsbad, NM 88220,  
(575) 361-2822

☒ Lea County

Call the Hobbs Field Station, 414 West Taylor, Hobbs NM 88240, (575)  
393-3612

1. Unless the production casing has been run and cemented or the well has been properly plugged, the drilling rig shall not be removed from over the hole without prior approval.
  - a. In the event the operator has proposed to drill multiple wells utilizing a skid/walking rig. Operator shall secure the wellbore on the current well, after installing and testing the wellhead, by installing a blind flange of like pressure rating to the wellhead and a pressure gauge that can be monitored while drilling is performed on the other well(s).
  - b. When the operator proposes to set surface casing with Spudder Rig
    - Notify the BLM when moving in and removing the Spudder Rig.
    - Notify the BLM when moving in the 2<sup>nd</sup> Rig. Rig to be moved in within 90 days of notification that Spudder Rig has left the location.
    - BOP/BOPE test to be conducted per Onshore Oil and Gas Order No. 2 as soon as 2nd Rig is rigged up on well.
2. Floor controls are required for 3M or Greater systems. These controls will be on the rig floor, unobstructed, readily accessible to the driller and will be operational at all times during drilling and/or completion activities. Rig floor is defined as the area immediately around the rotary table; the area immediately above the substructure on which the draw works are located, this does not include the dog house or stairway area.
3. The record of the drilling rate along with the GR/N well log run from TD to surface (horizontal well – vertical portion of hole) shall be submitted to the BLM office as well as all other logs run on the borehole 30 days from completion. If available, a digital copy of the logs is to be submitted in addition to the paper copies. The Rustler top and top and bottom of Salt are to be recorded on the Completion Report.

A. CASING

1. Changes to the approved APD casing program need prior approval if the items substituted are of lesser grade or different casing size or are Non-API. The Operator can exchange the components of the proposal with that of superior strength (i.e. changing from J-55 to N-80, or from 36# to 40#). Changes to the approved cement program need prior approval if the altered cement plan has less volume or strength or if the changes are substantial (i.e. Multistage tool, ECP, etc.). The initial wellhead installed on the well will remain on the well with spools used as needed.
2. Wait on cement (WOC) for Potash Areas: After cementing but before commencing any tests, the casing string shall stand cemented under pressure until both of the following conditions have been met: 1) cement reaches a minimum compressive strength of 500 psi for all cement blends, 2) until cement has been in place at least 24 hours. WOC time will be recorded in the driller's log. The casing integrity test can be done (prior to the cement setting up) immediately after bumping the plug.
3. Wait on cement (WOC) for Water Basin: After cementing but before commencing any tests, the casing string shall stand cemented under pressure until both of the following conditions have been met: 1) cement reaches a minimum compressive strength of 500 psi at the shoe, 2) until cement has been in place at least 8 hours. WOC time will be recorded in the driller's log. See individual casing strings for details regarding lead cement slurry requirements. The casing integrity test can be done (prior to the cement setting up) immediately after bumping the plug.
4. Provide compressive strengths including hours to reach required 500 pounds compressive strength prior to cementing each casing string. Have well specific cement details onsite prior to pumping the cement for each casing string.
5. No pea gravel permitted for remedial or fall back remedial without prior authorization from the BLM engineer.
6. On that portion of any well approved for a 5M BOPE system or greater, a pressure integrity test of each casing shoe shall be performed. Formation at the shoe shall be tested to a minimum of the mud weight equivalent anticipated to control the formation pressure to the next casing depth or at total depth of the well. This test shall be performed before drilling more than 20 feet of new hole.
7. If hardband drill pipe is rotated inside casing, returns will be monitored for metal. If metal is found in samples, drill pipe will be pulled and rubber protectors which have a larger diameter than the tool joints of the drill pipe will be installed prior to continuing drilling operations.
8. Whenever a casing string is cemented in the R-111-P potash area, the NMOCD requirements shall be followed.

B. PRESSURE CONTROL

1. All blowout preventer (BOP) and related equipment (BOPE) shall comply with well control requirements as described in Onshore Oil and Gas Order No. 2 and API RP 53 Sec. 17.
2. If a variance is approved for a flexible hose to be installed from the BOP to the choke manifold, the following requirements apply: The flex line must meet the requirements of API 16C. Check condition of flexible line from BOP to choke manifold, replace if exterior is damaged or if line fails test. Line to be as straight as possible with no hard bends and is to be anchored according to Manufacturer's requirements. The flexible hose can be exchanged with a hose of equal size and equal or greater pressure rating. Anchor requirements, specification sheet and hydrostatic pressure test certification matching the hose in service, to be onsite for review. These documents shall be posted in the company man's trailer and on the rig floor.
3. 5M or higher system requires an HCR valve, remote kill line and annular to match. The remote kill line is to be installed prior to testing the system and tested to stack pressure.
4. If the operator has proposed a multi-bowl wellhead assembly in the APD. The following requirements must be met:
  - a. Wellhead shall be installed by manufacturer's representatives, submit documentation with subsequent sundry.
  - b. If the welding is performed by a third party, the manufacturer's representative shall monitor the temperature to verify that it does not exceed the maximum temperature of the seal.
  - c. Manufacturer representative shall install the test plug for the initial BOP test.
  - d. Whenever any seal subject to test pressure is broken, all the tests in OOGO2.III.A.2.i must be followed.
  - e. If the cement does not circulate and one inch operations would have been possible with a standard wellhead, the well head shall be cut off, cementing operations performed and another wellhead installed.
5. The appropriate BLM office shall be notified a minimum of 4 hours in advance for a representative to witness the tests.
  - a. In a water basin, for all casing strings utilizing slips, these are to be set as soon as the crew and rig are ready and any fallback cement remediation has been done. The casing cut-off and BOP installation can be initiated four hours after installing the slips, which will be approximately six hours after bumping the plug. For those casing strings not using slips, the minimum wait time before cut-off is eight hours after bumping the plug. BOP/BOPE testing can begin after cut-off or once cement reaches 500 psi compressive strength (including lead when specified), whichever is greater. However, if the float does not

hold, cut-off cannot be initiated until cement reaches 500 psi compressive strength (including lead when specified).

- b. In potash areas, for all casing strings utilizing slips, these are to be set as soon as the crew and rig are ready and any fallback cement remediation has been done. For all casing strings, casing cut-off and BOP installation can be initiated at twelve hours after bumping the plug. However, **no tests** shall commence until the cement has had a minimum of 24 hours setup time, except the casing pressure test can be initiated immediately after bumping the plug (only applies to single stage cement jobs).
- c. The tests shall be done by an independent service company utilizing a test plug not a cup or J-packer. The operator also has the option of utilizing an independent tester to test without a plug (i.e. against the casing) pursuant to Onshore Order 2 with the pressure not to exceed 70% of the burst rating for the casing. Any test against the casing must meet the WOC time for water basin (8 hours) or potash (24 hours) or 500 pounds compressive strength, whichever is greater, prior to initiating the test (see casing segment as lead cement may be critical item).
- d. The test shall be run on a 5000 psi chart for a 2-3M BOP/BOP, on a 10000 psi chart for a 5M BOP/BOPE and on a 15000 psi chart for a 10M BOP/BOPE. If a linear chart is used, it shall be a one hour chart. A circular chart shall have a maximum 2 hour clock. If a twelve hour or twenty-four hour chart is used, tester shall make a notation that it is run with a two hour clock.
- e. The results of the test shall be reported to the appropriate BLM office.
- f. All tests are required to be recorded on a calibrated test chart. A copy of the BOP/BOPE test chart and a copy of independent service company test will be submitted to the appropriate BLM office.
- g. The BOP/BOPE test shall include a low pressure test from 250 to 300 psi. The test will be held for a minimum of 10 minutes if test is done with a test plug and 30 minutes without a test plug. This test shall be performed prior to the test at full stack pressure.
- h. BOP/BOPE must be tested by an independent service company within 500 feet of the top of the Wolfcamp formation if the time between the setting of the intermediate casing and reaching this depth exceeds 20 days. This test does not exclude the test prior to drilling out the casing shoe as per Onshore Order No. 2.

C. DRILLING MUD

Mud system monitoring equipment, with derrick floor indicators and visual and audio alarms, shall be operating before drilling into the Wolfcamp formation, and shall be used until production casing is run and cemented.

**D. WASTE MATERIAL AND FLUIDS**

All waste (i.e. drilling fluids, trash, salts, chemicals, sewage, gray water, etc.) created as a result of drilling operations and completion operations shall be safely contained and disposed of properly at a waste disposal facility. No waste material or fluid shall be disposed of on the well location or surrounding area.

Porto-johns and trash containers will be on-location during fracturing operations or any other crew-intensive operations.



**Devon Energy Center  
333 West Sheridan Avenue  
Oklahoma City, Oklahoma 73102-5015**

# **Hydrogen Sulfide (H<sub>2</sub>S) Contingency Plan**

**For**

**Aleutian 10-3 Fed Com 334H**

**Sec-10 T-23S R-31E  
315 FSL & 430' FEL  
LAT. = 32.3126113' N (NAD83)  
LONG = 103.7585154' W**

**Eddy County NM**

## Aleutian 10-3 Fed Com 334H

This is an open drilling site. H<sub>2</sub>S monitoring equipment and emergency response equipment will be used within 500' of zones known to contain H<sub>2</sub>S, including warning signs, wind indicators and H<sub>2</sub>S monitor.

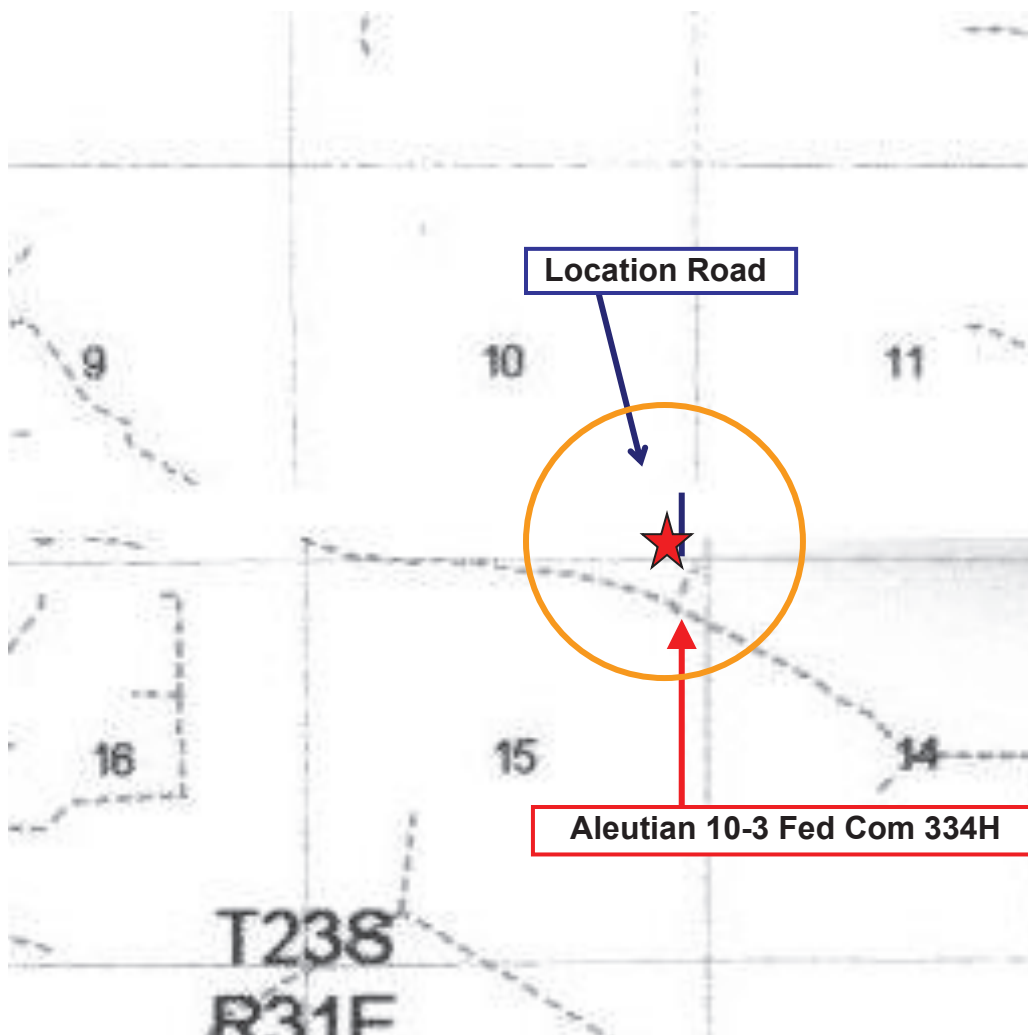
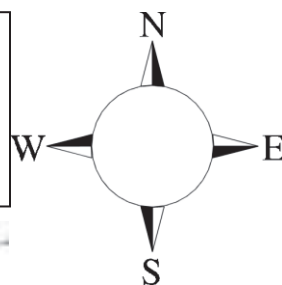

Assumed 100 ppm ROE = 3000' (Radius of Exposure)  
100 ppm H<sub>2</sub>S concentration shall trigger activation of this plan.

### Escape

Crews shall escape upwind of escaping gas in the event of an emergency release of gas. Escape can be facilitated from the location entrance road. Crews should then block the entrance to the location from the lease road so as not to allow anyone traversing into a hazardous area. The blockade should be at a safe distance outside of the ROE. There are no homes or buildings in or near the ROE.

**Assumed 100 ppm ROE = 3000'**

**100 ppm H<sub>2</sub>S concentration shall trigger activation of this plan.**

### **Emergency Procedures**

In the event of a release of gas containing H<sub>2</sub>S, the first responder(s) must

- Isolate the area and prevent entry by other persons into the 100 ppm ROE.
- Evacuate any public places encompassed by the 100 ppm ROE.
- Be equipped with H<sub>2</sub>S monitors and air packs in order to control the release.
- Use the “buddy system” to ensure no injuries occur during the response
- Take precautions to avoid personal injury during this operation.
- Contact operator and/or local officials to aid in operation. See list of phone numbers attached.
- Have received training in the
  - Detection of H<sub>2</sub>S, and
  - Measures for protection against the gas,
  - Equipment used for protection and emergency response.

### **Ignition of Gas Source**

Should control of the well be considered lost and ignition considered, take care to protect against exposure to Sulfur Dioxide (SO<sub>2</sub>). Intentional ignition must be coordinated with the NMOCD and local officials. Additionally the NM State Police may become involved. NM State Police shall be the Incident Command on scene of any major release. Take care to protect downwind whenever there is an ignition of the gas

### **Characteristics of H<sub>2</sub>S and SO<sub>2</sub>**

<b>Common Name</b>	<b>Chemical Formula</b>	<b>Specific Gravity</b>	<b>Threshold Limit</b>	<b>Hazardous Limit</b>	<b>Lethal Concentration</b>
<b>Hydrogen Sulfide</b>	H <sub>2</sub> S	1.189 Air = 1	10 ppm	100 ppm/hr	600 ppm
<b>Sulfur Dioxide</b>	SO <sub>2</sub>	2.21 Air = 1	2 ppm	N/A	1000 ppm

### **Contacting Authorities**

Devon Energy Corp. personnel must liaison with local and state agencies to ensure a proper response to a major release. Additionally, the OCD must be notified of the release as soon as possible but no later than 4 hours. Agencies will ask for information such as type and volume of release, wind direction, location of release, etc. Be prepared with all information available. The following call list of essential and potential responders has been prepared for use during a release. Devon Energy Corp. Company response must be in coordination with the State of New Mexico’s ‘Hazardous Materials Emergency Response Plan’ (HMER)



# **Hydrogen Sulfide Drilling Operation Plan**

## **I. HYDROGEN SULFIDE (H<sub>2</sub>S) TRAINING**

All personnel, whether regularly assigned, contracted, or employed on an unscheduled basis, will receive training from a qualified instructor in the following areas prior to commencing drilling operations on this well:

1. The hazards and characteristics of hydrogen sulfide (H<sub>2</sub>S)
2. The proper use and maintenance of personal protective equipment and life support systems.
3. The proper use of H<sub>2</sub>S detectors, alarms, warning systems, briefing areas, evacuation procedures, and prevailing winds.
4. The proper techniques for first aid and rescue procedures.

In addition, supervisory personnel will be trained in the following areas:

1. The effects of H<sub>2</sub>S metal components. If high tensile tubulars are to be used, personnel will be trained in their special maintenance requirements.
2. Corrective action and shut-in procedures when drilling or reworking a well and blowout prevention and well control procedures.
3. The contents and requirements of the H<sub>2</sub>S Drilling Operations Plan and Public Protection Plan.

There will be an initial training session just prior to encountering a known or probable H<sub>2</sub>S zone (within 3 days or 500 feet) and weekly H<sub>2</sub>S and well control drills for all personnel in each crew. The initial training session shall include a review of the site specific H<sub>2</sub>S Drilling Operations Plan and the Public Protection Plan.

## **II. HYDROGEN SULFIDE TRAINING**

Note: All H<sub>2</sub>S safety equipment and systems will be installed, tested, and operational when drilling reaches a depth of 500 feet above, or three days prior to penetrating the first zone containing or reasonably expected to contain H<sub>2</sub>S.

## **1. Well Control Equipment**

- A. Flare line
- B. Choke manifold – Remotely Operated
- C. Blind rams and pipe rams to accommodate all pipe sizes with properly sized closing unit
- D. Auxiliary equipment may include if applicable: annular preventer and rotating head.
- E. Mud/Gas Separator

## **2. Protective equipment for essential personnel:**

30-minute SCBA units located at briefing areas, as indicated on well site diagram, with escape units available in the top doghouse. As it may be difficult to communicate audibly while wearing these units, hand signals shall be utilized.

## **3. H<sub>2</sub>S detection and monitoring equipment:**

Portable H<sub>2</sub>S monitors positioned on location for best coverage and response. These units have warning lights which activate when H<sub>2</sub>S levels reach 10 ppm and audible sirens which activate at 15 ppm. Sensor locations:

- Bell nipple
- Possum Belly/Shale shaker
- Rig floor
- Choke manifold
- Cellar

### **Visual warning systems:**

- A. Wind direction indicators as shown on well site diagram
- B. Caution/ Danger signs shall be posted on roads providing direct access to locations. Signs will be painted a high visibility yellow with black lettering of sufficient size to be reasonable distance from the immediate location. Bilingual signs will be used when appropriate.

#### **4. Mud program:**

The mud program has been designed to minimize the volume of H<sub>2</sub>S circulated to surface. Proper mud weight, safe drilling practices and the use of H<sub>2</sub>S scavengers will minimize hazards when penetrating H<sub>2</sub>S bearing zones.

#### **5. Metallurgy:**

- A. All drill strings, casings, tubing, wellhead, blowout preventer, drilling spool, kill lines, choke manifold lines, and valves shall be H<sub>2</sub>S trim.
- B. All elastomers used for packing and seals shall be H<sub>2</sub>S trim.

#### **6. Communication:**

- A. Company personnel have/use cellular telephones in the field.
- B. Land line (telephone) communications at Office

#### **7. Well testing:**

- A. Drill stem testing will be performed with a minimum number of personnel in the immediate vicinity, which are necessary to safety and adequately conduct the test. The drill stem testing will be conducted during daylight hours and formation fluids will not be flowed to the surface. All drill-stem-testing operations conducted in an H<sub>2</sub>S environment will use the closed chamber method of testing.
- B. There will be no drill stem testing.

<b><u>Devon Energy Corp. Company Call List</u></b>		
Drilling Supervisor – Basin – Mark Kramer		405-823-4796
EHS Professional – Laura Wright		405-439-8129
<b><u>Agency Call List</u></b>		
<b><u>Lea County (575)</u></b>	<b>Hobbs</b>	
	Lea County Communication Authority	393-3981
	State Police	392-5588
	City Police	397-9265
	Sheriff's Office	393-2515
	<b>Ambulance</b>	<b>911</b>
	Fire Department	397-9308
	LEPC (Local Emergency Planning Committee)	393-2870
	NMOCD	393-6161
	US Bureau of Land Management	393-3612
<b><u>Eddy County (575)</u></b>	<b>Carlsbad</b>	
	State Police	885-3137
	City Police	885-2111
	Sheriff's Office	887-7551
	<b>Ambulance</b>	<b>911</b>
	Fire Department	885-3125
	LEPC (Local Emergency Planning Committee)	887-3798
	US Bureau of Land Management	887-6544
	NM Emergency Response Commission (Santa Fe)	(505) 476-9600
	24 HR	(505) 827-9126
	National Emergency Response Center	(800) 424-8802
	National Pollution Control Center: Direct	(703) 872-6000
	For Oil Spills	(800) 280-7118
	<b>Emergency Services</b>	
	Wild Well Control	(281) 784-4700
	Cudd Pressure Control	(915) 699-0139 (915) 563-3356
	Halliburton	(575) 746-2757
	B. J. Services	(575) 746-3569
<b><u>Give GPS position:</u></b>	Native Air – Emergency Helicopter – Hobbs (TX & NM)	(800) 642-7828
	Flight For Life - Lubbock, TX	(806) 743-9911
	Aerocare - Lubbock, TX	(806) 747-8923
	Med Flight Air Amb - Albuquerque, NM	(575) 842-4433
	Lifeguard Air Med Svc. Albuquerque, NM	(800) 222-1222
	Poison Control (24/7)	(575) 272-3115
	Oil & Gas Pipeline 24 Hour Service	(800) 364-4366
	NOAA – Website - <a href="http://www.nhc.noaa.gov">www.nhc.noaa.gov</a>	

Prepared in conjunction with  
Dave Small

