

UNITED STATES
DEPARTMENT OF THE INTERIOR
BUREAU OF LAND MANAGEMENT

SUNDRY NOTICES AND REPORTS ON WELLS

Do not use this form for proposals to drill or reenter an abandoned well. Use Form 3160-3 (APD) for such proposals.

FORM APPROVED
OMB No. 1004-0137
Expires March 31, 2007

5. Lease Serial No.
NM-107383

6. If Indian, Allottee or Tribe Name
Not Applicable

7. If Unit or CA/Agreement, Name and/o
Not Applicable

8. Well Name and No.
Marcel BMM Federal #1H

9. API Well No.
30-015-36845

10. Field and Pool, or Exploratory Area
Wildcat Wolfcamp

11. County or Parish, State
Eddy County, New Mexico

SUBMIT IN TRIPLICATE - Other instructions on page 2.

1. Type of Well
☒ Oil Well ☐ Gas Well ☐ Other (re-entry)

2. Name of Operator
Yates Petroleum Corporation 025575

3a. Address
105 South Fourth Street, Artesia, NM 88210

3b. Phone No. (include area code)
(575) 748-1471

4. Location of Well (Footage, Sec., T., R., M., or Survey Description)
1090' FNL and 200' FEL, Surface Hole
330' FNL and 330' FWL, Bottom Hole
Section 1, T16S-R29E

12. CHECK THE APPROPRIATE BOX(ES) TO INDICATE NATURE OF NOTICE, REPORT, OR OTHER DATA

TYPE OF SUBMISSION	TYPE OF ACTION			
<input type="checkbox"/> Notice of Intent	<input type="checkbox"/> Acidize	<input type="checkbox"/> Deepen	<input type="checkbox"/> Production (Start/Resume)	<input type="checkbox"/> Water Shut-Off
<input type="checkbox"/> Subsequent Report	<input type="checkbox"/> Alter Casing	<input type="checkbox"/> Fracture Treat	<input type="checkbox"/> Reclamation	<input type="checkbox"/> Well Integrity
<input type="checkbox"/> Final Abandonment Notice	<input type="checkbox"/> Casing Repair	<input type="checkbox"/> New Construction	<input type="checkbox"/> Recomplete	<input type="checkbox"/> Other
	<input checked="" type="checkbox"/> Change Plans	<input type="checkbox"/> Plug and Abandon	<input type="checkbox"/> Temporarily Abandon	
	<input type="checkbox"/> Convert to Injection	<input type="checkbox"/> Plug Back	<input type="checkbox"/> Water Disposal	

13 Describe Proposed or Completed Operation: Clearly state all pertinent details, including estimated starting date of any proposed work and approximate duration thereof. If the proposal is to deepen directionally or recomplete horizontally, give subsurface locations and measured and true vertical depths of all pertinent markers and zones. Attach the Bond under which the work will be performed or provide the Bond No. on file with BLM/BLA. Required subsequent reports must be filed within 30 days following completion of the involved operations. If the operation results in a multiple completion or recompletion in a new interval, a Form 3160-4 must be filed once testing has been completed. Final Abandonment Notices must be filed only after all requirements, including reclamation, have been completed, and the operator has determined that the site is ready for final inspection.)

Yates Petroleum Corporation wishes to change the Interim Reclamation Plan and Closed Loop Design Plan. Please see attached Exhibits.

J Fast 10-6-11

Thank you.

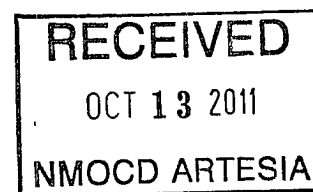

14. I hereby certify that the foregoing is true and correct

Name (Printed/Typed) Monti Sanders	Title Land Regulatory Technician
Signature <i>M. Sanders</i>	Date October 5, 2011

THIS SPACE FOR FEDERAL OR STATE USE

Approved by <i>James R. Amos</i>	Title SEPS	Date 10-6-11
Conditions of approval, if any, are attached. Approval of this notice does not warrant or certify that the applicant holds legal or equitable title to those rights in the subject lease which would entitle the applicant to conduct operations thereon.	Office CFD	

Title 18 U.S.C. Section 1001, make it a crime for any person knowingly and willfully to make to any department or agency of the United States any false, fictitious or fraudulent statements or representations as to any matter within its jurisdiction.

(Instructions on reverse)

10/17/2011

Accepted for record
NMOC D

YATES PETROLEUM CORPORATION
Marcel BMM Federal #1H
RECLAMATION PLAT

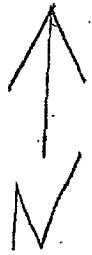

TOP SOIL

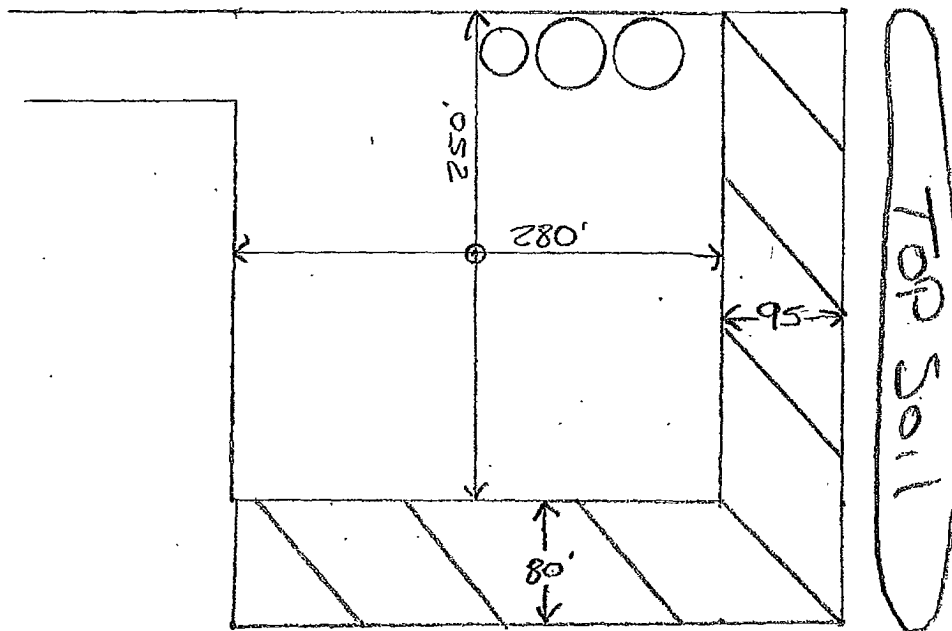

Not to Scale

FINAL Reclamation
May Look Different



Possible
Reclaimed
Area.

SilverOak 10

RIG PLATT
11-5-10

S



Main (575) 748-1471
Direct (575) 748-4196
Fax (575) 748-4229

SCOTT PITTS
Construction Supervisor

105 South Fourth Street
Artesia, New Mexico 88210
E-Mail scottp@yatespetroleum.com

Cellular (575) 365-4716
Residence (575) 748-3254

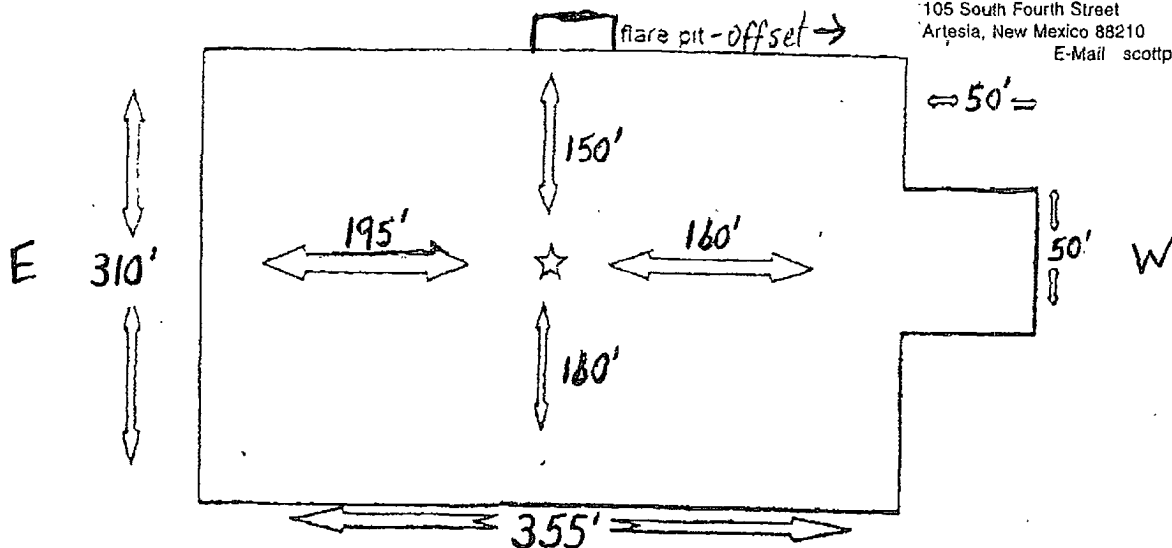

Pad Leveling Layout

5/21/2010

Level Sub & Piperacks Within 1" Install Blue Tops

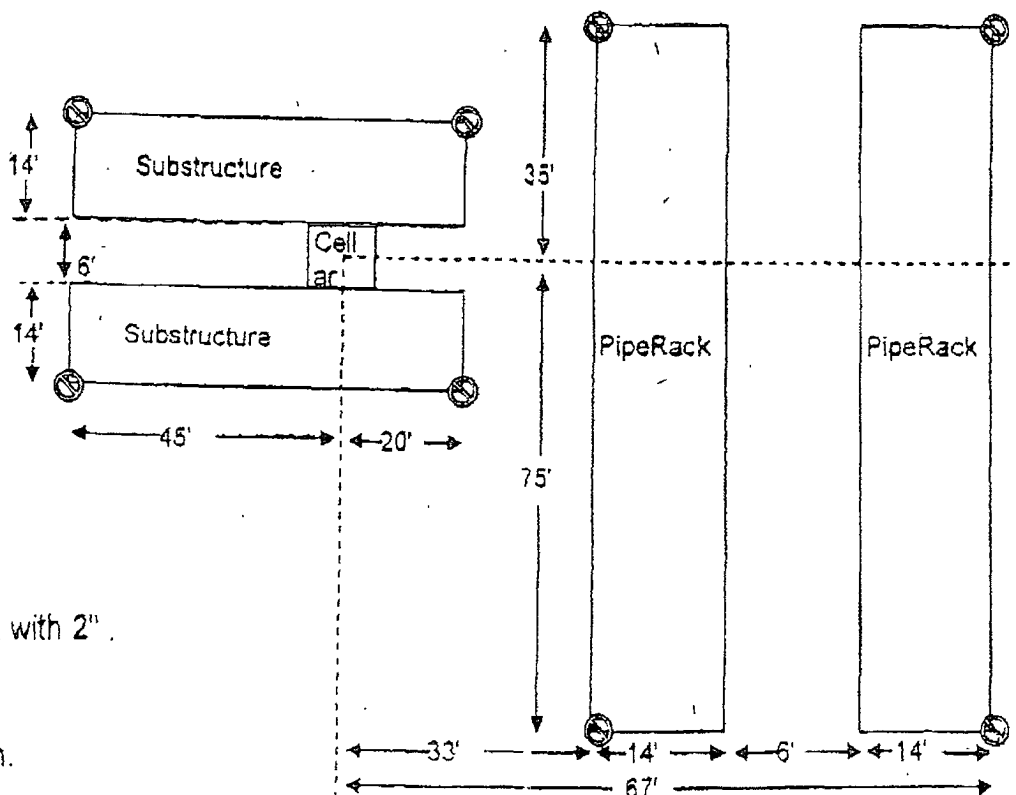

1. Level sub within 1", Pipe rack with 2".
2. Put extra caliche under sub.
3. Fence cellar right after install
4. 1' berm around entire location.
5. Cellar 6 x 6 x 8 .
6. Call Yates foreman for progress report
7. Keep sub area, pipe rack area & front of company man' house level & highest points on location. Slope outsides of