

DISTRICT I  
1625 N. FRENCH DR., HOBBS, NM 88240

DISTRICT II  
1301 W. GRAND AVENUE, ARTESIA, NM 88210

DISTRICT III  
1000 RIO BRAZOS RD., AZTEC, NM 87410

DISTRICT IV  
11885 S. ST. FRANCIS DR., SANTA FE, NM 87505

**State of New Mexico**  
Energy, Minerals & Natural Resources Department  
**OIL CONSERVATION DIVISION**  
1220 South St. Francis Dr.  
Santa Fe, New Mexico 87505

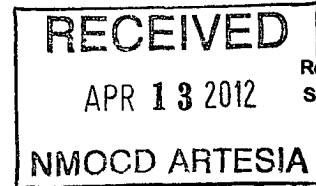

Form C-102  
Revised July 16, 2010  
Submit to Appropriate  
District Office

☐ AMENDED REPORT

**WELL LOCATION AND ACREAGE DEDICATION PLAT**

API Number <b>30-015-40166</b>	Pool Code <b>15011</b>	Pool Name <b>Culebra Bluff; Bone Spring South</b>
Property Code <b>39167</b>	Property Name <b>HERITAGE 2 15</b>	Well Number <b>1H</b>
OGRID No. <b>4323</b>	Operator Name <b>CHEVRON USA INC</b>	Elevation <b>3023'</b>

**Surface Location**

UL or lot No.	Section	Township	Range	Lot Idn	Feet from the	North/South line	Feet from the	East/West line	County
N	15	23-S	28-E		330	SOUTH	2010	WEST	EDDY

**Bottom Hole Location If Different From Surface**

UL or lot No.	Section	Township	Range	Lot Idn	Feet from the	North/South line	Feet from the	East/West line	County
C	15	23-S	28-E		510	NORTH	2260	WEST	EDDY
Dedicated Acres	Joint or Infill	Consolidation Code	Order No.						

NO ALLOWABLE WILL BE ASSIGNED TO THIS COMPLETION UNTIL ALL INTERESTS HAVE BEEN CONSOLIDATED OR A NON-STANDARD UNIT HAS BEEN APPROVED BY THE DIVISION

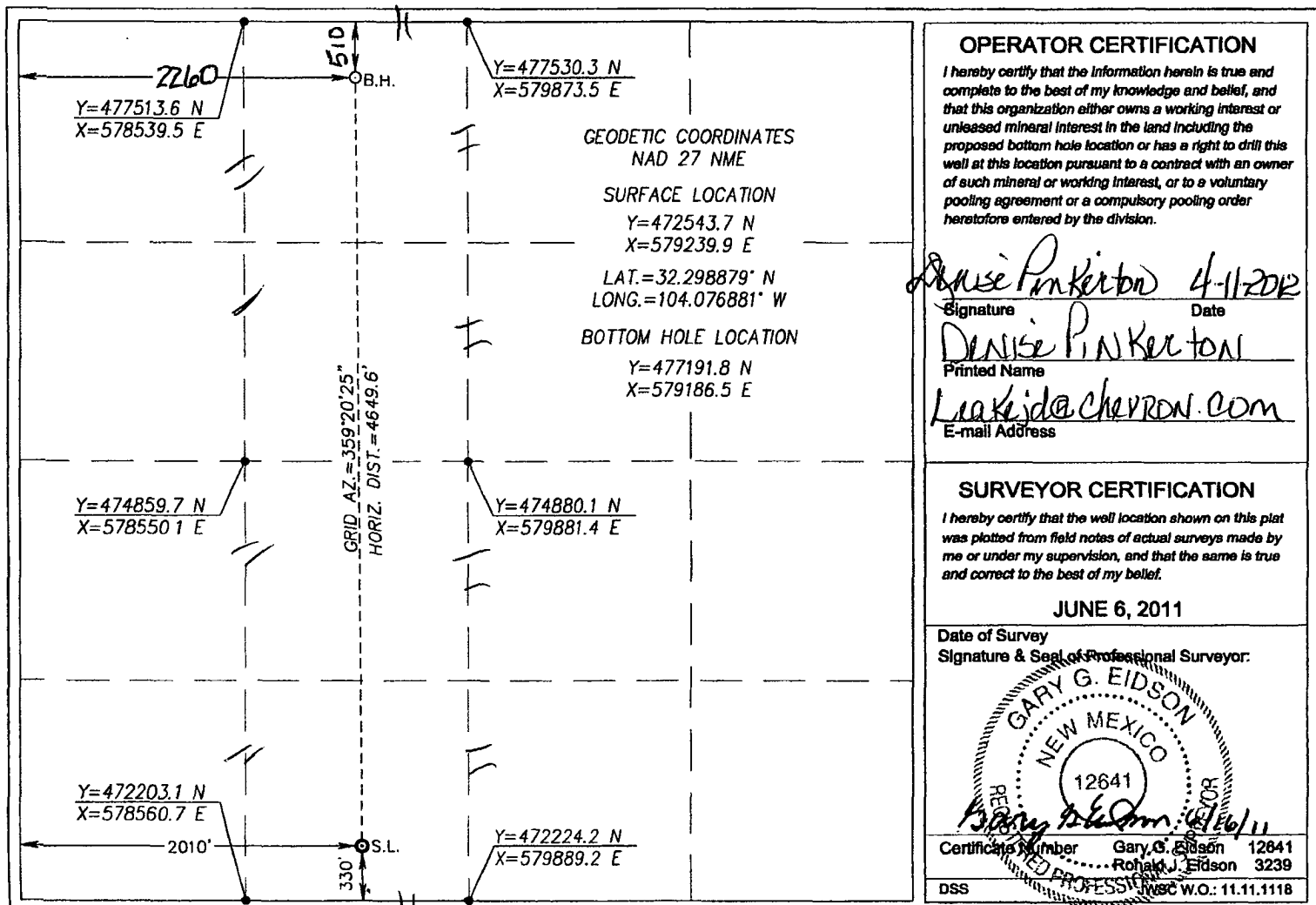

**OPERATOR CERTIFICATION**

I hereby certify that the information herein is true and complete to the best of my knowledge and belief, and that this organization either owns a working interest or unleased mineral interest in the land including the proposed bottom hole location or has a right to drill this well at this location pursuant to a contract with an owner of such mineral or working interest, or to a voluntary pooling agreement or a compulsory pooling order heretofore entered by the division.

*Denise Pinkerton* 4-11-2012  
Signature Date  
**DENISE PINKERTON**  
Printed Name  
**Liaki@chevron.com**  
E-mail Address

**SURVEYOR CERTIFICATION**

I hereby certify that the well location shown on this plat was plotted from field notes of actual surveys made by me or under my supervision, and that the same is true and correct to the best of my belief.

**JUNE 6, 2011**

Date of Survey  
Signature & Seal of Professional Surveyor:

**GARY G. EIDSON**  
NEW MEXICO  
12641

*Gary Eidson* 6/6/11  
Certificate Number Gary G. Eidson 12641  
Rohak J. Eidson 3239  
DSS MSC W.O.: 11.11.1118