

OCD-ARTESIA

11-1056

Form 3160-3
(April 2004)UNITED STATES
DEPARTMENT OF THE INTERIOR
BUREAU OF LAND MANAGEMENT

APPLICATION FOR PERMIT TO DRILL OR REENTER

FORM APPROVED
OMB No. 1004-0137
Expires March 31, 2007

1a. Type of work <input checked="" type="checkbox"/> DRILL <input type="checkbox"/> REENTER <i>NOS RECD 9/22/11</i>		5 Lease Serial No NMLC-058181
1b. Type of Well <input checked="" type="checkbox"/> Oil Well <input type="checkbox"/> Gas Well <input type="checkbox"/> Other <input type="checkbox"/> Single Zone <input type="checkbox"/> Multiple Zone		6 If Indian, Allottee or Tribe Name N/A
2 Name of Operator COG Operating LLC		7 If Unit or CA Agreement, Name and No N/A
3a Address 550 W. Texas, Suite 100 Midland TX 79701		8 Lease Name and Well No. Beech 25 Federal #10H <i><3024577></i>
3b Phone No. (include area code) (432) 685-4384		9 API Well No 30-015- 40209
4 Location of Well (Report location clearly and in accordance with any State requirements.) At surface SHL: 330' FSL & 1650' FWL, UL N At proposed prod zone BHL: 330' FSL & 1650' FEL, UL O		10 Field and Pool, or Exploratory Red Lake; Glorieta-Yeso, Northeast <i><96837></i>
14 Distance in miles and direction from nearest town or post office* 2 miles North of Loco Hills, NM		11 Sec, T R M or Blk and Survey or Area Sec 25, T17S, R27E
15 Distance from proposed* location to nearest property or lease line, ft (Also to nearest drg unit line, if any) 330'	16 No of acres in lease <i>40/160</i>	17 Spacing Unit dedicated to this well <i>40/80</i>
18 Distance from proposed location* to nearest well, drilling, completed, applied for, on this lease, ft 92'	19 Proposed Depth TV D: 3300' MD: 5090'	20 BLM/BIA Bond No. on file NMB000740; NMB000215
21 Elevations (Show whether DF, KDB, RT, GL, etc) 3610' GL	22 Approximate date work will start* 01/31/2012	23 Estimated duration 15 days

24. Attachments

The following, completed in accordance with the requirements of Onshore Oil and Gas Order No 1, shall be attached to this form

- | | |
|---|--|
| 1 Well plat certified by a registered surveyor | 4 Bond to cover the operations unless covered by an existing bond on file (see Item 20 above) |
| 2 A Drilling Plan | 5 Operator certification |
| 3 A Surface Use Plan (if the location is on National Forest System Lands, the SUPO shall be filed with the appropriate Forest Service Office) | 6 Such other site specific information and/or plans as may be required by the authorized officer |

25 Signature <i>[Signature]</i>	Name (Printed/Typed) Kelly J. Holly	Date 12/13/2011
Title Permitting Tech		

Approved by (Signature) <i>[Signature]</i>	Name (Printed/Typed) APR 20 2012	Date APR 20 2012
Title FIELD MANAGER	Office CARLSBAD FIELD OFFICE	

Application approval does not warrant or certify that the applicant holds legal or equitable title to those rights in the subject lease which would entitle the applicant to conduct operations thereon

Conditions of approval, if any, are attached.

APPROVAL FOR TWO YEARS

Title 18 USC Section 1001 and Title 43 USC Section 1212, make it a crime for any person knowingly and willfully to make to any department or agency of the United States any false, fictitious or fraudulent statements or representations as to any matter within its jurisdiction

*(Instructions on page 2)

Roswell Controlled Water Basin

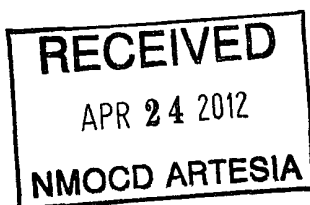
Approval Subject to General Requirements
& Special Stipulations AttachedSEE ATTACHED FOR
CONDITIONS OF APPROVAL

Surface Use Plan
COG Operating, LLC
Beech 25 Federal #10H
SL: 330' FSL & 1650' FWL UL N
BHL: 330' FSL & 1650' FEL UL O
Section 25, T-17-S, R27-E
Eddy County, New Mexico

I hereby certify that I, or persons under my direct supervision, have inspected the drill site and access road proposed herein; that I am familiar with the conditions that presently exist; that I have full knowledge of State and Federal laws applicable to this operation; that the statements made in this APD package are, to the best of my knowledge, true and correct; and that the work associated with the operations proposed herein will be performed in conformity with this APD package and the terms and conditions under which it is approved. I also certify that I, or COG Operating, LLC, am responsible for the operations conducted under this application. These statements are subject to the provisions of 18 U.S.C. 1001 for the filing of false statements. Executed this 16th day of November, 2011.

Signed: 

Printed Name: Carl Bird

Position: Drilling Engineer

Address: 550 W. Texas, Suite 1300, Midland, Texas 79701

Telephone: (432) 683-7443

Field Representative (if not above signatory): Same

E-mail: cbird@conchoresources.com

DISTRICT I
1625 N French Dr., Hobbs, NM 88240
Phone (575) 393-6161 Fax (575) 393-0720
DISTRICT II
811 S. First St., Artesia, NM 88210
Phone (575) 748-1283 Fax (575) 748-9720
DISTRICT III
1000 Rio Brazos Road, Aztec, NM 87410
Phone (505) 334-6178 Fax (505) 334-6170
DISTRICT IV
1220 S St Francis Dr., Santa Fe, NM 87505
Phone (505) 476-3460 Fax (505) 476-3462

State of New Mexico
Energy, Minerals & Natural Resources Department
OIL CONSERVATION DIVISION
1220 South St. Francis Dr.
Santa Fe, New Mexico 87505

Form C-102
Revised August 1, 2011
Submit one copy to appropriate
District Office

☐ AMENDED REPORT

WELL LOCATION AND ACREAGE DEDICATION PLAT

API Number 30-015 - 40209	Pool Code 96836	Pool Name Red Lake; Glorieta-Yeso, Northeast
Property Code 302457	Property Name BEECH 25 FEDERAL	Well Number 10H
OGRID No. 229137	Operator Name COG OPERATING, LLC	Elevation 3610'

Surface Location

UL or lot No	Section	Township	Range	Lot Idn	Feet from the	North/South line	Feet from the	East/West line	County
N	25	17-S	27-E		330	SOUTH	1650	WEST	EDDY

Bottom Hole Location If Different From Surface

UL or lot No	Section	Township	Range	Lot Idn	Feet from the	North/South line	Feet from the	East/West line	County
O	25	17-S	27-E		330	SOUTH	1650	EAST	EDDY

Dedicated Acres 80	Joint or Infill	Consolidation Code	Order No.
-----------------------	-----------------	--------------------	-----------

NO ALLOWABLE WILL BE ASSIGNED TO THIS COMPLETION UNTIL ALL INTERESTS HAVE BEEN CONSOLIDATED OR A NON-STANDARD UNIT HAS BEEN APPROVED BY THE DIVISION

<p>SECTION, QUARTER & SIXTEENTH CORNER COORDINATES (A) - Y=655275.7 X=528582.3 (B) - Y=653959.1, X=528584.2 (C) - Y=653939.2, X=531231.9 (D) - Y=655241.2, X=533871.7 (E) - Y=653920.4, X=533879.3</p> <p>GEODETIC COORDINATES NAD 27 NME SURFACE LOCATION Y=654276.6 N X=530233.2 E LAT.=32 798657" N LONG.=103.234943" W BOTTOM HOLE LOCATION Y=654262.1 N X=532227.7 E</p> <p>DETAIL 3605.9' 3606.4' 3608.0' 3613.0' 600'</p> <p>Project Area Producing Area SEE DETAIL GRID AZ = 90°25'03" HORIZ. DIST = 1995.0'</p>	<p>OPERATOR CERTIFICATION I hereby certify that the information herein is true and complete to the best of my knowledge and belief, and that this organization either owns a working interest or unleased mineral interest in the land including the proposed bottom hole location or has a right to drill this well at this location pursuant to a contract with an owner of such mineral or working interest, or to a voluntary pooling agreement or a compulsory pooling order heretofore entered by the division.</p> <p> 12-13-11 Signature Date Kelly J. Holly Printed Name kholly@concho.com E-mail Address</p>
	<p>SURVEYOR CERTIFICATION I hereby certify that the well location shown on this plat was plotted from field notes of actual surveys made by me or under my supervision, and that the same is true and correct to the best of my belief</p> <p>AUGUST 18, 2011</p>
	<p>Date of Survey Signature of Professional Surveyor Certificate Number: Gary C. Eidson 12641 Ronald J. Eidson 3239 AF REV. 12/77 JWSC W O 11 11 1706</p>

ATTACHMENT TO FORM 3160-3
COG Operating, LLC
Beech 25 Federal #10H
SHL: 330' FSL & 1650' FWL, Unit N
BHL: 330' FSL & 1650' FEL, Unit O
Sec 25, T17S, R27E
Eddy County, NM

1. Proration Unit Spacing: 160 Acres
2. Ground Elevation: 3610'
3. Proposed Depths: Horizontal TVD = 3,300', MD = 5090'
4. Estimated tops of geological markers:

Quaternary	Surface
Rustler	Not Present
Top of Salt	Not Present
Base of Salt	Not Present
Yates	235'
Seven Rivers	450'
Queen	965'
Grayburg	1385'
San Andres	1740'
Glorieta	3100'
Paddock	3130'
Blaine	3655'
Tubb	4660'

5. Possible mineral bearing formations:

Water Sand	Surface	Fresh Water
Grayburg	1385'	Oil/Gas
San Andres	1740'	Oil/Gas
Glorieta	3100'	Oil/Gas
Paddock	3130'	Oil/Gas
Blaine	3655'	Oil/Gas
Tubb	4660'	Oil/Gas

No other formations are expected to give up oil, gas or fresh water in measurable quantities. Setting 13 3/8" casing to 350' and circulating cement back to the surface will protect the surface fresh water sand. There is no Salt Section, but incompetent or unconsolidated zones, or deeper cave/karst zones will be protected by setting 9 5/8" casing to 1000' and circulating cement, in a single or multi-stage job and/or with an ECP, back to the surface. Any shallower zones above TD, which contain commercial quantities of oil and/or gas, will have cement circulated across them. This will be achieved by cementing, with a single or multi-stage job, the 7" x 5 1/2" production casing back 200' into the intermediate casing (although cement volume is actually calculated to surface), to be run at TD. If wellbore conditions arise that require immediate action and/or a change to this program, COG Operating LLC personnel will always react to protect the wellbore and/or environment.

See
COA

See
COA

ATTACHMENT TO FORM 3160-3
COG Operating, LLC
Beech 25 Federal #10H
Page 2 of 4

6. Casing Program - Proposed

<u>Hole size</u>	<u>Interval</u>	<u>OD of Casing</u>	<u>Weight</u>	<u>Cond.</u>	<u>Collar</u>	<u>Grade</u>
17-1/2"	0' - +/-350'	13-3/8"	48#	New	STC	H-40 or J/K-55
Collapse sf – 3.94, Burst sf – 9.22, Tension sf – 15.8						
12-1/4"	0' - +/-1000'	9-5/8"	36#	New	STC	J/K-55
Collapse sf – 2.03, Burst sf – 3.03, Tension sf – 7.82						
8-3/4" x 7 7/8"	0' – 5090'	7" x 5-1/2"	26#/17#	New	LTC	L-80
Collapse sf – 1.73, Burst sf – 1.88, Tension sf – 2.42						

Production string will be a tapered string with 7" 26# L-80 LTC ran from surface to kick off point and then crossed over to 5 1/2" 17# L-80 LTC.

7. Cement Program *See Conf*

13 3/8" Surface Csg: Set at +/- 350'MD, Lead Slurry: 350sx Class "C" w/ 2% CaCl₂ & .25 pps CF, 1.32 yield. 90% excess, calculated to surface.

9 5/8" Intrmd. Csg: Set at +/- 1000'MD. **Single Stage:** Lead Slurry: 200 sx 50:50:10:C:Poz:Gel w/ 5% salt, .25 pps CF, 2.45 yield. Tail Slurry: 200 sx Class "C" w/ 2% CaCl₂, 1.32 yield. 206% excess, calculated to surface.

Multi Stage: **Stage 1:** 200 sx Class "C" w/ 2% CaCl₂, 1.32 yield. 79% excess. **Stage 2:** 200 sx 50:50:10:C:Poz:Gel w/ 5% salt, .25 pps CF, 2.45 yield, back to surface, 161% excess; assumption for tool is lost circulation. Multi stage tool to be set at approximately, depending on hole conditions, 400' (50' below the surface casing). Cement volumes will be adjusted proportionately for depth changes of multi stage tool.

7 x 5 1/2" Production Csg: Set at +/- 5090'MD. **Single Stage:** Lead Slurry: 200 sx 35:65:6:C:Poz:Gel w/ 5% salt, 5 pps LCM, .2% SMS, .3% FL-52A, .125 pps CF, 2.01 yd. Tail Slurry: 200 sx 50:50:2:C:Poz:Gel w/ 5% salt, 3 pps LCM, .6% SMS, 1% FL-25, 1% BA-58, .125 pps CF, .3% FL-52A; 1.37 yield. DV Tool and ECP to be set at kick off point with 7" cemented to surface and 5 1/2" run with +/- 18 isolation packers and sliding sleeves in uncemented lateral. 86% excess in open hole, from kick off point, calculated to surface. **This is a minimum volume and will be adjusted up after caliper is run.**

Multi Stage: **Stage 1:** (Assumed TD of 5090'MD to DV at 1800') Lead Slurry: 200 sx 50:50:2:C:Poz:Gel w/ 5% salt, 3 pps LCM, .6% SMS, 1% FL-25, 1% BA-58, .125 pps CF, .3% FL-52A; 1.37 yield. 78% excess. **This is a minimum volume and will be adjusted up after caliper is run.** **Stage 2:** Lead Slurry: 200 sx 50:50:2:C:Poz:Gel w/ 5% salt, 3 pps LCM, .6% SMS, 1% FL-25, 1% BA-58, .125 pps CF, .3% FL-52A; 1.37 yield. Tail Slurry: 200 sx Class C w/ 0.3% R-3 + 1.5% CD-32, 1.02 yield. 67% excess calculated back to surface (no need for excess in casing overlap). **This is a minimum volume and will be adjusted up after caliper is run.**

Multi stage tool to be set at approximately 1800', depending on hole conditions. Cement volumes will be adjusted proportionately for depth changes of multi stage tool; assumption for use of tool is water flow.

ATTACHMENT TO FORM 3160-3
COG Operating, LLC
Beech 25 Federal #10H
Page 3 of 4

8. Pressure Control Equipment:

The blowout preventer equipment (BOP) shown in Exhibit #9 will consist of a double ram-type (2000 psi WP) preventer, and in some cases possibly a 2000 psi Hydril type annular preventer as provided for in Onshore Order #2. This unit will be hydraulically operated and the ram type preventer will be equipped with blind rams on top of 4 1/2" drill pipe rams on the bottom. A 13-5/8" will be used during the drilling of the well. The BOP will be nipped up on the 13 3/8" surface casing with BOP equipment and tested to 2000 psi. After setting 9-5/8" the BOP will then be nipped up on the 9-5/8" intermediate casing and tested by a third party to 2000 psi and used continuously until total depth is reached. Pipe rams will be operationally checked each 24-hour period. Blind rams will be operationally checked on each trip out of the hole. These checks will be noted on the daily tour sheets. Other accessories to the BOP equipment (Exhibit #10) will include a Kelly cock and floor safety valve, choke lines and a choke manifold (Exhibit #11) with a 2000 psi WP rating.

9. Proposed Mud Circulating System

Interval	Mud Wt.	Visc.	FL	Type Mud System
0' - 350'	8.5	28	NC	Fresh water native mud w/ paper for seepage and sweeps. Lime for PH.
350' - 1000'	10	30	NC	<i>See COA</i> Brine mud FW , lime for PH and paper for seepage and sweeps.
1000' - 5090'	9.1	29	NC	Drill section with fresh water/cut brine circulating the reserve utilizing periodic sweeps of paper as needed for seepage control and solids removal.

Sufficient mud materials to maintain mud properties and meet minimum lost circulation and weight increase requirements will be kept at the well site at all times.

10. Production Hole Drilling Summary:

Drill 8 3/4" hole and kick off at +/- 2823', building curve over +/- 750' to horizontal at 3300' TVD. Drill 7 7/8" lateral section in a Easterly direction for +/-1995' lateral to TD at +/-5090' MD, 3300' TVD. Run 7" x 5-1/2" production casing. 7" to be ran from surface to kickoff point and changed over to 5 1/2" with DV Tool and ECP at kickoff point. 5 1/2" casing will be ran from kickoff point to td and isolation packers set throughout lateral. 7" to be cemented from kickoff point to surface.

11. Auxiliary Well Control and Monitoring Equipment

- A. Kelly cock will be kept in the drill string at all times.
- B. A full opening drill pipe-stabbing valve with proper drill pipe connections will be on the rig floor at all times.

ATTACHMENT TO FORM 3160-3
COG Operating, LLC
Beech 25 Federal #10H
Page 4 of 4

12. Logging, Testing and Coring Program: *See CoA*

- A. No electric logging to be performed on this well.
- B. The mud logging program will consist of lagged 10' samples from intermediate casing point to T.D. in vertical pilot hole and from Kick off point to TD in Horizontal hole.
- C. Drill Stem test is not anticipated.
- D. No conventional coring is anticipated.
- E. Further testing procedures will be determined after the 7" x 5 1/2" production casing has been cemented based on drill shows and log evaluation.

13. Abnormal Conditions, Pressures, Temperatures and Potential Hazards:

No abnormal pressures or temperatures are anticipated. The estimated bottom hole temperature at TD is 100 degrees and estimated maximum bottom hole pressure is 1900 psig. Measurable gas volumes or Hydrogen Sulfide levels have not been encountered during drilling operations in this area, however an H2S plan is attached to the Drilling Program. No major loss of circulation zones has been reported in offsetting wells.

14. Anticipated Starting Date

Drilling operations will commence approximately on April 15, 2011 with drilling and completion operations lasting approximately 90 days.



COG Operating LLC

Eddy County, NM (NAN27 NME)

Beech²⁵ Federal #10H

Beech²⁵ Federal #10H

OH

Plan: Plan #1 8-3/4" Hole

SHL = 330' FSL & 1650' FWL

BHL = 330' FSL & 1650' FEL

Standard Planning Report

07. October, 2011





Scientific Drilling
Planning Report



Database:	EDM-Julio	Local Co-ordinate Reference:	Site Beech Federal #10H
Company:	COG Operating LLC	TVD Reference:	GL Elev @ 3610 00usft
Project:	Eddy County, NM (NAN27 NME)	MD Reference:	GL Elev @ 3610 00usft
Site:	Beech Federal #10H	North Reference:	Grid
Well:	Beech Federal #10H	Survey Calculation Method:	Minimum Curvature
Wellbore:	OH		
Design:	Plan #1 8-3/4" Hole		

Project:	Eddy County, NM (NAN27 NME)		
Map System:	US State Plane 1927 (Exact solution)	System Datum:	Mean Sea Level
Geo Datum:	NAD 1927 (NADCON CONUS)		
Map Zone:	New Mexico East 3001		

Site:	Beech Federal #10H		
Site Position:		Northing:	654,276 60 usft
From:	Map	Easting:	530,233 20 usft
Position Uncertainty:	0 00 usft	Slot Radius:	13-3/16 "
		Latitude:	32° 47' 55 166 N
		Longitude:	104° 14' 5 794 W
		Grid Convergence:	0 05 °

Well:	Beech Federal #10H		
Well Position	+N-S	0 00 usft	Northing:
	+E-W	0 00 usft	Easting:
Position Uncertainty	0.00 usft		Wellhead Elevation:
			Ground Level:
			3,610 00 usft

Wellbore:	OH		
Magnetics:	Model Name	Sample Date	Declination
			(°)
	IGRF2010	2011/10/07	7 90
			Dip Angle
			(°)
			60 60
			Field Strength
			(nT)
			48,855

Design:	Plan #1 8-3/4" Hole		
Audit Notes:			
Version:	Phase:	PLAN	Tie On Depth:
			0 00
Vertical Section:	Depth From (TVD)	+N-S	+E-W
	(usft)	(usft)	(usft)
	0.00	0 00	0 00
			Direction
			(°)
			90 42

Plan Sections										
Measured Depth	Inclination	Azimuth	Vertical Depth	+N-S	+E-W	Dogleg Rate	Build Rate	Turn Rate	TFO	Target
(usft)	(°)	(°)	(usft)	(usft)	(usft)	(°/100usft)	(°/100usft)	(°/100usft)	(°)	
0 00	0 00	0 00	0 00	0 00	0 00	0 00	0 00	0 00	0 00	
2,822 54	0 00	0 00	2,822 54	0 00	0 00	0 00	0 00	0 00	0 00	
3,572 54	90 00	90 42	3,300 00	-3 47	477.45	12 00	12 00	0 00	90 42	
5,089 62	90 00	90 42	3,300 00	-14 50	1,994 50	0 00	0 00	0 00	0 00	PBHL-Beech Fed #10

Database:	EDM-Julio	Local Co-ordinate Reference:	Site Beech Federal #10H
Company:	COG Operating LLC	TVD Reference:	GL Elev @ 3610.00usft
Project:	Eddy County, NM (NAN27 NME)	MD Reference:	GL Elev @ 3610.00usft
Site:	Beech Federal #10H	North Reference:	Grid
Well:	Beech Federal #10H	Survey Calculation Method:	Minimum Curvature
Wellbore:	OH		
Design:	Plan #1 8-3/4" Hole		

Planned Survey

Measured Depth (usft)	Inclination (°)	Azimuth (°)	Vertical Depth (usft)	+N/-S (usft)	+E/-W (usft)	Vertical Section (usft)	Dogleg Rate (°/100usft)	Build Rate (°/100usft)	Turn Rate (°/100usft)
0.00	0.00	0.00	0.00	0.00	0.00	0.00	0.00	0.00	0.00
2,822.54	0.00	0.00	2,822.54	0.00	0.00	0.00	0.00	0.00	0.00
KOP Start Build 12.00/100°									
2,900.00	9.30	90.42	2,899.66	-0.05	6.27	6.27	12.00	12.00	0.00
3,000.00	21.30	90.42	2,995.94	-0.24	32.60	32.60	12.00	12.00	0.00
3,100.00	33.30	90.42	3,084.64	-0.57	78.37	78.38	12.00	12.00	0.00
3,200.00	45.30	90.42	3,161.89	-1.03	141.59	141.59	12.00	12.00	0.00
3,300.00	57.30	90.42	3,224.31	-1.60	219.48	219.49	12.00	12.00	0.00
3,400.00	69.30	90.42	3,269.16	-2.24	308.65	308.66	12.00	12.00	0.00
3,500.00	81.30	90.42	3,294.50	-2.95	405.20	405.21	12.00	12.00	0.00
3,572.54	90.00	90.42	3,300.00	-3.47	477.45	477.46	12.00	12.00	0.00
Land EOC hold 90.00°									
3,600.00	90.00	90.42	3,300.00	-3.67	504.92	504.93	0.00	0.00	0.00
3,700.00	90.00	90.42	3,300.00	-4.40	604.91	604.93	0.00	0.00	0.00
3,800.00	90.00	90.42	3,300.00	-5.12	704.91	704.93	0.00	0.00	0.00
3,900.00	90.00	90.42	3,300.00	-5.85	804.91	804.93	0.00	0.00	0.00
4,000.00	90.00	90.42	3,300.00	-6.58	904.91	904.93	0.00	0.00	0.00
4,100.00	90.00	90.42	3,300.00	-7.31	1,004.90	1,004.93	0.00	0.00	0.00
4,200.00	90.00	90.42	3,300.00	-8.03	1,104.90	1,104.93	0.00	0.00	0.00
4,300.00	90.00	90.42	3,300.00	-8.76	1,204.90	1,204.93	0.00	0.00	0.00
4,400.00	90.00	90.42	3,300.00	-9.49	1,304.90	1,304.93	0.00	0.00	0.00
4,500.00	90.00	90.42	3,300.00	-10.21	1,404.89	1,404.93	0.00	0.00	0.00
4,600.00	90.00	90.42	3,300.00	-10.94	1,504.89	1,504.93	0.00	0.00	0.00
4,700.00	90.00	90.42	3,300.00	-11.67	1,604.89	1,604.93	0.00	0.00	0.00
4,800.00	90.00	90.42	3,300.00	-12.39	1,704.88	1,704.93	0.00	0.00	0.00
4,900.00	90.00	90.42	3,300.00	-13.12	1,804.88	1,804.93	0.00	0.00	0.00
5,000.00	90.00	90.42	3,300.00	-13.85	1,904.88	1,904.93	0.00	0.00	0.00
5,089.62	90.00	90.42	3,300.00	-14.50	1,994.50	1,994.55	0.00	0.00	0.00
PBHL-Beech Fed #10H									

Design Targets

Target Name	Dip Angle (°)	Dip Dir. (°)	TVD (usft)	+N/-S (usft)	+E/-W (usft)	Northing (usft)	Easting (usft)	Latitude	Longitude
hit/miss target									
Shape									
PBHL-Beech Fed #10H	0.00	0.00	3,300.00	-14.50	1,994.50	654,262.10	532,227.70	32° 47' 55.004 N	104° 13' 42.427 W
- plan hits target center									
- Point									

Plan Annotations

Measured Depth (usft)	Vertical Depth (usft)	Local Coordinates		Comment
		+N/-S (usft)	+E/-W (usft)	
2,822.54	2,822.54	0.00	0.00	KOP Start Build 12.00/100°
3,572.54	3,300.00	-3.47	477.45	Land EOC hold 90.00°



Scientific Drilling for COG Operating LLC
Site: Eddy County, NM (NAN27 NME)
Well: Beech Federal #10H
Wellbore: OH
Design: Plan #1 8-3/4" Hole



SECTION DETAILS

Sec	MD	Inc	Azi	TVD	+N/-S	+E/-W	Dleg	TFace	VSeet	Target
1	0.00	0.00	0.00	0.00	0.00	0.00	0.00	0.00	0.00	
2	2822.54	0.00	0.00	2822.54	0.00	0.00	0.00	0.00	0.00	
3	3572.54	90.00	90.42	3300.00	-3.47	477.45	12.00	90.42	477.46	
4	5089.62	90.00	90.42	3300.00	-14.50	1994.50	0.00	0.00	1994.55	PBHL-Beech Fed #10H

WELLBORE TARGET DETAILS (MAP CO-ORDINATES)

Name	TVD	+N/-S	+E/-W	Northing	Easting	Latitude	Longitude	Shape
PBHL-Beech Fed #10H	3300.00	-14.50	1994.50	654262.10	532227.70	32° 47' 55.004 N	104° 13' 42.427 W	Point

WELL DETAILS: Beech Federal #10H

+N/-S	+E/-W	Ground Level	3610.00	Longitude	Slot
0.00	0.00	Northing	Easting	Latitude	
		654276.60	530233.20	32° 47' 55.166 N	104° 14' 5.794 W

LEGEND

Plan #1 8-3/4" Hole

Plan: Plan #1 8-3/4" Hole (Beech Federal #10H/OH)

Created By: Julio Pina

Date: 07-Oct-11

Checked:

Date:

Reviewed:

Date:

PROJECT DETAILS Eddy County, NM (NAN27 NME)

Geodetic System: US State Plane 1927 (Exact solution)
Datum: NAD 1927 (NADCON CONUS)
Ellipsoid: Clarke 1866
Zone: New Mexico East 3001
System Datum: Mean Sea Level

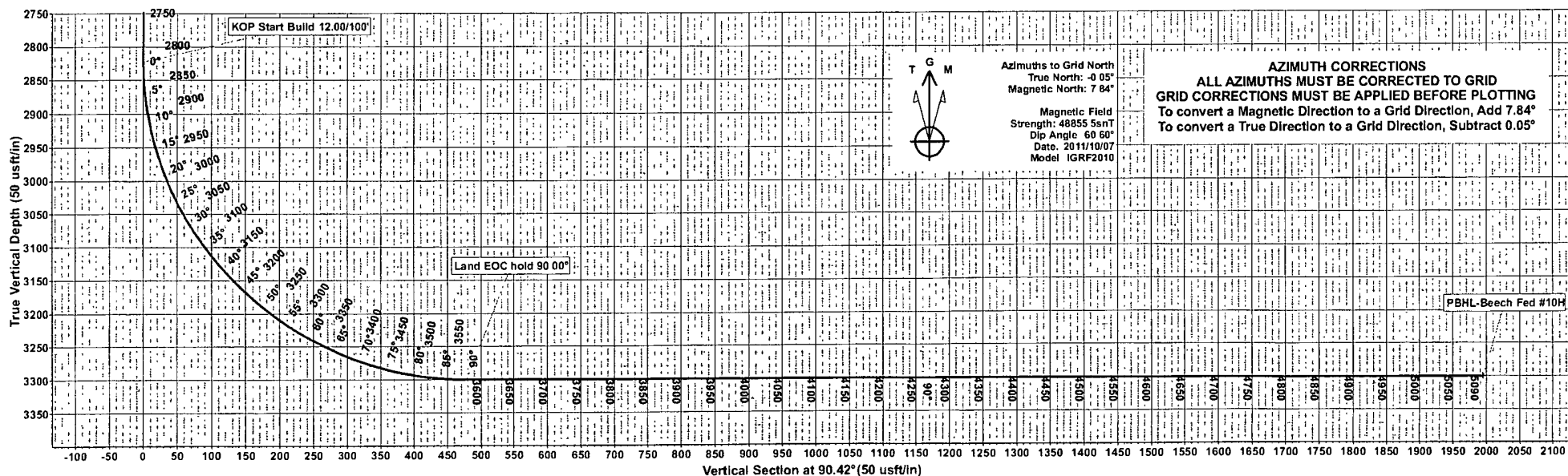
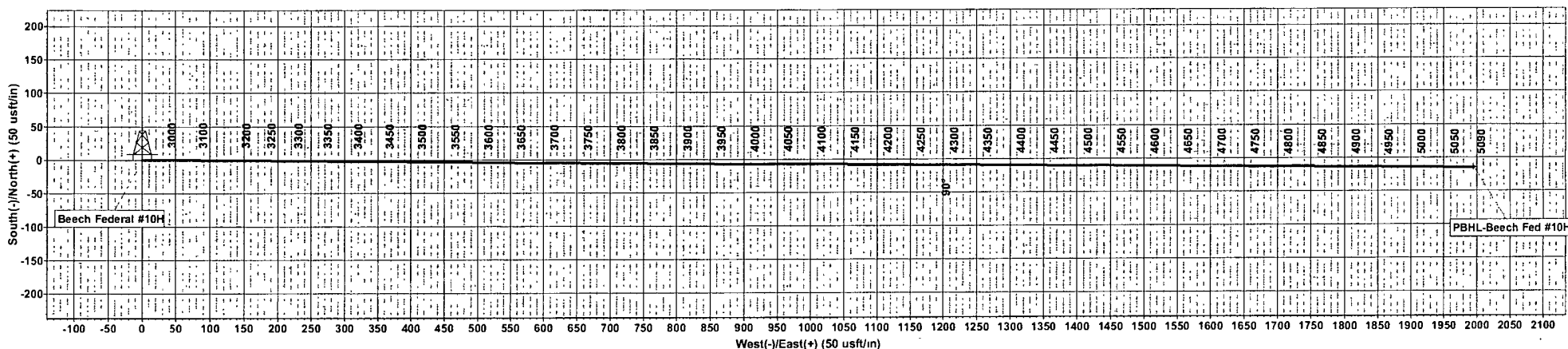

Azimuths to Grid North
True North: -0.05°
Magnetic North: 7.84°
Magnetic Field
Strength: 48855.5nT
Dip Angle: 60.60°
Date: 2011/10/07
Model: IGRF2010

AZIMUTH CORRECTIONS
ALL AZIMUTHS MUST BE CORRECTED TO GRID
GRID CORRECTIONS MUST BE APPLIED BEFORE PLOTTING
To convert a Magnetic Direction to a Grid Direction, Add 7.84°
To convert a True Direction to a Grid Direction, Subtract 0.05°

COG OPERATING LLC

550 West Texas, Suite 100
Midland, TX 79701

DIRECTIONAL PLAN VARIANCE REQUEST

**Beech 25 Federal #10H
EDDY, NM**

SHL	330 FSL, 1650 FWL	Sec 25, T17S, R27E, Unit N
BHL	330 FSL, 1650 FEL	Sec 25, T17S, R27E, Unit O

COG Operating LLC, as Operator, desires that the APD reflect the footages as stated on the surveyor's plat. However, Operator also desires to avoid inadvertently drilling the well to a non-standard location. Therefore, due to the proximity of the plat bottom hole location to the pro-ration unit hard line(s), the attached directional plan is designed to avoid the hard lines by as much as fifty feet; said fifty feet being in either (or both) the north-south and/or east-west directions as applicable.

COG Operating LLC

Exhibit #9

BOPE and Choke Schematic

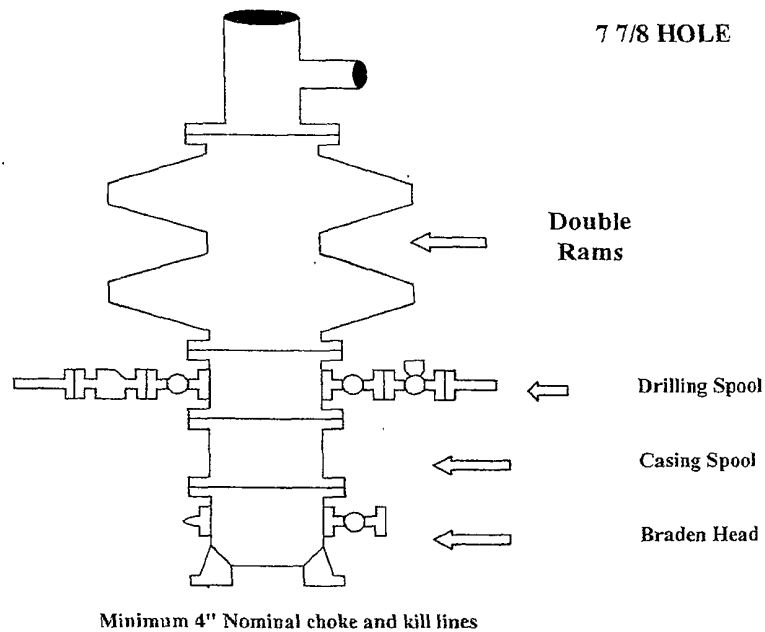

Choke Manifold Requirement (2000 psi WP)
No Annular Required

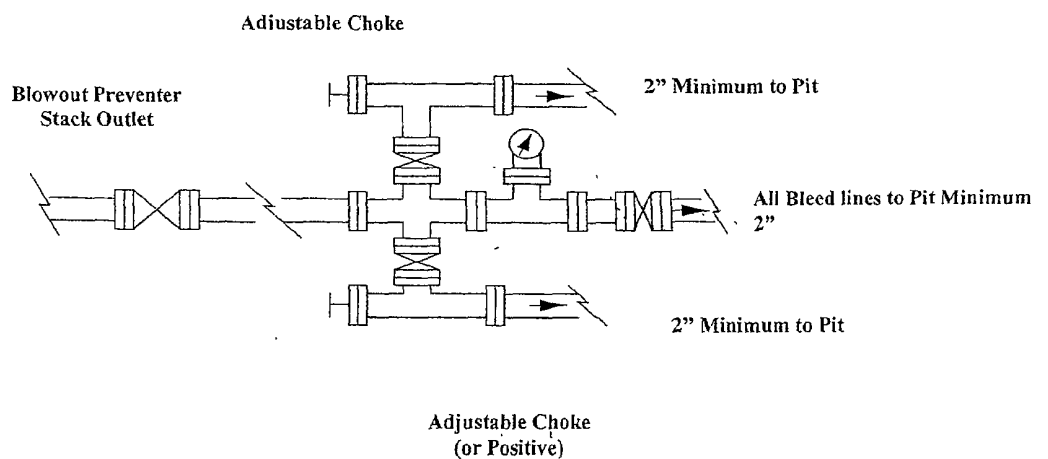

NOTES REGARDING THE BLOWOUT PREVENTERS
Master Drilling Plan
Eddy County, New Mexico

1. Drilling nipple to be so constructed that it can be removed without use of a welder through rotary table opening, with minimum I.D. equal to preventer bore.
2. Wear ring to be properly installed in head.
3. Blow out preventer and all fittings must be in good condition, 2000 psi WP minimum.
4. All fittings to be flanged.
5. Safety valve must be available on rig floor at all times with proper connections, valve to be full 2000 psi WP minimum.
6. All choke and fill lines to be securely anchored especially ends of choke lines.
7. Equipment through which bit must pass shall be at least as large as the diameter of the casing being drilled through.
8. Kelly cock on Kelly.
9. Extension wrenches and hands wheels to be properly installed.
10. Blow out preventer control to be located as close to driller's position as feasible.
11. Blow out preventer closing equipment to include minimum 40-gallon accumulator, two independent sources of pump power on each closing unit installation all API specifications.

COG Operating LLC
Closed Loop Equipment Diagram

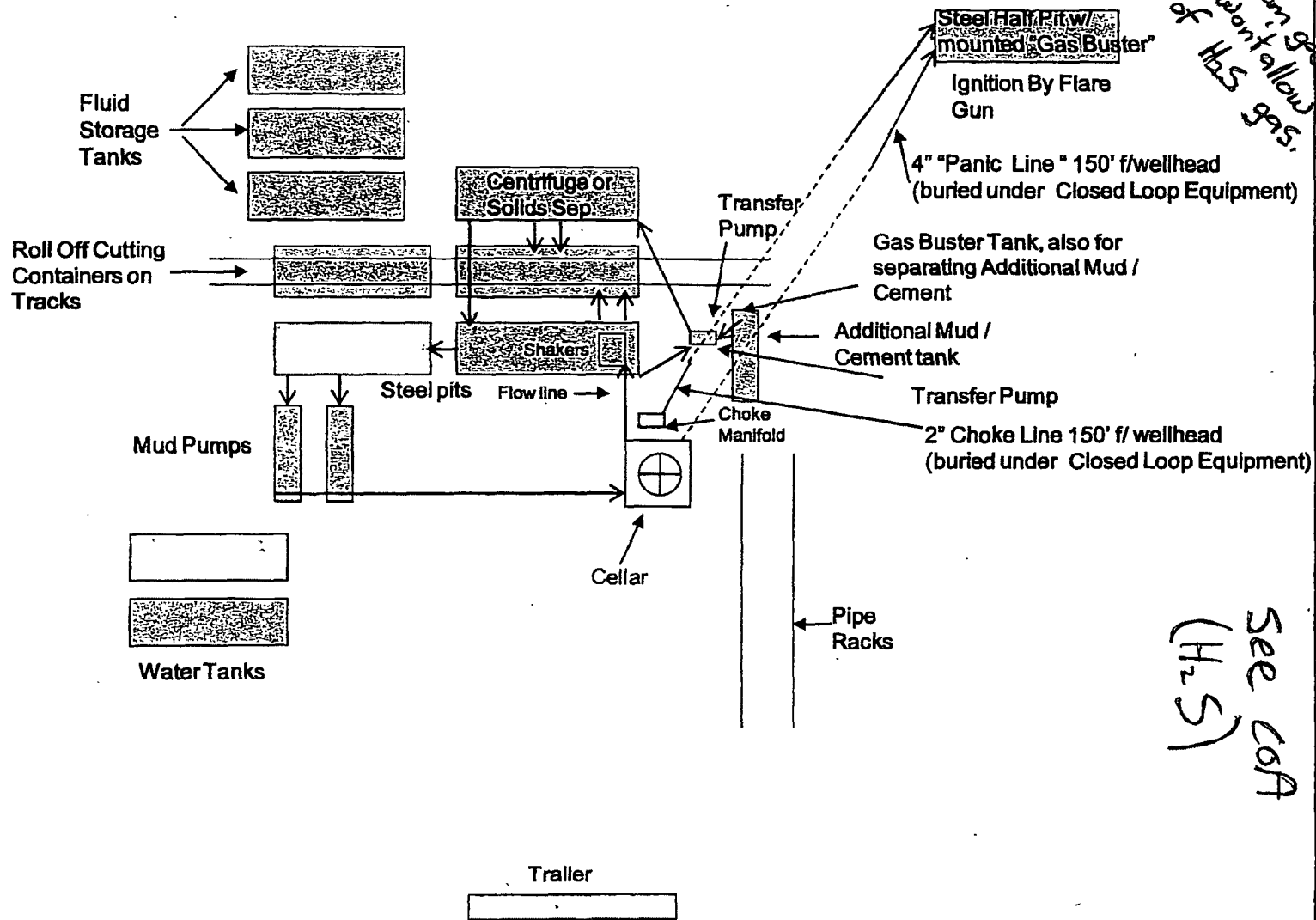

Closed Loop Operation & Maintenance Procedure

All drilling fluid circulated over shaker(s) with cuttings discharged into roll off container.

Fluid and fines below shaker(s) are circulated with transfer pump through centrifuge(s) or solids separator with cuttings and fines discharged into roll off container.

Fluid is continuously re-circulated through equipment with polymer added to aid separation of cutting fines.

Roll off containers are lined and de-watered with fluids re-circulated into system.

Additional tank is used to capture unused drilling fluid or cement returns from casing jobs.

This equipment will be maintained 24 hrs./day by solids control personnel and or rig crews that stay on location.

Cuttings will be hauled to either:

CRI (permit number R9166)

or

GMI (permit number 711-019-001)

dependent upon which rig is available to drill this well.

COG Operating LLC

Hydrogen Sulfide Drilling Operation Plan

I. HYDROGEN SULFIDE TRAINING

All personnel, whether regularly assigned, contracted, or employed on an unscheduled basis, will receive training from a qualified instructor in the following areas prior to commencing drilling operations on this well:

1. The hazards and characteristics of hydrogen sulfide (H₂S)
2. The proper use and maintenance of personal protective equipment and life support systems.
3. The proper use of H₂S detectors, alarms, warning systems, briefing areas, evacuation procedures, and prevailing winds.
4. The proper techniques for first aid and rescue procedures.

In addition, supervisory personnel will be trained in the following areas:

1. The effects of H₂S on metal components. If high tensile tubular are to be used, personnel will be trained in their special maintenance requirements.
2. Corrective action and shut-in procedures when drilling or reworking a well and blowout prevention and well control procedures.
3. The contents and requirements of the H₂S Drilling Operations Plan and Public Protection Plan.

There will be an initial training session just prior to encountering a known or probable H₂S zone (within 3 days or 500 feet) and weekly H₂S and well control drills for all personnel in each crew. The initial training session shall include a review of the site specific H₂S Drilling Operations Plan and the Public Protection Plan. **The concentrations of H₂S of wells in this area from surface to TD are low enough that a contingency plan is not required.**

II. H2S SAFETY EQUIPMENT AND SYSTEMS

Note: All H2S safety equipment and systems will be installed, tested, and operational when drilling reaches a depth of 500 feet above, or three days prior to penetrating the first zone containing or reasonable expected to contain H2S.

1. Well Control Equipment:

- A. Flare line.
- B. Choke manifold.
- C. Blind rams and pipe rams to accommodate all pipe sizes with properly sized closing unit.
- D. Auxiliary equipment may include if applicable: annular preventer & rotating head.

2. Protective equipment for essential personnel:

- A. Mark II Survive air 30-minute units located in the doghouse and at briefing areas, as indicated on well site diagram.

3. H2S detection and monitoring equipment:

- A. 1 portable H2S monitors positioned on location for best coverage and response. These units have warning lights and audible sirens when H2S levels of 20 PPM are reached.

4. Visual warning systems:

- A. Wind direction indicators as shown on well site diagram (Exhibit #8).
- B. Caution/Danger signs (Exhibit #7) shall be posted on roads providing direct access to location. Signs will be painted a high visibility yellow with black lettering of sufficient size to be readable at a reasonable distance from the immediate location. Bilingual signs will be used, when appropriate. See example attached.

5. Mud program:

- A. The mud program has been designed to minimize the volume of H2S circulated to surface. Proper mud weight, safe drilling practices, and the use of H2S scavengers will minimize hazards when penetrating H2S bearing zones.

6. Metallurgy:

- A. All drill strings, casings, tubing, wellhead, blowout preventer, drilling spool, kill lines, choke manifold and lines, and valves shall be suitable for H₂S service.
- B. All elastomers used for packing and seals shall be H₂S trim.

7. Communication:

- A. Radio communications in company vehicles including cellular telephone and 2-way radio.
- B. Land line (telephone) communication at Office.

8. Well testing:

- A. Drill stem testing will be performed with a minimum number of personnel in the immediate vicinity, which are necessary to safely and adequately conduct the test. The drill stem testing will be conducted during daylight hours and formation fluids will not be flowed to the surface. All drill-stem-testing operations conducted in an H₂S environment will use the closed chamber method of testing.
- B. There will be no drill stem testing.

EXHIBIT #7

WARNING
YOU ARE ENTERING AN H₂S
AUTHORIZED PERSONNEL ONLY

- 1. BEARDS OR CONTACT LENSES NOT ALLOWED
- 2. HARD HATS REQUIRED
- 3. SMOKING IN DESIGNATED AREAS ONLY
- 4. BE WIND CONSCIOUS AT ALL TIMES
- 5. CHECK WITH COG OPERATING FOREMAN AT

COG OPERATING LLC
1-432-683-7443
1-575-746-2010

EDDY COUNTY EMERGENCY NUMBERS

ARTESIA FIRE DEPT. 575-746-5050
ARTESIA POLICE DEPT. 575-746-5000
EDDY CO. SHERIFF DEPT. 575-746-9888

LEA COUNTY EMERGENCY NUMBERS

HOBBS FIRE DEPT. 575-397-9308
HOBBS POLICE DEPT. 575-397-9285
LEA CO. SHERIFF DEPT. 575-396-1196

COG Operating LLC

EXHIBIT 8

Drilling Location - H2S Safety Equipment Diagram

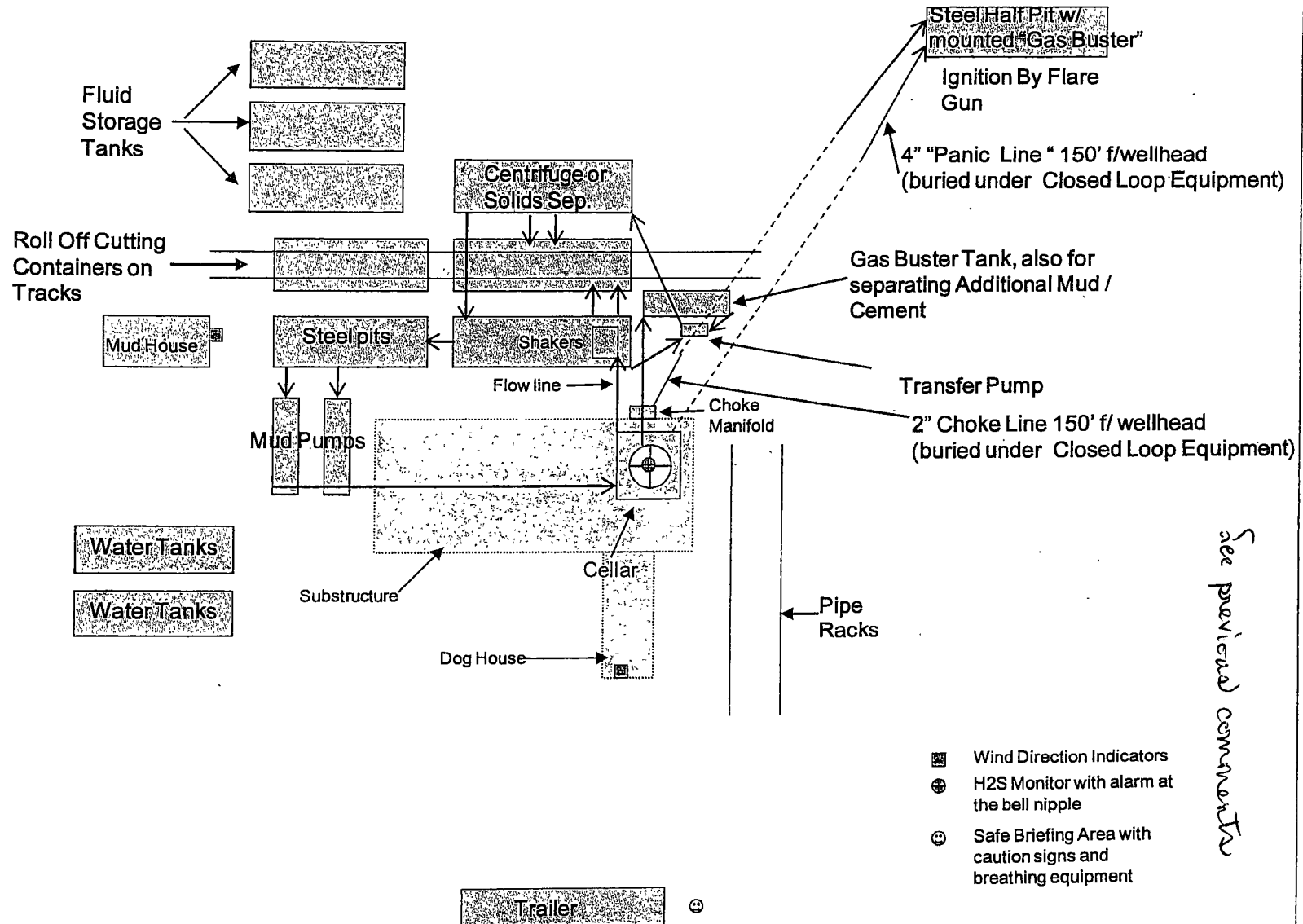

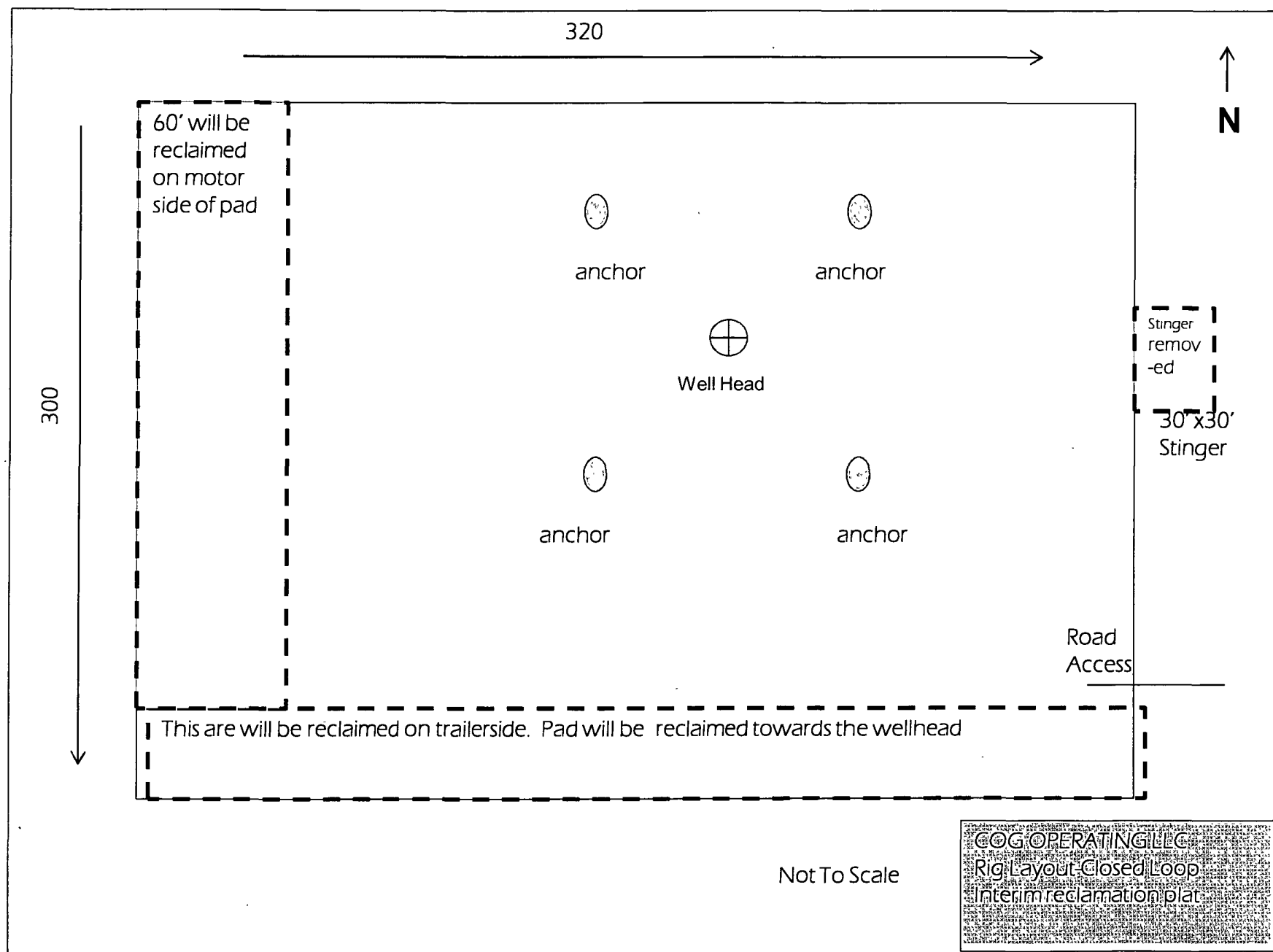

PECOS DISTRICT CONDITIONS OF APPROVAL

OPERATOR'S NAME:	COG Operating LLC
LEASE NO.:	NMLC058181
WELL NAME & NO.:	Beech 25 Federal 10H
SURFACE HOLE FOOTAGE:	330' FSL & 1650' FWL
BOTTOM HOLE FOOTAGE:	330' FSL & 1650' FEL
LOCATION:	Section 25, T. 17 S., R. 27 E., NMPM
COUNTY:	Eddy County, New Mexico

TABLE OF CONTENTS

Standard Conditions of Approval (COA) apply to this APD. If any deviations to these standards exist or special COAs are required, the section with the deviation or requirement will be checked below.

- ☐ **General Provisions**
- ☐ **Permit Expiration**
- ☐ **Archaeology, Paleontology, and Historical Sites**
- ☐ **Noxious Weeds**
- ☒ **Special Requirements**
 - Cave/karst**
- ☐ **Construction**
 - Notification
 - Topsoil
 - Closed Loop System
 - Federal Mineral Material Pits
 - Well Pads
 - Roads
- ☐ **Road Section Diagram**
- ☒ **Drilling**
 - High Cave/Karst
 - H2S requirement—Onshore Order #6
 - Waste Material and Fluids
- ☐ **Production (Post Drilling)**
 - Well Structures & Facilities
 - Pipelines
 - Electric Lines
- ☒ **Interim Reclamation**
- ☒ **Final Abandonment & Reclamation**

I. GENERAL PROVISIONS

The approval of the Application For Permit To Drill (APD) is in compliance with all applicable laws and regulations: 43 Code of Federal Regulations 3160, the lease terms, Onshore Oil and Gas Orders, Notices To Lessees, New Mexico Oil Conservation Division (NMOCD) Rules, National Historical Preservation Act As Amended, and instructions and orders of the Authorized Officer. Any request for a variance shall be submitted to the Authorized Officer on Form 3160-5, Sundry Notices and Report on Wells.

II. PERMIT EXPIRATION

If the permit terminates prior to drilling and drilling cannot be commenced within 60 days after expiration, an operator is required to submit Form 3160-5, Sundry Notices and Reports on Wells, requesting surface reclamation requirements for any surface disturbance. However, if the operator will be able to initiate drilling within 60 days after the expiration of the permit, the operator must have set the conductor pipe in order to allow for an extension of 60 days beyond the expiration date of the APD. (Filing of a Sundry Notice is required for this 60 day extension.)

III. ARCHAEOLOGICAL, PALEONTOLOGY & HISTORICAL SITES

Any cultural and/or paleontological resource discovered by the operator or by any person working on the operator's behalf shall immediately report such findings to the Authorized Officer. The operator is fully accountable for the actions of their contractors and subcontractors. The operator shall suspend all operations in the immediate area of such discovery until written authorization to proceed is issued by the Authorized Officer. An evaluation of the discovery shall be made by the Authorized Officer to determine the appropriate actions that shall be required to prevent the loss of significant cultural or scientific values of the discovery. The operator shall be held responsible for the cost of the proper mitigation measures that the Authorized Officer assesses after consultation with the operator on the evaluation and decisions of the discovery. Any unauthorized collection or disturbance of cultural or paleontological resources may result in a shutdown order by the Authorized Officer.

IV. NOXIOUS WEEDS

The operator shall be held responsible if noxious weeds become established within the areas of operations. Weed control shall be required on the disturbed land where noxious weeds exist, which includes the roads, pads, associated pipeline corridor, and adjacent land affected by the establishment of weeds due to this action. The operator shall consult with the Authorized Officer for acceptable weed control methods, which include following EPA and BLM requirements and policies.

V. SPECIAL REQUIREMENT(S)

Cave and Karst

** Depending on location, additional Drilling, Casing, and Cementing procedures may be required by engineering to protect critical karst groundwater recharge areas.

Cave/Karst Surface Mitigation

The following stipulations will be applied to minimize impacts during construction, drilling and production.

Construction:

In the advent that any underground voids are opened up during construction activities, construction activities will be halted and the BLM will be notified immediately.

No Blasting:

No blasting will be utilized for pad construction. The pad will be constructed and leveled by adding the necessary fill and caliche.

Tank Battery Liners and Berms:

Tank battery locations will be lined and bermed. A 20 mil permanent liner will be installed with a 4 oz. felt backing to prevent tears or punctures. Tank battery berms must be large enough to contain 1 ½ times the content of the largest tank.

Leak Detection System:

A method of detecting leaks is required. The method could incorporate gauges to measure loss, situating valves and lines so they can be visually inspected, or installing electronic sensors to alarm when a leak is present. Leak detection plan will be submitted to BLM for approval.

Automatic Shut-off Systems:

Automatic shut off, check valves, or similar systems will be installed for pipelines and tanks to minimize the effects of catastrophic line failures used in production or drilling.

Cave/Karst Subsurface Mitigation

The following stipulations will be applied to protect cave/karst and ground water concerns:

Rotary Drilling with Fresh Water:

Fresh water will be used as a circulating medium in zones where caves or karst features are expected. SEE ALSO: Drilling COAs for this well.

Directional Drilling:

Kick off for directional drilling will occur at least 100 feet below the bottom of the cave occurrence zone. SEE ALSO: Drilling COAs for this well.

Lost Circulation:

ALL lost circulation zones from the surface to the base of the cave occurrence zone will be logged and reported in the drilling report.

Regardless of the type of drilling machinery used, if a void of four feet or more and circulation losses greater than 70 percent occur simultaneously while drilling in any cave-bearing zone, the BLM will be notified immediately by the operator. The BLM will assess the situation and work with the operator on corrective actions to resolve the problem.

Abandonment Cementing:

Upon well abandonment in high cave karst areas additional plugging conditions of approval may be required. The BLM will assess the situation and work with the operator to ensure proper plugging of the wellbore.

Pressure Testing:

Annual pressure monitoring will be performed by the operator on all casing annuli and reported in a sundry notice. If the test results indicated a casing failure has occurred, remedial action will be undertaken to correct the problem to the BLM's approval.

VI. CONSTRUCTION

A. NOTIFICATION

The BLM shall administer compliance and monitor construction of the access road and well pad. Notify the Carlsbad Field Office at (575) 234-6235 at least 3 working days prior to commencing construction of the access road and/or well pad.

When construction operations are being conducted on this well, the operator shall have the approved APD and Conditions of Approval (COA) on the well site and they shall be made available upon request by the Authorized Officer.

B. TOPSOIL

The operator shall stockpile the topsoil in a low profile manner in order to prevent wind/water erosion of the topsoil. The topsoil to be stripped is approximately 4 inches in depth. The topsoil will be used for interim and final reclamation.

C. CLOSED LOOP SYSTEM

Tanks are required for drilling operations: No Pits.

The operator shall properly dispose of drilling contents at an authorized disposal site.

D. FEDERAL MINERAL MATERIALS PIT

Payment shall be made to the BLM prior to removal of any federal mineral materials. Call the Carlsbad Field Office at (575) 234-5972.

E. WELL PAD SURFACING

Surfacing of the well pad is not required.

If the operator elects to surface the well pad, the surfacing material may be required to be removed at the time of reclamation.

The well pad shall be constructed in a manner which creates the smallest possible surface disturbance, consistent with safety and operational needs.

F. ON LEASE ACCESS ROADS

Road Width

The access road shall have a driving surface that creates the smallest possible surface disturbance and does not exceed fourteen (14) feet in width. The maximum width of surface disturbance, when constructing the access road, shall not exceed twenty (20) feet.

Surfacing

Surfacing material is not required on the new access road driving surface. If the operator elects to surface the new access road or pad, the surfacing material may be required to be removed at the time of reclamation.

Where possible, no improvements should be made on the unsurfaced access road other than to remove vegetation as necessary, road irregularities, safety issues, or to fill low areas that may sustain standing water.

The Authorized Officer reserves the right to require surfacing of any portion of the access road at any time deemed necessary. Surfacing may be required in the event the road deteriorates, erodes, road traffic increases, or it is determined to be beneficial for future field development. The surfacing depth and type of material will be determined at the time of notification.

Crowning

Crowning shall be done on the access road driving surface. The road crown shall have a grade of approximately 2% (i.e., a 1" crown on a 14' wide road). The road shall conform to Figure 1; cross section and plans for typical road construction.

Ditching

Ditching shall be required on both sides of the road.

Turnouts

Vehicle turnouts shall be constructed on the road. Turnouts shall be intervisible with interval spacing distance less than 1000 feet. Turnouts shall be constructed on all blind curves. Turnouts shall conform to the following diagram:

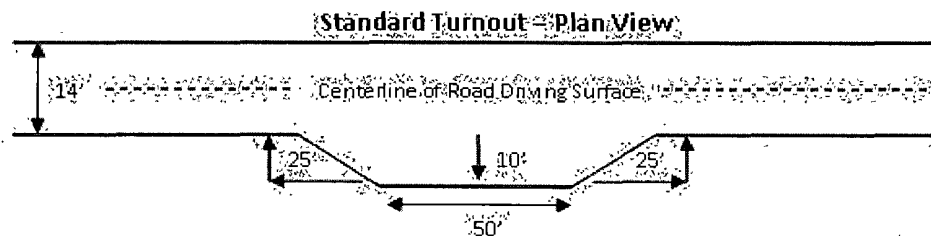

Drainage

Drainage control systems shall be constructed on the entire length of road (e.g. ditches, sidehill out sloping and insloping, lead-off ditches, culvert installation, and low water crossings).

A typical lead-off ditch has a minimum depth of 1 foot below and a berm of 6 inches above natural ground level. The berm shall be on the down-slope side of the lead-off ditch.

Cross Section of a Typical Lead-off Ditch

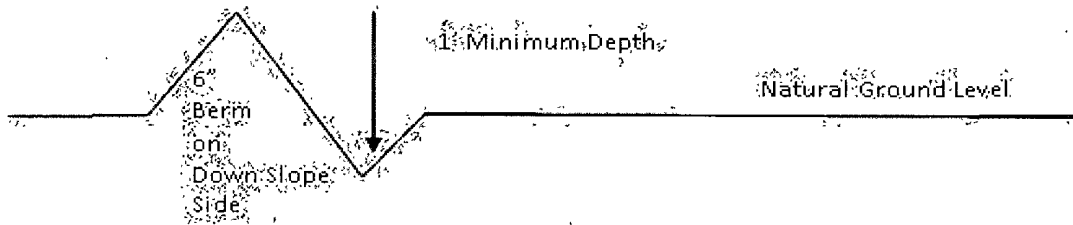

All lead-off ditches shall be graded to drain water with a 1 percent minimum to 3 percent maximum ditch slope. The spacing interval are variable for lead-off ditches and shall be determined according to the formula for spacing intervals of lead-off ditches, but may be amended depending upon existing soil types and centerline road slope (in %);

Formula for Spacing Interval of Lead-off Ditches

Example - On a 4% road slope that is 400 feet long, the water flow shall drain water into a lead-off ditch. Spacing interval shall be determined by the following formula:

$$400 \text{ foot road with } 4\% \text{ road slope: } \frac{400'}{4\%} + 100' = 200' \text{ lead-off ditch interval}$$

Culvert Installations

Appropriately sized culvert(s) shall be installed at the deep waterway channel flow crossing.

Cattleguards

An appropriately sized cattleguard(s) sufficient to carry out the project shall be installed and maintained at fence crossing(s).

Any existing cattleguard(s) on the access road shall be repaired or replaced if they are damaged or have deteriorated beyond practical use. The operator shall be responsible for the condition of the existing cattleguard(s) that are in place and are utilized during lease operations.

A gate shall be constructed and fastened securely to H-braces.

Fence Requirement

Where entry is required across a fence line, the fence shall be braced and tied off on both sides of the passageway prior to cutting.

The operator shall notify the private surface landowner or the grazing allotment holder prior to crossing any fence(s).

Public Access

Public access on this road shall not be restricted by the operator without specific written approval granted by the Authorized Officer.

Figure 1 – Cross Sections and Plans For Typical Road Sections

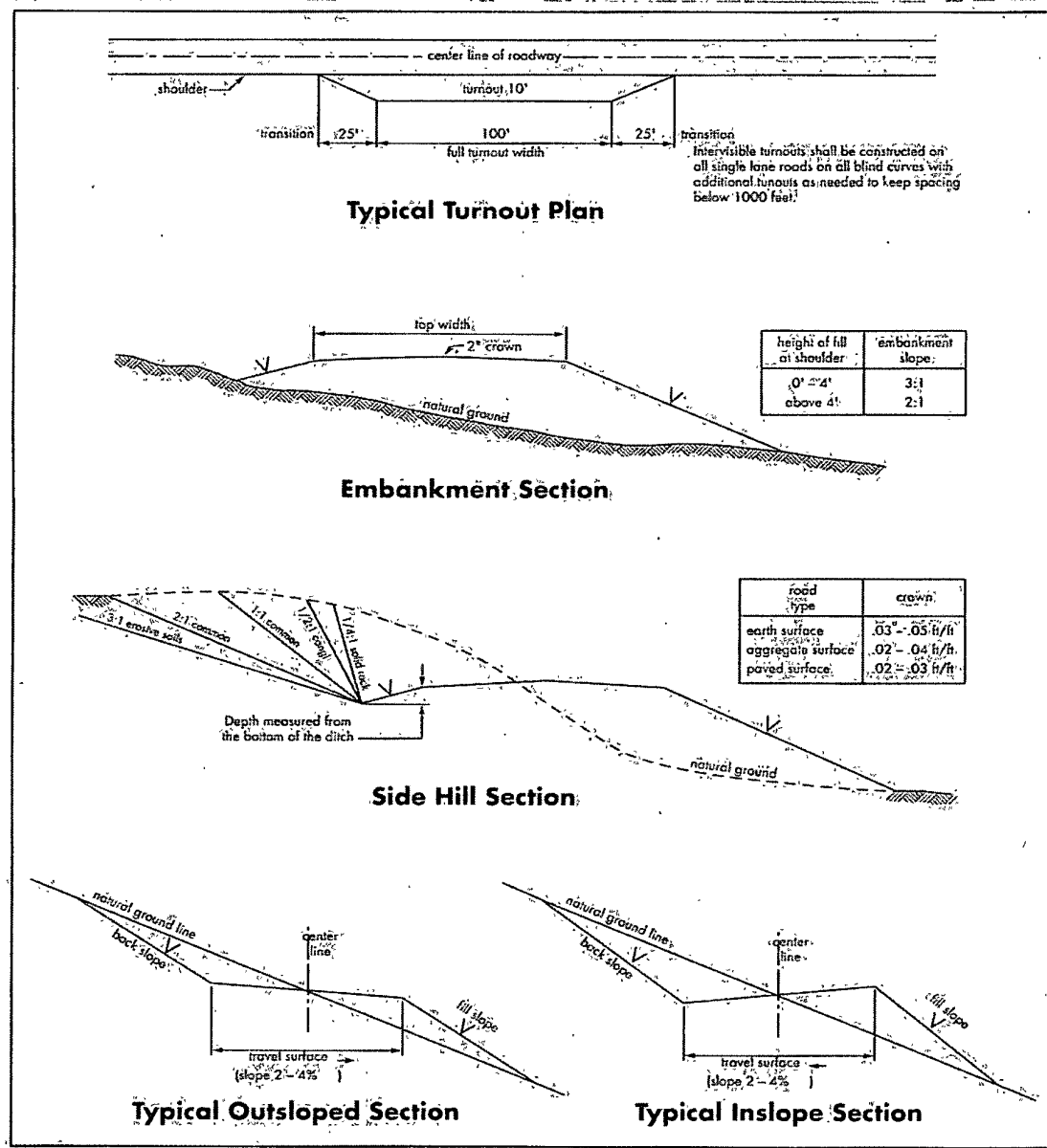

VII. DRILLING

A. DRILLING OPERATIONS REQUIREMENTS

The BLM is to be notified a minimum of 4 hours in advance for a representative to witness:

- a. Spudding well
- b. Setting and/or Cementing of all casing strings
- c. BOPE tests

☒ **Eddy County**

Call the Carlsbad Field Office, 620 East Greene St., Carlsbad, NM 88220,
(575) 361-2822

1. A Hydrogen Sulfide (H₂S) Drilling Plan should be activated prior to drilling the surface hole. **As a result, the Hydrogen Sulfide area must meet Onshore Order 6 requirements, which includes equipment and personnel/public protection items. If Hydrogen Sulfide is encountered, please provide measured values and formations to the BLM.**
2. Unless the production casing has been run and cemented or the well has been properly plugged, the drilling rig shall not be removed from over the hole without prior approval. **If the drilling rig is removed without approval – an Incident of Non-Compliance will be written and will be a “Major” violation.**
3. **The record of the drilling rate along with the GR/N well log run from TD to surface will be submitted to the BLM office as well as all other logs run on the borehole 30 days from completion. If available, a digital copy of the logs is to be submitted in addition to the paper copies. The top and bottom of Salt are to be recorded on the Completion Report.**

A. CASING

Changes to the approved APD casing program need prior approval if the items substituted are of lesser grade or different casing size. The Operator can exchange the components of the proposal with that of superior strength (i.e. changing from J-55 to N-80, or from 36# to 40#). Changes to the approved cement program need prior approval if the altered cement plan has less volume or strength or if the changes are substantial (i.e. Multistage tool, ECP, etc.).

Centralizers required on surface casing per Onshore Order 2.III.B.1.f.

Wait on cement (WOC) time prior to drilling out for a primary cement job will be a minimum 18 hours for a water basin, 24 hours in the potash area, or 500 pounds compressive strength, whichever is greater for all casing strings. **DURING THIS WOC TIME, NO DRILL PIPE, ETC. SHALL BE RUN IN THE HOLE.** Provide compressive strengths including hours to reach required 500 pounds compressive strength prior to cementing each casing string. See individual casing strings for details regarding lead cement slurry requirements.

No pea gravel permitted for remedial or fall back remedial without prior authorization from the BLM engineer.

HIGH CAVE/KARST

Possible lost circulation in the Grayburg and San Andres formations.

1. The **13-3/8** inch surface casing shall be set at **approximately 350 feet** and cemented to the surface.
 - a. If cement does not circulate to the surface, the appropriate BLM office shall be notified and a temperature survey utilizing an electronic type temperature survey with surface log readout will be used or a cement bond log shall be run to verify the top of the cement. Temperature survey will be run a minimum of six hours after pumping cement and ideally between 8-10 hours after completing the cement job.
 - b. **Wait on cement (WOC) time for a primary cement job is to include the lead cement slurry.**
 - c. Wait on cement (WOC) time for a remedial job will be a minimum of 4 hours after bringing cement to surface or 500 pounds compressive strength, whichever is greater.
 - d. If cement falls back, remedial cementing will be done prior to drilling out that string.
2. The minimum required fill of cement behind the **8-5/8** inch intermediate casing is:
Freshwater mud to be used to setting depth.

☒ As proposed. If cement does not circulate see B.1.a, c-d above.

Operator has proposed DV tool at depth of 400', but will adjust cement proportionately if moved. **DV tool SHALL be set a minimum of 50' below previous shoe and a minimum of 200' above current shoe.** Operator shall submit sundry if DV tool depth cannot be set in this range. If an ECP is used, it is to be set a minimum of 50' below the shoe to provide cement across the shoe. If it cannot be set below the shoe, a CBL shall be run to verify cement coverage.

a. First stage to DV tool:

- ☒ Cement to circulate. If cement does not circulate, contact the appropriate BLM office before proceeding with second stage cement job. Operator should have plans as to how they will achieve circulation on the next stage.

b. Second stage above DV tool:

- ☒ Cement to surface. If cement does not circulate, contact the appropriate BLM office.

3. The minimum required fill of cement behind the **7 X 5-1/2** inch production casing is:

- ☒ Cement from kickoff point to surface via DV tool and packer completion system below DV tool. If cement does not circulate, contact the appropriate BLM office.

Operator has proposed DV tool at depth of 1800', but will adjust cement proportionately if moved. DV tool shall be set a minimum of 50' below previous shoe and a minimum of 200' above current shoe. Operator shall submit sundry if DV tool depth cannot be set in this range.

a. First stage to DV tool:

- ☒ Cement not required. **Packer system will be used**

b. Second stage above DV tool:

- ☒ Cement to circulate. If cement does not circulate, contact the appropriate BLM office before proceeding with third stage cement job. Operator should have plans as to how they will achieve circulation on the next stage.

c. Third stage above DV tool:

- ☒ Cement to surface. If cement does not circulate, contact the appropriate BLM office.

4. If hardband drill pipe is rotated inside casing, returns will be monitored for metal. If metal is found in samples, drill pipe will be pulled and rubber protectors which have a larger diameter than the tool joints of the drill pipe will be installed prior to continuing drilling operations.

B. PRESSURE CONTROL

1. All blowout preventer (BOP) and related equipment (BOPE) shall comply with well control requirements as described in Onshore Oil and Gas Order No. 2 and API RP 53 Sec. 17. **Operator approved for either 13-5/8" or 11" BOP stack.**
2. Proposed blowout preventer (BOP) and related equipment (BOPE) meets minimum requirement.
 - a. **For surface casing only:** If the BOP/BOPE is to be tested against casing, the wait on cement (WOC) time for that casing is to be met (see WOC statement at start of casing section). Independent service company required.
3. The appropriate BLM office shall be notified a minimum of 4 hours in advance for a representative to witness the tests.
 - a. In a water basin, for all casing strings utilizing slips, these are to be set as soon as the crew and rig are ready and any fallback cement remediation has been done. The casing cut-off and BOP installation can be initiated four hours after installing the slips, which will be approximately six hours after bumping the plug. For those casing strings not using slips, the minimum wait time before cut-off is eight hours after bumping the plug. BOP/BOPE testing can begin after cut-off or once cement reaches 500 psi compressive strength (including lead when specified), whichever is greater. However, if the float does not hold, cut-off cannot be initiated until cement reaches 500 psi compressive strength (including lead when specified).
 - b. The tests shall be done by an independent service company utilizing a test plug **not a cup or J-packer**. The operator also has the option of utilizing an independent tester to test without a plug (i.e. against the casing) pursuant to Onshore Order 2 with the pressure not to exceed 70% of the burst rating for the casing. Any test against the casing must meet the WOC time for water basin (18 hours) or potash (24 hours) or 500 pounds compressive strength, whichever is greater, prior to initiating the test (see casing segment as lead cement may be critical item).
 - c. The results of the test shall be reported to the appropriate BLM office.
 - d. All tests are required to be recorded on a calibrated test chart. **A copy of the BOP/BOPE test chart and a copy of independent service company test will be submitted to the appropriate BLM office.**
 - e. The BOP/BOPE test shall include a low pressure test from 250 to 300 psi. The test will be held for a minimum of 10 minutes if test is done with a test plug and 30 minutes without a test plug.

C. DRILL STEM TEST

If drill stem tests are performed, Onshore Order 2.III.D shall be followed.

D. WASTE MATERIAL AND FLUIDS

All waste (i.e. drilling fluids, trash, salts, chemicals, sewage, gray water, etc.) created as a result of drilling operations and completion operations shall be safely contained and disposed of properly at a waste disposal facility. No waste material or fluid shall be disposed of on the well location or surrounding area.

Porto-johns and trash containers will be on-location during fracturing operations or any other crew-intensive operations.

CRW 041912

VIII. PRODUCTION (POST DRILLING)

A. WELL STRUCTURES & FACILITIES

Placement of Production Facilities

Production facilities should be placed on the well pad to allow for maximum interim recontouring and revegetation of the well location.

Containment Structures

The containment structure shall be constructed to hold the capacity of the entire contents of the largest tank, plus 24 hour production, unless more stringent protective requirements are deemed necessary by the Authorized Officer.

Painting Requirement

All above-ground structures including meter housing that are not subject to safety requirements shall be painted a flat non-reflective paint color
Shale Green, Munsell Soil Color Chart # 5Y 4/2

B. PIPELINES

STANDARD STIPULATIONS FOR SURFACE INSTALLED PIPELINES

A copy of the APD and attachments, including stipulations, survey plat and/or map, will be on location during construction. BLM personnel may request to you a copy of your permit during construction to ensure compliance with all stipulations.

Holder agrees to comply with the following stipulations to the satisfaction of the Authorized Officer:

1. The holder shall indemnify the United States against any liability for damage to life or property arising from the occupancy or use of public lands under this grant.
2. The holder shall comply with all applicable Federal laws and regulations existing or hereafter enacted or promulgated. In any event, the holder shall comply with the Toxic Substances Control Act of 1976 as amended, 15 USC 2601 et seq. (1982) with regards to any toxic substances that are used, generated by or stored on the right-of-way or on facilities authorized under this right-of-way grant. (See 40 CFR, Part 702-799 and especially, provisions on polychlorinated biphenyls, 40 CFR 761.1-761.193.) Additionally, any release of toxic substances (leaks, spills, etc.) in excess of the reportable quantity established by 40 CFR, Part 117 shall be reported as required by the Comprehensive Environmental Response, Compensation, and Liability Act, section 102b. A copy of any report required or requested by any Federal agency or State government as a result of a reportable release or spill of any toxic substances shall be furnished to the authorized officer concurrent with the filing of the reports to the involved Federal agency or State government.

3. The holder agrees to indemnify the United States against any liability arising from the release of any hazardous substance or hazardous waste (as these terms are defined in the Comprehensive Environmental Response, Compensation and Liability Act of 1980, 42 U.S.C. 9601, et seq. or the Resource Conservation and Recovery Act, 42 U.S.C. 6901, et seq.) on the Right-of-Way (unless the release or threatened release is wholly unrelated to activity of the Right-of-Way holder's activity on the Right-of-Way), or resulting from the activity of the Right-of-Way holder on the Right-of-Way. This agreement applies without regard to whether a release is caused by the holder, its agent, or unrelated third parties.

4. The holder shall be liable for damage or injury to the United States to the extent provided by 43 CFR Sec. 2883.1-4. The holder shall be held to a standard of strict liability for damage or injury to the United States resulting from pipe rupture, fire, or spills caused or substantially aggravated by any of the following within the right-of-way or permit area:

- a. Activities of the holder including, but not limited to construction, operation, maintenance, and termination of the facility.
- b. Activities of other parties including, but not limited to:
 - (1) Land clearing.
 - (2) Earth-disturbing and earth-moving work.
 - (3) Blasting.
 - (4) Vandalism and sabotage.
- c. Acts of God.

The maximum limitation for such strict liability damages shall not exceed one million dollars (\$1,000,000) for any one event, and any liability in excess of such amount shall be determined by the ordinary rules of negligence of the jurisdiction in which the damage or injury occurred.

This section shall not impose strict liability for damage or injury resulting primarily from an act of war or from the negligent acts or omissions of the United States.

5. If, during any phase of the construction, operation, maintenance, or termination of the pipeline; any oil, salt water, or other pollutant should be discharged from the pipeline system, impacting Federal lands, the control and total removal, disposal, and cleaning up of such oil, salt water, or other pollutant, wherever found, shall be the responsibility of the holder, regardless of fault. Upon failure of the holder to control, dispose of, or clean up such discharge on or affecting Federal lands, or to repair all damages resulting therefrom, on the Federal lands, the Authorized Officer may take such measures as he deems necessary to control and clean up the discharge and restore the area, including, where appropriate, the aquatic environment and fish and wildlife habitats, at the full

expense of the holder. Such action by the Authorized Officer shall not relieve the holder of any responsibility as provided herein.

6. All construction and maintenance activity will be confined to the authorized right-of-way width of 20 feet.

7. No blading or clearing of any vegetation will be allowed unless approved in writing by the Authorized Officer.

8. The holder shall install the pipeline on the surface in such a manner that will minimize suspension of the pipeline across low areas in the terrain. In hummocky or dune areas, the pipeline will be "snaked" around hummocks and dunes rather than suspended across these features.

9. The pipeline shall be buried with a minimum of 24 inches under all roads, "two-tracks," and trails. Burial of the pipe will continue for 20 feet on each side of each crossing. The condition of the road, upon completion of construction, shall be returned to at least its former state with no bumps or dips remaining in the road surface.

10. The holder shall minimize disturbance to existing fences and other improvements on public lands. The holder is required to promptly repair improvements to at least their former state. Functional use of these improvements will be maintained at all times. The holder will contact the owner of any improvements prior to disturbing them. When necessary to pass through a fence line, the fence shall be braced on both sides of the passageway prior to cutting of the fence. No permanent gates will be allowed unless approved by the Authorized Officer.

11. In those areas where erosion control structures are required to stabilize soil conditions, the holder will install such structures as are suitable for the specific soil conditions being encountered and which are in accordance with sound resource management practices.

12. Excluding the pipe, all above-ground structures not subject to safety requirement shall be painted by the holder to blend with the natural color of the landscape. The paint used shall be a color which simulates "Standard Environmental Colors" – **Shale Green**, Munsell Soil Color No. 5Y 4/2; designated by the Rocky Mountain Five State Interagency Committee.

13. The pipeline will be identified by signs at the point of origin and completion of the right-of-way and at all road crossings. At a minimum, signs will state the holder's name, BLM serial number, and the product being transported. Signs will be maintained in a legible condition for the life of the pipeline.

14. The holder shall not use the pipeline route as a road for purposes other than routine maintenance as determined necessary by the Authorized Officer in consultation with the holder. The holder will take whatever steps are necessary to ensure that the pipeline

route is not used as a roadway.

15. Any cultural and/or paleontological resource (historic or prehistoric site or object) discovered by the holder, or any person working on his behalf, on public or Federal land shall be immediately reported to the authorized officer. Holder shall suspend all operations in the immediate area of such discovery until written authorization to proceed is issued by the authorized officer. An evaluation of the discovery will be made by the authorized officer to determine appropriate cultural or scientific values. The holder will be responsible for the cost of evaluation and any decision as to proper mitigation measures will be made by the authorized officer after consulting with the holder.

C. ELECTRIC LINES (not applied for in APD)

IX. INTERIM RECLAMATION

During the life of the development, all disturbed areas not needed for active support of production operations should undergo interim reclamation in order to minimize the environmental impacts of development on other resources and uses.

Within six (6) months of well completion, operators should work with BLM surface management specialists (Jim Amos: 575-234-5909) to devise the best strategies to reduce the size of the location. Interim reclamation should allow for remedial well operations, as well as safe and efficient removal of oil and gas.

During reclamation, the removal of caliche is important to increasing the success of revegetating the site. Removed caliche that is free of contaminants may be used for road repairs, fire walls or for building other roads and locations. In order to operate the well or complete workover operations, it may be necessary to drive, park and operate on restored interim vegetation within the previously disturbed area. Disturbing revegetated areas for production or workover operations will be allowed. If there is significant disturbance and loss of vegetation, the area will need to be revegetated. Communicate with the appropriate BLM office for any exceptions/exemptions if needed.

All disturbed areas after they have been satisfactorily prepared need to be reseeded with the seed mixture provided below.

Upon completion of interim reclamation, the operator shall submit a Sundry Notices and Reports on Wells, Subsequent Report of Reclamation (Form 3160-5).

X. FINAL ABANDONMENT & RECLAMATION

At final abandonment, well locations, production facilities, and access roads must undergo "final" reclamation so that the character and productivity of the land are restored.

Earthwork for final reclamation must be completed within six (6) months of well plugging. All pads, pits, facility locations and roads must be reclaimed to a satisfactory revegetated, safe, and stable condition, unless an agreement is made with the landowner or BLM to keep the road and/or pad intact.

After all disturbed areas have been satisfactorily prepared, these areas need to be revegetated with the seed mixture provided below. Seeding should be accomplished by drilling on the contour whenever practical or by other approved methods. Seeding may need to be repeated until revegetation is successful, as determined by the BLM.

Operators shall contact a BLM surface protection specialist prior to surface abandonment operations for site specific objectives (Jim Amos: 575-234-5909).

Seed Mixture 4, for Gypsum Sites

The holder shall seed all disturbed areas with the seed mixture listed below. The seed mixture shall be planted in the amounts specified in pounds of pure live seed (PLS)* per acre. There shall be no primary or secondary noxious weeds in the seed mixture. Seed will be tested and the viability testing of seed will be done in accordance with State law(s) and within nine (9) months prior to purchase. Commercial seed will be either certified or registered seed. The seed container will be tagged in accordance with State law(s) and available for inspection by the authorized officer.

Seed will be planted using a drill equipped with a depth regulator to ensure proper depth of planting where drilling is possible. The seed mixture will be evenly and uniformly planted over the disturbed area (smaller/heavier seeds have a tendency to drop the bottom of the drill and are planted first). The holder shall take appropriate measures to ensure this does not occur. Where drilling is not possible, seed will be broadcast and the area shall be raked or chained to cover the seed. When broadcasting the seed, the pounds per acre are to be doubled. The seeding will be repeated until a satisfactory stand is established as determined by the authorized officer. Evaluation of growth will not be made before completion of at least one full growing season after seeding.

Species to be planted in pounds of pure live seed* per acre:

<u>Species</u>	<u>lb/acre</u>
Alkali Sacaton (<i>Sporobolus airoides</i>)	1.0
DWS Four-wing saltbush (<i>Atriplex canescens</i>)	5.0

DWS: DeWinged Seed

*Pounds of pure live seed:

Pounds of seed x percent purity x percent germination = pounds pure live seed