

DISTRICT I
1625 N. French Dr., Hobbs, NM 88240
DISTRICT II
1301 W. Grand Avenue, Artesia, NM 88210
DISTRICT III
1000 Rio Brazos Rd., Aztec, NM 87410
DISTRICT IV
1220 S. St. Francis Dr., Santa Fe, NM 87505

State of New Mexico
Energy, Minerals and Natural Resources Department

Form C-102
Revised July 16, 2010
Submit one copy to appropriate
District Office

OIL CONSERVATION DIVISION

1220 South St. Francis Dr.
Santa Fe, New Mexico 87505

WELL LOCATION AND ACREAGE DEDICATION PLAT

☐ AMENDED REPORT

API Number 30-015-20940	Pool Code 97077	Pool Name U.S.-Bone Spring
Property Code 305860	Property Name BIG EDDY UNIT	Well Number 38H
OGRID No. 260737	Operator Name BOPCO, L.P.	Elevation 3428'

Surface Location

UL or lot No.	Section	Township	Range	Lot Idn	Feet from the	North/South line	Feet from the	East/West line	County
C	34	21 S	29 E		660	NORTH	1980	WEST	EDDY

Bottom Hole Location If Different From Surface

UL or lot No.	Section	Township	Range	Lot Idn	Feet from the	North/South line	Feet from the	East/West line	County
XO	35	21 S	29 E		359	SOUTH	1948	EAST	EDDY
Dedicated Acres 480	Joint or Infill	Consolidation Code	Order No.						

NO ALLOWABLE WILL BE ASSIGNED TO THIS COMPLETION UNTIL ALL INTERESTS HAVE BEEN CONSOLIDATED
OR A NON-STANDARD UNIT HAS BEEN APPROVED BY THE DIVISION

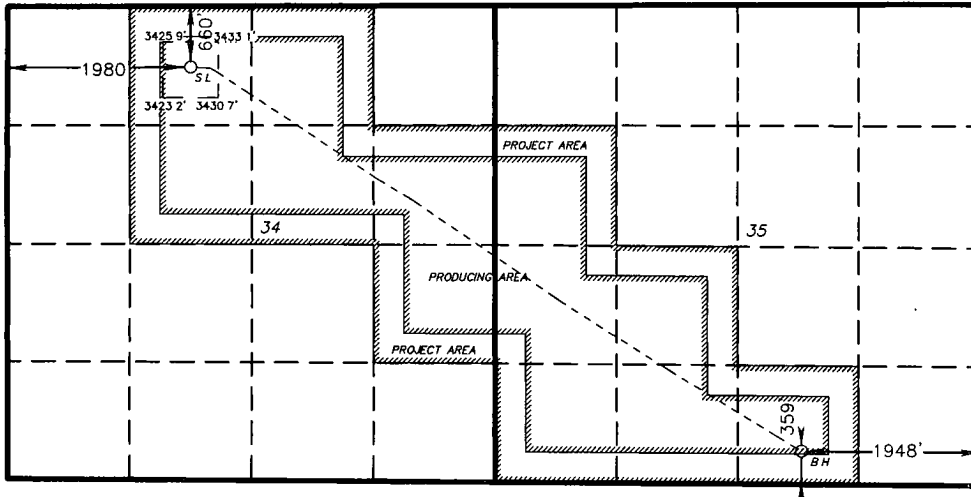

SURFACE LOCATION
Lat - N 32°26'28.26"
Long - W 103°58'26.77"
NMSPCE- N 524402.803
E 610823.032
(NAD-27)

BOTTOM HOLE LOCATION
Lat - N 32°25'46.70"
Long - W 103°57'09.36"
NMSPCE- N 520225.96
E 617472.38
(NAD-27)

NOTE: SURVEY CERTIFICATION
IS FOR SURFACE LOCATION ONLY

RECEIVED
APR 30 2012
NMOCD ARTESIA

OPERATOR CERTIFICATION

I hereby certify that the information contained herein is true and complete to the best of my knowledge and belief, and that this organization either owns a working interest or unleased mineral interest in the land including the proposed bottom hole location or has a right to drill this well at this location pursuant to a contract with an owner of such a mineral or working interest, or to a voluntary pooling agreement or a compulsory pooling order heretofore entered by the division.

Sandra J. Belt 4-26-12
Signature Date
Sandra J. Belt
Printed Name
sjbelt@basspet.com
Email Address

SURVEYOR CERTIFICATION

I hereby certify that the well location shown on this plat was plotted from field notes of actual surveys made by me or under my supervision, and that the same is true and correct to the best of my belief.

MARGARY L. JONES
Date Surveyed
Signature & Seal of
Professional Surveyor
W.O. 115500050

Certificate No. Gary L. Jones 7977
BASIN SURVEYS 24660