

District I
1625 N. French Dr., Hobbs, NM 88240

District II
1301 W. Grand Avenue, Artesia, NM 88210

District III
1000 Rio Brazos Rd., Aztec, NM 87410

District IV
1220 S. St. Francis Dr., Santa Fe, NM 87505

State of New Mexico
Energy, Minerals & Natural Resources Department
OIL CONSERVATION DIVISION
1220 South St. Frances Dr.
Santa Fe, NM 87505

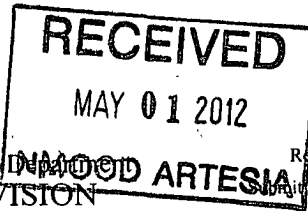

Form C-102
Revised October 15, 2009
Submit one copy to appropriate
District Office

☐ AMENDED REPORT

WELL LOCATION AND ACREAGE DEDICATION PLAT

1 API Number 30-015-37765	2 Pool Code 96610	3 Pool Name EMPIRE; GLORIETA-YESO, EAST
4 Property Code 37902	5 Property Name HATFIELD STATE	6 Well Number 2
7 OGRID No 229137	8 Operator Name COG OPERATING LLC	9 Elevation 3621.3

10 Surface Location

UL or lot N	Section 8	Township 17 S	Range 29 E	Lot Idn	Feet from the 990	North/South line SOUTH	Feet from the 2310	East/West line WEST	County EDDY
----------------	--------------	------------------	---------------	---------	----------------------	---------------------------	-----------------------	------------------------	----------------

11 Bottom Hole Location If Different From Surface

UL or lot	Section	Township	Range	Lot Idn	Feet from the	North/South line	Feet from the	East/West line	County
12 Dedicated Acres 40	13 Joint or Infill	14 Consolidation Code	15 Order No						

No allowable will be assigned to this completion until all interests have been consolidated or a non-standard unit has been approved by the division

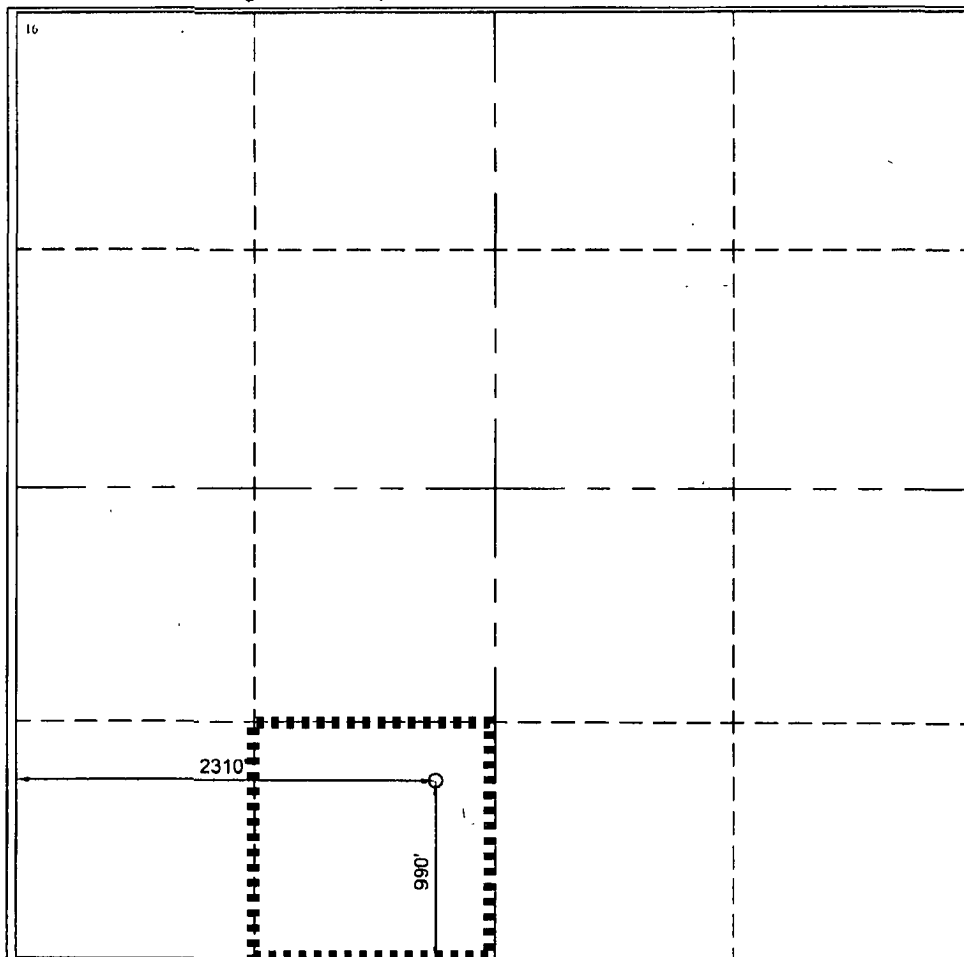

17 OPERATOR CERTIFICATION

I hereby certify that the information contained herein is true and complete to the best of my knowledge and belief, and that this organization either owns a working interest or unleased mineral interest in the land including the proposed bottom hole location or has a right to drill this well at this location pursuant to a contract with an owner of such a mineral or working interest, or to a voluntary pooling agreement or a compulsory pooling order heretofore enter by the division.

 4/26/12
Signature Date

Chasity Jackson
Printed Name

18 SURVEYOR CERTIFICATION

I hereby certify that the well location shown on this plat was plotted from field notes of actual surveys made by me or under my supervision, and that the same is true and correct to the best of my belief.

02/23/2010
Date of Survey

Signature and Seal of Professional Surveyor

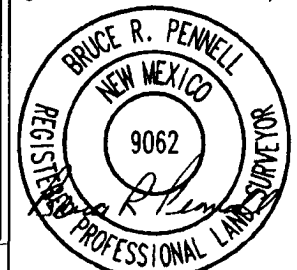

NAD27 GEOGRAPHIC COORDINATES

NAD27 SPC - NM EAST

LAT: 32.84444

LON: -104.09757

X = 572408.0

Y = 670998.1

Bruce R. Pennell
Certificate Number 9062