

District I
 1625 N. French Dr., Hobbs, NM 88240
 District II
 1301 W. Grand Avenue, Artesia, NM 88210
 District III
 1009 Rio Brazos Road, Aztec, NM 87410
 District IV
 1220 S. St. Francis Dr., Santa Fe, NM 87505

State of New Mexico
 Energy Minerals and Natural Resources

Form C-144
 June 1, 2004

Oil Conservation Division
 1220 South St. Francis Dr.
 Santa Fe, NM 87505

For drilling and production facilities, submit to appropriate NMOCD District Office.
 For downstream facilities, submit to Santa Fe office

Pit or Below-Grade Tank Registration or Closure

Is pit or below-grade tank covered by a "general plan"? Yes No

Type of action: Registration of a pit or below-grade tank Closure of a pit or below-grade tank

Operator: Pogo Producing Company Telephone: 432-685-8100 e-mail address: wrightc@pogoproducing.com
 Address: P. O. Box 10340, Midland, TX 79702-7340
 Facility or well name: Harroun 10 #4 API #: 30-015-32618 U/L or Qtr/Qtr K Sec 10 T 24 R 29
 County: Eddy County Latitude 32:13:51.35 Longitude 103:58:24.2 NAD: 1927 1983
 Surface Owner: Federal State Private Indian

<u>Pit</u>	<u>Below-grade tank</u>	
Type: Drilling <input checked="" type="checkbox"/> Production <input type="checkbox"/> Disposal <input type="checkbox"/> Workover <input type="checkbox"/> Emergency <input type="checkbox"/> Lined <input checked="" type="checkbox"/> Unlined <input type="checkbox"/> Liner type: Synthetic <input checked="" type="checkbox"/> Thickness <u>12</u> mil Clay <input type="checkbox"/> Pit Volume <u>2300</u> bbl	Volume: _____ bbl Type of fluid: _____ Construction material: _____ Double-walled, with leak detection? Yes <input type="checkbox"/> If not, explain why not.	
Depth to ground water (vertical distance from bottom of pit to seasonal high water elevation of ground water.)	Less than 50 feet 50 feet or more, but less than 100 feet 100 feet or more	(20 points) (10 points) (0 points) 0
Wellhead protection area: (Less than 200 feet from a private domestic water source, or less than 1000 feet from all other water sources.)	Yes No	(20 points) (0 points) 0
Distance to surface water: (horizontal distance to all wetlands, playas, irrigation canals, ditches, and perennial and ephemeral watercourses.)	Less than 200 feet 200 feet or more, but less than 1000 feet 1000 feet or more	(20 points) (10 points) (0 points) 0
Ranking Score (Total Points)		0

RECEIVED
JUN 10 2005
ODD-ARTESIA

If this is a pit closure: (1) Attach a diagram of the facility showing the pit's relationship to other equipment and tanks. (2) Indicate disposal location: (check the onsite box if your are burying in place) onsite offsite . If offsite, name of facility _____. (3) Attach a general description of remedial action taken including remediation start date and end date. (4) Groundwater encountered: No Yes . If yes, show depth below ground surface _____ ft. and attach sample results. (5) Attach soil sample results and a diagram of sample locations and excavations.

Additional Comments: Constructed before 4/15/04

I hereby certify that the information above is true and complete to the best of my knowledge and belief. I further certify that the above-described pit or below-grade tank has been/will be constructed or closed according to NMOCD guidelines , a general permit , or an (attached) alternative OCD-approved plan .

Date: 06/09/05
 Printed Name/Title Cathy Wright, Sr. Eng Tech Signature Cathy Wright
 Your certification and NMOCD approval of this application/closure does not relieve the operator of liability should the contents of the pit or tank contaminate ground water or otherwise endanger public health or the environment. Nor does it relieve the operator of its responsibility for compliance with any other federal, state, or local laws and/or regulations.

Approval: [Signature] Signature [Signature] Date: JUN 14 2005
 Printed Name/Title _____ Signature _____ Date: _____

Pit Closing Procedure:

Pits are dewatered. Dirt contractor digs a deep bury pit adjacent to the drilling pit. Deep bury pit is lined with 12 mil plastic. Dirt contractor pushes contents of drilling pit into the deep bury pit. Deep bury pit is capped with 20 mil plastic then covered with 3 feet of fill dirt.

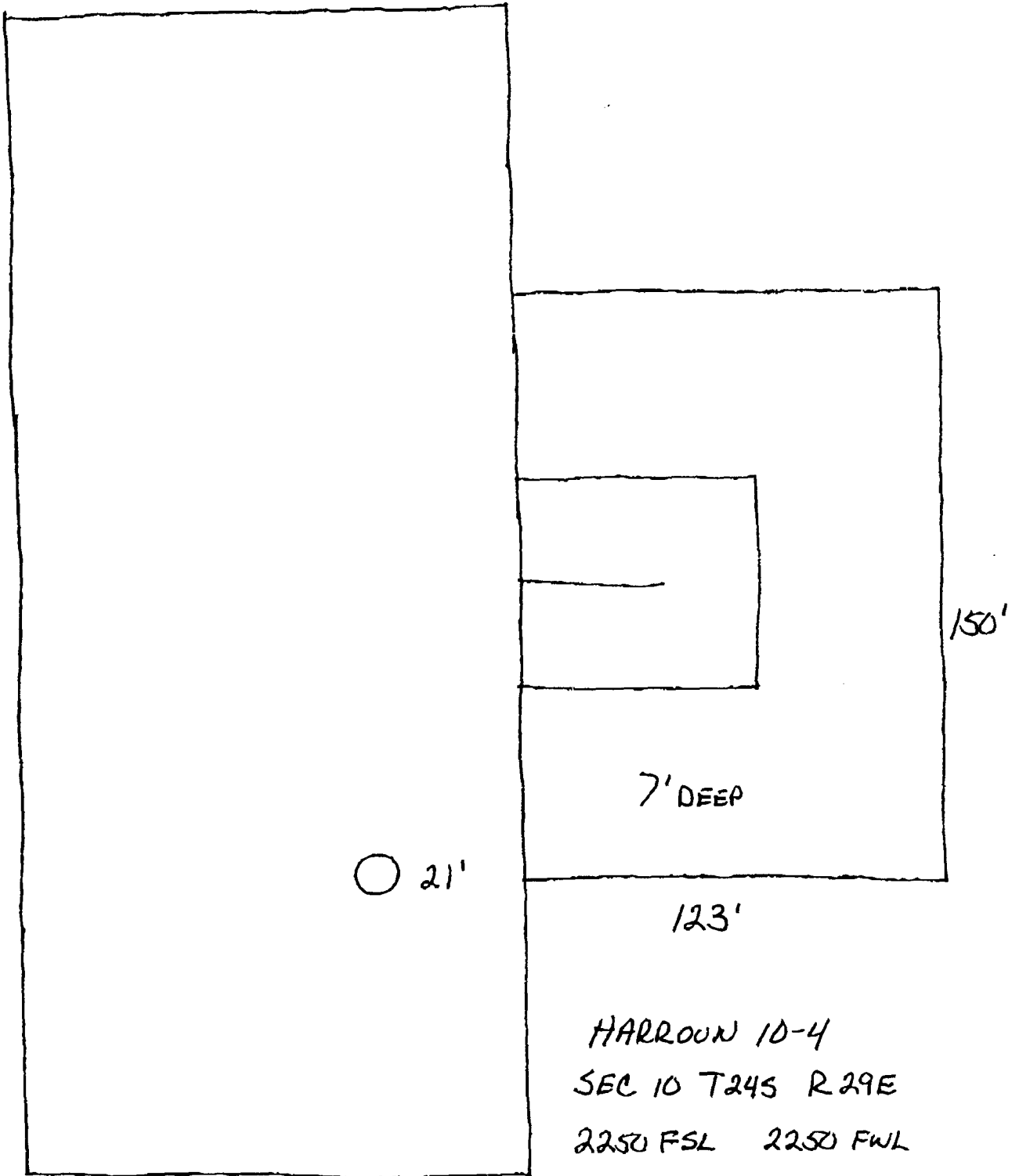

○ 21'

150'

7' DEEP

123'

HARROUN 10-4
 SEC 10 T24S R29E
 2250 FSL 2250 FWL

EDDY CO.

30-015 - 32618
 32:13:51.35
 103:58:24.2