

State of New Mexico
Energy, Minerals & Natural Resources Department
OIL CONSERVATION DIVISION
1220 South St. Francis
Santa Fe, New Mexico 87505

Revised August 1, 2011

Submit one copy to appropriate
District Office

☒ AMENDED REPORT

WELL LOCATION AND ACREAGE DEDICATION PLAT

"As Drilled"

API Number	Pool Code	Pool Name
30-015-41153	97949	WC-015 S2528150; Wolfcamp
Property Code	Property Name	Well Number
39278	SAN LORENZO 22/27 LE	2H
OGRID No.	Operator Name	Elevation
14744	MEWBOURNE OIL COMPANY	2984.5'

Surface Location

UL or lot no.	Section	Township	Range	Lot Idn	Feet from the	North/South line	Feet from the	East/West line	County
L	22	25 S	28 E		2260	SOUTH	760	WEST	EDDY

Bottom Hole Location If Different From Surface

UL or lot no.	Section	Township	Range	Lot Idn	Feet from the	North/South line	Feet from the	East/West line	County
E	27	25 S	28 E		2309	NORTH	770	WEST	EDDY

Dedicated Acres	Joint or Infill	Consolidated Code	Order No.
320			

No allowable will be assigned to this completion until all interests have been consolidated or a non-standard unit has been approved by the division.

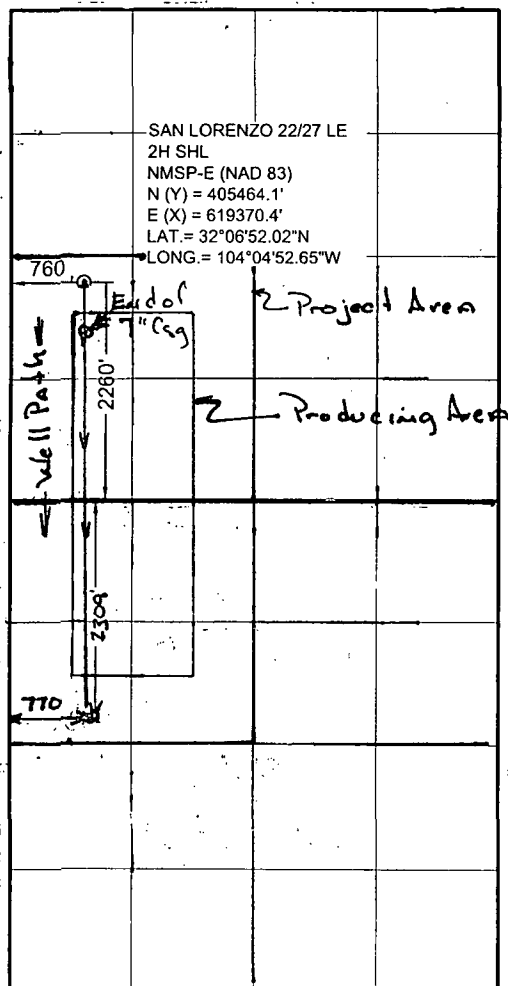

OPERATOR CERTIFICATION

I hereby certify that the information contained herein is true and complete to the best of my knowledge and belief, and that this organization either owns a working interest or unleased mineral interest in the land including the proposed bottom hole location or has a right to drill this well at this location pursuant to a contract with an owner of such a mineral or working interest, or to voluntary pooling agreement or a compulsory pooling order heretofore entered by the division.

Signature A.M. Gray Date 8/16/13

Signature [Signature] Date 01/16/15
Print Name N. M. Young

E-mail Address _____

SURVEYORS CERTIFICATION

I hereby certify that the well location shown on this plat was plotted from field notes of actual surveys made by me or under my supervision, and that the same is true and correct to the best of my belief.

February 15, 2013

Date of Survey _____

Signature and Seal of Professional Surveyor

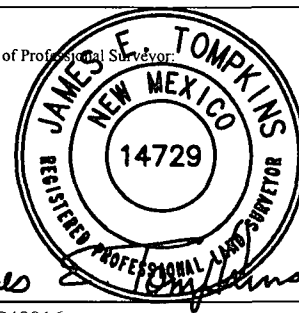

Job No.: WTC48916

JAMES E. TOMPKINS 14729

Certificate Number