

DISTRICT I
1626 N. French Dr., Hobbs, NM 88240

DISTRICT II
1301 W. Grand Avenue, Artesia, NM 88210

DISTRICT III
1000 Rio Brazos Rd., Aztec, NM 87410

DISTRICT IV
1220 S. St. Francis Dr., Santa Fe, NM 87505

State of New Mexico
Energy, Minerals and Natural Resources Department

Form C-102
Revised July 16, 2010

Submit one copy to appropriate
District Office

OIL CONSERVATION DIVISION

1220 South St. Francis Dr.
Santa Fe, New Mexico 87505

WELL LOCATION AND ACREAGE DEDICATION PLAT

☒ AMENDED REPORT
"As drilled"

API Number 30-015-40498	Pool Code 97650	Pool Name WC Williams Sink; Bone Spring
Property Code 30586	Property Name BIG EDDY UNIT	Well Number 250H
OGRID No. 260737	Operator Name BOPCO, L.P.	Elevation 3479'

Surface Location

UL or lot No.	Section	Township	Range	Lot Idn	Feet from the	North/South line	Feet from the	East/West line	County
1	35	19 S	31 E		1980	SOUTH	10	EAST	EDDY

Bottom Hole Location If Different From Surface

UL or lot No.	Section	Township	Range	Lot Idn	Feet from the	North/South line	Feet from the	East/West line	County
1	34	19 S	31 E		1969	SOUTH	1156	EAST	EDDY

Dedicated Acres 200	Joint or Infill	Consolidation Code	Order No.
------------------------	-----------------	--------------------	-----------

NO ALLOWABLE WILL BE ASSIGNED TO THIS COMPLETION UNTIL ALL INTERESTS HAVE BEEN CONSOLIDATED
OR A NON-STANDARD UNIT HAS BEEN APPROVED BY THE DIVISION

**PROPOSED BOTTOM
HOLE LOCATION**
Lat - N 32°36'53.89"
Long - W 103°51'06.12"
NMSPCE- N 587773.2
E 648299.8
(NAD-27)

**SURFACE LOCATION
BONE SPRING 2 PP**
Lat - N 32°36'54.08"
Long - W 103°49'50.97"
NMSPCE- N 587821.935
E 654727.125
(NAD-27)

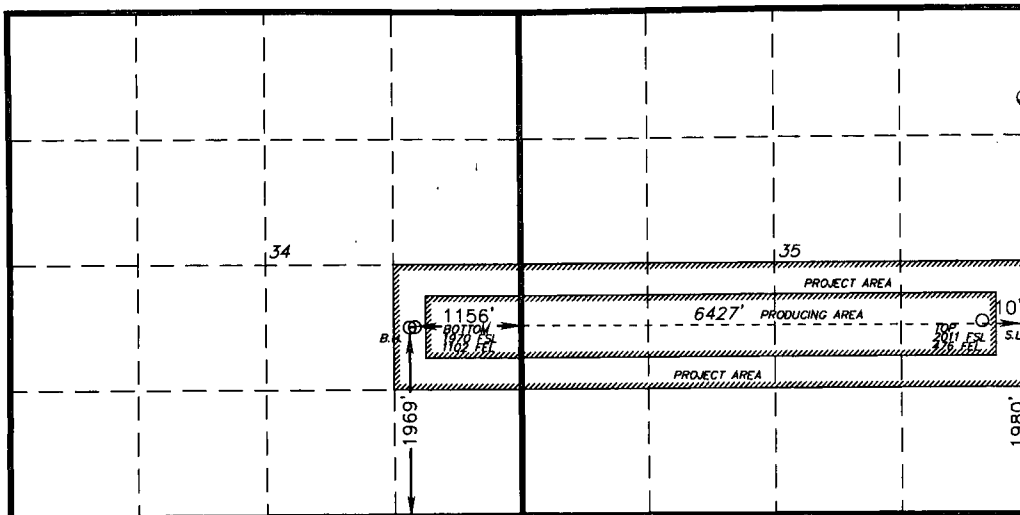

OPERATOR CERTIFICATION

I hereby certify that the information contained herein is true and complete to the best of my knowledge and belief, and that this organization either owns a working interest or unleased mineral interest in the land including the proposed bottom hole location or has a right to drill this well at this location pursuant to a contract with an owner of such a mineral or working interest, or to a voluntary pooling agreement or a compulsory pooling order heretofore entered by the division.

Signature: *Tracie J Cherry* Date: 12-04-13

Tracie J Cherry

Printed Name
tjcherry@basspet.com

Email Address

SURVEYOR CERTIFICATION

I hereby certify that the well location shown on this plat was plotted from field notes of actual surveys made by me or under my supervision, and that the same is true and correct to the best of my belief.

Date Surveyed: *NOVEMBER 15, 2013*
Signature & Seal of Professional Surveyor: *[Signature]*
W.S. *[Signature]*

Certificate No. Gary L. Jones 7977

BASIN SURVEYS 25537

RECEIVED
DEC 05 2013
NMOCD ARTESIA