

DISTRICT I  
1825 N. French Dr., Hobbs, NM 88240

DISTRICT II  
1301 W. Grand Avenue, Artesia, NM 88210

DISTRICT III  
1000 Rio Brazos Rd., Aztec, NM 87410

DISTRICT IV  
1220 S. St. Francis Dr., Santa Fe, NM 87505

State of New Mexico  
Energy, Minerals and Natural Resources Department

Form C-102  
Revised July 18, 2010

Submit one copy to appropriate  
District Office

OIL CONSERVATION DIVISION

1220 South St. Francis Dr.  
Santa Fe, New Mexico 87505

WELL LOCATION AND ACREAGE DEDICATION PLAT

X AMENDED REPORT  
"As drilled"

API Number 30-015-40498	Pool Code 97650	Pool Name WC Williams Sink; Bone Spring
Property Code 30586	Property Name BIG EDDY UNIT	Well Number 250H
OGRID No. 260737	Operator Name BOPCO, L.P.	Elevation 3479'

Surface Location

UL or lot No. 1	Section 35	Township 19 S	Range 31 E	Lot Idn	Feet from the 1980	North/South line SOUTH	Feet from the 10	East/West line EAST	County EDDY
--------------------	---------------	------------------	---------------	---------	-----------------------	---------------------------	---------------------	------------------------	----------------

Bottom Hole Location If Different From Surface

UL or lot No. 1	Section 34	Township 19 S	Range 31 E	Lot Idn	Feet from the 1969	North/South line SOUTH	Feet from the 1156	East/West line EAST	County EDDY
--------------------	---------------	------------------	---------------	---------	-----------------------	---------------------------	-----------------------	------------------------	----------------

Dedicated Acres 200	Joint or Infill	Consolidation Code	Order No.
------------------------	-----------------	--------------------	-----------

NO ALLOWABLE WILL BE ASSIGNED TO THIS COMPLETION UNTIL ALL INTERESTS HAVE BEEN CONSOLIDATED  
OR A NON-STANDARD UNIT HAS BEEN APPROVED BY THE DIVISION

PROPOSED BOTTOM  
HOLE LOCATION  
Lat - N 32°36'53.89"  
Long - W 103°51'06.12"  
NMSPCE- N 587773.2  
E 648299.8  
(NAD-27)

SURFACE LOCATION  
BONE SPRING 2 PP  
Lat - N 32°36'54.08"  
Long - W 103°49'50.97"  
NMSPCE- N 587821.935  
E 654727.125  
(NAD-27)

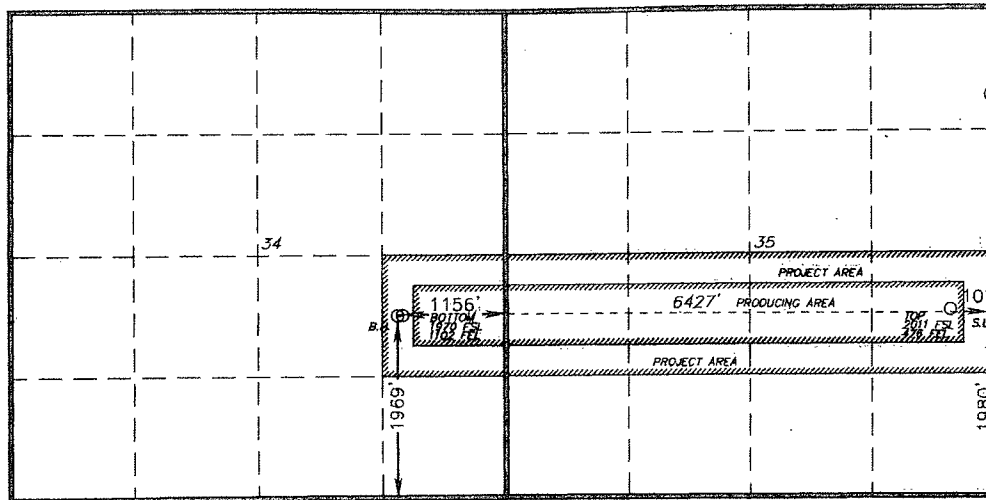

OPERATOR CERTIFICATION

I hereby certify that the information contained herein is true and complete to the best of my knowledge and belief, and that this organization either owns a working interest or unleased mineral interest in the land including the proposed bottom hole location or has a right to drill this well at this location pursuant to a contract with an owner of such a mineral or working interest, or to a voluntary pooling agreement or a compulsory pooling order heretofore entered by the division.

Signature: *Tracie J Cherry* Date: 12-04-13

Printed Name: Tracie J Cherry  
Email Address: tjcherry@basspet.com

Email Address

SURVEYOR CERTIFICATION

I hereby certify that the well location shown on this plat was plotted from field notes of actual surveys made by me or under my supervision, and that the same is true and correct to the best of my belief.

Date Surveyed: NOVEMBER 12, 2011  
Signature: *Gary L. Jones*  
Seal of Professional Surveyor  
W.S. 123456789

Certificate No. Gary L. Jones 7977

BASIN SURVEYS 25537