

DISTRICT I
1825 N. French Dr., Hobbs, NM 88240
DISTRICT II
1301 W. Grand Avenue, Artesia, NM 88210

DISTRICT III
1000 Rio Brazos Rd., Aztec, NM 87410

DISTRICT IV
1220 S. St. Francis Dr., Santa Fe, NM 87505

State of New Mexico
Energy, Minerals and Natural Resources Department

RECEIVED

MAR 13 2014

Form C-102
Revised July 16, 2010
Submit this copy to appropriate
District Office

OIL CONSERVATION DIVISION

1220 South St. Francis Dr.
Santa Fe, New Mexico 87505

WELL LOCATION AND ACREAGE DEDICATION PLAT

AMENDED REPORT
"As Drilled"

API Number 30-015-39766	Pool Code 50443	Pool Name Quahada Ridge; Delaware, SE
Property Code 306407	Property Name JAMES RANCH UNIT D12	Well Number 138H
OGRID No. 260737	Operator Name BOPCO, L.P.	Elevation 3343'

Surface Location

UL or lot No.	Section	Township	Range	Lot Idn	Feet from the	North/South line	Feet from the	East/West line	County
K	25	22 S	30 E		2365	SOUTH	2010	WEST	EDDY

Bottom Hole Location If Different From Surface

UL or lot No.	Section	Township	Range	Lot Idn	Feet from the	North/South line	Feet from the	East/West line	County
J	28	22 S	30 E		1969	SOUTH	2349	EAST	EDDY
Dedicated Acres 400	Joint or Infill	Consolidation Code	Order No.						

NO ALLOWABLE WILL BE ASSIGNED TO THIS COMPLETION UNTIL ALL INTERESTS HAVE BEEN CONSOLIDATED
OR A NON-STANDARD UNIT HAS BEEN APPROVED BY THE DIVISION

OPERATOR CERTIFICATION

I hereby certify that the information contained herein is true and complete to the best of my knowledge and belief, and that this organization either owns a working interest or unleased mineral interest in the land including the proposed bottom hole location or has a right to drill this well at this location pursuant to a contract with an owner of such a mineral or working interest, or to a voluntary pooling agreement or a compulsory pooling order heretofore entered by the division.

Signature: *Tracie J Cherry* Date: 3-12-14

Printed Name
tjcherry@basspet.com
Email Address

SURVEYOR CERTIFICATION

I hereby certify that the well location shown on this plat was plotted from field notes of actual surveys made by me or under my supervision, and that the same is true and correct to the best of my belief.

Date Surveyed: JANUARY 1, 2011
Signature & Seal of Professional Surveyor
GARY L. JONES

Certificate No. Gary L. Jones 7977
BASIN SURVEYS 25989

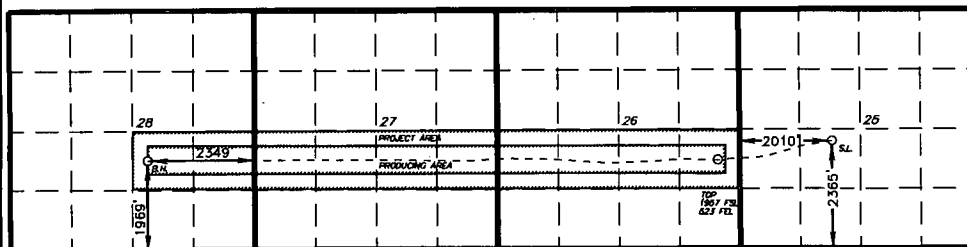

BOTTOM
HOLE LOCATION

Lat - N 32°21'40.51"
Long - W 103°53'04.97"
NMSPC- N 495429.9
E 638522.5
(NAD-27)

SURFACE LOCATION
DELAWARE PP

Lot - N 32°21'44.09"
Long - W 103°50'09.31"
NMSPC- N 495858.013
E 653587.389
(NAD-27)

SCALE 1"=4000'