

District I
1625 N. French Dr., Hobbs, NM 88240
District II
1301 W. Grand Avenue, Artesia, NM 88210
District III
1000 Rio Brazos Road, Aztec, NM 87410
District IV
1220 S. St. Francis Dr., Santa Fe, NM 87505

State of New Mexico
Energy Minerals and Natural Resources

Form C-101
May 27, 2004

Oil Conservation Division
1220 South St. Francis Dr.
Santa Fe, NM 87505

Submit to appropriate District Office

☐ AMENDED REPORT

APPLICATION FOR PERMIT TO DRILL, RE-ENTER, DEEPEN, PLUGBACK, OR ADD A ZONE

¹ Operator Name and Address Kaiser-Francis Oil Company P. O. Box 21468, Tulsa, OK 74121-1468		² OGRID Number 012361
³ Property Code		⁴ API Number 30-012-34457
⁵ Property Name Mesa "33" Fuerte		⁶ Well No. 2
⁹ Proposed Pool 1 Happy Valley Morrow		¹⁰ Proposed Pool 2 Happy Valley Strawn

7 Surface Location

UL or lot no.	Section	Township	Range	Lot Ida	Feet from the	North/South line	Feet from the	East/West line	County
I	33	21S	26E	-	1980	South	660	East	Eddy

8 Proposed Bottom Hole Location If Different From Surface n/a

UL or lot no.	Section	Township	Range	Lot Ida	Feet from the	North/South line	Feet from the	East/West line	County

Additional Well Information

¹¹ Work Type Code N	¹² Well Type Code G	¹³ Cable/Rotary R	¹⁴ Lease Type Code S	¹⁵ Ground Level Elevation 3259
¹⁶ Multiple No	¹⁷ Proposed Depth 11400	¹⁸ Formation Barnett Shale	¹⁹ Contractor Unknown	²⁰ Spud Date Upon approval
Depth to Groundwater 164 (Max) 52 (Min)		Distance from nearest fresh water well 528'		Distance from nearest surface water Unk.
Pit: Liner: Synthetic <input checked="" type="checkbox"/> 12mils thick Clay <input type="checkbox"/> Pit Volume: 42000 bbls Drilling Method: Fresh Water <input checked="" type="checkbox"/> Brine <input checked="" type="checkbox"/> Diesel/Oil-based <input type="checkbox"/> Gas/Air <input type="checkbox"/>				
Closed-Loop System <input type="checkbox"/>				

21 Proposed Casing and Cement Program

Hole Size	Cement to Cover All Oil, Gas and Water Bearing Zones	ting Dept	NOTIFY OCD OF SPUD & TIME TO WITNESS CEMENTING OF SURFACE & INTERMEDIATE CASING

²² Describe the proposed program. If this application is to DEEPEN or PLUG BACK, give the data on the present productive zone and proposed new productive zone. Describe the blowout prevention program, if any. Use additional sheets if necessary.

Drill 17 1/2" surface hole to 350'. Run 13 3/8" csg. Cmt to surf w/390 sxs. WOC 18 hrs. NU. Test. Drill 12 1/4" hole to 2650'. Run 9 5/8" csg. Cmt to surf w/895 sxs. NU BOP. Test to 5000#. WOC 18 hrs. Drill 8 3/4" hole to 11400'. Log. Evaluate. Run 5 1/2" csg. Set & cmt w/435 sxs. TOC @ 9500' +/- . BOP equipment will be used in accordance w/Rule 19.15.3.109. No H2S is expected. An H2S contingency plan has been sent under separate cover.

Drilling engineer: Drew Tyler (918) 491-4343

'Fresh Water Mud or Air to @ 2650'

²³ I hereby certify that the information given above is true and complete to the best of my knowledge and belief. I further certify that the drilling pit will be constructed according to NMOOD guidelines <input checked="" type="checkbox"/> a general permit <input type="checkbox"/> or an (attached) alternative OGD-approved plan <input type="checkbox"/>		OIL CONSERVATION DIVISION	
Printed name: Charlotte Van Valkenburg		Approved by: <i>[Signature]</i>	
Title: Technical Coordinator		Title: DEC 07 2005	
E-mail Address: Charlottv@KFOC.net		Approval Date:	Expiration Date: DEC 07 2006
Date: 12/7/05	Phone: 918-491-4314	Conditions of Approval Attached <input type="checkbox"/>	

Please catch every 100' mud samples from flow line
350 - 2650 in order to determine chloride levels.
Please submit data to OCD District II office
Thanks Bryan Annett - OCD

If earthen pits are used in association with the drilling of this well, an OCD pit permit must be obtained prior to pit construction.

District I

1625 N. French Dr., Hobbs, NM 88240

District II

1301 W. Grand Ave., Artesia, NM 88210

District III

1000 Rio Brazos Rd., Aztec, NM 87410

District IV

1220 S. St Francis Dr., Santa Fe, NM 87505

State of New Mexico
Energy, Minerals and Natural Resources
Oil Conservation Division
1220 S. St Francis Dr.
Santa Fe, NM 87505

Form C-102
 Permit 18785

WELL LOCATION AND ACREAGE DEDICATION PLAT

1. API Number	2. Pool Code 78060	3. Pool Name HAPPY VALLEY;MORROW (GAS)
4. Property Code	5. Property Name MESA "33" FUERTE	6. Well No. 002
7. OGRID No. 12361	8. Operator Name KAISER-FRANCIS OIL CO	9. Elevation 3259

10. Surface Location

UL - Lot I	Section 33	Township 21S	Range 26E	Lot Idn	Feet From 1980	N/S Line S	Feet From 660	E/W Line E	County EDDY
---------------	---------------	-----------------	--------------	---------	-------------------	---------------	------------------	---------------	----------------

11. Bottom Hole Location If Different From Surface

UL - Lot	Section	Township	Range	Lot Idn	Feet From	N/S Line	Feet From	E/W Line	County
12. Dedicated Acres 320.00	13. Joint or Infill	14. Consolidation Code	15. Order No.						

NO ALLOWABLE WILL BE ASSIGNED TO THIS COMPLETION UNTIL ALL INTERESTS HAVE BEEN CONSOLIDATED OR A NON-STANDARD UNIT HAS BEEN APPROVED BY THE DIVISION

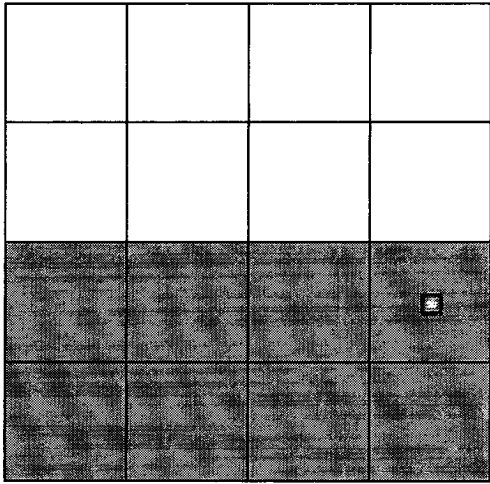
	<p style="text-align: center;">OPERATOR CERTIFICATION</p> <p><i>I hereby certify that the information contained herein is true and complete to the best of my knowledge and belief.</i></p> <p>E-Signed By: Title: Date:</p> <hr/> <p style="text-align: center;">SURVEYOR CERTIFICATION</p> <p><i>I hereby certify that the well location shown on this plat was plotted from field notes of actual surveys made by me or under my supervision, and that the same is true and correct to the best of my belief.</i></p> <p>Surveyed By: Macon McDonald Date of Survey: 11/5/2004 Certificate Number: 12185</p>
---	---

District I

1625 N. French Dr., Hobbs, NM 88240

District II

1301 W. Grand Ave., Artesia, NM 88210

District III

1000 Rio Brazos Rd., Aztec, NM 87410

District IV

1220 S. St Francis Dr., Santa Fe, NM 87505

State of New Mexico
Energy, Minerals and Natural Resources
Oil Conservation Division
1220 S. St Francis Dr.
Santa Fe, NM 87505

Form C-102
 Permit 18785

WELL LOCATION AND ACREAGE DEDICATION PLAT

1. API Number	2. Pool Code 78070	3. Pool Name HAPPY VALLEY;STRAWN (GAS)
4. Property Code	5. Property Name MESA "33" FUERTE	6. Well No. 002
7. OGRID No. 12361	8. Operator Name KAISER-FRANCIS OIL CO	9. Elevation 3259

10. Surface Location

UL - Lot I	Section 33	Township 21S	Range 26E	Lot Idn	Feet From 1980	N/S Line S	Feet From 660	E/W Line E	County EDDY
---------------	---------------	-----------------	--------------	---------	-------------------	---------------	------------------	---------------	----------------

11. Bottom Hole Location If Different From Surface

UL - Lot	Section	Township	Range	Lot Idn	Feet From	N/S Line	Feet From	E/W Line	County
12. Dedicated Acres 320.00		13. Joint or Infill		14. Consolidation Code		15. Order No.			

NO ALLOWABLE WILL BE ASSIGNED TO THIS COMPLETION UNTIL ALL INTERESTS HAVE BEEN CONSOLIDATED OR A NON-STANDARD UNIT HAS BEEN APPROVED BY THE DIVISION

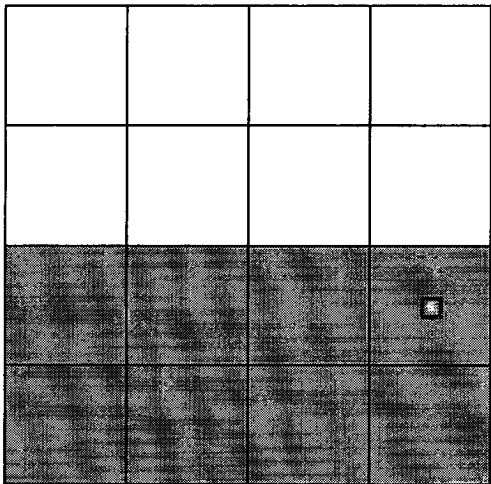
	OPERATOR CERTIFICATION
	<i>I hereby certify that the information contained herein is true and complete to the best of my knowledge and belief.</i> E-Signed By: Title: Date:
	SURVEYOR CERTIFICATION
	<i>I hereby certify that the well location shown on this plat was plotted from field notes of actual surveys made by me or under my supervision, and that the same is true and correct to the best of my belief.</i> Surveyed By: Macon McDonald Date of Survey: 11/5/2004 Certificate Number: 12185

Arrant, Bryan, EMNRD

From: Arrant, Bryan, EMNRD
To: Charlotte VanValkenburg
Cc:
Subject: RE: Attached Image - Mesa "33" Fuerte #2 (C-101)
Attachments:

Sent: Wed 12/7/2005 2:58 PM

Thanks Charlotte,

I have approved your APD. The API # is: 30-015-34457.

If you need a copy before the 1st of next week, please send me a fax # to fax you over a copy of the C-101. There are a number of conditions of approval.

One of the conditions of approval is that drilling mud samples from the flow line be caught every 100' in order to determine the chloride levels in the drilling mud. The results of this data is to be submitted to the District II

office here in Artesia before drilling the well to total depth. We are requiring this of all operators that drill in the Capitan Reef.

Thanks and I'll visit with you later,

Bryan Arrant
PES-Artesia
505-748-1283.103

From: Charlotte VanValkenburg [mailto:CharlotV@kfoc.net]
Sent: Wed 12/7/2005 2:32 PM
To: Arrant, Bryan, EMNRD
Subject: FW: Attached Image - Mesa "33" Fuerte #2 (C-101)

-----Original Message-----

From: noreply@kfoc.net [mailto:noreply@kfoc.net]
Sent: Wednesday, December 07, 2005 2:32 PM
To: Charlotte VanValkenburg
Subject: Attached Image

<<1255_001.pdf>>

Permit Comments

Operator: KAISER-FRANCIS OIL CO , 12361

Well: MESA "33" FUERTE #002

API:

There are no comments for this permit

November 14, 2005

NMOCD
Artesia, NM.

Re: BOP
Mesa "33" Fuerte #2
33-21S-26E
Eddy Co., NM.

RECEIVED
NOV 28 2005
OCD-ARTESIA

The pipe rams will be function tested on a daily basis and the blind rams will be function tested on all trips due to the close proximity of dwellings. This will follow the NU and testing of the BOP.

Sincerely,
Kaiser-Francis Oil Company

Drew Tyler
Engineer

RECEIVED
OCD-ARTESIA

**Kaiser-Francis Oil Company
Drilling Procedure Summary**

Mesa "33" Fuerte # 2

33-21S-26E

Eddy Co., NM.

DRILLING CONTRACTOR:

Unknown at this time

ESTIMATED FORMATION TOPS:

Strawn	9,850'
Atoka	10,180'
Morrow Lime	10,530'
Morrow A Sd	10,850'
Barnett Shale	11,330'

CASING PROGRAM:

Hole Size	Casing	Depth	Cement	TOC
17 1/2"	13 3/8"	350'	390 sxs	Surface
12 1/4"	9 5/8"	2,650'	895 sxs	Surface
8 3/4"	5 1/2"	11,400'	435 sxs	9500'

MUD PROGRAM: (SUBJECT TO CHANGES PENDING ON HOLE CONDITIONS)

Depth	Mud Type	Weight
0-350'	Fresh Water/Spud	8.6 - 9.3
500'-2600'	Brine Water Fresh Water Only	9.8 - 10.1
2600'-8500'	Fresh Water w/LCM as needed	8.3 - 10.5

Fluid loss across zone less than 12.

HYDROGEN SULFIDE CONTINGENCY PLAN:

This well/facility is not expected to have hydrogen sulfide in excess of 100 PPM, but due to the sensitive location, a contingency plan has been included with this permit. See attached.

BLOWOUT PREVENTION PROGRAM:

Blowout prevention equipment will be used during the drilling of this well. There will be regular testing of the BOP during drilling operations. BOP used will depend on the rig used to drill the well.

November 14, 2005

NMOCD
Artesia, NM.

Re: Nearest Dwelling
Mesa "33" Fuerte #2
33-21S-26E
Eddy Co., NM.

RECEIVED
NOV 28 2005
OCC-ARTESIA

The nearest occupied dwelling to the proposed location is 1233' to the south. There is also an unoccupied mobile home 913' SE of the proposed location.

Sincerely,
Kaiser-Francis Oil Company

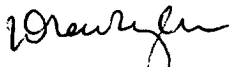

Drew Tyler
Engineer

**KAISER-FRANCIS OIL COMPANY
HYDROGEN SULFIDE (H₂S) CONTINGENCY PLAN
FOR DRILLING/COMPLETION WORKOVER/FACILITY**

**MESA FUERTE # 2
SECTION 33-T21S-R26E
EDDY COUNTY, NM**

**RECEIVED
NOV 28 2005
OCD-ARTESIA**

This well/facility is not expected to have H₂S, but due to the sensitive location, the following is submitted as requested.

TABLE OF CONTENTS

Emergency Response Activation and General Responsibilities	3
Individual Responsibilities During An H ₂ S Release	4
Procedure For Igniting An Uncontrollable Condition	5
Emergency Phone Numbers	6
Protection Of The General Public/Roe	7
Characteristics Of H ₂ S And SO ₂	8
Training	8
Public Relations	8
Maps	

EMERGENCY RESPONSE ACTIVATION AND GENERAL RESPONSIBILITIES

Activation of the Emergency Action Plan

In the event of any emergency situation, all personnel on location should first ensure that the following items are initiated. After that, they should refer to the appropriate Specific Emergency Guidance sections below for further responsibilities:

1. Notify the senior ranking contract representative on site.
2. Notify Kaiser-Francis representative in charge.
3. Notify civil authorities if the Kaiser-Francis Representative cannot be contacted and the situation dictates.
4. Perform rescue and first aid as required (without jeopardizing additional personnel).

General Responsibilities

In the event of an H₂S emergency, the following plan will be initiated.

- 1) All personnel will immediately evacuate to an up-wind and if possible up-hill "safe area".
- 2) If for any reason a person must enter the hazardous area, they must wear a SCBA (Self contained breathing apparatus).
- 3) Always use the "buddy system".
- 4) Isolate the well/problem if possible.
- 5) Account for all personnel
- 6) Display the proper colors warning all unsuspecting personnel of the danger at hand
- 7) Contact the Company personnel as soon as possible if not at the location. (use the enclosed call list as instructed)

At this point the company representative will evaluate the situation and coordinate the necessary duties to bring the situation under control, and if necessary, the notification of emergency response agencies and residents.

INDIVIDUAL RESPONSIBILITIES DURING AN H₂S RELEASE

The following procedures and responsibilities will be implemented on activation of the H₂S siren and lights.

All Personnel:

1. On alarm, don escape unit (if available) and report to upwind briefing area.

Rig Manager/Tool Pusher:

1. Check that all personnel are accounted for and their condition.
2. Administer or arrange for first aid treatment, and/or call EMTs as needed.
3. Identify two people best suited to secure well and perform rescue, and instruct them to don SCBA.
4. Notify Contract management and Kaiser-Francis Representative.
5. Remain at the briefing area, assess and monitor personnel and overall situation for hazards or conditions that might warrant a change in the action plan.

Two People Responsible for Shut-in and Rescue:

1. Don SCBA and acquire tools to secure well and perform rescue, i.e., wrenches, retrieval ropes, etc.
2. Utilize the buddy system to secure well and perform rescue(s).
3. Return to the briefing area and stand by for further instructions.

All Other Personnel:

1. Isolate the area and prevent entry by other persons into the 100 ppm ROE. Additionally the first responder(s) must evacuate any public places encompassed by the 100 ppm ROE. First responder(s) must take care not to injure themselves during this operation. Company and/or local officials must be contacted to aid in this operation. Evacuation of the public should be beyond the 100 ppm ROE.

Kaiser-Francis Oil Company Representative:

1. Remain at the briefing area, assess and monitor personnel and overall situation for hazards or conditions that might warrant a change in the action plan.
2. Notify company management or Local Incident Commander, and Police, Fire Department, or other local emergency services as required.

PROCEDURE FOR IGNITING AN UNCONTROLLABLE CONDITION:

Should control of the well be considered lost and ignition considered, take care to protect against exposure to Sulfur Dioxide (SO₂). Intentional ignition must be coordinated with the NMOCD and local officials. Additionally the NM State Police shall be the Incident Command of any major release.

The decision to ignite a well should be a last resort and one if not both of the following pertain.

- 1) Human life and/or property are in danger.
- 2) There is no hope of bringing the situation under control with the prevailing conditions at the site.

INSTRUCTIONS FOR IGNITION:

- 1) Two people are required. They must be equipped with positive pressure; self contained breathing apparatus and a "D"-ring style, full body, OSHA approved safety harness. Non-flammable rope will be attached.
- 2) One of the people will be a qualified safety person who will test the atmosphere for H₂S, Oxygen, & LFL. The other person will be the company supervisor; he is responsible for igniting the well.
- 3) Ignite up-wind from a distance no closer than necessary. Make sure that where you ignite from has the maximum escape avenue available. A 25mm flare gun shall be used, with a +/-500' range to ignite the gas.
- 4) Prior to ignition, make a final check for combustible gases.
- 5) Following ignition, continue with the emergency actions & procedures as before.

CONTACTING AUTHORITIES

Kaiser-Francis personnel must liaison with local and state agencies to ensure a proper response to a major release. Additionally, the OCD must be notified of the release as soon as possible but no later than 4 hours. Agencies will ask for information such type and volume of release, wind direction, location of release, etc. Be prepared with all information available. The following call list of essential and potential responders has been prepared for use during a release. This response plan must be in coordination with the State of New Mexico's 'Hazardous Materials Emergency Response Plan' (HMER).

EMERGENCY CALL LIST: (Start and continue until ONE of these people have been reached)

	<u>OFFICE</u>	<u>MOBILE</u>	<u>HOME</u>
Kaiser-Francis Oil Co.	918/494-0000		
David Rodawalt	432/563-2992	432/238-6969	432/520-7339
Drew Tyler	918/491-4343		
Charles Lock	918/491-4337	918/671-6510	918/250-1935
Ted Jacobson	918/491-4341		

EMERGENCY RESPONSE NUMBERS: Eddy County, New Mexico

State Police – Artesia	505/748-9718
State Police – Carlsbad	505/885-3137
State Police – Hobbs	505/392-5588
Eddy County Sheriff - Carlsbad	505/887-7551
Local Emergency Planning Center – Eddy County	505/887-9511
Local Emergency Planning Center – Lea County	505/397-9231
Fire Fighting, Rescue & Ambulance – Artesia	911
Fire Fighting, Rescue & Ambulance – Carlsbad	911 or 505/885-2111
Fire Fighting, Rescue & Ambulance – Hobbs	911 or 505/397-9308
New Mexico Oil & Gas Commission – Artesia	505/748-1283
New Mexico Oil & Gas Commission – Hobbs	505/393-6161
Aerocare – Lubbock	806/725-1100
Med Flight Air Ambulance – Albuquerque	505/842-4433
American Safety	505/748-6660
Indian Fire & Safety	505/746-4660
Callaway Safety	505/392-2973
BJ Services	505/746-3569
Halliburton	505/748-2746

PROTECTION OF THE GENERAL PUBLIC/ROE:

In the event of a release with a concentration greater than 100 ppm H₂S, the ROE (Radius of Exposure) calculations will be done to determine if the following conditions have been met:

- Does the 100 ppm ROE include any public area (any place not associated with this site)
- Does the 500 ppm ROE include any public road (any road which the general public may travel)
- Is the 100 ppm ROE equal to or greater than 3000 feet

If any one of these conditions have been met then the Contingency Plan will be implemented. The following shows how to calculate the radius of exposure and an example.

Calculation for the 100 ppm ROE:

$$X = [(1.589)(\text{concentration})(Q)] (0.6258)$$

(H₂S concentrations in decimal form)

10,000 ppm +=1.+

1,000 ppm +=.1+

100 ppm +=.01+

10 ppm +=.001+

Calculation for the 500 ppm ROE:

$$X + [(0.4546)(\text{concentration})(Q)] (.06258)$$

EXAMPLE: If a well/facility has been determined to have 150 ppm H₂S in the gas mixture and the well/facility is producing at a gas rate of 200 MCFPD then:

ROE for 100 PPM $X = [(1.589)(.0150)(200)] (0.6258)$

$$X = 2.65'$$

ROE for 500 PPM $X = [(0.4546)(.0150)(200)] (0.6258)$

$$X = 1.2'$$

(These calculations will be forwarded to the appropriate District NMOCD office when applicable.)

PUBLIC EVACUATION PLAN:

(When the supervisor has determined that the General Public will be involved, the following plan will be implemented)

- 1) Notification of the emergency response agencies of the hazardous condition and Implement evacuation procedures.
- 2) A trained person in H₂S safety, shall monitor with detection equipment the H₂S Concentration, wind and area of exposure (ROE). This person will determine the outer perimeter of the hazardous area. The extent of the evacuation area will be determined from the data being collected. Monitoring shall continue until the situation has been resolved. **(All monitoring equipment will be UL approved, for use in class I groups A,B,C & D, Division I, hazardous locations. All monitors will have a minimum capability of measuring H₂S, oxygen, and flammable values.)**
- 3) Law enforcement shall be notified to set up necessary barriers and maintain such for the duration of the situation as well as aid in the evacuation procedure.
- 4) The company supervising personnel shall stay in communication with all agencies through out the duration of the situation and inform such agencies when the situation has been contained and the effected area(s) is safe to enter.

CHARACTERISTICS OF H₂S AND SO₂

Common Name	Chemical Formula	Specific Gravity	Threshold Limit	Hazardous Limit	Lethal Concentration
Hydrogen Sulfide	H ₂ S	1.189 Air = 1	10 ppm	100 ppm	600 ppm
Sulfur Dioxide	SO ₂	2.21 Air = 1	2 ppm	N/A	1000 ppm

TRAINING:

All responders must have training in the detection of H₂S measures for protection against the gas, equipment used for protection and emergency response. Weekly drills by all crews will be conducted and recorded in the IADC daily log. Additionally, responders must be equipped with H₂S monitors at all times.

PUBLIC RELATIONS

Kaiser-Francis recognizes that the news media have a legitimate interest in incidents at Kaiser-Francis facilities that could affect the public. It is to the company's benefit to cooperate with the news media when incidents occur because these media are out best liaison with the public.

Our objective is to see that all reports of any emergency are factual and represent the company's position fairly and accurately. Cooperation with news media representatives is the most reliable guarantee that this objective will be met.

All contract and Kaiser-Francis employees are instructed **NOT** to make any statement to the media concerning the emergency incident. If a media representative contacts any employee, they should refer them to the designated Emergency Command Center where they should contact the Incident Commander or his designated relief for any information concerning the incident.

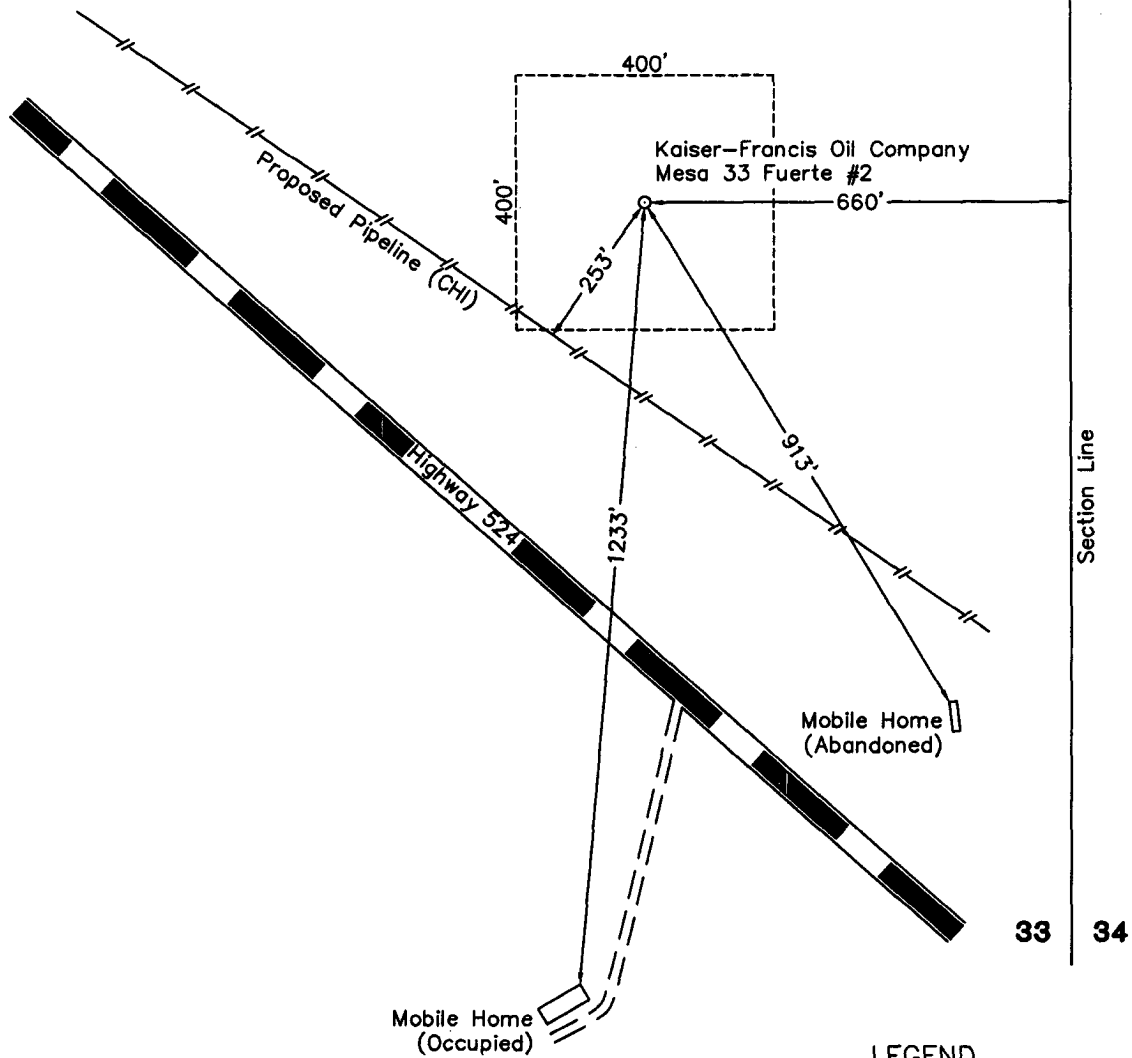

LEGEND

- - Denotes Proposed Well Location
- Denotes Highway



KAISER-FRANCIS OIL COMPANY

Surface Conditions Surrounding the

MESA 33 FUERTE #2

Located 1980' FSL & 660' FEL
Section 33, T-21-S, R-26-E, N.M.P.M.
Eddy County, New Mexico

November 22, 2005

Mr. Bryan Arrant
OCD
1301 W. Grand Ave
Artesia, NM 88210

RECEIVED
NOV 28 2005
OCD-ARTESIA

Re: Mesa "33" Fuerte #2
SE/4 Section 33-21S-26E
Eddy Co., NM.
Emergency Response

Kaiser-Francis Oil Company herewith submits additional information regarding emergency response for this proposed well.

Mr. David Rodawalt (Production Superintendent) will schedule an appointment with the Carlsbad City Manager to discuss the drilling process and emergency response capabilities that will be implemented by Kaiser-Francis Oil Company for this well. In addition, prior to drilling the well, we will provide the city with contact telephone numbers in the event of any emergency.

Mr. Rodawalt will also schedule a meeting with the Carlsbad City Fire Department to discuss the safety precautions we will be implementing and will discuss the notifications we will make to insure that the residents located in the proximity to the well are informed in the event of an emergency.

Kaiser-Francis Oil Company is committed to operating in a manner that will maintain the health and safety of our employees, contractors, and the public. If anyone has questions or concerns, please contact me at (918) 491-4343 or Mr. Rodawalt at (432) 563-2992.

Sincerely,
KAISER-FRANCIS OIL COMPANY

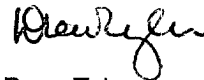

Drew Tyler
Operations Engineer

DT:klw

cc: Charles Lock
David Rodawalt
Charlotte Van Valkenburg