

NM OIL CONSERVATION
ARTESIA DISTRICT

FEB 16 2016

DISTRICT I

1826 N. French Dr., NM 88240
Phone:(575)393-8161 Fax:(575)393-0720

DISTRICT II

811 S. First St., Artesia, NM 88210
Phone:(575)748-1283 Fax:(575)748-9720

DISTRICT III

1000 Rio Brazos, Aztec, NM 87410
Phone:(505)334-6178 Fax:(505)334-6170

DISTRICT IV

1820 S. St. Francis Dr., Santa Fe, NM 87505
Phone:(505)476-3460 Fax:(505)476-3462

State of New Mexico
Energy, Minerals and Natural Resources Department

OIL CONSERVATION DIVISION

1220 South St. Francis Dr.
Santa Fe, New Mexico 87505

Form C-102
Revised August 1, 2011
Submit one copy to appropriate
District Office

WELL LOCATION AND ACREAGE DEDICATION PLAT

AMENDED REPORT
"As Drilled"

API Number 30-015-42427	Pool Code 97975	Pool Name WC-015-G-06 S243119C; B.S.
Property Code 313213	Property Name POKER LAKE UNIT CVX JV BS	Well Number 035H
OGRID No. 260737	Operator Name BOPCO, L.P.	Elevation 3498'

Surface Location

UL or lot No.	Section	Township	Range	Lot Idn	Feet from the	North/South line	Feet from the	East/West line	County
C	19	24 S	31 E		190'	NORTH	2332'	WEST	EDDY

Bottom Hole if Different From Surface

UL or lot No.	Section	Township	Range	Lot Idn	Feet from the	North/South line	Feet from the	East/West line	County
F	30	24 S	31 E		2309'	NORTH	1983'	WEST	EDDY

Dedicated Acres 240	Joint or Infill	Consolidation Code	Order No.
-------------------------------	-----------------	--------------------	-----------

NO ALLOWABLE WILL BE ASSIGNED TO THIS COMPLETION UNTIL ALL INTERESTS HAVE BEEN CONSOLIDATED
OR A NON-STANDARD UNIT HAS BEEN APPROVED BY THE DIVISION

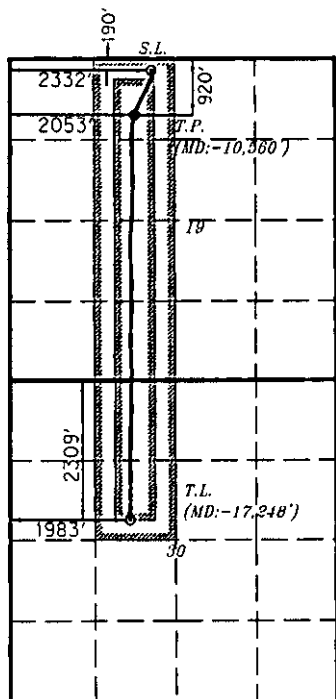

SURFACE LOCATION

Lat - N 32°12'33.92"
Long - W 103°49'03.57"
NMSPC- N 440289.6
E 659493.4
(NAD-27)

TOP PERFORATION

Lat - N 32°12'26.69"
Long - W 103°49'06.81"
NMSPC- N 439558.5
E 659218.1
(NAD-27)

TERMINUS LOCATION

Lat - N 32°11'20.63"
Long - W 103°49'07.69"
NMSPC- N 432882.8
E 659174.2
(NAD-27)

OPERATOR CERTIFICATION

I hereby certify that the information contained herein is true and complete to the best of my knowledge and belief, and that this organization either owns a working interest or unleased mineral interest in the land including the proposed bottom hole location pursuant to a contract with an owner of such a mineral or working interest, or to a voluntary pooling agreement or a compulsory pooling order heretofore entered by the division.

Signature: *Tracie J. Cherry* Date: *02/16/16*

Printed Name
Tracie J. Cherry

Email Address
tjcherry@basspet.com

SURVEYOR CERTIFICATION

I hereby certify that the well location shown on this plat was plotted from field notes of actual surveys made by me or under my supervision and that the same is true and correct to the best of my belief.

VASILEIOS KALOGIROU
NEW MEXICO
22501
PROFESSIONAL SURVEYOR

01-29-2014
VASILEIOS KALOGIROU
Certificate No. 22501
HALFP ASSOC., INC. 29714-W013

SCALE 1"=3000