

District I
1625 N. French Dr., Hobbs, NM 88240
Phone: (575) 393-6161 Fax: (575) 393-0720
District II
811 S. First St., Artesia, NM 88210
Phone: (575) 748-1283 Fax: (575) 748-9720
District III
1000 Rio Brazos Road, Aztec, NM 87410
Phone: (505) 334-6178 Fax: (505) 334-6170
District IV
1220 S. St. Francis Dr., Santa Fe, NM 87505
Phone: (505) 476-3460 Fax: (505) 476-3462

OIL CONSERVATION

ARTESIA DISTRICT

State of New Mexico
Energy, Minerals & Natural Resources
Department

OIL CONSERVATION DIVISION

1220 South St. Francis Dr.
Santa Fe, NM 87505

FORM C-102

Revised August 1, 2011

Submit one copy to appropriate

District Office

☒ AMENDED REPORT

WELL LOCATION AND ACREAGE DEDICATION PLAT

¹ API Number 30-015-43463	² Pool Code 98220	³ Pool Name PURPLE SAGE-WOLFCAMP GAS POOL
⁴ Property Code 314750	⁵ Property Name JANIE CONNER 13-24S-28E RB	⁶ Well Number #201H
⁷ OGRID No. 228937	⁸ Operator Name MATADOR PRODUCTION COMPANY	⁹ Elevation 2976'

¹⁰Surface Location

UL or lot no.	Section	Township	Range	Lot Idn	Feet from the	North/South line	Feet from the	East/West line	County
A	14	24-S	28-E	-	378'	NORTH	300'	EAST	EDDY

UL or lot no.	Section	Township	Range	Lot Idn	Feet from the	North/South line	Feet from the	East/West line	County
A	13	24-S	28-E	-	347'	NORTH	229'	EAST	EDDY

¹² Dedicated Acres 320	¹³ Joint or Infill	¹⁴ Consolidation Code	¹⁵ Order No.
---	-------------------------------	----------------------------------	-------------------------

No allowable will be assigned to this completion until all interests have been consolidated or a non-standard unit has been approved by the division.

¹⁶ 		¹⁷ OPERATOR CERTIFICATION I hereby certify that the information contained herein is true and complete to the best of my knowledge and belief, and that this organization either owns a working interest or unleased mineral interest in the land including the proposed bottom hole location or has a right to drill this well at this location pursuant to a contract with an owner of such a mineral or working interest, or to a voluntary pooling agreement or a compulsory pooling order heretofore entered by the division. Signature: <u>Trey Goodwin</u> Date: <u>2/21/17</u> Printed Name: <u>Trey Goodwin</u> E-mail Address: <u>tgoodwin@matadorresources.com</u>
SURFACE LOCATION NEW MEXICO EAST NAD 1927 X=587635 Y=445277 LAT.: N 32.2238672 LONG.: W 104.0499462 ELEV = 2976'	FIRST PERFORATION POINT NEW MEXICO EAST NAD 1927 X=588358 Y=445280 LAT.: N 32.2238692 LONG.: W 104.0476052 MD = 10243'	LAST PERFORATION POINT NEW MEXICO EAST NAD 1927 X=592876 Y=445317 LAT.: N 32.2239363 LONG.: W 104.0329963 MD = 14765'
PENETRATION POINT NEW MEXICO EAST NAD 1927 X=587834 Y=445290 LAT.: N 32.2238991 LONG.: W 104.0493009 MD = 9694'	BOTTOM HOLE LOCATION NEW MEXICO EAST NAD 1927 X=593025 Y=445319 LAT.: N 32.2239418 LONG.: W 104.0325135 MD = 14915'	

¹⁸**SURVEYOR CERTIFICATION**
 I hereby certify that the well location shown on this plat was plotted from field notes of actual surveys made by me or under my supervision, and that the same is true to the best of my belief.

04/14/2016

Date of Survey
Signature and Seal of Professional Surveyor

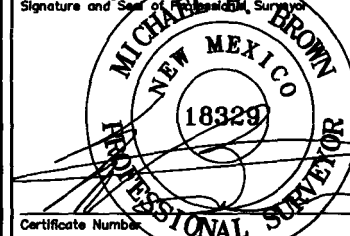

Certificate Number