

DISTRICT I  
1625 N. French Dr., Hobbs, NM 88240  
Phone: (575) 393-6161 Fax: (575) 393-0720

DISTRICT II  
811 S. First St., Artesia, NM 88210  
Phone: (575) 748-1283 Fax: (575) 748-9720

DISTRICT III  
1300 N. Main St., Aztec, NM 87410  
Phone: (505) 334-6178 Fax: (505) 334-6170

DISTRICT IV  
1220 S. St. Francis Dr., Santa Fe, NM 87505  
Phone: (505) 476-3460 Fax: (505) 476-3462

NEW MEXICO OIL CONSERVATION

ARTESIA DISTRICT

APR 25 2017

RECEIVED

# WELL LOCATION AND ACREAGE DEDICATION PLAT

State of New Mexico

Energy, Minerals & Natural Resources Department

OIL CONSERVATION DIVISION

1220 South St. Francis Dr.

Santa Fe, New Mexico 87505

Form C-102

Revised August 1, 2011

Submit one copy to appropriate  
District Office

☒ AMENDED REPORT

API Number <b>30-015-29351</b>	Pool Code <b>98220</b>	Pool Name <b>PURPLE SAGE - WOLFCAMP GAS POOL</b>
Property Code	Property Name <b>McKITTRICK 29 FEDERAL COM</b>	Well Number <b>22</b>
OGRID No. <b>246289</b>	Operator Name <b>RKI EXPLORATION AND PRODUCTION</b>	Elevation <b>3412</b>

## Surface Location

UL or lot no. <b>E</b>	Section <b>29</b>	Township <b>22 S</b>	Range <b>26 E</b>	Lot Idn	Feet from the <b>1715</b>	North/South line <b>NORTH</b>	Feet from the <b>1160</b>	East/West line <b>WEST</b>	County <b>EDDY</b>
---------------------------	----------------------	-------------------------	----------------------	---------	------------------------------	----------------------------------	------------------------------	-------------------------------	-----------------------

## Bottom Hole Location If Different From Surface

UL or lot no.	Section	Township	Range	Lot Idn	Feet from the	North/South line	Feet from the	East/West line	County
---------------	---------	----------	-------	---------	---------------	------------------	---------------	----------------	--------

Dedicated Acres <b>320 40</b>	Joint or Infill	Consolidated Code	Order No.
----------------------------------	-----------------	-------------------	-----------

No allowable will be assigned to this completion until all interests have been consolidated or a non-standard unit has been approved by the division.

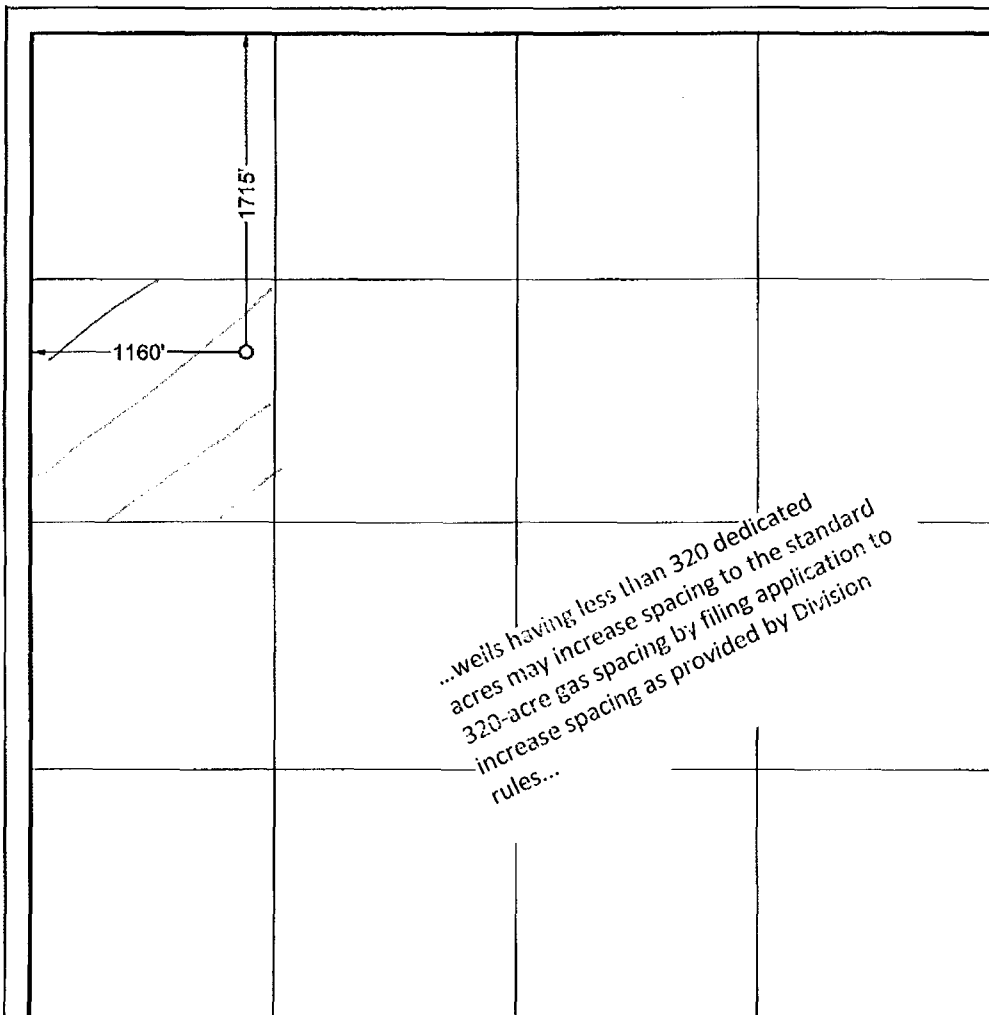

## OPERATOR CERTIFICATION

I hereby certify that the information contained herein is true and complete to the best of my knowledge and belief, and that this organization either owns a working interest or unleased mineral interest in the land including the proposed bottom hole location or has a right to drill this well at this location pursuant to a contract with an owner of such a mineral or working interest, or to voluntary pooling agreement or a compulsory pooling order heretofore entered by the division.

Signature *Jessica Demarco* Date **4/14/17**  
 Print Name **Jessica Demarco**  
 E-mail Address **Jessica.Demarco@wpsenergy.com**

## SURVEYORS CERTIFICATION

I hereby certify that the well location shown on this plat was plotted from field notes of actual surveys made by me or under my supervision, and that the same is true and correct to the best of my belief.

APRIL 13, 2017

Date of Survey

Signature and Seal of Professional Surveyor

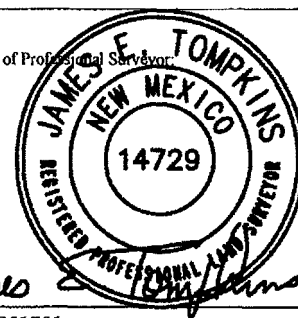

Job No. **WTC51791**

JAMES E. TOMPKINS 14729

Certificate Number