

LOCATION VERIFICATION MAP

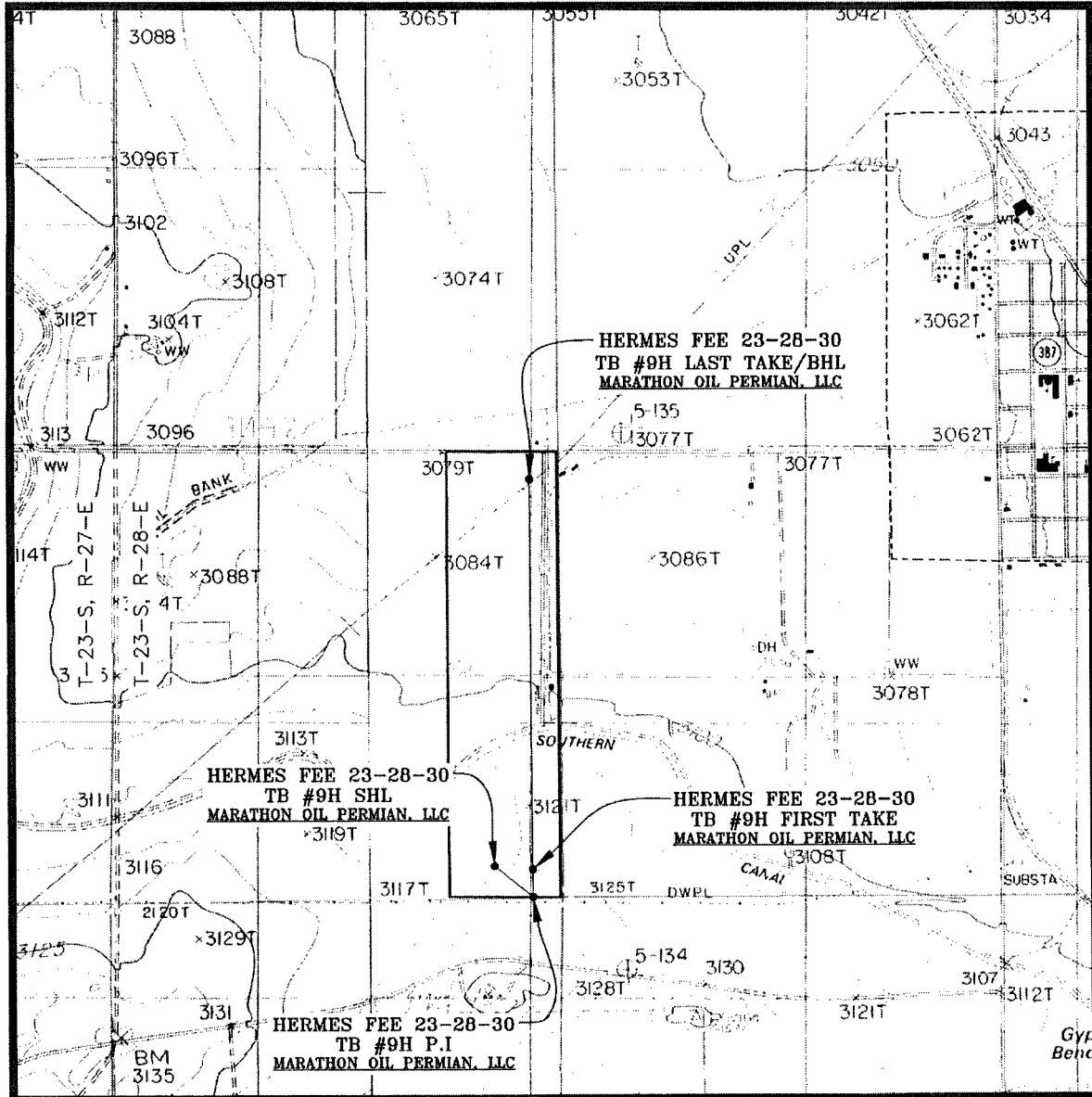

SEC. 30 TWP. 23-S RGE. 28-E
 SURVEY: N.M.P.M.
 COUNTY: EDDY
 DESCRIPTION: 368' FSL & 788' FEL
 ELEVATION: 3205'
 OPERATOR: MARATHON OIL PERMIAN, LLC
 LEASE: HERMES FEE 23-28-30
 U.S.G.S. TOPOGRAPHIC MAP: LOVING, N.M.

SCALE: 1" = 2000'
 CONTOUR INTERVAL = 10'

PREPARED BY:
 R-SQUARED GLOBAL, LLC
 1309 LOUISVILLE AVENUE, MONROE, LA 71201
 318-323-8900 OFFICE
 JOB No. R3791_005

VICINITY MAP

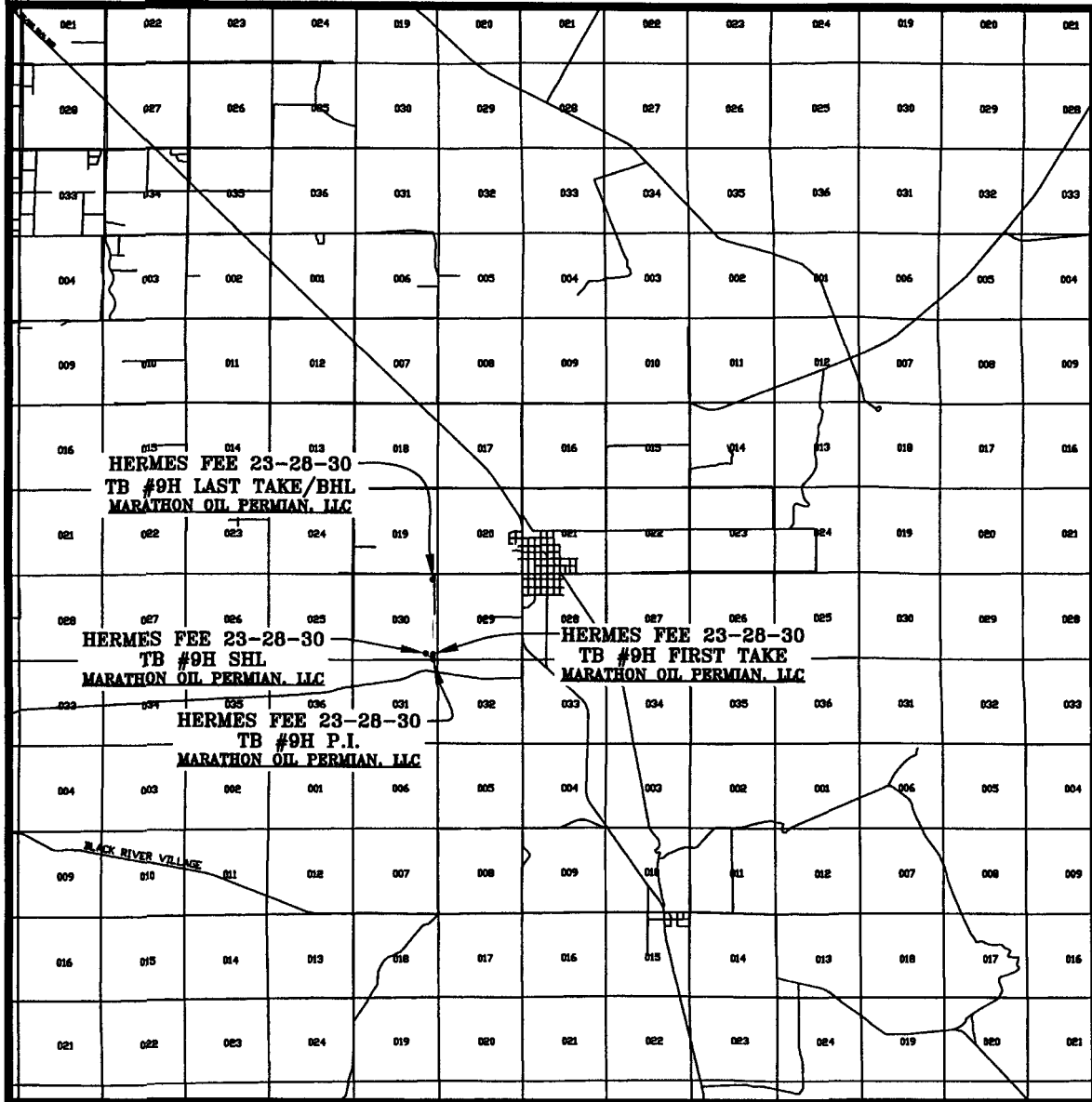

SEC. 30 TWP. 23-S RGE. 28-E
 SURVEY: N.M.P.M.
 COUNTY: EDDY
 DESCRIPTION: 368' FSL & 788' FEL
 ELEVATION: 3205'
 OPERATOR: MARATHON OIL PERMIAN, LLC
 LEASE: HERMES FEE 23-28-30
 U.S.G.S. TOPOGRAPHIC MAP: LOVING, N.M.

SCALE: 1" = 2 MILES

PREPARED BY:
 R-SQUARED GLOBAL, LLC
 1309 LOUISVILLE AVENUE, MONROE, LA 71201
 318-323-8900 OFFICE
 JOB No. R3781_005