

**SUNDRY NOTICES AND REPORTS ON WELLS**  
*Do not use this form for proposals to drill or to re-enter an abandoned well. Use form 3160-3 (APD) for such proposals.*

5. Lease Serial No.  
NMNM118108

6. If Indian, Allottee or Tribe Name

**SUBMIT IN TRIPLICATE - Other instructions on page 2**

7. If Unit or CA/Agreement, Name and/or No.

1. Type of Well

☐ Oil Well    ☒ Gas Well    ☐ Other
8. Well Name and No.  
Multiple--See Attached

2. Name of Operator

CHEVRON USA INCORPORATED

Contact: DORIAN K FUENTES

E-Mail: DJVO@CHEVRON.COM

9. API Well No.  
Multiple--See Attached

3a. Address

6301 DEAUVILLE BLVD  
MIDLAND, TX 79706

3b. Phone No. (include area code)

Ph: 432-687-7631

10. Field and Pool or Exploratory Area  
WILDCAT

4. Location of Well (Footage, Sec., T., R., M., or Survey Description)

Multiple--See Attached

11. County or Parish, State

EDDY COUNTY, NM

**12. CHECK THE APPROPRIATE BOX(ES) TO INDICATE NATURE OF NOTICE, REPORT, OR OTHER DATA**

TYPE OF SUBMISSION	TYPE OF ACTION			
<input checked="" type="checkbox"/> Notice of Intent	<input type="checkbox"/> Acidize	<input type="checkbox"/> Deepen	<input type="checkbox"/> Production (Start/Resume)	<input type="checkbox"/> Water Shut-Off
<input type="checkbox"/> Subsequent Report	<input type="checkbox"/> Alter Casing	<input type="checkbox"/> Hydraulic Fracturing	<input type="checkbox"/> Reclamation	<input type="checkbox"/> Well Integrity
<input type="checkbox"/> Final Abandonment Notice	<input type="checkbox"/> Casing Repair	<input type="checkbox"/> New Construction	<input type="checkbox"/> Recomplete	<input checked="" type="checkbox"/> Other
	<input type="checkbox"/> Change Plans	<input type="checkbox"/> Plug and Abandon	<input type="checkbox"/> Temporarily Abandon	Change to Original APD
	<input type="checkbox"/> Convert to Injection	<input type="checkbox"/> Plug Back	<input type="checkbox"/> Water Disposal	

13. Describe Proposed or Completed Operation: Clearly state all pertinent details, including estimated starting date of any proposed work and approximate duration thereof. If the proposal is to deepen directionally or recompleat horizontally, give subsurface locations and measured and true vertical depths of all pertinent markers and zones. Attach the Bond under which the work will be performed or provide the Bond No. on file with BLM/BIA. Required subsequent reports must be filed within 30 days following completion of the involved operations. If the operation results in a multiple completion or recompleat in a new interval, a Form 3160-4 must be filed once testing has been completed. Final Abandonment Notices must be filed only after all requirements, including reclamation, have been completed and the operator has determined that the site is ready for final inspection.

CHEVRON RESPECTFULLY REQUEST THE ABILITY TO BATCH DRILL THE HH SO 8 P2. THE WELLS INCLUDED ARE

HH SO 8 P2 5H  
 HH SO 8 P2 6H  
 HH SO 8 P2 13H  
 HH SO 8 P2 14H  
 HH SO 8 P2 21H  
 HH SO 8 P2 22H

**Carlsbad Field Office**  
**OCD Artesia**

SEE ATTACHED FOR  
 CONDITIONS OF APPROVAL

THE SUMMARY ATTACHED IS A BRIEF DESCRIPTION OF THE MAIN OPERATIONAL SEQUENCE FOR THE DRILLING AND CASING OF THE 6 WELLS LISTED ABOVE.

*Accepted for record - 1-3-18*  
 NMOC

**NM OIL CONSERVATION**  
 ARTESIA DISTRICT

14. I hereby certify that the foregoing is true and correct.

Electronic Submission #382905 verified by the BLM Well Information System

For CHEVRON USA INCORPORATED, sent to the Carlsbad

Committed to AFMSS for processing by TENILLE ORTIZ on 08/08/2017 (17T00036SE)

JAN 03 2018

Name (Printed/Typed) DORIAN K FUENTES

Title REGULATORY SPECIALIST

RECEIVED

Signature (Electronic Submission)

Date 07/27/2017

**THIS SPACE FOR FEDERAL OR STATE OFFICE USE**

Approved By ZOTIA STEVENS

Title PETROLEUM ENGINEER

Date 01/02/2018

Conditions of approval, if any, are attached. Approval of this notice does not warrant or certify that the applicant holds legal or equitable title to those rights in the subject lease which would entitle the applicant to conduct operations thereon.

Office Carlsbad

Title 18 U.S.C. Section 1001 and Title 43 U.S.C. Section 1212, make it a crime for any person knowingly and willfully to make to any department or agency of the United States any false, fictitious or fraudulent statements or representations as to any matter within its jurisdiction.

(Instructions on page 2)

\*\* BLM REVISED \*\* BLM REVISED \*\* BLM REVISED \*\* BLM REVISED \*\* BLM REVISED \*\*

Wells/Facilities, continued

Agreement	Lease	Well/Fac Name, Number	API Number	Location
NMNM118108	NMNM118108	HH SO 8 P2 5H	30-015-43935-00-X1	Sec 17 T26S R27E SESW 255FNL 960FWL
NMNM118108	NMNM118108	HH SO 8 P2 13H	30-015-43933-00-X1	Sec 17 T26S R27E NWNW 305FNL 960FWL
NMNM118108	NMNM118108	HH SO 8 P2 14H	30-015-43931-00-X1	Sec 17 T26S R27E NWNW 330FNL 960FWL
NMNM118108	NMNM118108	HH SO 8 P2 21H	30-015-43927-00-X1	Sec 17 T26S R27E NWNW 205FNL 960FWL
NMNM118108	NMNM118108	HH SO 8 P2 22H	30-015-43928-00-X1	Sec 17 T26S R27E NWNW 230FNL 960FWL
NMNM118108	NMNM118108	HH SO 8 P2 6H	30-015-43934-00-X1	Sec 17 T26S R27E NWNW 280FNL 960FWL

32. Additional remarks, continued

SHOULD YOU HAVE ANY QUESTIONS, PLEASE GIVE ME A CALL @ 432-687-7631.

**Delaware Basin in Eddy County**

**Changes to APD for Federal Wells**

<b>HH SO 8 P2</b>	<b>5H</b>	<b>30-015-43935</b>
<b>HH SO 8 P2</b>	<b>6H</b>	<b>30-015-43934</b>
<b>HH SO 8 P2</b>	<b>13H</b>	<b>30-015-43933</b>
<b>HH SO 8 P2</b>	<b>14H</b>	<b>30-015-43931</b>
<b>HH SO 8 P2</b>	<b>21H</b>	<b>30-015-43927</b>
<b>HH SO 8 P2</b>	<b>22H</b>	<b>30-015-43928</b>

**Rig        Patterson 270**

**CVX Contact:        Rod Milligan Drilling Engineer 281-413-9794**

**CVX Contactct:        Dorian K. Fuentes Regulatory Specialist 432-687-7631**

6 well pad Bi-lateral Patterson Mock Pad

[illegible]

- 
- Architectural site plan showing a residential development. The plan includes a central road labeled "ST. ASH". To the left of the road are several buildings, including a "HOUSE" and a "GARAGE". To the right of the road are more buildings, including a "HOUSE" and a "GARAGE". A large area on the right is labeled "MAINTENANCE YARD". Dimensions are indicated: "335'" for the total width, "179.5'" for a specific section, and "210'" for another section. A north arrow is located in the upper right corner.

Mud  
Produced

260'

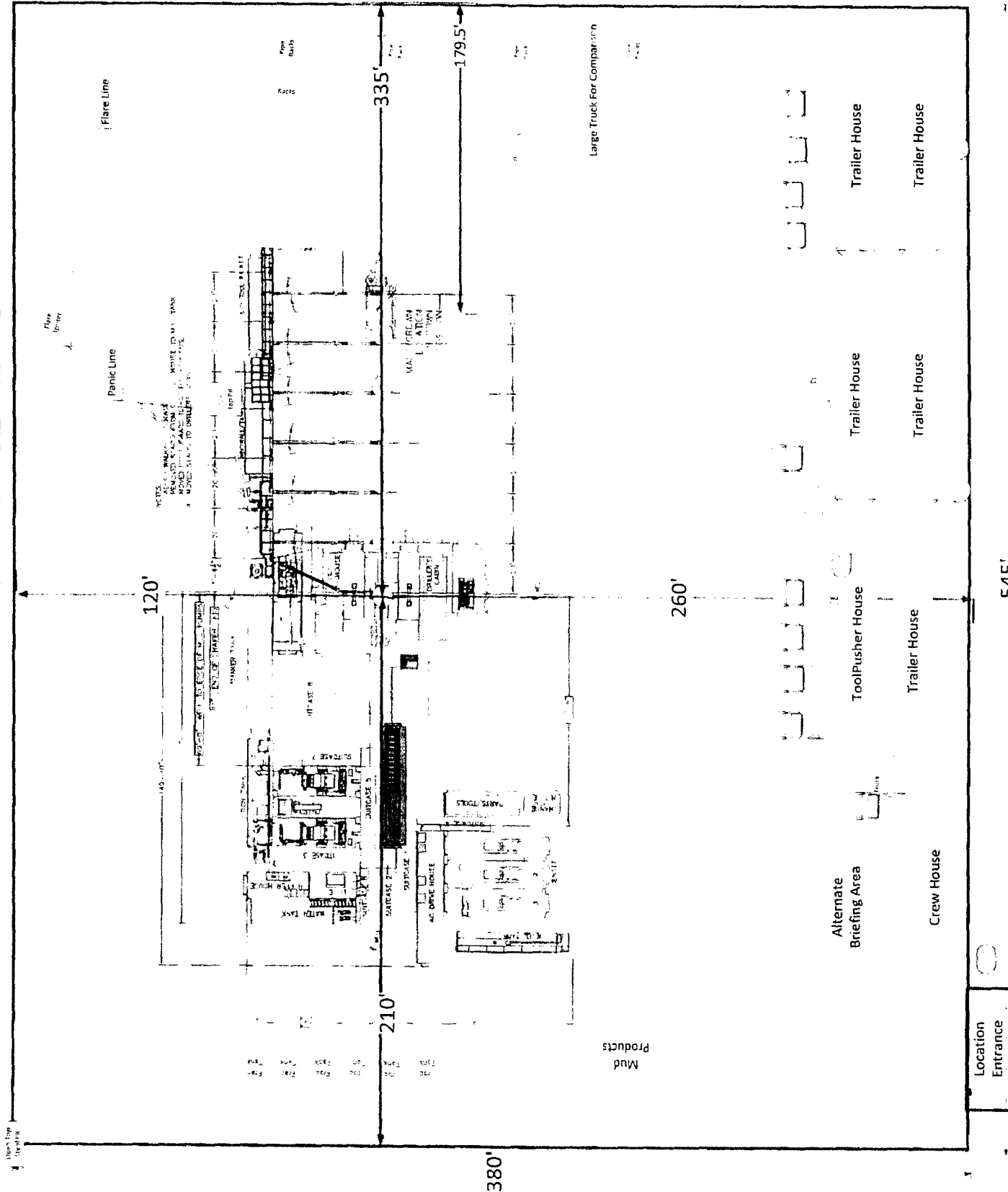

• **Surface Hole:**

1. Drill 17-1/2" surface hole with fresh water to planned casing set depth with 10' rat hole.
2. Run casing as stated by approved APD, land out wellhead, and cement.
3. Dress out 13-5/8" 5M SH-2 wellhead and install/secure with temporary abandonment cap, and a pressure gauge will be installed. Reference image below *Part U 399984*
4. Skid to next well according to below "Drill Order"  
*Repeat 1 through 3 until all six surface holes are drilled, cased and cemented*

• **Intermediate Hole:**

1. N/U, using an API approved Quick-Connect, and test 13-5/8" 10M Class IV BOP to 250 psi/ 5,000 psi.
2. Test casing to required pressure. Drill out shoe track and 10' of new formation. Perform FIT. Drill 12-1/4" intermediate hole to planned casing set depth with ~10' of rat hole.
3. Run casing as stated by approved APD, land out hanger and cement.

• **Production Hole:**

1. Test casing to required pressure. Drill out shoe track and 10' of new formation. Perform FIT. Drill 8-3/4" vertical section, curve, and lateral as stated by approved APD.
2. Run casing as stated by approved APD, cement, land out hanger and cement.
3. Install back pressure valve and temporary abandonment cap.  
Repeat steps in intermediate hole and production hole until all Six wells are drilled, cased, and cemented.

**Summary: Variance to batch drill the HH SO 10 P3 not requested in the MDP nor original submittal.**

**Chevron respectfully request the ability to batch drill in the HH SO 8 P2 13H, 14H, 21H, 22H, 5H, 6H. The summary provided is a brief description of the main operational sequences for drilling and casing the six wells referenced.**

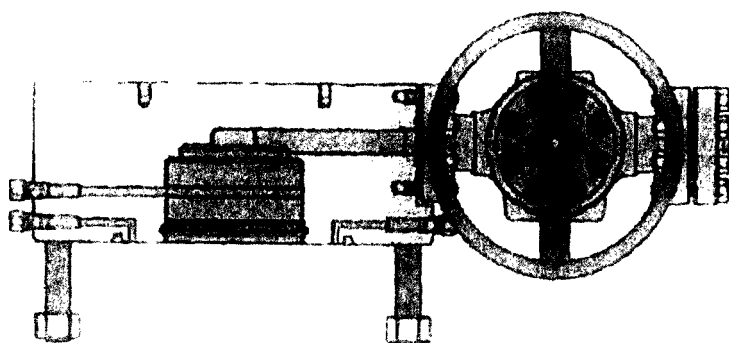

TA Cap, EBS-F-RH, 9"  
13-5/8" 5M  
Part # 399984 - Rental

**PECOS DISTRICT  
CONDITIONS OF APPROVAL**

<b>OPERATOR'S NAME:</b>	<b>Chevron USA Inc.</b>
<b>LEASE NO.:</b>	<b>NMNM-118108</b>
<b>WELL NAME &amp; NO.:</b>	<b>HH SO 8 P2 13H</b>
<b>SURFACE HOLE FOOTAGE:</b>	<b>0305' FNL &amp; 0960' FWL</b>
<b>BOTTOM HOLE FOOTAGE:</b>	<b>0180' FNL &amp; 0330' FWL Sec. 05, T. 26 S., R 27 E.</b>
<b>LOCATION:</b>	<b>Section 17, T. 26 S., R 27 E., NMPM</b>
<b>COUNTY:</b>	<b>Eddy County, New Mexico</b>

**All COAs still apply expect the following:**

1. Unless the production casing has been run and cemented or the well has been properly plugged, the drilling rig shall not be removed from over the hole without prior approval.
  - a. In the event the operator has proposed to drill multiple wells utilizing a skid/walking rig. Operator shall secure the wellbore on the current well, after installing and testing the wellhead, by installing a blind flange of like pressure rating to the wellhead and a pressure gauge that can be monitored while drilling is performed on the other well(s).
  - b. When the operator proposes to set surface casing with Spudder Rig
    - Notify the BLM when moving in and removing the Spudder Rig.
    - Notify the BLM when moving in the 2<sup>nd</sup> Rig. Rig to be moved in within 90 days of notification that Spudder Rig has left the location.
    - BOP/BOPE test to be conducted per Onshore Oil and Gas Order No. 2 as soon as 2nd Rig is rigged up on well.

**ZS 010218**