

Submit 1 Copy To Appropriate District Office
District I - (575) 393-6161
1625 N. French Dr., Hobbs, NM 88240
District II - (575) 748-1283
811 S. First St., Artesia, NM 88210
District III - (505) 334-6178
1000 Rio Brazos Rd., Aztec, NM 87410
District IV - (505) 476-3460
1220 S. St. Francis Dr., Santa Fe, NM 87505

State of New Mexico
Energy, Minerals and Natural Resources

Form C-103
Revised July 18, 2013

OIL CONSERVATION DIVISION
1220 South St. Francis Dr.
Santa Fe, NM 87505

SUNDRY NOTICES AND REPORTS ON WELLS (DO NOT USE THIS FORM FOR PROPOSALS TO DRILL OR TO DEEPEN OR PLUG BACK TO A DIFFERENT RESERVOIR. USE "APPLICATION FOR PERMIT" (FORM C-101) FOR SUCH PROPOSALS.)		WELL API NO. 30-015-44501
1. Type of Well: Oil Well <input type="checkbox"/> Gas Well <input checked="" type="checkbox"/> Other <input type="checkbox"/>		5. Indicate Type of Lease STATE <input type="checkbox"/> FEE <input checked="" type="checkbox"/>
2. Name of Operator Marathon Oil Permian LLC.		6. State Oil & Gas Lease No.
3. Address of Operator 5555 San Felipe St, Houston, TX 77056		7. Lease Name or Unit Agreement Name Hermes Fee 23 28 30 WA
4. Well Location Unit Letter <u>D</u> : <u>370</u> feet from the <u>South</u> line and <u>1634</u> feet from the <u>East</u> line Section <u>30</u> Township <u>23S</u> Range <u>28E</u> NMPM County <u>Eddy</u>		8. Well Number <u>1H</u>
11. Elevation (Show whether DR, RKB, RT, GR, etc.) 3117		9. OGRID Number 372098
		10. Pool name or Wildcat Purple Sage; Wolf Camp

12. Check Appropriate Box to Indicate Nature of Notice, Report or Other Data

NOTICE OF INTENTION TO:		SUBSEQUENT REPORT OF:	
PERFORM REMEDIAL WORK <input type="checkbox"/>	PLUG AND ABANDON <input type="checkbox"/>	REMEDIAL WORK <input type="checkbox"/>	ALTERING CASING <input type="checkbox"/>
TEMPORARILY ABANDON <input type="checkbox"/>	CHANGE PLANS <input type="checkbox"/>	COMMENCE DRILLING OPNS. <input type="checkbox"/>	P AND A <input type="checkbox"/>
PULL OR ALTER CASING <input type="checkbox"/>	MULTIPLE COMPL <input type="checkbox"/>	CASING/CEMENT JOB <input type="checkbox"/>	
DOWNHOLE COMMINGLE <input type="checkbox"/>			
CLOSED-LOOP SYSTEM <input type="checkbox"/>			
OTHER: <input type="checkbox"/>		OTHER: Updated C-102 <input checked="" type="checkbox"/>	

13. Describe proposed or completed operations. (Clearly state all pertinent details, and give pertinent dates, including estimated date of starting any proposed work). SEE RULE 19.15.7.14 NMAC. For Multiple Completions: Attach wellbore diagram of proposed completion or recompletion.

Marathon Oil Permian LLC. discovered an error in the SHL NAD27 LAT and LONG on the submitted C-102. Please see attachment for updated C-102.

Previous (incorrect) NAD27 LAT & LONG:
32.27159579N -104.12656165W

Updated (correct) NAD27 LAT & LONG:
32.26969451N -104.12286637W

NM OIL CONSERVATION
ARTESIA DISTRICT

FEB 15 2018

RECEIVED

DCD used
NAD 83

Spud Date: 12/15/2017

Rig Release Date: 01/28/2018

I hereby certify that the information above is true and complete to the best of my knowledge and belief.

SIGNATURE Melissa Szudera TITLE Regulatory Compliance Representative DATE 02/15/2018
Type or print name Melissa Szudera E-mail address: mszudera@marathonoil.com PHONE: 713-296-3179

For State Use Only

APPROVED BY Raymond St. Bodany TITLE Geologist DATE 2-15-18
Conditions of Approval (if any):

State of New Mexico
Energy, Minerals & Natural Resources Department
OIL CONSERVATION DIVISION
1220 South St. Francis Dr.
Santa Fe, NM 87505

FEB 15 2013

☐ AMENDED REPORT

RECEIVED

WELL LOCATION AND ACREAGE DEDICATION PLAT

¹ API Number 30-015-44501	² Pool Code 98220	³ Pool Name PURPLE SAGE; WOLFCAMP
⁴ Property Code	⁵ Property Name HERMES FEE 23-28-30 WA	⁶ Well Number 1H
⁷ OGRID No. 372098	⁸ Operator Name MARATHON OIL PERMIAN, LLC	⁹ Elevation 3117

¹⁰ Surface Location

UL or lot no.	Section	Township	Range	Lot Idn	Feet from the	North/South line	Feet from the	East/West line	County
□	30	T23S	R28E		370	SOUTH	1634	EAST	EDDY

" Bottom Hole Location If Different From Surface

UL or lot no.	Section	Township	Range	Lot Idn	Feet from the	North/South line	Feet from the	East/West line	County
B	30	T23S	R28E		330	NORTH	1990	EAST	EDDY

¹² Dedicated Acres	¹³ Joint or Infill	¹⁴ Consolidation Code	¹⁵ Order No.
320			

No allowable will be assigned to this completion until all interests have been consolidated or a non-standard unit has been approved by the division.

SECTION 24	SECTION 19		SECTION 20	
SECTION 25	SECTION 30	<p style="position: absolute; top: 10%; left: 10%;">LAST TAKE/BHL</p> <p style="position: absolute; bottom: 10%; right: 10%;">FIRST TAKE SHL</p> <p style="position: absolute; top: 50%; left: 50%; transform: translate(-50%, -50%);">CALLED 320 ACRE PRODUCING AREA</p>	SECTION 29	
R-27-E R-28-E	LAST TAKE POINT/BOTTOM HOLE LOCATION 330' FNL 1990' FEL NAD 83, SPCS NM EAST X:605855.70' / Y:466548.06' LAT:32.28244221N / LON:104.12455978W NAD 27, SPCS NM EAST X:564673.03' / Y:466489.14' LAT:32.28232197N / LON:104.12406355W		SECTION 26	
	FIRST TAKE POINT 330' FSL 2008' FEL NAD 83, SPCS NM EAST X:605861.47' / Y:461915.63' LAT:32.26970824N / LON:104.12457028W NAD 27, SPCS NM EAST X:564678.69' / Y:461856.83' LAT:32.26958792N / LON:104.12407447W		SECTION 27	
	SURFACE HOLE LOCATION 370' FSL 1634' FEL NAD 83, SPCS NM EAST X:606234.80' / Y:461955.14' LAT:32.26981484N / LON:104.12336214W NAD 27, SPCS NM EAST X:565052.01' / Y:461896.34' LAT:32.26969431N / LON:104.12286637W		SECTION 28	
SECTION 25	SECTION 30		SECTION 29	
SECTION 36	SECTION 31		SECTION 32	
CORNER COORDINATES NAD 83, SPCS NM EAST A - X: 605195.28' / Y: 466881.59' B - X: 607843.83' / Y: 466867.47' C - X: 607871.09' / Y: 461580.40' D - X: 605201.88' / Y: 461587.33'		CORNER COORDINATES NAD 27, SPCS NM EAST A - X: 564012.63' / Y: 466822.68' B - X: 566661.13' / Y: 466908.52' C - X: 566688.27' / Y: 461521.58' D - X: 564019.10' / Y: 461528.37'		

2	02/14/2018	DEF
REV.	DATE	BY

LOCATION VERIFICATION MAP

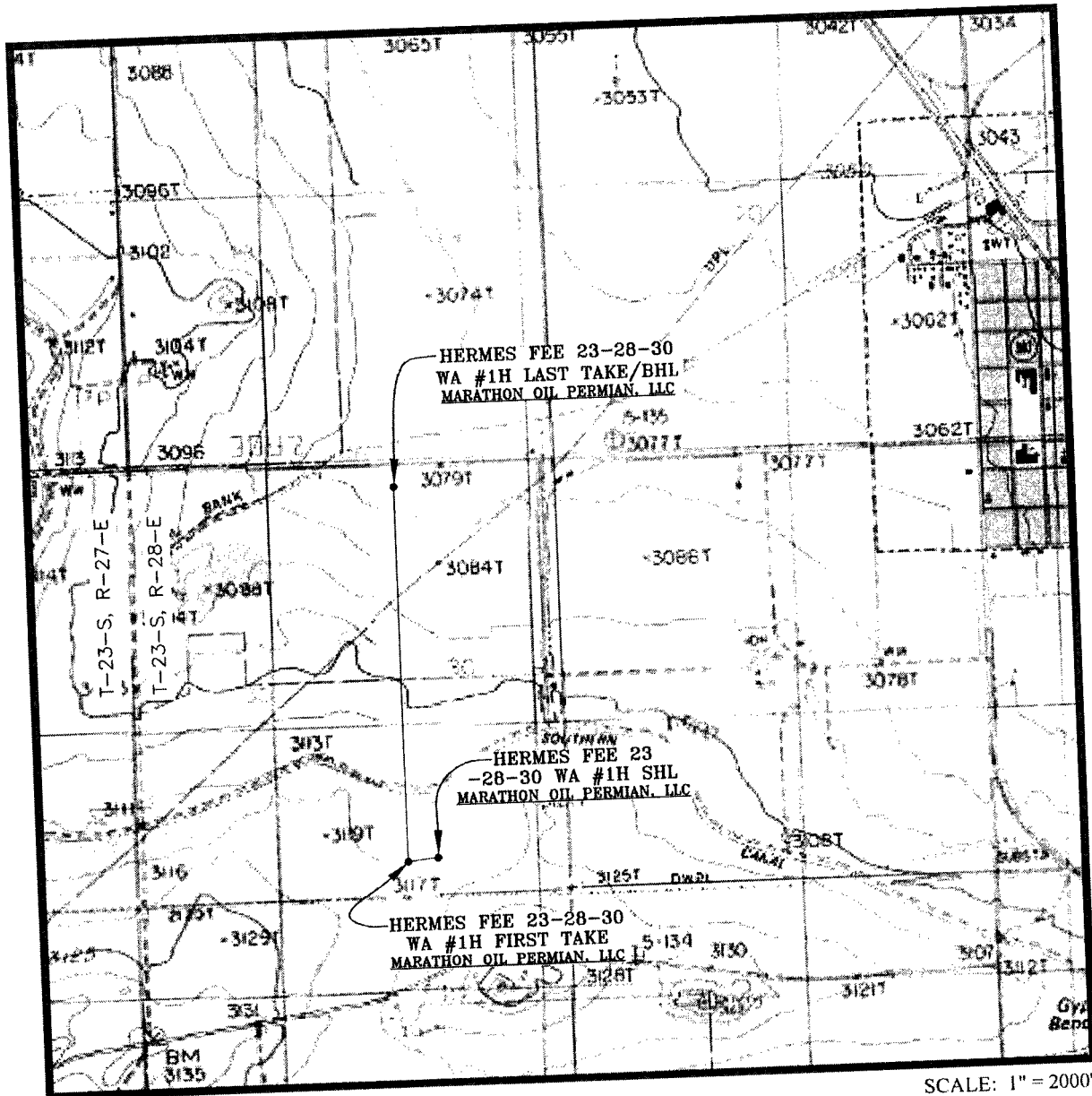

SEC. 30 TWP. 23-S RGE. 28-E
 SURVEY: N.M.P.M.
 COUNTY: EDDY
 DESCRIPTION: 370' FSL & 1634' FEL
 ELEVATION: 3117
 OPERATOR: MARATHON OIL PERMIAN, LLC
 LEASE: HERMES FEE 23-28-30
 U.S.G.S. TOPOGRAPHIC MAP: LOVING, N.M.

SCALE: 1" = 2000'
 CONTOUR INTERVAL = 10'

PREPARED BY:
 R-SQUARED GLOBAL, LLC
 1309 LOUISVILLE AVENUE, MONROE, LA 71201
 318-323-6900 OFFICE
 JOB No. R3791_001

VICINITY MAP

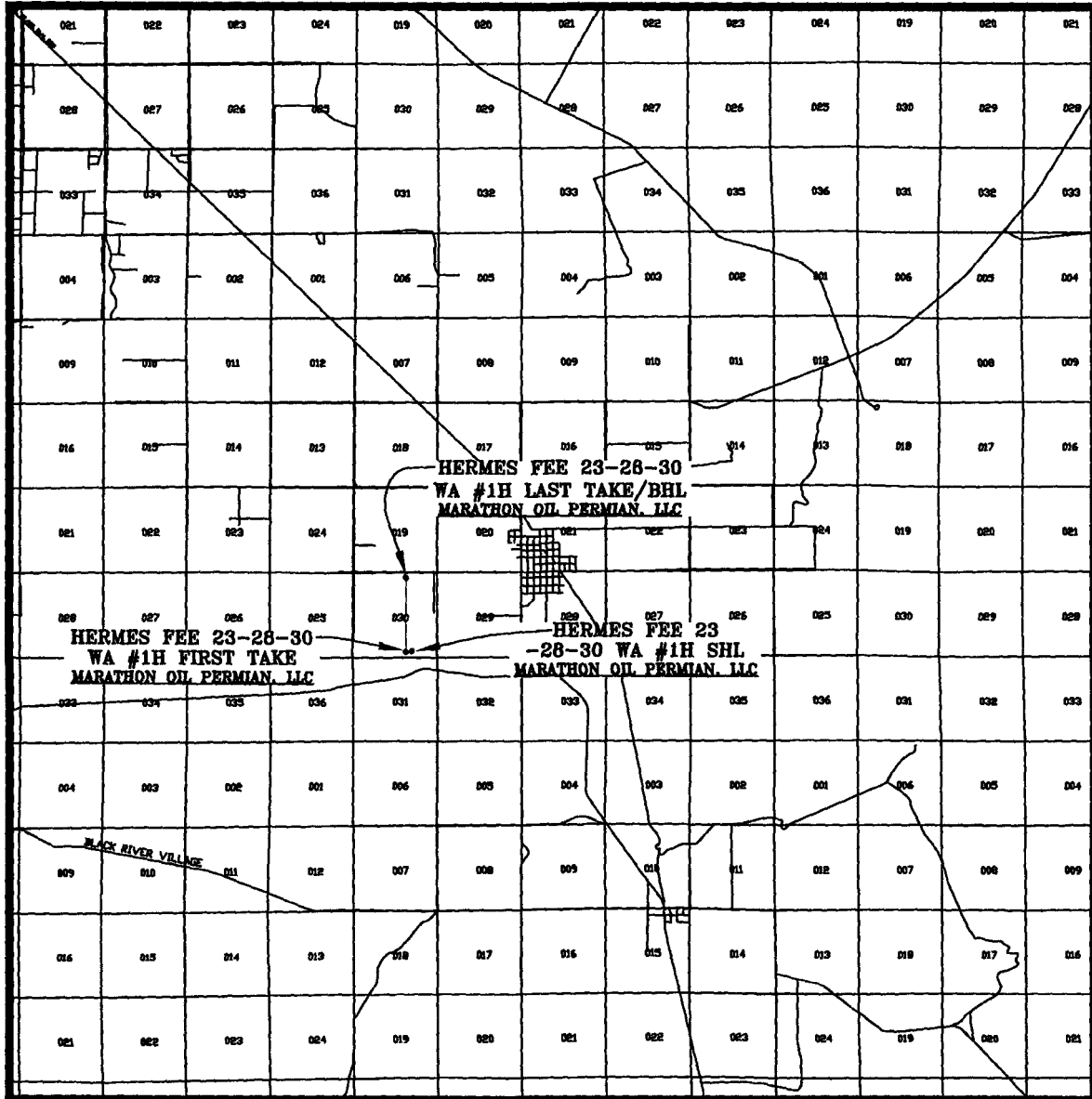

SEC. 30 TWP. 23-S RGE. 28-E
 SURVEY: N.M.P.M.
 COUNTY: EDDY
 DESCRIPTION: 370' FSL & 1634' FEL
 ELEVATION: 3117'
 OPERATOR: MARATHON OIL PERMIAN, LLC
 LEASE: HERMES FEE 23-28-30
 U.S.G.S. TOPOGRAPHIC MAP: LOVING, N.M.

SCALE: 1" = 2 MILES

PREPARED BY:
 R-SQUARED GLOBAL, LLC
 1309 LOUISVILLE AVENUE, MONROE, LA 71201
 318-323-6900 OFFICE
 JOB No. R3791_001