

District I  
1625 N. French Dr., Hobbs, NM 88240  
Phone: (575) 393-6161 Fax: (575) 393-0720  
District II  
811 S. First St., Artesia, NM 88210  
Phone: (575) 748-1283 Fax: (575) 748-9720  
District III  
1000 Rio Brazos Road, Aztec, NM 87410  
Phone: (505) 334-6178 Fax: (505) 334-6170  
District IV  
1220 S. St. Francis Dr., Santa Fe, NM 87505  
Phone: (505) 476-3460 Fax: (505) 476-3462

State of New Mexico  
Energy, Minerals & Natural Resources Department  
OIL CONSERVATION DIVISION  
1220 South St. Francis Dr.  
Santa Fe, NM 87505

Form C-102  
Revised August 1, 2011  
Submit one copy to appropriate  
District Office

APR 06 2018

☐ AMENDED REPORT

RECEIVED

WELL LOCATION AND ACREAGE DEDICATION PLAT

<sup>1</sup> API Number 30-015-44861	<sup>2</sup> Pool Code 98220	<sup>3</sup> Pool Name PURPLE SAGE (WOLFCAMP)
<sup>4</sup> Property Code 319770	<sup>5</sup> Property Name RED LIGHT STATE COM 23-26-27 WXY	<sup>6</sup> Well Number 12H
<sup>7</sup> OGRID No. 372098	<sup>8</sup> Operator Name MARATHON OIL PERMIAN LLC	<sup>9</sup> Elevation 3297'

<sup>10</sup> Surface Location

UL or lot no.	Section	Township	Range	Lot Idn	Feet from the	North/South line	Feet from the	East/West line	County
B	27	23S	26E		662	NORTH	2488	EAST	EDDY

<sup>11</sup> Bottom Hole Location If Different From Surface

UL or lot no.	Section	Township	Range	Lot Idn	Feet from the	North/South line	Feet from the	East/West line	County
G	34	23S	26E		2317	NORTH	2333	EAST	EDDY

<sup>12</sup> Dedicated Acres 480.00	<sup>13</sup> Joint or Infill	<sup>14</sup> Consolidation Code	<sup>15</sup> Order No.
---	-------------------------------	----------------------------------	-------------------------

No allowable will be assigned to this completion until all interests have been consolidated or a non-standard unit has been approved by the division.

<p>SECTION 21 SECTION 22 SECTION 28 SECTION 27</p> <p>SURFACE HOLE LOCATION 662' FNL 2488' FEL, SECTION 27 NAD 83, SPCS NM EAST X: 557722.51' / Y: 465887.91' LAT: 32.28078898N / LON: 104.28031422W NAD 27, SPCS NM EAST X: 516540.56' / Y: 465829.73' LAT: 32.28067132N / LON: 104.27981210W</p> <p>FIRST TAKE POINT 330' FNL 2357' FEL, SECTION 27 NAD 83, SPCS NM EAST X: 557856.73' / Y: 466222.88' LAT: 32.28170957N / LON: 104.27987937W NAD 27, SPCS NM EAST X: 516674.79' / Y: 466164.68' LAT: 32.28159191N / LON: 104.27937723W</p> <p>SECTION 28 SECTION 27 SECTION 33 SECTION 34</p> <p>LAST TAKE POINT/BOTTOM HOLE LOCATION 2317' FNL 2333' FEL, SECTION 34 NAD 83, SPCS NM EAST X: 557852.21' / Y: 458938.65' LAT: 32.26168609N / LON: 104.27990572W NAD 27, SPCS NM EAST X: 516670.12' / Y: 458880.67' LAT: 32.26156835N / LON: 104.27940417W</p>	<p>SECTION 23 SECTION 26 2357' 2488'</p> <p>CORNER COORDINATES NAD 83, SPCS NM EAST A - X: 557527.50' / Y: 466545.57' B - X: 560216.51' / Y: 466605.88' C - X: 560184.56' / Y: 458631.02' D - X: 557523.27' / Y: 458605.48'</p> <p>CORNER COORDINATES NAD 27, SPCS NM EAST A - X: 516345.56' / Y: 466487.38' B - X: 519034.55' / Y: 466547.63' C - X: 519002.44' / Y: 458572.99' D - X: 516341.17' / Y: 458547.51'</p> <p>480.00 ACRE PRODUCING AREA</p> <p>SECTION 26 SECTION 35 2349'</p> <p>2333'</p>	<p><b><sup>17</sup> OPERATOR CERTIFICATION</b></p> <p>I hereby certify that the information contained herein is true and complete to the best of my knowledge and belief, and that this organization either owns a working interest or unleased mineral interest in the land including the proposed bottom hole location or has a right to drill this well at this location pursuant to a contract with an owner of such a mineral or working interest, or to a voluntary pooling agreement or a compulsory pooling order heretofore entered by the division.</p> <p>Jennifer Van Curen 4/5/18 Signature Date</p> <p>Jennifer Van Curen Printed Name</p> <p>Email Address</p> <p><b><sup>18</sup> SURVEYOR CERTIFICATION</b></p> <p>I hereby certify that the well location shown on this plat was plotted from field notes of actual surveys made by me or under my supervision, and that the same is true and correct to the best of my belief.</p> <p>MARCH 14, 2018 Date of Survey</p> <p>Signature and Seal of Professional Surveyor</p> <p>LLOYD P. SHORT NEW MEXICO 21653 PROFESSIONAL SURVEYOR</p> <p>Certificate Number LLOYD P. SHORT 21653</p>
--	--	---

# LOCATION VERIFICATION MAP

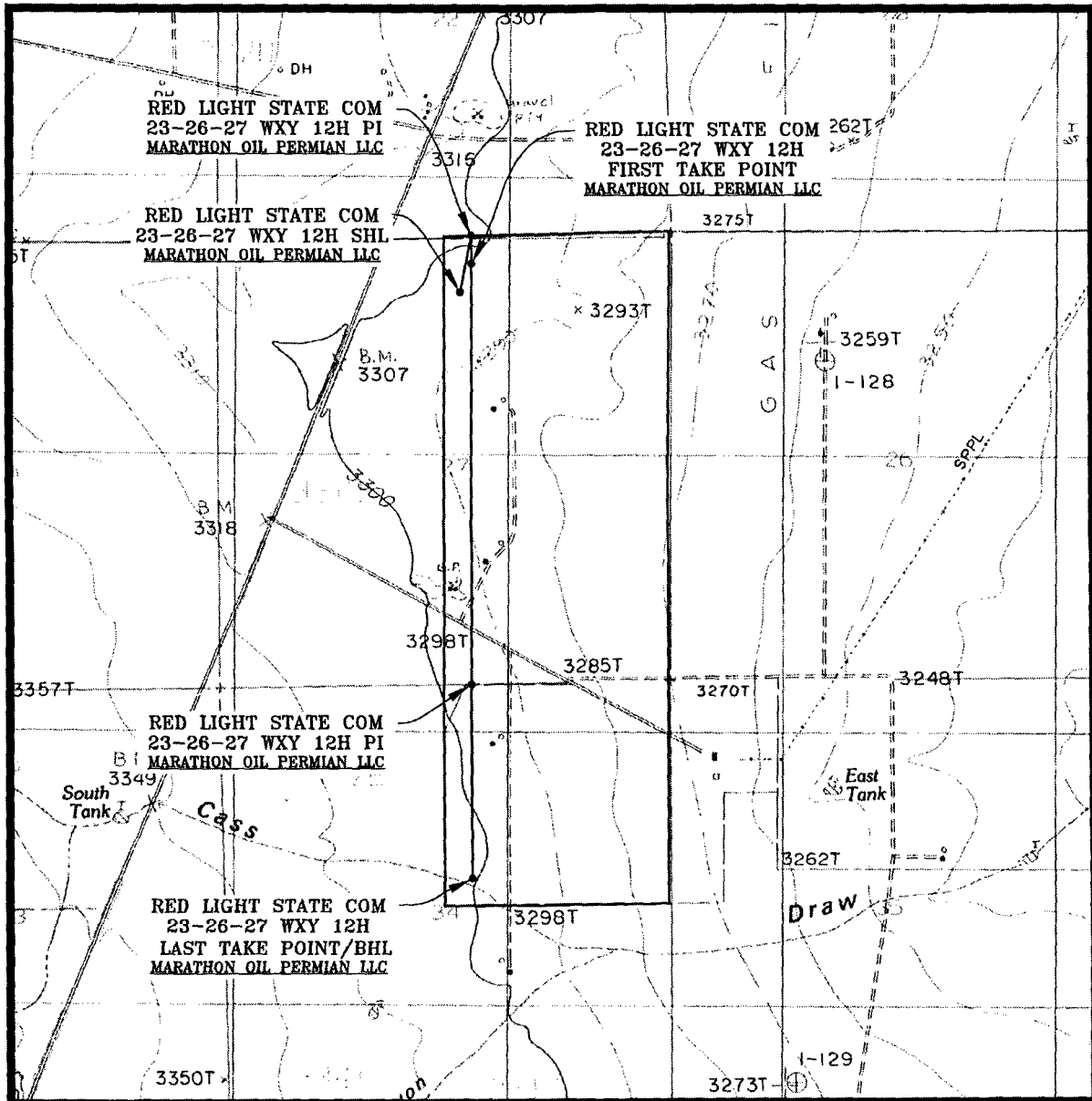

SEC. 27 TWP. 23-S RGE. 26-E  
 SURVEY: N.M.P.M.  
 COUNTY: EDDY  
 DESCRIPTION: 662' FNL & 2488' FEL  
 ELEVATION: 3297'  
 OPERATOR: MARATHON OIL PERMIAN LLC  
 LEASE: RED LIGHT STATE COM 23-26-27  
 U.S.G.S. TOPOGRAPHIC MAP: KITCHEN COVE, N.M.

SCALE: 1" = 2000'  
 CONTOUR INTERVAL = 10'

# VICINITY MAP

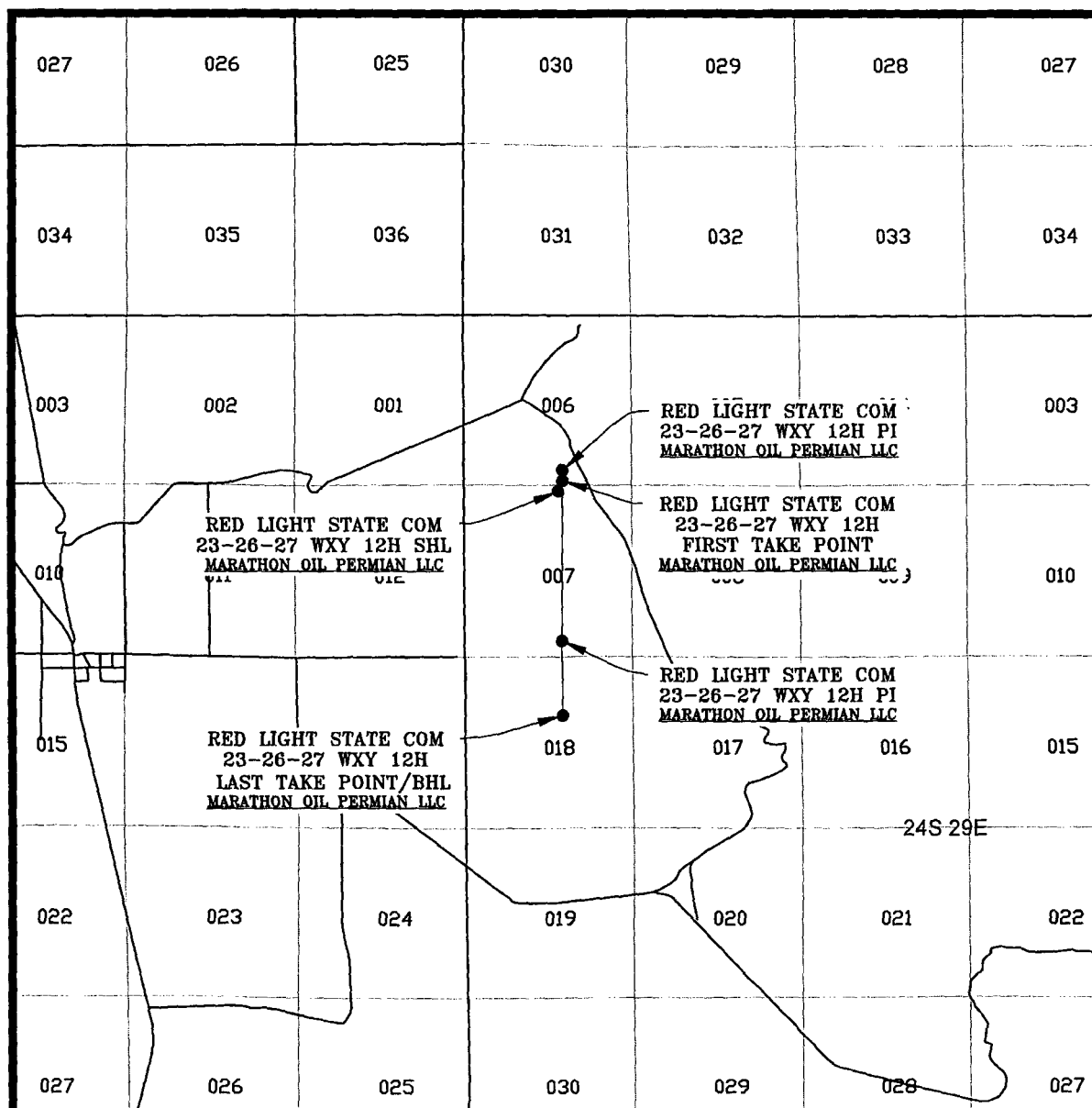

SEC. 27 TWP. 23-S RGE. 26-E  
 SURVEY: N.M.P.M.  
 COUNTY: EDDY  
 DESCRIPTION: 662' FNL & 2488' FEL  
 ELEVATION: 3297'  
 OPERATOR: MARATHON OIL PERMIAN LLC  
 LEASE: RED LIGHT STATE COM 23-26-27  
 U.S.G.S. TOPOGRAPHIC MAP: KITCHEN COVE, N.M.

SCALE: 1" = 1 MILE

PREPARED BY:  
 R-SQUARED GLOBAL, LLC  
 1309 LOUISVILLE AVENUE, MONROE, LA 71201  
 318-323-6900 OFFICE  
 JOB No. R3788\_006



# Marathon Oil Corporation

EDDY COUNTY, NM (NAD27)  
RED LIGHT STATE COM 23-26-27  
WXY #12H

PLAN #1  
RIG TBD

GL ELEV.: 3297.00  
DEPTH REF: XG = 26.5' @ 332.3 SOUTHER (RIG TBD)

M OIL CONSERVATION  
ARTESIA DISTRICT

APR 06 2018

RECEIVED

## WELL DETAILS:

GROUND LEVEL: 3297.00  
LATITUDE: 32° 16' 50.47" N  
LONGITUDE: 106° 47' 32.4" W  
EASTING: 516540.56  
NORTHING: 465829.73

SECTION DETAILS

MD	INC	AZI	TVD	+N-S	+E-W	DLEG	TEAGE	USECT	TARGET
0.00	0.00	0.00	0.00	0.00	0.00	0.00	0.00	0.00	
3000.00	0.00	0.00	3000.00	0.00	0.00	0.00	0.00	0.00	
3500.00	0.00	15.00	3497.47	42.04	11.26	2.00	15.00	42.04	
4000.00	0.00	15.00	3069.53	46.05	15.74	0.00	15.00	46.05	
4500.00	0.00	15.00	2641.00	50.08	15.74	0.00	15.00	50.08	
5000.00	0.00	15.00	2212.50	54.11	15.74	0.00	15.00	54.11	
5500.00	0.00	15.00	1784.00	58.14	15.74	0.00	15.00	58.14	
6000.00	0.00	15.00	1355.50	62.17	15.74	0.00	15.00	62.17	
6500.00	0.00	15.00	927.00	66.20	15.74	0.00	15.00	66.20	
7000.00	0.00	15.00	498.50	70.23	15.74	0.00	15.00	70.23	
7500.00	0.00	15.00	69.00	74.26	15.74	0.00	15.00	74.26	
8000.00	0.00	15.00	0.00	78.29	15.74	0.00	15.00	78.29	

DESIGN TARGET DETAILS

Name	TVD	+N-S	+E-W	North	East
BHILRSCWXY#12H	8730.00	-8949.69	129.57	465829.73	516540.56
FTFRLSCWXY#12H	8730.00	-8949.69	129.57	465829.73	516540.56

DRILLING TARGET: 8730' TVD @ 0VS // 90.0° INC.  
WINDOW: 10' UP // 10' DOWN  
WINDOW: 30' LEFT // 30' RIGHT

PROJECT DETAILS: EDDY COUNTY, NM (NAD27)  
GEODETIC SYSTEM: US STATE PLANE 1927 (EXACT SOLUTION)  
DATUM: NAD 1927 (NADCON CONUS)  
ELLIPSOID: CLARKE 1866 EAST 3001  
ZONE: NEW MEXICO EAST 3001  
SYSTEM DATUM: MEAN SEA LEVEL

SITE DETAILS: RED LIGHT STATE COM 23-26-27  
SITE CENTRE NORTHING: 465829.73  
EASTING: 516540.56  
POSITIONAL UNCERTAINTY: 0.03  
CONVERGENCE: 0.03  
LOCAL NORTH: GRID

FORMATION TOP DETAILS

TVD PATH	FORMATION
0.00	CASTLE
575.00	CASTLE
1563.00	BASE OF SALT
1762.00	LAMAR
1930.00	BELL CANYON
2617.00	CHERRY CANYON
3629.50	BONE SPRING
4151.00	1ST BONE SPRING SAND
4238.80	2ND BONE SPRING SAND
6562.00	3RD BONE SPRING SAND
8241.00	WOLF CAMP V SAND
8599.00	WOLF CAMP V SAND
8621.00	WOLF CAMP V SAND
8632.00	WOLF CAMP V SAND
8643.00	WOLF CAMP V SAND
8654.00	WOLF CAMP V SAND
8665.00	WOLF CAMP V SAND
8676.00	WOLF CAMP V SAND
8687.00	WOLF CAMP V SAND
8698.00	WOLF CAMP V SAND
8709.00	WOLF CAMP V SAND
8720.00	WOLF CAMP V SAND
8730.00	WOLF CAMP V SAND

TO CONVERT MAGNETIC NORTH TO GRID, ADD 7.37°  
TO CONVERT TRUE NORTH TO GRID, SUBTRACT 0.03°

TO CONVERT MAGNETIC NORTH TO GRID, ADD 7.37°  
TO CONVERT TRUE NORTH TO GRID, SUBTRACT 0.03°

TO CONVERT MAGNETIC NORTH TO GRID, ADD 7.37°  
TO CONVERT TRUE NORTH TO GRID, SUBTRACT 0.03°

TO CONVERT MAGNETIC NORTH TO GRID, ADD 7.37°  
TO CONVERT TRUE NORTH TO GRID, SUBTRACT 0.03°

TO CONVERT MAGNETIC NORTH TO GRID, ADD 7.37°  
TO CONVERT TRUE NORTH TO GRID, SUBTRACT 0.03°

TO CONVERT MAGNETIC NORTH TO GRID, ADD 7.37°  
TO CONVERT TRUE NORTH TO GRID, SUBTRACT 0.03°

TO CONVERT MAGNETIC NORTH TO GRID, ADD 7.37°  
TO CONVERT TRUE NORTH TO GRID, SUBTRACT 0.03°

TO CONVERT MAGNETIC NORTH TO GRID, ADD 7.37°  
TO CONVERT TRUE NORTH TO GRID, SUBTRACT 0.03°

TO CONVERT MAGNETIC NORTH TO GRID, ADD 7.37°  
TO CONVERT TRUE NORTH TO GRID, SUBTRACT 0.03°

TO CONVERT MAGNETIC NORTH TO GRID, ADD 7.37°  
TO CONVERT TRUE NORTH TO GRID, SUBTRACT 0.03°

TO CONVERT MAGNETIC NORTH TO GRID, ADD 7.37°  
TO CONVERT TRUE NORTH TO GRID, SUBTRACT 0.03°

TO CONVERT MAGNETIC NORTH TO GRID, ADD 7.37°  
TO CONVERT TRUE NORTH TO GRID, SUBTRACT 0.03°

TO CONVERT MAGNETIC NORTH TO GRID, ADD 7.37°  
TO CONVERT TRUE NORTH TO GRID, SUBTRACT 0.03°

TO CONVERT MAGNETIC NORTH TO GRID, ADD 7.37°  
TO CONVERT TRUE NORTH TO GRID, SUBTRACT 0.03°

TO CONVERT MAGNETIC NORTH TO GRID, ADD 7.37°  
TO CONVERT TRUE NORTH TO GRID, SUBTRACT 0.03°

TO CONVERT MAGNETIC NORTH TO GRID, ADD 7.37°  
TO CONVERT TRUE NORTH TO GRID, SUBTRACT 0.03°

TO CONVERT MAGNETIC NORTH TO GRID, ADD 7.37°  
TO CONVERT TRUE NORTH TO GRID, SUBTRACT 0.03°

TO CONVERT MAGNETIC NORTH TO GRID, ADD 7.37°  
TO CONVERT TRUE NORTH TO GRID, SUBTRACT 0.03°

TO CONVERT MAGNETIC NORTH TO GRID, ADD 7.37°  
TO CONVERT TRUE NORTH TO GRID, SUBTRACT 0.03°

TO CONVERT MAGNETIC NORTH TO GRID, ADD 7.37°  
TO CONVERT TRUE NORTH TO GRID, SUBTRACT 0.03°

TO CONVERT MAGNETIC NORTH TO GRID, ADD 7.37°  
TO CONVERT TRUE NORTH TO GRID, SUBTRACT 0.03°

TO CONVERT MAGNETIC NORTH TO GRID, ADD 7.37°  
TO CONVERT TRUE NORTH TO GRID, SUBTRACT 0.03°

TO CONVERT MAGNETIC NORTH TO GRID, ADD 7.37°  
TO CONVERT TRUE NORTH TO GRID, SUBTRACT 0.03°

TO CONVERT MAGNETIC NORTH TO GRID, ADD 7.37°  
TO CONVERT TRUE NORTH TO GRID, SUBTRACT 0.03°

TO CONVERT MAGNETIC NORTH TO GRID, ADD 7.37°  
TO CONVERT TRUE NORTH TO GRID, SUBTRACT 0.03°

TO CONVERT MAGNETIC NORTH TO GRID, ADD 7.37°  
TO CONVERT TRUE NORTH TO GRID, SUBTRACT 0.03°

TO CONVERT MAGNETIC NORTH TO GRID, ADD 7.37°  
TO CONVERT TRUE NORTH TO GRID, SUBTRACT 0.03°

TO CONVERT MAGNETIC NORTH TO GRID, ADD 7.37°  
TO CONVERT TRUE NORTH TO GRID, SUBTRACT 0.03°

TO CONVERT MAGNETIC NORTH TO GRID, ADD 7.37°  
TO CONVERT TRUE NORTH TO GRID, SUBTRACT 0.03°

TO CONVERT MAGNETIC NORTH TO GRID, ADD 7.37°  
TO CONVERT TRUE NORTH TO GRID, SUBTRACT 0.03°