

District I  
1625 N. French Dr., Hobbs, NM 88240  
Phone: (575) 393-6161 Fax: (575) 393-0720  
District II  
811 S. First St., Artesia, NM 88210  
Phone: (575) 748-1283 Fax: (575) 748-9720  
District III  
1000 Rio Brazos Road, Aztec, NM 87410  
Phone: (505) 334-6178 Fax: (505) 334-6170  
District IV  
1220 S. St. Francis Dr., Santa Fe, NM 87505  
Phone: (505) 476-3460 Fax: (505) 476-3462

State of New Mexico **NM OIL CONSERVATION** Form C-102  
Energy, Minerals & Natural Resources Department **ARTESIA DISTRICT** Revised August 1, 2011  
OIL CONSERVATION DIVISION Submit one copy to appropriate District Office  
1220 South St. Francis Dr. APR 23 2018  
Santa Fe, NM 87505

RECEIVED

☐ AMENDED REPORT

WELL LOCATION AND ACREAGE DEDICATION PLAT

<sup>1</sup> API Number 30-015-44893	<sup>2</sup> Pool Code 98220	<sup>3</sup> Pool Name Purple Sage, Wolfcamp
<sup>4</sup> Property Code 321273	<sup>5</sup> Property Name POKER LAKE UNIT 18 BRUSHY DRAW	<sup>6</sup> Well Number 121H
<sup>7</sup> OGRID No. 20737	<sup>8</sup> Operator Name BOPCO, L.P.	<sup>9</sup> Elevation 3164'

<sup>10</sup> Surface Location

UL or lot no.	Section	Township	Range	Lot Idn	Feet from the	North/South line	Feet from the	East/West line	County
2	18	25 S	30 E		2,310	NORTH	570	WEST	EDDY

<sup>11</sup> Bottom Hole Location If Different From Surface

UL or lot no.	Section	Township	Range	Lot Idn	Feet from the	North/South line	Feet from the	East/West line	County
4	19	25 S	30 E		200	SOUTH	330	WEST	EDDY

<sup>12</sup> Dedicated Acres 480	<sup>13</sup> Joint or Infill 482.162	<sup>14</sup> Consolidation Code	<sup>15</sup> Order No.
--------------------------------------	--	----------------------------------	-------------------------

No allowable will be assigned to this completion until all interests have been consolidated or a non-standard unit has been approved by the division.

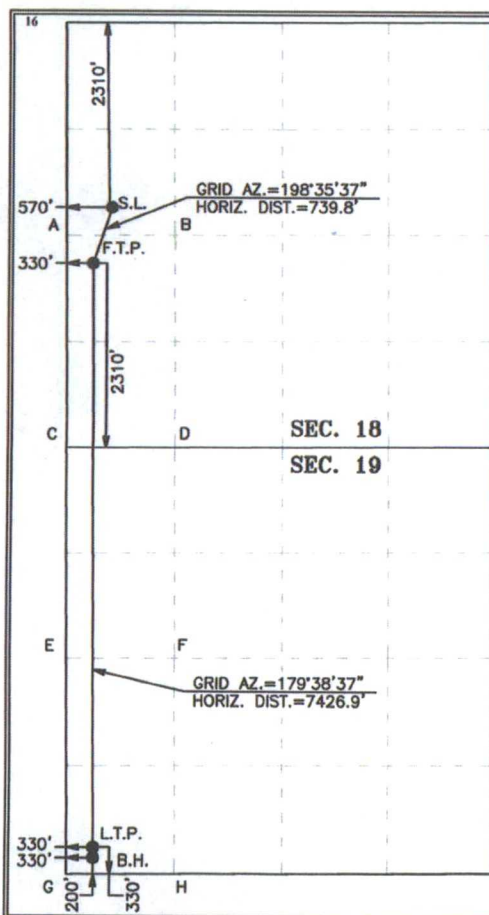

GEODETIC COORDINATES  
NAD 27 NME  
SURFACE LOCATION  
Y = 411,606.9  
X = 625,756.9  
LAT. = 32.130972°N  
LONG. = 103.927082°W

GEODETIC COORDINATES  
NAD 83 NME  
SURFACE LOCATION  
Y = 411,665.2  
X = 666,941.5  
LAT. = 32.131096°N  
LONG. = 103.927567°W

FIRST TAKE POINT  
NAD 27 NME  
Y = 410,905.8  
X = 625,521.0  
LAT. = 32.129047°N  
LONG. = 103.927853°W

FIRST TAKE POINT  
NAD 83 NME  
Y = 410,964.1  
X = 666,705.6  
LAT. = 32.129171°N  
LONG. = 103.928337°W

CORNER COORDINATES TABLE

NAD 27 NME  
A - Y = 411,254.3 N, X = 625,189.0 E  
B - Y = 411,260.5 N, X = 626,533.3 E  
C - Y = 408,594.2 N, X = 625,204.2 E  
D - Y = 408,601.2 N, X = 626,548.3 E  
E - Y = 405,935.1 N, X = 625,221.5 E  
F - Y = 405,943.0 N, X = 626,563.0 E  
G - Y = 403,277.4 N, X = 625,238.2 E  
H - Y = 403,285.0 N, X = 626,577.4 E

CORNER COORDINATES TABLE

NAD 83 NME  
A - Y = 411,312.6 N, X = 666,373.6 E  
B - Y = 411,318.8 N, X = 667,717.9 E  
C - Y = 408,652.4 N, X = 666,388.9 E  
D - Y = 408,659.4 N, X = 667,733.0 E  
E - Y = 405,993.3 N, X = 666,406.3 E  
F - Y = 406,001.2 N, X = 667,747.8 E  
G - Y = 403,335.5 N, X = 666,423.1 E  
H - Y = 403,343.1 N, X = 667,762.3 E

LAST TAKE POINT  
NAD 27 NME  
Y = 403,609.3  
X = 625,566.1  
LAT. = 32.108989°N  
LONG. = 103.927795°W

LAST TAKE POINT  
NAD 83 NME  
Y = 403,667.4  
X = 666,751.0  
LAT. = 32.109113°N  
LONG. = 103.928279°W

BOTTOM HOLE LOCATION  
NAD 27 NME  
Y = 403,479.3  
X = 625,566.9  
LAT. = 32.108631°N  
LONG. = 103.927794°W

BOTTOM HOLE LOCATION  
NAD 83 NME  
Y = 403,537.4  
X = 666,751.8  
LAT. = 32.108756°N  
LONG. = 103.928278°W

<sup>17</sup> OPERATOR CERTIFICATION

I hereby certify that the information contained herein is true and complete to the best of my knowledge and belief, and that this organization either owns a working interest or unleased mineral interest in the land including the proposed bottom hole location or has a right to drill this well at this location pursuant to a contract with an owner of such a mineral or working interest, or to a voluntary pooling agreement or a compulsory pooling order heretofore entered by the division.

Signature: *Stephanie Rabidue*  
Date: \_\_\_\_\_  
Printed Name: *Stephanie Rabidue*  
E-mail Address: *stephanie-rabidue@xtoenergy.com*

<sup>18</sup> SURVEYOR CERTIFICATION

I hereby certify that the well location shown on this plat was plotted from field notes of actual surveys made by me or under my supervision, and that the same is true and correct to the best of my belief.

1-3-2018  
Date of Survey  
Signature and Seal of Professional Surveyor:

MARK DILLON HARP 23786  
Certificate Number



AI 2017050635

*NSP*  
*RVP 4-24-18*